

# August Smart Lock Installation Guide





# Welcome!

This guide will get you up and running with your August Smart Lock. Installation generally takes less than 15 minutes. If you have any trouble, please check our support section ([august.com/support](http://august.com/support)), contact our installer network ([august.com/installers](http://august.com/installers)) or call 844-AUGUST1 (284-8781) for help.

# Preparation

Make sure your existing deadbolt is compatible with the August Smart Lock. Only standard deadbolts are supported. Use our compatibility assistant to double-check. **[august.com/compatibility](https://www.august.com/compatibility)**

## TOOLS NEEDED



You will need a standard phillips screwdriver.

Alternately, we have an installer network available in major cities, who can help with installation. **[august.com/installers](https://www.august.com/installers)**

## Compatibility

**YES**

### Standard

Deadbolt is mounted and operates independently of the door handle

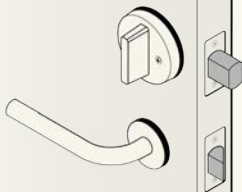

**NO**

### Integrated Lock & Handle

Handle and lock thumb-latch are both mounted together on a metal plate



**NO**

### Mortise

An integrated door handle and deadbolt in a single metal unit

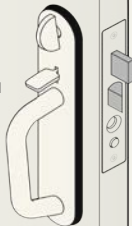

**NO**

### Rim Cylinder

Mounted, on top of the door and door jamb



# Package Contents



**1 August Smart Lock**  
(4 AA Batteries pre-installed)

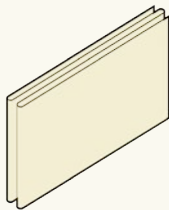

**1 Adhesive Strip**  
(Inside Envelope)



3 Adapters

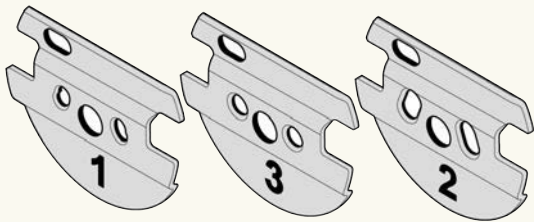

3 Mounting Plates

# Installation Overview

## Before Installation

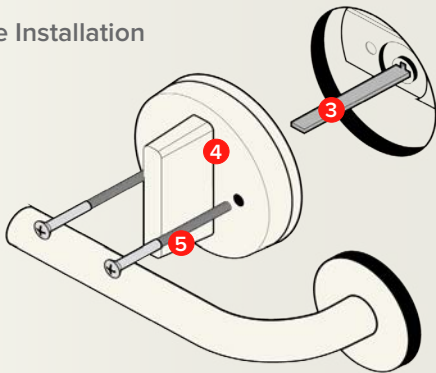

- 1 Key Hole
- 2 Deadbolt
- 3 Tail Piece
- 4 Thumb-latch
- 5 Screws

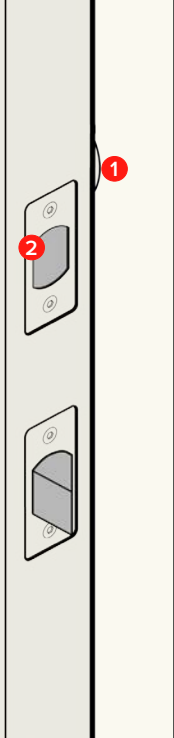



## After Installation

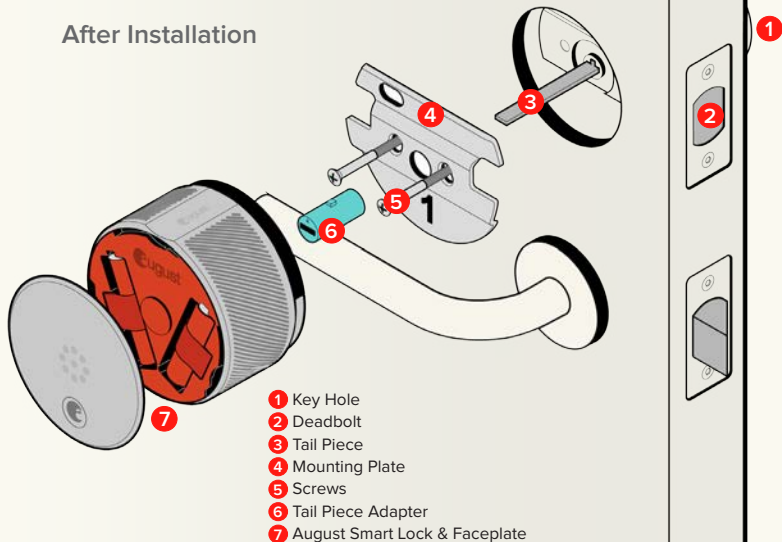

## Step 1: Prepare existing deadbolt.

Affix the supplied adhesive strip over the key hole, securing it to the exterior side of your door. This should hold the keyhole in place when you remove the thumb-latch on the inside of the door.

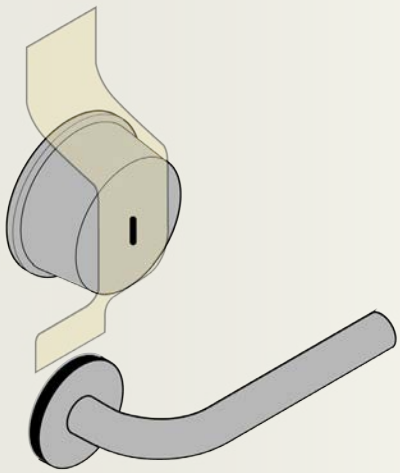
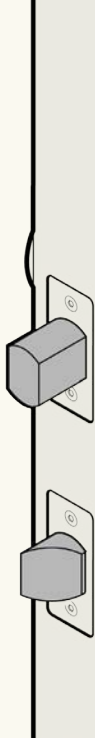

## Step 2: Remove your existing thumb-latch.

**A** Position your thumb-latch so that you can unscrew the existing screws on your deadbolt.

Remove the screws entirely from the deadbolt and keep them to assist in the next step.

**B** Your thumb-latch may include an additional back plate underneath it. If so, remove the back plate. Use the back plate and the longer screws for the next step.

A

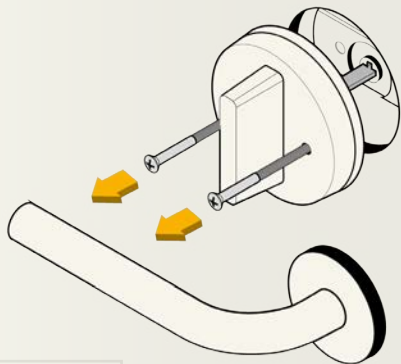

B

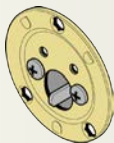









## Step 3: Select the correct mounting plate.

If you know the brand of your deadbolt, please select the correct mounting plate and adapter from the Compatibility Chart and go to Step 4 (page 18).

If not, go to Step 3a (page 16) to find the correct mounting plate and adapter.

# Standard Deadbolt Compatibility Chart

BRAND	MOUNTING PLATE	ADAPTER
Baldwin - Estate/Images*	1	
Baldwin Reserve/Prestige	3	
Defiant	2	
Emtek	3	
Kwikset*	3	
Omnia**	1	
Schlage***	2	
Weiser	2	
Weslock	1	

\* Baldwin and Kwikset Deadbolts installed before 1997 have unique installation requirements, please contact us at 844-AUGUST1 (284-8781) and we will walk you through installation. \*\* Compatible only with non-mortise, standard Omnia deadbolts. \*\*\* Commercial grade Schlage B560 deadbolts require supplemental screws. If your Schlage screws are too short please contact us at [support@august.com](mailto:support@august.com)

## Step 3a: Select the correct mounting plate.

- A** Insert the existing screws in the thumb-latch to help you choose the correct mounting plate. If there was a back plate under your thumb-latch, insert the screws into this back plate instead of the thumb-latch.
- B** Slide the mounting plates onto the screws one at a time until you find a mounting plate that allows the screws to fit straight through the holes.

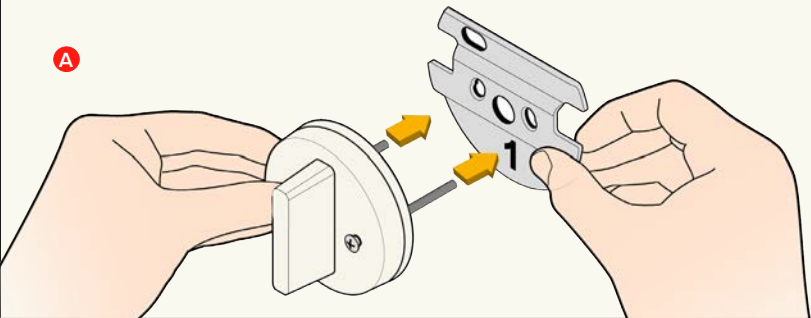

**A****B**

1.

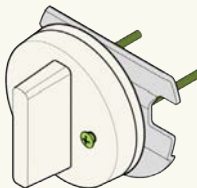
**COMPATIBLE**

2.

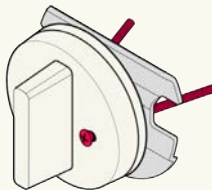
**NOT COMPATIBLE**

Having trouble selecting the right mounting plate? Try [august.com/installation](http://august.com/installation) or call August customer support at 844-AUGUST1 (284-8781)

## Step 4: Position the mounting plate.

- A** Remove the screws from the thumb-latch and use them to install the mounting plate over the existing deadbolt tail piece.
- B** Do not fully tighten the screws.

**A**

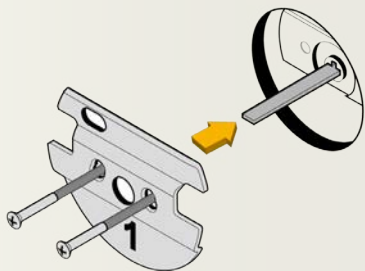

**B**

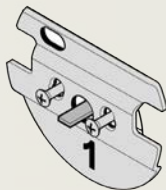

## Step 5: Position adapter and align mounting plate.

- A** Remove the tape from the key hole, and use your key to turn your deadbolt to the fully **unlocked position**.
  
- B** If your lock was not in the Compatibility Chart, select the adapter that matches your tail piece. To do this, slide each adapter onto the tail piece. The correct adapter will have the small nub pointing up.
  
- C** Place the correct adapter onto the tail piece with the small nub pointing up, and tighten the two screws. **(Do not over-tighten.)**

Having trouble selecting the right adapter? Call August customer support at 844-AUGUST1 (284-8781)

**A****B**

Front View

Deadbolt Tail Piece

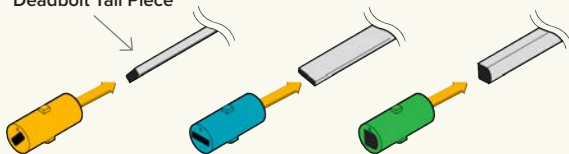

Adapter Alignment

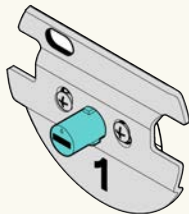
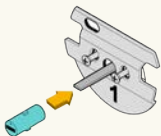
**C**

## Step 6:

# Attach the August Smart Lock.

Position the August Smart Lock with the curved notch at the top.

**A** Pull out both side wing latches. Slide August Smart Lock over adapter and tail piece and attach to mounting plate. **Make sure the back of the lock is flush with the door.**

**B** To secure the August Smart Lock, clamp down both side wing latches to the mounting plate completely and remove the clear tape from the curved notch.

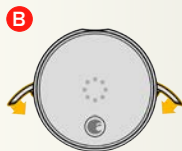
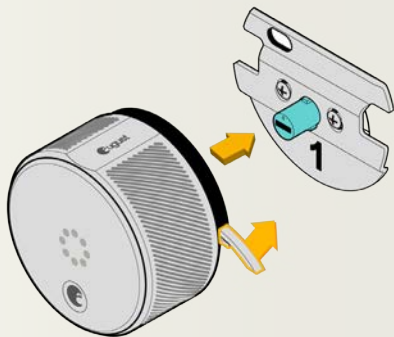
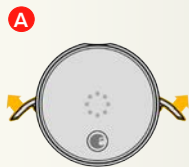

## Step 7:

# Remove battery tabs.

- A** Press down on the face plate and rotate it **counterclockwise** to open the battery compartment.
  
- B** Remove the two plastic tabs from the battery contacts. Make sure batteries are properly seated in the battery compartment.
  
- C** Align faceplate hooks with the August Smart Lock. The faceplate will lock into place with the logo at the bottom.



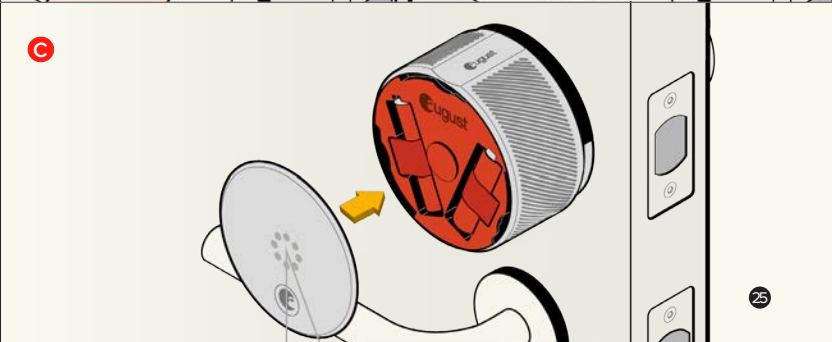
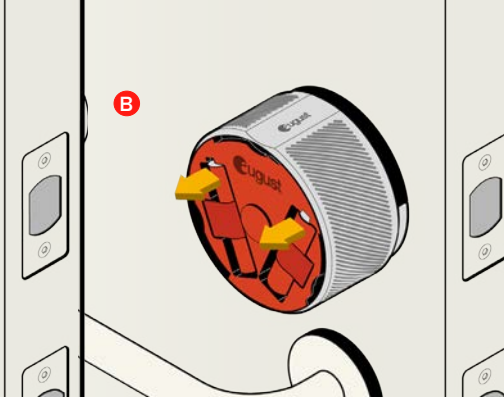

## Step 8: Install August App

Download the app from [august.com/app](https://august.com/app)

The App will then bring you through the necessary profiling and calibration processes.

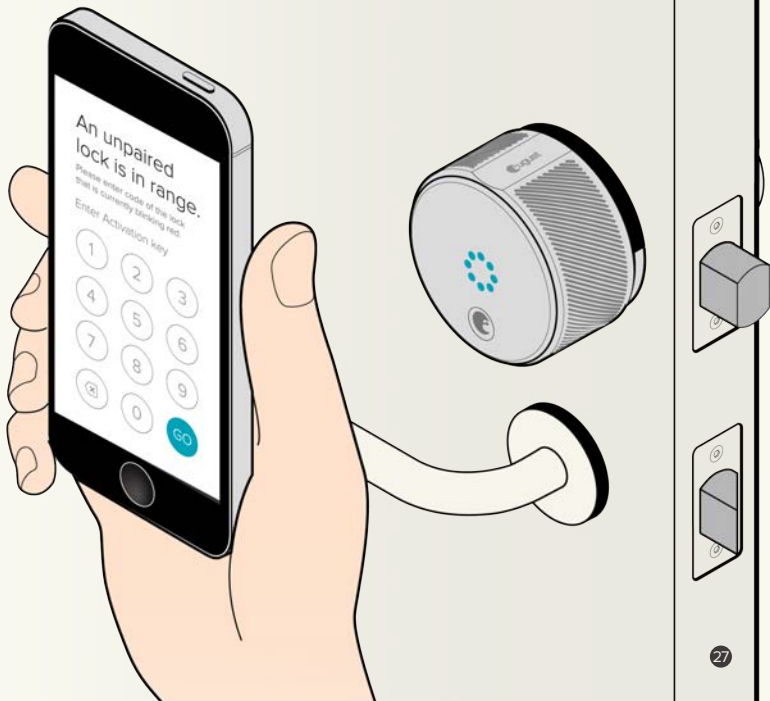

# Questions?

If you have any questions or difficulty, visit [august.com/support](http://august.com/support), call **844-AUGUST1 284-8781** or email questions to **[support@august.com](mailto:support@august.com)**

1006-0000-A Rev5  
©2014 August Home Inc.

# Terms and Conditons



# Limited Warranty Statement

- 1. One (1) year Limited Hardware Warranty.** Subject to the additional terms and conditions set forth below, August provides the following Limited Warranty:
  - Only to the person or entity that originally purchased the Device from August or from one of its authorized resellers or distributors; and
  - Only for Devices purchased and delivered to the end user within the United States, Canada, or Mexico.
- 2. Limited Warranty.** August warrants the Device against defects in materials and workmanship under normal use for a period of one (1) year from the date of purchase ("Warranty Period"). If a Device is returned to August during the Warranty Period as provided below, and August determines that the Device is defective, August will either repair or replace the unit with either a new or a refurbished August Smart Lock, or refund the original purchase price in return for the Device, at its option. If the Warranty Period has expired or is otherwise not applicable as per the Scope and Limitation on Warranty, we will return the Device to you. More information about this warranty can be found at [www.august.com/support](http://www.august.com/support).
- 3. Return and Warrant Service Process.** Please review the online help resources at [www.august.com/support](http://www.august.com/support) prior to seeking warranty service. To obtain warranty service, you must first obtain a Return Merchandise Authorization (RMA) number from a Customer Support Representative (CSR) at August. Customer Support contact information can be found by visiting [www.august.com/support](http://www.august.com/support). August may attempt to troubleshoot a warranty-related problem prior to issuing a RMA number. August may ask for additional information upon request. Issued RMA numbers remain valid for thirty days from issuance. Once an RMA number is obtained, your Device must be shipped freight prepaid; together with proof of purchase and all accessories, either its original packaging or packaging affording an equal degree of protection, to the August authorized distribution facility identified by the CSR. Failure to return any of the accessories may result in a delay and/or result in a credit to August or an invoice for the missing accessories.

In performing warranty service, August may furnish replacement parts on an exchange basis and replaced parts will become the property of August. Replacement parts provided by August shall be new or refurbished and of comparable quality, and may be a different part that contains compatible features and functions. You will reimburse August for the inspection, testing and repair of returned equipment determined by August not to be defective or which falls under one of the warranty exclusions described below (as well as pay all shipping and handling charges). In all cases, August's determination as to whether or not the equipment is defective and covered by warranty will be final. Any replacement equipment will be warranted hereunder for a period of one (1) year from shipment.
- 4. Scope of and Limitation of Warranty.** The warranty on this Device is limited to the repair or replacement of defective units as described in the Limited Warranty section above. This warranty does not cover customer training and education, installation, set up adjustment, signal or reception problems. This warranty does not cover damage due to acts of God, accident, misuse, abuse, negligence, commercial use or modification of, or to any part of your Device or caused by any third party product, service or system, use for purposes other than for which the Device was designed or intended, use in improper temperature, humidity or other environmental conditions, or use of the Device in violation of written instructions provided by August (which may be provided at the time of purchase or on its website at [www.august.com/support](http://www.august.com/support)). This warranty does not cover damage due to improper operation or maintenance, connections to improper voltage supply or attempted repair by anyone other than a facility authorized by August to service your Device. This warranty does not cover consumables (such as batteries). This warranty gives you specific legal rights, and you may have additional legal rights as required under local laws.

## REGULATORY COMPLIANCE INFORMATION

The August Smart Lock (ASL-01) is subject to the Federal Communications Commission (FCC) and Industry Canada (IC) rules.

### **NOTICE:**

Changes or modifications not expressly approved by the party responsible for compliance could void the user's authority to operate the equipment.

*This device complies with Part 15 of the FCC Rules and with RSS-210 of Industry Canada.*

*Operation is subject to the following two conditions:*

- (1) this device may not cause harmful interference, and*
- (2) this device must accept any interference received, including interference that may cause undesired operation.*

*Les changements ou modifications non expressément approuvés par la partie responsable de la conformité pourraient annuler l'autorité de l'utilisateur à utiliser l'équipement.*

*Le présent appareil est conforme aux CNR d'Industrie Canada applicables aux appareils radio exempts de licence. L'exploitation est autorisée aux deux conditions suivantes :*

- (1) l'appareil ne doit pas produire de brouillage, et*
- (2) l'utilisateur de l'appareil doit accepter tout brouillage radioélectrique subi, même si le brouillage est susceptible d'en compromettre le onctionnement.*



The serial number and regulatory codes are located on the back of the ASL-01.

## Specifications

Model Name:	August ASL-01
Description:	BLE Automatic Smart Lock
Model Number:	ASL-01
Standards:	Bluetooth Specification v4.0 (BLE), 2.4GHz ISM band (2402MHz to 2480MHz),
Channels:	40 x 2.0MHz channels
Data rate & Modulation:	1Mbps, GFSK, 250 kHz deviation.
Interface:	Bluetooth Low Energy (BLE)
LED:	Lock/Unlock
Speaker:	Output, 1Watt Max.
Antenna:	Internal Single-band (Internal IFA)
Transmitted Power:	0dBm Max.
Receive Sensitivity:	-84dBm Typical
Antenna Gain in dBi:	3dBi Typical
Power Consumption:	TX: BLE: 30mA Max. RX: BLE: 500uA Max. Motor Operation: 500mA Max.
Battery Type:	4 AA alkaline batteries.
Battery Life:	10 to 12 months *typical
Operational Voltage:	+7.0V Maximum Voltage. +6.0V Nominal Voltage. +4.0V Minimum Voltage.

## Environmental

Dimensions:	3.39" dia. x 2.24" height (86mm dia. x 57mm height)
Weight:	14.0 oz. (400 g)
Certification:	FCC, IC
Operating Temp.:	+32°F to +131°F (0°C to 55°C)
Storage Temp.:	-4°F to +140°F (-40°C to 60°C)
Operating Humidity:	10% to 85% Noncondensing
Storage Humidity:	5% to 90% Noncondensing
Model Name:	August ASL-01
Description:	Automatic Smart Door Lock

\*Depending on quality of batteries and lock usage.