



R/C RPMz

85812200201

INSTRUCTIONS For RPMz Remote Control Racing System

CONTENTS

● Warnings	1 - 2
● Model Parts	3
● Preparation of Transmitter	3 - 4
● Vehicle Assembly	5
● Parts Exploded View Diagram	6 - 7
● Inspection Before/After Operation	8 - 9
● Modifying the Operation	10 - 11

Warnings

- *This item is engineered to be a precision hobby-class product. Please treat accordingly.*
- *Read the instruction manual carefully before using or modifying the vehicle. If you are unsure, ask someone knowledgeable in R/C operation, or call our Consumer Service Department for assistance.*
- *This product contains small parts. Be careful to keep away from small children.*
- *Please use only alkaline or rechargeable batteries with this product. Use of other batteries may cause the product to perform poorly or damage the product.*
- *Please dispose of batteries properly in accordance with environmental protection laws.*

This device complies with part 15 of the FCC Rules. Operation is subject to the following two conditions: (1) This device may not cause harmful interference, and (2) this device must accept any interference received, including interference that may cause undesired operation. Changes of modifications not expressly approved by the party responsible for compliance could void the user's authority to operate the equipment.

**If you have any questions or comments, call our hotline at: (800) 833-3570
or, please write to:**

Revell-Monogram Consumer Service Department, 725 Landwehr Road, Northbrook, Illinois 60062
Be sure to include the plan number (85812200201), part number, description, your return address and phone number.
Visit our website: www.revell.com

REVELL-MONOGRAM, LLC Northbrook, IL, Copyright © 2007, All rights reserved.

Warnings



Please read all instructions carefully before operating or modifying the vehicle. Consult with an experienced R/C operator if you have questions.



This product contains many small parts. Be careful to keep away from children who could swallow or choke on them.



Be careful when using knives, screwdrivers, and similar tools when working on the vehicle to avoid injuring yourself.



If you choose to paint the car body, be sure to do so in a safe area with proper ventilation.

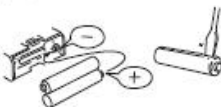

Be careful not to insert the positive and negative poles of the battery in the wrong direction as this could damage the vehicle or transmitter.



Be sure to check the frequency when operating vehicle within range of another RPMz. Change frequency crystals to avoid radio interference.



Be careful not to point the transmitter antenna towards someone's face.



Do not operate the vehicle in the street to avoid accidents.



Be sure to turn off the power to the vehicle and transmitter when not in use to avoid draining the batteries. Remove batteries when storing product for an extended period of time.



Don't store the model in direct sunlight or high temperature areas.

Don't operate the vehicle in water, high pile carpets, or coarse sandy areas as this may affect operation or damage the vehicle.



Parts

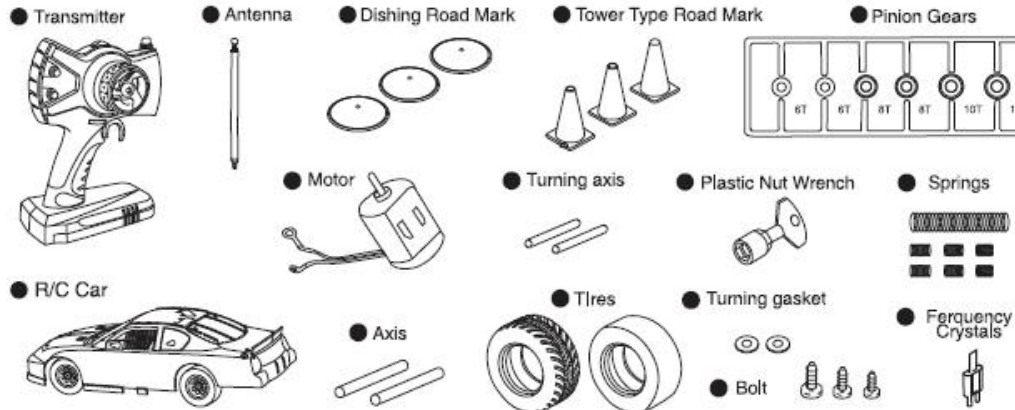

Battery

For best performance alkaline or 1300 ma Ni-cad rechargeable batteries are recommended. The Car requires 4 AA batteries and the Transmitter requires 8 AA batteries. Under normal operating conditions the Car will run for 30 minutes on a charge and the Transmitter 4 hours.

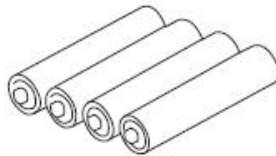

CAUTION A battery with damaged cover cannot be used for the Car and Transmitter



Transmitter Operation

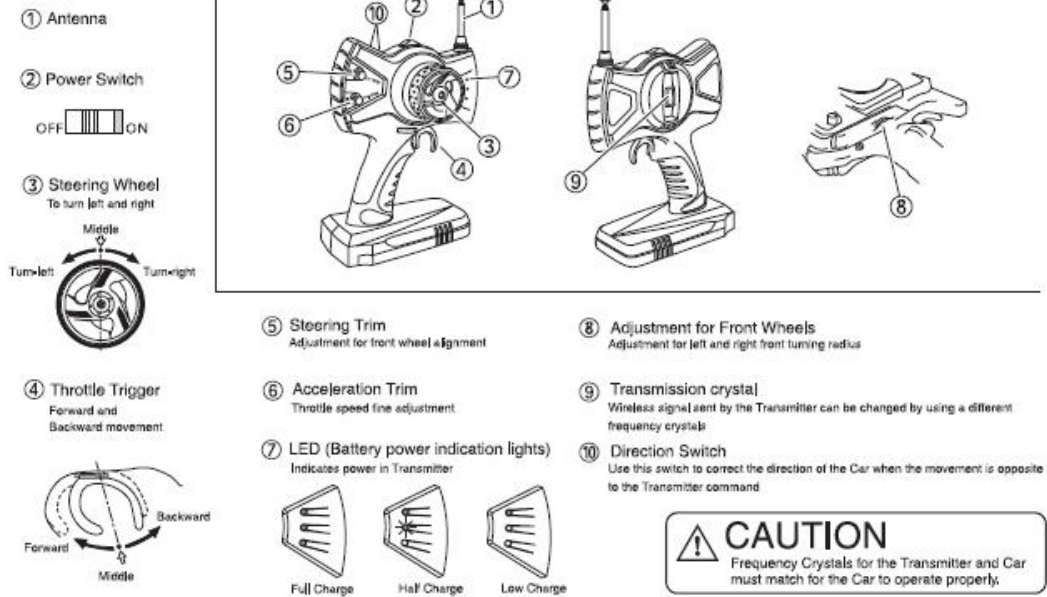

Installation of Transmitter Batteries

- ① Open the battery lid by pressing down on the arrow and sliding lid

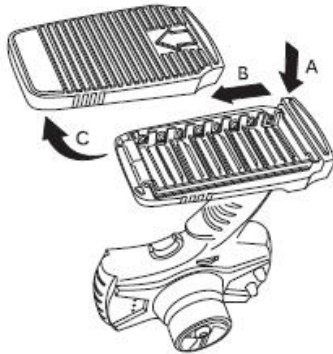

- ② Install 8 AA batteries as shown

CAUTION

Please notice the battery symbol is in the battery holder, if the positive and negative poles of battery are installed incorrectly, it may damage the transmitter



- ③ When the battery lid is closed properly you will hear a distinct "Click"

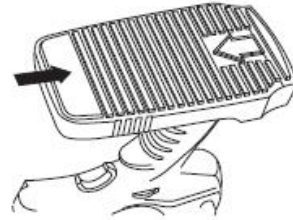

Installation of Antenna

- ① Remove the antenna from the foam packing
- ② Insert into the hole on top of the transmitter and rotate in the direction shown
- ③ Do not over-tighten

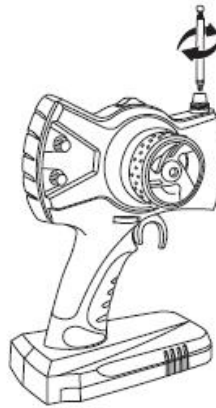

Remove Car from Platform

To remove Car squeeze tabs located on the bottom of the platform

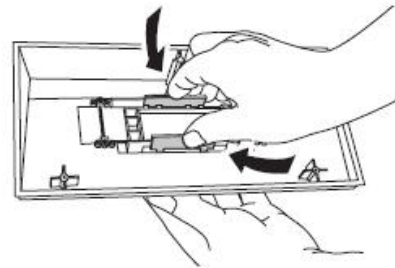
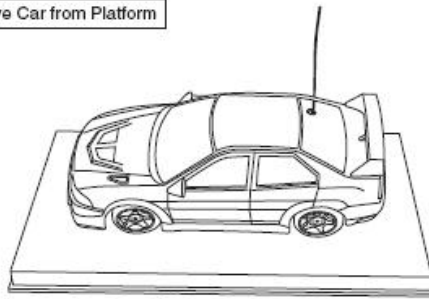

Car Assembly

1 Battery Installation

⚠ CAUTION

If the positive and negative poles of batteries are installed incorrectly, the car may be damaged.

ON OFF
Be sure car is turned off when installing batteries

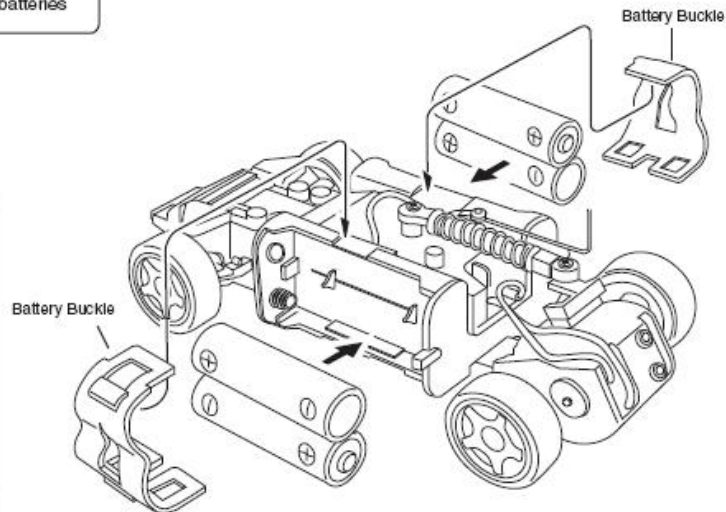
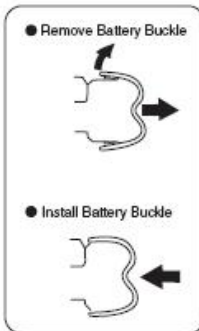

2 Body Installation

② Insert the tab on the chassis into the slot on the body.

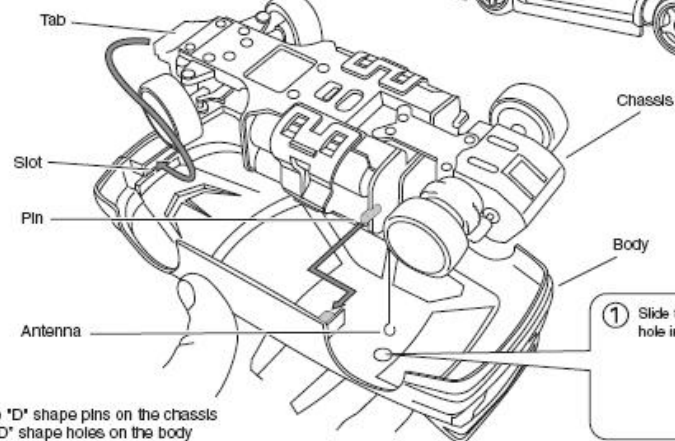

③ Insert the 'D' shape pins on the chassis into the 'D' shape holes on the body

① Slide the antenna through the round hole in the body



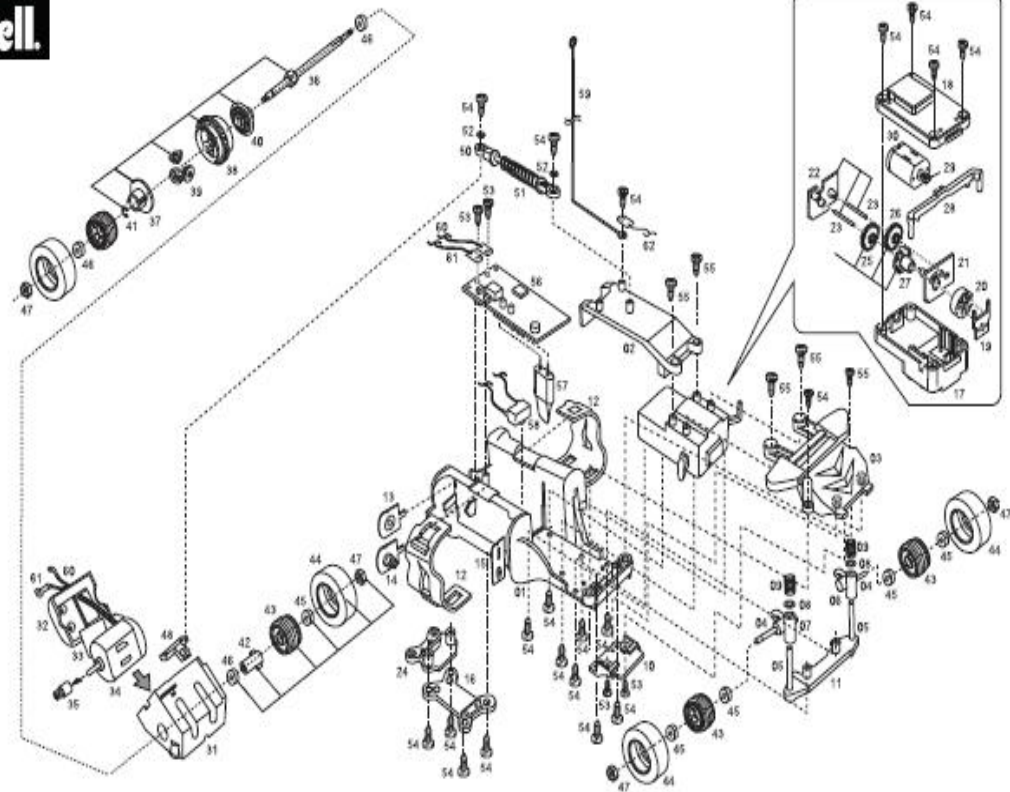

- | | | | | | | | | |
|------------------------|---------------------------------|------------------------------|--------------------------------|---------------------|-------------------------------|---------------------------|------------------------------------|---------------------------------------|
| 01. Car Bottom | 08. Steering Washer | 15. Connection Battery Place | 32. Gear Straker I | 38. Helm Motor Gear | 39. Rear Shell | 42. Car Wheel | 60. Shock Absorber Rod | 67. Crystal |
| 02. PCB Plate Cover | 09. Front Shock Absorber Spring | 16. "Y" Plate | 33. Helm Drive Shell I | 39. Helm Motor | 37. Differential Side Gear I | 43. Tube Cover | 61. Rear Shock Absorber Spring | 68. Switch |
| 03. Front Cover | 10. Front Clip Board | 17. Helm Cover | 34. Extension Place | 40. Motor Base | 38. Dull Gear | 44. Sealing I | 62. "Y" Shape Rubber Sealing Strip | 69. Packaging Antenna |
| 04. Front Shell | 11. Front Axis | 18. Helm Bottom Plate | 35. Duplex Gear I | 41. Motor Cover | 39. Epicyclic Gear | 45. Sealing II | 63. Bolt (ST2 x 6) | 70. Positive Motor Power Wire (Red) |
| 05. Steering Axis | 12. Sealing Guide | 19. Resistor Position Place | 36. Duplex Gear II | 42. Adjusting Patch | 40. Differential Side Gear II | 46. Flange Nut | 64. Bolt (ST2 x 6) | 71. Negative Motor Power Wire (Black) |
| 06. Left Steering Cup | 13. Positive Battery Place | 20. Resistor | 37. Helm Oscillating Side Gear | 43. Drive Motor | 41. Spline Ring | 48. Shock Absorber Ram | 65. Bolt (ST2 x 6) | 72. Antenna Lead Wire |
| 07. Right Steering Cup | 14. Negative Battery Place | 21. Gear Straker I | 38. Steering Connecting Rod | 44. Motor Gear | 42. Rear Wheel Gear | 49. Shock Absorber Damper | 66. PCB Plate | |

Inspection before Operation

Before operation, check the Transmitter and Car carefully in the following order

CAUTION The antenna must be screwed tightly in place, or the Car will lose control.

1 Transmitter (ON)

Pull up the antenna

► Move the power switch to the "ON" position

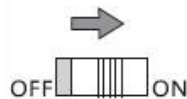

2 Car (ON)

► Move the power switch to the "ON" position

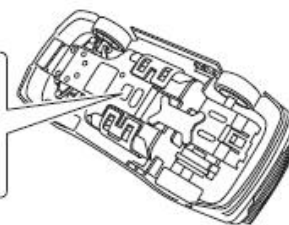

3 Throttle Fine Adjustment

To adjust Rear Wheel movement after switching the Car "ON"

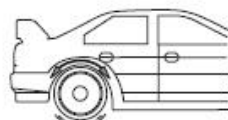
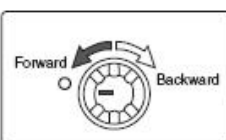

► Rotate the fine adjustment knob of throttle manually, to stop the rear wheels of model car without "chirp" sound.

4 Direction Fine Adjustment

To adjust Front Wheel alignment after switching the Car "ON"

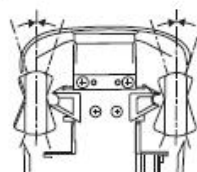
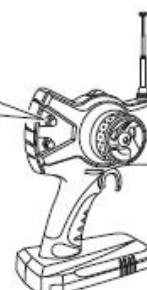
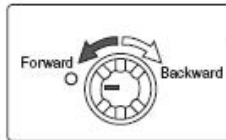

► Pull the trigger slightly by hand, to make the model drive slowly, meanwhile adjust the direction fine adjustment knob to make the model drive straight.

5 Steering Wheel Inspection

When Steering Wheel the Transmitter is turned left or right the Front Wheels on the Car should be the same as shown

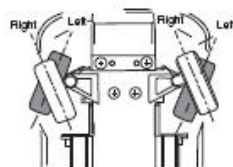
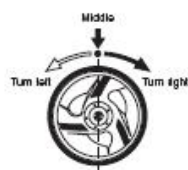

6 Throttle Trigger Inspection

- To move the Car forward pull the Trigger
- To move the Car backward push the Trigger
- Car should remain stationary with trigger in middle position

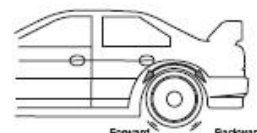
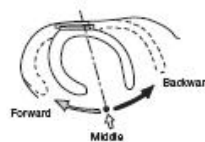

7 Turning Radius Inspection

- Slowly pull the Throttle Trigger to move the Car forward
- Rotate the Steering Wheel to the end position of either left or right
- Rotate this knob to adjust the turning radius

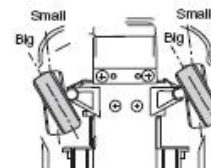
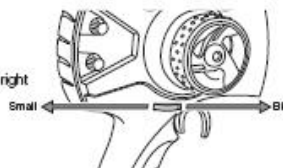

Inspection after Operation

1 Car (OFF)

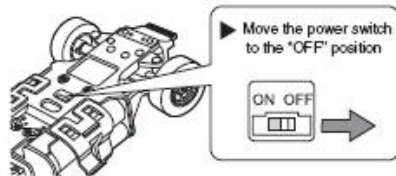

2 Transmitter (OFF)

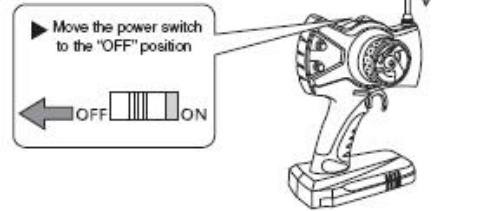

3 Battery

- Remove the batteries from both sides

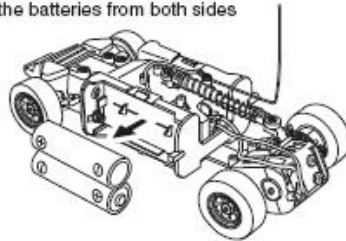

4 Chassis

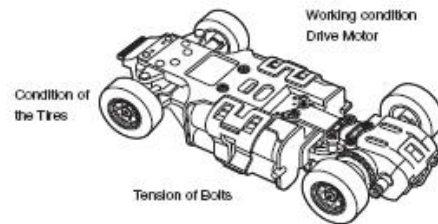

5 Cleaning

- Wipe with soft cloth



CAUTION

- Turn off the Car and transmitter power switches
- Remove the batteries and keep out of reach of children

Exchanging Frequency Crystals

** You must turn off the power to the Car and Transmitter Before exchanging crystals in the following order **

When there are several Cars operating in the same field, the frequency must be different for each Car. Transmitter and Car Crystals are not interchangeable.

Transmitter Transmission Crystal

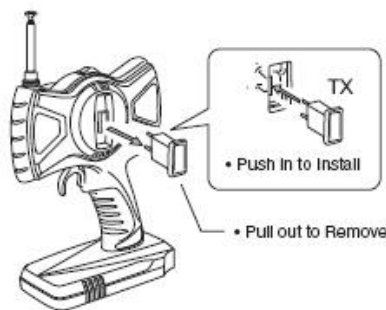

Car Receiving Crystal

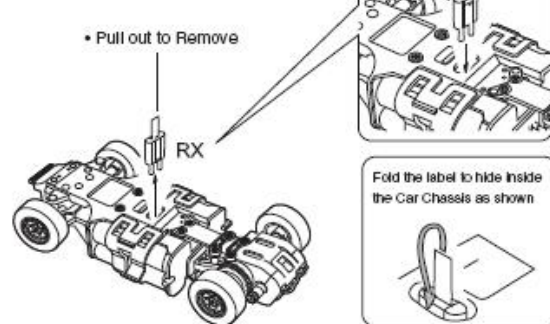

Motor Housing

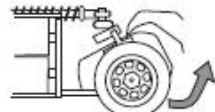

To Remove press the Motor Cover in the direction of arrow

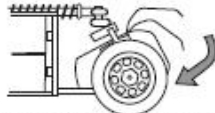

To Install press the Motor Cover in the direction of arrow

Pinion Gear

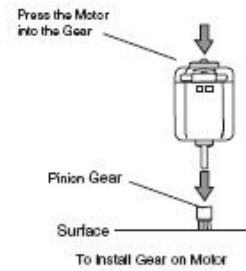
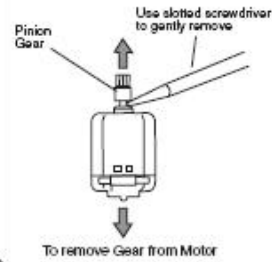

Drive Motor Assembly

► Note direction of ribs on patch

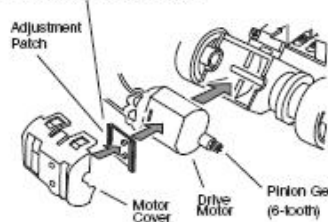

► Note direction of ribs on patch

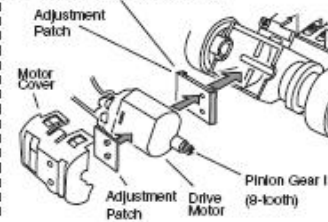

► Note direction of ribs on patch

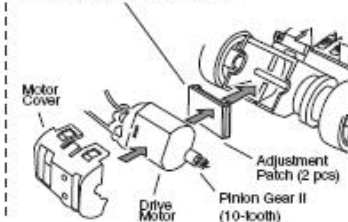

Speed and Acceleration Performance Adjustment

- The kit comes equipped with three different performance Pinion Gears.
- An 8-tooth gear has already been installed on the Drive Motor.
- To change the operating characteristics you can change gears according to the chart.

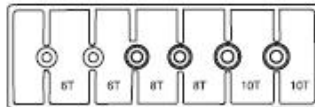

◀ Pinion Gears

Pinion Gear Teeth	Gear Ratio	Max Speed	Acceleration Performance	Operation Time
6T	7.1 : 1	Low-speed	Faster	Long
8T	5.3 : 1			
10T	4.3 : 1	High-speed	Slower	Short

Changing Wheels and Tires

- The kit comes with a choice of two different style Tires
- Slicks provide faster speed in straight-away sections.
- Treaded Tires provide better grip in corners.

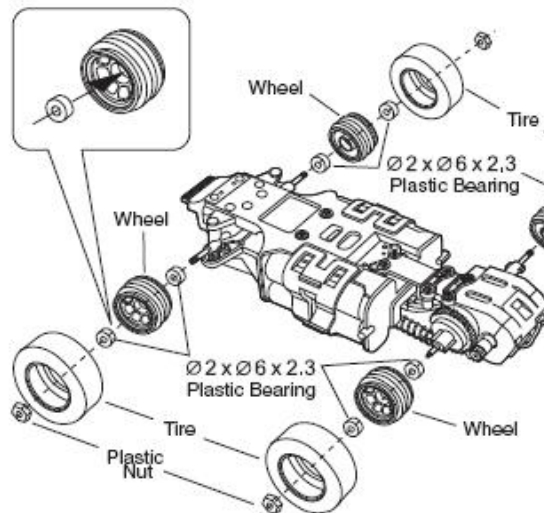

Install the Tire as shown

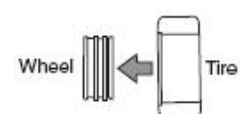

A small dab of glue in 2-3 spots helps secure tire to the Wheel

Plastic Nut Assembly

- Carefully thread Plastic Nut onto Axle. Note position of base on Plastic Nut
- Do not screw the Plastic Nut too tight, or it will be damaged.

Assembly of Front Axle

- ST 2 x 5 Bolt
----- 2 pcs
- ST 2 x 6 Bolt
----- 2 pcs
- ST 2 x 8 Bolt
----- 6 pcs

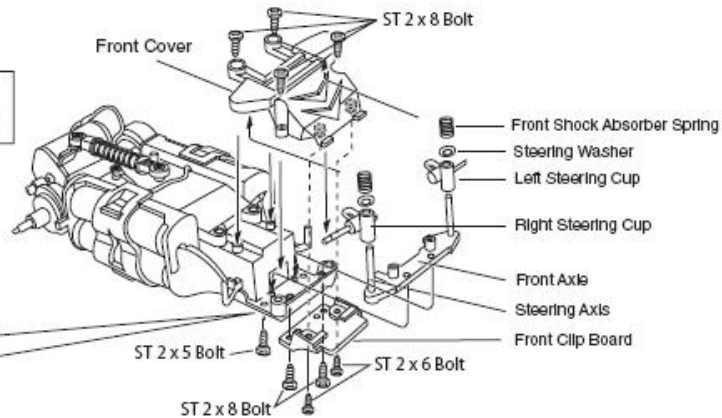
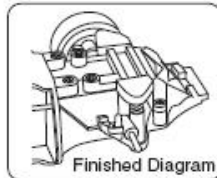

Drive Motor Assembly

- ST 2 x 5 Bolt
----- 6 pcs
- ST 2 x 6 Bolt
----- 2 pcs

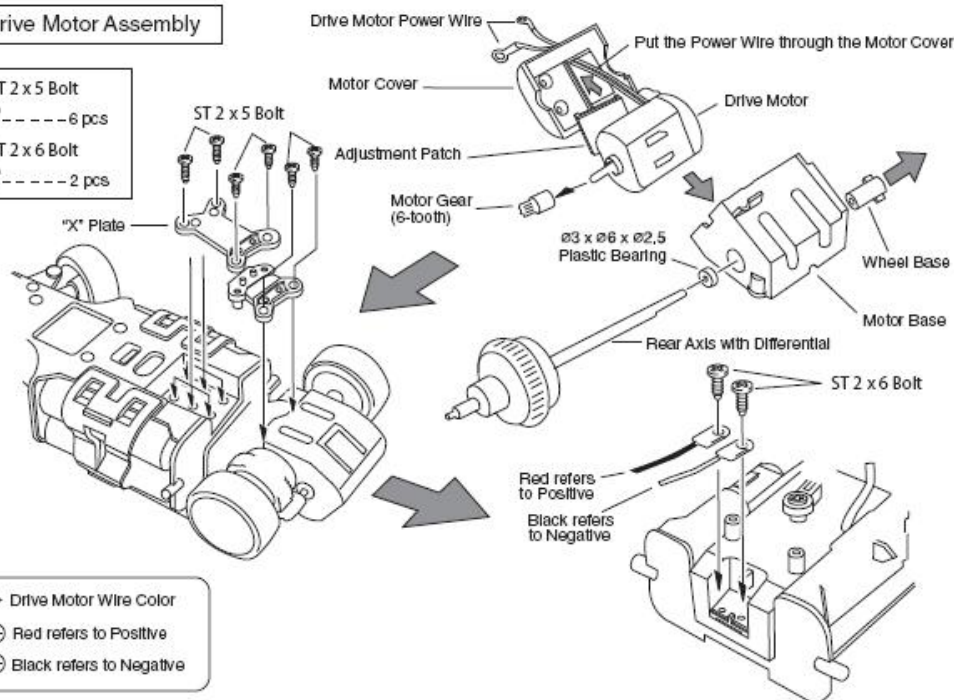

Differential Assembly

- ø2 Baffle Ring
----- 1 pcs

