

User Manual

Wireless Hands Free Car Kit

CK11



FCC ID: 2AITF-BTCK-11
Model No.: BTCK-11
www.avantree.com

Any questions? Contact:

Support@avantree.com
(Response Time: 1 working day)

Self-service Support:

- More FAQs on support.avantree.com
- 100+ Step by step video Guide – youtube.com/avantree/playlists

Telephone Support (Mon-Fri):

- USA / CANADA +1 800 232 2078 (EN, PST 9am-5pm)
- EU / Asia telephone No. refer to <http://www.avantree.com/contact-us>

Content

1. Product overview	1
2. What's in the box	2
3. Basic operations	3
4. "Auto Power On" function	4
5. Pairing and connecting	5
6. Multi-point: Pairing and connecting 2 phones simultaneously	7
7. Clear pairing history	8
8. How to charge	8
9. Product specifications	9

1. Product overview

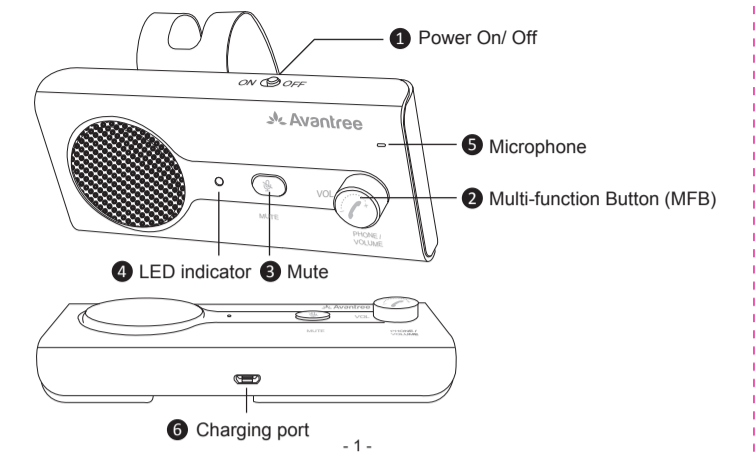

2. What's in the box?

- A. Avantree Bluetooth car kit
- B. Car charger
- C. USB charging cable
- D. Sun-visor clip
- E. Quick user guide / User Manual

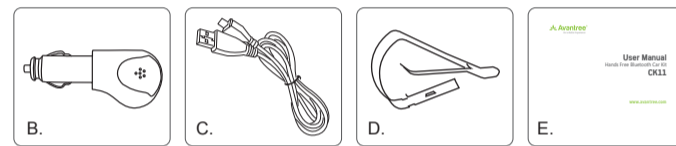
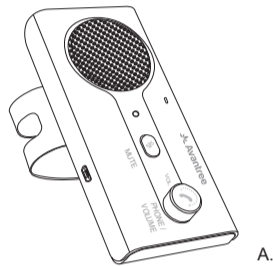

- 2 -

3. Basic operations

Component	Function	Operation
Power Switch	Power On/Off	Slide to ON/OFF
MFB	Pairing mode	Press and hold for 3 second until the LED flashes Blue and Red alternately
	Manually re-connect	Press once
	Answer/End a call	Press once
	Reject a call	Press and hold for 1 second
	Redial	Double click
	Voice control (phone feature)	Press once while CK11 connected to your phone
	Volume Up/down	Rotate the MFB to adjust the volume

- 3 -

4. "Auto Power On/Off" function

When the power switch is set to "ON", the "Auto Power On" function is activated. The device will turn on automatically the next time you open your car door. "Auto Power off" - when you leave your car and your phone disconnects from the CK-11, it will automatically turn off after about 10 minutes. The device can be turned off and the "Auto Power On/Off" function disabled by sliding the power switch to "OFF".

- 4 -

5. Pairing and connecting

- Step 1** Power on CK11 by setting the toggle switch to ON.
- Step 2** Press and hold the MFB for 3 seconds to enter pairing mode (Note: On first use the CK11 will automatically enter pairing mode).
- Step 3** Turn on Bluetooth on your phone - search for new devices.
- Step 4** Select "Avantree CK11".

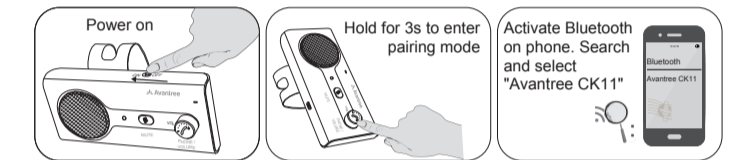

Note: Once paired and connected, the next time they will automatically reconnect.

- 5 -

6. Multi-point: Pairing and connecting 2 phones simultaneously

- Step 1** Connect the first phone (instructions above).
- Step 2** Press and hold the MFB for 3 seconds to enter pairing mode.
- Step 3** Turn on Bluetooth on the second phone and connect with the CK11.
- Step 4** Reboot the CK11 by turning it off then on again. Both phones will now be connected to the CK11.

- 6 -

7. Clear pairing history

You may need to reset the CK11 if it is not working as expected. When reset to its factory default settings, all the paired device information will be erased.

- Step 1** Set the CK11 to PAIRING MODE – press and hold the MFB for 3 second until the LED flashes BLUE and RED alternately.
- Step 2** Double click the mute button – you will hear 2 beeps indicating a successful reset. Then it will automatically enter pairing mode.

8. How to charge

When the battery runs low, the LED will flash every 6 seconds. Recharge the CK11 by plugging it into the supplied car charger, USB charger or PC USB port. It normally takes 3 hrs to fully charge the battery. The LED will turn red when charging and turn off when charging is completed. Charging requirements: DC5.0V/ 500mA-1A.

- 7 -

9. Product specifications

- BT Version: 4.2
- Supported Profiles: A2DP, AVRCP, HSP, HFP
- Operation Frequency Band: 2.4GHz~2.48GHz unlicensed ISM band
- Operation Range: Class 2, Up to 30ft.
- Working Time: 22 hrs
- Standby Time: 600hrs
- Charging Time: about 3 hrs
- Charger Voltage: DC5.0V, 500mA
- Battery: 650mA, BL-5B, rechargeable lithium-ion battery

- 8 -

Declaration of Conformity

This device complies with the essential requirements and other relevant provisions of Radio Equipment Directive 2014/53/EU. This device complies with part 15 of the FCC Rules. Operation is subject to the condition that this device does not cause harmful interference (1) this device may not cause harmful interference, and (2) this device must accept any interference received, including interference that may cause undesired operation.

Changes or modifications not expressly approved by the party responsible for compliance could void the user's authority to operate the equipment.

NOTE: This equipment has been tested and found to comply with the limits for a Class B digital device, pursuant to Part 15 of the FCC Rules. These limits are designed to provide reasonable protection against harmful interference in a residential installation. This equipment generates, uses and can radiate radio

- 9 -

frequency energy and, if not installed and used in accordance with the instructions, may cause harmful interference to radio communications. However, there is no guarantee that interference will not occur in a particular installation. If this equipment does cause harmful interference to radio or television reception, which can be determined by turning the equipment off and on, the user is encouraged to try to correct the interference by one or more of the following measures:

- Reorient or relocate the receiving antenna.
- Increase the separation between the equipment and receiver.
- Connect the equipment into an outlet on a circuit different from that to which the receiver is connected.
- Consult the dealer or an experienced radio/TV technician for help.

- 10 -

This device complies with FCC RF radiation exposure limits set forth for an uncontrolled environment. This transmitter must not be co-located or operating in conjunction with any other antenna or transmitter

Dispose of the packaging and this product in accordance with latest country provisions.



- 11 -



- 12 -