



## Tablet Bluetooth Keyboard and Case for iPad

**Model Number: BW05003-3**

### **INSTRUCTION MANUAL**

#### **After Sales Support**

**Telephone:** 1 866 235 5029  
**Email:** [mp656@messageplex.com](mailto:mp656@messageplex.com)

# Contents

Welcome	3
General Safety Instructions	4
Parts List	5
Features	6
Getting Started	7
Instructions	8
Other Useful Information	10
Repair and Refurbished Goods or Parts Notice	12

# Welcome

Congratulations on choosing to buy a BAUHN® product.

All products brought to you by BAUHN® are manufactured to the highest standards of performance and safety and, as part of our philosophy of customer service and satisfaction, are backed by our comprehensive 2 Year Warranty. We hope you will enjoy using your purchase for many years to come.

## After Sales Support

**Telephone:** 1 866 235 5029  
**Email:** [mp656@messageplex.com](mailto:mp656@messageplex.com)

# General Safety Instructions

Read this manual thoroughly before first use, even if you are familiar with this type of product. Keep the manual in a safe place for future reference, along with the completed warranty card, purchase receipt and carton. If applicable, pass these instructions on to the next owner of the appliance.

- In order to prevent environmental factors (dampness, dust, food, liquid etc.) harming the Tablet Case and Bluetooth Keyboard (short: the product), only use it in a well ventilated, clean and dry environment, away from excessive heat or moisture.
- Keep the product away from direct sunlight or heat sources.
- Only charge the product via the supplied USB cable. Do not charge it any other way.
- In case of damage, do not disassemble, repair or modify the product yourself. Contact the after sales support line for advice on repair or replacement, or refer servicing to qualified personnel only.
- This product is not intended for use by persons (including children) with reduced physical, sensory or mental capabilities, or lack of experience and knowledge, unless they have been given supervision or instruction concerning use of the product by a person responsible for their safety.
- Children should be supervised to ensure they do not play with the product.
- Keep the product away from sharp objects.
- Do not put any object on top of the product.
- Do not expose the product to microwaves.
- Do not twist or distort the keyboard.
- Keep the product away from oils, chemicals or any other organic liquids.
- Use water or alcohol based disinfectants for cleaning the silicone keyboard.

This device complies with Part 15 of the FCC Rules. Operation is subject to the following two conditions: (1) This device may not cause harmful interference, and (2) This device must accept any interference received, including interference that may cause undesired operation

## **NOTE:**

This equipment has been tested and found to comply with the limits for a Class B digital device. These limits are designed to provide reasonable protection against harmful interference in a residential installation. This equipment generates, uses and can radiate radio frequency energy, and if not installed and used in accordance with the instructions, may cause harmful interference to radio or television reception, which can be determined by turning the equipment off and on. In case of interference, try to correct the interference by one of the following measures:

- Reorient or relocate the receiving antenna.
- Increase the separation between the equipment and receiver.
- Connect the equipment into an outlet on a circuit different from that to which the receiver is connected.
- Consult an experienced radio/TV technician, or contact our after sales support line for help.

Modifications not expressly approved by the manufacturer could void the user's authority to operate the equipment under FCC rules.

# Parts List

- 1 Holding frame for tablet
- 2 USB Charging cable
- 3 Keyboard
- 4 Bluetooth indicator light
- 5 Bluetooth connect button
- 6 Power indicator light
- 7 Power on/off switch
- 8 Charging interface

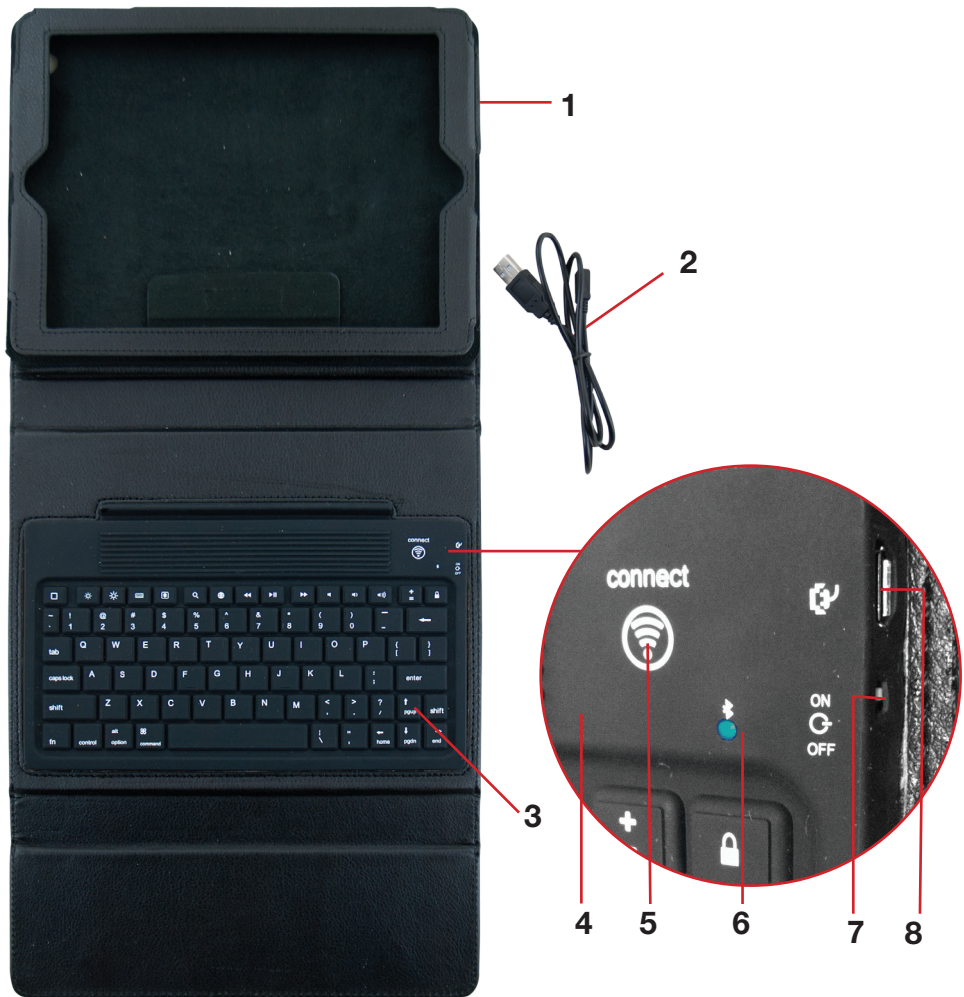

# Features

## Compatibility

The Bluetooth Keyboard can be connected to iPad 2, 3, 4 iPhone 3G, 3GS, 4, 4S, 5 and iPod Touch, iOS4.0 or later, Mobile Internet Devices (MID), Smartphones, PCs and other bluetooth enabled devices. For other bluetooth enabled devices, please verify the bluetooth standard and compatibility before attempting to connect to the keyboard.

**NOTE:** Depending on the operating system and version of the connected device, some function keys may not work.

## Features

- \* Bluetooth 3.0 interface with BROADCOM 20730 as main control chip
- \* WIDCOMM BTW Bluetooth technology, officially approved by Microsoft
- \* Stylish protective PU leather case with tablet display stand for easy viewing
- \* Lightweight, quiet keystroke design, dust-proof and spill-proof
- \* Energy saving keyboard with sleep mode

# Getting Started

## Before first use

- Unpack the product but keep all packaging materials until you have made sure your new Tablet Bluetooth Keyboard and case is undamaged and in good working order. Plastic wrapping can be a suffocation hazard for babies and young children, so ensure all packaging materials are out of their reach.
- Inspect the USB cable for damage. Do not use the product if the product or the USB cable have been damaged or are not working properly.

## Charging

Before first use, the Bluetooth Keyboard needs to be charged. During use, a flashing 'power' light indicates that the battery power is low and the device needs recharging. To charge/recharge the device:

**Step 1:** Connect the USB cable's micro connection to the keyboard charging interface.

**Step 2:** Connect the USB cable's regular connection to the computer's USB interface.

**Step 3:** The green 'charge' indicator light will stay on when the keyboard is charging. Once fully charged, the green indicator light will turn off.

**Step 4:** After you have finished charging, disconnect the USB cable, taking care not to damage the USB interface.

## Powering on/off

- Slide the Power On/Off switch to the 'On' position. The blue 'Bluetooth' and the red 'Power' indicators will illuminate for 4–5 seconds and then go off.
- After use, always turn off the power to extend the battery life. Slide the Power On/Off switch to the 'Off' position to power off.

## Storage

- If you intend not to use the Bluetooth Keyboard for an extended time, make sure it is fully charged before storing it away. Storing it with a depleted battery will shorten the lifespan of the keyboard's internal lithium battery.

# Instructions

## Pairing the Bluetooth Keyboard with an iPad

The following instructions are for pairing the product with an iPad.

**Step 1:** Slide the Power On/Off switch to the 'On' position. The blue 'Bluetooth' and the red 'Power' indicators will illuminate for 4–5 seconds and then go off.

**Step 2:** Press the 'Connect' button, the red 'Power' light will be on and the blue 'Bluetooth' light will start blinking. The Bluetooth Keyboard is now ready for connection to your iPad.



**Step 3:** Turn on and unlock the iPad. In menu mode, press Settings --> General --> Bluetooth --> Devices --> Bluetooth keyboard found. Click on the device to pair with it.



Select the Settings icon.

Open the Bluetooth setting.



# Instructions (Cont.)

**Step 4:** Enter the password code displayed on the screen, then press the Enter key.

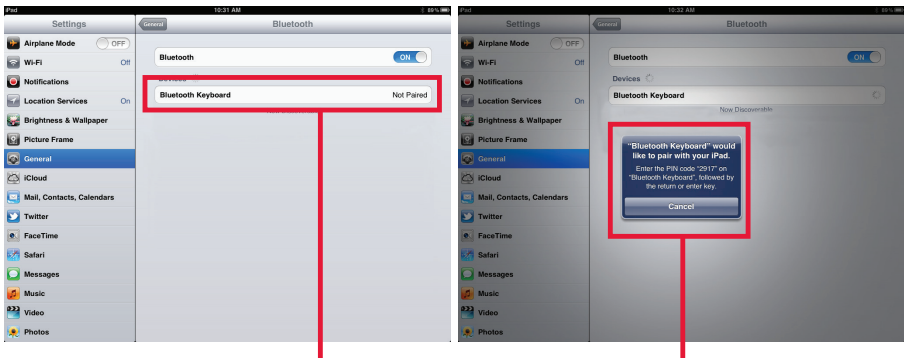

The Bluetooth Keyboard will show up as Bluetooth Keyboard "Not Paired". Select.

You will now be prompted to enter a PIN using your keyboard.

**Step 5:** Upon successful connection, the Bluetooth Keyboard will be listed as "Connected".

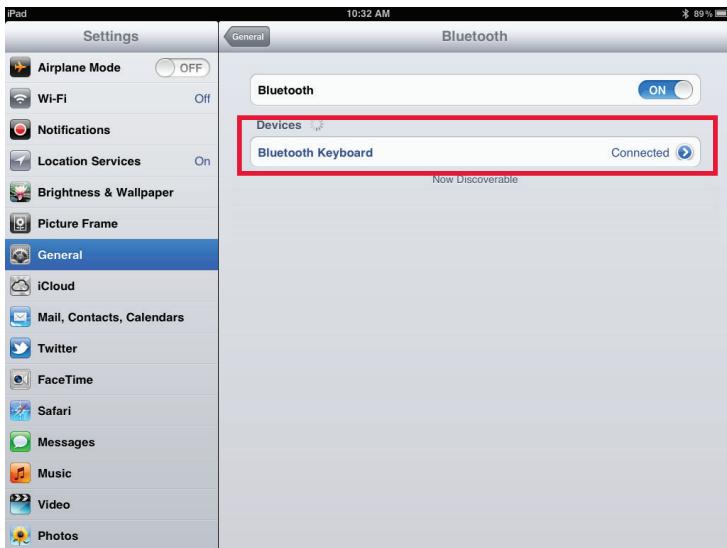

**NOTE:** Do not fold the cover of the Bluetooth Keyboard while it is still in use.

# Other Useful Information

## Troubleshooting guide

### Unable to connect

1. Make sure the Bluetooth Keyboard is within its effective working range (32ft).
2. Make sure the Bluetooth Keyboard is still paired. If not, pair the units again.
3. If the Bluetooth Keyboard is connected to any other Bluetooth products, please cancel, turn off the keyboard and pair again.
4. Check the battery power and recharge the unit, if necessary.

If none of the solutions offered above help you solve your problem, contact our after sales support line for advice.

# Other Useful Information (Cont.)

## Specifications

Executive standard	Bluetooth V3.0
Working distance	32 feet
Modulation system	FHSS 2.4G
Transmitting power	Class 2
Operating voltage	3.0-5.0V
Working current	<4.0mA
Standby current	≤1mA
Sleeping current	<200μA
Charging current	≥100mA
Standby time	60 days
Uninterrupted working time	30 hours
Charging time	4~4.5 hours
Lithium polymer battery capacity	400mAH
Lithium polymer battery life	3 years
Lithium polymer battery specifications	4 x 25 x 40mm
Key life	5 million
Operation temperature	-20°C~55°C
Storage temperature	-40°C~70°C
Humidity	20%-50%

## Responsible disposal

At the end of its working life, do not throw this device out with your household rubbish. Electrical and electronic products contain substances that can have a detrimental effect on the environment and human health if disposed of inappropriately. Observe any local regulations regarding the disposal of computer products and dispose of it appropriately for recycling. Contact your local authorities for advice on disposal/recycling facilities in your area.

### After Sales Support

**Telephone:** 1 866 235 5029  
**Email:** mp656@messageplex.com



# BAUHN®

EFFORTLESS TECHNOLOGY

Tablet Bluetooth Keyboard  
and Case for iPad

## Warranty Card

Unfortunately, from time to time, faulty products are manufactured which need to be returned to the supplier for repair.

Please be aware that if your product is capable of retaining user-generated data (such as files stored on a computer hard drive, telephone numbers stored on a mobile telephone, songs stored on a portable media player, games saved on a games console or files stored on a USB memory stick) during the process of repair, some or all of your stored data may be lost. We recommend you save this data elsewhere prior to sending the product for repair.

You should also be aware that rather than repairing goods, we may replace them with refurbished goods of the same type or use refurbished parts in the repair process.

Please be assured though, refurbished parts or replacements are only used where they meet ALDI's stringent quality specifications. Please complete the warranty section below and enclose this with your purchase docket to the address on the bottom of this page.

**Your details:**

Name \_\_\_\_\_

Address \_\_\_\_\_

\_\_\_\_\_

 \_\_\_\_\_ E mail \_\_\_\_\_

Date of purchase\* \_\_\_\_\_

\* We recommend you keep the receipt with this warranty card.

Location of purchase \_\_\_\_\_

Description of malfunction:

ALDI Customer Service  
NW Fulfilment  
549 Heartland Drive  
Suite E  
Sugar Grove IL 60554



**After Sales Support**

Telephone: 1 866 235 5029  
Email: mp656@messageplex.com