

Helpdesk/Technical Support

Technical Support E-mail: tech@swann.com

Telephone Helpdesk

USA Toll Free 1-800-627-2799

USA Parts & Warranty 1-800-627-2799

(M-F, 9am-5pm US PT)

AUSTRALIA 1800 788 210

NEW ZEALAND Toll Free 0800 479 266

UK 0808 168 9031



M480CAM111215E | © Swann 2015

Limited Warranty - Terms & Conditions

Swann Communications warrants this product against defects in workmanship and material for a period of one (1) year from its original purchase date. You must present your receipt as proof of purchase for warranty validation. Any unit which proves defective during the stated period will be repaired without charge for parts or labour or replaced at the sole discretion of Swann. The end user is responsible for all freight charges incurred to send the product to Swann's repair centres. The end user is responsible for all shipping costs incurred when shipping from and to any country other than the country of origin.

The warranty does not cover any incidental, accidental or consequential damages arising from the use of or the inability to use this product. Any costs associated with the fitting or removal of this product by a tradesman or other person or any

other costs associated with its use are the responsibility of the end user. This warranty applies to the original purchaser of the product only and is not transferable to any third party. Unauthorized end user or third party modifications to any component will render all warranties void. By law some countries do not allow limitations on certain exclusions in this warranty. Where applicable by local laws, regulations and legal rights will take precedence.

For Australia: Our goods come with guarantees which cannot be excluded under Australian Consumer Law. You are entitled to a replacement or refund for a major failure and for compensation for any other reasonably foreseeable loss or damage. You are also entitled to have the goods repaired or replaced if the goods fail to be of acceptable quality.

FCC Verification

This equipment has been tested and found to comply with the limits for Class B digital device, pursuant to part 15 of the FCC Rules. These limits are designed to provide reasonable protection against harmful interference in a residential installation. This equipment generates, uses and can radiate radio frequency energy and, if not installed and used in accordance with the instructions, may cause harmful interference to radio or television reception, which can be determined by turning the equipment off and on, the user is encouraged to try to correct the interference by one or more of the following measures:

- Reorient or relocate the receiving antenna
- Increase the separation between the equipment and the receiver
- Connect the equipment into an outlet on a circuit different from that to which the receiver is connected
- Consult the dealer or an experienced radio/TV technician for help

These devices comply with part 15 of the FCC Rules. Operation is subject to the following two conditions:

(1) These devices may not cause harmful interference.

(2) These devices must accept any interference received, including interference that may cause undesired operation.



Wi-Fi DAY/NIGHT CAMERA

Add-on Camera for Swann HD Wi-Fi Monitoring Systems

Introduction

Congratulations on your purchase of this Wi-Fi Day/Night Camera.

- A state of the art surveillance camera with 1080p video technology
- Seeing is believing with 1080p HD Cameras (2 Megapixel) perfect for most locations around home or business
- Latest infrared cut filter for amazing night vision to 66ft/20m for clarity in low light
- Sturdy metal construction suits indoor & outdoor applications with IP66 rating for any weather conditions
- Deter thieves, safeguard loved ones, protect your property & cut the cost of crime with this professional surveillance camera from Swann

Important instructions

- 1) Make sure your camera is fixed correctly and stable if fastened in place.
- 2) Only use the supplied power extension cable and power adapter (12V).
- 3) Do not operate if wires and terminals are exposed.

Please note - Have a look at the camera location tips included with your NVR, to select the best location for your camera (the camera location tips provided here are for general purpose only).

Important note - All jurisdictions have specific laws and regulations relating to the use of cameras. Before using any camera for any purpose, it is the buyer's responsibility to be aware of all applicable laws and regulations that prohibit or limit the use of cameras.

Connecting your Camera

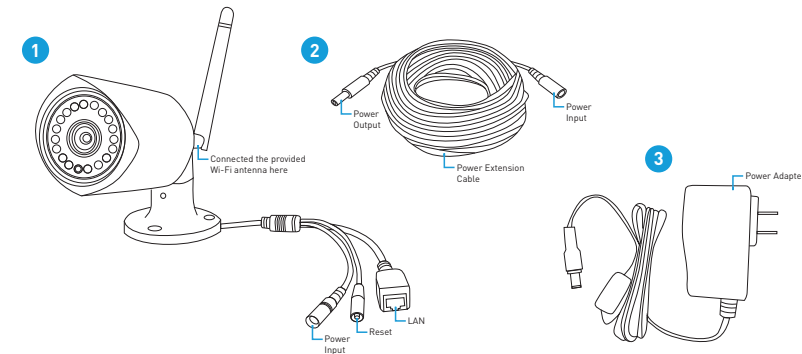

1. Use a clockwise motion to connect the provided Wi-Fi antenna to the Wi-Fi connection located at the rear. Connect the Power Input on the camera to the Power Output on the Power Extension Cable.

2. Connect the Power Input on the Power Extension Cable to the Power Adapter.

3. Connect the Power Adapter to a wall socket then press the wall socket's switch to the on position.

Reset - Press and hold the reset button, connect power and continue holding for 10 seconds.

LAN - This can be used to configure your camera to your wired or Wi-Fi network.

Mounting your Camera

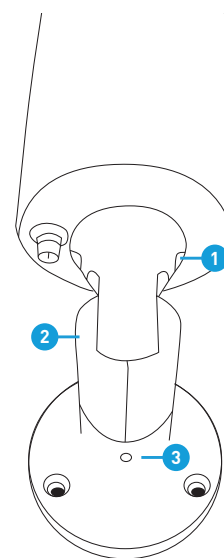

Your camera has three points of articulation (before mounting your camera, remove the Wi-Fi antenna first then reattach when finished). The most obvious is the screw secured elbow joint in the centre of the stand [2]. Using an L-wrench, loosen the hex screw and adjust to the position you want (up or down). Tighten the screw again to secure in place.

The second point of articulation [1] is the radial joint where the neck of the stand is attached directly to your camera. This enables you to rotate your camera left or right so your images will be oriented correctly. Using an L-wrench, loosen both screws (left side and right side) and position accordingly. Tighten both screws again to secure in place.

To rotate the camera stand left or right [3], loosen both screws located at the base and position accordingly. Tighten both screws again to secure in place.

Of course, there will always be some outlying cases where your camera simply won't fit. Maybe you have a hanging awning, or a drain pipe in an inconvenient spot. In these cases, we suggest obtaining a mounting bracket, which should be available from any good hardware store.

Camera Location Tips

Some things to consider when choosing a location -

1) What you want to monitor and where you'll get the best view of it.

2) How you're going to connect your camera to your monitoring system; remember that cables and connections should be kept out of the weather.

3) How to keep your camera out of harm's way. It's recommended to mount your camera at an elevated position.

4) Place your camera as close to the area of interest as practicable. The best position is from about 4m (13ft) above looking slightly down, keeping in mind the details you are looking for.

5) Although the sky looks nice when you look at the live view from your camera, it is an unlikely direction for an offender to approach, make sure your camera has minimal sky in it as the light in daylight can make the foreground of the image darker.

6) Think about the most likely way a potential offender may approach your home, use your cameras to give you the best coverage of these areas.

7) The camera's casing is resistant to water, different weather conditions and tampering. It would take an overwhelming event of this kind to damage the housing of your camera. However, the cable and connector are vulnerable and require protection.

8) Even though your camera is weather and water-resistant, prolonged exposure to adverse weather conditions such as sunlight or excessive moisture, may eventually damage the internal components of the camera and adversely affect its performance.

9) When running your cable, try to avoid bending it at sharp angles.

10) Don't put your cable near live electrical wiring. AC electricity generates radio "noise" which can interfere with the signal from your camera.

FCC Caution:

This device complies with part 15 of the FCC Rules. Operation is subject to the following two conditions: (1) This device may not cause harmful interference, and (2) this device must accept any interference received, including interference that may cause undesired operation.

Any Changes or modifications not expressly approved by the party responsible for compliance could void the user's authority to operate the equipment.

Note: This equipment has been tested and found to comply with the limits for a Class B digital device, pursuant to part 15 of the FCC Rules. These limits are designed to provide reasonable protection against harmful interference in a residential installation. This equipment generates uses and can radiate radio frequency energy and, if not installed and used in accordance with the instructions, may cause harmful interference to radio communications. However, there is no guarantee that interference will not occur in a particular installation. If this equipment does cause harmful interference to radio or television reception, which can be determined by turning the equipment off and on, the user is encouraged to try to correct the interference by one or more of the following measures:

- Reorient or relocate the receiving antenna.
- Increase the separation between the equipment and receiver.
- Connect the equipment into an outlet on a circuit different from that to which the receiver is connected.
- Consult the dealer or an experienced radio/TV technician for help.

This equipment complies with FCC radiation exposure limits set forth for an uncontrolled environment. This equipment should be installed and operated with minimum distance 20cm between the radiator & your body.