

# STUDIO ENERGY 2

## User Guide



### Contents

1. For your safety .....	1
2. Learn about the phone .....	2
● Overview .....	2
● Function Keys .....	2
3. Before using .....	3

● Insert SIM cards and SD card .....	3
● Charge the Battery .....	3
4. Getting started.....	4
● Basic Function .....	4
● Home screen.....	4
● Touch screen .....	5
● Network .....	6
5. Communication .....	6
● Make a call .....	6
● Send a Message .....	7
6. Multimedia.....	8
● Camera .....	8
● Video.....	9
● Gallery .....	9
● Music .....	9
7. Connection & Gestures .....	10
● WLAN.....	10
● Bluetooth.....	10
● USB .....	11
● Airplane mode .....	11
● Smart Gestures .....	12
● Touchless wake-up .....	13
8. Warnings and notes .....	14

# 1. For your safety

Please read this manual before using the cell phone to ensure safe and proper use.



## SWITCH OFF IN HOSPITALS

Please abide by relevant provisions or regulations. Please turn off your mobile phone near medical equipment.



## SWITCH OFF WHEN REFUELING

Don't use the phone at a refueling point. Don't use near fuel or chemicals.



## Micro SIM CARDS AND SD CARD ARE PORTABLE

Keep your phone, phone parts and accessories out of children's reach.



## BATTERY

Please do not destroy or damage the battery, it can be dangerous and cause fire.

Please do not throw battery in fire to avoid hazard.

When battery cannot be used, please dispose in safe environment.

Do not try to dismantle the battery.

If the battery or the charger is broken or old, please stop using them, and replace with certified genuine battery



## USE QUALITY EQUIPMENT

Use authorized equipment to avoid danger



## ROAD SAFETY COMES FIRST

Give full attention while driving, Park before using your phone. Please follow traffic rules of local city town.



## INTERFERENCE

All wireless devices may be susceptible to cause interference, which could affect performance.



## SWITCH OFF IN AIRCRAFT



Wireless devices can cause interference in aircraft. It's not only dangerous but also illegal to use mobile phone in an aircraft.

## 2. Learn about the phone

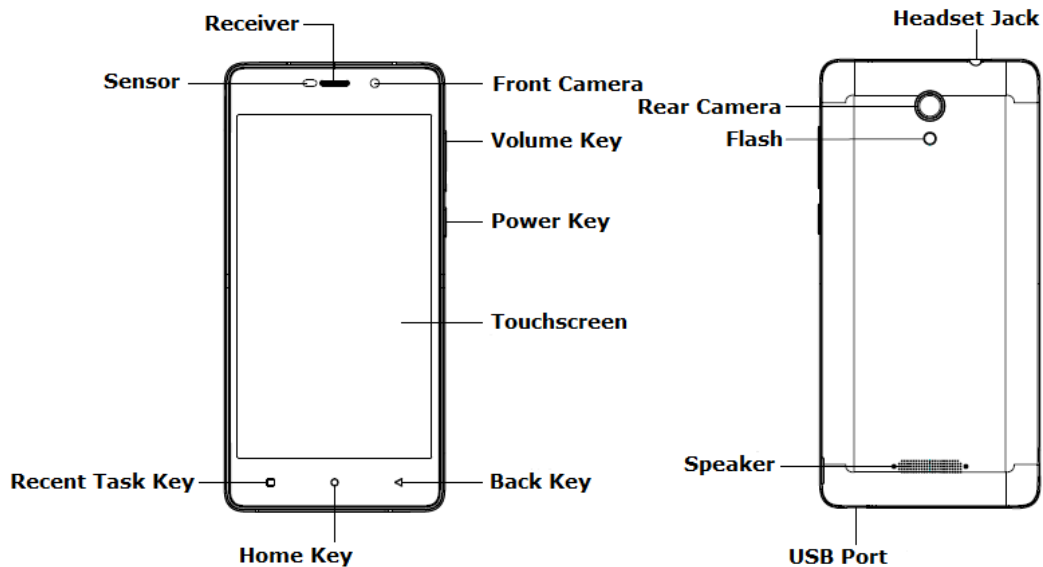
### Overview



### Function Keys

Keys	Function
Power key (Right side of the phone)	a) Press to Turns on/off the screen. b) Press and Hold to power off or reboot the phone.
Volume key (Right side of the phone)	a) Press when call is in progress, increase or decrease the volume, when the phone is ringing, silences the ringer. On the home screen when no call in progress, increase or decrease the ringtone volume or sets the phone to the silent instead of ringing. In other applications, controls the volume of music, spoken directions and other audio. b) Press and hold to quickly increasing ringtone volume to maximum or minimum.
 Recent task key	Tap to open the list of recent used apps.
 Home key	Tap to return to Home screen.
 Back key	Tap to return to the previous screen.

### ✓ IMPORTANT

The battery of mobile phone is fixed. It cannot remove.

### 3. Before using

The phone is a Dual SIM mobile allowing you to use the facility of two networks. To insert SIM card(s):

#### **Insert SIM cards and SD card**

1. Switch off the mobile phone and remove the rear cover.

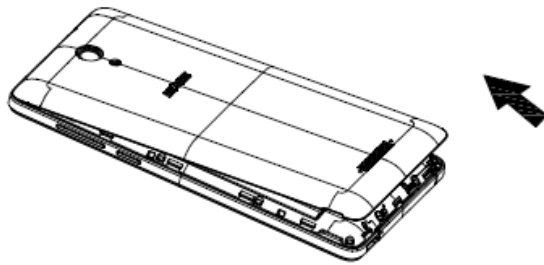

2. Insert the SIM cards & SD card correctly and memory card in the card slot(s).

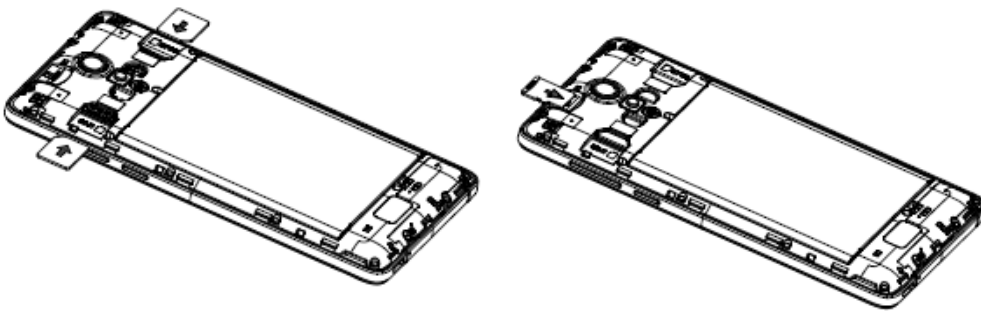

3. Finally replace the rear cover of the mobile phone.

#### ✓ **Note:**

1. The SIM card is a small part. Please keep away from Children to avoid swallowing the card by accident.
2. Please do not touch the metal surface of SIM card and away from electromagnetic field to avoid damage data.

#### **Charge the Battery**

Charge the battery before using it. Connect the USB cable to the USB power adaptor, and then plug the end of the USB cable into the USB Port.

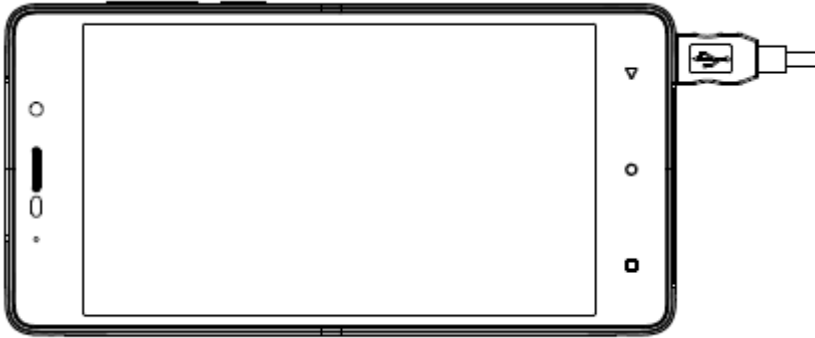

## 4. Getting started

### **Basic Function**

1. Turn on the phone  
Press and hold a while of power key to turn on the phone.
2. Turn off the phone  
Long press the power key until a menu will show. Choose “Power off” to turn off the phone.
3. Reboot the phone  
Long press the power key until a menu will show. Choose “Reboot” to restart the phone.
4. Lock the screen  
Option 1: Press the power key to turn off the screen and lock it  
Option 2: The screen will auto lock if you don't use the phone for a while.
5. Unlock the screen  
Press the power key, and then slide to top for unlocking.

### **Home screen**

The Home screen is your starting point to access all the features on your phone. It displays application icons, widgets, and other features. You can customize the Home screen with different wallpaper and display the items you want.



At the top of the screen, the Status bar displays the time, information about the status of your phone, and icons for notifications that you've received.

1. To move an item on the Home screen
  - 1) Touch & hold the item you want to move. Don't lift your finger.
  - 2) Drag the item to a new location on the screen. Pause at the edge of the screen to drag the item onto another screen pane.
  - 3) When the item is where you want it, lift your finger.
  
2. To uninstall an item from the Home screen
  - 1) Touch & hold the item you want to uninstall. Don't lift your finger. The top / bottom of the application will appear "Uninstall".
  - 2) Touch the "Uninstall" to delete the application.

### **Touch screen**

The main way to control Android™ 5.0 features is by using your finger to touch icons, buttons, menu items, the onscreen keyboard, and other items on the touch screen.

- Touch: To act on items on the screen, such as application and settings icons, to type letters and symbols using the onscreen keyboard, or to press onscreen buttons, you simply touch them with your finger.
- Touch & hold: Touch & hold an item on the screen by touching it and not lifting your finger until an action occurs.
- Drag: Touch & hold an item for a moment and then, without lifting your finger, move your finger on the screen until you reach the target position. You drag items on the

Home screen to reposition them and you drag to open the Notification panel.

- Swipe or slide: To swipe or slide, you quickly move your finger across the surface of the screen, without pausing when you first touch (so you don't drag an item instead). For example, you slide the screen up or down to scroll a list, and in some Calendar views you swipe quickly across the screen to change the range of time visible.
- Pinch: In some applications (Such as Maps, Browser, and Gallery) you can zoom in and out by placing two fingers on the screen at once and pinching them together (to zoom out) or spreading them apart (to zoom in).
- Rotate the screen: On most screens, the orientation of the screen rotates with the phone as you turn it from upright to its side and back again. You can turn this feature on and off.

### **Network**

When you assemble your phone with a SIM card from your wireless service provider, your phone is configured to use your provider's mobile networks for voice calls and for transmitting data.

#### **Settings-->Mobile networks-->Network operators**

The name of the wireless service provider you're currently registered with is selected in the list.

## **5. Communication**

### **Make a call**

- Touch the phone icon on the Home screen.
- Enter the phone number you want to dial.
- Touch the phone icon to dial the number that you entered.



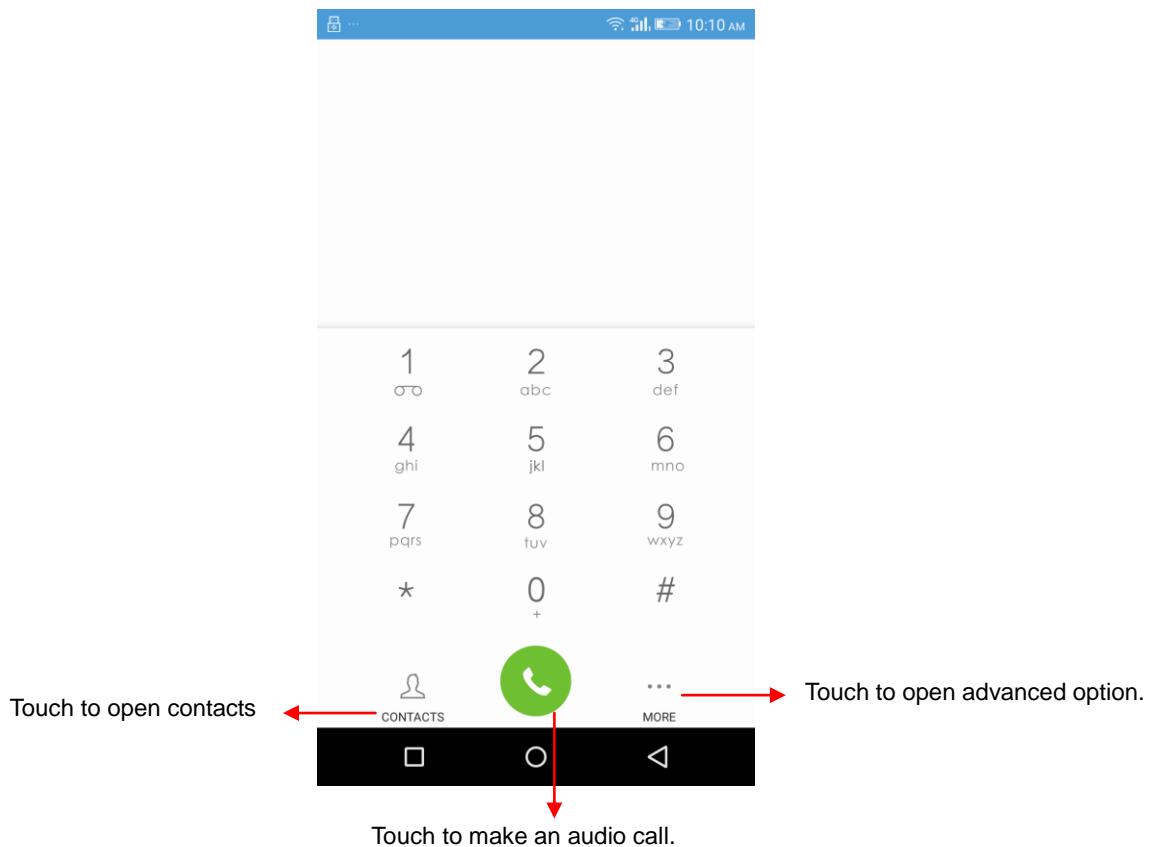

## Send a Message

You can use this phone to exchange text messages and multimedia messages with your friends on their mobile phones. The messages come to and from the same contact or phone number will be visible into a single conversation, so you can see your entire message history with a person conveniently.

### Enter text

- Tap a text field to see onscreen keyboard.
- Tap the keys on the keyboard to type; the characters you've entered appear in a strip above the keyboard. With suggestions for the word you are typing to the right. Press space to enter the highlighted suggested word.
- Use the Delete key to erase characters to the left of the cursor.
- When you're finished typing, Press Back to close the keyboard.





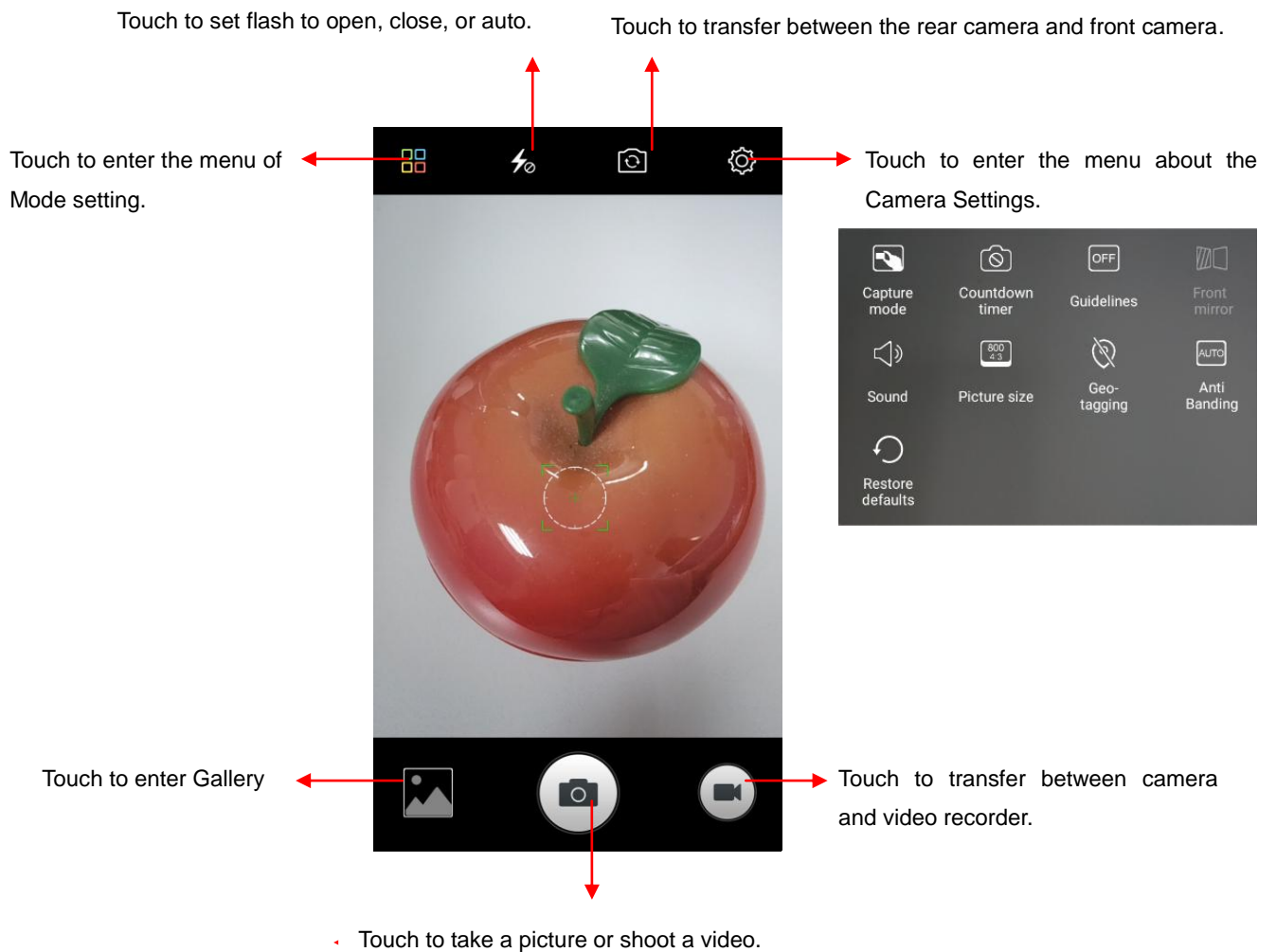

## 6. Multimedia

### 📷 Camera

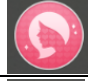
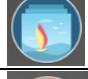
Camera is a combination of camera and camcorder that you use to shoot and share pictures and videos.

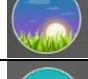
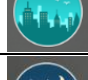

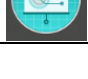
	Normal	Take a phone as usually.
	Face Beauty	DIY your face with Smoother, Whitening, Slimming, Enlarger.
	Take anytime	Best shot, Tracks, Best face, Motion blur, Eraser
	Filter	Multiple filters can choose. Normal, LOMO, Hazy, Bokeh, Time, Cate, Beauty, Sweet, Vintage, B&W.
	HDR	High-Dynamic Range. For Rear camera only.
	Panorama	Press camera button and move the phone on one direction slowly. For Rear camera only.
	Night	For Rear camera only.
	PicNote	Focus to PPT, Whiteboard, Book, Clip and optimize smartly after capturing. For Rear camera only.

#### **Video**

- Tap video icon to transfer it.
- Adjust the quality and other settings if you wish. Or leave them on automatic mode.
- Point the lens to frame the scene where you want to start.
- Touch the Start Video icon. Camera starts shooting the video.
- Touch Stop video icon to stop shooting. An image from your most recent video is displayed as a thumbnail at the bottom Left

#### **Gallery**

Touch the Gallery icon in the Launcher to view albums of your pictures and videos which you've taken with camera.

You can do the following operations:

- To share pictures: You can share your pictures through MMS, Bluetooth, and so on.
- To delete pictures: You can delete the pictures you are viewing.
- To get details about the picture: You can view more details about the picture.

#### **Music**

You use Music player to organize and listen to music and other audio files that you transfer to your phone from your computer.

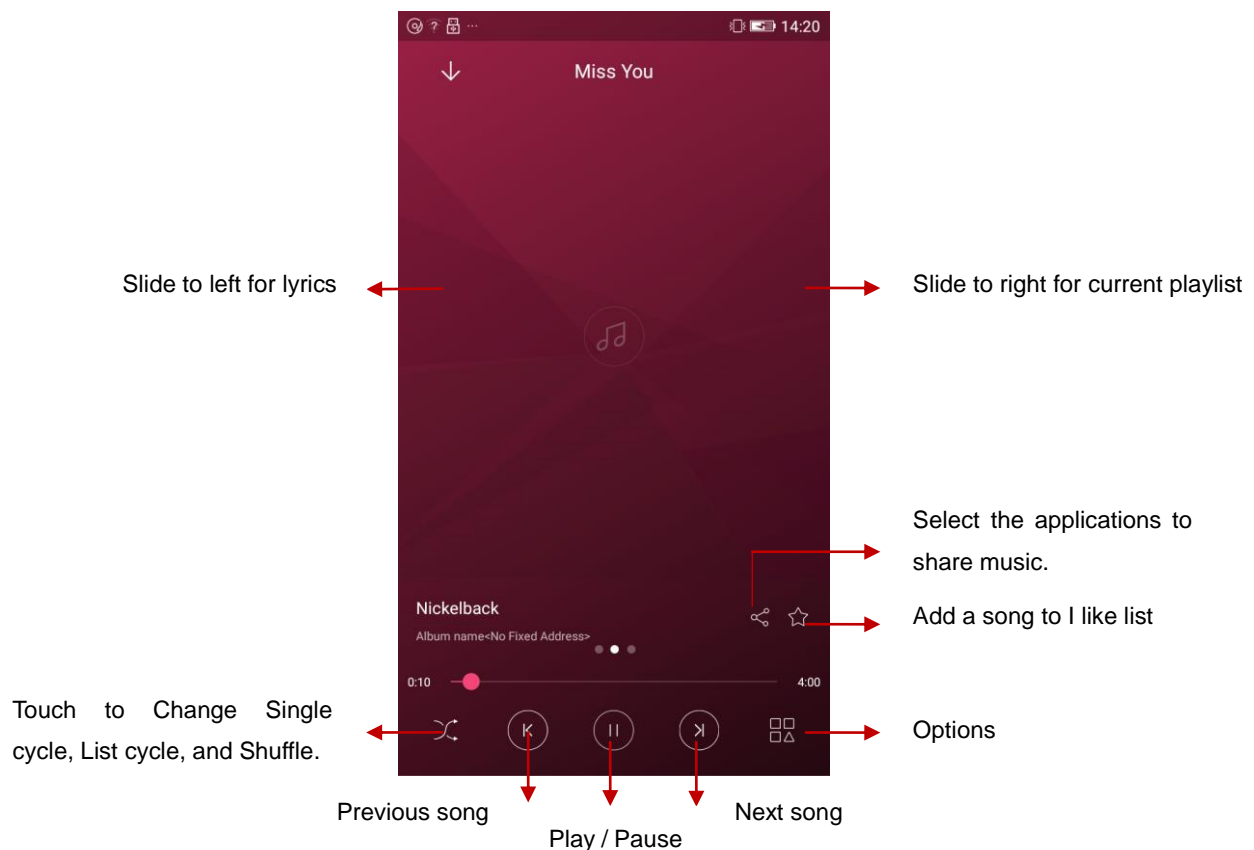

## 7. Connection & Gestures

Your phone can connect to a variety of networks and devices, including mobile networks for voice and data transmission, WLAN data networks, and Bluetooth devices, such as headsets. You can also connect your phone to a computer, to transfer files from your phone storage, and share your phone's mobile data connection via USB or as a portable WLAN hotspot.

### 📶 WLAN

WLAN is a wireless networking technology that can provide internet access at distance of up to 100 meters, depending on the WLAN router and your surroundings. You can configure the WLAN as follow:

- **Settings-->WLAN**, check **WLAN** to turn it on.
- Enter **WLAN**. The phone scans for available WLAN networks and displays the names of those it finds. Secured networks are indicated with a Lock icon. The phone will auto login the network if you previously connected.
- Touch a network to connect to it.

If the network is open, you are prompted to confirm that you want to connect to that network by touching connect. If the network is secured, you're prompted to enter a password or other credentials.

### 📶 Bluetooth

Bluetooth is a short-range wireless communications technology that devices can use to exchange information over a distance of about 10 meters. The most common Bluetooth devices are headphones for making calls or listening to music, hands-free kits for cars, and other portable device, including laptops and cell phones.

#### To send a file

- **Settings--> Bluetooth**, check **Bluetooth** to turn it on.
- Enter **File Explorer** to select a file, Select **Share--> Bluetooth**.
- Touch **Scan for devices**, the phone will scan for and display the names of all available Bluetooth devices in range.
- Touch the names of the other device in the list to pair them. After paired the file will be sent.

#### To receive a file

**Settings--> Bluetooth**, check **Bluetooth** to turn it on. Ensure your Bluetooth has been connected within visibility time

After paired, the phone will receive the file. The file you received will be saved to the "Bluetooth" folder in the File Explorer.

#### To connect to a Handsfree device

- **Settings-->Bluetooth**, Select "**Search for devices**";
- Turn on the Handsfree device, Select the Handsfree device in the list to pair.
- After paired, you can use the Handsfree device to listen to music and receive call.

### **USB**

You can connect your phone to a computer with a USB cable, to transfer music, pictures, and other files between your phone and the computer.

When connecting your phone to a computer, you must follow your computer's instructions for connecting and disconnecting USB devices, to avoid damaging or corrupting the files on your phone.

You can't share your phone's data connection and phone's storage via USB cable at the same time. If you are using USB tethering, you must turn that off first.

#### Open the USB storage

1. Use the USB cable that came with your phone to connect the phone to a USB port on your computer.
2. Touch **File Copy** in the screen that opens to confirm that you want to transfer files. When the phone is connected as USB storage, the screen indicates that USB storage is in use and you receive a notification. Your phone is mounted as a drive on your computer.

### **Airplane mode**

**Settings-->Airplane mode**, check **Airplane mode** to turn it on

Some locations may require you to turn off your phone's Cellular network, WLAN, and Bluetooth wireless connections. You can turn off all these wireless connections at once by

placing your phone in Airplane mode.

### **Smart Gestures**

**Settings-->Advanced Settings--> Smart Gestures**, check **Smart gestures** to turn it on. The smart gestures system supports a variety of experience and control, through gesture can be more convenient operation.

- Pause alarm

**Settings--> Advanced Settings-->Smart Gestures-->Select Pause alarm**

Flip back the phone to pause the on-going alarm.

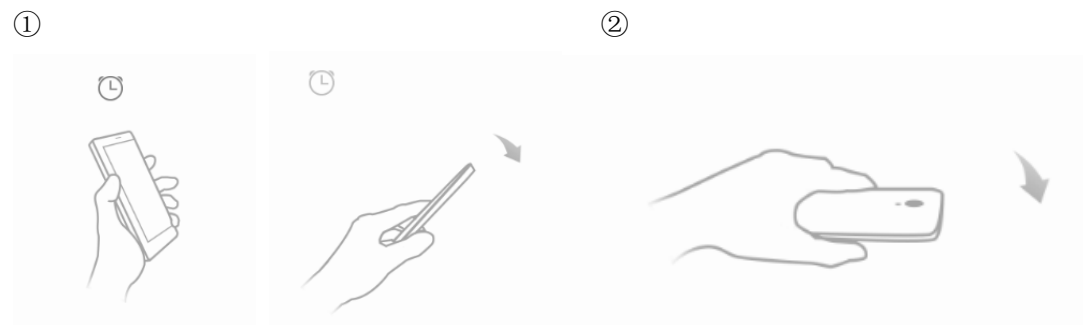

- Black screen gestures

**Settings--> Advanced Settings--> Smart Gestures-->Select Black screen gestures**

Draw pattern to access menu quickly while phone is in sleep mode.



- Smart bright screen

**Settings--> Advanced Settings--> Smart Gestures-->Select Smart bright screen**

When front camera detects you are viewing screen, the screen can be maintained normally. Enable this function, the status bar will display this icon .

The following scenario, the function maybe failure:

- User doesn't face on the screen
- The light is too strong or too dark
- Front camera in use by other applications

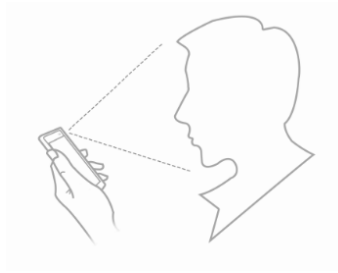

- Double click wake

**Settings--> Advanced Settings--> Smart Gestures-->Select Double click wake**

In sleep screen, quick double tapping can wake up the mobile phone.

①

②

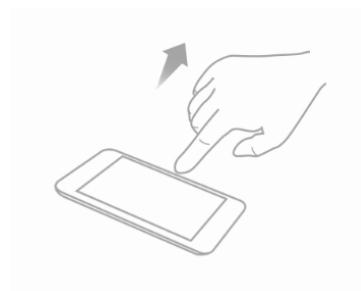
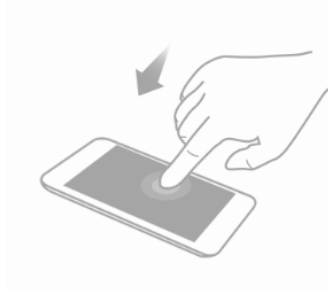

- Touchless wake-up

**Settings-->Advanced Settings-->Smart Gestures-->Touchless wake-up, check Touchless wake-up to turn it on.**

You can slide to unlock, view image, control volume without touch screen.

- Touchless desktop control

**Settings--> Advanced Settings--> Smart Gestures-->Touchless wake-up -->Select Touchless desktop control**

While mobile phone is in system desktop, palm slowly wave left/right over the phone can slid desktop to according direction.

①

②



- Touchless image browsing

**Settings--> Advanced Settings--> Smart Gestures-->Touchless wake-up -->Select Touchless image browsing**

Wave your palm left/right slowly over the top of the phone to view the previous/next image.

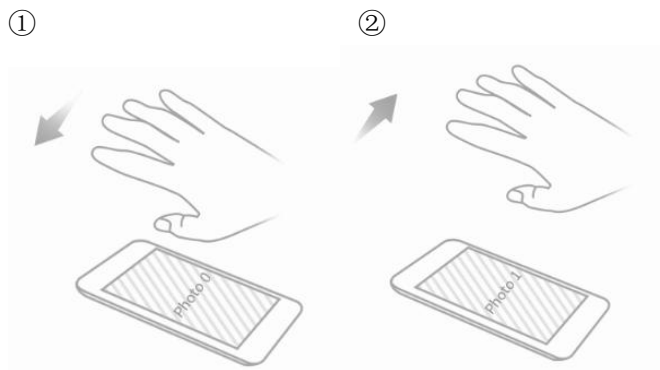

- Touchless video control

**Settings--> Advanced Settings--> Smart Gestures-->Touchless wake-up -->Select Touchless video control**

Wave your palm left/right slowly over the top of the phone to play/pause playing. Wave up/down to control volume up/down.

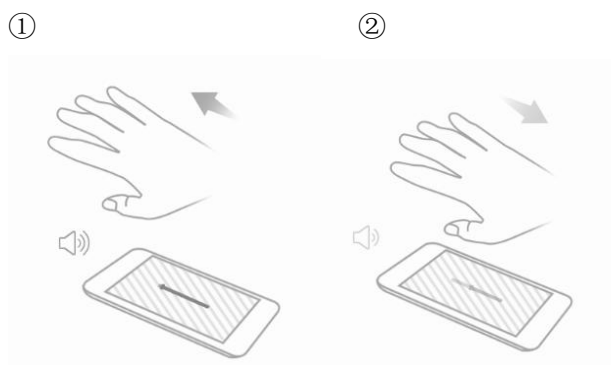
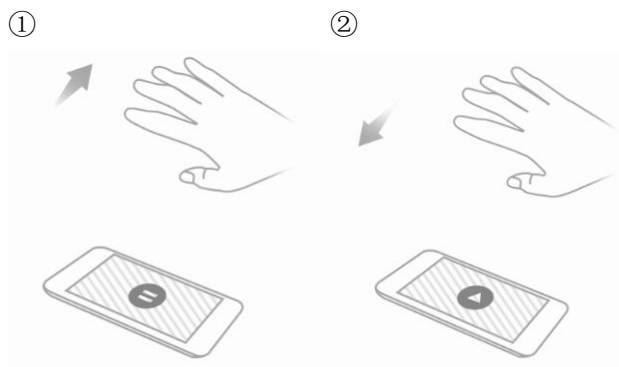

## 8. Warnings and notes

### Operational Warnings

IMPORTANT INFORMATION ON SAFE AND EFFICIENT OPERATION. Read this information before using your phone. For the safe and efficient operation of your phone, observe these guidelines:

**Potentially explosive at atmospheres:** Turn off your phone when you are in any areas with a potentially explosive atmosphere, such as fueling areas (gas or petrol stations, below deck on boats), storage facilities for fuel or chemicals, blasting areas and areas near electrical blasting caps, and areas where there are chemicals or particles (Such as



metal powders, grains, and dust) in the air.

**Interference to medical and personal Electronic Devices:** Most but not all electronic equipment is shielded from RF signals and certain electronic equipment may not be shielded against the RF signals from your phone.

**Audio Safety:** This phone is capable of producing loud noises which may damage your hearing. When using the speaker phone feature, it is recommended that you place your phone at a safe distance from your ear.

**Other Media Devices, hospitals:** If you use any other personal medical device, consult the manufacture of your device to determine if it is adequately shielded from external RF energy. Your physician may be able to assist you in obtaining this information. Turn your phone OFF in health care facilities when any regulations posted in these areas instruct you to do so. Hospitals or health care facilities may be using equipment that could be sensitive to external RF energy.

**Product statement on handling and use:** You alone are responsible for how you use your phone and any consequences of its use.

You must always switch off your phone wherever the use of a phone is prohibited. Use of your phone is subject to safety measures designed to protect users and their environment. Always treat your phone and its accessories with care and keep it in a clean and dust-free place

Do not expose your phone or its accessories to open flames or lit tobacco products.

Do not expose your phone or its accessories to liquid, moisture, or high humidity.

Do not drop, throw, or try to bend your phone or its accessories

Do not use harsh chemicals, cleaning solvents, or aerosols to clean the device or its accessories.

Do not attempt to disassemble your phone or its accessories; only authorized personnel must do so.

Do not expose your phone or its accessories to extreme temperatures, minimum 32°F and maximum 113°F (0°C to 45°C).

**Battery:** Your phone includes an internal lithium-ion or lithium-ion polymer battery. Please note that use of certain data applications can result in heavy battery use and may require frequent battery charging. Any disposal of the phone or battery must comply with laws and regulations pertaining to lithium-ion or lithium-ion polymer batteries.

**Faulty and damaged products:** Do not attempt to disassemble the phone or its accessory. Only qualified personnel must service or repair the phone or its accessory. If your phone or its accessory has been submerged in water, Punctured, or subjected to a severe fall, do not use it until you have taken it to be checked at an authorized service center.

Android is a trademark of Google Inc.

## **FCC Regulations:**

This mobile phone complies with part 15 of the FCC Rules. Operation is subject to the following two conditions: (1) This device may not cause harmful interference, and (2) this device must accept any interference received, including interference that may cause undesired operation.

This mobile phone has been tested and found to comply with the limits for a Class B digital device, pursuant to Part 15 of the FCC Rules. These limits are designed to provide reasonable protection against harmful interference in a residential installation. This equipment generates, uses and can radiated radio frequency energy and, if not installed and used in accordance with the instructions, may cause harmful interference to radio communications. However, there is no guarantee that interference will not occur in a particular installation. If this equipment does cause harmful interference to radio or television reception, which can be determined by turning the equipment off and on, the user is encouraged to try to correct the interference by one or more of the following measures:

- Reorient or relocate the receiving antenna.
- Increase the separation between the equipment and receiver.
- Connect the equipment into an outlet on a circuit different from that to which the receiver is connected.
- Consult the dealer or an experienced radio/TV technician for help.

FCC Note:

Caution: Changes or modifications not expressly approved by the party responsible for compliance could void the user's authority to operate the equipment.

## **RF Exposure Information (SAR)**

This phone is designed and manufactured not to exceed the emission limits for exposure to radio frequency (RF) energy set by the Federal Communications Commission of the United States.

During SAR testing, this device was set to transmit at its highest certified power level in all tested frequency bands, and placed in positions that simulate RF exposure in usage against the head with no separation, and near the body with the separation of 10 mm. Although the SAR is determined at the highest certified power level, the actual SAR level of the device while operating can be well below the maximum value. This is because the phone is designed to operate at multiple power levels so as to use only the power required to reach the network. In general, the closer you are to a wireless base station antenna, the lower the power output.

The exposure standard for wireless devices employing a unit of measurement is known as the Specific Absorption Rate, or SAR.

The SAR limit set by the FCC is 1.6W/kg.

This device is complied with SAR for general population /uncontrolled exposure limits in ANSI/IEEE C95.1-1992 and had been tested in accordance with the measurement methods and procedures specified in IEEE1528.

The FCC has granted an Equipment Authorization for this model phone with all reported SAR levels evaluated as in compliance with the FCC RF exposure guidelines. SAR information on this model phone is on file with the FCC and can be found under the Display Grant section of [www.fcc.gov/oet/ea/fccid](http://www.fcc.gov/oet/ea/fccid) after searching on FCC ID: YHLBLUSTENERGY2.

For this device, the highest reported SAR value for usage against the head is 0.49 W/kg, for usage near the body is 1.17 W/kg.

While there may be differences between the SAR levels of various phones and at various positions, they all meet the government requirements.

SAR compliance for body-worn operation is based on a separation distance of 10 mm between the unit and the human body. Carry this device at least 10 mm away from your body to ensure RF exposure level compliant or lower to the reported level. To support body-worn operation, choose the belt clips or holsters, which do not contain metallic components, to maintain a separation of 10 mm between this device and your body. RF exposure compliance with any body-worn accessory, which contains metal, was not tested and certified, and use such body-worn accessory should be avoided.

## **IC Notice**

This device complies with Industry Canada license-exempt RSS standard(s). Operation is subject to the following two conditions:

- (1) this device may not cause interference, and
- (2) this device must accept any interference, including interference that may cause undesired operation of the device.

Le présent appareil est conforme aux CNR d'Industrie Canada applicables aux appareils radio exempts de licence. L'exploitation est autorisée aux deux conditions suivantes:

- (1) l'appareil ne doit pas produire de brouillage, et
- (2) l'utilisateur de l'appareil doit accepter tout brouillage radioélectrique subi, même si le brouillage est susceptible d'en

This Class B digital apparatus complies with Canadian ICES-003.

Cet appareil numérique de la classe B est conforme à la norme NMB-003 du Canada.

IC: 11492A-STENERGY2

## **IC Radiation Exposure Statement**

This EUT is compliance with SAR for general population/uncontrolled exposure limits in IC RSS-102 and had been tested in accordance with the measurement methods and procedures specified in IEEE 1528 and IEC 62209. This equipment should be installed and operated with minimum distance 1.0 cm between the radiator and your body. This device and its antenna(s) must not be co-located or operating in conjunction with any other antenna or transmitter.

Cet appareil est conforme aux limites d'exposition DAS incontrôlée pour la population générale de la norme CNR-102 d'Industrie Canada et a été testé en conformité avec les méthodes de mesure et procédures spécifiées dans IEEE 1528 et IEC 62209. Cet appareil doit être installé et utilisé avec une distance minimale de 1.0 cm entre l'émetteur et votre corps. Cet appareil et sa ou ses antennes ne doivent pas être co-localisés ou fonctionner en conjonction avec tout autre antenne ou transmetteur.