

**LOGO**

**BLU  
GSM/GPRS/WCDMA Mobile Phone  
User Guide**

## Contents

<b>I CAUTIONS ON MOBILE PHONE USE</b>	<b>4</b>
<b>1.1 INTERFERENCE</b>	<b>4</b>
<b>1.2 REASONABLE USE</b>	<b>4</b>
<b>1.3 QUALIFIED MAINTENANCE SERVICE</b>	<b>4</b>
<b>1.4 WATER-RESISTANCE</b>	<b>4</b>
<b>1.5 EMERGENCY CALLS</b>	<b>4</b>
<b>2 PRECAUTIONS FOR USE OF BATTERY</b>	<b>4</b>
<b>3 CAUTIONS FOR CHILDREN</b>	<b>4</b>
<b>II. KEYS AND PARTS</b>	<b>5</b>
<b>III. START TO USE</b>	<b>6</b>
<b>1 INSERT SIM CARD</b>	<b>6</b>
<b>2 INSERT MEMORY CARD</b>	<b>7</b>
<b>3 CHARGE THE BATTERY</b>	<b>8</b>
<b>IV. BASIC FUNCTIONS</b>	<b>9</b>
<b>1 LOCK AND UNLOCK THE SCREEN</b>	<b>9</b>
<b>2 MAKE IT YOURS</b>	<b>10</b>
<b>4 MAKE A CALL</b>	<b>18</b>
<b>5 CALL LOG</b>	<b>19</b>

<b>6 ANSWERING PHONE CALLS AND REJECTION</b>	<b>20</b>
<b>7. ADD A CONTACT</b>	<b>21</b>
<b>8. SEND AND RECEIVE MESSAGE(S)</b>	<b>22</b>
<b>9. BROWSER THE WEB</b>	<b>24</b>
<b>10. ENJOY MUSIC</b>	<b>24</b>
<b>11. DOWNLOAD APPLICATIONS FROM PLAY STORE</b>	<b>26</b>
<b>12. MANAGE APPLICATIONS</b>	<b>27</b>
<b>13. APPLICATIONS &amp; UTILITIES</b>	<b>28</b>
<b>VI. TECHNICAL INFORMATION</b>	<b>30</b>
<b>VII HEALTH AND SAFETY INFORMATION</b>	<b>32</b>
<b>1. FCC REGULATIONS</b>	<b>32</b>
<b>2. SAR INFORMATION</b>	<b>33</b>

## **I Cautions on mobile phone use**

### **1.1 Interference**

All phones may be interfered, which affect phone calls.

### **1.2 Reasonable use**

Use only in the normal position. Do not touch the antenna area unnecessarily.

### **1.3 Qualified maintenance service**

Only qualified personnel may install or repair this product.

### **1.4 Water-resistance**

Your device is not water resistant. Keep it dry.

### **1.5 Emergency calls**

Ensure the phone is switched on and in service. Enter the emergency number and press the Dial icon.

## **2 Precautions for use of battery**

**2.1** Do not dispose of batteries near or in a fire to avoid dangers.

**2.2** Do not dispose of batteries in the garbage. Dispose of batteries to assigned battery recycling center.

## **3 Cautions for children**

Keep your device out the reach of children in case of accidental injury caused by incorrect use of

the device as toys.

## II. Keys and parts

---



- 1. SIM card holder
- 2. Receiver
- 3. Front Camera
- 4. MIC
- 5. Audio jack
- 6. USB connector
- 7. Speaker
- 8. Adjust volume key
- 9. Power key
- 10. Rear Camera
- 11. Flashlight

### **III. Start to use**

#### **1 Insert SIM card**

The phone is a Dual SIM mobile phone allowing you to use the facility of two networks.  
To insert SIM card(s):

Insert the SIM card correctly in the card slot(s) (See figure below), suggest switch off the phone when you insert SIM card.

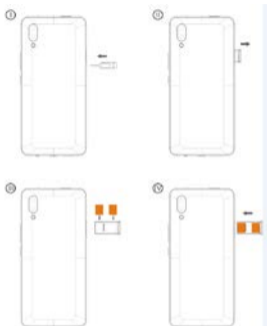

## 2 Insert Memory card

Insert the Micro SD card into the slot with the correct direction (See figure below), suggest switch off the phone when you insert SIM card.

Note: Use only compatible memory cards with this device. Incompatible memory cards may damage the card or the device and corrupt the data stored in the card.



### 3 Charge the battery

During charging, the battery indicator on the phone is a thunder icon. If the device is switched off during charging, there will still be a charging indication on the screen that shows the phone is being charged. If the device is overused when the battery is low, the charging icon might take



some time to appear.

When the battery indicator on the screen says 'Battery is full', thunder icon will disappear, which means the completion of charging. If the phone is switched off during charging, the screen will display ' Battery is full '. It generally takes 4 hours to charge the battery. During charging, the battery, the device and the charger will get hot. This is normal.

Unplug the charger from the AC electrical outlet and disconnect the wiring between the phone and the charger after charging. .

**Cautions:** Charge the phone in a well ventilated place in which the temperature is between -10 °C to +55 °C. ~~By the manufacturer only~~ The use of unconfirmed charger may lead to dangers and violate the manufacturer's warranty clause. If the temperature is too high or too low during charging, the device will automatically send a warning and stop charging to avoid damage to the battery or any danger.

#### **IV. Basic functions**

##### **1 Lock and unlock the screen**

Press power button to enter Sleep mode and meanwhile the screen will be locked; press power button again to wake up and then drag to up direction for unlock.

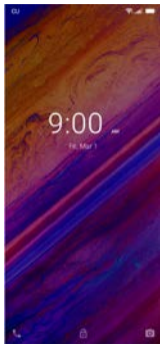

## **2 Make it yours**

1. Home screen: It is your starting point to access all the features on your phone. It displays application icons, widgets, shortcuts, and other features. Long press home screen and Modify Wallpaper



2. Long press Home screen, and then you can Modify Wallpaper; or enter Launcher and long press and hold an application till the screen vibrates, and then release your finger hold.



Long press and hold the widget or icon you want to move. Once the phone vibrates, don't release your hold on the icon. Drag the widget or icon to a new location on the screen Press and hold on an icon till the phone vibrates, and drag the widgets or icon to the trash to remove!

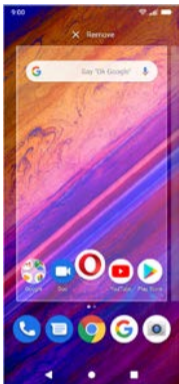

Swipe left and enter to application list

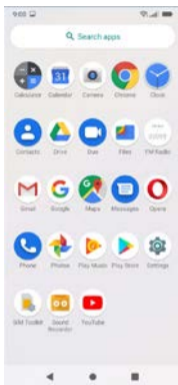

3. Notification Bar: At the top of the screen, the Status Bar displays the time,

status, and notifications. If there is a new message, missed call or something in the notification bar, you can drag it down to open notification panel and click the desired one to have a view. When you finished, you can close it by dragging the panel up or pressing “Back”

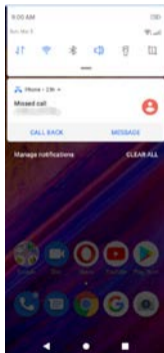
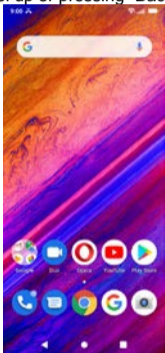

4. If you connect your phone to PC via USB, you can find the USB options, choose Media device (MTP) option you can see your phone memory in PC, this is same function like USB storage,

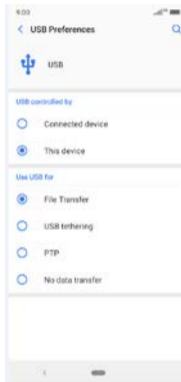

3 Switch to Recently Used Application  
Press home key.





*Touch this icon  
to close all*

*Touch and slide this  
place can choose to  
open the history  
application*

#### 4 Make a call



Click  and enter a complete phone number to make a call. Your phone supports smart search.



Swipe to right to view Favorite, Call history and Contacts.

## 5 Call log

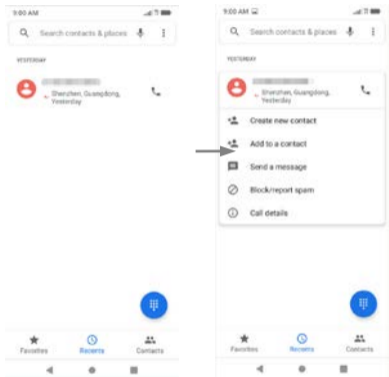

*Press the number which you want see the details or*

press the number, you can call back, view contact details etc.

## 6 Answering phone calls and rejection

Although there is a call, you can choose to answer or hang up directly.

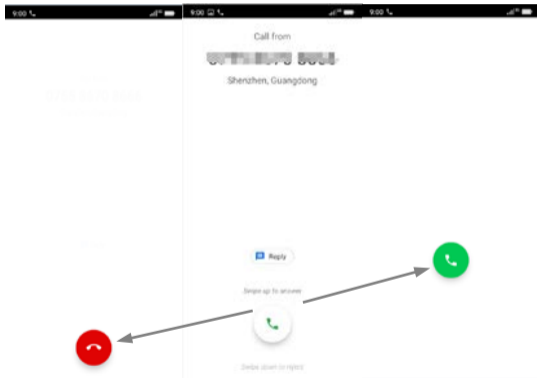

Drag the icon, select the icon to select the answer or hang up.

## 7. Add a contact

Touch  to enter contact

Touch  to add new contact



No contacts yet



Click here to add new contact and in this page press menu key to enter menu view, setting, etc.

## 8. Send and Receive message(s)



Touch  enter messaging, touch compose new message.



*Tap this icon to select desired contact from*



*Touch to switch the digital input and symbols*

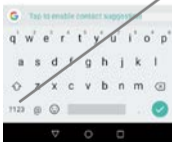

Press space or a punctuation mark to enter the highlighted suggestion

When you are composing a new text message, you can select text for cutting or copying. The selected text is highlighted in green.

Tap  to add "Attach" including Pictures, Videos, Audios, etc to send MMS&SMS

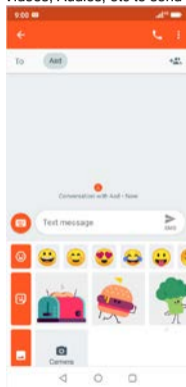
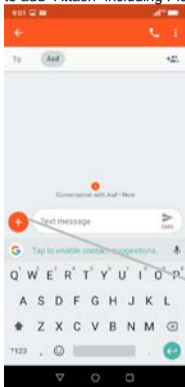

When a new message comes, you can read by dragging notification panel and click the message, or entering Message to read it directly.

Long press one of the all message threads, you can delete thread”.

## **9. Browser the Web**

### **1. Set up Internet/Data connection**

Enter Settings > More..., scroll down to find out Mobile network, and then enter “Access Points Names, choose the desired WAP account.

### **2. Switch on Data connection or Wi-Fi**

To browse the web, you need to switch on Data connection. If there is Wi-Fi around, you can switch on Wi-Fi to use it browse the web.

## **10. Enjoy music**

When you copy music to your SD card, the Music player searches the card for music files and builds a catalog of your music, based on information about each file that is stored in the file itself.





## 11. Download applications from Play Store

1. Add Google™ account
2. Enter play store and download apps

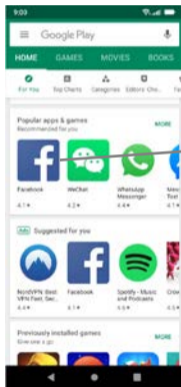

## 12. Manage Applications

Enter Setting > App.  
You can see app info.

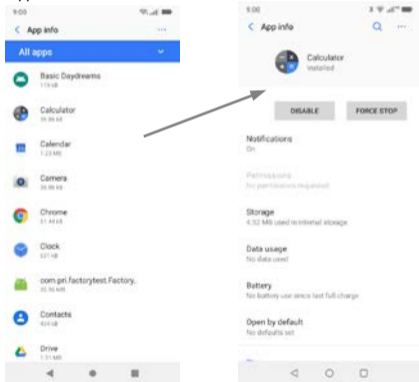

### 13. APPLICATIONS & UTILITIES

For your entertainment purpose, your device is provided with several interesting games, applications and utilities, such as Gmail, Email, Play store. Please ensure that you have GPRS setting in your device to access the applications. Contact your operator for GPRS settings.

**Tips:** With connection to Wi-Fi network, this application can run normally, too.

### 14.Settings

#### 14.1Wi-Fi

Open Wi-Fi, search nearby Wi-Fi and connect it, then you can use internet or download apps for free.

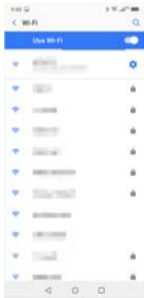

## 14.2 Bluetooth

Open Bluetooth, connect to other phone, you can share something like music, photos, movies etc to other people

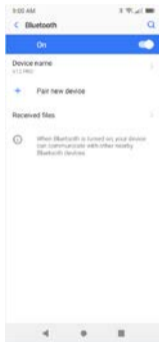

## 14.3 Security

Screen lock

There are four screen lock you can choose Slide, Pattern, PIN, Password.

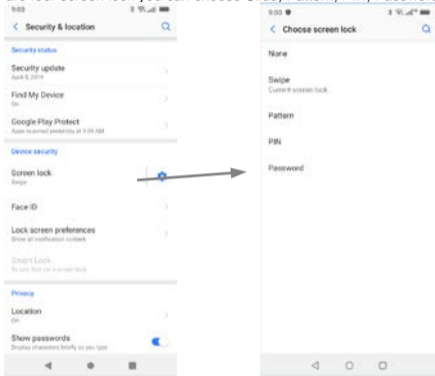

## VI. Technical Information

Model: N1

Size Length: 158.7x74.1x8.6mm

Battery: 3400mAh

GMS: B2/3/5/8

WCDMA: B1/2/4/5/8

FDD: B1/2/3/4/5/7/8/12/13/17/28 (A+B)

Weight: 182g

Nominal voltage: 3.80V

Max. Voltage: 4.35V

Continuous standby time:300hours

Continuous calling time: 180hours

Operation Temperature: -10~40

The operation time of the battery depends on conditions such as:

- Transmitting power level
- Signal (distance between the phone and the base station)

- Network parameters defined by the operator
- Phone use (WAP, games, SMS)
- Charging procedure used

## **VII Health and Safety Information**

### **1. FCC Regulations**

This device complies with part 15 of the FCC Rules. Operation is subject to the following two conditions: (1) This device may not cause harmful interference, and (2) this device must accept any interference received, including interference that may cause undesired operation.

This equipment has been tested and found to comply with the limits for a Class B digital device, pursuant to part 15 of the FCC Rules. These limits are designed to provide reasonable protection against harmful interference in a residential installation. This equipment generates, uses and can radiate radio frequency energy and, if not installed and used in accordance with the instructions, may cause harmful interference to radio communications. However, there is no guarantee that interference will not occur in a particular installation. If this equipment does cause harmful interference to radio or television reception, which can be determined by turning the equipment off and on, the user is encouraged to try to correct the interference by one or more of the following measures:

- Reorient or relocate the receiving antenna.
- Increase the separation between the equipment and receiver.
- Connect the equipment into an outlet on a circuit different from that to which the receiver is



connected.

—Consult the dealer or an experienced radio/TV technician for help.

Changes or modifications not expressly approved by the party responsible for compliance could void the user's authority to operate the equipment.

## **2. SAR Information**

The SAR limit of USA (FCC) is 1.6 W/kg averaged over one gram of tissue. This phone has also been tested against this SAR limited. The highest SAR value reported under this standard during product certification for use at the ear is 0.87 W/kg and body is 0.44 W/kg.

To reduce exposure to RF energy, use a hands-free accessory or other similar option to keep this device away from your head and body. Carry this device at least 1.0 cm away from your body to ensure exposure levels remain at or below the as-tested levels. Choose the belt clips, holsters, or other similar body-worn accessories which do not contain metallic components to support operation in this manner. Cases with metal parts may change the RF performance of the device, including its compliance with RF exposure guidelines, in a manner that has not been tested or certified, and use such accessories should be avoided.

Google, Google Play and other marks are trademarks of Google LLC