



DTTAB2in1-116-1

2in1 tablet pc

## USER GUIDE

11.6" Tablet with Docking Keyboard



Review this manual before operating your Direkt-Tek laptop and keep it for future reference.

## Table of Contents

---

TABLE OF CONTENTS	Page
1.0 Introduction.....	2
1.1 Overview .....	2
2.0 Appearance and Buttons.....	3
2.1 Introduction to Desktop.....	4
2.2 Windows Start Menu .....	4
2.3 Introduction to App Interface .....	4
3.0 Basic Operations.....	6
3.1 Sleep, Restart and Shut Down .....	6
3.2 Recovery.....	6
3.3 Bluetooth.....	7
3.4 Security Management .....	8
4.0 How To Set Up Fingerprint (Windows Hello).....	9
4.1 Remove Fingerprint.....	11
5.0 Using Windows Ink.....	12
5.1 Sticky Notes.....	12
5.2 Sketchpad.....	13
5.3 Screen Sketch.....	14
6.0 Using The Smart Stylus.....	14
6.1 Parts Of The Smart Stylus.....	14
6.2 Replacing The Tip.....	15
6.3 Package Contents.....	15
6.4 Install The Battery.....	15
7.0 Specifications.....	16

### 1.0 INTRODUCTION

This User Guide is designed to guide you through the key functions and features of your new laptop. Please read carefully to ensure an optimal user experience and keep it handy for future reference.

### 1.1 OVERVIEW

The new Direkt-Tek 11.6" Tablet with Docking Keyboard (DTTAB2in1 116-1) features Windows 10, HD resolution screen of 1920 x 1080 and boasts an Intel® Atom® x5-Z8350 Processor with 2M Cache and up to 1.92 GHz. With the Tablet with Docking Keyboard you can access the web, news, local business information and the Windows Store, where you can download your favorite apps, games, movies and more! With the built-in Bluetooth function you can seamlessly pair your Tablet with Docking Keyboard with any Bluetooth compatible devices.

### NOTES

- The Tablet with Docking Keyboard is a high-density electronic product. DO NOT attempt to disassemble the device.
- Please do not drop or bang the device.
- Avoid using this product in the following environments: Extremely hot or cold places, high humidity, dusty areas, direct sunlight or long-term exposure to the sun.
- The product may be cleaned with a damp cotton cloth; the use of any chemical cleaning fluid is prohibited. Please keep the product away from water at all times.
- If you use headphones, DO NOT use them while crossing the street, riding a bicycle or driving a motorcycle.
- Please use approved battery, battery charger and accessories only. The use of any other type of products would be a breach of warranty and may be dangerous.
- If you have any questions regarding the use of this product, please contact your local dealer or contact Direkt-Tek customer service center directly at [CustomerService@direkt-tek.com](mailto:CustomerService@direkt-tek.com) or call (888) 999-1675.
- Direkt-Tek will not be held responsible for any files lost due to product damage, repair or other causes. Please be sure to follow instructions in the User Guide and backup your files in a timely manner.

# Appearance and Buttons

## 2.0 APPEARANCE AND BUTTONS

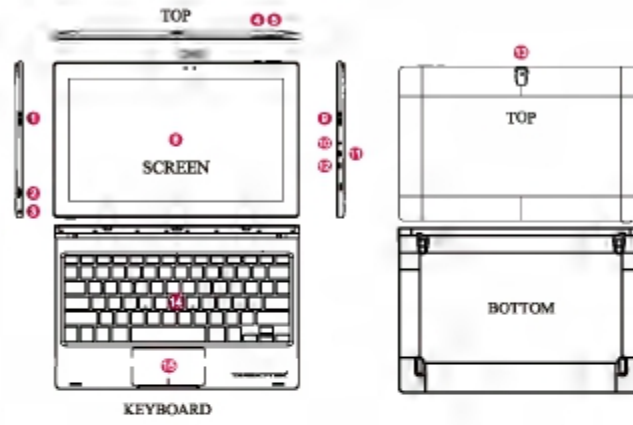

- ❶ Speaker
- ❷ SD Card Reader
- ❸ Earphone
- ❹ Power
- ❺ Volume
- ❻ Front Camera
- ❼ Microphone
- ❽ Screen

- ❹ Speaker
- ❿ DC IN
- ⓫ Micro HDMI
- ⓬ USB Type C
- ⓭ Rear Camera
- ⓮ Keyboard
- ⓯ Touchpad



## Introduction to Desktop

---

### 2.1 INTRODUCTION TO THE DESKTOP

You must log on to your Microsoft account before the start up application can run.

### 2.2 WINDOWS START MENU

Press the key  on the keyboard or click the icon  on the screen until you see the Start Menu. All applications/programs are displayed in the form of "magnets" listed on the screen. Click on any of the icons to open.



### 2.3 INTRODUCTION TO APP INTERFACE



If you want to pin more application programs on the Start interface, press and hold the application program for about one second, and release the magnet until the pop-up option appears and select "Pin to Start" to fix to the start screen, or just press and move to the start screen. (Screen 1).

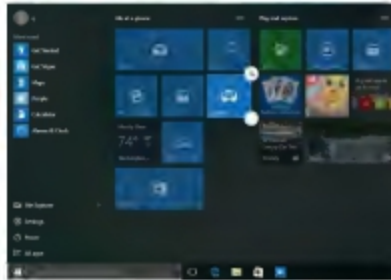

(Screen 1)



(Screen 2)

Conversely, if you want to cancel or delete a certain application in the Start screen, press and hold the application program magnet for about one second and click . You can also click  to check more menu options, such as resizing the magnet you want. (Screen 2) Slide it to the left from the right side of the screen to start Action Center to check the laptop status: Rotation lock, Bluetooth, Brightness, etc.

## Basic Operations

### 3.0 BASIC OPERATIONS

#### 3.1 Sleep, Restart and Shutdown

##### Force Reset / Shutdown

If the laptop freezes, you can press and hold the Power button for 8–12 seconds, then the laptop will shutdown.



#### 3.2 RECOVERY

Follow the steps below

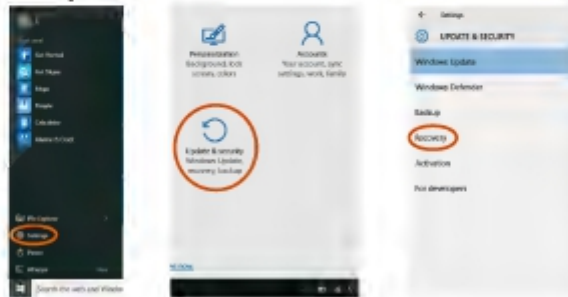





Click the  button in the lower left corner of screen and select "Settings" then select "Update & Security", click on "Recovery". The program will walk you through simple steps necessary to recover your system.

## Basic Operations (Cont'd)

### 3.3 BLUETOOTH

- Click the  button in the lower left corner of screen.
  - Select "Settings"
  - Select "Devices", click on "Bluetooth".
- a) Make sure the Bluetooth switch is set to "On"  
After you turn on Bluetooth, the laptop will auto-search other devices you can pair with your device.

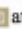
#### Send or Receive Files via Bluetooth

- b) Send a File: Before sending files, you should open the window, "Select where to send your files": Click the icon  at lower right corner of desktop -  - Send a File.
- c) Receive a File: Before receiving the files, you should open the window "Waiting for a connection": Click the icon  at lower right corner of desktop -  - Receive a File.

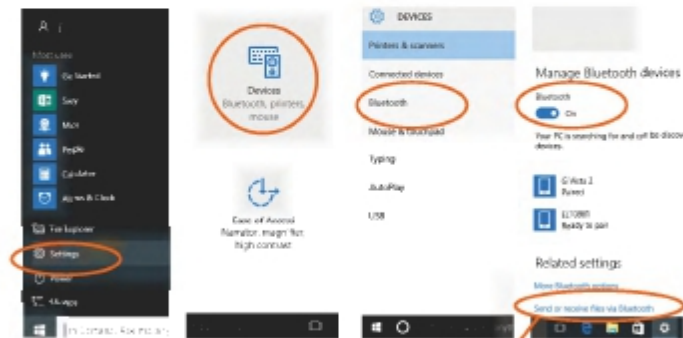

Send or Receive Files via Bluetooth





### 3.4 SECURITY MANAGEMENT

Method for quick setup:

Click the  button in the lower left corner of screen and select "Settings".

Select "Accounts" on the right and click "Create local account" in "Your account" on the right side. After creating a user name and a password for Windows Live ID Account, input username, password, confirm password and password prompt.

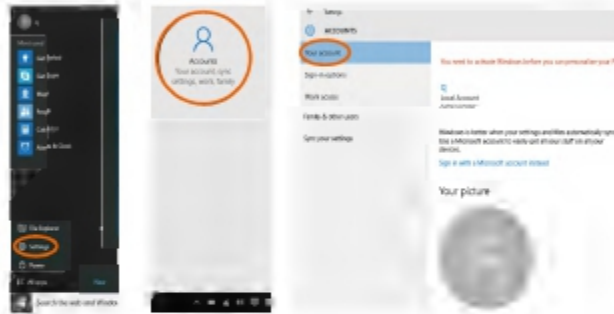

## Windows Hello

Windows Hello is a faster, more secure way to log in than typing a password – because YOU are the password. Windows Hello recognizes you and greets you by name, granting you secure access with a fingerprint reader, illuminated infrared, and other specialized biometric sensors.

### 4.0 HOW TO SET UP FINGERPRINT

- 1 - Open Accounts Settings.  
(Settings> Accounts)



- 2 - Select Sign-in options and set a password to gain access to additional security features.



- 3 - After setting your password, set up a PIN code to gain access to Windows Hello.



## Windows Hello (Cont'd)

4 - After your password and PIN code are set, select **Fingerprint Set up** to begin Windows Hello set up.



5 - Follow the Windows Hello setup instructions to scan and register your fingerprint. NOTE: Windows Hello will use 8-10 scans. We recommend you place the same finger in different positions for thorough fingerprint registration.



6 - Scan Fingerprint



## Windows Hello (Cont'd)

7 - Once the fingerprint is set, your Windows Hello fingerprint scan is complete and ready to use! You have the option of adding multiple fingerprints to the same account, or setting up fingerprints for different accounts.

**NOTE:** We recommend adding at least two fingerprints per account. This ensures consistent accessibility without compromising your security.



### 4.1 TO REMOVE FINGERPRINT

Return to Windows Hello settings and select **Remove**.  
(Settings > Accounts > Sign-in options)



**Tip:** To remove identification data, go to Settings > Accounts > Sign-in options. Under Windows Hello, select **Remove**.

## Windows Ink

---

### 5.0 USING WINDOWS INK

Write sticky notes, make sketches, and draw on screenshots in Windows Ink Workspace.

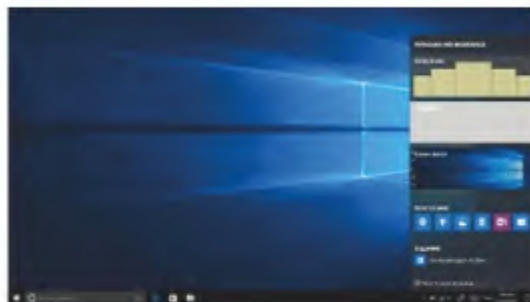

NOTE: If you don't have a Windows Ink pen, you may also draw using a mouse or finger.

To open Windows Ink Workspace, select the application from the Windows Taskbar. Windows Ink has three distinct features: Sticky Notes, Sketchpad, and Screen Sketch.

### 5.1 STICKY NOTES

Create a Sticky Note by selecting Add Note. Notes can be dragged around the screen. Select More to set change the note's size, Color, and other features. Use Sticky Note to set reminders with Cortana, doodle, or write down your next big idea.

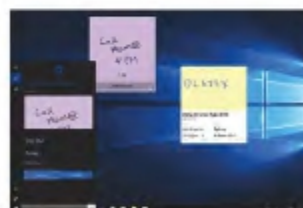

## Windows Ink (Cont'd)

---

Cortana makes Sticky Note even more useful. With Insights, add reminders to your Sticky Note for Cortana to store and track. Whether you're checking a flight or need to call mom, Cortana will track your itinerary and keeps addresses, phone numbers, and other information on-hand. NOTE: If text does not turn blue, your Insights feature may be turned off. You will need to enable Insights on the Sticky Note settings to activate the reminder feature. (More > Settings)

### 5.2 SKETCHPAD

Write sticky notes, make sketches, and draw on screenshots in Windows Ink Workspace.



Sketchpad is a blank slate for you to sketch, draw, and color whatever you want. Choose your writing instrument (pencil, ballpoint pen, highlighter) and use stencils (ruler, protractor) to guide your lines. Change the size of your brush mid-stroke, and erase hiccups with a variety of sized erasers. Save, copy, and share your finished products.

### 5.3 SCREEN SKETCH

Use Screen Sketch to draw on whatever you're doing on your PC at the moment, or to sketch on a previous screen sketch capture. Screen Sketch puts all of the Sketchpad tools at your disposal when drawing on screenshots.



### 6.0 USING THE SMART STYLUS

Press the "Eraser" or "Alt" button to wake up the smart stylus.

### 6.1 PARTS OF THE SMART STYLUS

1. Tip
2. Smart Stylus Hood
3. Eraser Button
4. Alt Button (Mouse Right + Click)
5. Clip
6. Battery Compartment
7. AAAA Battery
8. Use Stylus Replacement Tool to remove/replace Tip



**RECOMMENDED:** Keep the unused tips in the foam portion of the package.

### 6.2 REPLACING THE TIP

The Smart Stylus comes with 2 types of tips, soft and hard. They can be removed and replaced by using the included Tip Replacement Tool as follows:

1. With the Tip Replacement Tool in one hand, and the stylus in another, bring the Tool over the tip of the stylus.
2. Pinch the tool closed around the Tip, and slowly pull the Tip out of the body of the stylus.
3. To place a new tip, use the Tip Replacement Tool to remove a tip from the packaging. With the pointed end of the Tip pinched in the Tool, slide the new Tip into the stylus until the neck of the Tip is not visible.



#### **WARNING: Choking Hazard**

This device may contain small parts which may be a choking hazard to children under 3. Keep small parts away from children.

### 6.3 PACKAGE CONTENTS

1. Smart Stylus
2. AAAA Battery
3. Soft Tips
4. Hard Tips
5. Tip Replacement Tool

Voltage: 1.5V  
Current: 0.88mA  
Power: 1.32mW  
Working: 44kHz  
Frequency: 18kHz

**NOTE:** One of the tips is installed in the Smart Stylus.

### 6.4 INSTALL THE BATTERY

1. Unscrew the top of the stylus by turning it counter-clockwise.
2. Insert one battery, positive (+) side down, into the battery compartment.
3. Replace the stylus top by screwing back on clockwise.





## Specifications

System Standard Configuration		
Product Form	Form Factor	Detachable 2- in -1
	Dimensions	198.57*114.3*19.26mm
	Weight	1.4KG ( Keyboard included)
LCD	Screen Size	11.6
	Screen Resolution	1920*1080 FHD IPS
TP	Touch Module	Capacitive panel, multi-point touch, G+G (Optional)
Battery	Type	Lithium-ion polymer battery 3.8V
	Capacity	8000mAh
	Working Time	6-8 hours
System Hardware Configuration		
CPU	Type	Cherry Trail Z8350
	Speed	1.44GHz-1.92GHz
GPU	Type	Intel HD Graphics 400
Memory	Capacity	LPDDR3 2GB
Storage	Capacity	eMMC 32GB
Camera	Front	2M
	Rear	2M
Speaker	Built-in	Built-in stereo speakers 6R/0.8W*2
G-Sensor	Built-in	G-sensor 3 axis
Network Connections		
WIFI	WIFI Module	RTL8723BS 802.11b/g/n
3G/LTE	Built-in	Optional
Bluetooth	BT Module	Bluetooth 4.0
Ethernet Network	External Dongle	N/A
Interface		
Memory Card Slot	External Memory	1x Micro SD card up to 64GB
DC Jack	DC Output	Support*1
USB Interface	Support Data Transfer	Support Micro USB*1
Headphone Jack	MUSIC Output	3.5mm standard headphone jack
HDMI Interface	Video Output	Support Micro HDMI*1
Keyboard	Input Device	Support Hard Keyboard
Main Accessories		
Adapter	Standard Configuration	5V/3A
Main Accessories		
OS	Windows	Windows 10 Home

**FCC Caution:** Any changes or modifications not expressly approved by the party responsible for compliance could void the user's authority to operate this equipment. This device complies with Part 15 of the FCC Rules. Operation is subject to the following two conditions:

- (1) This device may not cause harmful interference, and
- (2) this device must accept any interference received, including interference that may cause undesired operation.

This device and its antenna(s) must not be co-located or operating in conjunction with any other antenna or transmitter.

FCC RF Exposure Information and Statement the SAR limit of USA (FCC) is 1.6 W/kg averaged over one gram of tissue. Device DTTAB2in1-116-1 (FCC ID: 2ACPR-DTTAB-116-1) has been tested against this SAR limit. SAR information on this can be viewed on-line at <http://www.fcc.gov/oet/ea/fccid/>. Please use the device FCC ID number for search.

The highest reported SAR for body-worn accessory is 0.974 W/kg

This device was tested for typical operations 0mm from the body. To maintain compliance with FCC RF exposure requirements, 0mm separation distance should be maintained to the user's bodies

**NOTE:**

This equipment has been tested and found to comply with the limits for a Class B digital device, pursuant to Part 15 of the FCC Rules.

These limits are designed to provide reasonable protection against harmful interference in a residential installation. This equipment generates, uses and can radiate radio frequency energy and, if not installed and used in accordance with the instructions, may cause harmful interference to radio communications.

However, there is no guarantee that interference will not occur in a particular installation.

If this equipment does cause harmful interference to radio or television reception, which can be determined by turning the equipment off and on, the user is encouraged to try to correct the interference by one or more of the following measures:

- Reorient or relocate the receiving antenna.
- Increase the separation between the equipment and receiver.
- Connect the equipment into an outlet on a circuit different from that to which the receiver is connected.
- Consult the dealer or an experienced radio/TV technician for help.

FCC ID: 2ACPR-DTTAB-116-1

