



**EV-C-101-1-BK**

**EV-C-101-1-BL**

**EV-C-101-1-PK**

## **USER GUIDE**

**10.1" Ultra Thin Laptop**



Review this manual before operating your EVOO laptop  
and keep it for future reference.

# Introduction and Table of Contents

---

<b>TABLE OF CONTENTS</b>	<b>Page</b>
1.0 Introduction.....	1
1.1 Overview .....	2
2.0 Appearance and Buttons.....	3
2.1 Introduction to Desktop.....	4
2.2 Windows Start Menu .....	4
2.3 Introduction to App Interface .....	4
3.0 Basic Operations.....	6
3.1 Sleep, Restart and Shut Down .....	6
3.2 Recovery.....	6
3.3 Bluetooth.....	7
3.4 Security Management .....	8
4.0 Specifications.....	9

## **1.0 INTRODUCTION**

This User Manual is designed to guide you through the key functions and features of your new Notebook. Please read carefully to ensure an optimal user experience and keep it handy for future reference.

### **NOTE:**

To change from English language prompts to Spanish language prompts, please go to “Control Panel,” then to “Clock, Language and Region,” and then to “Language” to change from English to Spanish.

# Overview and Notes

---

## 1.1 OVERVIEW

The new EVOO 10.1” Ultra Thin Laptop (EV-C-101-1) features Windows 10 Home, 1280 x 800p resolution and boasts a Intel® Cherry Trail® Z8350. With the Notebook you can access the web, news, local business information and the Windows Store, where you can download your favorite apps, games, movies and more! With the built-in Bluetooth function you can seamlessly pair your Notebook with any Bluetooth compatible devices.

## NOTES

- The Notebook is a high-density electronic product. DO NOT attempt to disassemble the device.
- Please do not drop or bang the device.
- Avoid using this product in the following environments: Extremely hot or cold places, high humidity, dusty areas, direct sunlight or long-term exposure to the sun.
- The product may be cleaned with a damp cotton cloth; the use of any chemical cleaning fluid is prohibited. Please keep the product away from water at all times.
- If you use headphones, DO NOT use them while crossing the street, riding a bicycle or driving a motorcycle.
- Please use approved battery, battery charger and accessories only. The use of any other type of products would be a breach of warranty and may be dangerous.
- If you have any questions regarding the use of this product, please contact your local dealer or contact EVOO customer service center directly at [customerservice@evooproducts.com](mailto:customerservice@evooproducts.com) or call (888) 999-1682.
- EVOO will not be held responsible for any files lost due to product damage, repair or other causes. Please be sure to follow instructions in the User Guide and backup your files in a timely manner.

# Appearance and Buttons

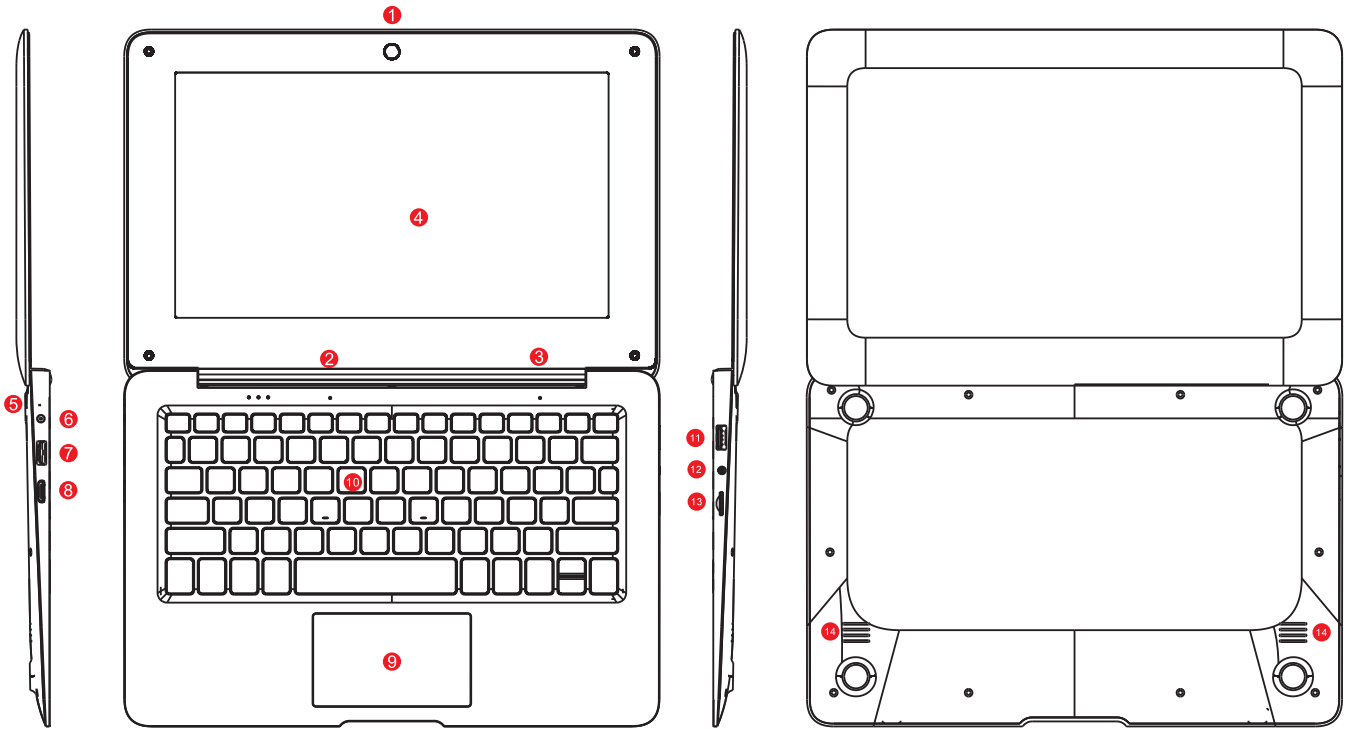

- ① Camera
- ② Microphone
- ③ Microphone
- ④ Screen
- ⑤ Charge Light
- ⑥ DC IN
- ⑦ USB 3.0
- ⑧ Mini HDMI



- ⑨ Touchpad
- ⑩ Keyboard
- ⑪ USB 2.0
- ⑫ AUX Input
- ⑬ TF card
- ⑭ Speaker

# Introduction to Desktop

## 2.1 INTRODUCTION TO THE DESKTOP

You must log on to your Microsoft account before the start up application can run.

## 2.2 WINDOWS START MENU

Press the key  on the keyboard or click the icon  on the screen until you see the Start Menu. All applications/programs are displayed in the form of “magnets” listed on the screen. Click on any of the icons to open.



## 2.3 INTRODUCTION TO APP INTERFACE

If you want to pin more application programs on the Start interface, press and hold the application program for about one second, and release the magnet until the pop-up option appears and select “Pin to Start” to fix to the start screen, or just press and move to the start screen. (Screen 1).

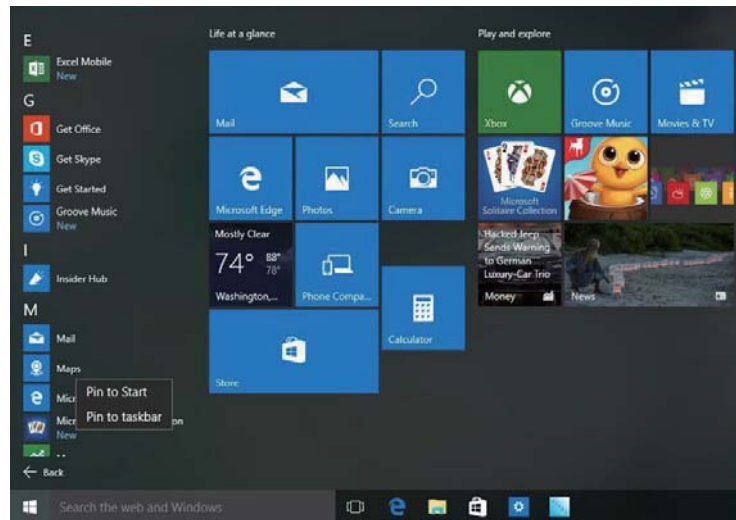

# Introduction to Desktop (Cont'd)

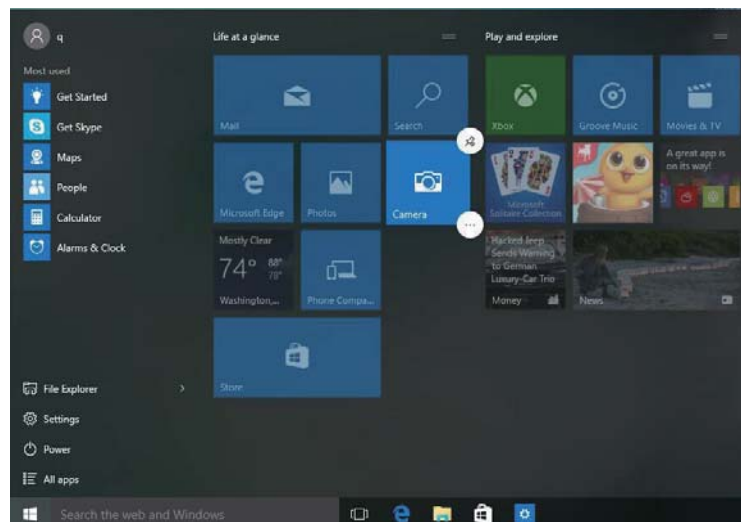

(Screen 1)



(Screen 2)

Conversely, if you want to cancel or delete a certain application in the Start screen, press and hold the application program magnet for about one second and click . You can also click  to check more menu options, such as resizing the magnet you want. (Screen 2) Slide it to the left from the right side of the screen to start Action Center to check the laptop status: Rotation lock, Bluetooth, Brightness, etc.

# Basic Operations

## 3.0 BASIC OPERATIONS

### 3.1 Sleep, Restart and Shutdown

#### Force Reset / Shutdown

If the laptop freezes, you can press and hold the Power button for 8~12 seconds, then the laptop will shutdown.



## 3.2 RECOVERY

Follow the steps below

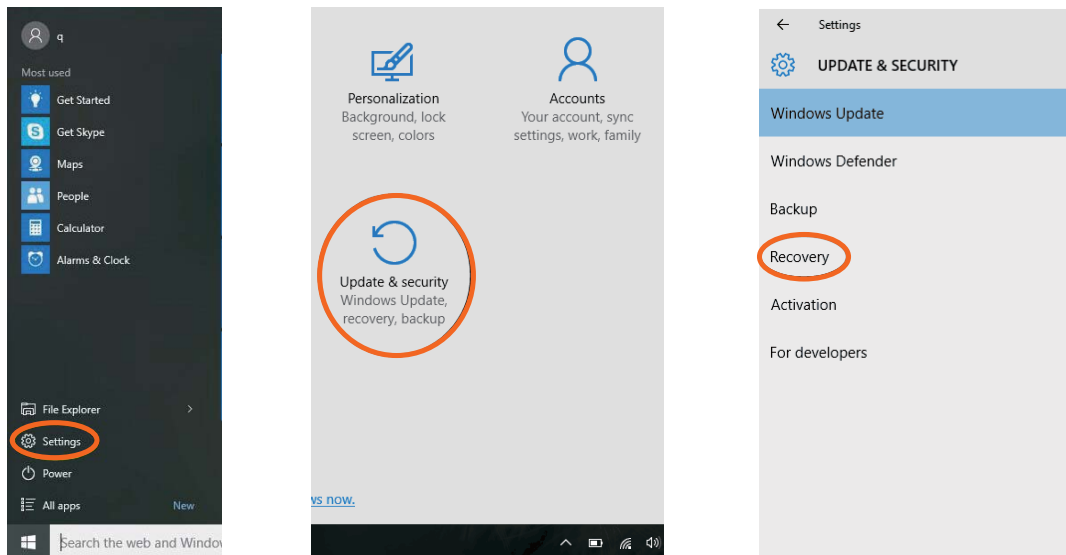

Click the  button in the lower left corner of screen and select **“Settings”** then select **“Update & Security”**, click on **“Recovery”**. The program will walk you through simple steps necessary to recover your system.







# Basic Operations (Cont'd)

## 3.3 BLUETOOTH

- Click the  button in the lower left corner of screen.
  - Select **“Settings”**
  - Select **“Devices”**, click on **“Bluetooth”**.
- a) Make sure the Bluetooth switch is set to **“On”**  
After you turn on Bluetooth, the Notebook will auto-search other devices you can pair with your device.

### Send or Receive Files via Bluetooth

- b) Send a File: Before sending files, you should open the window, "Select where to send your files": Click the icon  at lower right corner of desktop -  - Send a File.
- c) Receive a File: Before receiving the files, you should open the window "Waiting for a connection": Click the icon  at lower right corner of desktop -  - Receive a File.

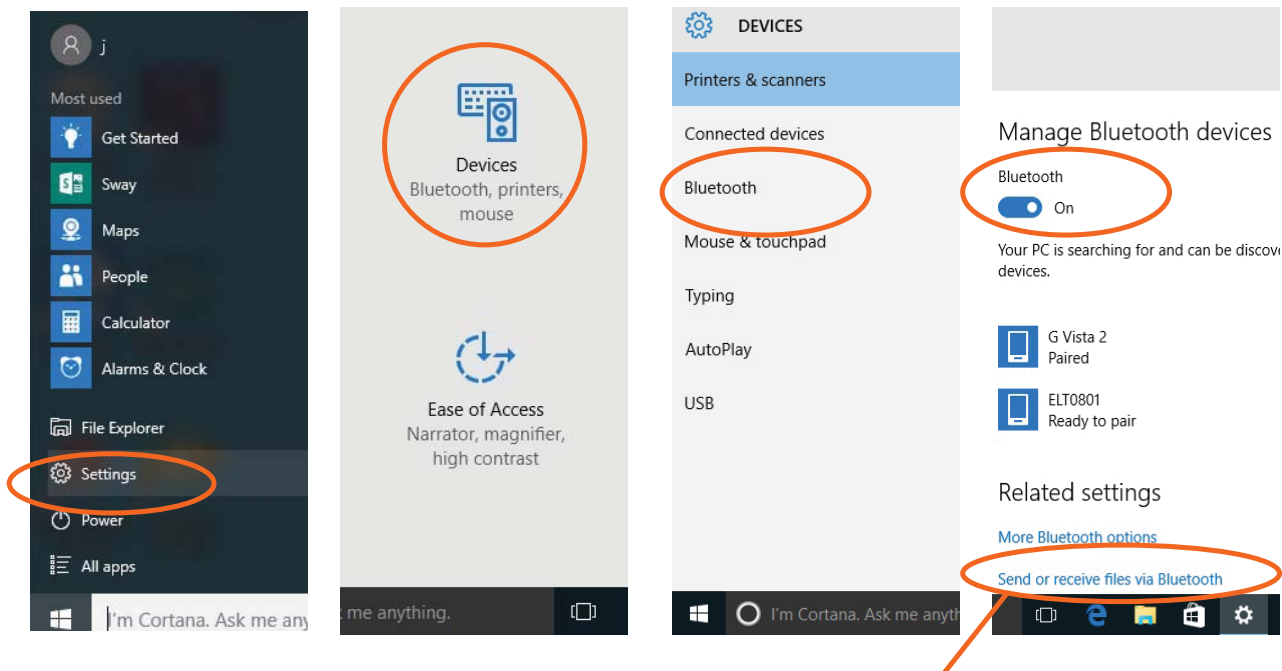

### Send or Receive Files via Bluetooth





# Basic Operations (Cont'd)

## 3.4 SECURITY MANAGEMENT

Method for quick setup:

Click the  button in the lower left corner of screen and select “Settings”.

Select “Accounts” on the right and click “Create local account” in “Your account” on the right side. After creating a user name and a password for Windows Live ID Account, input username, password, confirm password and password prompt.

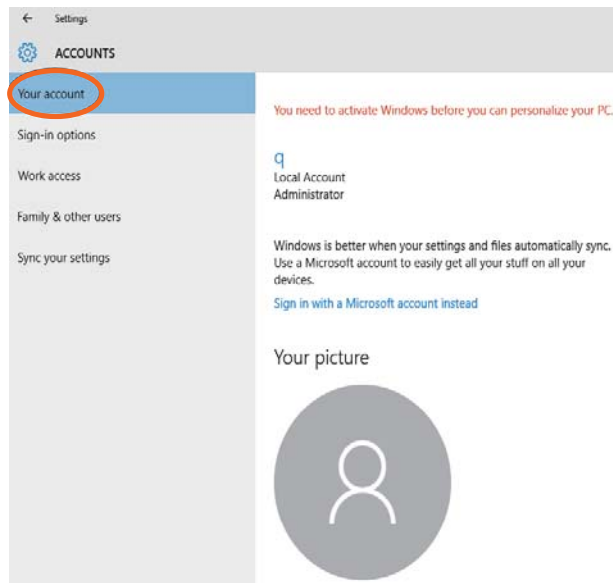
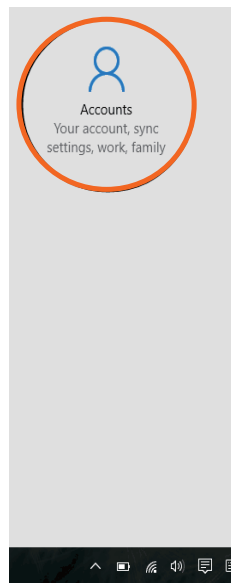
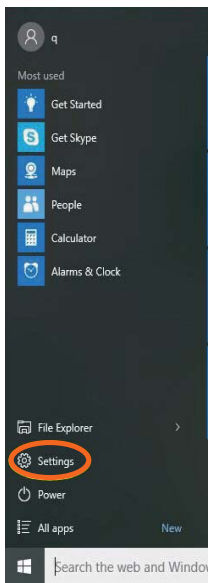

# Specifications

System Standard Configuration		
<b>Product Form</b>	Form Factor	Ultra Thin Laptop
	Dimensions	278.0*185.6*18.0mm
<b>LCD</b>	Screen Size	10.1"
	Screen Resolution	1280*800 IPS
<b>Battery</b>	Type	Lithium-ion polymer battery 3.7.v
	Capacity	5600mAh
	Working Time	Up to 6 hours
System Hardware Configuration		
<b>CPU</b>	Type	Cherry Trail Z8350
	Speed	1.44GHz-1.92GHz
<b>GPU</b>	Type	Intel HD Graphics 400
<b>Memory</b>	Capacity	LPDDR3 2GB
<b>Storage</b>	Capacity	32GB
<b>Camera</b>	Front	0.3M
<b>Speaker</b>	Built-in	stereo speakers 8R/1.0Wx2
Network Connections		
<b>WIFI</b>	Module	802.11b/g/n
<b>Bluetooth</b>	Module	Bluetooth 4.0
<b>Ethernet Network</b>	External Dongle	Supportive
Interface		
<b>Memory Card Slot</b>	External Memory	1x Micro SD card up to 64GB
<b>USB Interface</b>	Support Data Transfer	USB 3.0(x1) USB 2.0(x1)
<b>Headphone Jack</b>	Music Output	3.5mm standard
<b>HDMI Interface</b>	Video Output	Mini HDMI X 1
Main Accessories		
<b>Adapter</b>	Standard Configuration	DC 5V/3A
Software Configuration		
<b>OS</b>	Windows	Windows10 Home
<b>Certification</b>		FCC, CEC, BQB, Pro65

#### FCC compliance statement

This device complies with part 15 of the FCC Rules. Operation is subject to the following two conditions:

- (1) This device may not cause harmful interference, and
- (2) this device must accept any interference received, including interference that may cause undesired operation.

Note: This equipment has been tested and found to comply with the limits for a Class B digital device, pursuant to part 15 of the FCC Rules. These limits are designed to provide reasonable protection against harmful interference in a residential installation. This equipment generates uses and can radiate radio frequency energy and, if not installed and used in accordance with the instructions, may cause harmful interference to radio communications. However, there is no guarantee that interference will not occur in a particular installation. If this equipment does cause harmful interference to radio or television reception, which can be determined by turning the equipment off and on, the user is encouraged to try to correct the interference by one or more of the following measures:

Reorient or relocate the receiving antenna.

Increase the separation between the equipment and receiver.

Connect the equipment to an outlet on a circuit different from that to which the receiver is connected.

Consult the dealer or an experienced radio/TV technician for help.

Important: Changes or modifications to this product not authorized by Bmorn could void the electromagnetic compatibility (EMC) and wireless compliance and negate your authority to operate the product.

This product has demonstrated EMC compliance under conditions that included the use of compliant peripheral devices and shielded cables between system components. It is important that you use compliant peripheral devices and shielded cables between system components to reduce the possibility of causing interference to radios, televisions, and other electronic devices.

SAR Statement:

This device has been tested and meets applicable limits for radio frequency (RF) exposure.

Specific Absorption Rate (SAR) refers to the rate at which the body absorbs RF energy. The SAR limit is 1.6 watts per kilogram in USA that set the limit averaged over 1 gram of tissue. This device (FCC ID: 2ACPR-EV-C-101-1) has been tested against this SAR limit. During testing, the device radios are set to their highest transmission levels and placed in positions that simulate uses against the body, with no separation, the highest SAR value reported is 0.677 W/kg. SAR information on this can be viewed on-line at

<https://www.fcc.gov/oet/ea/fccid>. Please use the device FCC ID number for search.

Cases with metal parts may change the RF performance of the device, including its compliance with RF exposure guidelines, in a manner that has not been tested or certified.

evo