

Introduction and Table of Contents

1.0 INTRODUCTION

This User Guide is designed to guide you through the key functions and features of your new Ultra Slim Laptop. Please read carefully to ensure an optimal user experience and keep it handy for future reference.

NOTE:

To change from English language prompts to Spanish language prompts, please go to “Control Panel,” then to “Clock, Language and Region,” and then to “Language” to change from English to Spanish.

1.1 TABLE OF CONTENTS

Page

1.0 Introduction.....	1
1.1 Table of Contents	2
1.2 Overview	2
2.0 Appearance and Buttons.....	3
2.1 Introduction to Desktop.....	4
2.2 Windows Start Menu	4
2.3 Introduction to App Interface	4
3.0 Basic Operations.....	6
3.1 Sleep, Restart and Shut Down	6
3.2 Recovery.....	6
3.3 Bluetooth.....	7
3.4 Security Management	8
4.0 Features	9
5.0 Warranty Information	10

Overview and Notes

1.2 OVERVIEW

10.1" windows laptop, a standard resolution screen of 1024x600 and boasts a 1.8GHz Intel Bay Trail Quad Core Processor. With the Ultra Slim Laptop you can access the web, news, local business information and the Windows Store, where you can download your favorite apps, games, movies and more! With the built-in Bluetooth function you can seamlessly pair your Ultra Slim Laptop with any Bluetooth compatible devices. You can store all your important documents, pictures and movies with its 32 GB of memory. The storage capacity can also be expanded up to **128** GB using the Micro-Card Reader slot.

NOTES

- 10.1" windows laptop, electronic product. DO NOT attempt to disassemble the device.
- Please do not drop or bang the device.
- Avoid using this product in the following environments: Extremely hot or cold places, high humidity, dusty areas, direct sunlight or long-term exposure to the sun.
- The product may be cleaned with a damp cotton cloth; the use of any chemical cleaning fluid is prohibited. Please keep the product away from water at all times.
- If you use headphones, DO NOT use them while crossing the street, riding a bicycle or driving a motorcycle.
- Please use approved battery, battery charger and accessories only. The use of any other type of products would be a breach of warranty and may be dangerous.

- Please be sure to follow instructions in the User Guide and backup your files in a timely manner.

Appearance and Buttons

2.0 APPEARANCE AND BUTTONS





1. USB Port
2. Headphone Jack
3. Micro SD Slot
4. DC Jack
5. USB Port
6. HDMI Port
7. Speaker
8. Camera
9. LCD
10. Mic
11. Touch Pad
12. Keyboard

Introduction to Desktop

2.1 INTRODUCTION TO THE DESKTOP

You must log on to your Microsoft account before the start up application can run.

2.2 WINDOWS START MENU

Press the key  on the keyboard or click the icon  on the screen until you see the Start Menu. All applications/programs are displayed in the form of “magnets” listed on the screen. Click on any of the icons to open.



2.3 INTRODUCTION TO APP INTERFACE

If you want to pin more application programs on the Start interface, press and hold the application program for about one second, and release the magnet until the pop-up option appears and select “Pin to Start” to fix to the start screen, or just press and move to the start screen. (Screen 1).

Basic Operations

3.0 BASIC OPERATIONS

3.1 Sleep, Restart and Shutdown

Force Reset / Shutdown

If the laptop freezes, you can press and hold the Power button for 8~12 seconds, then the laptop will shutdown.



3.2 RECOVERY

Follow the steps below

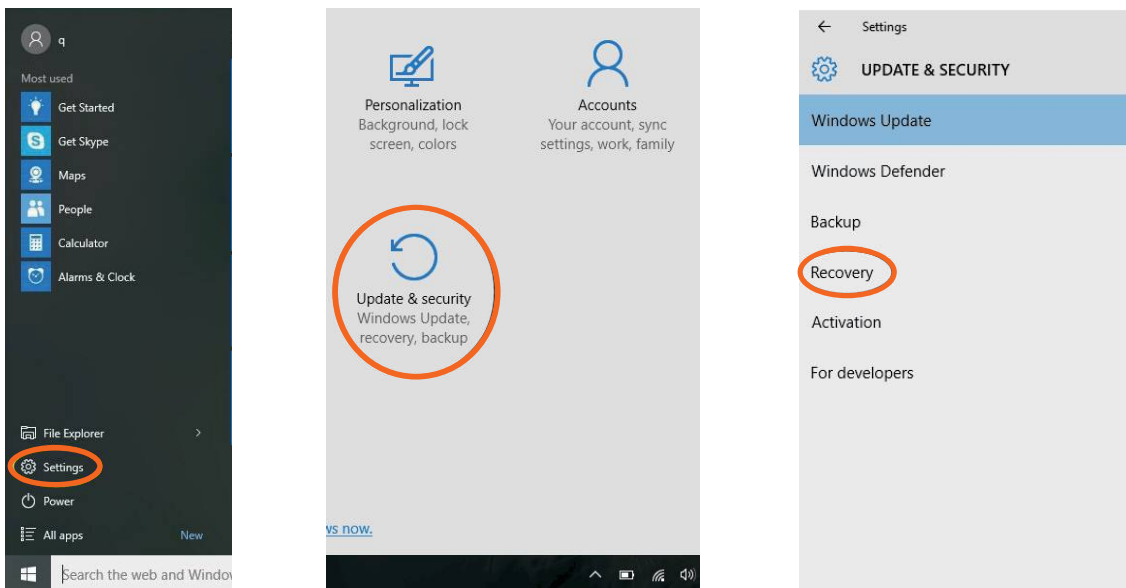

Click the  button in the lower left corner of screen and select “Settings” then select “Update & Security”, click on “Recovery”. The program will walk you through simple steps necessary to recover your system.

Basic Operations (Cont'd)





3.3 BLUETOOTH

- Click the  button in the lower left corner of screen.
- Select “**Settings**”
- Select “**Devices**”, click on “**Bluetooth**”.

a) Make sure the Bluetooth switch is set to “**On**”

After you turn on Bluetooth, the laptop will auto-search other devices you can pair with your device.

Send or Receive Files via Bluetooth

- b) Send a File: Before sending files, you should open the window, "Select where to send your files": Click the icon  at lower right corner of desktop -  - Send a File.
- c) Receive a File: Before receiving the files, you should open the window "Waiting for a connection": Click the icon  at lower right corner of desktop -  - Receive a File.

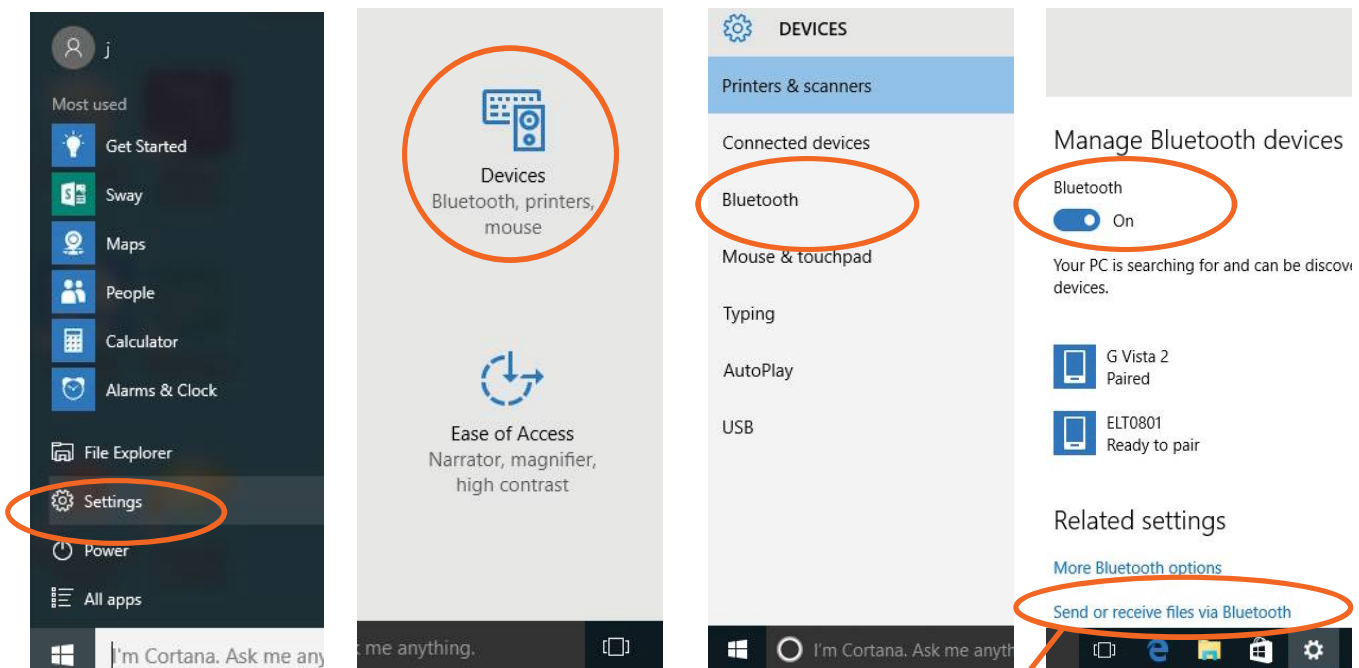

Send or Receive Files via Bluetooth



Basic Operations (Cont'd)

3.4 SECURITY MANAGEMENT

Method for quick setup:

Click the  button in the lower left corner of screen and select “Settings”.

Select “Accounts” on the right and click “Create local account” in “Your account” on the right side. After creating a user name and a password for Windows Live ID Account, input username, password, confirm password and password prompt.

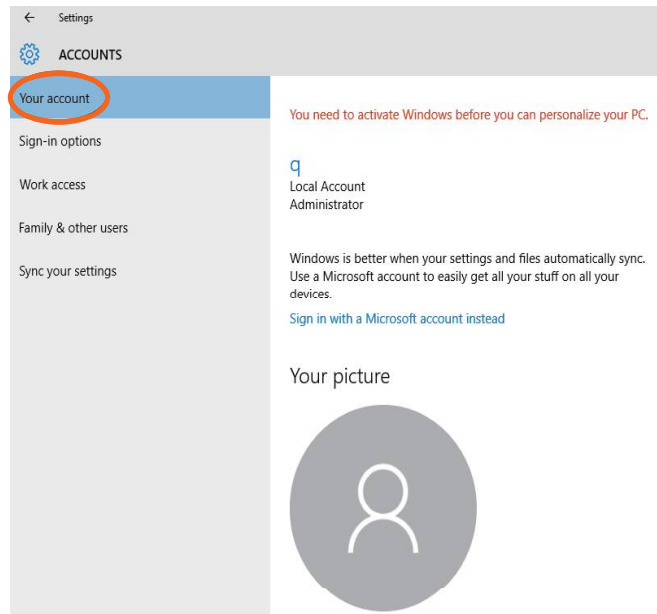
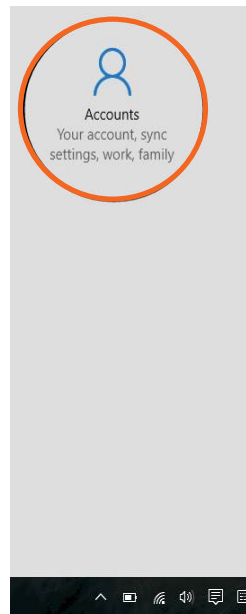
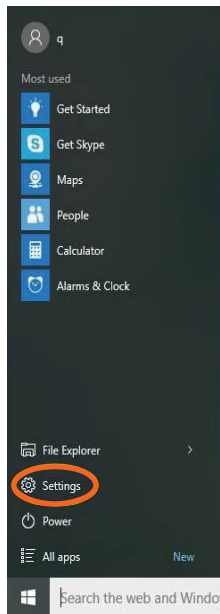

Features

4.0 FEATURES

- Screen Size 10.1"
- Resolution 1024 x 600
- Panel Type TN
- Design Clamshell
- Operating System Windows 10
- Processor Intel Bay Trail
- Processor Quad Core
- Processor 1.8 GHz
- Storage 32GB
- Memory (RAM) 2GB
- Expansion Slot Micro SD
- Front camera 0.3MP
- Rear camera n/a
- Battery 5600 mAH Lithium - – UP TO 6 HOURS
- micro USB n/a
- HDMI 1 x micro
- USB 2.0 2

Items are included in your package:

- * Laptop
- * Power Adapter
- * User Manual

This device complies with Part 15 of the FCC Rules. Operation is subject to the following two conditions: (1) This device may not cause harmful interference, and (2) this device must accept any interference received, including interference that may cause undesired operation.

This equipment has been tested and found to comply with the limits for a Class B digital device, pursuant to Part 15 of the FCC Rules. These limits are designed to provide reasonable protection against harmful interference in a residential installation. This equipment generates, uses and can radiate radio frequency energy and, if not installed and used in accordance with the instructions, may cause harmful interference to radio communications. However, there is no guarantee that interference will not occur in a particular installation. If this equipment does cause harmful interference to radio or television

reception, which can be determined by turning the equipment off and on, the user is encouraged to try to correct the interference by one of the following measures:

- Reorient or relocate the receiving antenna.
- Increase the separation between the equipment and receiver.
- Connect the equipment into an outlet on a circuit different from that
to which the receiver is connected.
- Consult the dealer or an experienced radio/TV technician for help.

FCC Caution:

- Any changes or modifications not expressly approved by the party responsible for compliance could void the user's authority to operate this equipment.
- This transmitter must not be co-located or operating in conjunction with any other antenna or transmitter.

Radiation Exposure Statement:

This device meets the government's requirements for exposure to radio waves.

This device is designed and manufactured not to exceed the emission limits for exposure to radio frequency (RF) energy set by the Federal Communications Commission of the U.S. Government.

The exposure standard for wireless device employs a unit of measurement known as the Specific Absorption Rate, or SAR. The SAR limit set by the FCC is 0.86W/kg. *Tests for SAR are conducted using standard operating positions accepted by the FCC with the device transmitting at its highest certified power level in all tested frequency bands.