

EVERLOCK

User's manual

BDS-212K

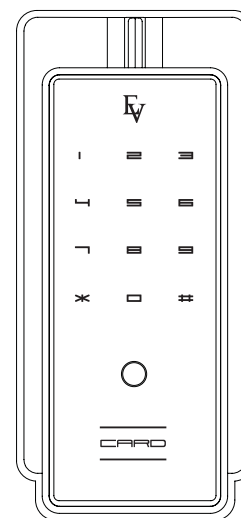

- ▶ A touch sensor type of ultra-slim and noble design
- ▶ The RF function(ISO 14443A, 13.56MHz Type) allows you to register various types of cards
- ▶ Fire detection alarm sounds and automatic release of the locking device
- ▶ Automatic locking function
- ▶ Antitheft and double locking
- ▶ Override emergency cylinder keys

Warning : In case of emergency, you should be fully aware of the method for using the manual shutting device.

Please, get a copy of product warranty from the installer.

If the product warranty is not clearly specified, then you may be exposed to some disadvantages in case of needs for A/S.

※ This product's performance and design are subject to change without prior notice for the purpose of quality improvement.

Summary of the methods for using the product

Functions	How to operate it			Remarks
	Entering the menu	Detailed procedures	Ending the menu	
General function				
Register card	[SET]	Touch the card sensor + Card 1 + Card 2		You can register up to twenty(20)
Delete card	If you re-register it, the existing cards information will be deleted.			
Register password	[SET]	Password + #		
Open the door from the outside	Touch the numerical pad + password + #			Using password
	Touch the card sensor + Card contact			Using RF card
Mandatory functions				
Battery low alarm	“For elise” will be played when opening or closing the door.			
Impulsive intrusion alarm function	Alarm sounds will be on for two(2) minutes in case of impulsive intrusion or damaged systems.			
Forced locking of the system	If you enter wrong password or card information for five time, the system will be halted for three minutes.			
Additional functions, very useful for you				
Initialization	Press [SET] for 3 seconds	123 + #	—	
Setting the induction number of digits for conceal the password.	Press [SET] for 3 seconds	* + Select one number from 1 to 5 + #	—	
Volume control	Press [SET] for 3 seconds	Select one number from 0 to 2 + #	—	
Automatic / manual locking	Press [SET] for 3 seconds	7 + # 9 + #		Automatic locking mode Manual locking mode
Antitheft function setting	Press # for 3 seconds	Password + #	—	Using password
	Press # for 3 seconds	Touch the card sensor + card contact	—	Using RF card
Double locking	Shifts the internal double locking switch to locked mode. (show red color)			

■ Table of contents

1. Cautions for use	4
2. Product features	6
3. Product specifications and components	7
4. Name of each part	8
5. Using the general function	9
1) Register card 2) Register and change password 3) Open the door from the outside using password	
4) Open the door from the outside using a card 5) Open the door from the inside	
6. Mandatory functions of the equipment	13
1) Replace batteries 2) How to use the emergency battery 3) Intrusion/damage alarm function	
4) Fire detection function 5) Forced locking of the system 6) How to do when lost a registered card	
7. Additional information useful for you	16
1) Auto/manual locking setting 2) Anti-theft function (Outdoor forced locking)	
3) Double locking function (Indoor forced locking) 4) Volume control	
5) Setting the induction number of digits for conceal the password 6) Initialization	
8. Contact us	21

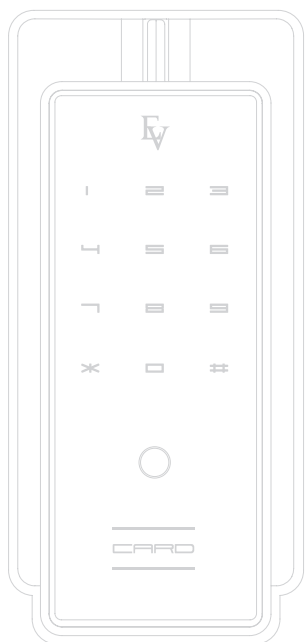

1. Cautions for use

- ▶ Get a copy of product warranty with accurate specifications from the installer.
- ▶ Please, ask the installer to teach you how to use the product.
- ▶ Be fully familiarized with the main functions.
- ▶ This product is designed to maintain its locking condition despite 30,000V electrical shocks.

This information aims to maintain the safety of our users and prevent any damages on property or inconvenience. Read it carefully for your correct use of the product.



Warning

If this sign is violated, a user may experience severe injury or even die.



Caution

If this sign is violated, it may cause injury to the user or property damages.



Attention

This sign asks for you to pay attention.



Prohibited

This sign signifies prohibited actions.

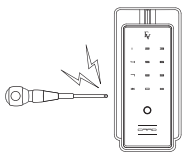

Do not disassemble the product.

This product's inner area is designed in a precise and complex way. Do not disassemble it on your own. It may lead to serious malfunctions.

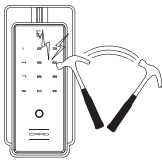

Do not apply impacts to it.

It may cause malfunctions or defective operation.

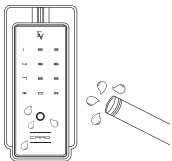

Do not spray water to the product. Do not install it in a humid place.

Everlock is not either water or vibration free. It may cause malfunctions due to short-circuits in the product.

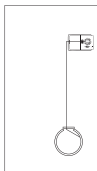

If the door has a hole for milk delivery or any other type of hole, then please block it completely

It is possible to manipulate the door lock through the hole and to make illegal entry.

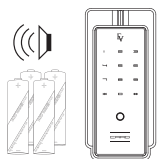

- **Do not forget to replace the battery when necessary.**

When the low battery alarm or display is on, then please replace it with a new one within one week after that.

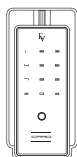

New
installation

- **If you move to another address and require new installation, please contact your installer.**

(Additional costs may accrue for new installation)

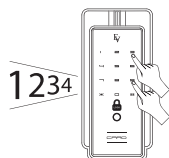

- **Please, pay close attention to your password at all times.**

Your password must set and changed periodically.

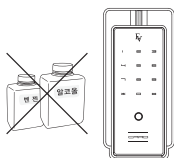

- **Do not use water, benzene or alcohol to clean the product.**

It may lead to malfunctions of the electronic product. You are advised to wipe it off gently with a dry cloth.

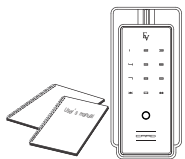

- **You must read the user' s manual carefully to operate the product properly.**

Otherwise, it may lead to malfunctions or poor performance.

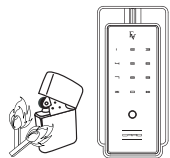

- **Do not approach flammable substance such as a lighter to the product.**

It may lead to malfunctions or poor performance.

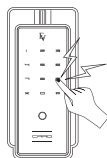

- **Do not press the button too hard or apply excessive forces to manipulate the equipment.**

It may lead to malfunctions.

2. Product features

▶ A touch sensor type of ultra-slim and noble design

It does not require you any motion as to lift up the product's cover. To open the door, just gently touch the pad. After authenticating your password, you are required to enter additional numbers in this secure system preventing illegal leakages of password.

▶ Can support operational modes suitable for various users environments

You may set the desirable operation mode for your environment whether it is a general household, business site or security area strictly prohibiting illegal entry.

▶ You can register various types of cards as RF function card(ISO 14443A Type).

If your card has the RF function(ISO 14443A type), then you can register it as your card to use the system.

▶ Fire detection alarm sounds and automatic release of the locking device

It includes the fire detection alarm function. If heat above 60 degrees Celsius is detected, then the alarm sound will be generated and the doorlock will automatically release the locking function.

▶ Automatic locking function

It is automatically locked after you close the door. You will never leave your home without locking the door.

▶ Antitheft and double locking

"If you set the double locking function when you are inside, then no one can open the door from the outside. To the contrary, if you set the antitheft function from the outside, an alarm sound will occur as they open the door from the inside."

▶ Audio volume control

In consideration of inconvenience with noises generated when Everlock is used, we allow you to freely select the desirable audio volume.

▶ Override emergency cylinder keys

User can use an override cylinder keys in case of a circuit trouble.

3. Product specifications and components

(1) Product specifications

Classifications	Specifications		Remarks
Sizes	Inner device (mm)	90(W) × 157(H) × 37(D)	
	Outer device (mm)	70(W) × 150(H) × 19(D)	
Material	Inner device	Aluminum, Zinc, ABS	
	Outer device	Aluminum die casting	
Temperature of use	-20 ~ 55°C		
Voltage of use	Rated voltage 6V(4 units of 1.5V AA type alkaline batteries)		If used 10 times/day, then it can last for one year

※ The battery's life cycle may vary depending on temperatures, humidity, the number of use and the quality of the battery itself.

(2) Components

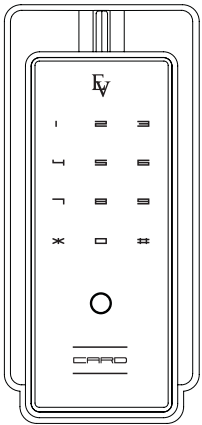

▶ Outer device

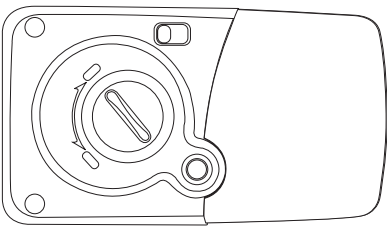

▶ Inner device



▶ RF cards (Four units)



▶ User's manual
(including the product warranty)
and installation diagram

▶ 4 units of AA batteries

▶ Screw envelopes

▶ Latch

▶ 2 units of emergency keys

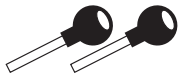

4. Name of each part

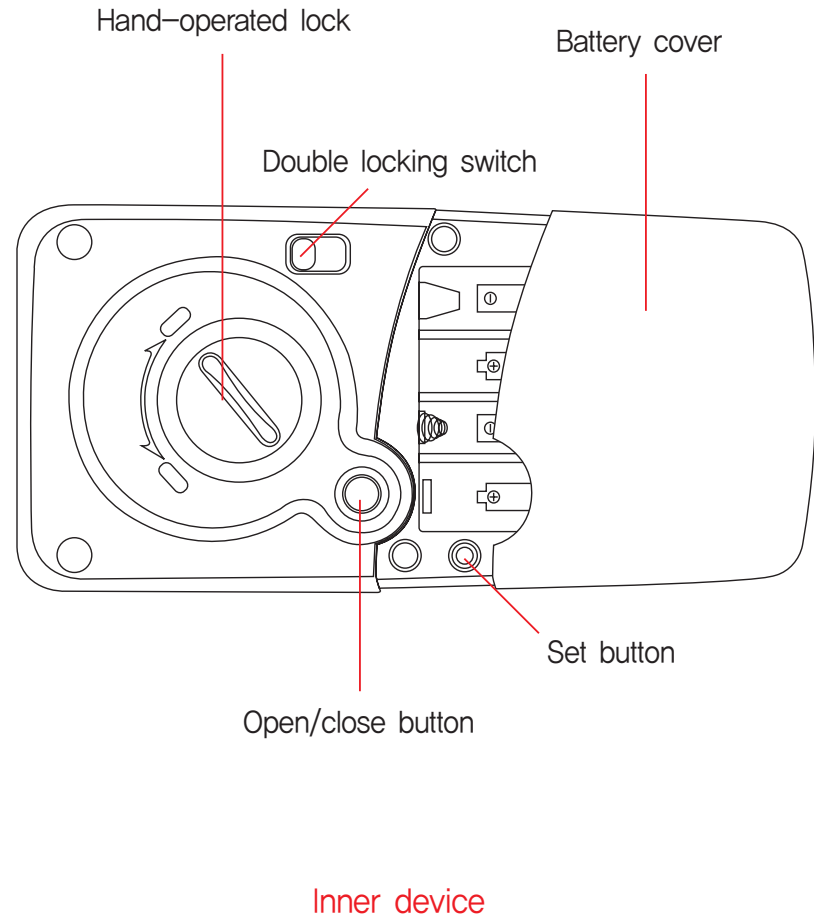
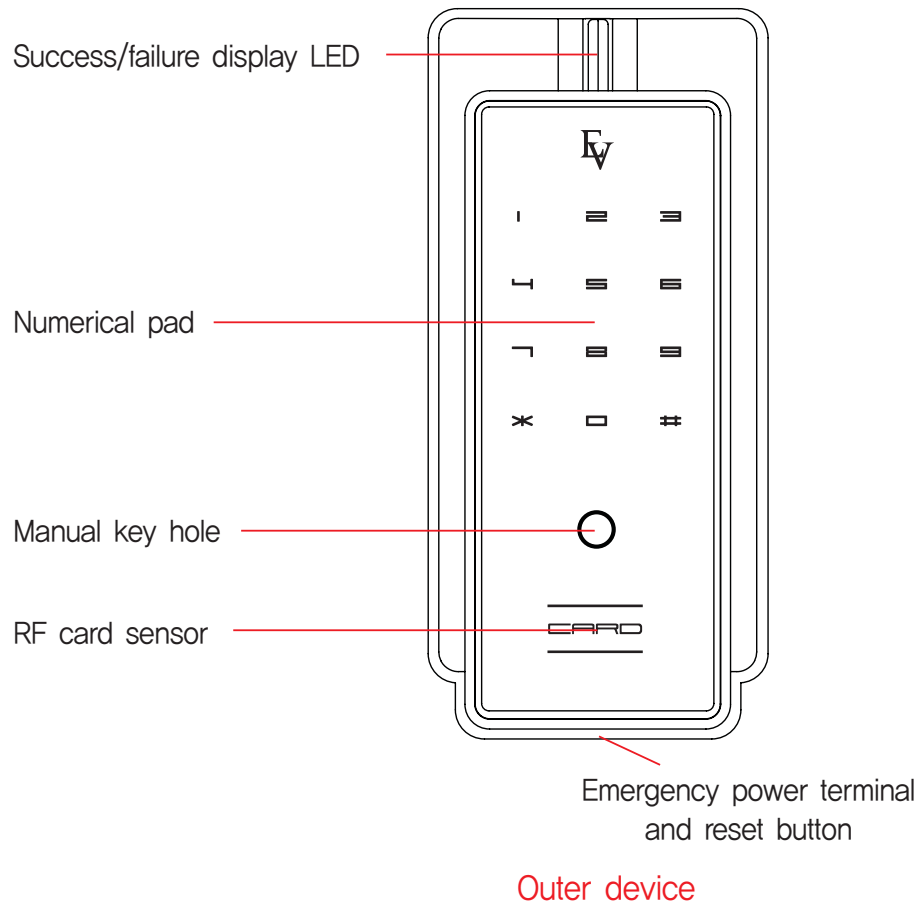

5. Using the general function

1) Register card

Other than the cards provided for you, you can register and use credit cards with the RF function(only the ISO 14443A, 13.56MHz Type can be used).



Caution

- ▶ When registering a card or checking registration, the door may get closed accidentally. Please, make sure to completely open the door before proceeding.
- ▶ When you register your cards, all the previously registered cards will be deleted from the list. So, please, make sure to register all the cards again if you want to use them.

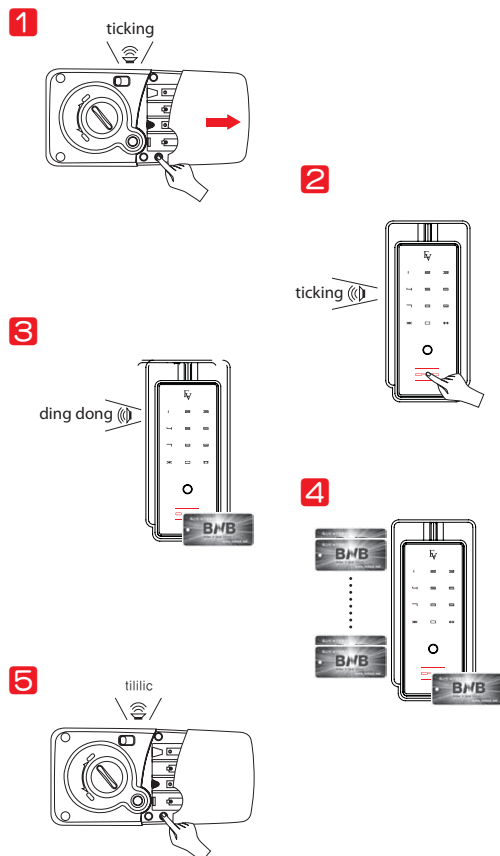

- (1) Press the [SET] button(inner device) : Enter registration mode.
Open the battery cover of inner device, and press the [SET] button. Then, you will hear the 'ticking' sound and the numerical pad and the card sensor's lamp will be illuminated.
- (2) Touch the card sensor(outdoor)
As you touch the card sensor located on the outer device, you will hear the 'ticking' sound and the card sensor's lamp will be on.
- (3) Card contact (outdoor)
As you place the card which should be registered near the card sensor on the outer device, you will hear the 'ding dong' sound and registration will be completed.
- (4) Place contact all other cards near the sensor
All the cards to be registered should be placed near the card sensor one by one as shown in 3.
※ You can register up to twenty(20) cards.
※ If the card contact time is more than seven seconds, then only the previously registered cards will be stored and the registration mode will be finished.
- (5) Press the [SET] button(inner device) : Registration mode is over.
After registering all the cards, press the [SET] button and then you will hear the "tillic" sound and the registration mode will be over.
※ If you have registered your twentieth card, then you will hear the "tillic" sound and the registration mode will be over.

2) Register or change password

You can use 4 to 12 digits in your password.



Caution

1. When registering password or changing it, the door may get closed accidentally. Please, make sure to completely open the door before proceeding.
2. The default factory setting for the password is "1234" and for your safety, please, change it before using it.

1

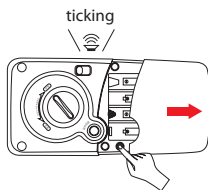

2

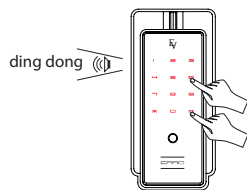

- (1) Press the [SET] button(inner device) : Enter registration mode.

Open the battery cover of inner device, and press the [SET] button. Then, you will hear the 'ticking' sound and the numerical pad and the card sensor's lamp will be illuminated.

- (2) Enter the new password(outdoor)

After entering the new password(4 to 12 digits), touch the "#" button. You will hear the "ding dong" sound and your registration of password will be completed.

3) Open the door from the outside using password

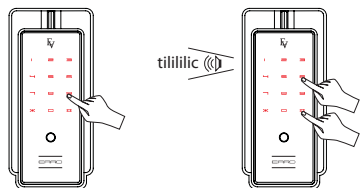

● Enter password

If you touch any button on the numerical pad, it will be illuminated. At this moment, you can enter your password and touch the “#” button. You will hear the “tillilic” sound and the locking condition will be released and you are required to touch additional numbers.



Caution

► If you enter unregistered passwords for five(5) times in a row, the system will enter the locking mode and will be halted for three(3) minutes.

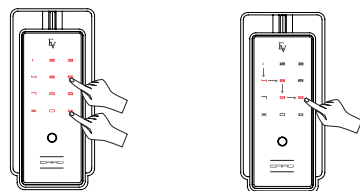

● Enter additional numbers

After you have entered registered password and touch the “#” button, arbitrary numbers(1 to 5 digits) will be illuminated in order. Each time the lamp is on, touch the numbers.

※ The default factory setting does not include the above function.

Reference

► The number of digits illuminated in order can be set by the user.
(Refer to page 19 for setting the number of digits for your guidance.)

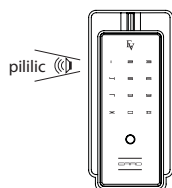

● Open the door and get inside

After you have successfully entered additional numbers, you will hear the ‘pililic’ sound and the locking condition will be released. Now, you can open the door.

4) Open the door from the outside using a RF card

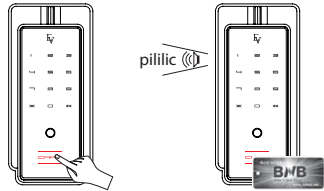

- As you touch the card sensor, it will be illuminated. At that moment, place a registered card near the sensor. You will hear the 'pililic' sound and now you can open the door.
- ※ If you touch the card sensor when no card has been yet registered, you will hear the 'pik pik' sound which warns you.



Caution

- ▶ If you use unregistered cards for five(5) times in a row, the system will enter the locking mode and will be halted for three(3) minutes.

5) Open the door from the inside

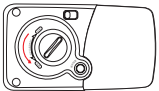

- **Open the door electronically.**
Press the [OPEN/CLOSE] button on the main body located on the inner device. You will hear the 'pililic' sound and now you can get out.
- **Open the door manually.**
Turn the manual switch to the 'open' direction. Then, the locking condition will be released and now you can get out.
- ※ Caution : You must be fully aware of the method for manually opening the door. In addition, let other members of your house or organization to know how to use it.

6. Mandatory functions of the equipment

※ These are the main functions that users should be fully aware of. If you are not, then it may cause injuries or damages your property.

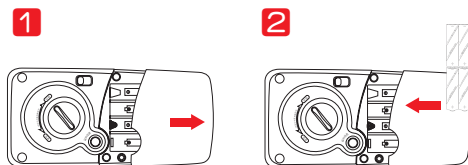

1) Replace exhausted battery

If you hear the 'for elise' tune when you open or close the door using password or cards, then it means that the battery should be replaced.



Caution

- ▶ Within one week after you hear the warning sound, you should replace all the four batteries with new ones.
- ▶ If you keep using the equipment without replacing the batteries, it will stop working.

(1) Open the cover of the main body located inside

After gently pressing the side of the battery cover, pull out the cover to the front.

(2) Replace the battery

After replacing the batteries, please carefully check whether you hear the 'tillic' sound.



Caution

- ▶ Do not reverse the polarities of the batteries. The door lock may not work properly.
- ▶ If there is liquid coming out of the battery, then it may damage the product. Check your battery periodically (once every six month).

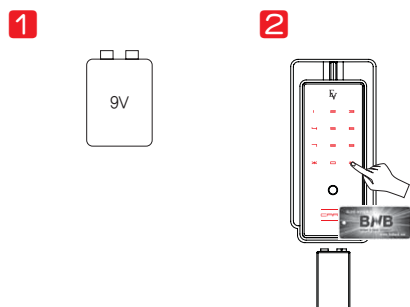

2) How to use the emergency battery

If your battery is exhausted and thus the door does not open, then you may use the emergency battery to open the door.

(1) Prepare a rectangular 9V battery for emergency

(2) Open the door using an emergency battery

Contact the external power supply terminal on the outside with your 9V battery. Meanwhile, place your card near the sensor or use password to open the door.

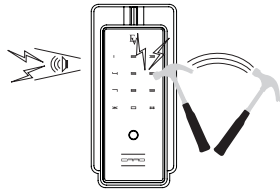

3) Invasion/damage alarm function

If someone forcefully attempts to open the door from either inside or outside, an alarm sound will be generated.

The alarm sound for invasion or damages will continue for two(2) minutes or until the alarm is cleared.

In order to clear this alarm, you must enter password or use registered cards.

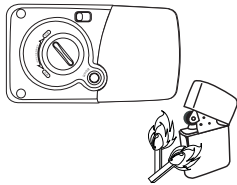

4) Fire detection function

It automatically detects the indoor temperature. If the temperature is around 60 degrees Celsius, then an alarm sound will be generated and the locking condition will be automatically released.

Reference

- ▶ It is activated by heat with around 60 degrees Celsius. It may vary depending on the environment.
- ▶ Even if it is forced to be locked either internally or externally, once high temperature heat is detected, the locking condition will be released automatically.
- ▶ It only operates when the internal temperature is high. It is not affected by the external temperature.

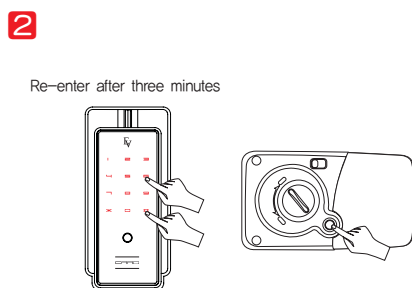
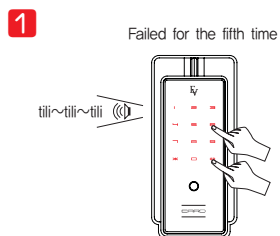

5) Forced locking of the system

If you failed to enter correct passwords or use valid cards for five times in a row, you will hear the 'tili~tili~tili' sound for about 10 seconds. And, the system will enter the locking mode and will be halted for three(3) minutes.

There is no way other way to clear the alarm from the outside other than waiting for three minutes. From the inside, you can simply press the [OPEN/CLOSE] button to clear the alarm.

Reference

- Everlock always remembers how many times you failed. Even if there is a long elapsed time between each try, it will enter the forced locking mode as you failed for the fifth time.
- But, even if you failed for four times, as you succeed in opening the door or the system enters into the forced locking mode, then the number of failures will be automatically cleared.

6) How to do when lost a registered card

All the remaining card should be reregistered in order to prevent someone from using the lost card on his own.

7. Additional information useful for you

1) Auto/manual locking setting

※ The default factory setting and the basic setting for installation are in automatic locking mode.

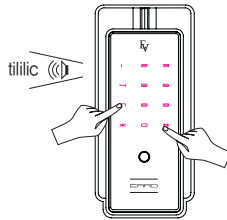
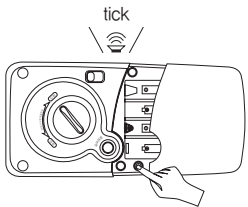

(1) Automatic locking mode

※ If you close the door, then it will be automatically locked within three seconds.

- ▷ If you open the battery cover on the inside and press the [SET] button for 3 seconds, then you will hear the 'tick' sound and the numerical pad's LED will be illuminated.
- ▷ If you touch 7#, then you will hear the 'tililic' sound and the setting for automatic locking mode will be completed.

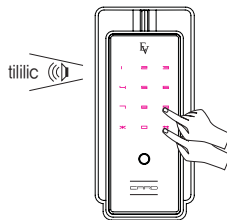
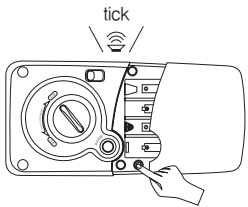

(2) Manual locking

※ Even if you close the door, it won't be automatically locked. To lock the door, you should touch the “#” button on the outside for two(2) times or press the [OPEN/CLOSE] button on the inside.

- ▷ If you open the battery cover on the inside and press the [SET] button for 3 seconds, then you will hear the 'tick' sound and the numerical pad's LED will be illuminated.
- ▷ If you touch 9#, then you will hear the 'tililic' sound and the setting for manual locking mode will be completed.

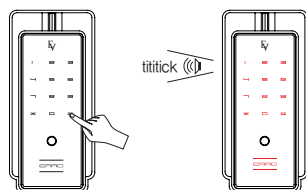
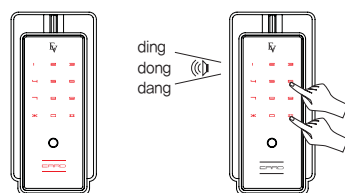
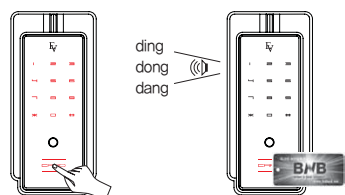
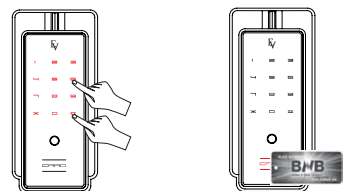
Entering the setting mode**Setting with password****Setting with a card****Deactivating the antitheft function****2) Antitheft function(Outdoor forced locking function)**

This function is used to prevent illegal entry from the outside when you away from your home. Even if you press the [OPEN/CLOSE] button on the inside, the locking function can't be released.

(1) Antitheft setting

Press the “#” button for about three(3) seconds while the door is locked. You will hear the “tititick” alarm sound and the numerical pad and the card sensor's LED will be illuminated.

▷ Setting with password: If you enter password and press the “#” button, then you will hear the “ding dong dang” sound and the antitheft function will be activated.

▷ Setting with a card: After touching the card sensor, place a registered card near the card sensor. You will hear the “ding dong dang” sound and the antitheft function will be activated.

(2) Deactivate antitheft function

▷ Open the door using your password or registered card. It will be automatically deactivated.

3) Double locking function(Indoor forced locking)

This function is used to forcefully lock the door from the inside, so that no one can release the locking condition from the outside.

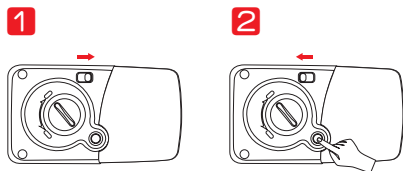

(1) Double locking setting

While the door is closed, you can shift the indoor double locking switch to the locking mode.(show red color)

(2) Release double locking

It shifts the double locking switch to the open mode.(show green color)

※ If you press the [OPEN/CLOSE] button while the door is in double locking mode, you will just hear the 'ti ti ti' sound and the door will not open. If you try to open the door from the outside using password or cards, you will just hear the 'pi pi pi' sound and the door won't open.



Caution

If you set the double locking function, then you may not be able to open the door from the outside. So please be careful. Especially, do not allow your children to operate this function.

4) Volume control

This function is used to control the audio volume generated by Everlock.

■ If you press the [SET] button for three(3) seconds on the inner device, you will hear the 'ticking' sound and the numerical pad's LED will be illuminated. At this moment, select from 0 to 2 and then touch the "#" button to complete your audio volume setting.

※ Even if you select the etiquette (mute) mode, you will hear alarms sounds from the equipment.

※ The default factory setting and the basic setting for installation are in level 2.

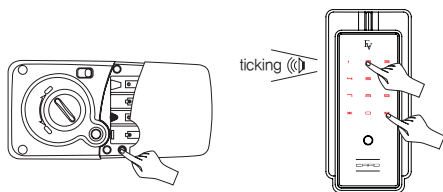

▷ Etiquette mode : 0

▷ Low mode : 1

▷ High mode : 2

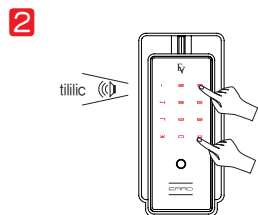
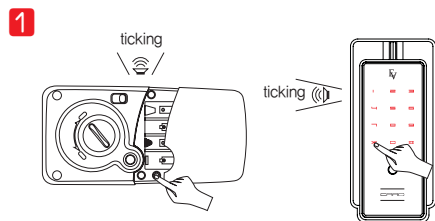

5) Setting the induction number of digits for conceal the password.

If you want to open the door from the outside using your password, you must enter additional numbers that the equipment requests. The number of digits in this induction number can be set by the user.

- (1) If you press the [SET] button for 3 seconds on the inner device, then you will hear the 'ticking' sound and the numerical pad's LED will be turned on. At this moment, touch the "*" button and then the numerical pad's LED will start blinking and you will hear the 'ticking' sound.
- (2) Select one from 0 to 5 and then touch the "#" button. You will hear the "tilllic" sound and the setting for the induction number will be completed.

No induction number	1 digit Induction number	2 digits Induction number	3 digits Induction number	4 digits Induction number	5 digits Induction number
0	1	2	3	4	5

Reference

- The default factory setting or the basic setting for initialization is 0 digit.

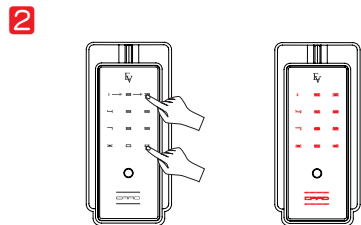
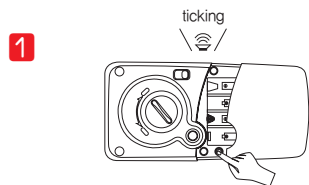

6) Initialization method

This function is used to initialize all the registered information to its factory setting. Once you initialize it, the password will be set to 1234 and the all the registered card information will be deleted.

Reference

- After initializing the registered information, please register again your card and password.

- (1) If you press the [SET] button for 3 seconds on the inner device, then you will hear the 'ticking' sound and the numerical pad's LED will be illuminated.
- (2) If you touch "123#", then the numerical pad and the card sensor's LED will blink for about five seconds to signifying that initialization is in progress.

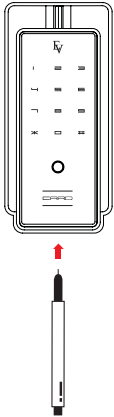

7) Reset function

If the equipment does not work properly or it malfunctions, this function can be very useful.

- ▷ The reset switch is located in the middle of the connection terminal for the emergency battery. Use a ball pen or pin to touch this reset switch. You will hear the 'pililic' sound and the reset function will be activated.

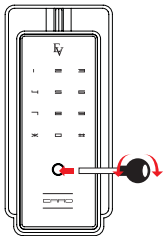

8) Using emergency cylinder keys

In case of broken down or battery exhausted of EVERLOCK, you can open the locked door by using emergency cylinder keys.

- (1) How to use : Remove the key cover(Outdoor) and insert the keys to the key hole then turn right.



Caution

- ▶ Use only emergency case. When set antitheft function, the door open by cylinder keys an alarm sound will occur.
- ▶ When Enter the password or registered card the alarm sound will be automatically deactivated.

8. Contact us

Headquarters & Factory

169-1, Jubuk-ri, Yangji-myeon, Cheoin-gu, Yongin-si, Gyeonggi-do, KOREA 449-822
TEL. +82-31-337-1203 | FAX. +82-31-337-1209

Seoul R&DB Center

E&C Venture Dream Tower VI 808, 197-28, Guro-dong, Guro-gu, Seoul, KOREA 152-050
TEL +82-2-801-0199 | FAX. +82-2-801-0299

Technical support : techsupport@bnbsol.com

Sales & marketing : sales@bnbsol.com

Limited Warranty Coverage

If your product does not work properly because of a defect in materials or workmanship, BNB Solutions will, for the length of one(1) year, which starts with the date of original purchase ("Limited Warranty Period"), at its option either (a) repair your product with new or refurbished parts, or (b) replace it with a new or refurbished product. Defective products must be shipped at the consumers cost to BNB Solutions Co., Ltd.

The forgoing warranty shall not apply to defects resulting from abuse, misuse, accident alternation, neglect, use of unregistered parts, unauthorized repair or installation, or natural disaster, such as lightening, fire, strong winds, flooding, etc. BNB Solutions shall have the right of final determination as to the existence and cause of the defect.

THE WARRANTY SET FORTH ABOVE IS EXCLUSIVE AND NO OTHER WARRANTY, WHETHER WRITTEN OR ORAL IS EXPRESSED OR IMPLIED. BNB SOLUTIONS SPECIFICALLY DISCLAIMS AND IMPLIED WARRANTIES OF MERCHANTABILITY AND FITNESS FOR A PARTICULAR PURPOSE.

In no event shall BNB Solutions be liable for direct, indirect, special, incidental or consequential damages, (including loss of profits) whether based on contract, tort, or any legal theory.

If you think you product needs servicing, please contact BNB Solutions customer service center.

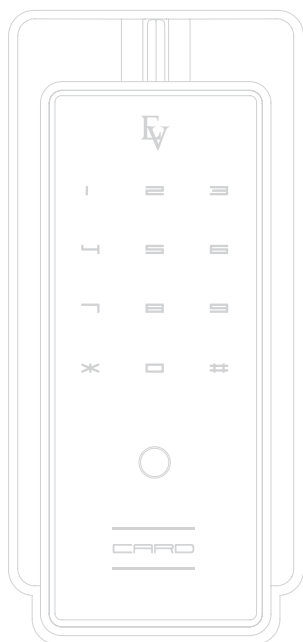

MEMO

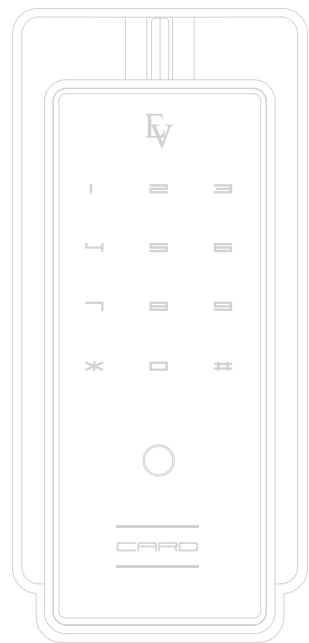

MEMO

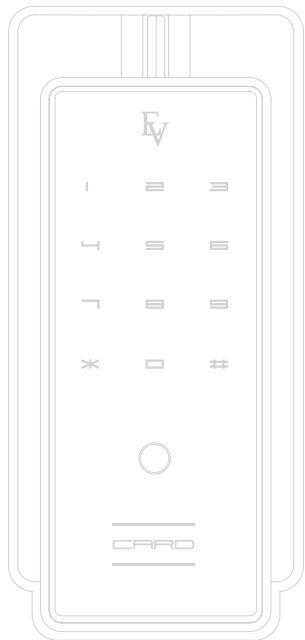



Product name		EVERLOCK		
Model name		BDS-212K		
Date of purchase		Year	Month	Day
Customer	Name			
	Telephone			
	Address			
Agent (Sales)	Name			
	Telephone			
	Address			

The warranty period ("Limited Warranty Period") expires one(1) year after the date of purchase.

- If you want to receive good A/S, then you should submit the product warranty specifying the date of purchase, within the period of warranty.
- This product warranty can't be issued again.
Please, keep it safely along with the user's manual.
- The free warranty period expires one year after the date of purchase.
- If your negligence or carelessness has caused defects,
or if the warranty period has expired, then you will be charged for A/S.
- If you discover some defects with the product, please contact your installer or our main office.

BNB Solutions Co., Ltd.

BNB
Better & Best Solutions

Create the Best Value with Advanced Products.



User's Information

Cautions

Modifications not expressly approved by the party responsible for compliance could void the user's authority to operate the equipment.

FCC compliance Information

This device complies with part 15 of FCC Rules. Operation is subject to the following two conditions: 1. This device may not cause harmful interference, and 2. This device must accept any interference received. Including interference that may cause undesired operation.

Information to User

This equipment has been tested and found to comply with the limits for a Class B digital device, Pursuant to part 15 of the FCC Rules. These limits are designed to provide reasonable protection against harmful interference in a residential installation. This equipment generates, uses and can radiate radio Frequency energy and, if not installed and used in accordance with the instructions, may cause harmful interference to radio communications. However, there is no guarantee that interference will not occur in a particular installation. If this equipment does cause harmful interference to radio or television reception, which can be determined by turning the equipment off and on, the user is encouraged to try to correct the interference by one or more of the following measures:

- Reorient or relocate the receiving antenna.**
- Increase the separation between the equipment and receiver- Connect the equipment into an outlet on a circuit different from that to which the receiver is connected.**
- Consult the dealer or an experienced radio/TV technician for help.**