



APPENDIX H

: USER'S MANUAL



Blue & Communication

BnCOM CO.,LTD. /www.bncomm.co.kr/

Wireless freedom

Bluetooth® Stereo Headset BHS-100



BnCOM
Blue & Communication

BLUETOOTH HEADSET USER GUIDE

Table of contents

■ Before using the Headset	
Included in package	4
Parts description	4
■ Using the headset	
Charging	5
Power on / Power off	6
Pairing	6
Fitting headset on your ear	8
■ Actual use	
Making a call	8
Answering a call	9
Ending a call	9
Volume control	10
Call waiting	10
Transferring a call	10
Mic mute	10
■ Hearing the music	
Play music	11
Pause music	11
Stop music	11
Next track	11
Previous track	11
Fast forward	11
Rewind	11
■ Appendix	
Frequently asked questions	12
Safety precautions	13
Specification and Features	14
Declaration of confirmation	15
Limited Warranty	16

-3-

BLUETOOTH HEADSET USER GUIDE

Before using the Headset

The Bluetooth headset, BHS-100 is a wireless headset using Bluetooth® technology. This Product support A2DP, AVRCP as well as headset and handsfree Profiles. Bluetooth® is registered trademark of Bluetooth® SIG and Bluetooth® can be used only certified manufacturers.

Included in package

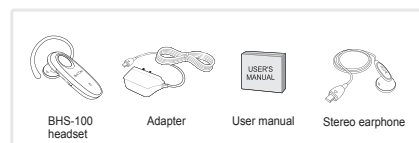

Parts description

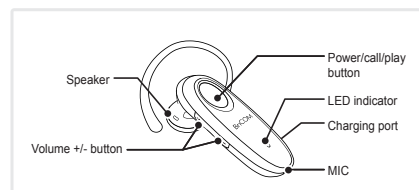

-4-

BLUETOOTH HEADSET USER GUIDE

Using the headset

Charging

BHS-100 is powered by a rechargeable battery pack. You must charge the battery fully before using the headset for the first time.

1. Plug Adapter into headset charging port.
2. The headset cannot be used while charging.
3. Charging will be completed within three hours.

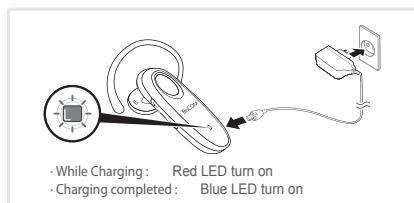

- While Charging : Red LED turn on
- Charging completed : Blue LED turn on



Do not attempt to charge the headset with anything other than adapter provided. Using unauthorized adapter may damage the headset.

-5-

BLUETOOTH HEADSET USER GUIDE

Power on / Poweroff

	Action	Tone	LED indication
Power on	Press and hold the power/call/play button for 3 seconds.	You will hear melody as the power is turned on.	Blue LED blinks 5 times.
Power off	Press and hold the power/call/play button for 3 seconds.	You will hear melody as the power is turned off.	Red LED is on for 2 seconds and then turns off.

Pairing

1. While the power is turned off, press and hold the power/call/play button for 6 seconds.
2. You will hear the melody indicating that the power is on. After that, you will hear the short beep.

※ When turning on the power initially after purchase, the headset will enter to the 'Pairing Mode' automatically



Warning In order for all the functions of the headset to be available, pair the headset in the stereo headset mode. Paired in hands-free or headset mode, some functions are restricted.

-6-

BLUETOOTH HEADSET USER GUIDE

3. When Pairing mode, The blue LED indicator blinking rapidly.



4. Using your handset, find the 'Bluetooth menu' and 'search for' or 'add' new device.

5. Select 'BHS-100' from the list of devices and pair it with your handset.

※ The way of pairing or screen indication should be different according to the handset model.

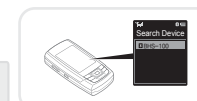

6. When asked for the Pass/PIN code during the pairing procedure, please enter '0000'.



7. If pairing was successful, the Blue LED indicator blinks 2 times every 5 seconds.



Your headset may not be compatible with some handset. Ensure that your headset has bluetooth capability.

-7-

Fitting headset on your ear

Wear headset on your ear. Depending on which ear you are going to wear the headset, simply adjust the earloop accordingly.



Actual use

Making a call

- Making a call**
After entering the telephone number, press the power/call/play button briefly.
- Last number redial**
Press the power/call/play button for 1 second to activate last number redial. (Some headset will show the list of calls.)
- Voice dialing**
Briefly press the power/call/play button to activate 'voice command'.

Tip : Your headset must support the 'voice dial' function.

Answering a call

Briefly press the power/call/play button to answer an incoming call.

Ending a call

Briefly press the power/call/play button or handset end key.

Volume control

Briefly press the volume + or volume - button to adjust the speaker volume.

Call waiting

Answer a second call without hanging up the first call by pressing the power/call/play button for 1 second.

Tip : This function is not available in the headset mode.

Transferring a call

While on a call briefly press the power/call/play button for transferring the audio to the headset.

☒ Pressing too long may cause turning off the headset.

Mic mute

To make mute Mic during an active call, press volume + and volume - button simultaneously for 1 second.
When repeating again, mute function is just cancelled.
(On mute Mic, you will hear a beep per 10 seconds.)

Hearing the music

Play music

Press the power/call/play button twice in series.

Pause music

While playing music, press the power/call/play button twice in series.

Stop music

In the condition of playing music or stop, press the power/call/play button for 1 second.

Next track

While playing music, press the volume + button 1 second.

Previous track

While playing music, press the volume - button 1 second.

Fast forward

While playing music, press the volume + button for 3 seconds, releasing the button causes to replay from the stopped point.

Rewind

While playing music, press the volume - button for 3 seconds, releasing the button causes to replay from the stopped point.

Appendix

Frequently asked questions

I cannot pair the headset with my handset.	You can delete the headset pairing on your handset. Try following [pairing] on page 6.
How far away from my handset will the headset work?	The operating range is typically up to 30feet (10meters). The actual distance may vary depending on the situation.
Will the headset work with laptop, PDA, and PC?	The headset will work with devices that are compliant with bluetooth function and support the headset, hands-free, A2DP and AVRCP profiles.
Will the headset work with my cordless phone at home?	The headset is not designed for use with cordless phones.
Will anything cause interference with my conversation when I'm using the headset?	Appliance such as cordless phone and wireless networking equipment may cause interference with your conversation. To reduce any interference, keep the headset away from other devices that use or produce radio waves.
Can other bluetooth headset users hear my conversation?	When you pair the headset to your handset, you are creating a private link between only these two bluetooth technology in the headset is not easily monitored by third parties, because bluetooth wireless signals are significantly lower in radio frequency power than those produced by a typical mobile handset.
How do I take care of the headset?	To clean the headset, use a clean, soft cloth that is slightly damp.
Will the headset interfere with my car's electronics, radio, or computer?	The headset produces significantly less power than a typical mobile handset. It also only emits signals that are in compliance with standard consumer-grade electronics equipment.
Can I change battery in the headset?	Warranty and parts replacement of this product is 6 months. If you want to replace the battery, visit the authorized A/S center. Battery life will vary due to usage patterns and environmental conditions.

Safety precautions

- Please note the followings in using your headset.
 - Do not drop or cause severe impact to your headset.
 - Keep your headset within normal operating temperatures and avoid storage at extreme temperature.
 - Maintain your headset in dry conditions and do not expose you headset to water or other liquids.
 - Keep your headset out of the reach of children or pets.
- Please use only authorized products.
 - The use of unauthorized batteries, battery chargers or accessories can shorten the life of the headset and cause malfunction and damage to the headset.
- Do not use in a place where its use is prohibited.
 - The use in prohibited areas such as hospital or airplane may cause serious problems and risks to communication system or navigation of the hospital or airplane.
- Please turn off in an explosion sensitive area.
 - Make sure that you abide by the instructions, directions or cautions of the explosion sensitive area.
- Do not attempt to disassemble your headset.
 - Make sure to visit a designated customer service center for repair. Damages caused by disassembly, modification or repair by yourself are not covered by warranty.
- Do not use it near a microwave oven or wireless LAN products.
 - It may cause malfunction or noise to your headset as they use same frequency as your headset.
- Do not use your headset while you are driving.
 - Make sure to comply with the rules and regulations of use of headset in driving.

Specification and Features

Product Name	Bluetooth Wireless Headset (BHS-100)
Bluetooth specification	Version 2.1
Supported Bluetooth Profiles	Headset / Handsfree / A2DP / AVRCP
Frequency range	2402 ~ 2480 MHz
Output power	0.25 ~ 2.5 mW
Operating Range	Up to 33 feet (10meters)
Dimensions	55.6mm(L) * 17.8mm(w) * 11mm(H)
Weight	9.8g
Operating Temperature	-10°C ~ 60°C
Battery type	3.7V, Li-Polymer
Talk time	Up to 7 hours
Music play time	Up to 5 hours
Stand by time	Up to 120 hours
Charging time	< 3 hours

* Time of battery may differ from the above, depending on your using conditions and circumstances.

Declaration of confirmation

FCC NOTICE TO USERS

This device complies with part 15 of the FCC Rules. Operation is subject to the following two conditions:
(1) This device may not cause harmful interference, and (2) this device must accept any interference received, including interference that may cause undesired operation (of the device).

IMPORTANT NOTE

According to the KDB447498 (3)(b)(c), The output power is lower than 25 mW for any simultaneous transmitting antenna for which stand-alone SAR evaluation is not required. This equipment complies with FCC radiation exposure. Any change to the antenna or the device could result in the device exceeding the RF exposure requirements and void user's authority to operate the device



Caution: Changes or modifications not expressly approved by the party responsible for compliance could void the user's (or your) authority to operate the equipment.