

# **User Manual**

**AirStation**

**WMR-300**

# Contents

**Chapter 1 - Product Overview ..... 2**

---

Package Contents..... 2

Hardware Overview..... 3

**Chapter 2 - Installation..... 5**

---

**Appendix A - Specifications ..... 6**

---

**Appendix B - Environmental Information..... 8**

---

**Appendix C - GPL Information ..... 9**

---

# Chapter 1 - Product Overview

## Package Contents

---

The following items are included in your AirStation package. If any of the items are missing, please contact your vender.

- AirStation ..... 1
- Case ..... 1
- Ethernet Cable ..... 1
- Quick Setup Guide..... 1
- Warranty Statement..... 1

# Hardware Overview

---

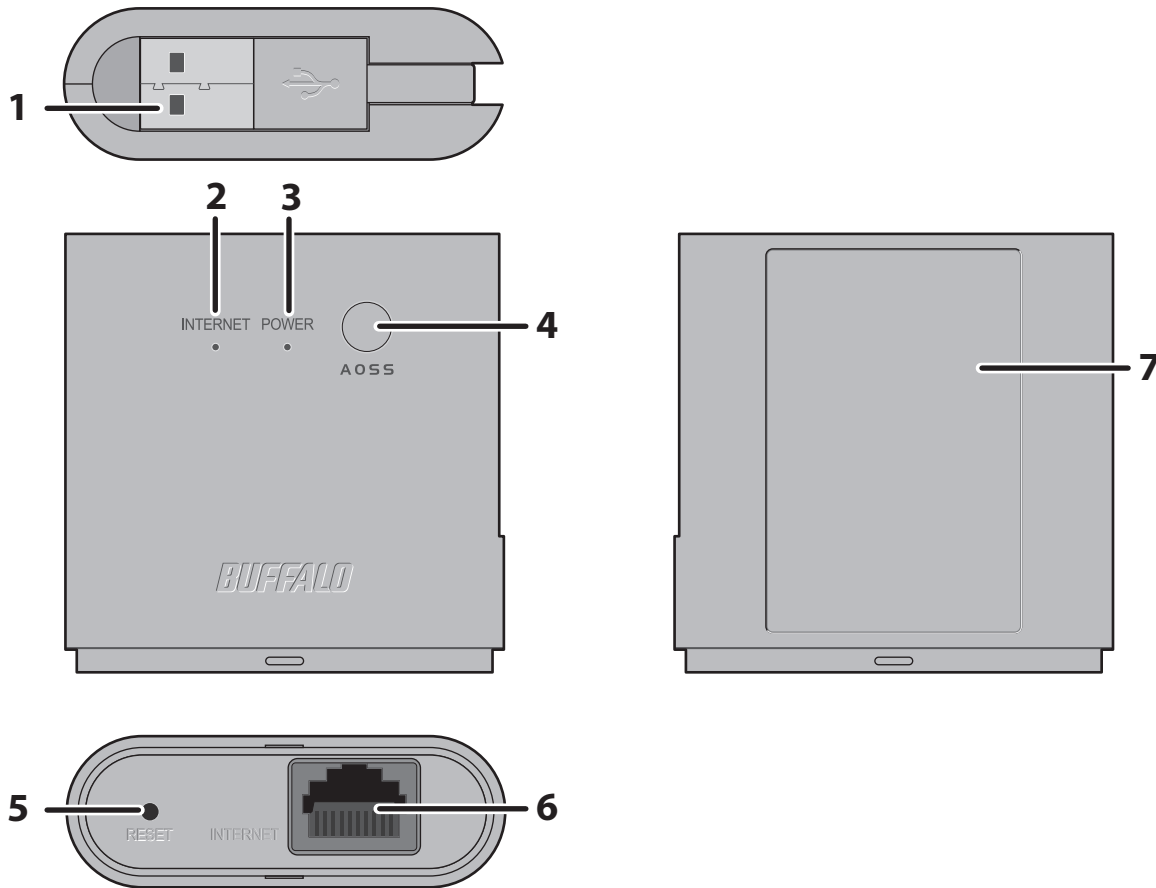

**1 USB cable**                      Connect to PC, or USB power adapter.

**2 Internet LED (Green)**

- On:                                      The Internet port is connected.
- Blinking:                              The Internet port is not connected.
- Off:                                      Router functionality is disabled.

**3 Power/Diag LED (Green or Red)**

- On (Green):                              Power is on, and WLAN is enabled.
- Blinking (Green):                      Booting
- 2 Blinks (Green):                      AirStation is waiting for an AOSS or WPS security key.
- Blinking slowly                      Power is on, and WLAN is disabled.  
(Green):
- Continuously blinking:              AOSS/WPS error; failed to exchange security keys.  
(Red):

- 2 blinks (Red)\*2: Flash ROM error.
- 3 blinks (Red)\*2: Wired Ethernet LAN error.
- 4 blinks (Red)\*2: Wireless LAN error.
- 5 blinks (Red)\*3: IP address setting error.
- 9 blinks (Red)\*2: System error.
- Continuously blinking\*1: Updating firmware, saving settings, or initializing settings.

\*1 Never unplug the USB cable while the Power/Diag LED is blinking continuously.

\*2 Turn off AirStation first, wait for a few seconds, then turn it back on.

\*3 Because the network addresses of both the Internet port (WAN port) and the LAN port are the same, it is not possible to establish communication. Change the LAN-side IP address of the AirStation.

- 4 AOSS button** To initiate AOSS, hold down this button until the Power/Diag LED flashes (about 1 second). Then, push or click the AOSS button on your wireless client device to complete the connection. Both devices must be powered on for this to work.
- 5 Reset button** To reset all settings, hold down this button until the Power/Diag LED turns red (about 3 seconds). The power must be on for this to work.
- 6 Internet Port** 10 Mbps and 100 Mbps connections are supported.  
Note: In bridge/AP mode (router off), the Internet port becomes a regular LAN port.
- 7 Factory Default Settings** This sticker shows the AirStation's SSID, default encryption key, and WPS PIN code.

# Chapter 2 - Installation

To configure your AirStation, follow the procedure below.

**1**

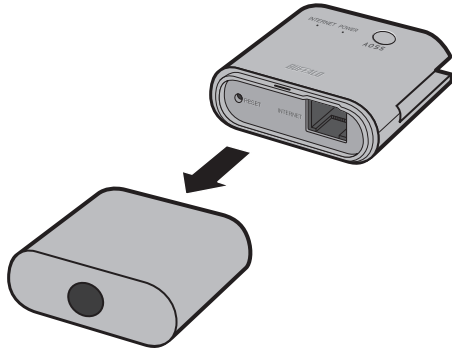

**2**

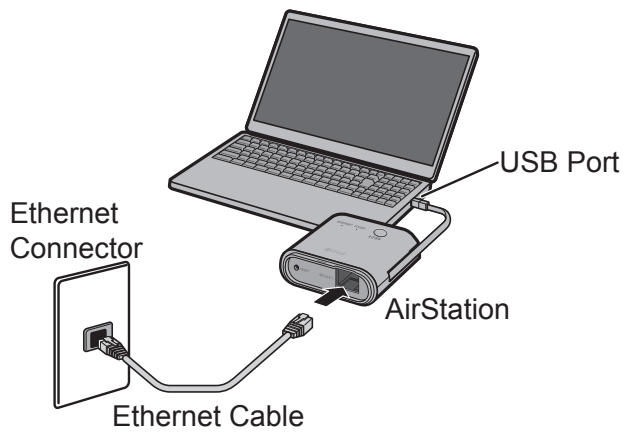

**3**

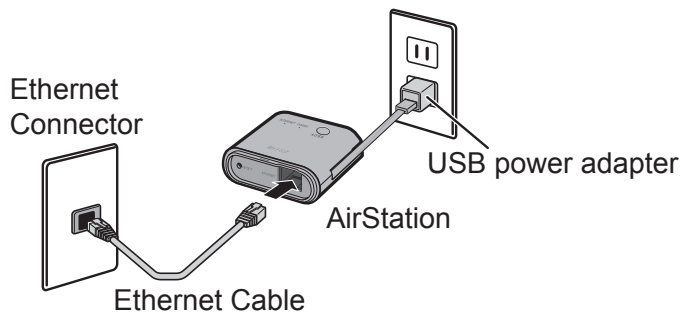

**4** Launch a web browser. If the home screen is displayed, setup is complete.

# Appendix A - Specifications

<b>WAN Interface</b>	
Standard Compliance	IEEE802.3u (100BASE-TX), IEEE802.3 (10BASE-T)
Transmission Rate	10 / 100 Mbps
Transmission Encoding	100BASE-TX 4B5B/MLT-3, 10BASE-T Manchester Coding
Access Method	CSMA/CD
Speed and Flow Control	10 / 100 Mbps, Auto Sensing, Auto MDIX
Number of LAN Ports	1
LAN Port Connector	RJ-45
<b>Wireless LAN Interface</b>	
Standard Compliance	IEEE802.11n/g/b
Transmission Method	Direct Sequence Spread Spectrum (DSSS), OFDM, MIMO
Frequency Range	2412-2462 MHz (Channels 1, 2, 3, 4, 5, 6, 7, 8, 9, 10, 11)
Transmission Rate 802.11n/b/g	802.11n: 20 MHz BW (Long GI) 130, 117, 104, 78, 52, 39, 26, 13 Mbps (2 stream) 65, 58.5, 52, 39, 26, 19.5, 13, 6.5 Mbps (1 stream) 20 MHz BW (Short GI) 144.4, 130, 115.6, 86.7, 57.8, 43.3, 28.9, 14.4 Mbps (2 stream) 72.2, 65, 57.8, 43.3, 28.9, 21.7, 14.4, 7.2 Mbps (1 stream) 40 MHz BW (Long GI) 270, 243, 216, 162, 108, 81, 54, 27 Mbps (2 stream) 135, 121.5, 108, 81, 54, 40.5, 27, 13.5 Mbps (1 stream) 40 MHz BW (Short GI) 300, 270, 240, 180, 120, 90, 60, 30 Mbps (2 stream) 150, 135, 120, 90, 60, 45, 30, 15 Mbps (1 stream)  802.11g: 54, 48, 36, 24, 18, 12, 9, 6 Mbps  802.11b: 11, 5.5, 2, 1 Mbps
Access Mode	Infrastructure Mode
Security	AOSS, WPA2-PSK (AES), WPA/WPA2 mixed PSK, WPA-PSK (AES), 64-bit or 128-bit WEP, Mac Address Filter

<b>Other</b>	
Power Supply	External AC 100-240 V Universal, 50/60 Hz
Power Consumption	About 2.5 W (Max)
Dimensions	TBD
Weight	TBD
Operating Environment	0 - 40° C (32 - 104° F), 10 - 85% (non-condensing)



# Appendix B - Environmental Information

- The equipment that you have purchased has required the extraction and use of natural resources for its production.
- The equipment may contain hazardous substances that could impact health and the environment.
- In order to avoid the dissemination of those substances in our environment and to diminish the pressure on the natural resources, we encourage you to use the appropriate take-back systems.
- The take-back systems will reuse or recycle most of the materials of your end life equipment in a sound way.
- The crossed-out wheeled bin symbol invites you to use those systems.



- If you need more information on collection, reuse, and recycling systems, please contact your local or regional waste administration.

# Appendix C - GPL Information

The source code for Buffalo products that use GPL code is available at <http://opensource.buffalo.jp/>.