

setting guide



This setting guide should only be used as general reference. After some uses, you will learn what settings will work best for your bottles. Always test your bottles before feeding your baby.



Quick Warming



Room Temperature (70°F/21°C)

Cold Temperature (39°F/4°C)

Plastic Bottle		Glass Bottle	Plastic Bottle		Glass Bottle
setting 1	1oz/30ml	×	setting 1	1oz/30ml	×
setting 2	2oz/60ml	×	setting 2	2oz/60ml	×
setting 3	3oz/90ml	setting 1	setting 3	3oz/90ml	setting 1
setting 4	4oz/120ml	setting 2	setting 4	4oz/120ml	setting 2
setting 5	5oz/150ml	setting 3	setting 5	5oz/150ml	setting 3
setting 6	6oz/180ml	setting 4	setting 6	6oz/180ml	setting 3
setting 7	7oz/210ml	setting 5	setting 7	7oz/210ml	setting 4
setting 8	8oz/240ml	setting 6	setting 8	8oz/240ml	setting 5
setting 9	9oz/270ml	setting 6	setting 9	9oz/270ml	setting 6



Steady Warming



Room Temperature (70°F/21°C)

Cold Temperature (39°F/4°C)

Plastic Bottle		Glass Bottle	Plastic Bottle		Glass Bottle
setting 1	1oz/30ml	×	setting 1	1oz/30ml	×
setting 2	2oz/60ml	setting 1	setting 2	2oz/60ml	setting 1
setting 3	3oz/90ml	setting 2	setting 3	3oz/90ml	setting 2
setting 4	4oz/120ml	setting 4	setting 4	4oz/120ml	setting 3
setting 5	5oz/150ml	setting 4	setting 5	5oz/150ml	setting 4
setting 6	6oz/180ml	setting 5	setting 6	6oz/180ml	setting 5
setting 7	7oz/210ml	setting 7	setting 7	7oz/210ml	setting 6
setting 8	8oz/240ml	setting 7	setting 8	8oz/240ml	setting 7
setting 9	9oz/270ml	setting 7	setting 9	9oz/270ml	setting 7

babybrezza®

safe+smart
bottle warmer

Instruction
Manual



IMPORTANT SAFEGUARDS

When using electrical appliances, basic safety precautions should always be followed including the following:

1. Read all instructions before using.
2. Do not touch hot surfaces. Use handles.
3. To protect against electric shock do not immerse cord, plug or appliance in water or other liquid.
4. Close supervision is necessary when any appliance is used by or near children.
5. Unplug from outlet when not in use and before cleaning. Allow to cool before inserting or removing parts.
6. Do not operate any appliance with a damaged cord or plug or after the appliance malfunctions or has been damaged in any manner. Return appliance to the nearest authorized service facility for examination, repair, or adjustment.
7. The use of accessory attachments not recommended by the appliance manufacturer may cause fire, electric shock or injury.
8. Use on level surface and be sure there is no debris under the unit and the rubber pads are touching the surface.
9. Household use only. Do not use outdoors.
10. Do not let cord hang over edge of table or counter, or touch hot surfaces.
11. Do not place on or near hot gas or electric burner, or in a heated oven.
12. Extreme caution must be used when moving an appliance containing hot liquids.
13. Do not use appliance for anything other than intended use.
14. A short power cord is provided to reduce risk resulting from entanglement or tripping over a longer cord. Extension cords may be used if care is exercised in their use.
15. This appliance has a polarized plug (one blade wider than the other). To reduce risk of electric shock, this plug is intended to fit into a polarized outlet only one way. If the plug does not fit fully into the outlet, reverse the plug. If it still does not fit, contact a qualified electrician. Do not attempt to modify the plug in any way.
16. To disconnect, turn appliance off, then remove plug from wall outlet.
17. Make sure appliance is turned off before unplugging.
18. If using the appliance with an extension cord, make sure the cord is at least as great as the proper electrical rating for the machine. The extension cord should be arranged so that it does not drape over counter top or tabletop where it can be pulled on by children or tripped over unintentionally.
19. Before serving be sure food is at safe temperature.
20. Unplug cord from wall outlet before serving milk or food warmed in appliance.
Do not leave cord within child's reach.

This device complies with Industry Canada's licence-exempt RSSs. Operation is subject to the following two conditions:

- (1) This device may not cause interference.
- (2) This device must accept any interference, including interference that may cause undesired operation of the device.

⚠ CAUTION: To maintain the compliance with the RF exposure guideline, place the unit at least 8in/20cm from nearby persons.

⚠ CAUTION: If E1, E2, E3, or E4 error messages appear on the bottle warmer screen, please contact customer service before any continued use of the bottle warmer.

SAVE THESE INSTRUCTIONS

Get to know your Baby Brezza Safe+Smart Bottle Warmer

Components

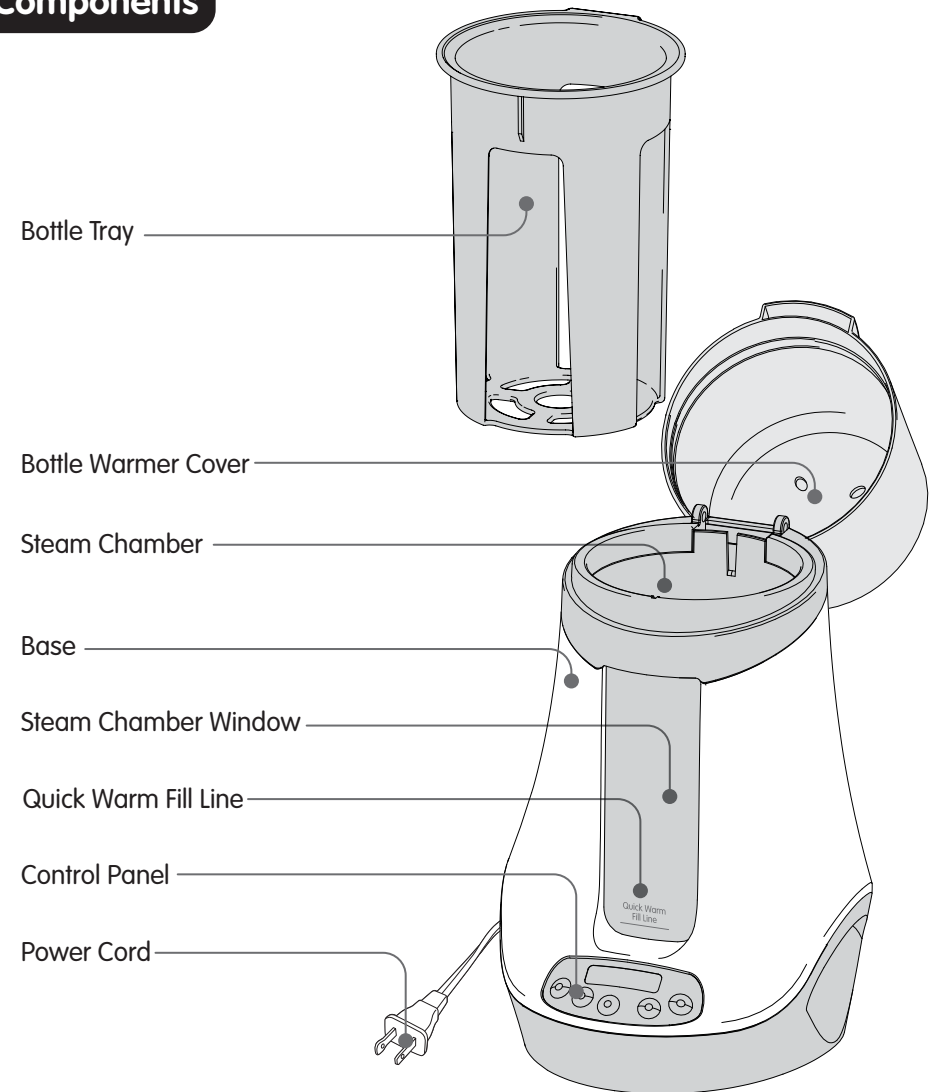

TECHNICAL DATA

Supply voltage: 120V ~ 60Hz

Model: BRZ00139

Current: 4.4A

Power - Heater : 500W

Controls + Indicator Icons

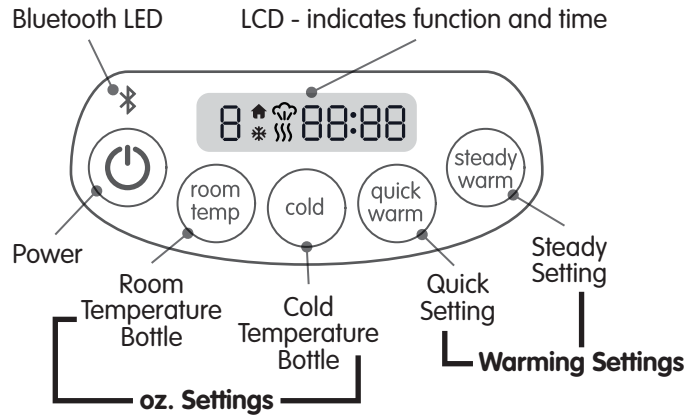

LCD Screen Setting Icons:



Preparing the Bottle Warmer

1 Insert plug into wall outlet.

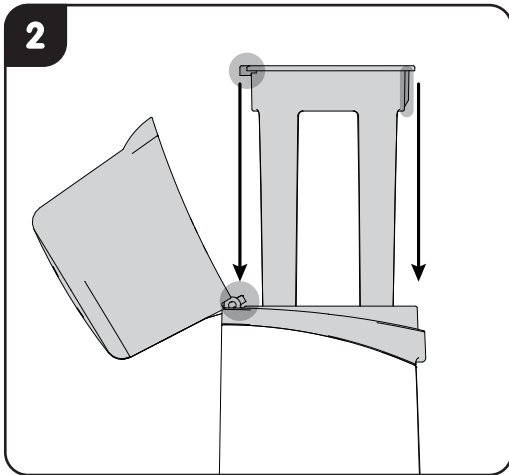

Place the bottle tray into the warmer. Ensure that the tabs around the bottle tray rim align with the slots in the bottle warmer.

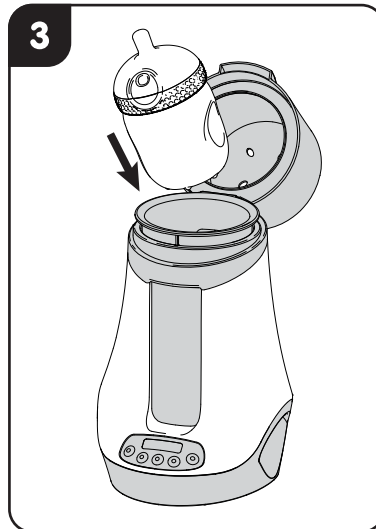

Place your bottle into the tray.

Follow steady warm, quick warm, or defrost instructions on Pages 4 and 5.

CAUTION: Before warming any bottles in this appliance, always remove any inner bottle vent systems from the bottle to prevent fluids from leaking if gas forms during warming.

Bottle Warming

4a Using the "Steady Warm" Function

Recommended for breast milk, defrosting, heating food or formula bottles that you want to warm with low heat. Used to preserve nutrients that may be affected by high heat.

1. Prepare the bottle tray in the machine as described in "Setting Up the Warmer" through step 3.

2. Fill the bottle warmer with water until it matches the **height of the liquid inside the bottle**. Use room temperature water for optimal heating. Using hot or cold water will result in inaccurate or dangerous bottle temperatures.

3. Close the bottle warmer cover.

4. Press to turn on machine.

5. Identify the starting temperature of your bottle.

If you are warming a room temperature bottle (approximately 70F/21C), you will select your bottle size using the "room temp" button on the control panel.

If you are warming a cold bottle or cold food (bottle/food that has been refrigerated or is approximately 35F/4C), you will select your bottle size using the "cold" button on the control panel.

6. **Select setting.** Press the "room temp" or "cold" buttons repeatedly to choose the appropriate setting for your bottle. Refer to the "Setting Guide" on the back cover of this booklet to determine the setting to use. Setting is based on the number of ounces you are heating, and whether you are using a glass or plastic bottle.

7. Press to begin heating.

Make sure water level is the same as liquid in bottle.

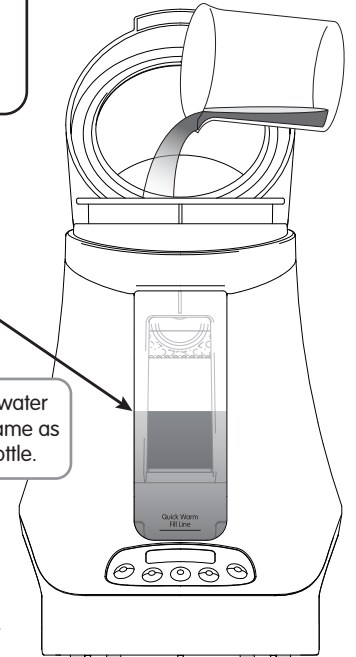

Defrosting Frozen Milk or Food

To use the defrost setting, press the "cold" temperature setting until you reach the icon "F" on the LCD screen. Use this function to defrost frozen milk pouches or food jars.

Press to begin heating.

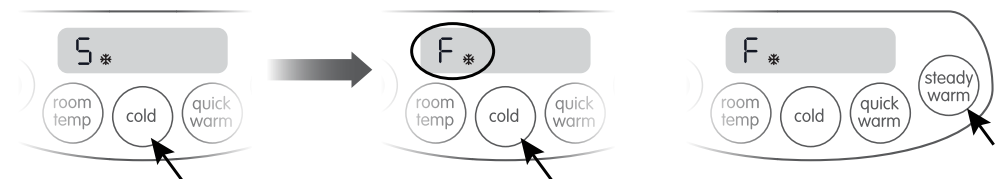

Bottle Warming

4b Using the "Quick Warm" Function

Warms bottles rapidly. Recommended for formula or dairy milk.

1. Prepare the bottle tray in the machine as described in "Setting Up the Warmer".

2. Fill the bottle warmer with room temperature water to the "Quick Warm" fill line. Using hot or cold water will result in inaccurate or dangerous bottle temperatures.

3. Press  to turn on machine.

4. Identify the starting temperature of your bottle.

room temp

If you are warming a room temperature bottle (approximately 70F/21C), you will select your bottle size using the "room temp" button on the control panel.

cold

If you are warming a cold bottle or cold food (bottle/food that has been refrigerated or are approximately 35F/4C), you will select your bottle size using the "cold" button on the control panel.

5. **Select setting.** Press the "room temp" or "cold" buttons repeatedly to choose the appropriate setting for your bottle. Refer to the "Setting Guide" on the back cover of this booklet to determine the setting to use. Setting is based on the number of ounces you are heating, and whether you are using a glass or plastic bottle.

6. Press  to begin heating.

When heating is complete, the display will flash 00:00 and there will be 5 audible beeps that indicate a finished heating cycle.

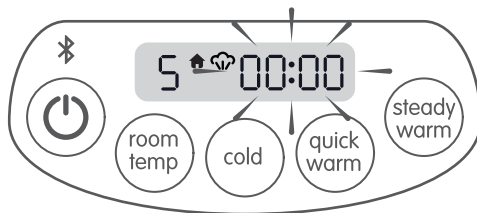

CAUTION: If you are warming multiple bottles, allow the bottle warmer to cool before warming the next bottle.

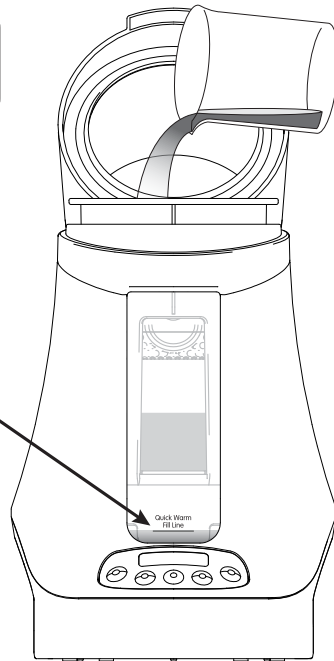

5

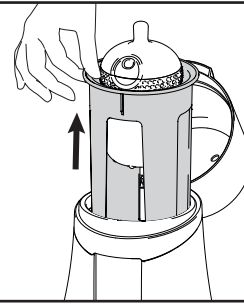

Lift the lid open and carefully lift the bottle tray from the orange lip. Place it on a countertop and remove the bottle.

6

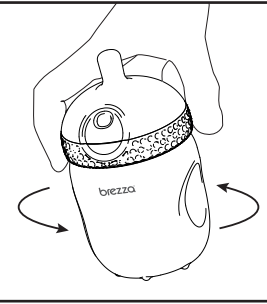

Gently swish the fluid in the bottle thoroughly so the temperature becomes uniform throughout the bottle.

⚠ After a few uses, you will learn what the best warming times are for your baby. Always test the formula/breast milk temperature before feeding your baby.

Cleaning the Bottle Warmer

1



2

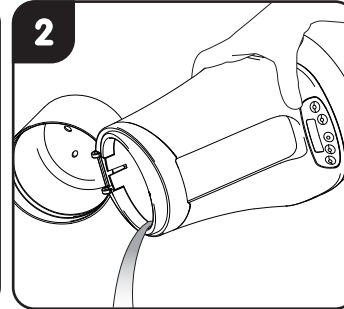

3

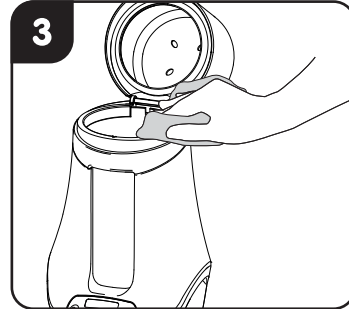

- Unplug the bottle warmer and remove bottle tray from base.
- Carefully pour out any water in base. If necessary, wipe base with damp cloth.
- Wipe dry before next use. **Note: Do not use scouring pads, abrasives or solvents for cleaning.**
- Do not submerge the appliance into any water or liquid.
- Do not disassemble the appliance as there are no serviceable parts inside.
- Bottle tray is dishwasher safe.

De-scaling the Bottle Warmer

It is important to de-scale this appliance every 4 weeks to ensure that it continues to work properly. Pour all remaining water out of the water chamber. To de-scale, mix 2oz (50ml) of white vinegar with 4oz (100ml) of cold water into the water chamber, and then run one heating cycle on setting 5 until any scaling has been removed. Please ensure proper ventilation when descaling with vinegar.

CAUTION: Any other servicing should be performed by an authorized service representative.

Smart Bottle Warmer Mobile App

The Smart Bottle Warmer can be set up straight from your mobile device.

Download and install the Baby Brezza Smart Bottle Warmer app located in the app store.

Bluetooth  is required on your mobile device to connect to the Baby Brezza Smart Bottle Warmer.

1 Press  on the Smart Bottle Warmer to turn it on.

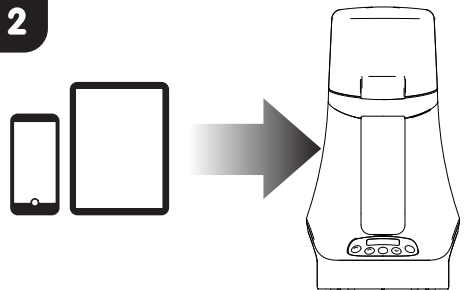

Ensure that your mobile device is at most 20 ft. from the bottle warmer.

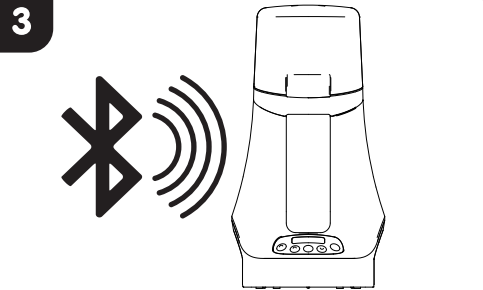

In the Baby Brezza App, press  to sync your phone to your Smart Bottle Warmer. Ensure that bluetooth connectivity is on in your mobile device.

Setup Interface

Once connected, the setup screen will display on your mobile device.

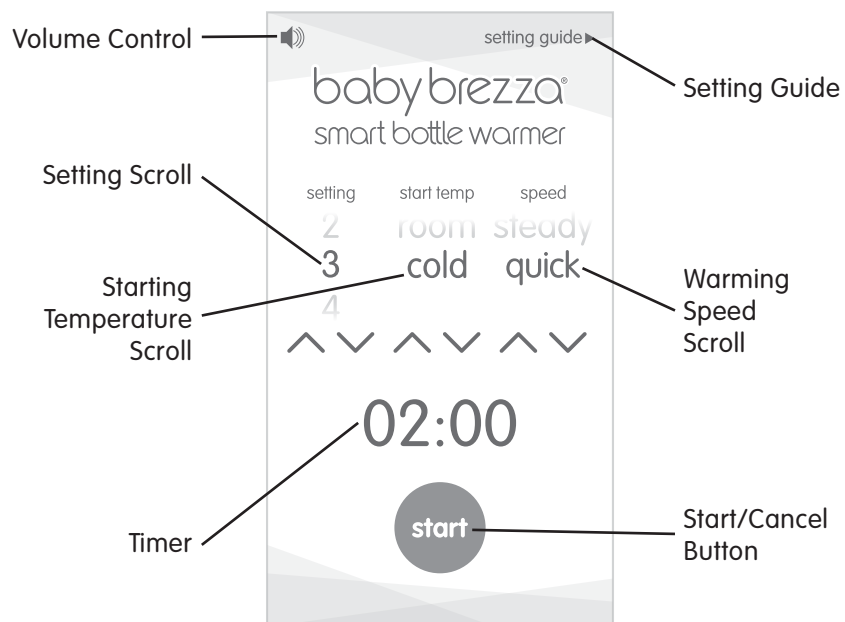

4 Prepare your bottle and bottle warmer.

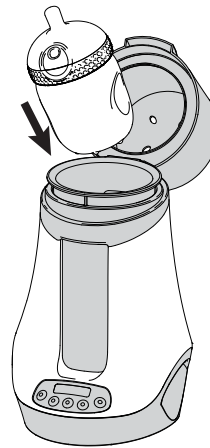

Place bottle into bottle warmer

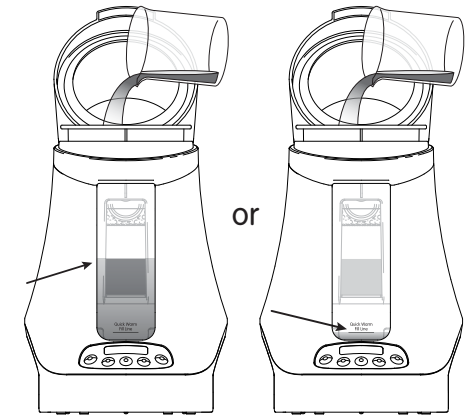

Add water to bottle warmer based on your setting

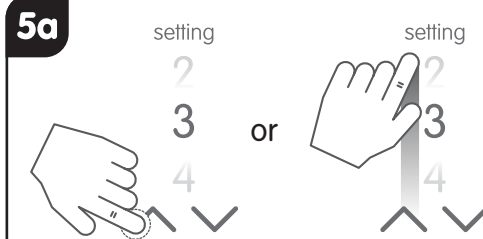

Scroll through each setting by pressing on the arrow keys or swiping up or down on each column.



Use the setting guide if you need assistance choosing the correct warmer setting.

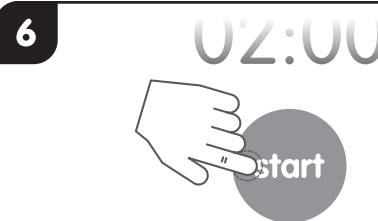

Press the "Start" button on your mobile device to beginning warming.

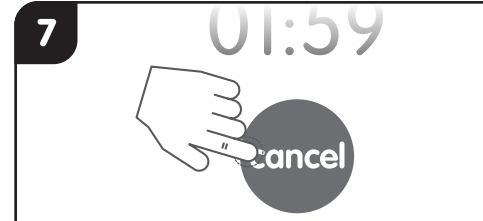

Timer will begin counting down. If bottle warming needs to be stopped for any reason, simply press the "cancel" button to stop heating.

When a warming cycle is cancelled, the timer will reset to the start time of the last setting used. Adjust the warming settings accordingly and press "start" to begin a new cycle.

⚠ CAUTION: Allow the bottle warmer to cool before starting a new warming cycle.

Troubleshooting

Condition	Cause	Remedy
Machine will not start.	Machine is unplugged.	Ensure that machine is securely plugged into an outlet.
	Machine is not turned on.	Press  to turn on the machine. Do not hold down the button.
Lid will not close.	Bottle Tray is misaligned inside bottle warmer.	Ensure that bottle tray is lined up with bottle tray slots in the bottle warmer.
Machine will not sync to mobile device.	Bluetooth connectivity in mobile device is not turned on.	Turn on the Bluetooth connectivity in your mobile device before syncing to the machine.
	Mobile device is out of range.	Mobile device needs to be within 20ft of the bottle warmer.
Warmed bottle is too hot. (Quick warm setting)	Not enough water added to bottle warmer.	Add water to the marked Quick Warm fill line.
	Setting time is too long or incorrect setting chosen.	Try a lower setting according to your preference.
Warmed bottle is too hot. (Steady warm setting)	Not enough water added to bottle warmer.	Add water until it matches the height of liquid in your bottle.
	Setting time is too long or incorrect setting chosen.	Try a lower setting according to your preference.
Warmed bottle is too cold. (Quick & Steady warm settings)	Too much water added to bottle warmer.	Reduce water in bottle warmer to the required height based on your setting. (Refer to pg 3-4)
	Setting time is too short or incorrect setting chosen.	Try a higher setting according to your preference.

If you can not remedy problems with the machine by using the troubleshooting chart above, please contact Customer Service at: 1-888-396-6552

Troubleshooting

Condition	Cause	Remedy
"E5" error displays on machine or "Error" message displays on app.	Little or no water has been added to the machine.	Add cold water to the machine and let it sit and cool for 5 min. Empty out cold water and restart the bottle warmer. Make sure to add the appropriate amount of water needed for warming.
E1, E2, E3, or E4 error displays on machine.	Internal malfunction in machine.	Please contact customer service before continuing to use your machine.

Limited 1-year Warranty

The limited warranty is valid only on products bought through authorized resellers and used in the United States and Canada. Buying through an unauthorized reseller or using this product outside of the United States and Canada automatically voids this warranty. This warranty is available to consumers only. You are a consumer if you own a Baby Brezza Bottle Warmer that was purchased at retail for personal, family or household use. Except as otherwise required under applicable state law, this warranty is not available to retailers or other commercial purchasers or owners. We warrant that your Baby Brezza Bottle Warmer will be free of defects in material or workmanship under normal home use for one year from the date of original purchase. Customer will be required to present original proof of purchase in order to obtain the warranty benefits. In the event that you do not have proof of purchase date, the purchase date for purposes of this warranty will be the date of manufacture. If your Baby Brezza Bottle Warmer should prove to be defective within the warranty period, we will repair it or, if we consider it necessary, replace it.

⚠ Warning: Changes or modifications to this unit not expressly approved by the party responsible for compliance could void the user's authority to operate the equipment.

NOTE: This equipment has been tested and found to comply with the limits for a Class B digital device, pursuant to Part 15 of the FCC Rules. These limits are designed to provide reasonable protection against harmful interference in a residential installation. This equipment generates, uses and can radiate radio frequency energy and, if not installed and used in accordance with the instructions, may cause harmful interference to radio communications. However, there is no guarantee that interference will not occur in a particular installation. If this equipment does cause harmful interference to radio or television reception, which can be determined by turning the equipment off and on, the user is encouraged to try to correct the interference by one or more of the following measures:

- Reorient or relocate the receiving antenna.
- Increase the separation between the equipment and receiver.
- Connect the equipment into an outlet on a circuit different from that to which the receiver is connected.
- Consult the dealer or an experienced radio/TV technician for help.

Customer Service and Warranty

If you are experiencing problems with your Baby Brezza Smart Bottle Warmer, please call our Customer Service department at 1-888-396-6552 before returning the product so that we can offer you our best service customized to your particular situation.