



OmniView™

KVM Switch with Audio

*Control up to four computers from one keyboard,
mouse, and monitor*



belkin.com

Belkin Corporation

501 West Walnut Street
Compton • CA • 90220 • USA
Tel: 310.898.1100
Fax: 310.898.1111

Belkin Components, Ltd.

Express Business Park
Shipton Way • Rushden • NN10 6GL
United Kingdom
Tel: +44 (0) 1933 35 2000
Fax: +44 (0) 1933 31 2000

Belkin Components B.V.

Starparc Building • Boeing Avenue 333
1119 PH Schiphol-Rijk • The Netherlands
Tel: +31 (0) 20 654 7300
Fax: +31 (0) 20 654 7349

Belkin Components, Ltd.

7 Bowen Crescent • West Gosford
NSW 2250 • Australia
Tel: +61 (0) 2 4372 8600
Fax: +61 (0) 2 4372 8603

Belkin Tech Support

US: 310.898.1100 ext. 2263
800.223.5546 ext. 2263
Europe: 00 800 223 55 460
Australia: 1800 666 040

P73778-C

© 2002 Belkin Corporation. All rights reserved. All trade names are registered trademarks of respective manufacturers listed. Macintosh, Apple, Mac, and Mac OS are trademarks of Apple Computer, Inc., registered in the U.S. and other countries.

User Manual

SOHO Series

F1DS102P
F1DS104P
F1DS102T
F1DS104T

TABLE OF CONTENTS

Introduction	1
Overview	
Feature Overview	2
Equipment Requirements	4
Operating Systems	5
Unit Display Diagrams	6
Specifications	8
Installation	
Pre-Configuration	9
PS/2 Installation	11
USB Installation	16
Using Your KVM Switch	
Powering Up the Systems	21
Selecting a Computer Using Direct-Access Port Selectors	21
Selecting a Computer Using Keyboard Hot Key Commands	21
AutoScan Mode	22
Belkin KVM Switches and Accessories	
OmniView KVM Switches	23
OmniView KVM Cables	25
OmniView Accessories and Adapters	28
FAQs	29
Troubleshooting	32
Warranty, FCC, CE, ICES Statement	36

INTRODUCTION

Congratulations on your purchase of the Belkin OmniView SOHO Series KVM Switch with Audio (the KVM Switch). Our diverse line of quality KVM solutions exemplifies the Belkin commitment to delivering high-quality, durable products at a competitive price. Engineered to give you control over multiple computers/servers from one console, Belkin KVM Switches come in a variety of capacities suitable for all configurations, large or small. This compact, affordable Belkin OmniView KVM Switch is backed by a Belkin Five-Year Warranty and free technical support.

This manual will provide details about your new Switch, from installation and operation, to troubleshooting—in the unlikely event of a problem.

For easy installation, please refer to the Quick Installation Guide included with your KVM Switch.

Thank you for purchasing the Belkin OmniView SOHO Series KVM Switch with Audio. We appreciate your business and have confidence that you will soon see for yourself why over 1 million Belkin OmniView KVM Switches are being used worldwide.

Contents of Package:

- OmniView SOHO Series KVM Switch with Audio
- Attachable Base
- DB25 to RJ45 Flash Cable
- Two PS/2 Extension Cables
- User Manual
- Quick Installation Guide
- Registration Card

OVERVIEW

The Belkin OmniView SOHO Series KVM Switch with Audio allows you to control up to four computers, depending on the model, with one keyboard, monitor, and mouse. All SOHO Series KVM Switches with Audio support PS/2 input devices (keyboard and mouse) as well as VGA, SVGA, XGA, and XGAII video.

The Switch you have purchased supports either PS/2 output for computers (F1DS102P or F1DS104P), or both PS/2 and USB output for both USB and PS/2 computers (F1DS102T or F1DS104T). Consult the packaging notation to ascertain which KVM Switch you have purchased, and consult your computer manufacturer's literature if you are not sure about which OmniView SOHO Series KVM Switch with Audio is right for you.

Feature Overview

Hot Keys

Hot keys allow you to select ports using designated key commands. Control up to four computers using a simple hot key sequence on your keyboard. Full hot key instructions for usage and commands are located in this manual, on page 21.

AutoScan

The AutoScan feature allows you to automatically scan and monitor the activities of all operating computers connected to your KVM Switch one by one. AutoScan usage instructions are located in this manual, on page 22.

Video Resolution

With a 400MHz bandwidth, the Switch is able to support video resolutions of up to 2048x1536@85Hz. To preserve signal integrity at high resolutions, 75-Ohm coaxial VGA cabling is required.

OVERVIEW

Flash Upgrade

Flash upgradeability allows you to obtain the latest firmware upgrades for your KVM Switch, when necessary. These upgrades will let your KVM Switch continue to be compatible with the latest devices and computers. Firmware upgrades are free for the lifetime of the product. Call Belkin Tech Support at 1-800-223-5546 ext. 2263 for upgrade information and support.

Microphone/Audio Support

The KVM Switch has been designed with built-in microphone and speaker jacks to support the growth of multimedia use in small-office and home-office environments. This feature eliminates the need to disconnect and reconnect these devices when switching between computers and reduces the clutter on your desktop with fewer speakers.

Direct-Access Port Selectors

Direct-access port selectors conveniently located on the front face of the KVM Switch allow for simple, manual port selection.

Cable Management

The designed enclosure offers built-in cable management to contain connected cables. Once the cables have been connected and the shroud slid into place, the cables are conveniently maintained through the back opening.

LED Display

An LED display is added to the face of the KVM Switch for easy status monitoring. A lit LED indicates which computer the console has control of. The corresponding direct-access port selector is located next to the LED. When pushed, the LED should light next to the direct-access port selector selected.

OVERVIEW

Equipment Requirements

Cables

For each PS/2 computer to be connected to the KVM Switch, one VGA cable, one PS/2 keyboard cable, and one PS/2 mouse cable is necessary. Keyboard and mouse cables must have PS/2 male to PS/2 male connectors. For USB computers, one VGA cable and one USB A to B cable is required.

To support resolutions of up to 2048x1536@85Hz, use of a 75-Ohm coaxial VGA cable is required to preserve signal integrity. Cables must have HDDB15 female to HDDB15 male connectors.

Belkin OmniView KVM Cables for SOHO Series with Audio offer the highest quality possible to ensure that your data is optimally transmitted. They are molded together for clean and organized setup, and include PC99 color-coded connectors for easier identification and connection. Cables are available in USB and PS/2 protocols. Please refer to your KVM Switch to determine if it supports USB. The following cables are recommended for your KVM Switch:

F1D9101-XX (USB Style)



F1D9100-XX (PS/2 Style) (-XX denotes the length in feet)

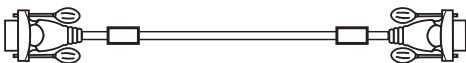
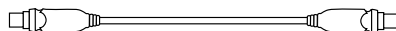

OVERVIEW

Operating Systems

OmniView SOHO Series KVM Switches with Audio are for use on CPUs using:

Platforms

- Windows® 95/98/2000/Me/NT®/XP
- DOS
- Linux®
- Novell® NetWare® 4.x/5.x
- Mac® OS* (F1DS102T and F1DS104T)
*with USB support

Keyboards

- Supports 101-/102-/104-/107-key keyboards

Mice

- PS/2 mice with 2, 3, 4, or 5 buttons, compatible with Microsoft®

Monitor

- VGA
- SVGA
- MultiSync®

Microphone

Multimedia microphone/stereo with 3.5mm connectors

Audio

Multimedia speaker/stereo with 3.5mm connectors

Optional Power Supply

An optional 9V, 600mA power supply is available. Visit belkin.com for ordering information.

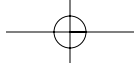

OVERVIEW

Unit Display Diagrams

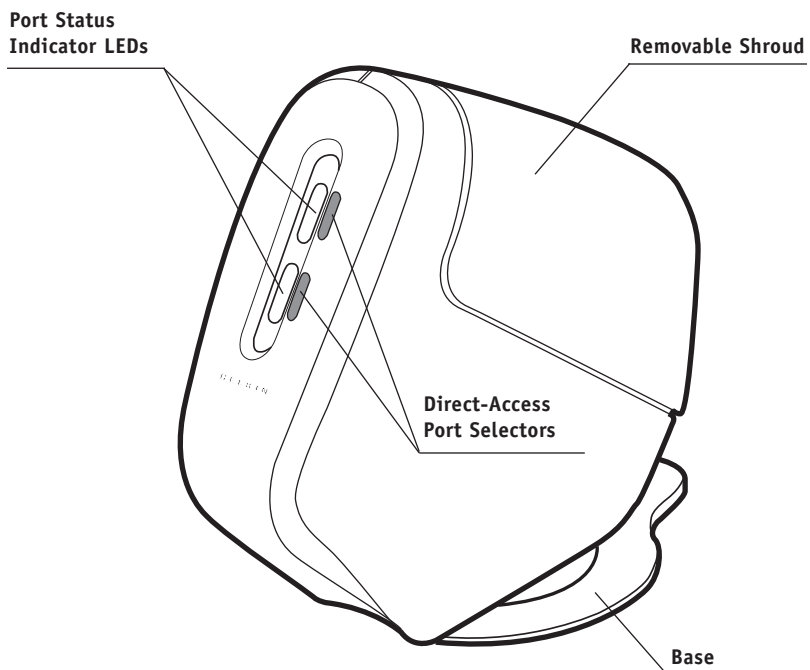

**Front View
Fig. 1**

OVERVIEW

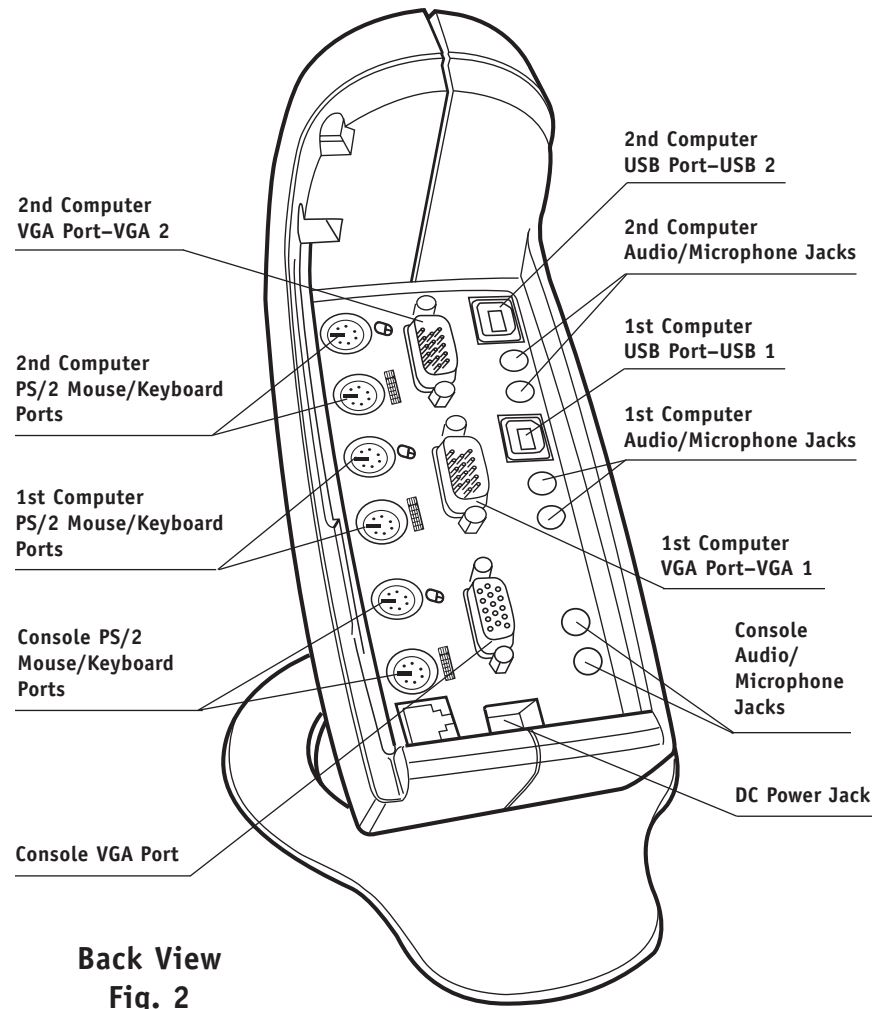

**Back View
Fig. 2**

SOHO Series 2-Port KVM Switch with Audio, PS/2 and USB shown

OVERVIEW

Specifications

Part No.: F1DS102P, F1DS104P

Power: By PS/2 keyboard port or optional 9V DC, 600mA AC adapter with center pin positive polarity

PCs Supported:
2 (F1DS102P)
4 (F1DS104P)

Keyboard Emulation: PS/2

Mouse Emulation: PS/2

Monitor Supported: VGA and SVGA MultiSync®, LCD (with use of adapter cable)

Max Resolution: 2048X1536@85Hz

Keyboard Input:
6-pin miniDIN (PS/2)

Mouse Input:
6-pin miniDIN (PS/2)

Audio Input/Output:
3.5mm jack

Microphone Input/Output:
3.5mm jack

VGA Port: 15-pin HDDB type

LED Indicators:
2 (F1DS102P)
4 (F1DS104P)

Enclosure: High-impact plastic

Dimensions:

F1DS102P
(H) 6.75 x (W) 4.25 x (D) 7.75 inches
(H) 17.2 x (W) 10.8 x (D) 19.7 centimeters

F1DS104P
(H) 7.75 x (W) 4.75 x (D) 9.5 inches
(H) 19.7 x (W) 12.1 x (D) 24.1 centimeters

Weight:

F1DS102P 1.5 lbs. (0.68kg.)

F1DS104P 2.0 lbs. (0.91kg.)

Operating Temp: 32° to 104° F (0° to 40° C)

Storage Temp: -4° to 140° F (-20° to 60° C)

Humidity: 0-80% RH, non-condensing

Warranty: 5 years

Part No.: F1DS102T, F1DS104T

Power: By PS/2 keyboard port, USB port, or optional 9V DC, 600mA AC adapter with center pin positive polarity

PCs Supported:
2 (F1DS102T)
4 (F1DS104T)

Keyboard Emulation: USB and PS/2

Mouse Emulation: USB and PS/2

Monitor Supported: VGA and SVGA MultiSync, LCD (with use of adapter cable)

Max Resolution: 2048X1536@85Hz

Keyboard Input: 6-pin miniDIN (PS/2)

Mouse Input: 6-pin miniDIN (PS/2)

Audio Input/Output: 3.5mm jack

Microphone Input/Output: 3.5mm jack

VGA Port: 15-pin HDDB type

LED Indicators:
2 (F1DS102T)
4 (F1DS104T)

Enclosure: High-impact plastic

Dimensions:

F1DS102T
(H) 6.75 x (W) 4.25 x (D) 7.75 inches
(H) 17.2 x (W) 10.8 x (D) 19.7 centimeters

F1DS104T
(H) 7.75 x (W) 4.75 x (D) 9.5 inches
(H) 19.7 x (W) 12.1 x (D) 24.1 centimeters

Weight:

F1DS102T 1.5 lbs. (0.68kg.)

F1DS104T 2.0 lbs. (0.91kg.)

Operating Temp: 32° to 104° F (0° to 40° C)

Storage Temp: -4° to 140° F (-20° to 60° C)

Humidity: 0-80% RH, non-condensing

Warranty: 5 years

Note: Specifications are subject to change without notice.

INSTALLATION

Pre-Configuration

Where to Place the KVM Switch

The compact size of the KVM Switch makes it perfect for desktop placement. Consider the following when deciding where to place the KVM Switch: whether or not you intend to use the direct-access port selectors; the length of the cables attached to your keyboard, mouse, and monitor; the location of your CPUs from your console; and the length of the cables you use to connect your computers to the KVM Switch.

Cable Distance Requirements

For PS/2 computers: VGA signals are best retained when transmitted up to 25 feet (7.6m). Beyond 25 feet (7.6m), probability of video degradation increases with an increase in distance. For this reason, your PS/2 computer should be placed within 25 feet (7.6m) of the KVM Switch.

Note: If your computer needs to be more than 25 feet (7.6m) from the KVM Switch, you can use the Belkin CAT5 Extender to extend your PS/2 keyboard, PS/2 mouse, and monitor up to 500 feet (152.4m) away using standard CAT5 UTP cable.

For USB computers: USB signals can be transmitted up to 15 feet (4.6m) between the KVM and the CPU. Beyond 15 feet (4.6m), probability of signal failure is likely.

Cautions and Warnings

Avoid having cables near fluorescent lights, air conditioning equipment, or machines that create electrical noise (e.g., vacuum cleaners).

INSTALLATION

Single-Switch Installation

This section provides complete instructions for the hardware setup of a single KVM Switch. (F1DS102P, F1DS104P, F1DS102T, or F1DS104T)

Important Note:

Before attempting to connect anything to the KVM Switch or into your computer(s), make sure that everything is powered off. Plugging and unplugging cables while computers are powered on may cause irreversible damage to the computers and KVM Switch. Belkin Corporation will not be responsible for damage caused by these actions.

Installing the KVM Switch Base

Hold the main housing with one hand and the base with the other. With the narrow part of the base facing toward the rear of the housing, align the hooks of the base to the base holes located underneath the housing. Put the hooks through the holes and push the base toward the front of the housing to lock the base into place. See Fig. 3.

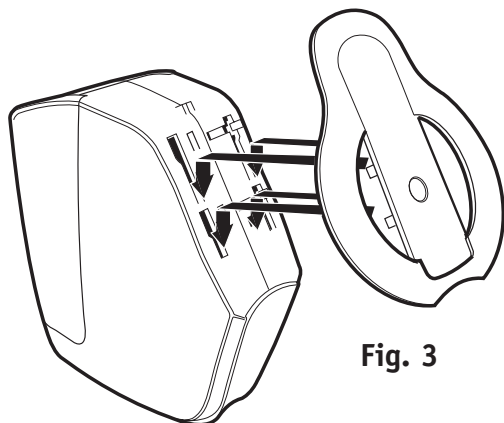

Fig. 3

INSTALLATION

PS/2 Installation

Keyboard, Video, and Mouse Connections

Connect the Console

1. Using the cable that is included with your monitor, connect it to the VGA port in the "Console" section of the KVM Switch. See Fig. 4.
2. Connect a PS/2 keyboard to the purple port in the "Console" section of the KVM Switch. See Fig. 5.
3. Connect a PS/2 mouse to the green port in the "Console" section of the KVM Switch. See Fig. 5.

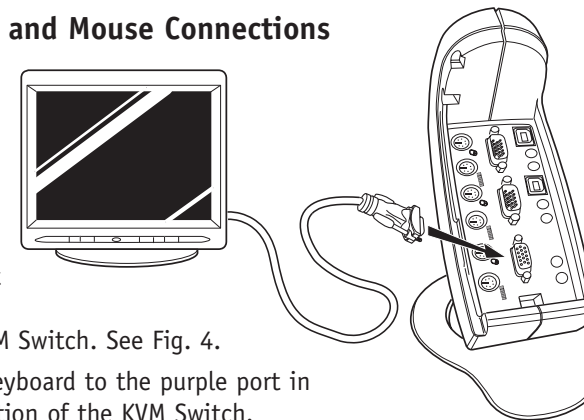

Fig. 4

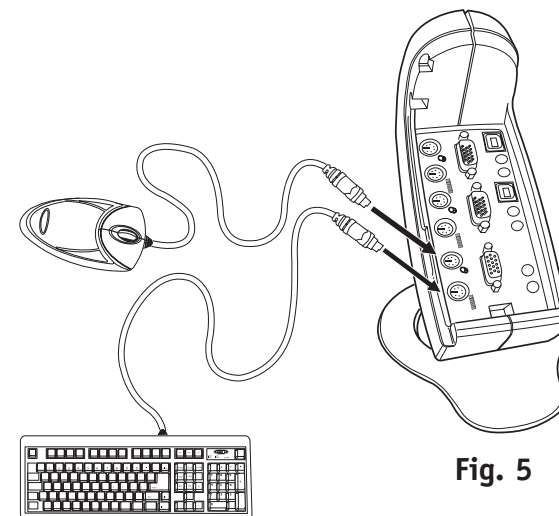

Fig. 5

INSTALLATION

Connect the Computer

- Using the VGA cable (Belkin part number F1D9100-XX), connect the male end of the cable to the VGA port of the computer, and the female end to the VGA port of the KVM Switch labeled "VGA1". See Fig. 6.

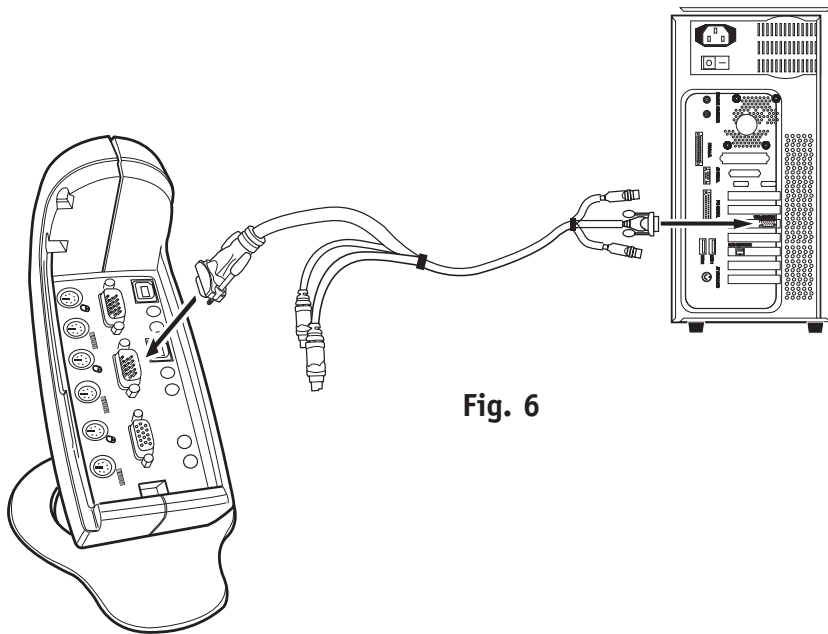

Fig. 6

INSTALLATION

- Connect the PS/2 keyboard and PS/2 mouse cables (Belkin part number F1D9100-XX), to the appropriate ports on the KVM Switch. See Fig. 7.

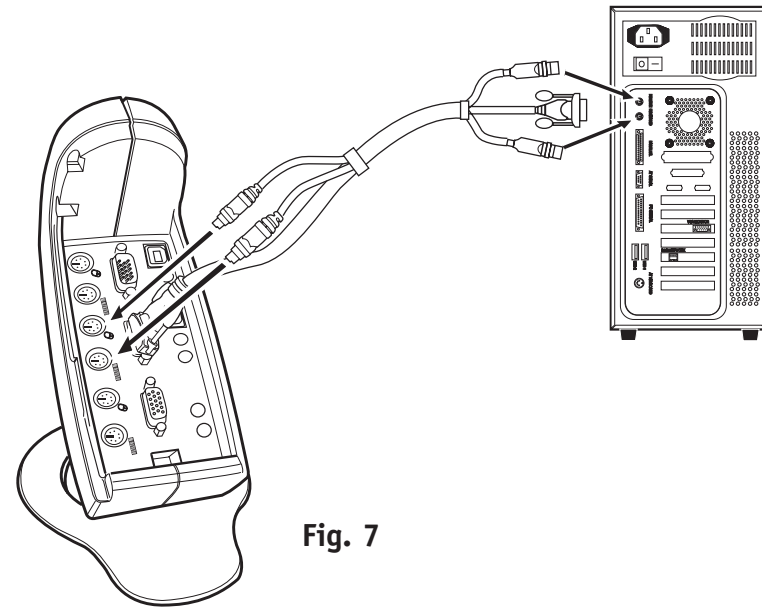

Fig. 7

- Repeat steps 4 and 5 for each additional computer you wish to connect.

INSTALLATION

Audio and Microphone Connections

Recommended Belkin OmniView KVM Cables for SOHO Series with Audio are included with Belkin part number F1D9100-XX

Note: Speakers and microphones are not required for use of your KVM Switch.

Connect the Audio

1. Using the audio cable attached to your speakers, connect the male 3.5mm plug to the lime audio jack in the "Console" section of the KVM Switch. See Fig. 8.

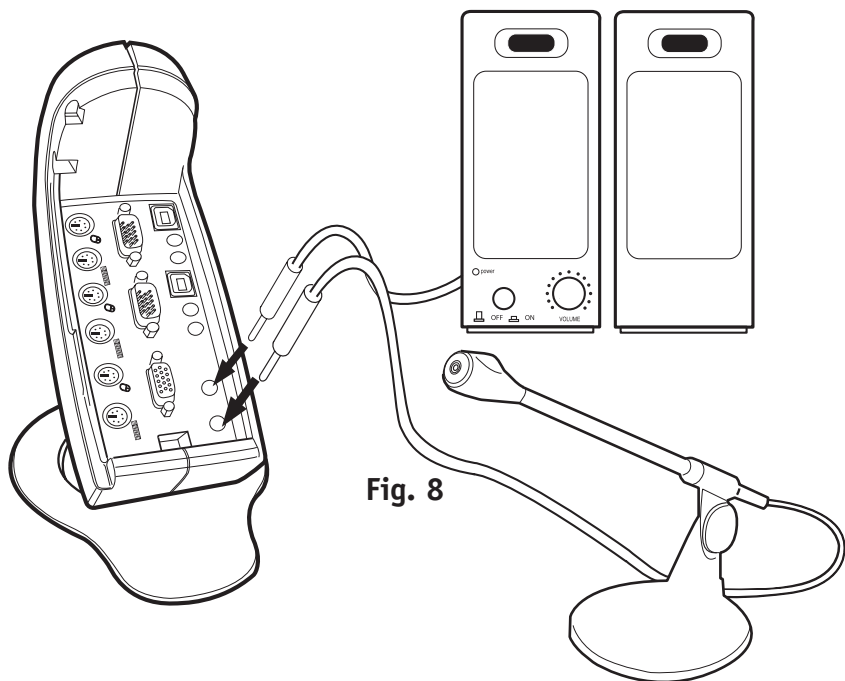

Fig. 8

INSTALLATION

2. Using the mic cable attached to your microphone, connect the male 3.5mm plug to the pink mic jack in the "Console" section of the KVM Switch. See Fig. 8.
3. Using the OmniView KVM Cable for SOHO Series with Audio (the KVM Cable), connect one end of the lime male 3.5mm plug to the speaker jack of your sound card or computer and connect the other end to the audio jack of the KVM Switch. See Fig. 9.
4. Using the KVM Cable, connect one end of the pink male 3.5mm plug to the mic jack of your sound card or computer and connect the other end to the pink mic jack of the KVM Switch. See Fig. 9.

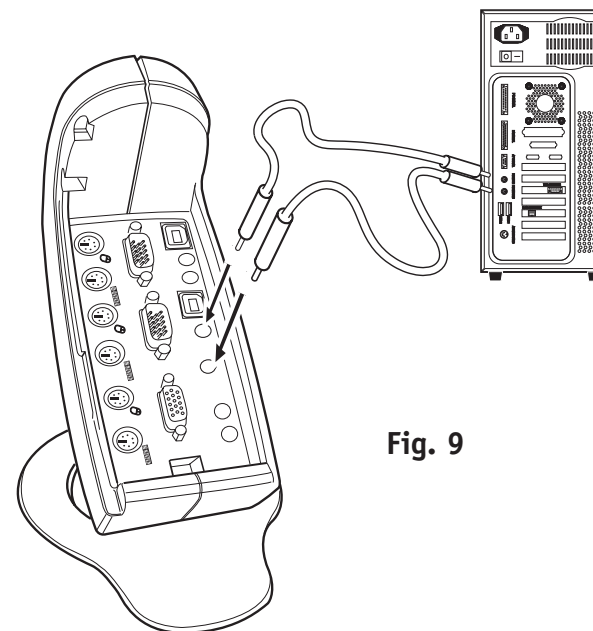

Fig. 9

INSTALLATION

USB Installation

Keyboard, Monitor, and Mouse Connections

Available on F1DS102T and F1DS104T models only

Note: On some computers, you must enable USB support on your system BIOS. Please reference your computer manufacturer's manual or motherboard manual to verify that USB support is enabled.

Connect the Console

1. Using the cable that is included with your monitor, connect it to the VGA port in the "Console" section of the KVM Switch. See Fig. 10.

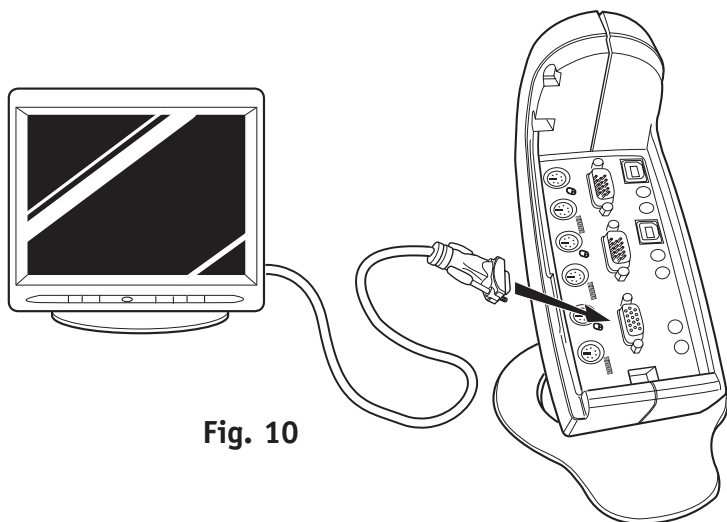

Fig. 10

INSTALLATION

2. Connect a PS/2 keyboard to the purple port in the "Console" section of the KVM Switch. See Fig. 11.

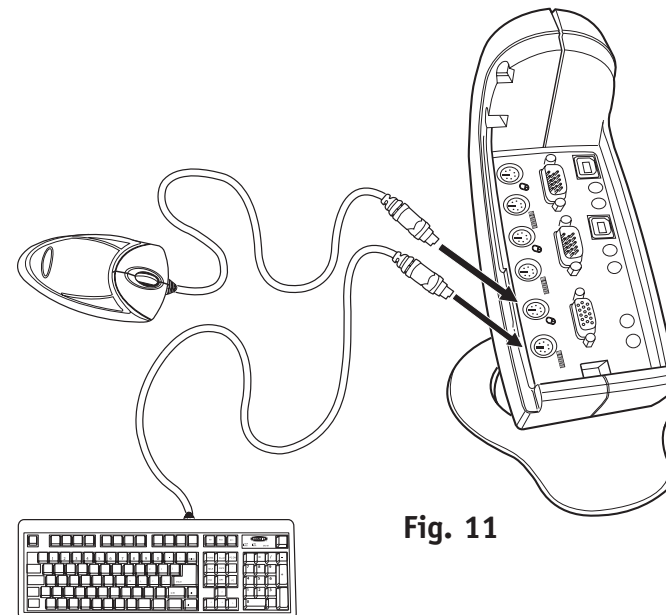

Fig. 11

3. Connect a PS/2 mouse to the green port in the "Console" section of the KVM Switch. See Fig. 11.
4. Power on your computer as you would normally and wait until your operating system completes loading. See Fig. 11.

INSTALLATION

Connect the Computer

- Using a standard USB A to B cable (we recommend Belkin part number F1D9101-XX), insert the end with the B-type connector to the KVM Switch. Insert the other end of the cable with the A-type connector to an available port on your USB computer or USB hub that is attached to your computer. See Fig. 12.
- Your computer should recognize the KVM Switch and will automatically install the HID USB driver if not already installed on your computer.

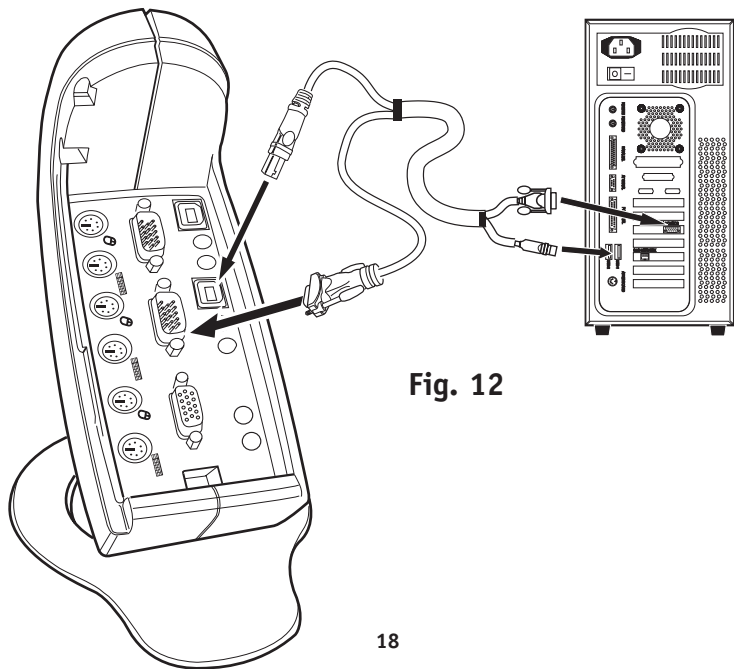

Fig. 12

INSTALLATION

Audio and Microphone Connections

Recommended Belkin OmniView KVM Cables for SOHO Series with Audio are included with Belkin part number F1D9101-XX.

Note: Speakers and microphones are not required for use of your KVM Switch.

Connect the Audio

- Using the audio cable attached to your speakers, connect the male 3.5mm plug to the lime audio jack in the "Console" section of the KVM Switch. See Fig. 13.

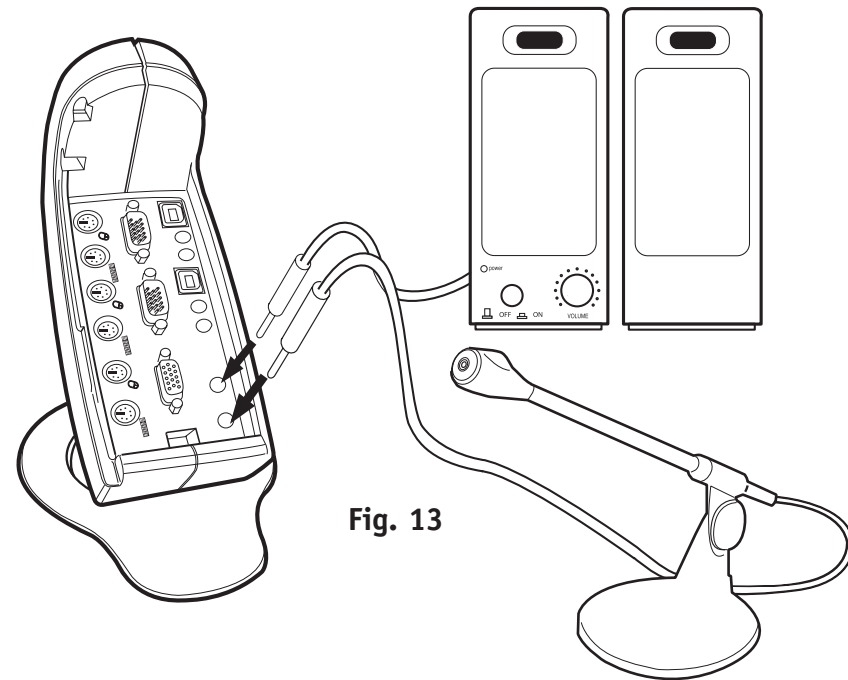

Fig. 13

- Using the mic cable attached to your microphone, connect the male 3.5mm plug to the pink mic jack in the "Console" section of the KVM Switch. See Fig. 13.

INSTALLATION

9. Using the OmniView KVM Cable for SOHO Series with Audio (the KVM Cable), connect one end of the lime male 3.5mm plug to the speaker jack of your sound card or computer and connect the other end to the lime audio jack of the KVM Switch. See Fig. 14.

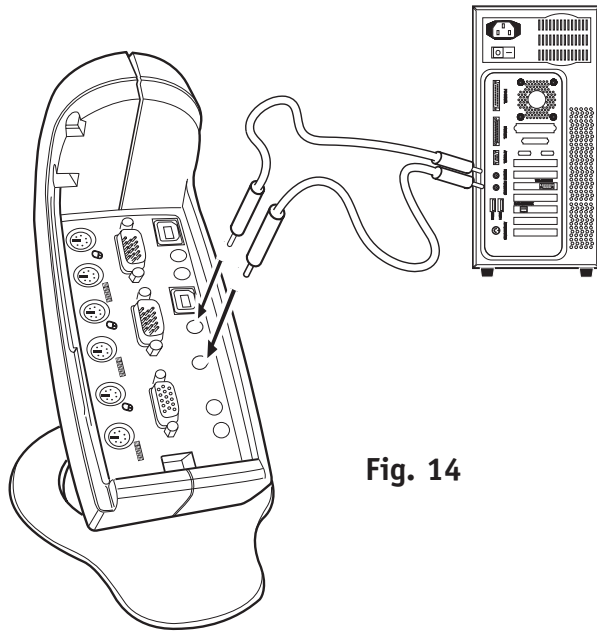

Fig. 14

10. Using the KVM Cable, connect one end of the pink male 3.5mm plug to the mic jack of your sound card or computer and connect the other end to the pink mic jack of the KVM Switch. See Fig. 14.

USING YOUR KVM SWITCH

Powering Up the Systems

Once all cables have been connected, power up the CPUs that are attached to the KVM Switch. All computers can be powered on simultaneously. The KVM Switch emulates a mouse and keyboard on each port and allows your computer to boot normally. Your KVM Switch should now be ready for use.

You can select which computer to operate by either the direct-access port selectors located on the front panel of the KVM Switch or through keyboard hot key commands. Note that it will take 1–2 seconds for the video to display after switching. This is due to the refresh of the video signal. There is also re-synchronization of the mouse and keyboard signal that takes place. This is normal operation and ensures that proper synchronization is established.

Selecting a Computer Using Direct-Access Port Selectors

You can directly select which computer you wish to control by pressing the corresponding direct-access port selector next to the appropriate port. The LED will be lit to indicate that the port is currently selected.

Selecting a Computer Using Keyboard Hot Key Commands

You can command the KVM Switch to switch ports with a simple keyboard command sequence by using the “SCROLL LOCK” key and up/down arrow keys. To send commands to the KVM Switch, the “SCROLL LOCK” key must be pressed twice within two seconds. You will hear a beep for confirmation. Then you can press the up/down arrow keys to switch between ports.

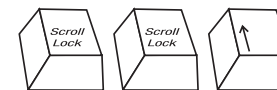

Switch to next active port,
up arrow

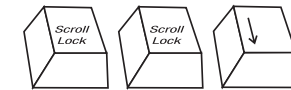

Switch to previous active port,
down arrow

USING YOUR KVM SWITCH

You can switch directly to any port by entering the port number of the port you wish to use. For example, if you press "SCROLL LOCK", "SCROLL LOCK", "2", the computer on port 2 will be selected.

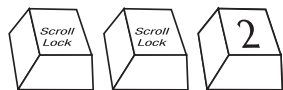

Switch to port 2—#2 key

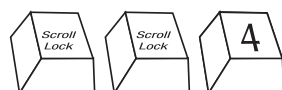

Switch to port 4—#4 key

AutoScan Mode

In AutoScan mode the KVM Switch remains on one port for 10 seconds before switching to the next. This time interval cannot be changed.

To enable AutoScan mode press "SCROLL LOCK", "SCROLL LOCK", "0".

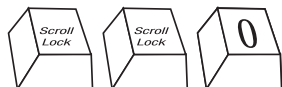

Enable AutoScan mode—#0 key

Note: There is no mouse or keyboard control in this mode. This is necessary to prevent errors. Otherwise, if the user is moving the mouse or using the keyboard when the unit switches to the next port, communication between the computer and KVM Switch could be interrupted and cause erratic mouse movement, or wrong characters to display when using the keyboard.

To disable AutoScan mode, press the space bar.

BELKIN KVM SWITCHES AND ACCESSORIES

OmniView KVM Switches

OmniView E Series

These KVM devices allow you to control two or four computers from one console and make switching between computers more convenient. Designed for compatibility with your PS/2 platform, they reduce desktop clutter and provide a simple, reliable solution at a lower price point. High-quality resolution of up to 2048x1536@85Hz is supported through the E Series KVM Switch when used with coaxial VGA cabling, offering the highest resolution without compromising the quality of the display. Power for the KVM Switch draws off of the keyboard, meaning no power supply is necessary and less cables to hassle with. Other standard features found on this unit include: hot key functionality; PS/2 keyboard and mouse emulations for error-free boot up; and a Belkin Two-Year Warranty.

F1DB102P E Series 2-Port KVM Switch, PS/2

F1DB104P E Series 4-Port KVM Switch, PS/2

OmniView SOHO Series with Audio

This innovative design provides built-in cable management and uses little space while adding a whole new sculpted look to your desktop. The PS/2 KVM Switch allows you to control two or four computers from one console. Its convenient PS/2 compatibility makes it ideal for use with PS/2 computers. The greatest interface flexibility is yours with PS/2 and USB Switches. They offer you expanded compatibility with either interface, or both, along with the additional convenience of direct-access port selectors on the face of the Switch. The USB KVM Switch offers support for USB computers and consoles. It includes a built-in, 2-port USB device hub that allows you to connect additional shared peripherals. Switch between speakers and microphones without having to unplug and re-plug them when switching computers. The flash feature allows users to download firmware updates to ensure compatibility with the latest computers and devices. The designed enclosure offers cable management in a neat and convenient manner. High-quality resolution of up to 2048x1536@85Hz is supported by the SOHO Series KVM Switch when used with coaxial VGA cabling, offering the highest resolution without compromising the quality of the display. Other standard features found on this unit include: hot key functionality; keyboard and mouse emulations for error-free boot up; and a Belkin Five-Year Warranty.

BELKIN KVM SWITCHES AND ACCESSORIES

F1DS102P SOHO Series 2-Port KVM Switch with Audio, PS/2
 F1DS104P SOHO Series 4-Port KVM Switch with Audio, PS/2
 F1DS102U SOHO Series 2-Port KVM Switch with Audio, USB
 F1DS104U SOHO Series 4-Port KVM Switch with Audio, USB
 F1DS102T SOHO Series 2-Port KVM Switch with Audio, PS/2 & USB
 F1DS104T SOHO Series 4-Port KVM Switch with Audio, PS/2 & USB

OmniView PRO2 Series with On-Screen Display

OmniView PRO2 Series KVM Switches deliver reliability, performance, and centralized control necessary for today's enterprise environment. This series of KVM Switches enables you to control multiple platform servers from a single console. Available in the desktop-style, 4-port, and the 19-inch rack-mountable. 8- and 16-port models, the OmniView PRO2 Series KVM Switch expands easily for full control of as many as 256 CPUs through dedicated daisy-chain ports. Video resolutions of up to 2048x1536@85Hz are supported through a 400MHz bandwidth. On-Screen Display allows you to name and select attached servers using an on-screen interface. Switch between ports by using hot key commands or direct-access port selectors. The PRO2 Series uses standard cables for easy installation; includes a 12-volt DC, 1-Amp power supply; and is backed by a Belkin Five-Year Warranty.

F1DA104T PRO2 Series 4-Port KVM Switch with On-Screen Display, PS/2 & USB

F1DA108T PRO2 Series 8-Port KVM Switch with On-Screen Display, PS/2 & USB

F1DA116T PRO2 Series 16-Port KVM Switch with On-Screen Display, PS/2 & USB

OmniView MATRIX2 Series with Dual-Console Control

OmniView MATRIX2 Series 8- and 16-Port KVM Switches enable two administrators to control up to eight or 16 PS/2 and USB platform servers, separately or simultaneously. Each user operates a separate console following a different bus path for complete independence from the other console. The OmniView MATRIX2 Series KVM Switch expands easily for full control of as many as 256 computers through dedicated daisy-chain ports and is natively rack-mountable for server room environments. Video resolutions of up to 2048x1536@85Hz are supported through a 400MHz bandwidth. On-Screen Display allows you to name and select attached servers using an on-screen interface. Switch between ports by using hot key commands or direct-access port selectors. The MATRIX2 Series uses standard cables for easy installation; includes a 12-volt DC, 1-Amp power supply; and is backed by a Belkin Five-Year Warranty.

F1DM208T MATRIX2 Series 8-Port KVM Switch with Dual-Console Control, PS/2 & USB

F1DM216T MATRIX2 Series 16-Port KVM Switch with Dual-Console Control, PS/2 & USB

BELKIN KVM SWITCHES AND ACCESSORIES

OmniView KVM Cables

OmniView KVM Cables provide you with the quality connections necessary to set up your KVM solution. Each kit provides the proper cables and connectors to complete the installation of a Belkin OmniView KVM Switch. OmniView KVM Cables feature sturdy, strain-relief construction and PVC overmolding to prevent data loss. Use of 20-gauge wire delivers the high-performance cable that users have come to identify with the Belkin name. A ferrite bead reduces electromagnetic and radio frequency interference (EMI/RFI). PC99 color-coded connectors and modified thumbscrews have been added for easier installation.

OmniView E Series KVM Cables

Belkin E Series Cables allow you to connect all your PS/2 computers to your KVM Switch while offering high performance.

- Industry-standard, 14-pin coaxial VGA cabling
- Nickel-plated connectors
- Gray PVC Flextec jacket

Work with OmniCube™, OmniView SE, PRO, MATRIX, E, SOHO, PRO2 Series, and many other KVM Switches.

F1D9000-XX, PS/2 Style

OmniView SOHO Series KVM Cables with Audio

SOHO Series Cables provide you with the proper connection between your computers, speakers, and microphones, and your SOHO Series KVM Switch.

- Industry-standard, 14-pin coaxial VGA cabling
- One All-In-One 3.5mm audio/mic cable
- Nickel-plated connectors
- Gray PVC Flextec jacket

Work with OmniView SOHO Series KVM Switches.

F1D9100-XX, PS/2 Style

F1D9101-XX, USB Style

BELKIN KVM SWITCHES AND ACCESSORIES

OmniView PRO Series Plus All-In-One KVM Cables

Belkin PRO Series Plus Cables allow you to easily connect all your computers and servers to your OmniView KVM Switches, and are molded together for better cable management.

- All-In-One molded design for cable management
- Industry-standard, 14-pin coaxial VGA cable
- Nickel-plated connectors
- Gray PVC Flextec jacket

Work with OmniCube, OmniView SE, PRO, MATRIX, E, SOHO, PRO2 Series, and many other KVM Switches.

F3X1105-XX, PS/2 Style

F3X1962-XX, USB Style

OmniView MATRIX Series All-In-One KVM Cables

Belkin MATRIX Series Cables provide optimum connectivity between each of your servers and your MATRIX2 Series KVM Switches. The MATRIX Series Cables use advanced micro-cable construction to deliver fast and reliable data transfers.

- Advanced, micro-cable construction
- All-In-One molded design for cable management
- Industry-standard, 14-pin coaxial VGA wiring
- Nickel-plated connectors
- Gray PVC Flextec jacket

Work with OmniView MATRIX2 Series KVM Switches.

F1D9300-XX, PS/2 Style

F1D9301-XX, USB Style

BELKIN KVM SWITCHES AND ACCESSORIES

OmniView Gold Series All-In-One KVM Cables

Belkin Gold Series Cables offer the highest-possible cable performance, providing maximum conductivity and error-free data transmission. These cables allow you to easily connect all your computers and servers to your OmniView KVM Switches, and are molded together for better cable management.

- All-In-One molded design for cable management
- Custom, 15-pin coaxial VGA cabling
- 24K gold-plated connectors
- Black PVC Flextec jacket

Work with OmniCube, OmniView SE, PRO, MATRIX, E, SOHO, PRO2 Series, and many other KVM Switches.

F3X1835-XX-GLD, PS/2 Style

F3X1895-XX-GLD, USB Style

OmniView Daisy-Chain Cables

These cables let you daisy-chain multiple KVM Switches together to expand the size of your PRO2 or MATRIX2 Series KVM configuration. Made of premium wires and coaxial VGA lines, these cables preserve signal integrity from the first to the last computer.

For PRO2: F1D108-CBL (Available in lengths of 2 and 6 feet)

For MATRIX2: F1D9302-XX (Available in lengths of 1, 3, and 5 feet)

(-XX denotes the length in feet)

BELKIN KVM SWITCHES AND ACCESSORIES

OmniView KVM Accessories and Adapters

Belkin KVM technology includes various accessories and adapters to complete your KVM solution. The adapter series converts Mac®, Sun™, or USB keyboards, video, and mouse signals into PS/2 and VGA.

F1D080 – The OmniView PS/2 Mac Adapter™ converts a Macintosh® computer with a 4-pin ADB™ (Apple® Desktop Bus) and DB15 connector into a PS/2 keyboard, HDDB15 VGA monitor, and PS/2 mouse.

F1D082 – The OmniView PS/2 Sun Adapter™ converts a Sun 8-pin keyboard/mouse and 13W3 video into a PS/2 keyboard, PS/2 mouse, and VGA monitor.

F1D084 – The OmniView CAT5 Extender enables you to control a PC or KVM Switch up to 500 feet (152.4m) away using standard UTP CAT5 cabling.

F1D087 – The OmniView Keyboard Extender allows you to extend your keyboard up to 250 feet (76.2m) away.

F1D088 – The OmniView VGA Monitor Extender bridges up to 250 feet (76.2m) of distance between your PC and monitor.

F1D089 – The OmniView Keyboard Splitter allows you to work with two kinds of PS/2 keyboards and pointing devices without swapping cables or rebooting the computer.

F1D090 – The OmniView Mouse Splitter allows you to work with two kinds of PS/2 mice or trackballs without swapping cables or rebooting the computer.

F1D201 – The OmniView 2-Port Reverse KVM Switch gives two users central control of one PC from two sets of keyboards, monitors, and mice.

F5U119 – The Belkin PS/2-to-USB Adapter converts PS/2 keyboard and mouse signals to USB format.

F1DR200 – The OmniView SOHO Series 2-Port Replacement Kit includes shroud, base, flash cable, two PS/2 extension cables, and SOHO Series User Manual.

F1DR400 – The OmniView SOHO Series 4-Port Replacement Kit includes shroud, base, flash cable, two PS/2 extension cables, and SOHO Series User Manual.

OmniView Power Supplies

F1DS001-PWR – 9V AC, 1A

F1D084-PWR – 9V AC, 500mA

F1D065-PWR – 9V DC, 600mA

F1D108-PWR – 12V DC, 1A

FAQs

Q: What operating systems does the KVM Switch support?

A: The KVM Switch will support any operating system that runs on a PS/2 and USB platform. It will also work with non-USB-enabled Sun and Mac operating systems using the appropriate adapters (Belkin OmniView PS/2 Sun Adapter—F1D082 and OmniView PS/2 Mac Adapter—F1D080). Operating systems include, but are not limited to, DOS, Windows 95/98/2000/Me/NT/XP, Linux, Mac OS.

Q: What does flash-upgrade capability mean?

A: With flash-upgrade capability, you can update your KVM Switch firmware when needed through a simple connection. Internet-upgrade capability ensures that your KVM Switch works with the most current computers and devices.

Q: Does the KVM Switch support Microsoft IntelliMouse®?

A: The KVM Switch supports mice from Microsoft, Logitech®, Kensington®, and Belkin. Please contact Belkin Technical Support for compatibility issues you may experience.

Q: How does the KVM Switch allow the user to switch between ports?

A: The KVM Switch supports two methods of port selection. The user can select computers using specially designated keyboard hot keys, or can independently access the desired port by directly interfacing with the direct-access port selectors.

Q: How far can the second user be from the KVM Switch?

A: When using PS/2 connections, the KVM Switch can be up to 25 feet (7.6m) away from your computer. If your computer needs to be more than 25 feet (7.6m) from the KVM Switch, you can use the Belkin CAT5 Extender to extend your PS/2 keyboard, PS/2 mouse, and monitor up to 500 feet (152.4m) away using standard CAT5 UTP cable. When using a USB connection between your KVM Switch and computer, we recommend that your computer be no more than 15 feet (4.6m) from the KVM Switch.

FAQs

Q: What is the maximum video resolution that the KVM Switch supports?

A: The advanced video circuit in the KVM Switch supports a maximum resolution of 2048x1536@85Hz. Higher-resolution support is ideal for graphic artists and designers who depend on high-quality video.

Q: What video bandwidth does the KVM Switch support?

A: The KVM Switch supports 400MHz of video bandwidth.

Q: What is the difference between the SOHO Series KVM Switch and the E Series KVM Switch?

A: The SOHO Series KVM Switch offers additional audio and microphone support; a space-saving desktop design; cable management; flash-upgrade capability; and USB option.

Q: Can PS/2 and USB connections be used simultaneously on the same port?

A: No, you must use one or the other per CPU port on the KVM Switch.

Q: What are the benefits of the SOHO Series KVM Switch's supporting audio and microphone inputs and outputs?

A: The SOHO Series KVM Switch is perfect for the home- and small-office user who commonly uses multimedia. With multimedia support you do not need an extra set of speakers for each computer that is connected to your KVM unit.

Q: Do I have to install any software to use the KVM Switch?

A: No, the KVM Switch does not require any drivers or software to be installed in your computers. Simply connect all your computers to the PC ports on the KVM Switch, then attach one keyboard, monitor, and mouse to the "Console" port and it is ready for use.

FAQs

Q: Does the KVM Switch require an AC adapter?

A: The KVM Switch can be powered by the PS/2 keyboard port of your computer. An optional 9V DC, 600mA power adapter with center pin positive polarity may be used for instances where power cannot be drawn from a PS/2 port of a computer. The KVM Switch can also be powered from the USB port (available on the F1DS102T and F1DS104T only).

Q: Can I use the KVM Switch to switch video signals only?

A: Yes, you may use the KVM Switch to switch between video signals only without having to connect the keyboard and mouse. The keyboard and mouse should be connected directly to the computer that the video signal is taken from to ensure that your computer functions properly.
Note: The KVM Switch will require the use of the optional AC power adapter since power cannot be drawn from the computer via USB or keyboard.

Q: Can I use the USB SOHO Series KVM Switch on my Sun computer that supports USB?

A: Yes, the USB SOHO Series KVM Switch works with any USB-capable computer.

Q: Does the USB SOHO Series KVM Switch support Linux?

A: Yes, the USB SOHO Series KVM Switch works with all Linux kernels configured for USB support.

Q: Does the KVM Switch support Microsoft keyboards?

A: Yes, the KVM Switch is compatible with Microsoft Internet Keyboard PRO, Natural[®] Keyboard PRO, and Logitech keyboards with up to standard 107-key support only.

Q: How long is the warranty for the KVM Switch?

A: The KVM Switch comes with a five-year limited warranty.

TROUBLESHOOTING

VIDEO

I am getting ghosting, shadowing, or fuzzy images on my monitor.

- Check that all video cables are inserted properly.
- Check that the monitor you are using supports the resolution and refresh-rate setting on your computer.
- Check that the graphics card you are using supports the resolution and refresh-rate setting on your computer.
- Connect the monitor directly into the computer you are having trouble with to see if the problem still appears.

I am getting a black screen on my monitor.

- Check that all video cables are inserted properly.
- If you are not using a power adapter, check that the keyboard cable is connected and inserted properly between the computer and KVM Switch for the appropriate port.
- If you are using the KVM Switch for video switching only and have no keyboard and mouse connection between the KVM Switch and PC, you will need to purchase the optional 9V DC, 600mA power adapter (F1D065-PWR for your appropriate country).
- Connect your monitor directly to the computer to verify that your monitor is functioning properly.

TROUBLESHOOTING

KEYBOARD

Computer does not detect keyboard and I get a keyboard error reported at boot up.

- Check that the keyboard cable between the KVM Switch and the computer is connected properly. Tighten any loose connections.
- Try swapping your keyboard with a different one.
- Try connecting the computer to a different port.
- If you are using the keyboard software that was included with your keyboard, uninstall it and install the standard Microsoft keyboard driver.

MOUSE

Mouse is lost when I switch to a different channel.

- Check that the mouse you are using is connected properly to the console of the KVM Switch.
- If you are using a mouse driver that was included with your mouse, uninstall it and install the standard Microsoft mouse driver.
- Disconnect and reconnect the mouse cable attached to the channel with which you are experiencing problems to re-synchronize the mouse connection.
- Attach the mouse directly to the computer you are experiencing mouse problems with.
- If the computer just awoke from standby mode, allow up to one minute to regain mouse function.
- Deactivate power-management schemes on the PC that you are experiencing problems with.
- Try swapping the mouse with a different one.

TROUBLESHOOTING

The mouse is not detected at boot up.

- Check the cables and make sure that they are inserted properly.

The computer boots up fine, but the mouse does not work.

- Make sure it is plugged in properly.
- Make sure the mouse works when directly plugged into the computer. Rebooting may be necessary when trying this.
- Try a different mouse.

When I switch from one port to another, mouse movement is completely erratic.

- Make sure you do not have more than one mouse driver installed.
- Make sure that the driver is either for a standard PS/2 mouse or a PS/2 mouse compatible with Microsoft.
- Make sure you do not have any mouse drivers loaded in your "CONFIG.SYS" or "AUTOEXEC.BAT" files.
- Avoid moving the mouse or pressing the mouse button when switching ports on the KVM Switch.
- You can reset the mouse and resume proper mouse movement simply by unplugging the mouse from the front of the KVM Switch for about 2–3 seconds, and then plugging it in again.

TROUBLESHOOTING

GENERAL

My computer does not boot when connected to the KVM Switch and works fine when I connect the keyboard, video, and mouse directly to it.

- Make sure that the keyboard and mouse cables are connected tightly between the KVM Switch and the computer.
- Check that the keyboard and mouse cables are not crossed.

USB – (F1DS102T, F1DS104T) only

I am connecting my computer to the USB SOHO Series KVM Switch via USB and my keyboard and mouse do not work.

- Prior to connecting the USB SOHO Series KVM Switch, make sure that the HID USB driver is installed on each computer. (To install the HID USB driver, connect a USB mouse and USB keyboard to the computer. Windows should automatically install the drivers.)

Some of the keys on my keyboard are not functioning properly when I use a Mac computer.

- Because you are using a PC keyboard on a Mac computer, a few of the option keys on your PC keyboard may be reversed. All major keys will function as labeled.

AUDIO AND MICROPHONE

I have connected the speakers to the KVM Switch and I am not getting any sound from my computer.

- Check that the sound is enabled on the computer by going into the system setting.
- Check that the volume is turned up in your sound configuration.
- Make sure that the audio cable is connected properly and connected to the appropriate connector.
- Check that the speakers you are using are functioning properly.

WARRANTY, FCC, CE, ICES STATEMENT

FCC Statement

DECLARATION OF CONFORMITY WITH FCC RULES FOR ELECTROMAGNETIC COMPATIBILITY

We, Belkin Corporation, of 501 West Walnut Street, Compton, CA 90220, declare under our sole responsibility that the products:

F1DS102T, F1DS104T
F1DS102P, F1DS104P

to which this declaration relates:

Comply with Part 15 of the FCC Rules. Operation is subject to the following two conditions:
(1) this device may not cause harmful interference, and (2) this device must accept any interference received, including interference that may cause undesired operation.

CE Declaration of Conformity

We, Belkin Corporation, declare under our sole responsibility that the products F1DS102T, F1DS104T, F1DS102P, and F1DS104P, to which this declaration relates, are in conformity with Emissions Standard EN55022 and with Immunity Standard EN55024, LVP EN61000-3-2, and EN61000-3-3.

ICES

This Class B digital apparatus complies with Canadian ICES-003. Cet appareil numérique de la classe B est conforme à la norme NMB-003 du Canada.

Belkin Corporation Limited Five-Year Product Warranty

Belkin Corporation warrants this product against defects in materials and workmanship for its warranty period. If a defect is discovered, Belkin will, at its option, repair or replace the product at no charge provided it is returned during the warranty period, with transportation charges prepaid, to the authorized Belkin dealer from whom you purchased the product. Proof of purchase may be required.

This warranty does not apply if the product has been damaged by accident, abuse, misuse, or misapplication; if the product has been modified without the written permission of Belkin; or if any Belkin serial number has been removed or defaced.

THE WARRANTY AND REMEDIES SET FORTH ABOVE ARE EXCLUSIVE IN LIEU OF ALL OTHERS, WHETHER ORAL OR WRITTEN, EXPRESSED OR IMPLIED. BELKIN SPECIFICALLY DISCLAIMS ANY AND ALL IMPLIED WARRANTIES, INCLUDING, WITHOUT LIMITATION, WARRANTIES OF MERCHANTABILITY AND FITNESS FOR A PARTICULAR PURPOSE.

No Belkin dealer, agent, or employee is authorized to make any modification, extension, or addition to this warranty.

BELKIN IS NOT RESPONSIBLE FOR SPECIAL, INCIDENTAL, OR CONSEQUENTIAL DAMAGES RESULTING FROM ANY BREACH OF WARRANTY, OR UNDER ANY OTHER LEGAL THEORY, INCLUDING BUT NOT LIMITED TO LOST PROFITS, DOWNTIME, GOODWILL, DAMAGE TO OR REPROGRAMMING, OR REPRODUCING ANY PROGRAM OR DATA STORED IN OR USED WITH BELKIN PRODUCTS.

Some states do not allow the exclusion or limitation of incidental or consequential damages or exclusions of implied warranties, so the above limitations of exclusions may not apply to you. This warranty gives you specific legal rights, and you may also have other rights that vary from state to state.