

Universal Wireless AV Adapter

USER MANUAL

8820-00867 Rev. A00

F7D4550v1

Ok mk 7/27/11

TABLE OF CONTENTS

Getting Started

What's in the Box

How to Set It Up

Where to Place Your Universal Wireless AV Adapter

Getting to Know Your Universal Wireless AV Adapter

Front Panel

Back Panel

Technical Details

Technical Features

System Requirements

Using Your Universal Wireless AV Adapter

Updating the Firmware via the Web Interface

Resetting the Universal Wireless AV Adapter

Restoring your Universal Wireless AV Adapter to Factory Defaults

Troubleshooting, Support, and Warranty

Troubleshooting

Technical Support

Belkin International, Inc., Limited 2-Year Product Warranty

Regulatory Information

FCC Statement

Getting Started

What's in the Box

Universal Wireless AV Adapter

Ethernet Cable
Power Supply
Quick Installation Guide
Belkin CD with User Manual

How to Set It Up

To get started, you will need:

Wireless router, with its network name and password

Personal Computer

Web Browser

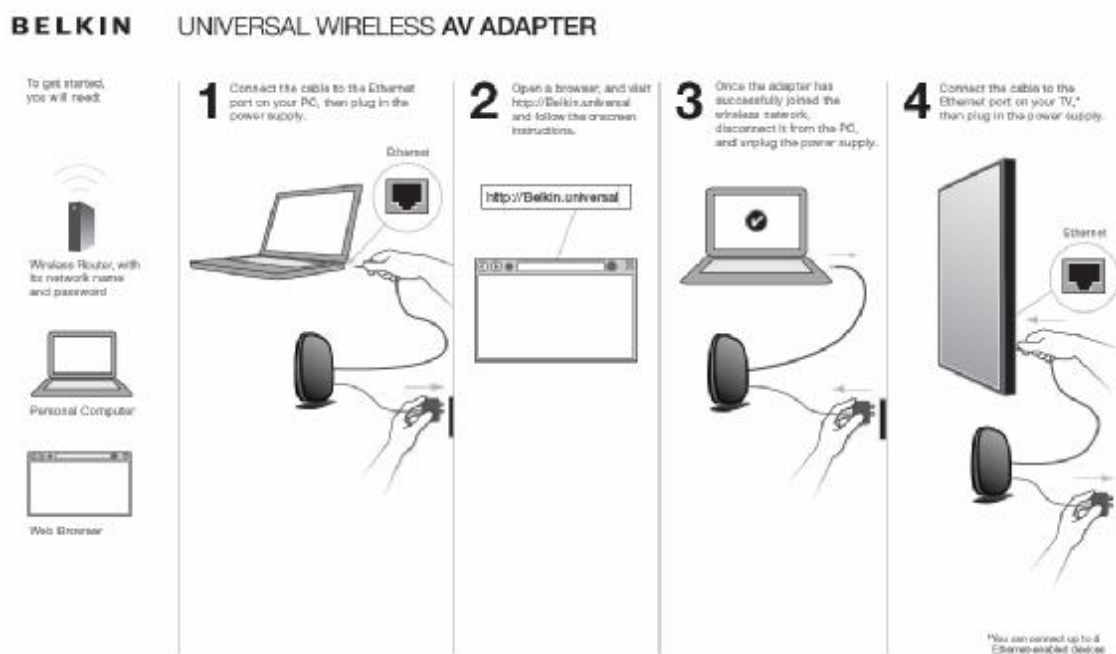

- 1) **Connect your Adapter's Ethernet cable to your PC's Ethernet port. Plug the Adapter's power supply into a wall outlet.**
- 2) **Open an Internet browser and type: <http://belkin.universal> into the address bar. A "Welcome screen" will appear to guide you through the Adapter setup.**
Browsers supported: Firefox® 3.5 and above, Internet Explorer® 6 and above, Google Chrome™ 7 and above, Safari® 4 and above

Note: Default language is English. You may change languages by clicking on the language icon and choosing from the available options.



- a. Click the “Get Started” button to begin the setup process.
 - b. Follow the directions on your browser to set up your device.
- 3) Once the Adapter has successfully joined the wireless network, disconnect it from the PC, and unplug the power supply.**

4) Connect your Adapter's Ethernet cable to your TV's Ethernet port*. Plug the Adapter's power supply into a wall outlet.

*You can connect up to 4 Ethernet-enabled devices.

Where to Place Your Universal Wireless AV Adapter

For the best results, place the Universal Wireless AV Adapter (the Adapter) next to your TV or AV equipment in an open location away from large metal objects and magnets such as those found in speakers. Raising the Adapter above floor level can improve the strength of your wireless signal.

Note: Once set up, the device needs to be restored to factory defaults (either via firmware GUI or via holding the reset button for 10 seconds, and then repeating the setup process).

Getting to Know Your Universal Wireless AV Adapter

Front Panel

Front Panel

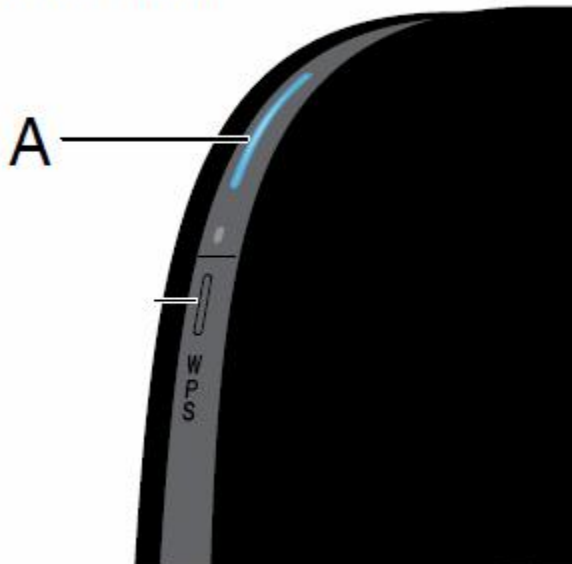

Modify the diagram to remove the line below "A"

A) Universal Wireless AV Adapter Status Light

Your Adapter's status is shown by the light on the front.

Off: The Adapter is not plugged into a power source.

Blinking Blue: The Adapter is starting up.

Blinking Blue/Amber: Indicates the Adapter needs to be set up.

Solid Blue: The Adapter is connected to the Wi-Fi® network.

Solid Amber: The Adapter is connected to the Wi-Fi network, but the signal is weak. You may experience performance problems. Consider moving the Adapter closer to the wireless router.

Blinking Amber:

The Adapter is not connected to the Wi-Fi network. Check to make sure that your wireless router is functioning properly, and/or move the Adapter closer to the wireless router.

Back Panel

Modify the diagram to

- Remove the “dot” above USB port (C)
- Remove connectors A, C and re-label

Back Panel

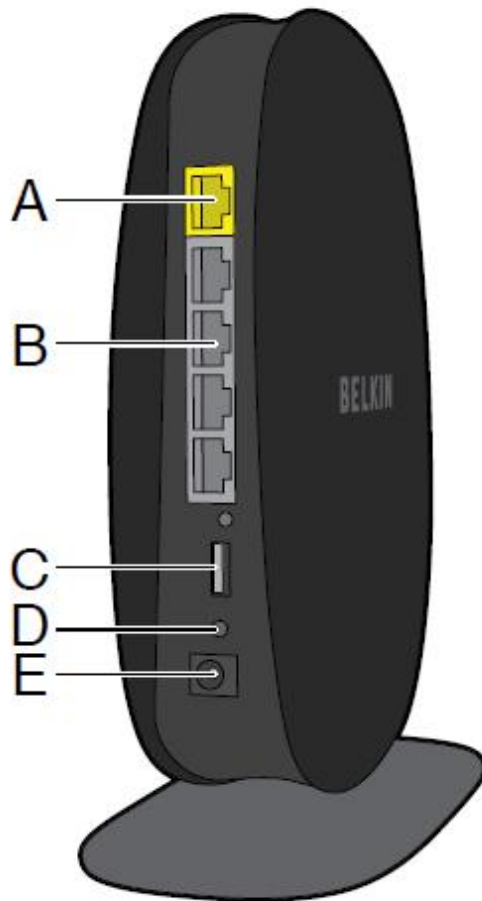

A) Wired (LAN) Connectors

Connect up to four AV devices such as Internet-Enabled TVs, Blu-ray™ players, gaming consoles, or other Ethernet-enabled devices to these ports using Ethernet cables.

B) Reset Button

This button is used to restart your Adapter in rare cases when it functions incorrectly. Resetting the Adapter will preserve your settings. This button may also be used to restore the factory default settings. Please see the “Troubleshooting” section for more information.

C) Power Connector

Connect the included power supply to this jack.

Technical Details

Technical Features

Integrated 802.11n Wireless Bridge:

Utilizes Dual-Band network technology (2.4GHz and 5GHz), allowing interference-free bandwidth to all your connected AV devices

Integrated 4-Port 10/100 Switch

Your Adapter has a built-in, 4-port network switch to connect your wired AV devices to the Internet.

System Requirements

Universal Wireless AV Adapter

Wireless router

At least one computer with an installed network interface adapter

RJ45 Ethernet networking cable

Internet browser

Using your Universal Wireless AV Adapter

Updating the Adapter's Firmware via the Web Interface

Note: Your PC needs to be wired to the Adapter in order to access the web interface. Open an Internet browser and type: <http://belkin.universal> into the address bar.

The following steps show you how to update your Adapter's firmware using its web interface.

BELKIN Universal Wireless AV Adapter Language

Status
[Restart Adapter](#)
[Restore Factory Defaults](#)
[Firmware Update](#)
[Log](#)

Firmware update

From time to time, Belkin may release new versions of the VideoLink Wireless[™] Adapter's firmware. Firmware updates contain improvements and fixes to problems that may have existed. Click the check for update button below to see if there is a firmware update available for your adapter.

Current Firmware: 1.00.00 (Oct.11.2011)

If you are currently connected to the adapter wirelessly, you will need to rejoin your home network, and check for updates by visiting Belkin's support site.

Update Firmware: No File Chosen

Resetting the Universal Wireless AV Adapter

Restart your Adapter

BELKIN Universal Wireless AV Adapter Language

Status
[Restart Adapter](#)
[Restore Factory Defaults](#)
[Firmware Update](#)
[Log](#)

Restart Adapter

Sometimes it may be necessary to reboot the Adapter if it is not working properly. Restarting the adapter will not delete any of your configuration settings. Clicking the button will restart the adapter.

Reset Button

The "Reset" button is used in rare cases when the Adapter may function improperly. Resetting the Adapter will restore the Adapter's normal operation while maintaining the programmed settings. You can also restore the factory default settings by using the "Reset" button.

Resetting the Universal Wireless AV Adapter

Push and release the “Reset” button. The light on the Adapter will momentarily flash and then become solid again, indicating the reset is complete.

Restoring Your Adapter to Factory Defaults

Press and hold the “Reset” button for at least 10 seconds, and then release it. The light on the Adapter will become blue/amber in an alternating flash pattern indicating that the Adapter is ready to be set up again.

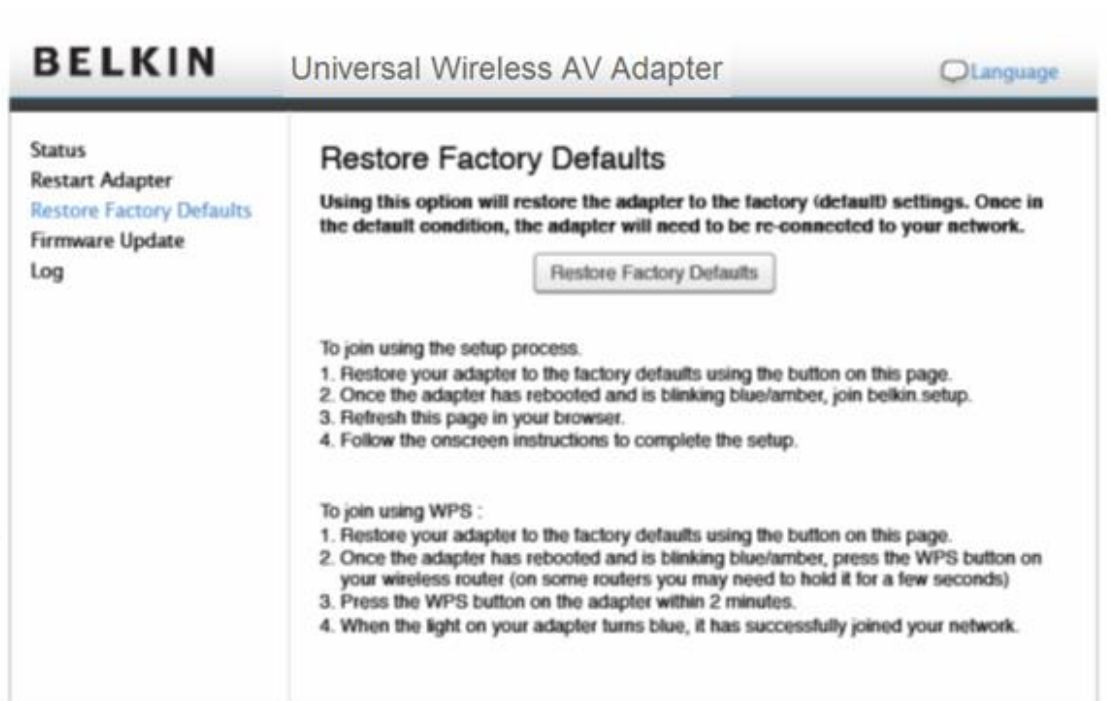

The screenshot shows the web interface for the Belkin Universal Wireless AV Adapter. The header includes the Belkin logo, the product name 'Universal Wireless AV Adapter', and a 'Language' dropdown menu. On the left, a navigation menu lists 'Status', 'Restart Adapter', 'Restore Factory Defaults' (highlighted in blue), 'Firmware Update', and 'Log'. The main content area is titled 'Restore Factory Defaults' and contains the following text: 'Using this option will restore the adapter to the factory (default) settings. Once in the default condition, the adapter will need to be re-connected to your network.' Below this text is a button labeled 'Restore Factory Defaults'. Further down, there are two sections of instructions: 'To join using the setup process' and 'To join using WPS :', each followed by a four-step numbered list.

BELKIN Universal Wireless AV Adapter Language

Status
Restart Adapter
Restore Factory Defaults
Firmware Update
Log

Restore Factory Defaults

Using this option will restore the adapter to the factory (default) settings. Once in the default condition, the adapter will need to be re-connected to your network.

[Restore Factory Defaults](#)

To join using the setup process.

1. Restore your adapter to the factory defaults using the button on this page.
2. Once the adapter has rebooted and is blinking blue/amber, join belkin setup.
3. Refresh this page in your browser.
4. Follow the onscreen instructions to complete the setup.

To join using WPS :

1. Restore your adapter to the factory defaults using the button on this page.
2. Once the adapter has rebooted and is blinking blue/amber, press the WPS button on your wireless router (on some routers you may need to hold it for a few seconds)
3. Press the WPS button on the adapter within 2 minutes.
4. When the light on your adapter turns blue, it has successfully joined your network.

Troubleshooting, Support, and Warranty

Troubleshooting

Belkin Setup cannot find my Universal Wireless AV Adapter.

If Belkin Setup is not able to communicate with your Adapter during the installation process, please make sure that the wireless router is turned on and has Internet connectivity.

The Adapter is having trouble connecting to my wireless network.



BELKIN Universal Wireless AV Adapter Setup

English

 **Please contact Belkin Support for help. You'll need the following information:**

Product Name: [Universal Wireless AV Adapter](#)
Product Number: [12345](#)
Issue: [SSID cannot be found.](#)

[Save a copy of this page](#)

Belkin Support Numbers

Argentina	800 222 0147
Australia	1 800 235 546
Belgium	0707 00073
Brazil	0800 888 8018 / 4003 8018
Canada	800 223 5546
Chile	123 00208354
China	800 819 0159

Blinking Amber LED:

This indicates that the Adapter is not connected to your wireless network. Please move the Adapter closer to your router.

Solid Amber LED:

This indicates that the Adapter is connected to your wireless network, but the signal is weak. You might experience slower performance. Please move the Adapter closer to your router.

My wireless network performance is slow, inconsistent, suffers from weak signal, or I'm having difficulty maintaining a connection with my wireless network.

Wireless technology is radio-based, which means connectivity and the throughput performance between devices decreases when the distance between devices increases. Other factors that will cause signal degradation (metal is generally the worst culprit) are obstructions such as walls and metal appliances. Note also that connection speed may decrease as you move your Adapter farther away from the router.

Technical Support

US

<http://www.belkin.com/support>

UK

<http://www.belkin.com/uk/support>

Australia

<http://www.belkin.com/au/support>

New Zealand

<http://www.belkin.com/au/support>

Singapore

1800 622 1130

Europe

<http://www.belkin.com/uk/support>

Belkin International, Inc., Limited 2-Year Product Warranty

What this warranty covers.

Belkin International, Inc. ("Belkin") warrants to the original purchaser of this Belkin product that the product shall be free of defects in design, assembly, material, or workmanship.

What the period of coverage is.

Belkin warrants the Belkin product for two years.

What will we do to correct problems?

Product Warranty.

Belkin will repair or replace, at its option, any defective product free of charge (except for shipping charges for the product). Belkin reserves the right to discontinue any of its products without notice, and disclaims any limited warranty to repair or replace any such discontinued products. In the event that Belkin is unable to repair or replace the product (for example, because it has been discontinued), Belkin will offer either a refund or a credit toward the purchase of another product from Belkin.com in an amount equal to the purchase price of the product as evidenced on the original purchase receipt as discounted by its natural use.

What is not covered by this warranty?

All above warranties are null and void if the Belkin product is not provided to Belkin for inspection upon Belkin's request at the sole expense of the purchaser, or if Belkin determines that the Belkin product has been improperly installed, altered in any way, or tampered with. The Belkin Product Warranty does not protect against acts of God such as flood, lightning, earthquake, war, vandalism, theft, normal-use wear and tear, erosion, depletion, obsolescence, abuse, damage due to low voltage disturbances (i.e. brownouts or sags), non-authorized program, or system equipment modification or alteration.

How to get service.

To get service for your Belkin product you must take the following steps:

1. Contact Belkin International, Inc., at 12045 E. Waterfront Drive, Playa Vista, CA 90094, Attn: Customer Service, or call (800)-223-5546, within 15 days of the Occurrence. Be prepared to provide the following information:
 - a. The part number of the Belkin product.
 - b. Where you purchased the product.
 - c. When you purchased the product.
 - d. Copy of original receipt.

2. Your Belkin Customer Service Representative will then instruct you on how to forward your receipt and Belkin product and how to proceed with your claim.

Belkin reserves the right to review the damaged Belkin product. All costs of shipping the Belkin product to Belkin for inspection shall be borne solely by the purchaser. If Belkin determines, in its sole discretion, that it is impractical to ship the damaged equipment to Belkin, Belkin may designate, in its sole discretion, an equipment repair facility to inspect and estimate the cost to repair such equipment. The cost, if any, of shipping the equipment to and from such repair facility and of such estimate shall be borne solely by the purchaser. Damaged equipment must remain available for inspection until the claim is finalized. Whenever claims are settled, Belkin reserves the right to be subrogated under any existing insurance policies the purchaser may have.

How state law relates to the warranty.

THIS WARRANTY CONTAINS THE SOLE WARRANTY OF BELKIN. THERE ARE NO OTHER WARRANTIES, EXPRESSED OR, EXCEPT AS REQUIRED BY LAW, IMPLIED, INCLUDING THE IMPLIED WARRANTY OR CONDITION OF QUALITY, MERCHANTABILITY OR FITNESS FOR A PARTICULAR PURPOSE, AND SUCH IMPLIED WARRANTIES, IF ANY, ARE LIMITED IN DURATION TO THE TERM OF THIS WARRANTY.

Some states do not allow limitations on how long an implied warranty lasts, so the above limitations may not apply to you.

IN NO EVENT SHALL BELKIN BE LIABLE FOR INCIDENTAL, SPECIAL, DIRECT, INDIRECT, CONSEQUENTIAL OR MULTIPLE DAMAGES SUCH AS, BUT NOT LIMITED TO, LOST BUSINESS OR PROFITS ARISING OUT OF THE SALE OR USE OF ANY BELKIN PRODUCT, EVEN IF ADVISED OF THE POSSIBILITY OF SUCH DAMAGES.

This warranty gives you specific legal rights, and you may also have other rights, which may vary from state to state. Some states do not allow the exclusion or limitation of incidental, consequential, or other damages, so the above limitations may not apply to you.

FCC Statement

DECLARATION OF CONFORMITY WITH FCC RULES FOR ELECTROMAGNETIC COMPATIBILITY

We, Belkin International, Inc., of 12045 E. Waterfront Drive, Playa Vista, CA 90094, declare under our sole responsibility that the device, **F7D4550v1**, complies with Part 15 of the FCC Rules. Operation is subject to the following two conditions: (1) this device may not cause harmful interference, and (2) this device must accept any interference received, including interference that may cause undesired operation.

Caution: Exposure to Radio Frequency Radiation.

The device shall be used in such a manner that the potential for human contact normal operation is minimized.

This equipment complies with FCC radiation exposure limits set forth for an uncontrolled environment. This equipment should be installed and operated with a minimum distance of 20cm between the radiator and your body.

Federal Communications Commission Notice

This equipment has been tested and found to comply with the limits for a Class B digital device, pursuant to Part 15 of the FCC Rules. These limits are designed to provide reasonable protection against harmful interference in a residential installation.

This equipment generates, uses, and can radiate radio frequency energy, and if not installed and used in accordance with the instructions, may cause harmful interference to radio communications. However, there is no guarantee that interference will not occur in a particular installation. If this equipment does cause harmful interference to radio or television reception, which can be determined by turning the equipment off and on, the user is encouraged to try and correct the interference by one or more of the following measures:

- Reorient or relocate the receiving antenna.
- Increase the distance between the equipment and the receiver.
- Connect the equipment to an outlet on a circuit different from that to which the receiver is connected.
- Consult the dealer or an experienced radio/TV technician for help.

FCC Caution: Any changes or modifications not expressly approved by the party responsible for compliance could void the user's authority to operate this equipment.

For operation within 5.15 ~ 5.25GHz frequency range, it is restricted to indoor environment.

IEEE 802.11b or 802.11g operation of this product in the U.S.A. is firmware-limited to channels 1 through 11.

This device and its antenna(s) must not be co-located or operating in conjunction with any other antenna or transmitter.

Canada-Industry Canada (IC)

The wireless radio of this device complies with RSS 210 Industry Canada. This Class B digital apparatus complies with Canadian ICES-003.

Operation is subject to the following two conditions: (1) this device may not cause interference, and (2) this device must accept any interference, including interference that may cause undesired operation of the device.

Cet appareil numérique de la classe B conforme à la norme NMB-003 du Canada.

IMPORTANT NOTE:

Radiation Exposure Statement:

This equipment complies with IC radiation exposure limits set forth for an uncontrolled environment. This equipment should be installed and operated with minimum distance 20cm between the radiator & your body.

Caution:

The device for the band 5150-5250 MHz is only for indoor usage to reduce potential for harmful interference to co-channel mobile satellite systems.

High power radars are allocated as primary users (meaning they have priority) of 5250-5350 MHz and 5650-5850 MHz and these radars could cause interference and/or damage to LE-LAN devices.

NOTE IMPORTANTE: (Pour l'utilisation de dispositifs mobiles)

Déclaration d'exposition aux radiations:

Cet équipement est conforme aux limites d'exposition aux rayonnements IC établies pour un environnement non contrôlé. Cet équipement doit être installé et utilisé avec un minimum de 20 cm de distance entre la source de rayonnement et votre corps.

Avertissement:

Le dispositif fonctionnant dans la bande 5150-5250 MHz est réservé uniquement pour une utilisation à l'intérieur afin de réduire les risques de brouillage préjudiciable aux systèmes de satellites mobiles utilisant les mêmes canaux.

Les utilisateurs de radars de haute puissance sont désignés utilisateurs principaux (c.-à-d., qu'ils ont la priorité) pour les bandes 5250-5350 MHz et 5650-5850 MHz et que ces radars pourraient causer du brouillage et/ou des dommages aux dispositifs LAN-EL.

© 2011 Belkin International, Inc. All rights reserved. All trade names are registered trademarks of respective manufacturers listed. Safari is a trademark of Apple Inc., registered in the U.S. and other countries. Internet Explorer is either a registered trademark or trademark of Microsoft Corporation in the United States and/or other countries.