

BELKIN.

User Manual
TuneBase™ FM for iPod®

FCC Warning

Changes or modifications not expressly approved by the party responsible for compliance could void the user's authority to operate the equipment.

This equipment complies with FCC radiation exposure limits set forth for an uncontrolled environment. End users must follow the specific operating instructions for satisfying RF exposure compliance. This transmitter must not be co-located or operating in conjunction with any other antenna or transmitter.

FCC Statement:

This device complies with Part 15 of the FCC Rules. Operation is subject to the following two conditions: (1) this device may not cause harmful interference, and (2) this device must accept any interference received, including interference that may cause undesired operation.

Introduction

Congratulations and thank you for purchasing the innovative TuneBase FM from Belkin. This product is designed to mount, stabilize, charge, power, and play your iPod as you drive. Please review this User Manual carefully so that you can be sure to get the most from your iPod, virtually anywhere you go.

Firmware Required

For complete compatibility, confirm your iPod has the following version of firmware. To check your iPod's firmware, select the "Settings" menu and then select the "About" menu. Your iPod's version is listed under "Version". If your firmware is out of date, consult the manufacturer's website to download an updated version.

iPod	Version of Firmware
iPod mini	1.4 and above
iPod photo	1.1 and above
iPod 4G	3.1 and above
iPod nano	1.0 and above
iPod video	1.0 and above

Note: iPod 3G is not supported.

Setup Instructions

1. Turn your car stereo volume down.
2. Connect the Belkin TuneBase FM to your cigarette-lighter adapter in your car. The LED on the TuneBase FM indicates proper connection.

Warning: Avoid excessive force when rotating the connector in the cigarette-lighter adapter. If you experience resistance, unplug the connector from the outlet and reinsert it in the desired position. Failure to do so may result in damage to the car's cigarette-lighter adapter or power outlet.

Note: The exact dimensions of power outlets vary by make and model of the car. In some cases, the fit might be improved by pressing the collar (included with the product) into the power outlet before inserting the connector in order to ensure a tight fit. However, the collar will not be necessary in most cars (note: when it is not necessary, it will not fit in the power outlet).

- A. Be sure to position the ring securely around the metal contact to ensure proper electrical connection within the power outlet.
- B. Power source (cigarette-lighter outlet)
- C. Fit ring
- D. Connector

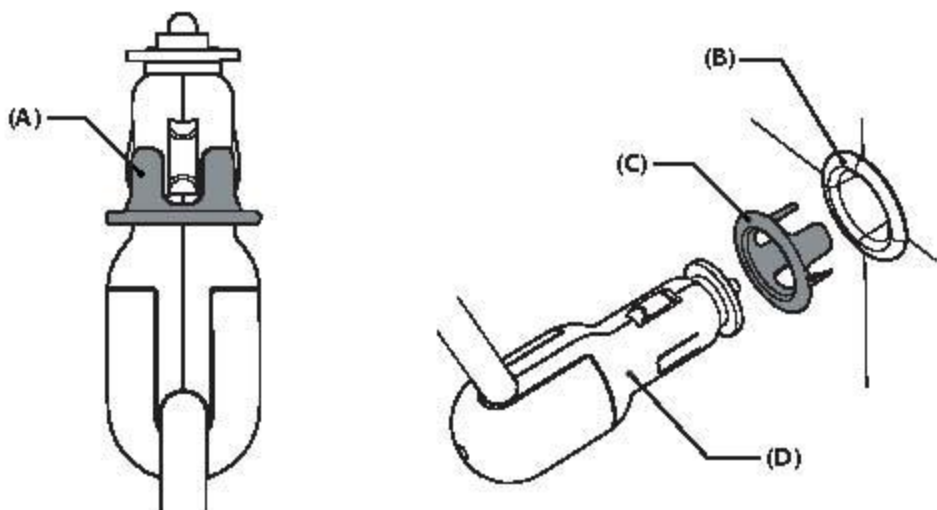

Setup Instructions

3. Bend and position the flexible-steel neck to a desired position for your iPod.
4. The TuneBase FM for iPod includes eight adapters for all supported iPod models (4G iPod 20GB/40GB, iPod photo 30GB/60GB, iPod video 30GB/60GB, mini, nano). Choose the adapter that fits your iPod and carefully insert the adapter firmly into the top of the cradle.
5. Carefully slide your iPod into the cradle at the top of the TuneBase FM. The iPod will power on if the car battery is on.

Note: The iPod automatically pauses playback when power is removed from the cigarette lighter or the car is turned off.

Note: To avoid damage to the iPod, please be sure to disconnect it from the TuneBase FM's cradle before disconnecting the TuneBase FM from the power outlet of the car.

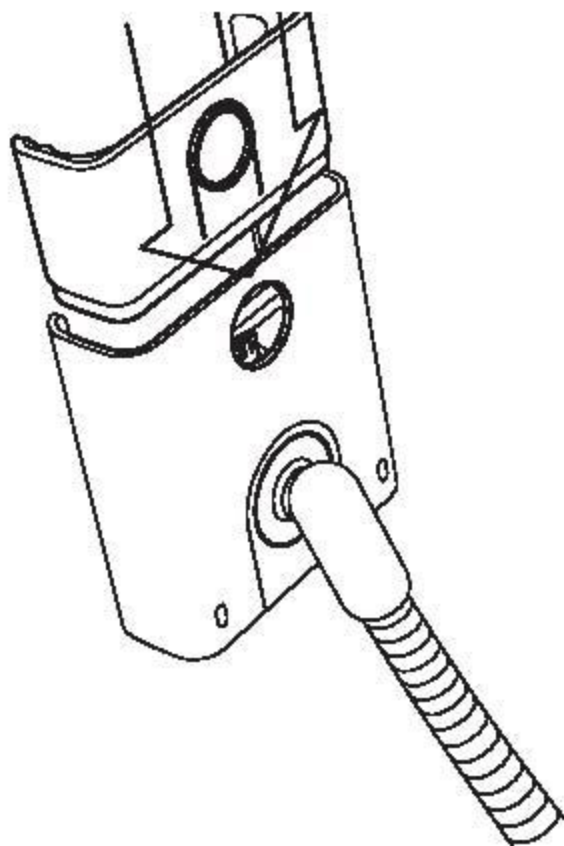

Using the TuneBase FM Transmitter

The TuneBase FM transmitter function automatically turns on when the iPod is connected and car power is available. It automatically turns off when the iPod is removed or car power becomes unavailable.

1. Tune your car stereo frequency to a channel with a weak broadcast signal. The ideal channel is one that is not broadcasting a radio program, or is doing so weakly.
2. Insert your iPod into the TuneBase FM. The iPod backlight will turn on and the current transmitter frequency will be displayed on the iPod screen.
3. Press the "▲" or "▼" button on the TuneBase FM to select the transmission frequency chosen in step 1. The frequency will be visible on the iPod's screen. Pressing and holding either button will provide faster tuning.
4. After displaying the current frequency for five seconds, the iPod screen will return to the iPod Main Menu. This will happen after making any changes to the TuneBase FM's settings. All settings—including transmission frequency, volume control setting, and stereo/mono control setting—are permanently stored in memory at this time.

Note: iPod playback will pause momentarily when entering and exiting the TuneBase FM control menu. Playback will quickly resume.

5. Adjust the volume of your FM radio to the desired listening level.

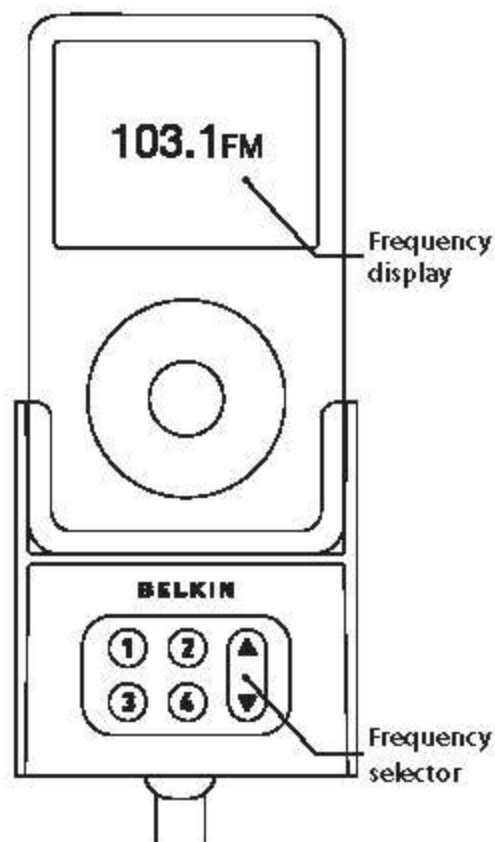

Storing and Using Presets

1. To store a preset, select the desired frequency using "▲" or "▼" buttons. Press and hold the desired preset button (1, 2, 3, or 4) for two seconds. An audible beep sounds when the new frequency is programmed*. The iPod display reflects the change when the memory button is released by showing which memory button was pressed followed by the frequency saved in that memory position.
- * Do NOT remove the iPod from the cradle until it returns to the Main Menu screen or new settings may not be saved.
2. To select a preset frequency, momentarily press "1", "2", "3", or "4". This instantly tunes the FM transmitter to the frequency stored in that preset.

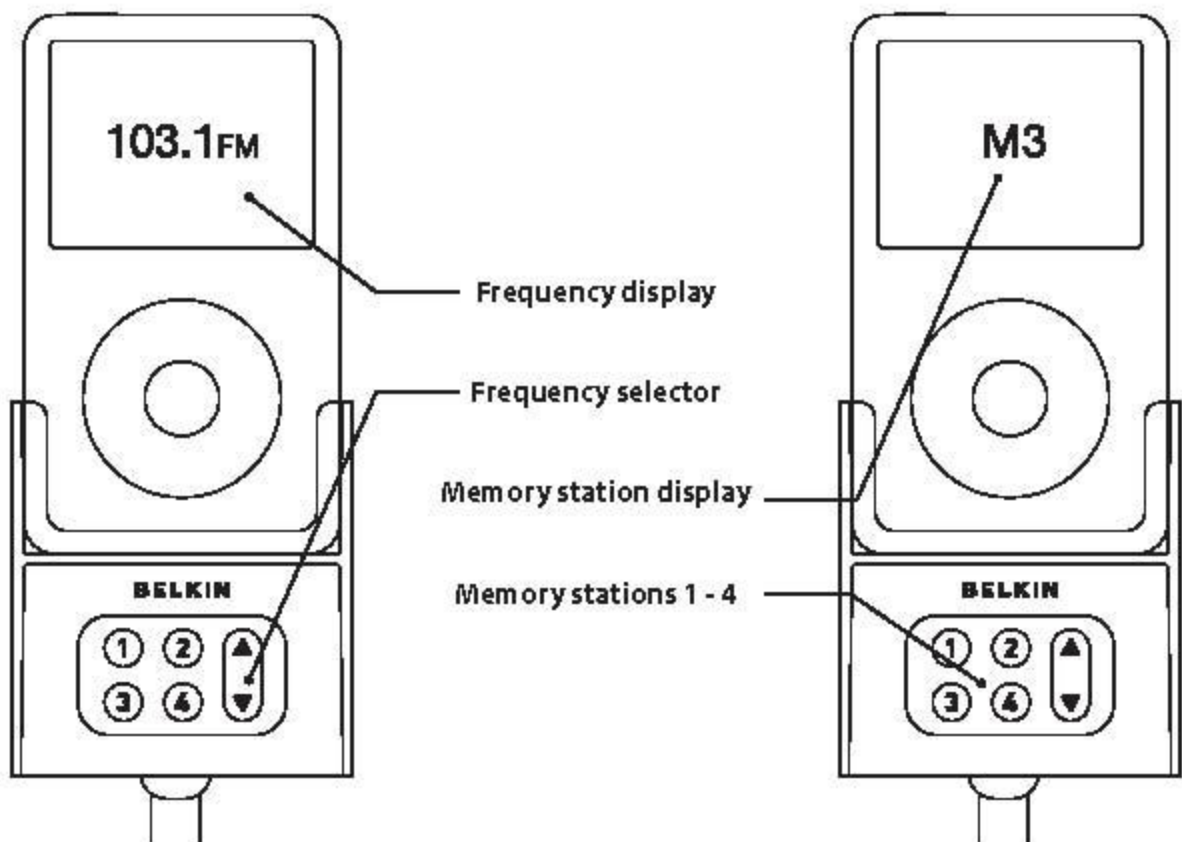

Transmission Volume Setting

Although the default volume setting will be ideal for most conditions, you may be able to improve the performance of the TuneBase FM by adjusting the volume of the transmitted audio signal. The TuneBase FM allows you to select one of five volume levels. You may wish to decrease the volume if you experience distorted audio.

You can access the transmission volume menu by pressing the "1" and "2" buttons simultaneously. TuneBase FM displays the current volume setting on the iPod, which is represented by "VOL 1" (low), "VOL 2", "VOL 3" (default), "VOL 4", and "VOL 5" (high).

You can then change the volume level by using the up and down arrows. To accept your volume selection, press one of the memory preset buttons, or simply wait for the iPod screen to return to the iPod Main Menu.

Note: The iPod nano has a lower audio output level than other iPod models, so a volume setting of "VOL 4" or "VOL 5" works best for iPod nano.

Stereo/Mono Selection

Transmitting music in stereo generally gives you the highest-quality listening experience. However, you may get better FM signal reception by changing the transmission to mono. TuneBase FM transmits in stereo mode by default. We suggest that you switch from stereo to mono transmission only if your car stereo is NOT receiving a clear signal from the TuneBase FM, or if you are listening to mono recordings such as audio books.

You can access the stereo/mono transmission menu by pressing the "1" and "3" buttons simultaneously. The TuneBase FM then displays the current mode setting, which is represented by "MONO" or "ST".

You can change the mode by pressing the up or down arrows. Either arrow will change between the two modes. The new setting takes effect immediately.

To accept your mode selection, press one of the memory preset buttons, or simply wait for the iPod screen to return to the iPod Main Menu.

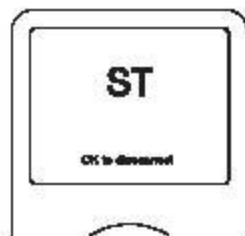

Troubleshooting

Issue - My iPod does not seem to be charging.

Solution 1 - Make sure that the TuneBase FM is correctly connected to your car's power outlet. The green indicator light on the cigarette-lighter adapter portion of the product should be lit at all times.

Solution 2 - Check to see that the iPod is pushed all the way into the cradle.

Solution 3 - Ensure that your car's power outlet is receiving power. Some cars are designed so that power is not provided to the power outlet unless the car is in ignition mode or the engine is running. If none of these solutions solves the problem, the fuse of the TuneBase FM might be burned out. In order to replace the fuse, please carefully follow these steps:

NOTE: DO NOT ATTEMPT TO DO THIS IN THE CAR. Use a clean, level surface or table for disassembly so that components do not get lost. The contact piece at the front end of the cigarette-lighter adapter is spring-loaded. With pliers, carefully and slowly remove the nut at the front end so that the spring inside the cigarette-lighter adapter does not get lost. The fuse will be easily accessible now. Purchase a new fuse at any auto-supply store.

Please refer to Fig. A for correct order of assembly. Be sure to tighten the nut firmly with pliers.

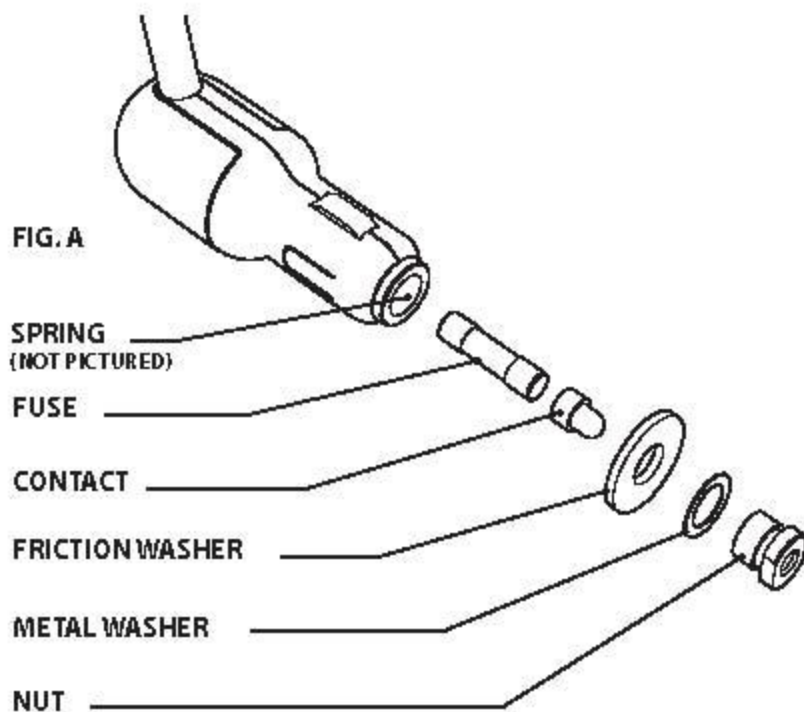

Troubleshooting

Issue - The audio is distorted.

Solution 1 - Decrease the TuneBase FM volume setting. Setting the volume setting to "VOL 4" or "VOL 5" increases the likelihood of audio distortion, except when using iPod nano.

Solution 2 - Make sure that your iPod EQ setting is "Off" or "Flat". Some EQ settings cause the audio to clip.

Solution 3 - Tune your car stereo and the TuneBase FM to a different frequency.

Issue - The audio is too quiet.

Solution 1 - Increase the transmission volume setting, especially when using an iPod nano. If you hear distortion in the audio, decrease the volume setting. The default setting of "VOL 3" is ideal for most conditions.

Issue - I am unable to get clear FM reception.

Solution 1 - Tune your car stereo and the TuneBase FM to a different frequency.

Solution 2 - In some instances, lowering the car antenna (available in some cars) will improve the clarity of the TuneBase FM's signal.

Solution 3 - Change the stereo/mono setting to mono mode. This may improve signal reception, but the audio will be monaural instead of stereo.

Issue - iPod playback stays paused after I've changed a setting on the TuneBase FM.

Solution - Simply press the "Play/Pause" button on your iPod to resume playback.

Issue - When I remove my iPod from the TuneBase FM cradle or turn off my car, iPod playback does not automatically pause.

Solution - If you remove the iPod from the TuneBase FM cradle within 12 seconds of adjusting the TuneBase FM settings, or remove power to the TuneBase FM during this time, the iPod may not automatically pause. Simply press the "Play/Pause" button on your iPod to pause playback.

Issue - When returning to the iPod Main Menu after adjusting the TuneBase FM settings, the iPod stays on the "OK to disconnect" screen.

Solution - Remove your iPod from the TuneBase FM and reconnect it. If you are no longer using the TuneBase FM, simply remove and then reset your iPod by pressing the "select" and "menu" buttons simultaneously for 10 seconds.

Troubleshooting

Issue – The TuneBase FM does not appear to be saving my settings.

Solution - Be sure not to remove the iPod from the cradle or remove power to the TuneBase FM while adjusting the TuneBase FM settings. Your settings are stored in memory when the iPod screen returns to the iPod Main Menu.

Issue – The TuneBase FM and iPod are in the way of my car's controls.

Solution - The TuneBase FM has been designed to easily position in a wide range of orientations within the car. Use the flexible gooseneck and the articulation behind the docking cradle to position it away from any controls of the car. Be sure to position the gooseneck in as close to an upright position in relation to the adapter as possible (Fig. B).

Issue - The TuneBase FM rotates out of position around the center of the power outlet.

Solution 1 - Be sure to solidly attach the cigarette-lighter adapter portion of the TuneBase FM in the power outlet. Test the stability by pushing it sideways before driving.

Solution 2 - In some cars, the power outlet is bigger in diameter than the cigarette-lighter adapter. You will notice a wiggle in the TuneBase FM when pushing it. In that case, fit the collar provided around the TuneBase FM's cigarette-lighter adapter. Then, attach the cigarette-lighter adapter to the power outlet. Slide the collar into the power outlet, making sure that all four protrusions securely fit into the power outlet.

Solution 3 - Some power outlets will not fit all four protrusions of the collar. In order to improve the fit of the cigarette-lighter adapter in the power outlet of the car, you can cut the collar to size. In order to do so, please cut as many protrusions as necessary with scissors. Carefully cut one by one, always trying the fit in the power outlet after each cut. Cut the protrusions from one side to the other (Fig. C).

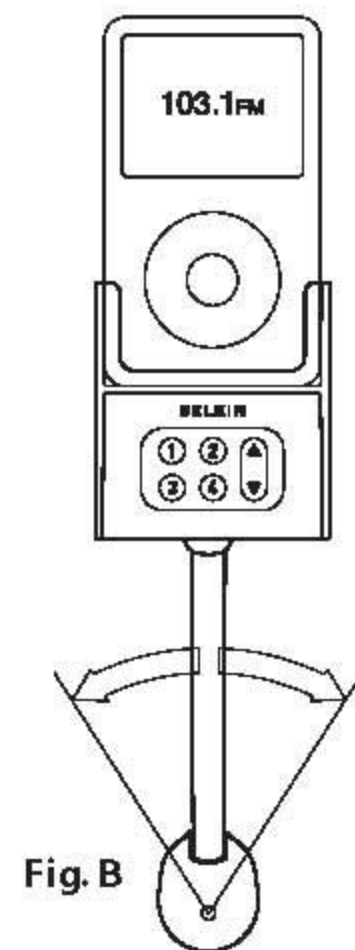
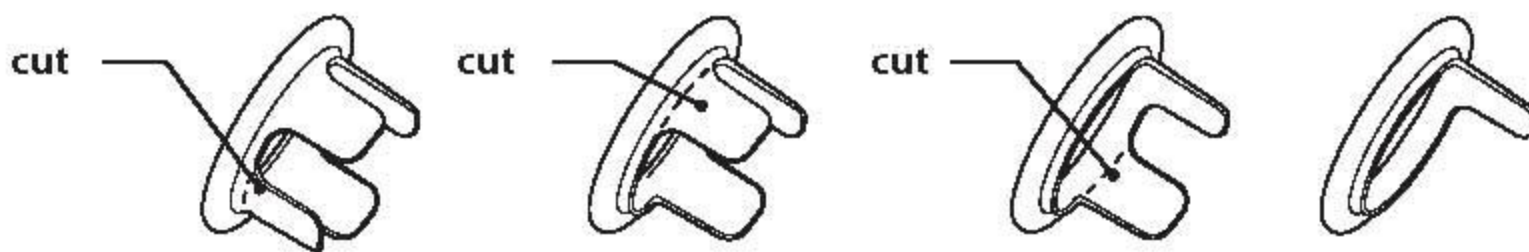

Fig. C.
Test fit in
power outlet after
each cut!



Troubleshooting

Issue - The TuneBase FM connects firmly to the power outlet of my car but the TuneBase FM still rotates.

Solution - Check to see if the power outlet of your car rotates in its socket. If so, please consult your car manufacturer.

Issue - The rubber friction washer is out of position and I cannot insert the cigarette-lighter adapter into the car's power outlet.

Solution - Please use a clean and empty table for disassembly. DO NOT ATTEMPT TO DO THIS IN THE CAR. Use pliers to loosen the nut at the end of the cigarette-lighter adapter slightly. It is not necessary to unscrew the entire nut. Move the friction washer back into centered position. Use pliers to tighten the nut firmly.

Issue - I pulled the TuneBase FM out of the power outlet of my car but the rubber washer slipped off and remained in the power outlet.

Solution - This is rare, but if it occurs: DISCONNECT THE BATTERY OF YOUR CAR BEFORE ATTEMPTING TO REMOVE THE WASHER! ANY ATTEMPT TO REMOVE THE WASHER WITHOUT DISCONNECTING THE BATTERY MAY RESULT IN PHYSICAL HARM TO YOU OR DAMAGE TO THE CAR. Use pliers to carefully remove the friction washer from the power outlet. Then, place it back onto the cigarette-lighter adapter. Then, reconnect the car battery.

Information

Warning

The TuneBase/TuneBase FM requires full concentration and both hands to install. DO NOT ATTEMPT TO INSTALL THE PRODUCT WHILE DRIVING. Make sure the product fits securely and firmly into your car's power outlet before driving. After installation, ensure that the TuneBase FM does not freely rotate in the power outlet of the car by following the instructions in this User Manual. DO NOT ATTEMPT TO ADJUST OR RETRIEVE AN UNSECURED TUNEBase FM OR IPOD WHILE DRIVING. Adjust the TuneBase FM so that both the TuneBase FM and the iPod do not interfere with any of the operating controls of the car.

DO NOT INSERT ANY OBJECTS OTHER THAN THE CIGARETTE-LIGHTER ADAPTER INTO THE POWER OUTLET OF THE CAR WITHOUT DISCONNECTING THE BATTERY OF THE CAR FIRST. FAILURE TO OBSERVE THIS SAFETY WARNING CAN RESULT IN POSSIBLE INJURY OR PROPERTY DAMAGE.

Belkin does not assume any responsibility for personal injury or property damage incurred due to hazardous driving as a result of interaction with the TuneBase FM, the iPod, or the power outlet of the car.

FCC Statement

DECLARATION OF CONFORMITY WITH FCC RULES FOR ELECTROMAGNETIC COMPATIBILITY

We, Belkin Corporation, of 501 West Walnut Street, Compton, CA 90220, declare under our sole responsibility that the product:

F8Z 049

to which this declaration relates:

Complies with Part 15 of the FCC Rules. Operation is subject to the following two conditions: (1) this device may not cause harmful interference, and (2) this device must accept any interference received, including interference that may cause undesired operation.

ICES

This Class B digital apparatus complies with Canadian ICES-003. Cet appareil numérique de la classe B est conforme à la norme NMB-003 du Canada.



Belkin Corporation Limited 3-Year Warranty

What this warranty covers. Belkin Corporation warrants to the original purchaser of this Belkin product that the product shall be free of defects in design, assembly, material, or workmanship.

What the period of coverage is. Belkin Corporation warrants the Belkin product for three years.

What will we do to correct problems? *Product Warranty.* Belkin will repair or replace, at its option, any defective product free of charge (except for shipping charges for the product).

What is not covered by this warranty? All above warranties are null and void if the Belkin product is not provided to Belkin Corporation for inspection upon Belkin's request at the sole expense of the purchaser, or if Belkin Corporation determines that the Belkin product has been improperly installed, altered in any way, or tampered with. The Belkin Product Warranty does not protect against acts of God (other than lightning) such as flood, earthquake, war, vandalism, theft, normal-use wear and tear, erosion, depletion, obsolescence, abuse, damage due to low voltage disturbances (i.e. brownouts or sags), non-authorized program, or system equipment modification or alteration.

How to get service. To get service for your Belkin product you must take the following steps:

1. Contact Belkin Corporation at 501 W. Walnut St., Compton CA 90220, Attn: Customer Service, or call (800)-223-5546, within 15 days of the Occurrence. Be prepared to provide the following information:
 - a. The part number of the Belkin product.
 - b. Where you purchased the product.
 - c. When you purchased the product.
 - d. Copy of original receipt.
2. Your Belkin Customer Service Representative will then instruct you on how to forward your receipt and Belkin product and how to proceed with your claim.

Belkin Corporation reserves the right to review the damaged Belkin product. All costs of shipping the Belkin product to Belkin Corporation for inspection shall be borne solely by the purchaser. If Belkin determines, in its sole discretion, that it is impractical to ship the damaged equipment to Belkin Corporation, Belkin may designate, in its sole discretion, an equipment repair facility to inspect and estimate the cost to repair such equipment. The cost, if any, of shipping the equipment to and from such repair facility and of such estimate shall be borne solely by the purchaser. Damaged equipment must remain available for inspection until the claim is finalized. Whenever claims are settled, Belkin Corporation reserves the right to be subrogated under any existing insurance policies the purchaser may have.

How state law relates to the warranty. THIS WARRANTY CONTAINS THE SOLE WARRANTY OF BELKIN CORPORATION, THERE ARE NO OTHER WARRANTIES, EXPRESSED OR, EXCEPT AS REQUIRED BY LAW, IMPLIED, INCLUDING THE IMPLIED WARRANTY OR CONDITION OF QUALITY, MERCHANTABILITY OR FITNESS FOR A PARTICULAR PURPOSE, AND SUCH IMPLIED WARRANTIES, IF ANY, ARE LIMITED IN DURATION TO THE TERM OF THIS WARRANTY.

Some states do not allow limitations on how long an implied warranty lasts, so the above limitations may not apply to you.

IN NO EVENT SHALL BELKIN CORPORATION BE LIABLE FOR INCIDENTAL, SPECIAL, DIRECT, INDIRECT, CONSEQUENTIAL OR MULTIPLE DAMAGES SUCH AS, BUT NOT LIMITED TO, LOST BUSINESS OR PROFITS ARISING OUT OF THE SALE OR USE OF ANY BELKIN PRODUCT, EVEN IF ADVISED OF THE POSSIBILITY OF SUCH DAMAGES.

This warranty gives you specific legal rights, and you may also have other rights, which may vary from state to state. Some states do not allow the exclusion or limitation of incidental, consequential, or other damages, so the above limitations may not apply to you.

BELKIN.

www.belkin.com

Belkin Corporation
501 West Walnut Street
Los Angeles, CA 90220, USA
310-898-1100
310-898-1111 fax

Belkin Ltd.
Express Business Park, Shipton Way
Rushden, NN10 6GL, United Kingdom
+44 (0) 1933 35 2000
+44 (0) 1933 31 2000 fax

Belkin B.V.
Boeing Avenue 333
1119 PH Schiphol-Rijk, The Netherlands
+31 (0) 20 654 7300
+31 (0) 20 654 7349 fax

Belkin Ltd.
7 Bowen Crescent, West Gosford
NSW 2250, Australia
+61 (0) 2 4372 8600
+61 (0) 2 4372 8603 fax

Tech Support
US: 310-898-1100 ext. 2263
800-223-5546 ext. 2263
Europe: 00 800 223 55 460
Australia: 1800 235 546
New Zealand: 0800 235 546

© 2006 Belkin Corporation. All rights reserved.

All trade names are registered trademarks of respective manufacturers listed.
iPod is a trademark of Apple Computer, Inc., registered in the U.S. and other countries.