

The ET-S is an engine compartment bulkhead mounted electronic treadle. On electronically controlled diesel engines, the ET-S fulfills the same function as a conventional mechanical throttle. However, rather than transmitting a mechanical force to the engine governor, the ET-S controls engine speed by supplying a variable electrical voltage to the engine's electronic controller.

The main components of the ET-S are: a mounting plate, suspended treadle, potentiometer (variable resistor), actuator body and base. The selected potentiometer, chosen for a specific engine application, provides the electrical link to the engine control system.

For Service Data and Maintenance Information, see SD-15-4111.

WEIGHT approx. 3.7 lbs.

VRMS No. is 44-007-047.

Device Code for the Caterpillar version is 4112.

Device Code for the Cummins version is 4111.

Device Code for the Detroit Diesel Corp. version is 4113.

This treadle is used as part of the BCM-KW module - see Catalog page 98-A-1 for further details.

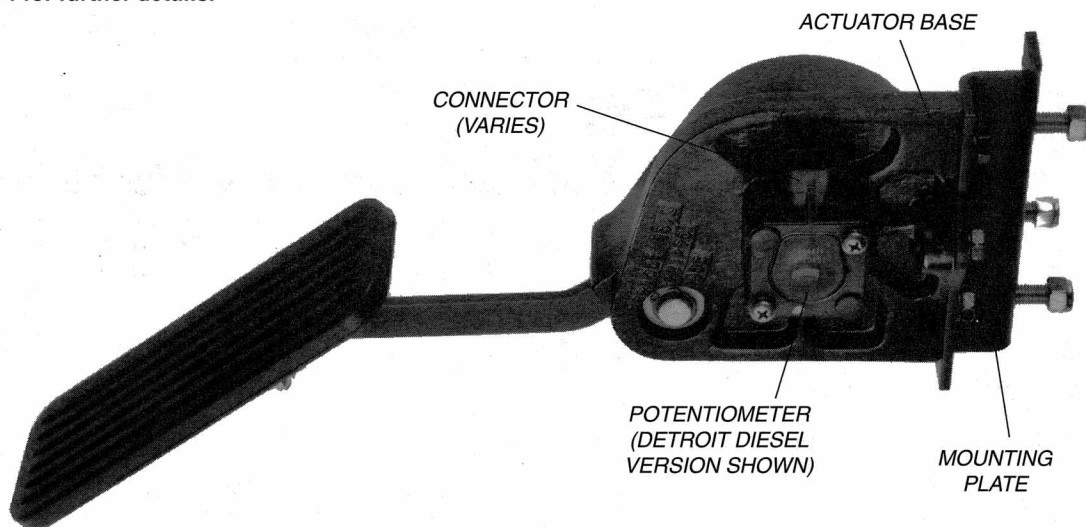
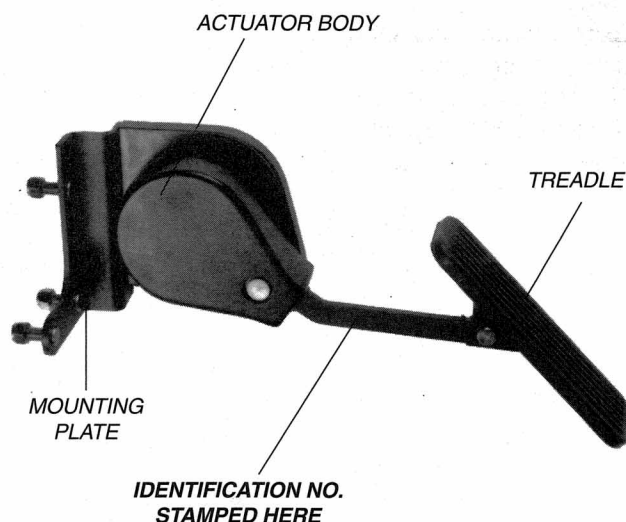

Identification Number (Items in bold are OE Assembly No.s)	Service Replacement Part	Customer I.D. Number	Potentiometer Replacement Kit
5001650 (supersedes 5001550*)	800230	Kenworth Q21-1005-1	5002356 (Caterpillar)
5001649 (supersedes 5001551*)	800231	Kenworth Q21-1005-2	5002357 (Cummins)
5001651 (supersedes 5001552*)	800232	Kenworth Q21-1005-3	5002358 (DDC)

* These identification numbers are found on early release models of the ET-S.

NOTE

Except for the Kits shown on this page, and the Rubber Treadle Cover (Pc. No. 5001556), all other components are non-serviceable.

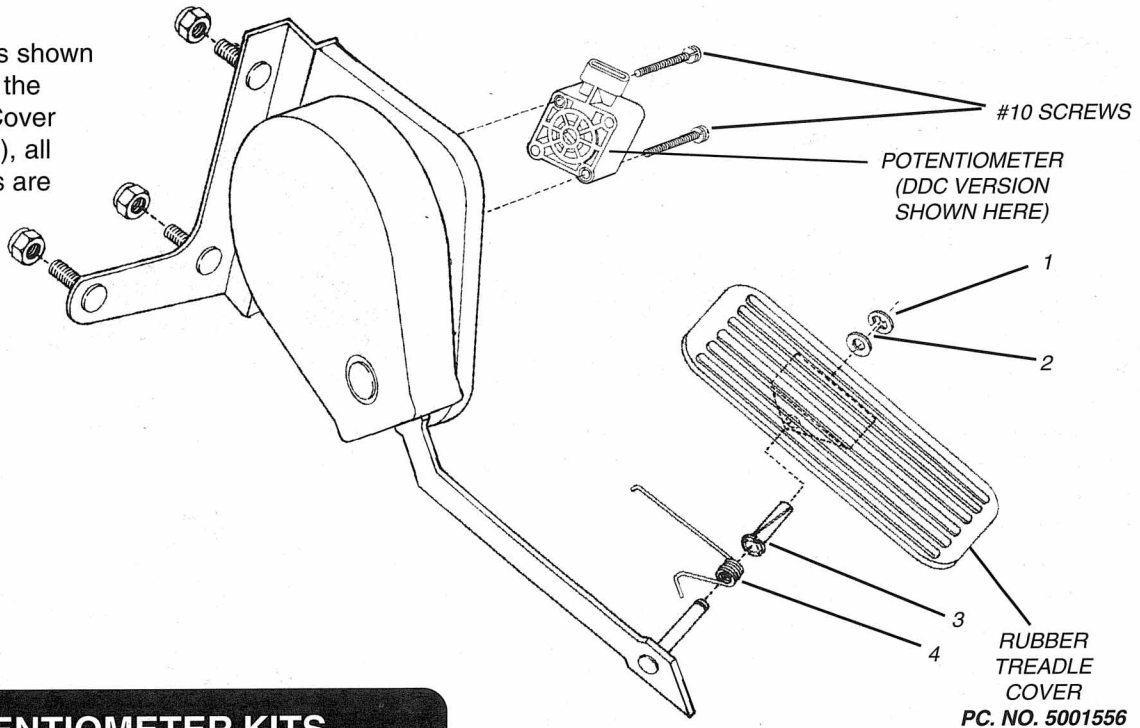
**POTENTIOMETER KITS****KIT 5002356**

Cummins
Potentiometer/Switch

6 PIN
CONNECTOR

Number shown
here is not a
piece no. - DO
NOT attempt to
use for ordering
service
replacement

[KIT INCLUDES TWO #10 CAP
SCREWS]

KIT 5002357

Caterpillar Position Sensor

3 PIN
CONNECTOR

WIRE HARNESS
ATTACHED

Number shown here is not a
piece no. - DO NOT attempt
to use for ordering service
replacement

[KIT INCLUDES TWO #10 CAP SCREWS]

KIT 5002358

DDC Potentiometer

3 PIN
CONNECTOR

Number shown
here is not a
piece no. - DO
NOT attempt to
use for ordering
service
replacement

[KIT INCLUDES TWO #10 CAP
SCREWS]

TREADLE SPRING KIT

Pc. No. 5002359

THIS KIT SERVICES ALL ASSEMBLIES
(Refer to Figure at the top of this page)

KEY	ITEM	QTY
1	RETAINING RING	1
2	NYLON WASHER	1
3	NYLINER BEARING	1
4	TREADLE SPRING	1