

Hello,
Thank you for purchasing BEC 430M, the portable 4G LTE Mobile Hotspot. This device offers high-speed and great performance of 4G LTE, automatic 3G failover, with Wi-Fi hotspot for mobile Internet connectivity wherever you go. Using the BEC 430M, you may send/receive text messages, have up to 8 Wi-Fi enabled clients to enjoy instant mobile Internet access and download / upload / share files, music and photos, and more all at the same time.

This Quick Start Guide helps you to set up your BEC 430M and how to use its key features. To begin, insert your SIM card and make sure the battery is fully charged before using for the first time prior to powering on your 4G/LTE Mobile Hotspot.

PLEASE READ THIS DOCUMENT CAREFULLY BEFORE USING YOUR BEC 430M

Application Scenarios

I. Wi-Fi Hotspot: 4G internet sharing via Wi-Fi mode

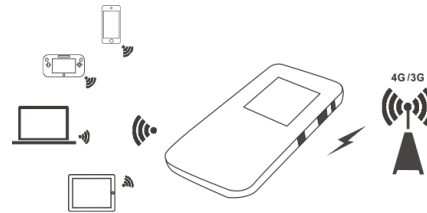

II. USB Modem: Connect with a PC / Notebook

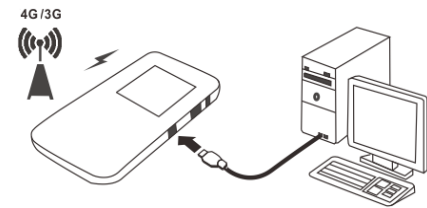

What's in the Box

- BEC 430M Device x 1
- USB Cable x 1
- Power adapter x 1
- This Quick Start Guide

Hardware Overview

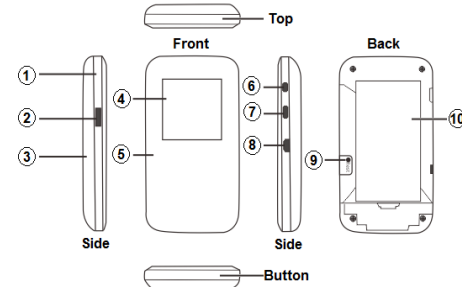

- | | |
|---------------------|------------------------------|
| 1 Mid-frame Housing | 6 Power Button |
| 2 SD Card Slot | 7 WPS Button |
| 3 Battery Cover | 8 microUSB Port |
| 4 LCD Screen | 9 Reset Button |
| 5 Faceplate | 10 Battery / SIM Compartment |

Get Started

I. SIM & Battery - Insert / Remove

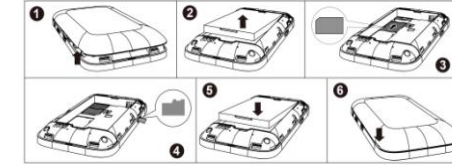

Step 1 Gently pull and remove the battery cover off the device

Step 2 Remove the battery

Step 3 Insert the SIM card in a correct direction into the slot completely, follow the indication next to the card slot.

Step 4 Insert a memory SD card if needed

Step 5 Put the battery back and make sure the gold contact aligned then gently press it down to secure the battery.

Step 6 Replace the battery cover and press firmly along the edge to ensure all side tabs click into place.

II. Battery –Charging

Fully charge the battery before attempting to power on the BEC 430M for the first time.

If your 430M have not been used for a period of time or the battery is fully depleted, the 430M may not get powered on immediately after the charger is plugged in.

WARNING Use only the provided power supply and battery with your BEC 430M as they are approved and designed for the device. Use of an incompatible battery or power supply from an unknown manufacturer may increase the risk of device malfunctions, failure, overheat, explode resulting property damage, body injury, etc. Such use voids all warranties, whether expressed or implied, on the product.

III. Turn on your BEC 430M

To start, press and hold the power button until LED / LCD screen start flashing.

IV. Connect to the Internet

Wireless LAN Connection

Set up and connect your notebook, smart phone or tablet with the 430M wirelessly.

Remove the battery cover to find your unique SSID and Wi-Fi key in **WPA/WPA2-PSK** mode.

Model: BEC 430M
SSID: BECxxxxxx
WiFi Key: xxxxxxxxxxxx
IP Address: 192.168.0.1
Password: admin

Access to the Web Management of 430M

Make sure your Wi-Fi device is connected and received an IP address from the BEC 430M.

Default Management IP: **192.168.0.1 / 255.255.255.0**
Open a web browser and type <http://192.168.0.1> in the URL address bar and enter.

The login prompt will appear and input the default password (**admin**) to access to the Home Page.

The Home page displays current WAN & LAN network status, total number of connected Wi-Fi clients, statistic and 4G LTE signal strength.

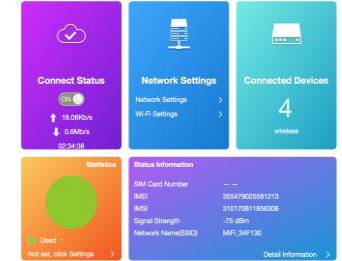

Otherwise, select *Manual* to create a new enter a new Internet profile by entering details such as Profile Name, APN, username / password, and other information provided by your service provider. Click **Next**.

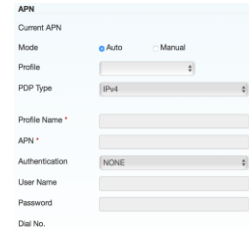

Step 3: Wi-Fi Hotspot –Change SSID

Verify or update your Wi-Fi network name (SSID) to a unique and different name. Click **Next**.

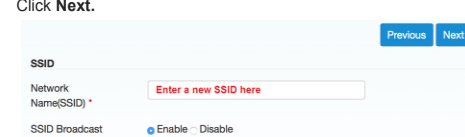

Step 4: Wi-Fi Hotspot –Change Security Mode

Verify or update the security mode (default in **WPA/WPA2-PSK**) and/or Pre-shared Key. Click **Next**.

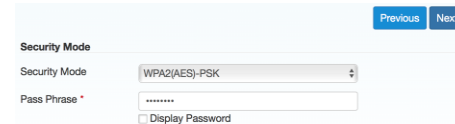

Step 5: Confirm and Save Settings

Verify all settings and click **Apply** to save and complete the Setup Wizard. You should now be able to access to the Internet.



V. Restart (Reboot) / Factory Restart

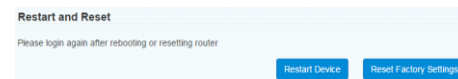

▶ **Restart / Reboot the Device**
To reboot your 430M without deleting current save settings such as Internet profile, DDNS, Firewall, etc.

▶ **Reset Factory Restart**
In case you have forgotten the login password, SSID, or Wi-Fi passphrase (password), you can factory restart your 430M by deleting all settings you have configured and saved.

You may also press and hold the **RESET** button on the back of the 430M until the device restarts again.

To access to the 430M again, you will need to use the default credential to log back in to the device. (Refer to **IV. Connect to the Internet** in this document)

Product Support and Contact Information

If you have other inquiries or need further technical support, please contact with your Internet Service Provider or visit us at www.bectechnologies.net.



BEC 430M

4G/LTE Mobile Hotspot

FCC Statement

1. This device complies with Part 15 of the FCC Rules. Operation is subject to the following two conditions:

(1) This device may not cause harmful interference.

(2) This device must accept any interference received, including interference that may cause undesired operation.

2. Changes or modifications not expressly approved by the party responsible for compliance could void the user's authority to operate the equipment.

NOTE:

This equipment has been tested and found to comply with the limits for a Class B digital device, pursuant to Part 15 of the FCC Rules.

These limits are designed to provide reasonable protection against harmful interference in a residential installation.

This equipment generates uses and can radiate radio frequency energy and, if not installed and used in accordance with the instructions, may cause harmful interference to radio communications. However, there is no guarantee that interference will not occur in a particular installation. If this equipment does cause harmful interference to radio or television reception, which can be determined by turning the equipment off and on, the user is encouraged to try to correct the interference by one or more of the following measures:

Reorient or relocate the receiving antenna.

Increase the separation between the equipment and receiver.

Connect the equipment into an outlet on a circuit different from that to which the receiver is connected.

Consult the dealer or an experienced radio/TV technician for help.

SAR Information Statement

Your wireless phone is a radio transmitter and receiver. It is designed and manufactured not to exceed the emission limits for exposure to radiofrequency (RF) energy set by the Federal Communications Commission of the U.S. Government. These limits are part of comprehensive guidelines and establish permitted levels of RF energy for the general population. The guidelines are based on standards that were developed by independent scientific organizations through periodic and thorough evaluation of scientific studies. The standards include a substantial safety margin designed to assure the safety of all persons, regardless of age and health. The exposure standard for wireless mobile phones employs a unit of measurement known as the Specific Absorption Rate, or SAR. The SAR limit set by the FCC is 1.6 W/kg. * Tests for SAR are conducted with the phone transmitting at its highest certified power level in all tested frequency bands. Although the SAR is determined at the highest certified power level, the actual SAR level of the phone while operating can be well below the maximum value. This is because the phone is designed to operate at multiple power levels so as to use only the power required to reach the network. In general, the closer you are to a wireless base station antenna, the lower the power output. Before a phone model is available for sale to the public, it must be tested and certified to the FCC that it does not exceed the limit established by the government adopted requirement for safe exposure. The tests are performed in positions and locations (e.g., at the ear and worn on the body) as required by the FCC for each model. when worn on the body, as described in this user guide, is **1.421W/Kg**(Body-worn measurements differ among phone models, depending upon available accessories and FCC requirements). The maximum scaled SAR in hotspot mode is **1.421W/Kg**. While there may be differences between the SAR levels of various phones and at various positions, they all meet the government requirement for safe exposure. The FCC has granted an Equipment Authorization for this model phone with all reported SAR levels evaluated as in compliance with the FCC RF exposure guidelines. SAR information on this model phone is on file with the FCC and can be found under the Display Grant section of <http://www.fcc.gov/oet/fccid> after searching on

FCC ID: **QI3BIL-BEC430M** Additional information on Specific Absorption Rates (SAR) can be found on the Cellular Telecommunications Industry Association (CTIA) web-site at <http://www.wow-com.com>. * In the United States and Canada, the SAR limit for mobile phones used by the public is 1.6 watts/kg (W/kg) averaged over one gram of tissue. The standard incorporates a substantial margin of safety to give additional protection for the public and to account for any variations in measurements.

Body-worn Operation

This device was tested for typical body-worn operations. To comply with RF exposure requirements, a minimum separation distance of **10mm** must be maintained between the user's body and the handset, including the antenna. Third-party belt-clips, holsters, and similar accessories used by this device should not contain any metallic components. Body-worn accessories that do not meet these requirements may not comply with RF exposure requirements and should be avoided. Use only the supplied or an approved antenna.