

BISSELL®

POWER STEAMER DELUXE

Deep Cleaning Machine. For Professional-Style Deep Cleaning of Carpet, Upholstery, and Bare Floors.

- Gets dirt vacuums can't.
- Restores color and brightness to all carpet textures.
- Full Two Year Warranty.
- Safely cleans stain-resistant carpets.
- Designed for optimum cleaning results when used with BISSELL Carpet and Upholstery Formula and BISSELL Bare Floor Formula.



Owner's Manual
Model No. 1631-1

Retain Manual for Future Use

IMPORTANT SAFETY INSTRUCTIONS

When using an electrical appliance, basic precautions should always be followed, including the following:

Read all the instructions before using the BISSELL POWER STEAMER

WARNING: To reduce the risk of fire, electric shock or injury:

1. Do not leave appliance when plugged in. Unplug from outlet when not in use and before servicing.
2. **WARNING:** To avoid electric shock, use indoors only.
3. Do not allow to be used as a toy. Close attention is necessary when used by or near children.
4. Use only as described in this manual. Use only Manufacturer's recommended attachments.
5. Do not use with damaged cord or plug. If appliance is not working as it should, has been dropped, damaged, left outdoors, or dropped into water, return it to an authorized service center.
6. Do not pull or carry by cord, use cord as a handle, close a door on a cord, or pull cord around sharp edges or corners. Do not run appliance over cord. Keep cord away from heated surfaces.
7. Do not unplug by pulling on cord. To unplug, grasp the plug, not the cord.
8. Do not handle plug or appliance with wet hands.
9. Do not put any object into openings. Do not use with any opening blocked; keep free of dust, lint, hair, and anything that may reduce air flow.
10. Keep hair, loose clothing, fingers, and all parts of body away from openings and moving parts.
11. Do not pick up anything that is burning or smoking such as cigarettes, matches or hot ashes.
12. Turn off all controls before unplugging.
13. Use extra care when cleaning stairs. Keep cleaner on a stable surface.
14. Do not pick up flammable or readily combustible material (lighter fluid, gasoline, etc.) or use unit in the presence of explosive liquids or vapor.
15. Do not use cleaner in an enclosed space where flammable, explosive or toxic vapors are given off by oil base paint, paint thinner, some moth proofing substances or in an area where flammable dust is present.
16. Do not pick up toxic material such as chlorine bleach, drain cleaner, gasoline, etc. with this unit.

17. Connect to a properly grounded outlet only. See grounding instructions.
18. Do not carry the Power Steamer while in use.

GROUNDING INSTRUCTIONS

This appliance must be grounded. If it should malfunction or break down, grounding provides a path of least resistance for electrical current to reduce the risk of electric shock. The appliance is equipped with a cord having an equipment-grounding conductor and grounding plug. The plug must be plugged into an appropriate outlet that is properly installed and grounded in accordance with all local codes and ordinances.

DANGER: Improper connection of the equipment-grounding conductor can result in a risk of electric shock. Check with a qualified electrician or service person if you are in doubt as to whether the outlet is properly grounded. Do not modify the plug provided with the appliance — if it will not fit the outlet, have a proper outlet installed by a qualified electrician.

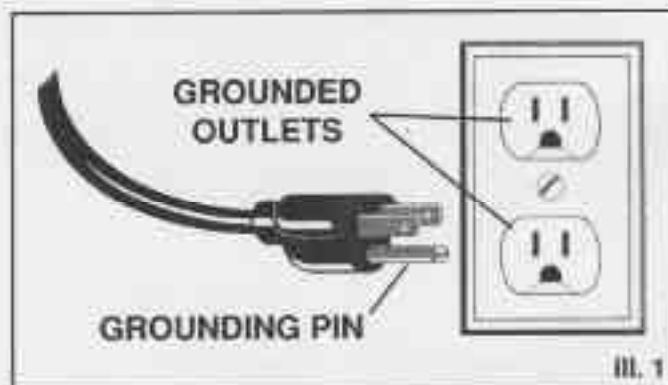

This appliance is for use on a nominal 120-volt circuit and has a grounding plug that looks like the plug in the illustration above. Make sure that the appliance is connected to an outlet having the same configuration as the plug. No adapter should be used with the appliance.

SAVE THESE INSTRUCTIONS

For Household use only

INTRODUCTION

Welcome to the growing family of satisfied BISSELL customers. Our products are designed with you, the user in mind. BISSELL Deep Cleaning Machines offer the newest developments in user convenience and cleaning power.

Please read through the safety precautions on the opposite page and follow the instructions in this manual to get the best cleaning results. BISSELL carpet cleaning formulas will help. BISSELL carpet and bare floor cleaning formulas are specifically designed to give optimum cleaning action with the BISSELL family of deep cleaning machines.

Your new Deep Cleaning Machine is designed for years of dependable service. Our assurance of quality is reflected in the Full Two Year Warranty as stated below. Should you need replacement parts in the future, refer to the section at the back of this manual for a list of replaceable items.

If after reading through this manual, you have additional questions on how to use this machine, or need information on other BISSELL products, please contact the BISSELL Information and Service Department at **1-800-237-7691**. Hours are Monday-Friday 8:30 A.M. to 5:00 P.M. E.S.T.

FULL TWO YEAR WARRANTY

BISSELL Inc., upon receipt of the product, will repair or replace free of charge any part which is defective, or malfunctions within two years of purchase date provided that it has been used for deep cleaning of personal carpet and upholstery and not used for commercial or rental service.

Terms

1. Return the machine with proof of purchase date to your dealer, your nearest BISSELL Authorized Service Center, or return by United Parcel Service or Parcel Post to BISSELL Inc., 2345 Walker N.W., Grand Rapids, Michigan 49504. BISSELL will reimburse you for the UPS or Parcel Post charge.
2. Any defective or malfunctioning part will be repaired or replaced, and appliance returned postpaid to owner.
3. This warranty gives you specific legal rights, and you may also have other rights which may vary from state to state.

PART IDENTIFICATION

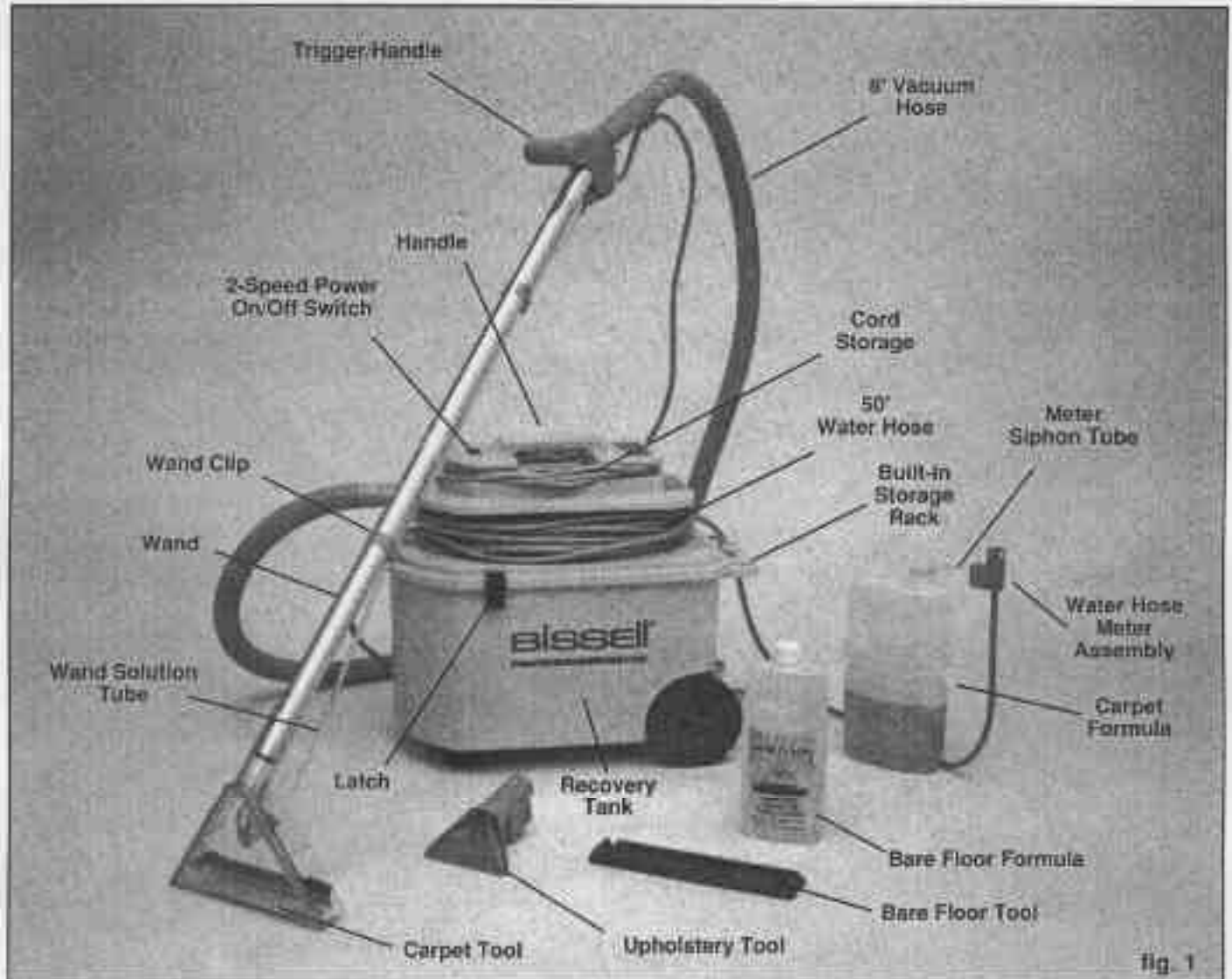

fig. 1

TABLE OF CONTENTS

Part Identification	4
Setup	5
Operation - Carpets	7
- Upholstery	9
- Bare Floors	10
Troubleshooting	11
Maintenance/Storage	11
Replacement Parts	12

SETUP



1. **Unpack machine from carton.** Remove the packing materials and the parts stored inside for shipment, fig. 2. Remove all materials packed inside (trigger/handle, wand solution tube, wand clips (2), ball float, float frame, Carpet Formula, carpet tool, upholstery tool, bare floor tool, and adapters).

Remove wand tubes, 8' vacuum hose, 50' water hose, and the cleaning formula from the carton.

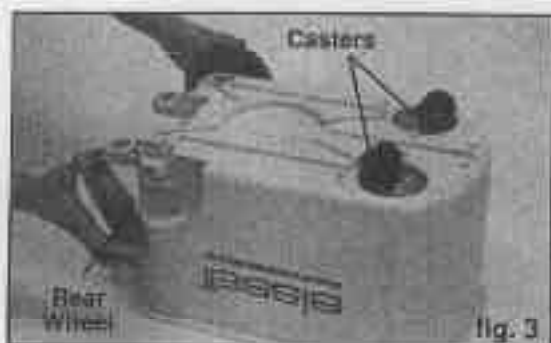

2. **Attach the casters and wheels.** Turn the tank upside down and insert the two casters into the holes on the front of the tank bottom, fig. 3. Push in until you feel and hear them snap into place. Make sure they swivel freely. Turn the tank onto its side and press on the rear wheel, fig. 3. Be sure all three prongs of the wheel post are positioned inside the hole in the tank, then press firmly on the center of the wheel until it snaps into place. Wheels should turn freely. Repeat for opposite wheel.

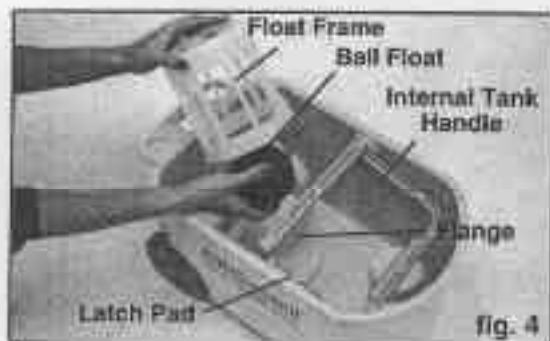

3. **Assemble the float and frame.** Turn the tank right side up. Place the ball float inside the raised flange on the bottom of the tank. Position the float frame over the ball float and press onto the flange, fig. 4. Press firmly. If the frame is hard to press on, run hot water over the rim for about 30 seconds to soften the plastic, then press on while it is still hot. Ball float and frame must be in place before running this machine.
4. **Lower the internal tank handle.** Make sure the internal tank handle is lowered before assembling top.



5. **Replace the machine top.** Align the latches on the machine top with the latch pads on the tank, fig. 4. Press the latches down until they catch. To unlatch, pull the bottom of the latches away from the tank.
6. **Attach the vacuum hose to the front of the machine,** fig. 5, and to the trigger/handle, fig. 6. To attach these pieces, push in the small latching buttons (A) as you insert the matching pieces. Line up the button and hole... the button will spring up, locking the pieces together.

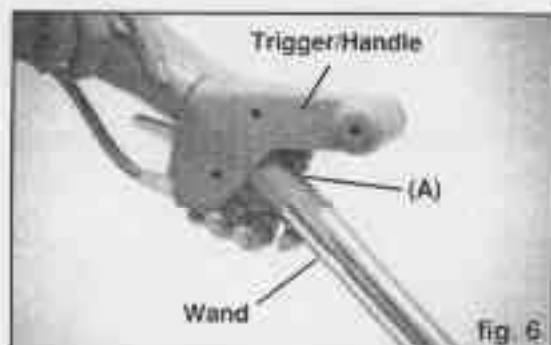

7. **Assemble the wand.** Connect the two aluminum extension wands together and insert into the trigger/handle, fig. 6.

8. **Clip the wand solution tube to the wand.** Push the wand solution tube (short tube) into the indent in one of the wand clips (open, 'C'-shaped clips); then snap the clip onto the wand; fig. 7.



9. **Attach carpet tool** to the base of the extension wand, fig. 8.

10. **Connect the wand solution tube.** Push the end of the tube over the spray nozzle on the rear of the carpet tool, fig. 8. Attach the other end of the wand solution tube to the nozzle on the bottom of the trigger/handle, fig. 9. (Note: Tube does not have to contact the black O-ring.)



11. **Attach the 50' water hose.** This is the 50' hose that can be coiled around the top of the cleaner. Attach the end of this hose with the threaded fitting to the fitting on the back of the trigger/handle, fig. 9. NOTE: If hose will not thread on, see the Hose Fitting Maintenance Note, ill. 2, at the end of this section. Snap the water hose into the built-in hose clip on the rear of the handle. Tighten all fittings finger tight – DO NOT USE TOOLS. Overtightening will damage the plastic fittings.



12. **Connect the water hose meter to your water supply.** Unwrap enough of the water hose to reach from the water supply faucet to the farthest area to be cleaned. The hose may then be held in place with the hose clips molded into the tank top. Insert the cone-shaped screen washer, fig. 11, into the threaded metal fitting and then attach the meter to your faucet with the adapters provided.

Most faucets have aerators or screen filters which must be removed to attach the water hose meter. Unscrew the aerator by hand if possible. If pliers are necessary, wrap the aerator with tape to avoid damaging the finish. Adapters are provided to fit internal threaded faucets. Additional adapters may be necessary to fit laundry-type threads. Check with your local hardware store or call Customer Service at 1-800-237-7691. Threadless adapters are also available.



13. **To use the upholstery cleaning tool or the bare floor tool,** see pages 9 and 10 for instructions on the use of these tools.

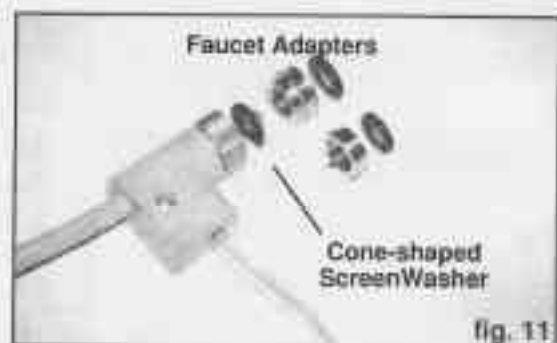

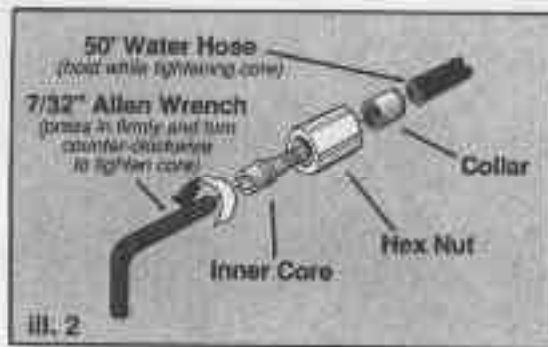

HOSE FITTING MAINTENANCE NOTE

Occasionally the inner core of the hose fitting may loosen. If this occurs, the water hose will not thread onto the trigger/handle assembly. This situation may be corrected by simply retightening the fitting. Make sure the collar is pressed all the way onto the hose, insert a 7/32" Allen hex wrench and while holding the hose, press the wrench in firmly and turn counter-clockwise as shown in the illustration.



OPERATION

CARPET CLEANING INSTRUCTIONS

1. **Before cleaning carpets, vacuum thoroughly** with a regular vacuum cleaner to remove larger pieces of dirt and debris.

NOTE: This machine is designed for **DEEP CLEANING ONLY!** **DO NOT** use as a dry vac! Machine damage or personal injury may result if used as a dry vac.

2. **Water temperature.** The best cleaning results are obtained by using warm water (120°F/48°C max.). To avoid cold water starts, run water up to temperature before connecting the solution meter and hose.

NOTE: Always test an inconspicuous area to be certain carpets and rugs are colorfast. Deep cleaning may damage certain decorative rugs - **test first!**

3. **Connect the meter to the faucet** as described in the Setup instructions (opposite page).
4. **Place the siphon tube into the cleaning solution.** The end of the siphon tube must remain below the liquid, fig. 12.

A bottle of BISSELL cleaning formula* is included with your machine. Check the label and follow any mixing instructions if required. Before changing from one cleaning formula to another, be sure to flush the system thoroughly with plain water.

***NOTE:** Only BISSELL cleaning formulas are recommended for use with this machine. Many detergents and all purpose cleaners create excessive sudsing. Using solvents or citrus or pine oil based cleaners may damage this machine.

5. **Plug in the power cord.** Unwind the cord from the top of the machine and plug into a grounded wall receptacle.
6. **Turn on the switch,** fig. 13, and you are ready to clean your carpets. The 2-speed switch lets you choose extra suction if desired.
7. **For the best cleaning results prespot heavily soiled areas.** To do this, hold the carpet tool approximately 6 inches over the heavily soiled area and dampen** with cleaning solution by pulling the trigger. This operation can be done without the

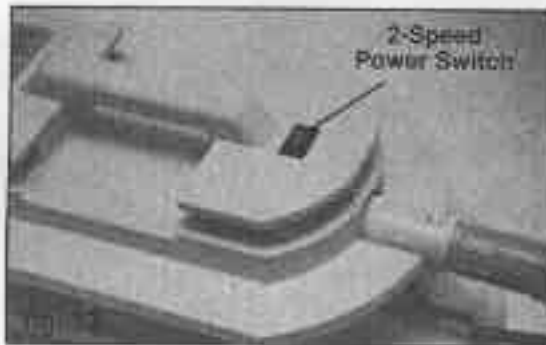

vacuum running and using only the water pressure from your faucet. Once you have prespotted the heavily soiled areas, you can then proceed to clean the entire room as directed below.

- 8. Begin cleaning** by placing the carpet tool on the carpet surface. Hold the trigger with one hand and place the other hand on the handle to control the wand. Pull the trigger to spray the cleaning solution onto the carpet** and pull the wand toward you so that the vacuum picks up the dirty water, fig. 14. It is important to pull the trigger for at least 10 seconds at a time, to be certain the cleaning formula is mixed properly with the water from the faucet. Several final passes over the carpet with only the vacuum on (finger off the trigger) will help the carpet dry faster by removing excess water.

** It is important to avoid over soaking carpets.

- 9. When the recovery tank is full**, the internal float will automatically shut off the vacuum suction – you will notice a change in the pitch of the sound from the motor. It is then necessary to empty the recovery tank. Turn the machine off, disconnect the power cord and remove the top.
- 10. Turn the water off** if you will be away from the machine for more than a few minutes.
- 11. Carry the recovery tank to a sink or drain and dump.** Use the internal handle and molded grip on the rear of the tank, fig. 15, to help balance the tank while emptying. Rinse the tank briefly, reassemble the top, and continue cleaning.

It may be necessary to empty the recovery tank more often if there is excess foaming due to soap left in your carpet from previous cleaning.

- 12. When finished cleaning**, put the siphon tube into some clean water and run the machine briefly to flush the system. Rinse all parts with clean water – see Cleaning/Storage in the User Maintenance Section on page 11.



IMPORTANT: BEFORE BEGINNING CLEANING ANY UPHOLSTERED FURNITURE, READ THE FOLLOWING INSTRUCTIONS VERY CAREFULLY.

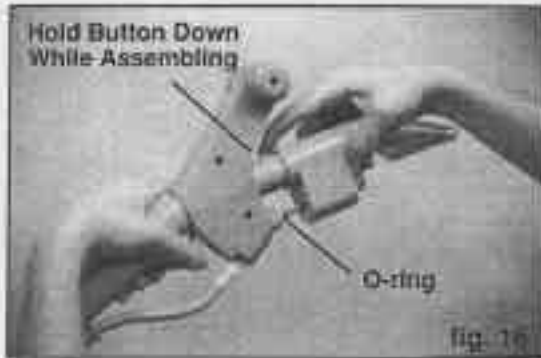

OPERATION

UPHOLSTERY CLEANING INSTRUCTIONS

- 1. It is essential that you know the type of fabric** you are going to clean and if the fabric may be cleaned with wet methods. Most popular upholstery fabrics may be cleaned by wet methods; however, delicate or unusual fabrics may be **DRY CLEAN ONLY**. Most fabrics are coded by the manufacturer to detail cleaning methods for a particular fabric. Check the label on the upholstery; it should have a cleaning code. Codes for cleaning are: W=wet clean, S=solvent only, or W/S=wet clean or solvent. If the upholstery is not coded or you are in doubt about the type of fabric, check with the dealer where the furniture was purchased. Bring in a cushion or arm cover if necessary. **CLEANING UPHOLSTERY WHICH IS NOT COMPATIBLE WITH WET METHODS MAY RESULT IN DAMAGE TO THE FABRIC. KNOW WHAT THE FABRIC IS AND HOW IT MAY BE CLEANED BEFORE USING THE BISSELL SC ON UPHOLSTERY.**
- 2. Check the stuffing material** if possible. Look inside cushions and underneath the furniture. If filling is colored it may bleed through and discolor fabric.
- 3. Attach the upholstery tool.** Disconnect the wand supply tube and the wand from the trigger/handle. Line up the vacuum and tube openings of the upholstery tool with those on the trigger/handle, fig. 16. Push the locking button down and slide the parts together until the locking button pops up. Wetting the black O-ring before assembly will make the parts slide together easier.
- 4. Test clean** an inconspicuous area several hours before starting to clean. Let test area dry completely. Inspect for changes in color, bleeding, stretching, or shrinkage. **IF IN DOUBT, TEST ANOTHER AREA.** If test area is satisfactory, proceed with cleaning.
- 5. Before cleaning upholstery, vacuum thoroughly** with a regular vacuum cleaner to remove larger pieces of dirt and debris. Clean one section of upholstery at a time. With the vacuum on, slowly pull upholstery tool toward you while depressing the trigger to release cleaning solution, fig. 17. Make a second spray pass at right angles to the first. This will eliminate any streaking or uneven appearance. To remove any excess moisture, repeat this procedure without spraying any cleaning solution. **DO NOT OVER-WET FABRIC.** 1-4 spray passes should be adequate for most cleaning jobs. Over-wetting must be avoided, as it may cause shrinkage, bleeding, discoloration, and other problems. Heavy soils and tough spots may require Bissell Aerosol Foam Upholstery Cleaner to loosen dirt before cleaning.
- 6. Curved, highly detailed or buttoned surfaces,** such as chair arms, backs and skirting, may be easily cleaned holding upholstery tool 5-6 inches from fabric and spraying surface with cleaning solution. Do not saturate. Vacuum loose soil and excess solution with upholstery tool. Repeat procedure. Should solution contact wood or painted surfaces, simply wipe dry with a clean soft cloth.

REPLACEMENT PARTS

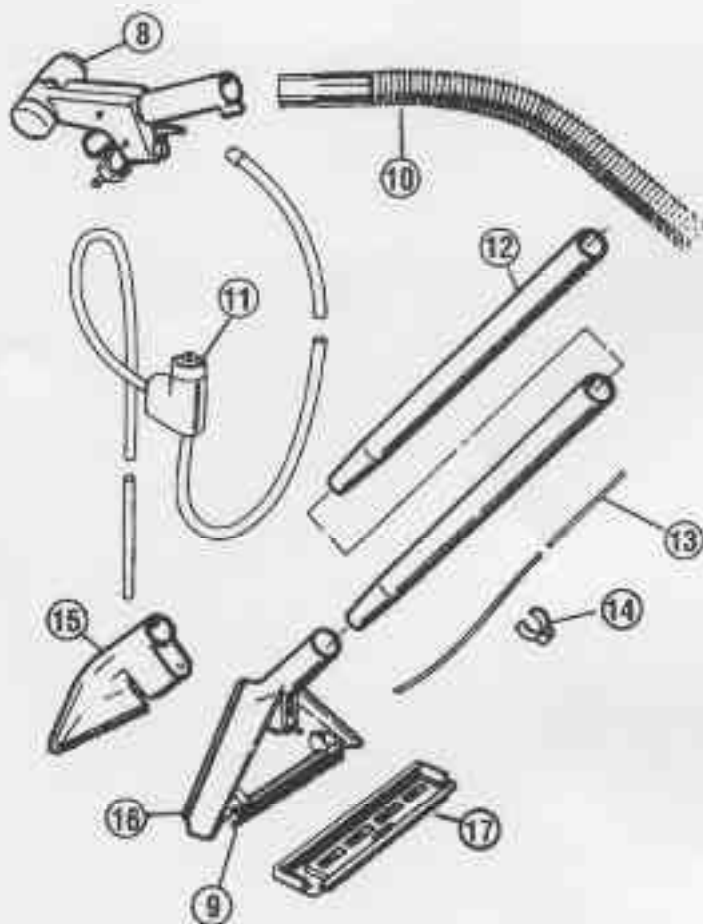
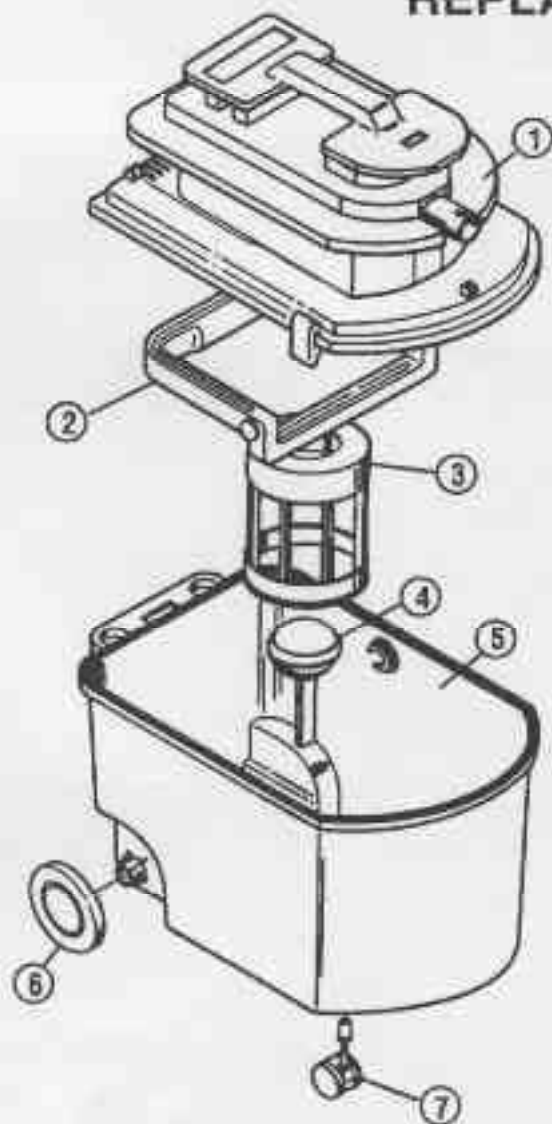

Item	Part No.	Part Name	Qty.
1	603-5512	Tank Top Assembly	1
2	010-4459	Internal Handle	1
3	013-1516	Frame, Float	1
4	010-0327	Ball, Float	1
5	015-9005	Recovery Tank	1
6	013-9788	Wheel	2
7	010-2278	Caster & Socket	2
8	016-4181	Trigger/Handle	1
9	010-1181	Carpet Tool Scrub Brush	1
10	010-4575	Vacuum Hose	1
11	603-5109	50' Water Hose/Meter Asm.	1
12	015-9661	Wand	2
13	016-9464	Wand Solution Tube	1
14	010-2464	Wand Clip	2
15	016-4706	Upholstery Tool	1
16	016-8965	Carpet Tool	1
17	015-0471	Bare Floor Tool	1

For repairs or replacement parts, visit your Authorized BISSELL Service Center or call the BISSELL Customer Service Department at 1-800-237-7691. Remember to have the machine model number and part number ready when ordering parts.

BISSELL
INFORMATION & SERVICE
1-800-237-7691 MON.-F
 8:00 AM - 5:00 PM E.S.T.

BISSELL Power Steamer Deluxe
 Model No. 1631-1
 Purchase Date: _____
 Store: _____