



**Blue Bamboo
H50 User Guide**

H50



June 05, 2007

BLUE BAMBOO
Room 10A, East Tower, Hi-Tech
King World
668 Beijing East Road, Shanghai,
P.R.C. 200001
Tel: (+86-21) 5308-4181
Fax: (+86-21) 5308-4187
www.bluebamboo.com

BLUE BAMBOO

Date: June 05, 2007

Version: 1.0

Copyright © 2007 BLUE BAMBOO

All rights reserved.

No part of this publication may be copied, distributed, stored in a retrieval system, translated into any human or computer language, transmitted, in any form or by any means, without the prior written consent of BLUE BAMBOO. All other brand names and trademarks in this guide are the property of Blue Bamboo.

Information in this document is subject to change without notice.

Trademark:

It is a registered trademark of BLUE BAMBOO.

All other trademarks are the property of their respective companies.

Certifications:

The production has been approved by CE, [FCC ID: UWJH50CM02](#), [UWJH50CM06](#). [FCC Register: US: 331MM07BH50CM03](#), [CCC SRRC and MII](#)

The Li-ion battery has been approved by UN.DOT and CE

The power adapter has been approved by CCC, TUV GS, UL, CE and FCC

[Changes or modifications not expressly approved by the party responsible for compliance could void the user's authority to operate the equipment.](#)

SAR statement:

[FCC ID: UWJH50CM02 and UWJH50CM06 which this declaration relates is conformity with the article C95.1-1999 of essential requirements and other relevant requirements of the ANSI.](#) The antennas used for this transmitter must be installed to provide a separation distance of at least 20 cm from all persons and must not be co-located or operating in conjunction with any other antenna or transmitter. [Simulation of MPE \(Maximum permissible exposure\) for the product indicates that the product is compliant with the following standards and/or other normative documents: SAR \(art C95.1-1999\): ANSI](#)

FCC statement:

This device complies with part 15 of the FCC Rules. Operation is subject to the following two conditions: (1) This  device may not cause harmful interference, and (2) this device must accept any interference received, including interference that may cause undesired operation.

This equipment has been tested and found to comply with the limits for a Class B digital device, pursuant to part 15 of the FCC Rules. These limits are designed to provide reasonable protection against harmful interference in a residential installation. This equipment generates uses and can radiate radio frequency energy and, if not in-installed and used in accordance with the instructions, may cause harmful interference to radio communications. However, there is no guarantee that interference will not occur in a particular installation. If this equipment does cause harmful interference to radio or television reception, which can be determined by turning the equipment off and on, the user is encouraged to try to correct the interference by one or more of the following measures:

- Reorient or relocate the receiving antenna.
- Increase the separation between the equipment and receiver.
- Connect the equipment into an outlet on a circuit different from that to which the receiver is connected.
- Consult the dealer or an experienced radio/ TV technician for help.

Table of Contents

Introduction.....	2
1. Operating Environment and Safety	2
1.1 Environment.....	2
1.2 Safety Concerns.....	2
2. H50 Terminal Operation	2
2.1 Unpack the Shipping Carton	3
2.2 Terminal Features.....	3
2.3 Battery.....	6
2.3.1 Installation.....	7
2.3.2 Charging the Battery.....	8
2.4 Paper Installation	8
2.5 SAM Card Installation	11
2.6 SIM Card Installation (For GPRS Module Only)	12
2.7 GPRS/Modem Module Installation.....	12
2.8 Smart Card Reader Transactions	13
2.9 Magnetic Card Reader Transactions	14
3 Maintenance.....	14
3.1 Terminal	14
3.2 Card Readers:.....	15
3.3 Printer.....	15
4 Troubleshooting.....	15
4.1 Terminal Does Not Start	15
4.2 Terminal Display Does Not Show Correct or Readable Information	15
4.3 Battery Will Not Charge	15
4.4 Printer Does Not Work	16
4.5 Serial Port Does Not Work.....	16
4.6 Terminal Does Not Process Transaction	16
4.7 Keypad Does Not Respond	17
5 Service and Support.....	17
6 Specifications	17
6.1 Power Requirements.....	17
6.2 Environmental	17
6.3 H50 Terminal Dimensions and Weight	17
7 Accessories and Documentation.....	18
7.1 How to Order.....	18

Introduction

This guide describes how to set up and install an H50 terminal. It also includes information on how to

- Protect the terminal from adverse environmental conditions
- Install and maintain the battery
- Establish communications connections through modem and GPRS

1. Operating Environment and Safety

This section provides tips on using and protecting your terminal.

The H50 is a portable terminal for performing transactions remotely. Since it is a portable unit, location is not a factor. However, follow the rules established in the environment and safety sections.

1.1 Environment

- Do not leave the terminal in a non-climate-controlled vehicle. The H50 terminal is highly sensitive to temperature extremes. Subjecting the terminal to temperatures outside the stated operating range can void your warranty
- Do not use the H50 terminal where there is moisture or high humidity, chemicals or oils, or excessive heat or dust
- Avoid electrical appliances or other devices that emit excessive voltage fluctuations or electrical noise (for example, air conditioners, electric motors, neon signs, high-frequency or magnetic security devices, or computer equipment)
- Keep the H50 terminal away from anything that radiates heat, such as a stove or motor
- Damage to the unit from exposure to sun, rain, or dust may void your warranty
- Do not use the H50 terminal near water, including bathtubs, basins, the kitchen sink or laundry tub, in a wet basement, or near a swimming pool

1.2 Safety Concerns

The following guidelines help to ensure your safety and the safety of others:

- Do not connect the power and phone cables across a walkway or high traffic area
- Avoid using the H50 terminal during electrical storms
- If using the H50 terminal while charging the battery, ensure that the unit is placed close enough to a power outlet so that the power adapter readily reaches the unit
- Do not attempt to use ungrounded power adapters, extender cables, or AC outlets.
- Don't disassemble the H50 terminal, battery or AC adapter. Only qualified technicians may service the device.
- Do not use batteries, AC adaptors or H50 terminals near water.
- Do not plug the power pack into an outdoor outlet.
- Do not short-circuit, disassemble, crush, or puncture the battery.
- Do not allow metal to touch battery terminal.
- Do not expose the battery to fire or water.

2. H50 Terminal Operation

This section describes the features of the H50 terminal, including:

- Providing power to the terminal
- Charging the battery
- Installing paper
- Installing modem or GPRS
- Completing magnetic card and smart card transactions

2.1 Unpack the Shipping Carton

Open the shipping carton and carefully inspect the contents for possible tampering or shipping damage. The carton contents include:

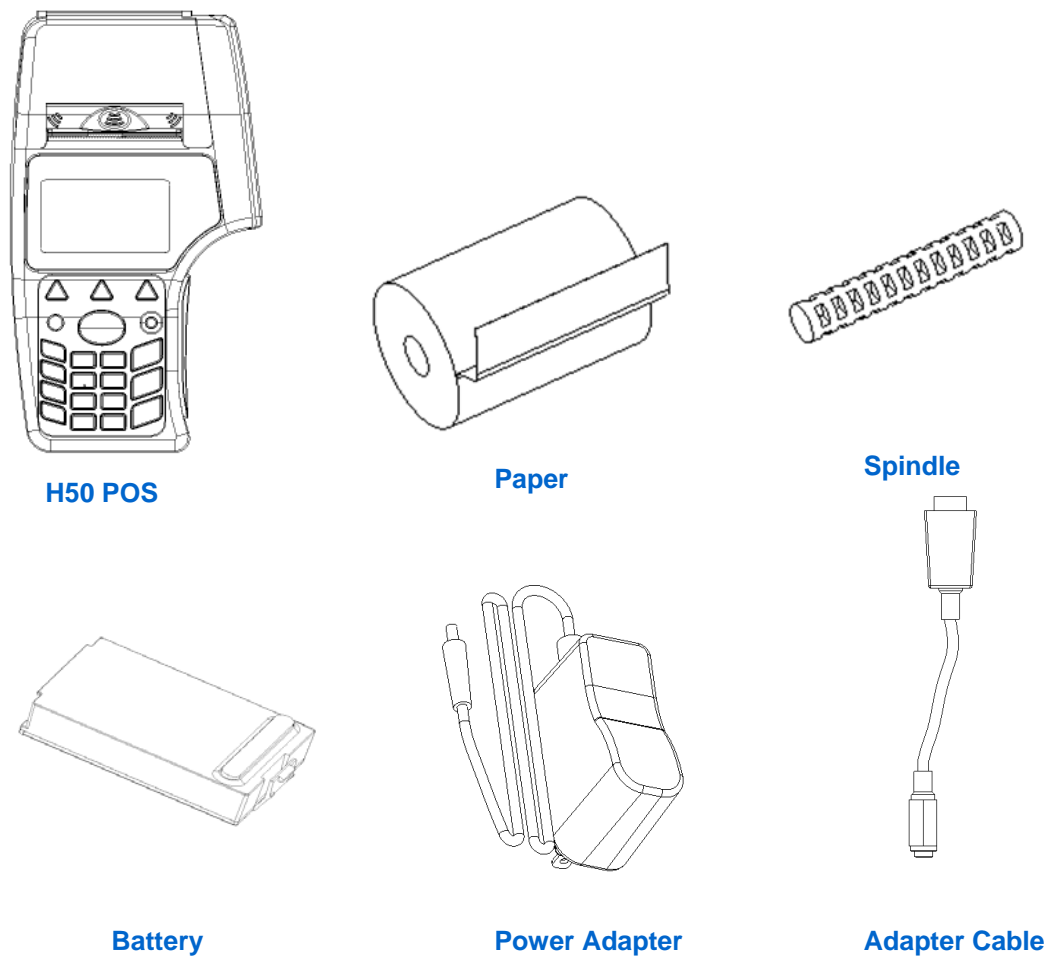

(Figure 1) H50 Terminal Shipping Carton Components

2.2 Terminal Features

Features of the H50 terminal is shown as in Figure 2 and Figure 3:



(Figure 2) H50 Terminal Front



(Figure 3) H50 Terminal Back

- **The LCD display**
- **Alphanumeric keys are in a Telco style form**

- 1 qz
- 2 abc
- 3 def
- 4 ghi
- 5 jkl
- 6 mno
- 7 prs
- 8 tuv
- 9 wxy
- 0 -sp
- , ' "
- #

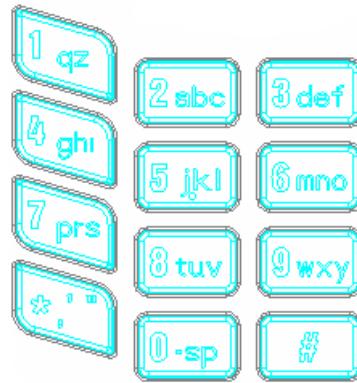

- **Three Color-coded-function keys**

- Enter – This is the green key with a downward vertical right angle arrow label.



- Clear – This is the yellow key with a leftward arrow label.



- Cancel – This is the red key with an "X" label.



- **4-navigation key** – This is the navigation key to help the user select the correct menu option. The upper and lower keys help the user scroll up and down the menu. The left and right keys help the user move to a higher or lower menu level.

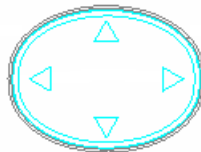

- **Power on/off key**



- **Menu key** – Displays the main menu for that application.



- **Three programmable function keys** – These keys are placed just below the display. The keys will point to three different areas on the display. The user can then select an option displayed in one of these areas.

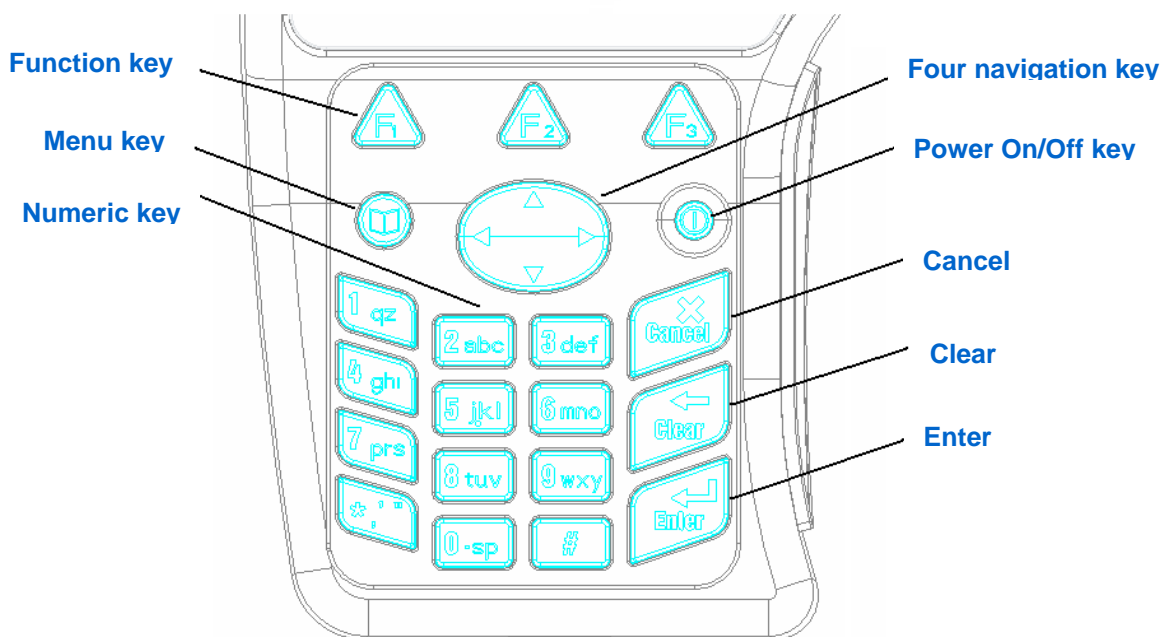

(Figure 4) Keypad Placement

2.3 Battery

The H50 wireless terminal uses a Li-ion battery. The internal logic of the battery prevents both overcharging and undercharging (a fault condition in which the battery level goes well below the minimum acceptable charge and the battery becomes unusable).



Note:

Conserve battery power by turning the H50 terminal off when not in use. If the terminal will not be used for several days, remove the battery from the terminal, as it continues to discharge even when the terminal is turned off.

2.3.1 Installation

The battery will be shipped with contact protective film which needs to be removed. See Figure 5.

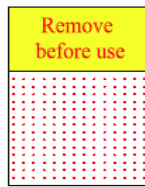

(Figure 5) Battery contact guard

The battery installs in a slot on the back of the terminal, as shown in Figures 6 and 7.

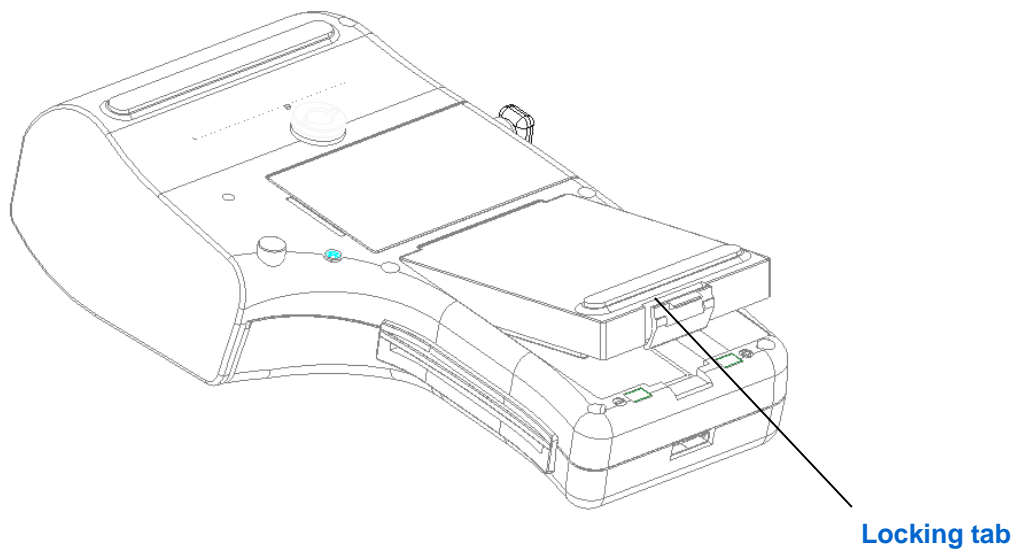

(Figure 6) The locking tab clicks when the battery is in place.

To remove the battery, push the locking tab at the bottom of the battery and pull the battery from its slot.

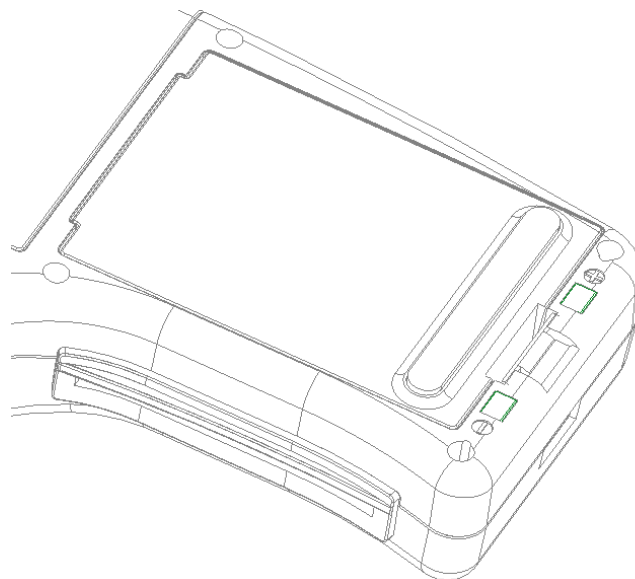

(Figure 7) Battery installed

**Warning**

- Do not dispose of batteries in a fire. Li-ion batteries must be recycled or disposed of properly
- Do not dispose of Li-ion batteries in municipal waste sites
- Use only batteries and power packs approved by Blue Bamboo
- Do not plug the Power Adapter into an outdoor outlet

2.3.2 Charging the Battery

- When the unit turns on, allow the battery to fully discharge. Then connect the power adapter to the unit and charge for 3-4 hours. The unit is now ready for operation.
- **If the battery hasn't been used for over half a year, suggest do a full-discharge and full-charge cycle to keep the battery's activity**
- To determine the charge state of the battery, turn on the terminal. The charge status is displayed on the right of LCD. Five bars indicate a full charge without flash. The charge status will flash to indicate that the unit is charging
- On the underside of the H50 is one port—the *power* port. Use this port to connect the H50 to the power adapter to recharge the battery through the unit. To connect the H50 terminal to power:
 - a. Insert the power adapter into power port of the terminal (Figure 8).
 - b. Plug the power adapter into a wall outlet.

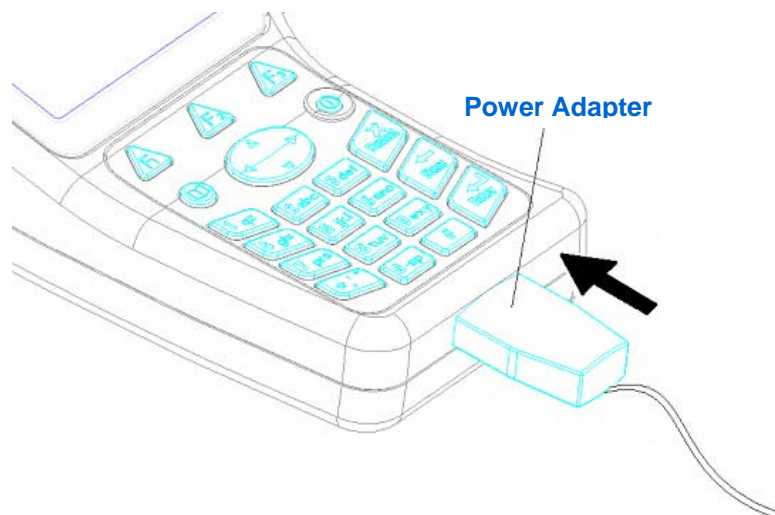

(Figure 8) Plug in H50 Terminal Adapter Cable

2.4 Paper Installation

- The internal thermal printer uses a roll of single-ply, thermal-sensitive paper 58 mm wide and 40 mm or less in diameter

- A pink out-of-paper indicator line appears on the edge of the paper approximately 18 inches before the end of the roll. After this line appears, there is enough paper remaining on the roll to conclude at least one transaction

To install the paper roll in the internal thermal printer:

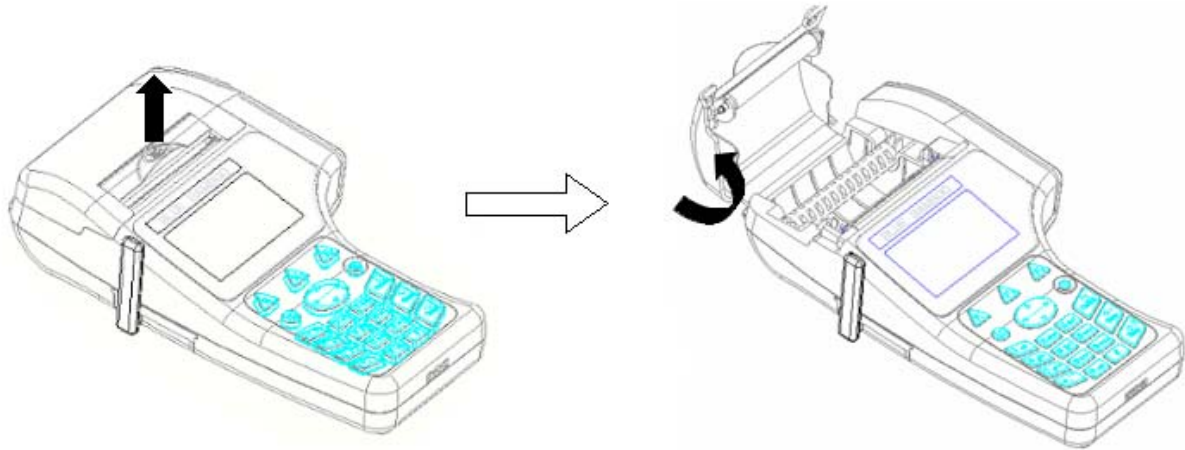

(Figure 9) Open the printer cover

- Open the printer cover by rotating the printer cover up and back as seen in Figure 9. Note that the cover is hinged and it is unnecessary to remove it completely from the unit
- Loosen the glued leading edge of the paper from the roll
- Slide the axle through the printer roll and drop the paper roll into the printer tray so paper feeds from the bottom (Figure 10)

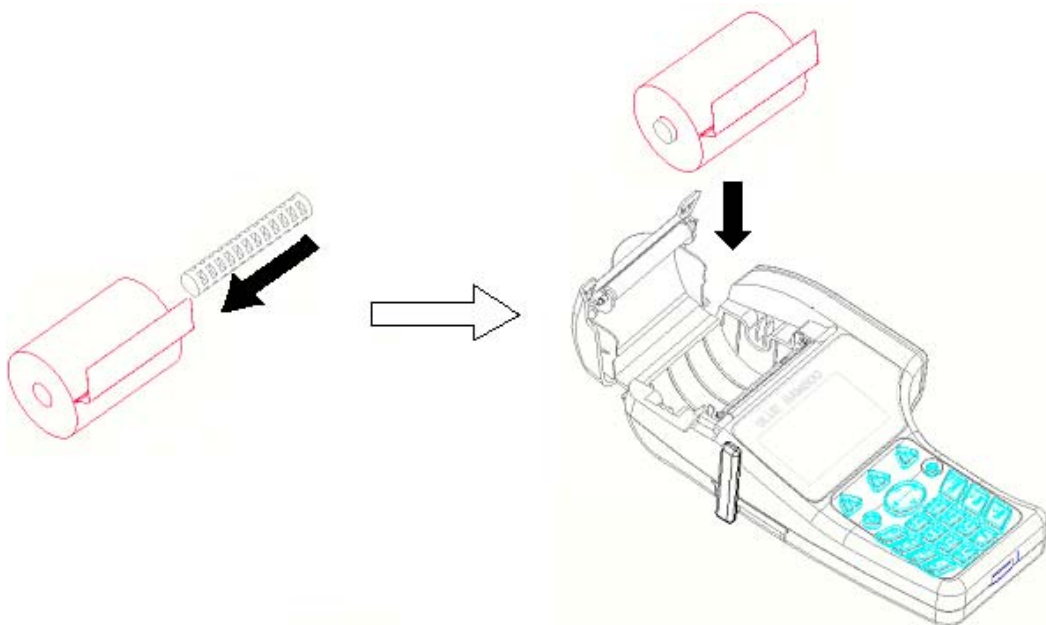

(Figure 10) Load Paper

- d. Close the cover by gently pressing the paper cover until it clicks shut. Allow a small amount of paper to extend outside the cover, as shown in (Figure 11)

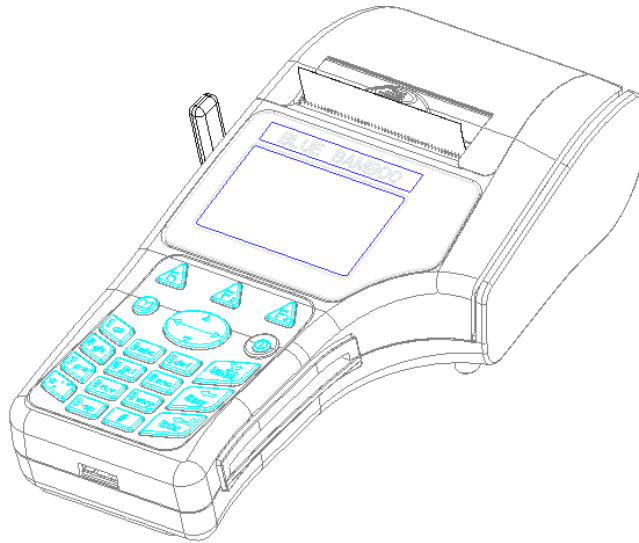

(Figure 11) Complete paper installation

- e. Insert the serial cable (18 pin) into terminal.

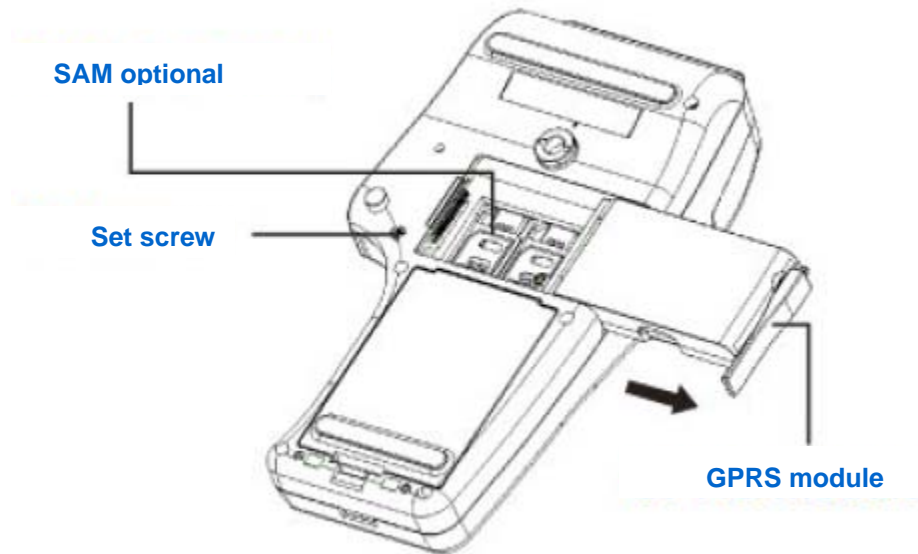

Figure 12 Install serial cable

2.5 SAM Card Installation

When you first receive the H50 terminal, you may need to install a Secure Access Module (SAM) card. The following procedure describes SAM card installation:

- f. Remove the GPRS/Modem module. The SAM door is located beneath the GPRS/Modem module, see Figure 13
- g. Release the SAM card holder doors by sliding them toward you
- h. Lift the doors to open the card holders (Figure 14) and insert the SAM card in the door with the electronic chip facing down and the cut-out corner on top. (Figure 15)
- i. Close the lid of the card holder and slide it up to lock it into place



(Figure 13) SAM ports doors

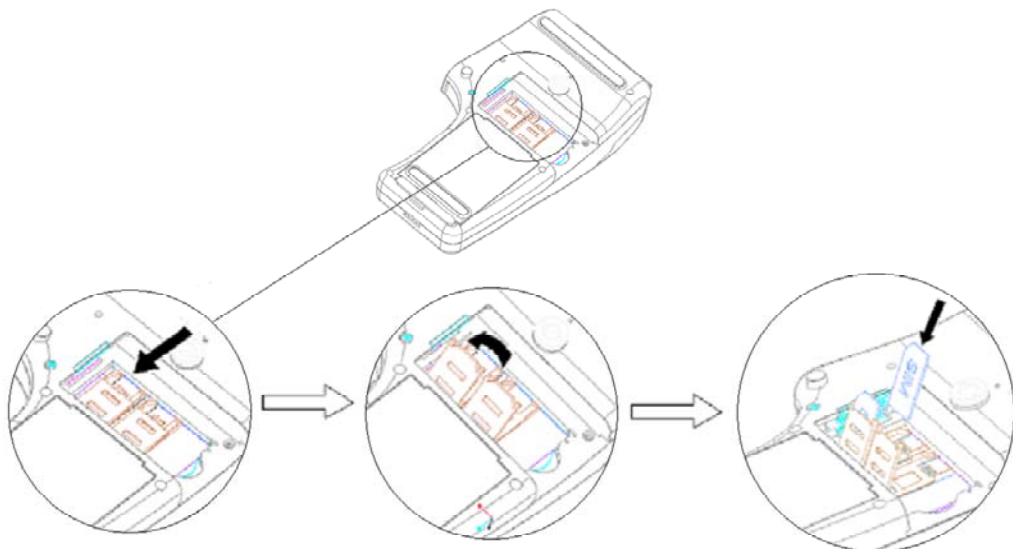

(Figure 14) Open card holder door

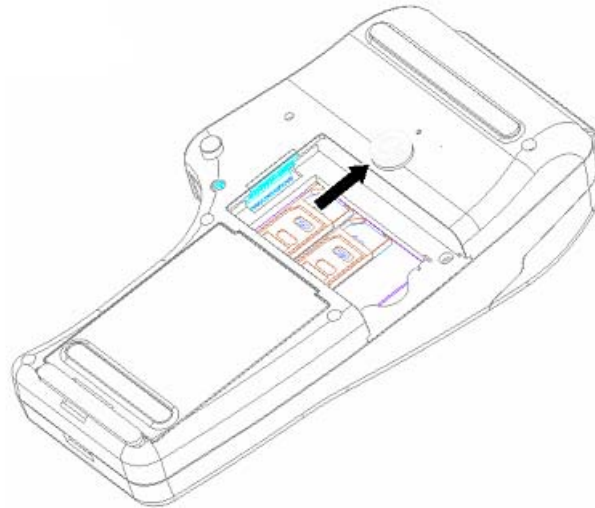

(Figure 15) Insert SIM card



CAUTION: Observe standard precautions for handling electrostatic sensitive devices.

Electrostatic discharges can damage this equipment. Wearing an anti-static wrist strap grounded to a metal surface is recommended.

2.6 SIM Card Installation (For GPRS Module Only)

The SIM (Subscriber Identity Module) card is a smart card inserted in the GPRS module of the H50 terminal that contains your account information. Use the following procedure to install or replace a SIM card:

- a. Hold the GPRS module in one hand and the SIM card in the other
- b. Insert the SIM card with the electronic chip facing up and the cut out corner pointing away from the module, as seen in Figure 16. Be sure to insert the SIM cards in the GPRS module before installing the module

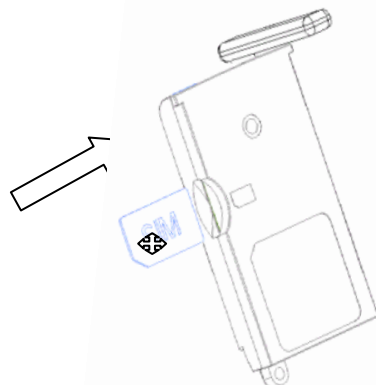

(Figure 16) Insert SIM Card

2.7 GPRS/Modem Module Installation

To insert GPRS/Modem Module into the terminal:

- a. Turn the terminal over so that you are facing the back of the terminal (Figure 17)
- b. Hold the terminal in your left hand and the GPRS/Modem Module in your right hand
- c. Insert the GPRS/Modem Module gently into the terminal slot with the modem lock oriented to the lower left
- d. Use the screw to lock the GPRS/Modem Module into place

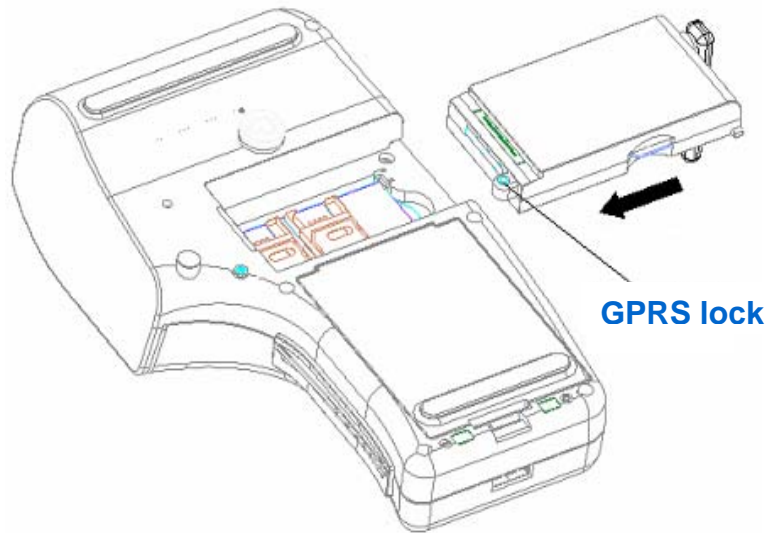

(Figure 17) Install GPRS/Modem Module

2.8 Smart Card Reader Transactions

To conduct a smart card reader transaction:

- a. Position the smart card and insert it into the smart card reader slot in a smooth, continuous motion until it seats firmly with the chip facing up (Figure 18). Leave the smart card in the card reader until the transaction is complete. Premature removal voids the transaction.

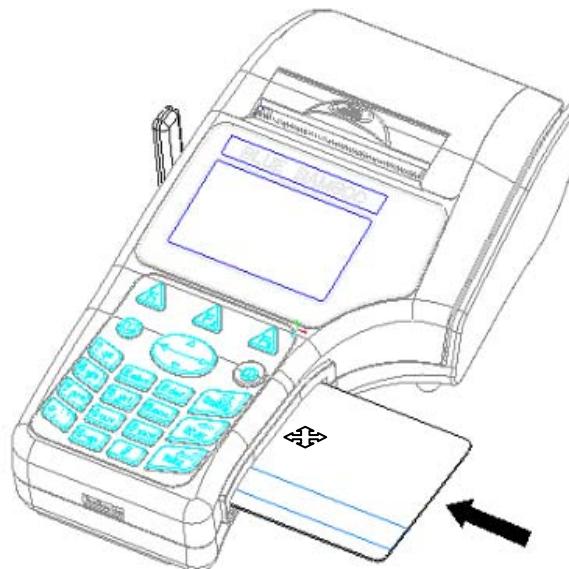

(Figure 18) Insert card

- b. Remove the card when the display indicates the transaction is complete.

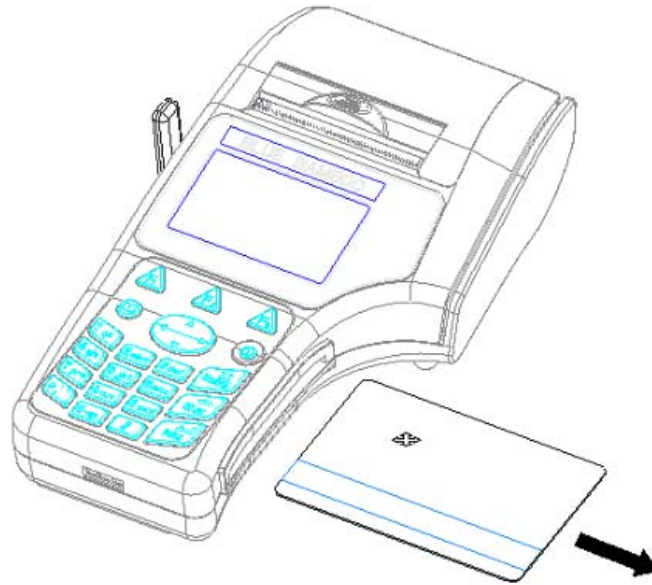

(Figure 19) Remove card

2.9 Magnetic Card Reader Transactions

To conduct a magnetic card reader transaction:

- Position the card with the magnetic stripe facing down and towards the printer.
- Swipe it through the reader in either direction, as shown in Figure 20.

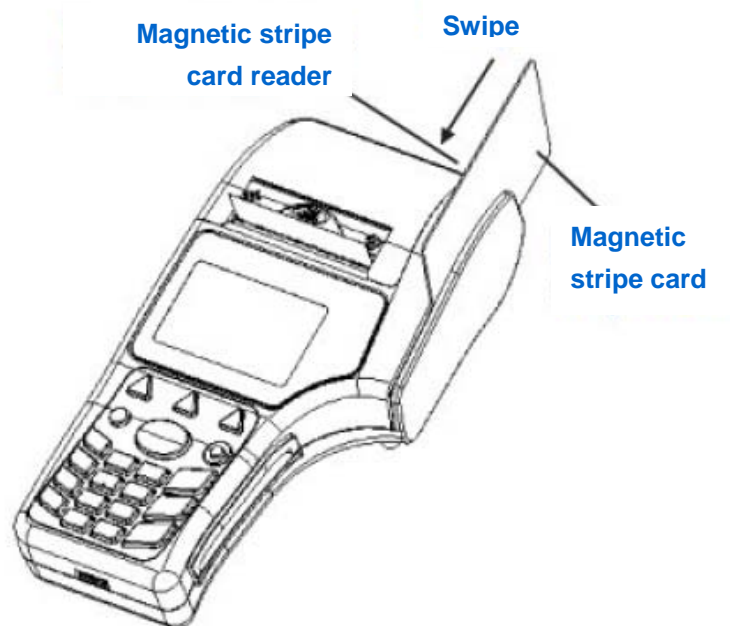

(Figure 20) Swipe card

3 Maintenance

3.1 Terminal

- For normal dirt, use a clean cloth slightly dampened with water and a drop or two of mild soap. For stubborn stains, use alcohol or an alcohol-based cleaner

- Never use thinner, acetone, trichloroethylene, or key tone-based solvents — these chemicals can deteriorate plastic or rubber parts
- Do not spray cleaners or other solutions directly onto the keypad or display

3.2 Card Readers:

- The magnetic and smart card readers require no regular maintenance. For card reader service, contact your distributor or service provider.



CAUTION: Do not attempt to clean the card readers. Doing so may void your warranty.

3.3 Printer

- Keep the printer port clean. Avoid contact with water.

4 Troubleshooting

Blue Bamboo follows stringent quality control standards in the manufacturing of H50 terminals. Each unit that leaves the factory receives numerous tests to ensure quality and reliable operation. However, if you encounter a problem in operation, read this section for possible causes and solutions. If the problem persists or if it is not described below, contact your local Blue Bamboo representative for assistance.



Caution: Do not, under any circumstance, attempt to disassemble the terminal. If a terminal has been disassembled it will void the warranty.

4.1 Terminal Does Not Start

- Check to make sure the Battery protection plastic has been removed.
- Ensure that the battery charge state is not below the critically low level
- Recharge or replace the battery
- Make sure that you press the power on/off key for approximately 2 seconds, until the unit lights up

4.2 Terminal Display Does Not Show Correct or Readable Information

- Shut off and restart the terminal
- Recharge or replace the battery
- If the problem persists, contact your local Blue Bamboo representative for assistance

4.3 Battery Will Not Charge

- The battery must initially receive a full charge and then full discharge to calibrate its full charge capacity. This operation is performed at manufacture; however, it is recommended that the battery receive a full charge/discharge once a year
- Conserve battery power by turning the H50 terminal off when not in use. If the terminal is not to be used for several days, remove the battery from the terminal as it continues to discharge even when the terminal is turned off
- The H50 terminal will notify the user when the battery charge is sufficiently low and may automatically shut off if the battery reaches a critically low state. If the battery is used until it is completely dead, it make

take several recharge attempts to reset the safety circuit when charging. To check that the safety circuit has been reset, simply turn on the terminal. If it turns on, it was reset, if it does not turn on reconnect the power adapter and begin charging again

4.4 Printer Does Not Work

- Check battery status. The printer will not print if there is an insufficient charge remaining in the battery to complete the print operation
- Check if the printer is out of paper and that the roll is properly installed. Open the paper roll cover and install a new roll of printer paper and ensure that the roll is feeding from the bottom
- Verify that the printer roller and paper roll dust cover are properly installed
- If the problem persists, contact your local Blue Bamboo representative for assistance

4.5 Serial Port Does Not Work

- Check the serial cable connection
- Ensure the outlet has power
- The cable connecting the optional device to the H50 base serial port may be defective. Try a different serial cable.
- If the problem persists, contact your local Blue Bamboo representative for assistance.

4.6 Terminal Does Not Process Transaction

There are several possible reasons why the H50 terminal may not be processing transactions. Use the following steps to troubleshoot failures:

1. Check the magnetic card reader

- Perform a test transaction using several different magnetic stripe cards to ensure the problem is not a defective card
- Ensure that you are swiping cards properly. With the H50 MSR card reader, the black, magnetic stripe on the card should face down and left, toward the LCD screen

2. Check the smart card reader

- Perform a test transaction using several different smart cards to ensure the problem is not a defective card
- Ensure that the card is inserted correctly. The chip on the card should be facing up and inwards
- Ensure the smart cards are properly inserted in the cardholders and the cardholders are properly secured

3. Check the signal strength on-screen

- Indicator displays at least one bar to indicate connectivity to radio network
- Check antenna connection and orientation
- Ensure that the radio has been activated by your service provider

4. Check the telephone line

- Connect to a working telephone and check for a dial tone. If there is no dial tone, replace the telephone cable
- If the problem appears to be with the telephone line, check with the party you are trying to call to see if their system is operational. If they are not experiencing difficulties with their line, contact the telephone company and have your line checked

- If the telephone line works, contact your local Blue bamboo representative for assistance

4.7 Keypad Does Not Respond

- Check the display panel. If it displays the wrong characters or nothing at all when you press a key, follow the steps outlined in section 4.2
- If pressing a function key does not perform the expected action, refer to the user documentation for that application to ensure you are entering data correctly.
- If the problem persists, contact your local Blue Bamboo representative for assistance

5 Service and Support

- For the H50 terminal, contact your local Blue Bamboo representative or service provider.
- Visit the H50 online store at www.bluebamboo.com

6 Specifications

This section provides information on the power requirements and environmental conditions to which the units can be subjected, as well as the unit dimensions.

6.1 Power Requirements

The external AC/DC power adapter will be used only with the Li-ion batteries and it has the following requirements:

- **Construction:** adapter with a power cord to the outlet that can be country specific for the plug and a DC power cord to the H50
- **Input voltage:** 100 – 240VAC, 50/60 Hz
- **Output voltage:** 9 V DC
- **Output current:** 1000 mA
- **Safety:** certifications by country

6.2 Environmental

Temperature:

- Storage: -20C° to 60C°
- Operating: 0C° to 40 C°

Humidity:

- Storage 10% to 90% RH, non-condensing
- Operating: 15% to 85% RH, non-condensing

6.3 H50 Terminal Dimensions and Weight

	Weight (kg)	Dimension
H50 Terminal	0.424	109mm(L)x192mm(W)x53mm(H)
Unit box	0.94	260mm(L)*240mm(W)*108mm(H)
H50 master carton	11.1	560mm(L)*535mm(W)*267mm(H)

7 Accessories and Documentation

This section lists accessories and documentation available for the H50 terminal.

7.1 How to Order

- Visit the H50 online store at www.bluebamboo.com