

# Blue Line Pet Friendly TriTech Motion Detector

ISC-BDL2-WP12, ISC-BDL2-WP6



This product is intended for use in the following countries within the European Union and in other countries outside of the European Union:

**ISC-BDL2-WP12G (10.525 GHz):**

Austria, Belgium, Denmark, Finland, Greece, Italy, Luxembourg, Netherlands, Norway, Portugal, Spain, Sweden

**ISC-BDL2-WP12H (10.588 GHz):**

France, United Kingdom

**US Patent No.**

5,670,943  
7,009,106  
5,450,062

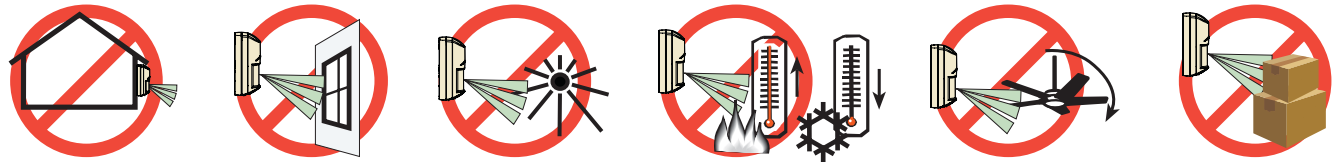
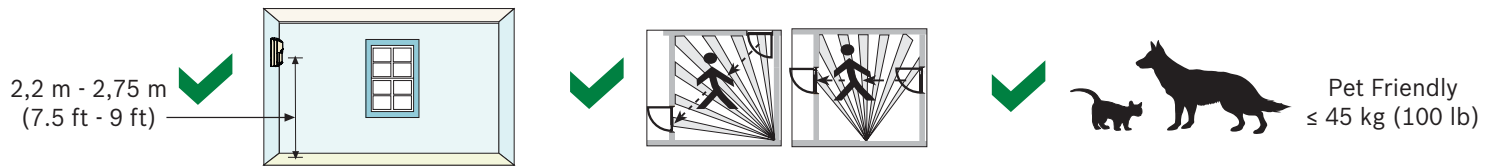

Changes or modifications not expressly approved by Bosch Security Systems, Inc. can void the user's authority to operate the equipment.

**UL**  
Use only a Listed limited-power source.

**SELV**  
Connect all wiring to a safety extra-low voltage (SELV) circuit only.

**CE** EN 50131-2-4 Grade 2  
EN 50130-5 Environmental Class II  
IP30 IK04 (EN 60529, EN 50102)

**IMQ** Solo il modello ISC-BDL2-WP12, ISC-BDL2-WP6 è certificato IMQ – Sistemi di sicurezza al primo livello di prestazione. La certificazione IMQ – Sistemi di sicurezza del MODELLO ISC-BDL2-WP12, ISC-BDL2-WP6 decade nel caso di installazione del rilevatore con gli snodi

Ligue todas as cablagens apenas a um circuito de segurança de tensão extra baixa (SELV).

Conecte el cableado únicamente a un circuito de seguridad para voltajes muy bajos (SELV).

Alle Drähte sind ohne Ausnahme an Niederspannung anzuschließen.

Sluit alle bedrading uitsluitend aan op een circuit met een extra lage veiligheids spanning.

Prenez soin de connecter tous les câbles à un circuit à très basse tension de sécurité (TBTS).

Collegare tutti i cavi esclusivamente a un circuito SELV (circuito di sicurezza a bassissima tensione).

**Temperature:**  
-30°C to +55°C (-20°F to +130°F)  
UL Listed installations, range is 0°C to +49°C (+32°F to +120°F)  
Pour les installations certifiées NFA2P, Température de fonctionnement -10°C à +55°C

**Humidity:**  
0 - 95% Relative Humidity (0 - 85% UL installations)

**Indicate Reason for Warranty Return**

- Ordered Wrong Product
- False Alarm
- Catch Performance
- Does Not Power Up
- LED Does Not Turn Off
- LED Does Not Turn On
- Alarm Relay
- Tamper Alarm
- Mechanical (Please Describe):

\_\_\_\_\_

\_\_\_\_\_

\_\_\_\_\_

- Terminal Strip
- Other (Please Describe):

\_\_\_\_\_

\_\_\_\_\_

\_\_\_\_\_

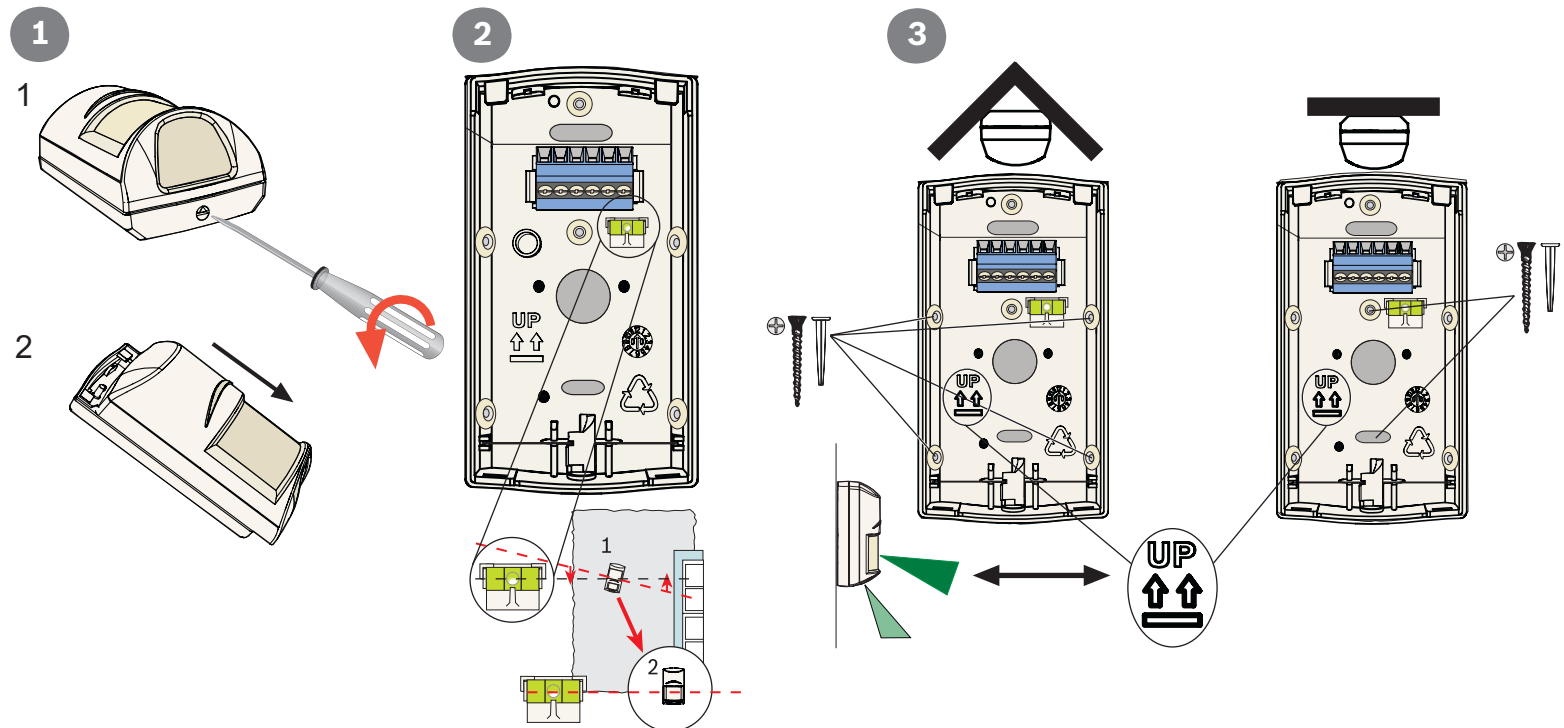

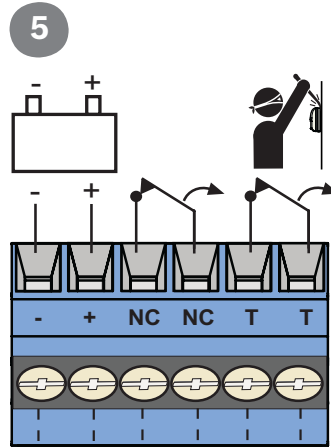
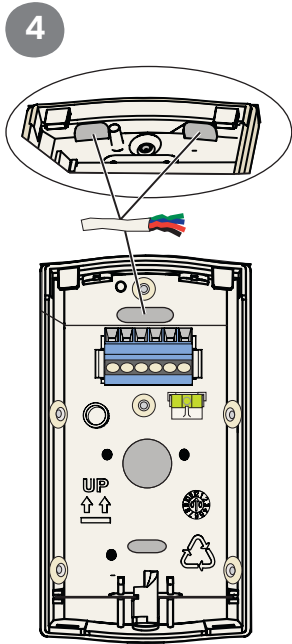

**NS** 10-15 Vcc  
 10 mA @ 12 Vcc en veille/  
 en alarme, source limitée en  
 puissance, ondulation  
 résiduelle 1 V.

UL Listed product installations,  
 provide 4 h (40 mAh) standby  
 power from the control unit or  
 by a UL Listed burglary power supply.

9 - 15 VDC  
 $\le 100\text{ mA}$ , 25 VDC, 3W  
 10 mA @ 12 VDC

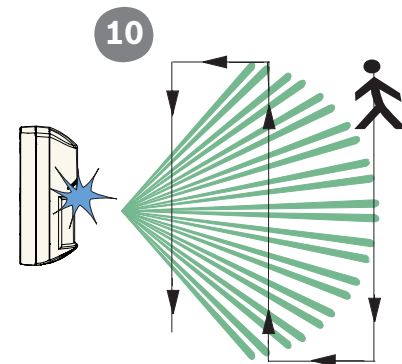
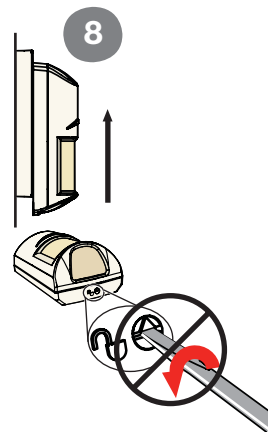
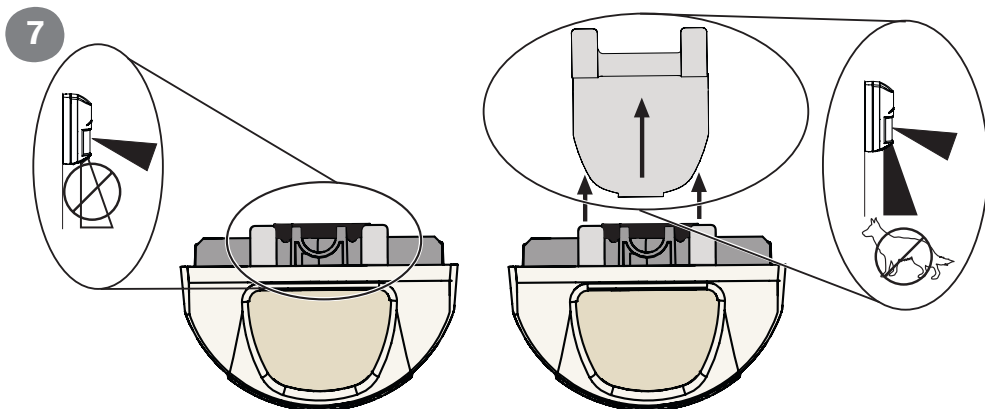
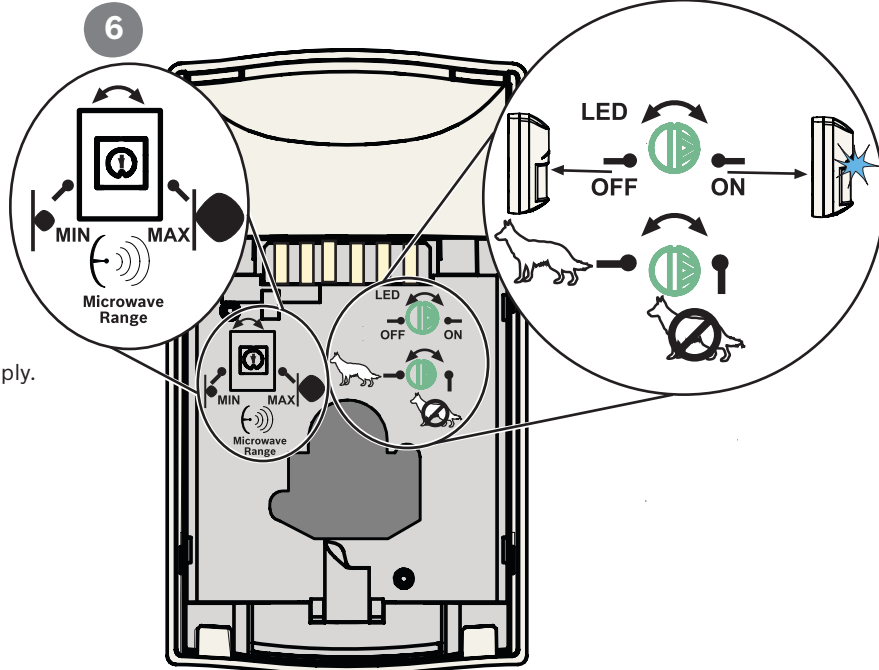

ISC-BDL2-WP12

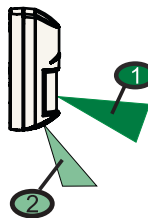
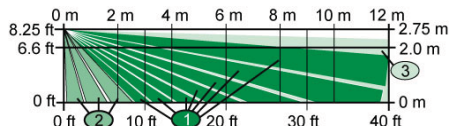
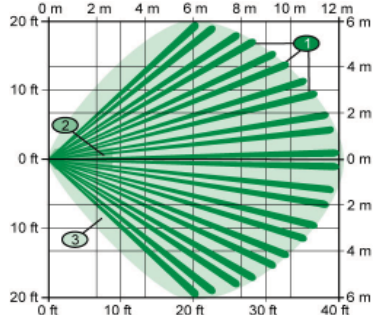

ISC-BDL2-WP6

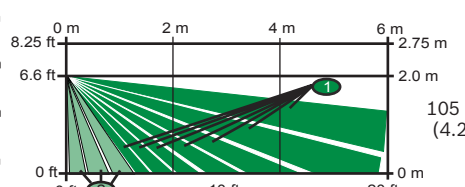
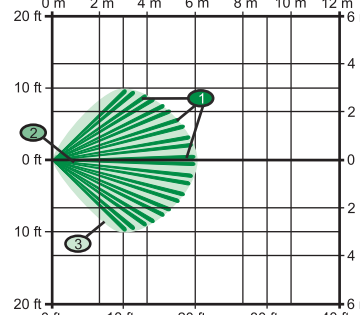

? → [www.boschsecurity.com](http://www.boschsecurity.com)