

MECHATARS™

TRAINING MANUAL



WWW.MECHATARS.COM

6+

 **WARNING:**
CHOKING HAZARD-Small parts.
Not for children under 3 years.

TABLE OF CONTENTS

Important Safety Information	2
Introduction	3
Leveling Up Your Mechatar	4
Connecting Your Mechatar to the Mechaverse	5
Remote Control Features	6
Quick Start Instructions	7
Elements	8

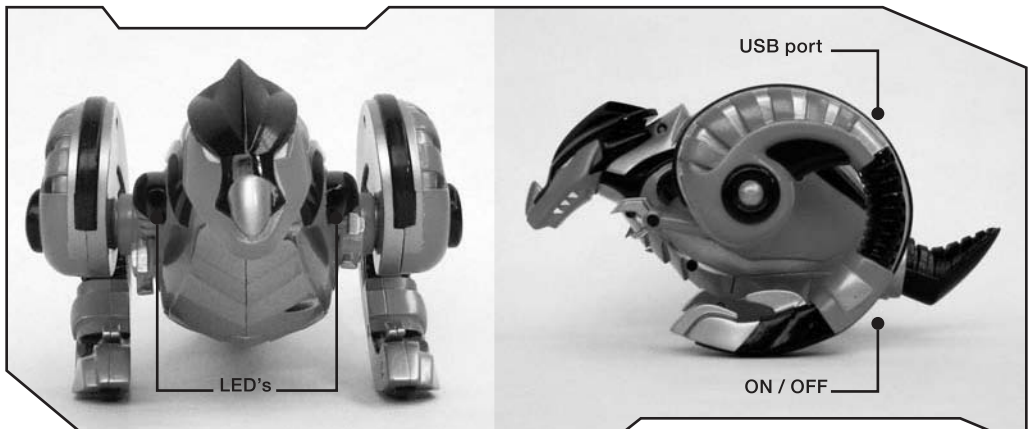

Package contents:

1 Mechatar

1 Remote Control

\$5 Mechra Card

Element Chart

USB Cable

IMPORTANT SAFETY INFORMATION

Battery information:

- Mechatar uses 4 AAA LR03 alkaline batteries (Not included)
- Remote control uses 3 AAA LR03 alkaline batteries (Not included)

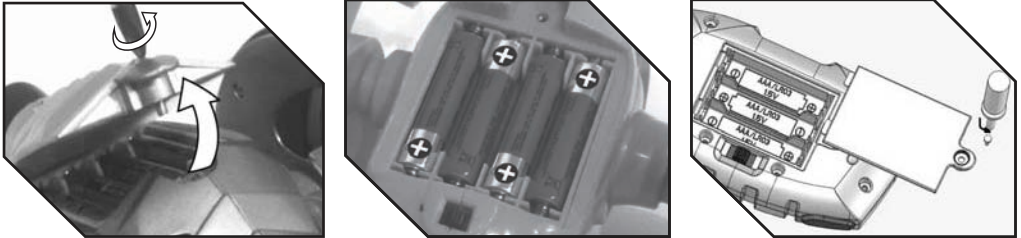

Important information:

- Batteries should be replaced by adults.
- Ensure battery polarity is correct
- Use only recommended type of battery. The Mechatar and the Remote Control both require AAA batteries for operation.
- Do not mix old and new batteries or different types of batteries
- Remove exhausted batteries from your Mechatar and Mechatar Remote Control
- Replace all batteries of the same type/brand at the same time.
- Do not short circuit terminals
- Remove batteries if you are not going to play with your Mechatar for an extended period of time
- Non-rechargeable batteries are not to be recharged.
- Rechargeable batteries are to be removed from the toy before being charged.
- Rechargeable batteries are only to be used under adult supervision.
- Do not use rechargeable batteries
- Mechatars will emit a "low power" message when battery power is running low
- Mechatars are designed for children ages 6 and older
- Use Mechatars indoors in dry locations
- Do not place Mechatars close to the edge of an elevated surface while playing with it
- Do not throw Mechatar
- This manual contains important information and must be retained.

TWO WORLDS, ONE WAR...

THE INITIATIVE

Two worlds, one war--this is your reality. You are now part of a cross-dimensional effort to battle against the greatest threat the universe has ever known, The Swarm. If you decide to join our ranks you will become one of the legendary members of our coalition called the Initiative. Now it is in your hands--can you save us all?

The Initiative was founded years ago when a group of human scientists discovered an inter-galactic rift between the Earth and the Mechaverse, a distant galaxy never before known to humankind. Through this rift, the scientists were able to make contact with the Mechatars, who told the humans the sad tale of their ongoing war against the Swarm. The scientists were determined to help and quickly formed a top-secret society called the Initiative.

We at the Initiative have one mission--to aid the Mechatars in their struggle by training Mechatars here on Earth and helping them fight the Swarm in the Mechaverse. But we need your help to achieve these goals and end the Swarm threat once and for all. If you prove worthy, you can one day consider yourself a member of our elite fighting force.

As a member of our team you will plan attacks, execute missions and learn more about the fascinating cultures of the Mechaverse. When you travel online to battle in the Mechaverse at www.Mechatars.com, you will enter the incredible world of the Mechatars. Play online or put your Mechatar into high gear here on Earth. The Swarm may be anywhere and it is your duty to confront them wherever they appear. Are you up to the challenge? Are you ready to be a member of the Initiative? If so, there is no time to waste. Begin your training today!

Sincerely,
Commander Shawn Outlaw
Leader of the Initiative

LEVELING UP YOUR MECHATAR

As a member of the Initiative, you will experience the thrill of online battles as well as the intensity of offline missions. In order to build a squad of powerful Mechatars, you will need to fight the battle in both worlds.

As you progress, your Mechatar will evolve as it learns new abilities and wields more powerful weapons. The key is completing missions that earn your Mechatar more status and strength.

Missions

As long as the struggle with the Swarm continues, you will need to complete missions to advance the cause of the Initiative. You will receive new missions in the Mechaverse and you can equip missions to your Mechatar at any time. You will access missions on your Mechatar by entering "Mission Mode".

Battles

Mechatars are bred to fight and they know that training is key to improving their skills. When two Mechatars meet up on Earth, they love to put their talents to the test by engaging in a battle. You'll learn all about the deep strategic battle system by taking the online tutorials at www.Mechatars.com. How to master weapons, attacks and Elements to take down rival Mechatars and eventually, the Swarm!

Training battles are also available in the Mechaverse for all skill levels. Test matches are a great way to better your record, gain experience and level up.

Mechra

As you explore the Mechaverse you may want to pick up some additional items to aid in the battle against the Swarm. The currency of the Mechaverse is called Mechra and you can use it to buy things like elite missions, elite taunts and rare weapons. Visit the store at www.Mechatars.com frequently to find the latest items

As you play the game, you'll also earn Credits for completing basic activities. Credits can be spent on tons of cool things in the store as well.

CONNECTING TO THE MECHVERSE

URGENT: Your Mechatar needs to gather critical data from the Mechaverse. Connect him immediately to your computer!

It is critical to connect your Mechatar frequently to the Mechaverse because that is how you upload experience points to the Mechaverse and download new mission data and other new features.

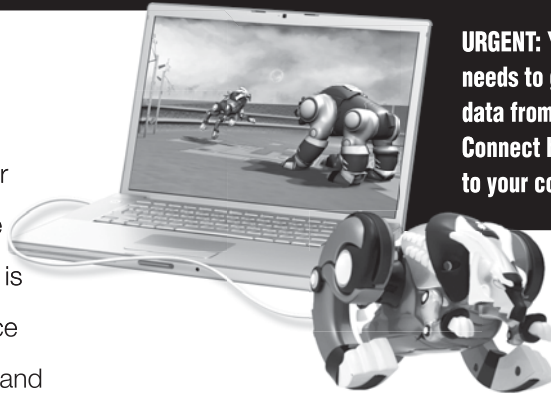

To connect your Mechatar:

1. Insert smaller end of supplied USB cable into the USB receptor on the back of the Mechatar.
2. Insert opposite end of USB cable into an available port on your personal computer.
3. Turn your Mechatar on.
4. Make sure your computer is connected to the internet.
5. If this is the first time you are connecting your Mechatar to the computer, you will be prompted to install the Mechatars Client software.
6. Create a new user account at www.Mechatars.com. If you have an existing account, log in to that account.
7. Make sure to follow all instructions carefully to ensure a safe and secure connection.

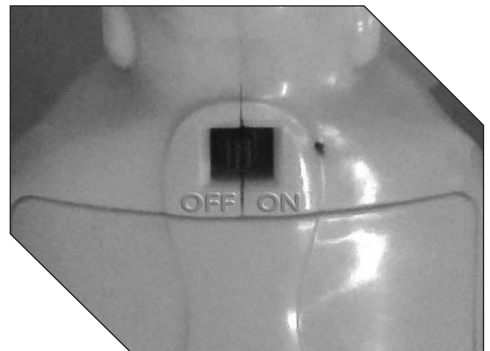
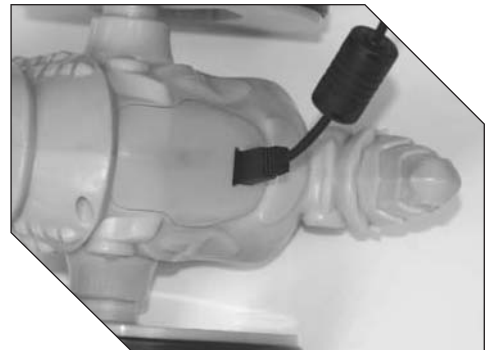

To disconnect your Mechatar:

Once you have received a message indicating it is safe to disconnect, simply pull the USB cable out of the back of the Mechatar.

REMOTE CONTROL FEATURES

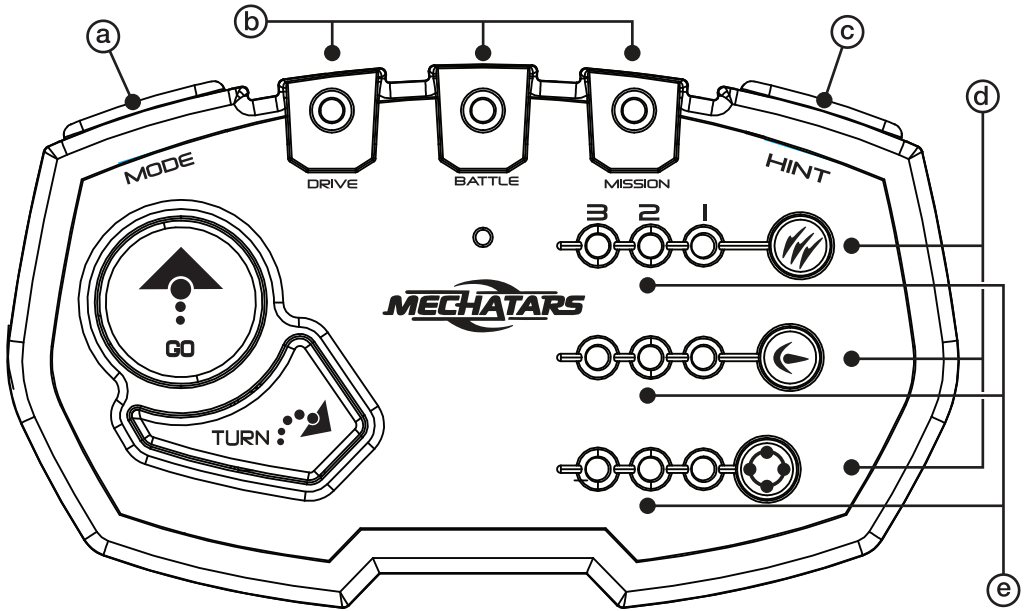

 The Go Button moves your Mechatar forward and confirms selections

 The Turn Button makes your Mechatar turn

(a) The Mode Button cycles between Drive, Battle and Mission modes

(b) The Mode LEDs display your current mode

(c) The Hint button provides clues for optimal Mechatar operation

(d) Weapon Buttons can be used in all three modes:

 Blast Button

 Rush Button

 Storm Button

(e) LEDs indicate power level of your attack and minigame status



Power switch turns Remote Control On and Off

QUICK START INSTRUCTION

Before you connect to the Mechaverse, you can explore your world in Drive mode.

To select Drive mode:

1. Turn the Mechatar and Remote Control on
2. Press the Mode button until you hear the Mechatar say "Drive mode"
3. You will see the Drive mode light turn on
4. You may drive your Mechatar using the GO and Turn buttons
5. Also use weapon buttons to flash the Mechatar's lasers and play weapon attack sounds

Important!

Try different combinations of weapon attacks to discover secret codes. Then watch your Mechatar perform their special move!

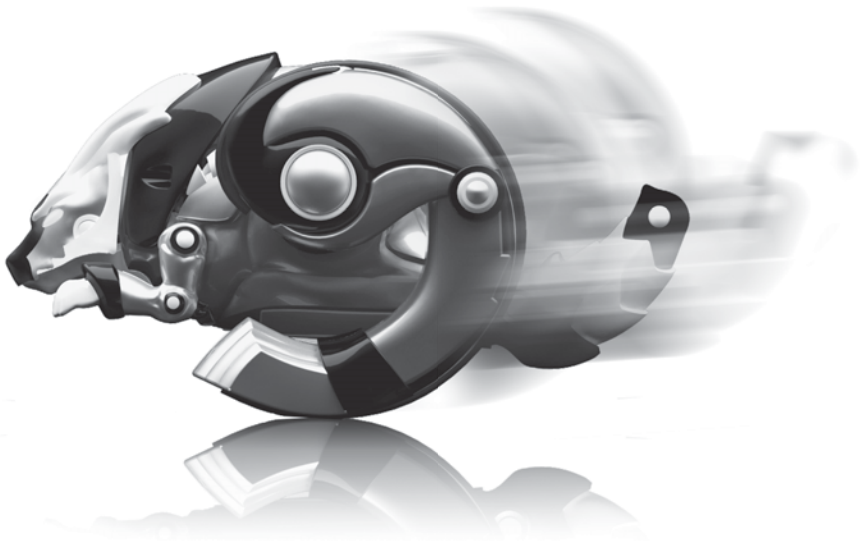

ELEMENTS

There are eight Elements that control the natural flow of life in the Mechaverse. Each weapon used in the Mechaverse is infused with an Elemental power source which gives the weapon unique advantages in battle.

When you battle with other Mechatars or the Swarm, the Elements become critical in determining how powerful a particular attack is. To learn more about the battle system, take the online tutorials and download the latest instruction manual at www.Mechatars.com.

The chart below illustrates how the Elements of the Mechaverse interact. For example, a weapon enhanced with the Cryon Element has a strong chance of overwhelming a Lumis weapon, while a Toxis weapon often will overwhelm a Cryon weapon.

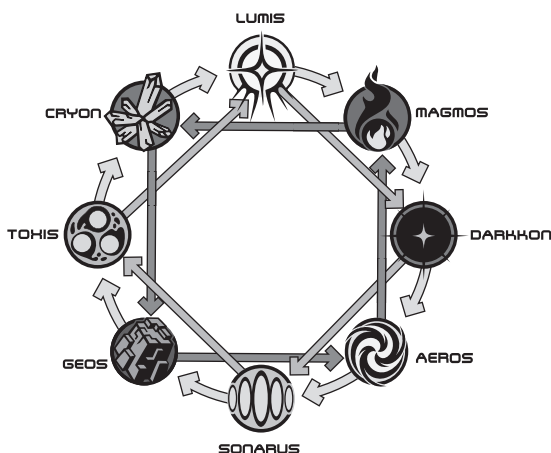

Each Mechatar also favors certain elements. The Mechatars and their favorite Elements are shown below.

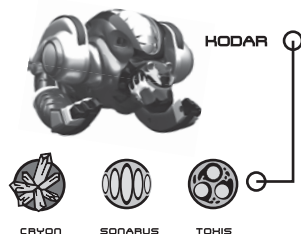
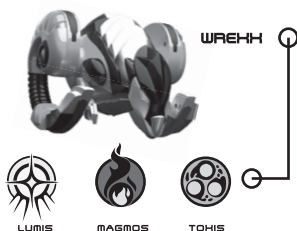

NOTES

This device complies with Part 15 of the FCC Rules. Operation is subject to the following two conditions: (1) This device may not cause harmful interference, and (2) The device must accept any interference received, including interference that may cause undesired operation.

Note

This equipment has been tested and found to comply with the limits for a class B digital device, pursuant to part 15 of the FCC rules. These limits are designed to provide reasonable protection against harmful interference in a residential installation. This equipment generates uses, and can radiate radio frequency energy and, if not installed and used in accordance with the instructions, may cause harmful interference to radio communications.

- However, there is no guarantee that interference will not occur in a particular installation. If this equipment does cause harmful interference to radio or television reception, which can be determined by turning the equipment off and on, the user is encouraged to try and correct interference by one or more of the following measures:
- Reorient or relocate the receiving antenna
- Increase the separation between the equipment and receiver
- Connect the equipment into an outlet on a circuit different from that to which the receiver is connected
- Consult the dealer or experienced radio/TV technician for help

WARNING: Changes or modifications to this unit not expressly approved by party responsible for compliance could void the user's authority to operate the equipment. To maintain the compliance with the FCC's RF exposure guideline, place the Internet radio unit (MECHATAR) at least 20cm from nearby persons.

WARNING! This equipment may experience difficulty and/or memory loss when subjected any electrostatic discharge, radio frequency interference, or sudden power surge/ interruption. The user is encouraged to reset the equipment should any of these occur.

Under the environment with electrostatic discharge, the sample may malfunction. It requires user to reset the sample by re-plugging the USB cable and then restarting the software again.

NOTES

BUILD YOUR SQUAD OF MECHATARS AND COLLECT ELITE POWER PACKS



ALPHA



WREHH



HODAR

POWER PACKS



HAMMER OF GLACIUS



LOST OBSIDIAN



ZEPHYRIN'S HOWLER



GROUNDBREAKER OF ET

STORM DRONES
COMING SOON



Power Packs and Mechatars sold separately

BOSSA NOVA ROBOTICS

DISTRIBUTED BY:
Bossa Nova Robotics, Inc.
2740 Smallman Street, Suite 400
Pittsburgh, PA 15222
www.iloverobots.com



Let's care for the environment:
The wheellie bin symbol indicates that the product must not be disposed of with other household waste. Please use designated collection points or recycling facilities when disposing of the product.



BOSSA NOVA ROBOTICS

PROJECT TITLE	PG# / BRAND	PROJECT MANAGER / EXT.
Mechatars Instructional manual		Tony Nesvacil/
FILE NAME	SPEC. / NI#	DIMENSIONS
BNR_Mechatar_InstructyManual.ai		6" W x X 8.25" H
STAGE	PRINT PROCESS / #COLORS	RELEASE DATE / VENDOR
<input checked="" type="radio"/> MECHANICAL <input type="radio"/> PREFLIGHT	TBD	05/04/2011

ROUND	1	2	3	4	5	6	7	8	9	10
DATE	04/28/11	05/02/11	05/03/11	05/04/11	02/16/11	00/00/00	00/00/00	00/00/00	00/00/00	00/00/00
ARTIST	TN	TN	TN	TN	TN	-	-	-	-	-
PROOF	-	-	-	-	-	-	-	-	-	-

COLORS
<div style="display: flex; flex-direction: column; align-items: flex-start;"> <div style="display: flex; justify-content: space-around; width: 100%;"> <div style="background-color: black; color: white; padding: 5px; border-radius: 5px;">PMS Black</div> <div style="background-color: #cccccc; padding: 5px; border-radius: 5px;">PMS XXXX</div> </div> <div style="display: flex; justify-content: space-around; width: 100%; margin-top: 10px;"> <div style="background-color: #0070c0; color: white; padding: 5px; border-radius: 5px;">PMS XXXX</div> <div style="background-color: #cccccc; padding: 5px; border-radius: 5px;">PMS XXXX</div> </div> </div>

NOTES:
Dielines do not print.

V6

