

brother®

MPRINT

Quick Reference Guide

MW-145BT
Mobile Printer

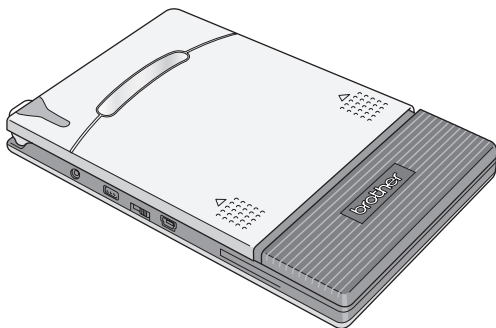

Before using this printer, be sure to read this Quick Reference Guide.

www.brother.com

Thank you for purchasing the Brother MW-145BT.

We provide service & support for users who register their products on our website. We recommend that you take this opportunity to register with us by visiting us at:

Online User Registration
<http://registermybrother.com/>

Online Support Page
<http://solutions.brother.com/>

NOTE: It is also possible to access the above sites from the online user registration window of the included CD-ROM. We look forward to your registration.

Federal Communications Commission (FCC) Declaration of Conformity (For USA Only)

Responsible Party : Brother International Corporation

100 Somerset Corporate Boulevard Bridgewater, NJ 08807-0911 USA

TEL : (908) 704-1700

declares that the product

Product Name : Brother MPrint MW-145BT

Model Number : MW-145BT

complies with Part 15 of the FCC Rules. Operation is subject to the following two conditions: (1) this device may not cause harmful interference, and (2) this device must accept any interference received, including interference that may cause undesired operation.

This equipment has been tested and found to comply with the limits for a Class B digital device, pursuant to Part 15 of the FCC Rules. These limits are designed to provide reasonable protection against harmful interference in a residential installation. This equipment generates, uses, and can radiate radio frequency energy and, if not installed and used in accordance with the instructions, may cause harmful interference to radio communications.

However, there is no guarantee that interference will not occur in a particular installation. If this equipment does cause harmful interference to radio or television reception, which can be determined by turning the equipment off and on, the user is encouraged to try to correct the interference by one or more of the following measures:

- Reorient or relocate the receiving antenna
- Increase the separation between the equipment and receiver.
- Connect the equipment into an outlet on a circuit different from that to which the receiver is connected.
- Consult the dealer or an experienced radio / TV technician for help.

Important

- The enclosed interface cable should be used in order to ensure compliance with the limits for a Class B digital device.
- Changes or modifications not expressly approved by Brother Industries, Ltd. could void the user's authority to operate the equipment.

Brother[®] One Year Limited Warranty (USA Only)

Who is covered:

- This limited warranty ("warranty") is given only to the original end-user/retail purchaser (referred to in this warranty as "Original Purchaser") of the accompanying Product, consumables and accessories (collectively referred to in this warranty as "this Product").
- If you purchased a Product from someone other than an authorized Brother reseller in the United States or if the Product was used prior to your purchase you are not the Original Purchaser and the Product that you purchased is not covered by this warranty.

What is covered:

- This Product includes the Product and may include Consumable and Accessory Items. Accessory Items may include, but are not limited to USB cable, AC adaptor and photo sleeves. Consumable Items may include but are not limited to BMS paper, battery, tape cassettes and label rolls.
- Except as otherwise provided herein, Brother warrants that the Product and the accompanying Consumable and Accessory Items will be free from defects in materials and workmanship, when used under normal conditions.
- This warranty applies only to Products purchased and used in the United States. For Products purchased in, but used outside the United States, this warranty covers only warranty service within the United States.

What is the length of the Warranty Periods:

- Product and Accompanying Accessory Items: one year from the original purchase date.
- Accompanying Consumable Items: 90 days from the original purchase date or the rated life of consumable, whichever comes first.

What is NOT covered:

This warranty does not cover:

- (1) Physical damage to this Product;
- (2) Damage caused by improper installation, improper or abnormal use, misuse, neglect or accident (including but not limited to shipping this Product without the proper preparation and/or packaging);
- (3) Damage caused by another device or software used with this Product (including but not limited to damage resulting from use of non Brother[®]-brand parts and Consumable and Accessory Items);
- (4) Consumable and Accessory Items that expired in accordance with a rated life;
- (5) Problems arising from other than defects in materials or workmanship.

This limited warranty is VOID if this Product has been altered or modified in any way (including but not limited to attempted warranty repair without authorization from Brother and/or alteration/removal of the serial number).

What to do if you think your Product is eligible for warranty service:

Report your issue to our Customer Service Hotline at 1-800-255-0415 or mobilesolutionsinfo@Brother.com **within the applicable warranty period.**

Supply Brother with a copy of your dated bill of sale showing that this Product was purchased within the United States.

What Brother will ask you to do:

After contacting Brother you will be required to send the Product properly packaged, freight prepaid, to Brother together with a photocopy of your bill of sale. Brother **will provide a Return Authorization Number (i.e RA#) that must be written on the outside of the carton that contains your Product and instructions to where you should return your Product. You are responsible for the cost of shipping, packing the Product, and insurance (if you desire). You are also responsible for loss or damage to this Product in shipping.**

What Brother will do:

If the problem reported concerning your Product and/or accompanying Consumable and Accessory Items is covered by this warranty and if you first reported the problem within the applicable warranty period, Brother will repair or replace the Product and/or accompanying Consumable and Accessory Items at no charge to you for parts or labor. The decision as to whether to repair or replace the Product and/or accompanying Consumable and Accessory Items is made by Brother in its sole discretion.

Brother reserves the right to supply a refurbished or remanufactured replacement Products and/or accompanying Consumable and Accessory Items and use refurbished parts provided such replacement Products conform to the manufacturer's specifications for new Product/parts. The repaired or replacement Product and/or accompanying Consumable and Accessory Items will be returned to you freight prepaid.

If the Product and/or accompanying Consumable and Accessory Items are not covered by this warranty (either stage), you will be charged for shipping the Product and/or accompanying Consumable and Accessory Items back to you and charged for any service and/or replacement parts/Product at Brother's then current rates.

Identification: Brother shall be allowed to place identification marks on equipment covered and repaired under this agreement.

Limitations:

Brother is not responsible for damage to or loss of any equipment, media, programs or data related to the use of this Product. Except for the repair or replacement as described above, Brother shall not be liable for any direct, indirect, incidental or consequential damages or specific relief. Because some states do not allow the exclusion or limitation of consequential or incidental damages, the above limitation may not apply to you.

THIS WARRANTY IS GIVEN IN LIEU OF ALL OTHER WARRANTIES, WRITTEN OR ORAL, WHETHER EXPRESSED BY AFFIRMATION, PROMISE, DESCRIPTION, DRAWING, MODEL OR SAMPLE. ANY AND ALL WARRANTIES OTHER

THAN THIS ONE, WHETHER EXPRESS OR IMPLIED, INCLUDING IMPLIED WARRANTIES OF MERCHANTABILITY AND FITNESS FOR A PARTICULAR PURPOSE, ARE HEREBY DISCLAIMED.

- This Limited Warranty is the only warranty that Brother is giving for this Product. It is the *final expression and the exclusive and only statement* of Brother's obligations to you. It replaces all other agreements and understandings that you may have with Brother or its representatives.
- This warranty gives you certain rights and you may also have other rights that may vary from state to state.
- This Limited Warranty (and Brother's obligation to you) may not be changed in any way unless you and Brother sign the same piece of paper in which we (1) refer to this Product and your bill of sale date, (2) describe the change to this warranty and (3) agree to make that change.

Important: We recommend that you keep all original packing materials, in the event that you ship this Product

Important Information

Should you have questions, or need information about your Brother Product, we have a variety of support options for you to choose from:

USA-Customer Service:
Customer Service
1-800-255-0415

Customer Service
1-303-460-1628 (fax)

Website
www.brothermobilesolutions.com

Supplies / Accessories
1-800-543-6144

Brother Mobile Solutions, Incorporated
100 Technology Drive, Suite 250A
Broomfield, CO 80021

Record your model and serial number and your date and location of Purchase below for your records. Keep this information with your proof of purchase (bill of sale) in case your Product requires service.

Model # _____

Serial # _____

Date of purchase: _____

Reseller name: _____

Reseller address: _____

Important: We recommend that you keep all original packing materials, in the event that you need to ship the machine.

Save Time - Register On-Line!

Don't stand in line at the post office or worry about lost mail. Visit us on-line at

www.registermybrother.com

Your product will immediately be registered in our database and you can be on your way!

Also, while you're there, look for contests and other exciting information!

CAUTION

RISK OF EXPLOSION IF BATTERY IS REPLACED BY AN
INCORRECT TYPE.
DISPOSE OF USED BATTERIES ACCORDING TO THE
INSTRUCTIONS.

Trademarks

The Brother logo is a registered trademark of Brother Industries, Ltd.

Brother is a registered trademark of Brother Industries, Ltd.

© 2009 Brother Industries, Ltd.

Microsoft, Windows, Windows Mobile and Windows Vista are registered trademarks of Microsoft Corporation in the United States and other countries.

The Bluetooth word mark and logos are owned by the Bluetooth SIG, Inc. and any use of such marks by Brother Industries, Ltd. under license.

All other software and product names mentioned are trademarks or registered trademarks of their respective companies.

For the latest information and updates on the Brother mobile printer feature, visit <http://solutions.brother.com>.

Manual structure

A User's Guide and a Software User's Guide are provided on the CD-ROM included with this printer. Read the User's Guide before operating the printer. It is recommended you save the User's Guide onto your Windows® PC for future reference.

User's Guide

The User's Guide provides precautions for using this printer, details on the printer's setup, the procedures for installing and uninstalling the software onto a Windows® PC or onto a Windows Mobile® device.

Software User's Guide

The Software User's Guide describes how to use the software for Windows® PC or Windows Mobile® device and their printing procedures.

Enclosed accessories

MW-145BT mobile printer

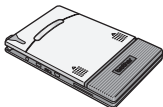

USB cable

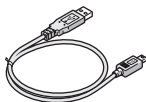

Paper cassette

filled with C-11 thermal paper (50 sheets).



AC adapter

(AD-210US)
Brother Industries, Ltd.

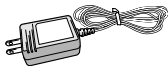

CD-ROM

(contains the software, the User's Guide and the Software User's Guide)



Quick Reference Guide (This guide)



Lithium ion Rechargeable battery pack

(BT-100)
Brother Industries, Ltd.



Getting Started

Installing the battery

! Danger



Do not use this printer with any rechargeable battery other than that specified (BT-100), otherwise a fire or damage may result.



- DO NOT take off the black plastic that covers the battery.
- The battery connector should not be frequently unplugged and reconnected, otherwise it may become damaged or the battery cord may break.
The battery should only be removed when replacing it at the end of its service life, or when the printer will not be used for a long period of time.

1 Press the area indicated ① on the battery cover ② and slide it off the MW-145BT.

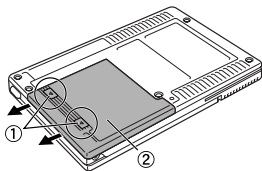

2 Insert the connector ① of the battery ② in the direction shown right.

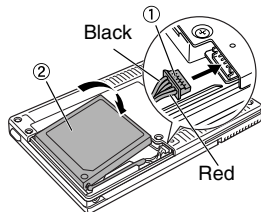

- Insert the connector fully, without using excessive force.
- Be sure you insert the connector in the correct orientation, otherwise it may be damaged.

- 3** Fit the battery cord into the groove as shown in the illustration.

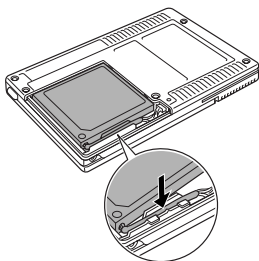

- 4** Install the battery cover by sliding it onto the back of the MW-145BT.

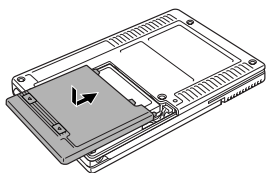

Be careful that you do not catch the battery connector cord.

Charging

Use the AC adapter designed specifically for this printer to charge the battery.

After purchasing this printer, be sure to charge the battery fully before using it.

1 Plug the AC adapter cable into the printer.

2 Plug the AC adapter plug into a household electrical outlet (AC 110 V - 120 V).

Charging of the lithium ion battery automatically begins.

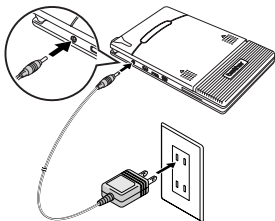

- The orange charging LED is lit.
- When charging is finished, the charging LED goes off.



- It takes approximately three hours for the battery to be recharged from completely empty to fully charged (with the printer turned off).
- Recharge the battery in an environment with a temperature between 5 °C and 40 °C/41 °F and 104 °F. (The battery will not recharge if the ambient temperature is outside of this range.)

3 After charging is finished, disconnect the AC adapter.



The MW-145BT cannot be operated solely with the AC adapter. The rechargeable battery must be installed.

■ Charging LED (Orange)

With the charging LED, the status of the power supply can be checked.

The charging LED has two functions.



(1) Checking the charging status (when the AC adapter is connected)

LED status	Printer status
Constantly lit	Charging
Off	Finished charging
Flashing	Malfunctioning battery

(2) Checking the battery level (while running off the lithium ion battery)

LED status	Battery level
Off	More than 60% charged
Flashes once	Less than 60% charged
Flashes twice	Less than 30% charged
Continues to flash 3 times	Almost empty



- Please try to discharge the battery completely before recharging it, to increase battery lifetime.
- If the charging LED flashes while the printer is printing, immediately connect the AC adapter and charge the battery. The printer may stop printing.
- Due to the characteristics of batteries, even though the battery is fully charged, using them in locations at low temperatures greatly reduces the number of prints possible.
- In order to maintain the efficiency and life of the rechargeable battery, remove the AC adapter from the printer when charging is completed.
- In order to maintain the efficiency and life of the rechargeable battery, do not place or use the printer in direct sunlight, near heaters or other hot appliances, in any location exposed to extremely high temperatures (e.g. on the dashboard or in the back of your car).

Turning on/off the printer

Press and hold the power button for a short while, until the green or blue status LED illuminates.

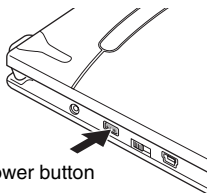

- When the printer is turned on, the status LED is:
Green (if Bluetooth is switched off)
Blue (if Bluetooth is switched on)



In order to prevent this printer from accidentally being turned on, it will not come on if the power button is lightly pressed.

Preparing the paper cassette

Use only the paper cassette designed exclusively for this printer. Use of any other paper will result in damage.

Prepare the paper cassette before installing it into the printer.

- 1** **Firmly** fold the lid back along the fold (①).

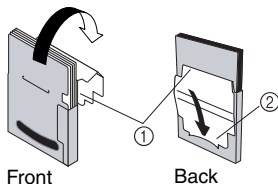

Make sure that the lid is firmly folded, otherwise a paper misfeed may result.

- 2** Insert the tab on the lid into the slit (②) at the back of the cassette.

Installing the paper cassette

- 1** Slide the paper cassette cover (on the top of the printer) in the direction shown in ①.

→ The paper cassette cover will open in the direction indicated by ②.

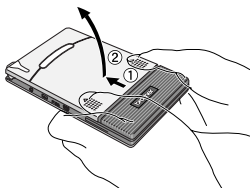

- 2** Insert the paper cassette.

The paper type indication on the paper cassette should face up. The end of the paper should point toward you.

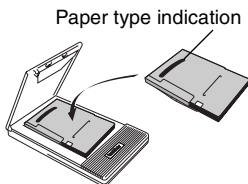

- 3** Close the paper cassette cover in the direction shown in ③.

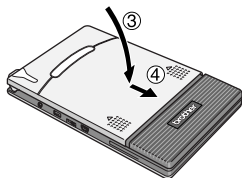

- 4** Slide the paper cassette cover in the direction shown in ④.

If the paper cassette is correctly loaded, the paper type indication on the cassette can be seen through the paper check window, and the paper cassette cover will be locked.

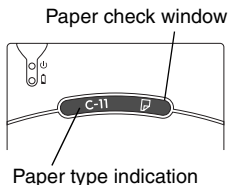

■ If the paper is not fed correctly

Clean the pick-up roller.

- 1** Open the paper cassette cover.
- 2** Rotate the pick-up roller in the feed direction until it stops.

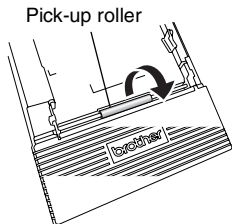

- 3** Attach a piece of cellophane tape to the rubber pick-up roller.

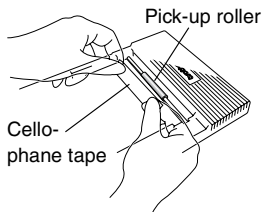

- 4** Remove the cellophane tape, and turn the pick-up roller 3 to 4 mm/0.1" to 0.2" in the opposite direction of the feed direction.

→ Any dirt on the pick-up roller is removed with the tape.

- 5** Repeat steps 3 and 4 until the pick-up roller is clean.

brother®

Printed in Japan
LBA242001

