



# Rider 15

Quick Start Guide

Download  
Bryton Mobile App



[www.brytonsport.com](http://www.brytonsport.com)

Bryton



## Key Functions

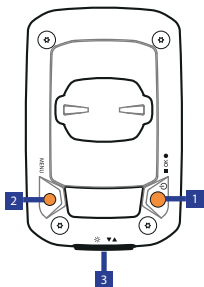

### 1 Power/OK (⏻/■OK●)

- Press to turn the device on.
- Press and hold to turn the device off.
- In free cycling, press to start recording.
- When recording, press to stop recording.
- In Menu, press to confirm a selection.

### 2 MENU(MENU)

- Press to enter/exit menu mode.
- Press to be back to main menu.
- Long press to clear notification icons.

### 3 Backlight/Page (☀/▼▲)

- Long press to turn on/off backlight
- In Menu, press to move down to scroll through menu options.
- In Meter mode, press to switch meter screen page.

## Getting Started

Please charge your device for at least 4 hours before the first use.

To begin **1**. Press to turn on the device. **2**. Press to select the unit and press to confirm the selection. **3**. Device will automatically search for satellite signals. **4**. After GPS signal is fixed ( → ) just ride on and enjoy your workout in free cycling mode. To record, press to start recording.

\*To get GPS acquisition, please take the device to an open sky outdoor environment.

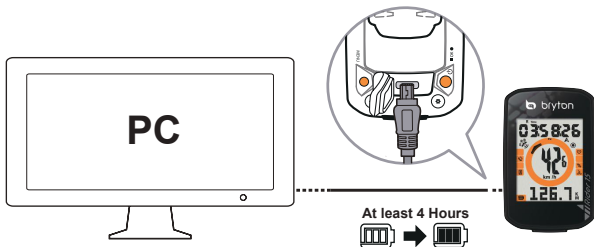











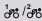





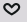

## Sync Data to / from Bryton App

It is required to pair your device with Bryton App before syncing data for the first time.

1. Turn on your device.
2. After Bryton App is installed, please sign up a new account or sign in with your Bryton account.
3. Tap "BT Sync", and select the device you would like to pair, and tap "+".
4. Tap "Yes" after checking if UUID shown on app is the same as your device's.
5. Your device is successfully paired with Bryton App.
6. It would start uploading tracks from paired device.

After pairing with Bryton app and simple setup, you can receive phone call, text and email notifications, customize data grid, calibrate altitude and manage other settings.

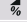
## Icon Description

	Bike 1/ Bike 2		Text Notification	<b>R</b>	Ride Time		Maximum
	No GPS Signal (Not fixed)	<b>DST</b>	Daylight Saving Time	<b>T</b>	Trip Time		Average
	Weak GPS Signal		Backlight		Cadence Value		Heart Rate Sensor
	Strong GPS Signal	<b>PM</b>	Afternoon		Heart Rate Value		Speed Sensor
	Power Status		12hr or 24 hr	<b>Odo</b>	Odometer		Cadence Sensor
	Call Notification		Gradient	<b>D</b>	Distance		Bluetooth Active
	Email Notification	<b>ALT ▲</b> <b>ALT ▼</b>	Altitude Gain Altitude Loss	<b>D1</b> <b>D2</b>	Distance 1 Distance 2	<b>REC</b>	Recording

## Reboot Device

Press(  / **MENU** ) at the same time to reboot the device.

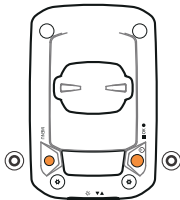

### Note:

For firmware update, please go to [www.brytonsport.com](http://www.brytonsport.com)>  (Menu) > Support > Download.

For video instructions, please go to [www.brytonsport.com](http://www.brytonsport.com)>  (Menu) > Support > Tutorial.

For User Manual, Please go to [www.brytonsport.com](http://www.brytonsport.com)>  (Menu) > Support > Download > Manual > User Manuals.

# Specifications

## Rider 15

Item	Description
Display	2" Segment Type HTN LCD
Physical Size	71 x 46.2 x 16.5 mm
Weight	52g
Operating Temperature	-10°C ~ 50°C
Battery Charging Temperature	0°C ~ 40°C
Battery	Li polymer rechargeable battery
Battery Life	16 hours with open sky
GPS	Integrated high-sensitivity GPS receiver with embedded antenna
BLE Smart	Bluetooth smart wireless technology with embedded antenna
Water Resistant	Water resistant to a depth of 1 meter for up to 30 minutes.
Barometer	Equipped with barometer

# Install Rider 15

## Use Bike Mount to Mount Rider

1

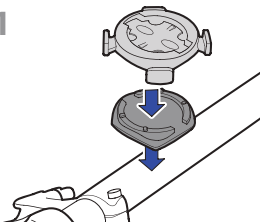

2

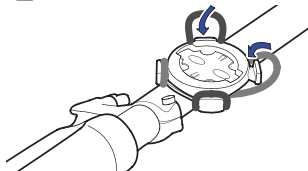

3

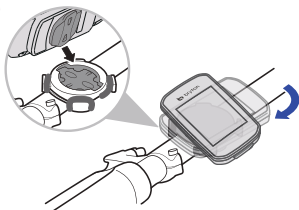

4

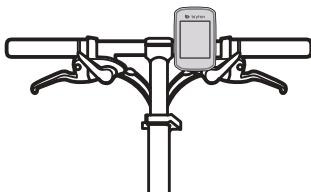

### ***Federal Communication Commission Interference Statement***

This equipment has been tested and found to comply with the limits for a Class B digital device, pursuant to Part 15 of the FCC Rules. These limits are designed to provide reasonable protection against harmful interference in a residential installation.

This equipment generates, uses and can radiate radio frequency energy and, if not installed and used in accordance with the instructions, may cause harmful interference to radio communications. However, there is no guarantee that interference will not occur in a particular installation. If this equipment does cause harmful interference to radio or television reception, which can be determined by turning the equipment off and on, the user is encouraged to try to correct the interference by one of the following measures:

- . Reorient or relocate the receiving antenna.
- . Increase the separation between the equipment and receiver.
- . Connect the equipment into an outlet on a circuit different from that to which the receiver is connected.
- . Consult the dealer or an experienced radio/TV technician for help.

***FCC Caution:*** To assure continued compliance, any changes or modifications not expressly approved by the party responsible for compliance could void the user's authority to operate this equipment. (Example - use only shielded interface cables when connecting to computer or peripheral devices).

### ***FCC Radiation Exposure Statement***

This equipment complies with FCC RF radiation exposure limits set forth for an uncontrolled environment. This equipment should be installed and operated with a minimum distance of 20 centimeters between the radiator and your body.

This transmitter must not be co-located or operating in conjunction with any other antenna or transmitter.

The antennas used for this transmitter must be installed to provide a separation distance of at least 20 cm from all persons and must not be co-located or operating in conjunction with any other antenna or transmitter.

This device complies with Part 15 of the FCC Rules. Operation is subject to the following two conditions:

- (1) This device may not cause harmful interference, and
- (2) This device must accept any interference received, including interference that may cause undesired operation.

***Industry Canada Statement***

This device complies with Industry Canada RSS-247 standard. Operation is subject to the following two conditions: (1) this device may not cause interference, and (2) this device must accept any interference, including interference that may cause undesired operation of the device.

Le présent appareil est conforme aux CNR d'Industrie Canada applicables aux appareils radio exempts de licence. L'exploitation est autorisée aux deux conditions suivantes : (1) l'appareil ne doit pas produire de brouillage, et (2) l'utilisateur de l'appareil doit accepter tout brouillage radioélectrique subi, même si le brouillage est susceptible d'en compromettre le fonctionnement.

***IC Radiation Exposure Statement:***

This equipment complies with IC RSS-102 radiation exposure limit set forth for an uncontrolled environment. This equipment should be installed and operated with minimum distance 0.5 cm between the radiator and your body.

Cet équipement est conforme aux CNR-102 d'Industrie Canada. Cet équipement doit être installé et utilisé avec une distance minimale de 0.5 centimètres entre le radiateur et votre corps. Cet émetteur ne doit pas être co-localisées ou opérant en conjonction avec autre antenne ou émetteur. Les antennes utilisées pour cet émetteur doivent être installés et fournir une distance de séparation d'au moins 0.5 centimètre de toute personne et doit pas être co-située ni fonctionner en conjonction avec une autre antenne ou émetteur.