

210mm

KidLane

# Stage Mic Sing-Off

Bluetooth Karaoke with Dual Microphones

For Ages  
4+

## SAFETY WARNINGS

- Before use, read all safety warnings.
- Only use this product for the purpose described in this manual.
- Always inspect the product for damage. Discontinue use if the product is damaged in any way.
- Do not use the product if you are unable to use serviceable components.
- **WARNING:** Strangulation Hazard - long cord
- Not suitable for children under 3 years due to small parts - choking hazard.
- Remove all packaging before giving to child.
- Please keep packaging for future reference.
- Do not use old and new batteries.
- Do not mix alkaline, standard (carbon-zinc), or rechargeable batteries.
- Alkaline batteries are recommended. Use only the specified voltage.
- Insert batteries using the correct polarity. Always use, replace and recharge (if applicable) batteries under adult supervision.
- Do not charge with non-rechargeable batteries.
- Do not use the product if the batteries are damaged.
- Do not dispose of batteries in a fire, batteries may explode or leak.
- Recycle or dispose of batteries according to federal, state, and local laws.

## CONTENTS

1. Wired Mics
2. Adjustable Mic Holders
3. Device Holder
4. Connector
5. Stage Mic Sing-Off
6. Adjustable Stand
7. Base Center
8. Base Legs

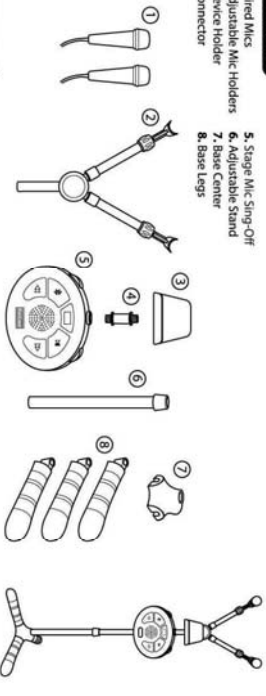

## ASSEMBLY

1. Press the 3 Base Legs onto the Base Center from underneath.
2. Press the Adjustable Stand down into the center hole of the Base Center.
3. Secure the Adjustable Stand to the post on the underside of the Stage Mic Sing-Off by rotating counter-clockwise. Adjust the height and then tighten the ring on the Adjustable Stand by rotating clockwise.

4. Remove the back Battery Cover using a Sing-Off by rotating clockwise.
5. Slide the ring on the back of the Device over the Adjustable Mic Holders to the Connector by rotating clockwise.
6. Press the Mic onto the Adjustable Mic Holder. The mic disappears from the back side of the Stage Mic Sing-Off.

## BATTERY INSTALLATION

Remove the back Battery Cover using a Sing-Off by rotating clockwise. Insert 4 AA size batteries (not included) in the polarity direction shown to the right. Screw the battery cover back on.

**NOTE:** Can be powered via standard Micro USB Adapter (Not included).

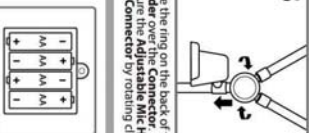

## FEATURES

- BLUETOOTH MODE**
- Keep pressing the Play Mode Button until the LCD screen displays "BT".
  - Select "Scan for device" on your Bluetooth enabled device. It will show up as "K020514" on your device.
  - Press Play/Pause for music. Song when pairing is complete.
  - Press Previous and Next buttons to switch songs.
- NOTE:** If you want to pair the Stage Mic Sing-Off to any device, turn on the Bluetooth function on the current connected device. The Stage Mic Sing-Off will show up as "K020514" on the device.
- LINE IN MODE**
- Use the included AUX cable to plug in an external device.
  - Press Play/Pause for music. The LCD screen displays "Line".
- NOTE:** The Stage Mic Sing-Off is unable to control music play in this mode. All songs need to be selected using the connected device.
- USB MODE**
- Insert a USB that Drive into the port on the back side.
  - Press Play/Pause for music. The LCD screen displays "USB".
  - Press Play/Pause for music. The LCD screen displays "USB".
  - Press Play/Pause for music. The LCD screen displays "USB".
- PLAY MODE RECALL FULL FUNCTION**
- When powered on, the Stage Mic Sing-Off will revert to the previously selected mode.
  - If no external devices are connected, the Stage Mic Sing-Off will revert to Bluetooth mode.
- TURNING THE MIC ON AND OFF**
- Press the MIC-ON/OFF and MIC-L-ON/OFF buttons to turn the mic on and off.
  - Make sure you check the ports on the back side to see which mic you are using.
- USING RECORD AND PAUSE**
- Press the Record Button. After the sound plays, record up to 8 minutes from one or both mics.
  - Press the Pause Button to play it back. Each time you create a new recording, it overwrites the previous recording.
- ADJUSTING THE VOLUME**
- Press the Plus and Minus buttons to adjust the master volume. (15 is the default volume.)
  - Use the Mic Vol dial on the back to adjust the mic input level.
- AUDIENCE SOUND EFFECTS**
- Press the Applause Button or Boo Sound Button on top for added fun.

## FCC STATEMENT

This equipment complies with Part 15 of the FCC Rules. Operation is subject to the following two conditions:

- (1) This device may not cause harmful interference, and
- (2) This device must accept any interference received, including interference that may cause undesired operation.

This equipment has been tested and found to comply with the limits for a Class B digital device pursuant to part 15 of the FCC rules. These limits are designed to provide protection against harmful interference in a residential environment. This equipment does not emit radio frequency interference to radio communication devices. However, there is no guarantee that interference will not occur in a particular installation. If this equipment does cause harmful interference to radio or television reception, which can be determined by turning the equipment off and on, the user is advised to try one of the following measures:

- Reorient or relocate the receiving antenna.
- Increase the distance between the equipment and the receiver.
- Connect the equipment to an outlet on a circuit different from that to which the receiver is connected.
- Consult the dealer or an experienced radio/TV technician for help.

**FCC Radiation Exposure Statement:** This equipment complies with FCC radiation exposure limits set forth for an uncontrolled environment. In order to avoid the possibility of exceeding the FCC radio frequency exposure limits, the maximum proximity to the antenna shall not be less than 20cm in any direction during normal operation.

Model: K020514  
 Manufacturer: KidLane Inc.  
 Model: K020514  
 Manufacturer: KidLane Inc.



**WARNING:**  
 CHOKING HAZARD - Small parts.  
 Not suitable for children under 3 years.

297mm