

Bushnell®

neo

PHANTOM

GPS RANGEFINDER



F.P.O.
Image-replace

User Manual

Care and Maintenance

To help ensure reliable operation, the following care and maintenance guidelines are recommended :

- Avoid exposing the unit to extreme environmental conditions for a prolonged period of time. The unit is IPX4 rated and resistant against water splashes from any direction, but is not fully waterproof and should not be submerged in water at any depth, or exposed to heavy rain or other strong streams of water.
- Avoid severe impacts on the unit.
- You may clean the unit occasionally with a soft, damp cloth.
- DO NOT expose the unit to strong chemicals such as gasoline and alcohol, as they will damage the unit.
- Store the unit in a dry place when it is not in use.

WARNING

Do not attempt to open the NEO Phantom.

Risk of explosion if battery is replaced with incorrect type.

- Do not attempt to open, disassemble or service the internal battery. The battery must be replaced by a qualified technician.
- Do not crush, puncture or short the battery's external contacts. Do not expose to temperatures above 140° F (60° C).
- Properly recycle or dispose of the battery. Do not dispose in fire or water.

Legal Disclaimer

By using this product, you agree that Bushnell Outdoor Products will not be held legally responsible for any injury or damage to you or any person or property caused by the user's improper operation and/or poor judgment while using this product.

Note: See Limited Warranty for other limitations to our liability.

Additional Information

The Global Positioning System (GPS), a network of 32 satellites orbiting Earth, is operated and maintained by the U.S. government. This GPS device requires at least 3 satellites to be acquired to accurately determine your position. Any change made to the system by the government could affect the accuracy and performance of this product.

Bushnell Golf GPS Website

www.bushnellgolf.com is the best online resource for all our Golf GPS product owners, including product support, FAQs, etc. It also serves as a portal to access iGolf.com GPS course files to use with these Bushnell products. Registering your NEO Phantom via **www.bushnell.igolf.com** is not required, but will ensure you have access to the latest updated GPS course data.

Table of Contents

Contents	Page #
Charging the Battery	4
Package Contents / Computer Requirements / Updates	4
Buttons and Functions	5
Getting Started	6
Using the Play Golf Mode	6
Button Functions in Play Golf Mode	7
Using the Play Golf Menu / Play Menu Items	8
Using the Settings Mode	9
Settings Menu Items	9-11
Accessing Updated Golf Course Data	12
How to Find the Product ID / Serial Number	13
Warranty Information	14



Charging the Battery

The rechargeable battery of the NEO Phantom is long lasting and provides up to 16 hrs (3 rounds of golf typically) on a charge. However, battery life may be reduced due to a variety of factors (external temperature, etc). All rechargeable batteries lose their effective charge length over time. **At the end of your round, be sure to completely power off your NEO Phantom by pressing and holding the PWR button until the display goes off.**

To check your remaining battery life, select "Battery" from the **PLAY GOLF** menu (pg. 8), or from the **SETTINGS** menu (pg. 9). To recharge the battery, attach the smaller plug on the included USB cable to the port at the bottom side of the unit and connect the large (standard) USB plug to your computer. The NEO Phantom and USB cable are compatible with all USB ports, including iPhone/other smartphone USB chargers. Once connected, press the PWR button-the display will read "**CHARGING**". When the Phantom is fully charged (*about 4 hrs from totally discharged state, less if partial charge remains*) and ready to use, "**CHARGING COMPLETED**" will be displayed (*press PWR to check charge status if not displayed*).

Package Contents

- 1 - Bushnell NEO Phantom GPS Rangefinder
- 1 - USB/Charging Cable
- 1 - Quick Start Guide

Computer Requirements

USB Port that supplies 5V DC for charging
OS: Windows (XP/Vista/Windows 7 or higher), Mac (OS X 10.4 or higher)
Maximum charging current: 5V DC \leq 150mA
Maximum battery charging temperature: 45°C

Firmware/Software Updates

Please check www.bushnellgolf.com periodically for the latest firmware and software releases.

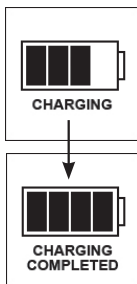

Buttons and Functions



1. **SHOT DISTANCE Button:** Press at starting point, walk to ball position to find length of shot.
2. **MENU Button:** View Menu options/items.
3. **UP ▲ Button:** Scrolls up through Menu.
4. **SELECT ► Button:** Selects highlighted Menu item.
5. **DOWN ▼ Button:** Scrolls down through Menu.
6. **PWR Button:** Press & hold (1.5 sec.) to power on/off.
7. **USB Port:** Connect to PC or smartphone charger with supplied cable to charge.

F.P.O.
Image-replace

Rear View

Product ID (serial #)



**Note: Backlight is activated with any button push. The backlight will remain lit for 10 seconds after last button push. Backlight is disabled in Play Golf Mode.*

GETTING STARTED

1. First, be sure the battery has a full charge. If you are using it for the first time, it should be charged until full (see pg. 4). Next, make sure you are outdoors, in a location with a clear view of the sky overhead, to ensure good reception of GPS satellite signals. Now, you're ready to power up and use your NEO Phantom.
2. Press and hold the PWR button on the top side of the unit until it powers on (start screen as shown on right). Press and hold again to turn off the power.
3. To turn on the backlight after the unit is powered on, briefly press and release the PWR button.
4. The display will show the Main Menu (from the time & date display screen, press the MENU button on the right side), with a choice of two operating modes: **PLAY GOLF** or **SETTINGS**.



USING THE PLAY GOLF MODE

1. Highlight **PLAY GOLF** and press the SELECT button. Display will show "**SEARCHING**", then **SELECT COURSE**.
2. Use the UP/DOWN buttons to select (highlight) your course from list of nearby courses (closest distance at top), then press SELECT.
3. The display will show "**LOADING**", then: Current hole # (at upper left), Par for the hole (upper right), and distances to the center (large number at center screen), front (lower left) and back (lower right) of green. (see next page)

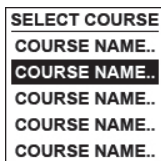

Displayed Info in Play Golf Mode

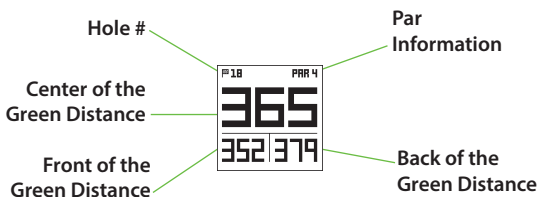

Button Functions in Play Golf Mode



BUTTON FUNCTIONS IN PLAY GOLF MODE

- Press UP or DOWN buttons to manually advance to the next hole (useful for "shotgun" starts), or go back to the previous hole.
- Press the SHOT button at the tee ("point A")-display will update to indicate distance from point A to your current location ("point B") as you walk. Useful to measure the length of your shot. Press SHOT again to return to zero and set a new starting point.
- Press the SELECT button to display distances to bunkers, hazards, etc. for the hole from your current location. Press SELECT again to return to the regular PLAY GOLF display.

P 18	PAR 4
365	
SHOT	

P 18	PAR 4
RFB	— 379
EDF	— 379
CRK	— 379
CRKC	— 379

USING THE PLAY MENU IN PLAY GOLF MODE

1. In **PLAY GOLF** Mode, press the MENU button to view the **PLAY MENU**.
2. Select item from menu using UP/DOWN buttons to highlight it, then press SELECT button.
3. If multiple options are available for a setting, use UP/DOWN to highlight your choice, then press select.
4. A dot in a checkbox to the left of a setting indicates the current setting (to change it, highlight a different setting and press SELECT).
5. Press MENU button to return to previous menu screen.



PLAY GOLF MENU ITEMS

- **BATTERY***: press SELECT button to see battery condition (charge %). (**also provided in the **SETTINGS** Menu*)

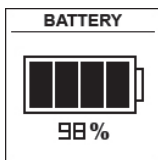

- **YARD/METER***: press SELECT. Dot in checkbox indicates current setting (default=**YARDS**). To change how distances are displayed, highlight **YARDS** or **METERS**, press select. (**also provided in the **SETTINGS** Menu*)

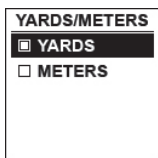

- **RESUME PLAY**: from any screen, returns display to showing current hole and distances based on current location.
- **NEW COURSE**: select another golf course from list.
- **EXIT ROUND**: stops tracking course, ends current game.

USING THE SETTINGS MODE

1. Highlight **SETTINGS** (if you are in **PLAY GOLF** mode, press **MENU** and select **EXIT ROUND** to go to the main menu) and press **SELECT**.
2. Select item from menu using **UP/DOWN** buttons to highlight it, then press **SELECT** button.
3. If multiple options are available for a setting, use **UP/DOWN** to highlight your choice, then press select.
4. A dot in a checkbox to the left of a setting indicates the current setting (to change it, highlight a different setting and press **SELECT**).
5. Press **MENU** button to return to previous menu screen.

SETTINGS
BATTERY
YARDS/METERS
AUTO OFF
TIME/DATE
CONTRAST

SETTINGS MENU ITEMS

- **BATTERY***: press **SELECT** button to see battery condition (charge %). (*also provided in the **PLAY GOLF Menu**)
- **YARD/METER***: press **SELECT**. Dot in checkbox indicates current setting (default=**YARDS**). To change how distances are displayed, highlight **YARDS** or **METERS**, press select. (*also provided in the **PLAY GOLF Menu**)
- **AUTOOFF**: press **SELECT**. Dot in checkbox indicates current setting (default=**OFF**).
ON=unit will automatically power off after 30 minutes if no buttons have been pressed (or if unit has not auto advanced to next hole as you walk the course).
OFF=unit will stay powered on until user manually powers off by holding **PWR** button. To change setting, highlight **ON** or **OFF**, press **SELECT**.

AUTO OFF
<input checked="" type="checkbox"/> ON
<input type="checkbox"/> OFF

NOTE: selecting "ON" can help avoid running down the battery charge if you forget to power off after a round-but there is the possibility of losing GPS satellite contact, along with all data generated since your start of play. "OFF" is the normally recommended setting. Use "ON" with caution.

- **TIME/DATE** > press SELECT then highlight and select one of these four time/date related settings:

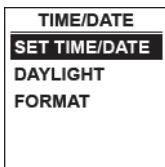

1) **TIME ZONE:** scroll through list and highlight your time zone (list continues if DOWN button is pressed at bottom of screen), press SELECT.

2) **SET TIME/DATE:** press SELECT and highlight a method:

- **BY GPS:** press SELECT to automatically set the time based on your current GPS location.

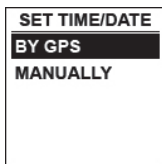

- **MANUALLY:** use the UP/DOWN buttons to enter the correct current time and date yourself.

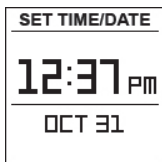

3) DAYLIGHT SAVI: press SELECT and highlight current daylight savings time status for your location:

- **DST ON +1**
- **DST OFF -1**

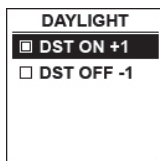

4) FORMAT: press SELECT and highlight preference for time display:

- **12 HOUR**
- **24 HOUR**

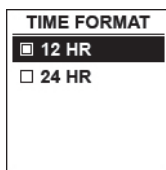

- **CONTRAST:** press SELECT then use UP/DOWN to select the display contrast level for best viewing quality, from 1 (lowest) to 10 (highest). Lower contrast can improve screen viewing in bright sun, as can higher contrast settings on cloudy days.



- **ABOUT:** press SELECT to display your unit's firmware version.



Accessing Updated Golf Course Data

Your NEO Phantom is pre-loaded with data for over 33,000 courses located worldwide. It is ready to use right out of the box, with no need to download software or pay any membership fees.

But you might be thinking, "What if a new course opens sometime after my unit was made? Is there a way to update the database in my unit to add it?" The answer is yes, and it's simple to do.

Go to **www.bushnellgolf.com** and view the product page for any of the different color versions of the NEO Phantom. You'll find three orange links you can click:

- **How to Update Your Golf GPS with the Latest Maps**
Click this link for step-by-step directions for finding and downloading new course data from iGolf.com
- **Request Course Update**
Click this link to go to a form you can fill out and email to iGolf to submit a course that is not included in the database, or if you find information (data for a hole) that is not mapped correctly on an existing course.
- **Search for Available Courses on Your Bushnell Golf GPS**
Click this link to search the current iGolf database to verify a course you are interested in is included.

You can also go to: **<https://igolf.com>** and click "Join Now", fill in your contact info on the registration form then select "I Have A GPS Device" to access course updates.

Use the provided USB cable to connect your NEO Phantom to your PC or Mac. Once connected, the screen will display **"USB MODE"**.

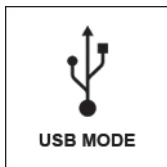

BLUETOOTH SETTINGS

The NEO Phantom can connect to the smartphone app via Bluetooth. Once connected the NEO Phantom can receive text, email, phone, calendar, and Tee Time alerts. Further the smartphone app can configure the NEO Phantom, display Fitness data and Swing Pro data.

The smartphone app can be obtained from the Apple Store and Google Play store for iPhone and Android devices, respectively. Download and install the app on the mobile device. Go to the mobile devices’ settings page to turn on Bluetooth, then launch the app.

To connect your NEO Phantom to the smartphone app follow the steps below:

- 1. On your smartphone, make sure you have Bluetooth turned on.
- 2. On your NEO Phantom, go to the “Main Menu” and then select “Bluetooth” *(right)*.
- 3. Select “YES” to turn Bluetooth on.
- 4. Your NEO Phantom will then give you a code. Enter that code into the smartphone app when requested.
- 5. Once paired correctly, your smartphone app will display a confirmation. The device is now paired with your smartphone.

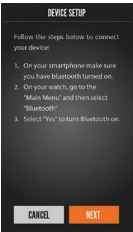

F.P.O.

MAGNETIC BITE FEATURE

The NEO Phantom features a powerful BITE magnet incorporated into the rear center of its housing, which allows it to be securely attached to the included belt/bag clip, or directly to a golf cart bar. To use the BITE clip, simple slide it onto your belt or golf bag (*round concave part facing out*), then place the convex BITE magnet on the back of the Phantom near the round concave area on the BITE clip (*see below*).



F.P.O.
Image-replace

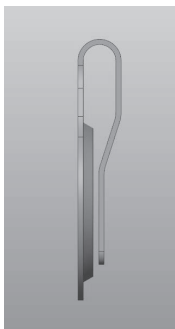

**BITE Clip for attaching Phantom
to belt or golf bag**

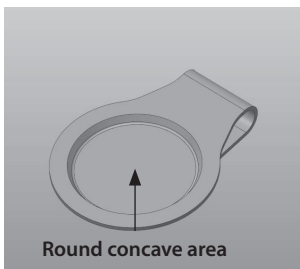

How to Find the Product ID / Serial Number

The serial # (Product ID) of your Phantom can be found on the back of the unit. Write it down below for future reference. You will need it to register on the iGolf site so you can access newly added golf courses or update data for existing courses.

F.P.O.
Image-replace

Product ID (serial #)



My Serial #/Product ID

ONE YEAR LIMITED WARRANTY

Your Bushnell® NEO Phantom is warranted to be free of defects in materials and workmanship for one year after the date of purchase. In the event of a defect under this warranty, we will, at our option, repair or replace the product, provided that you return the product postage prepaid. This warranty does not cover damages caused by misuse, improper handling, installation, or maintenance provided by someone other than a Bushnell Authorized Service Department.

Any return made under this warranty must be accompanied by the items listed below:

1. A check/money order in the amount of \$10.00 to cover the cost of postage and handling
2. Name and address for product return
3. An explanation of the defect
4. Proof of Date Purchased

Product should be well packed in a sturdy outside shipping carton to prevent damage in transit, to the address listed below:

IN U.S.A. Send To:

Bushnell Outdoor Products
Attn.: Repairs
9200 Cody
Overland Park, Kansas 66214

IN CANADA Send To:

Bushnell Outdoor Products
Attn.: Repairs
140 Great Gulf Drive, Unit B
Vaughan, Ontario L4K 5W1

For products purchased outside the United States or Canada please contact your local dealer for applicable warranty information. In Europe you may also contact Bushnell at:

Bushnell Germany GmbH
European Service Centre
Mathias-Brüggen-Str. 80
D-50827 Köln
GERMANY
Tel: +49 221 995568-0
Fax: +49 221 995568-20

This warranty gives you specific legal rights.
You may have other rights which vary from country to country.

©2017 Bushnell Outdoor Products

Windows is a registered trademark of Microsoft Corporation in the United States and other countries.

Mac and Mac OS are trademarks of Apple Inc., registered in the U.S. and other countries.

Other names may be trademarks of their respective owners.

FCC Statement

This device complies with Part 15 of the FCC interference limits for Class B digital devices FOR HOME OR OFFICE USE. These limits are designed to provide reasonable protection against harmful interference in a residential installation, and are more stringent than "outdoor" requirements.

This device complies with part 15 of the FCC Rules. Operation of this device is subject to the following conditions (1) This device may not cause harmful interference, and (2) this device must accept any interference received, including interference that may cause undesired operation.

This equipment generates, uses and can radiate radio frequency energy and, if not installed and used in accordance with the instructions, may cause harmful interference to radio communications. However, there is no guarantee that interference will not occur in a particular installation. If this equipment does cause harmful interference to radio or television reception, which can be determined by turning the equipment off and on, the user is encouraged to try to correct the interference by one or more of the following measures:

- Reorient or relocate the receiving antenna.
- Increase the separation between the equipment and receiver.
- Connect the equipment into an outlet on a circuit different from that to which the receiver is connected.
- Consult the dealer or an experienced radio/TV technician for help.

The device does not contain any user-serviceable parts. Repairs should only be made by an Authorized Bushnell repair center. Unauthorized repairs or modifications could result in permanent damage to the equipment, and will void your warranty and your authority to operate this device under Part 15 regulations.

The shielded interface cable which is provided must be used with the equipment in order to comply with the limits for a digital device pursuant to Subpart B of Part 15 of FCC Rules.

Radiation Exposure Statement:

The product complies with the FCC portable RF exposure limit set forth for an uncontrolled environment and are safe for intended operation as described in this manual. The further RF exposure reduction can be achieved if the product can be kept as far as possible from the user body or set the device to lower output power if such function is available.

Industry Canada statement:

This device complies with ISED's licence-exempt RSSs. Operation is subject to the following two conditions: (1) This device may not cause harmful interference, and (2) this device must accept any interference received, including interference that may cause undesired operation.

Le présent appareil est conforme aux CNR d'ISED applicables aux appareils radio exempts de licence. L'exploitation est autorisée aux deux conditions suivantes: (1) le dispositif ne doit pas produire de brouillage préjudiciable, et (2) ce dispositif doit accepter tout brouillage reçu, y compris un brouillage susceptible de provoquer un fonctionnement indésirable.

Radiation Exposure Statement:

The product complies with the Canada portable RF exposure limit set forth for an uncontrolled environment and are safe for intended operation as described in this manual. The further RF exposure reduction can be achieved if the product can be kept as far as possible from the user body or set the device to lower output power if such function is available.

Déclaration d'exposition aux radiations:

Le produit est conforme aux limites d'exposition pour les appareils portables RF pour les États-Unis et le Canada établies pour un environnement non contrôlé. Le produit est sûr pour un fonctionnement tel que décrit dans ce manuel. La réduction aux expositions RF peut être augmentée si l'appareil peut être conservé aussi loin que possible du corps de l'utilisateur ou que le dispositif est réglé sur la puissance de sortie la plus faible si une telle fonction est disponible.

Bushnell®

neo

PHANTOM

GPS RANGEFINDER

Customer Service: (800) 423-3537
www.bushnellgolf.com

©2017 Bushnell Outdoor Products