

CONTENTS AND FEATURES

- A. X-Craft™ Vehicle
- B. Transmitter
- C. Battery Charger
- D. Battery Pack

Vehicle

- 1) Wing
- 2) Air Bag Skirt

Transmitter

- 3) Antenna
- 4) Throttle Stick Left Side
- 5) Throttle Stick Right Side
- 6) LED indicator (light indicates when transmitter is turned on or off)
- 7) Lift Cut Button (stop/braking)

DO NOT LIFT VEHICLE BY THE AIR BAG SKIRT. USE WING TO HOLD

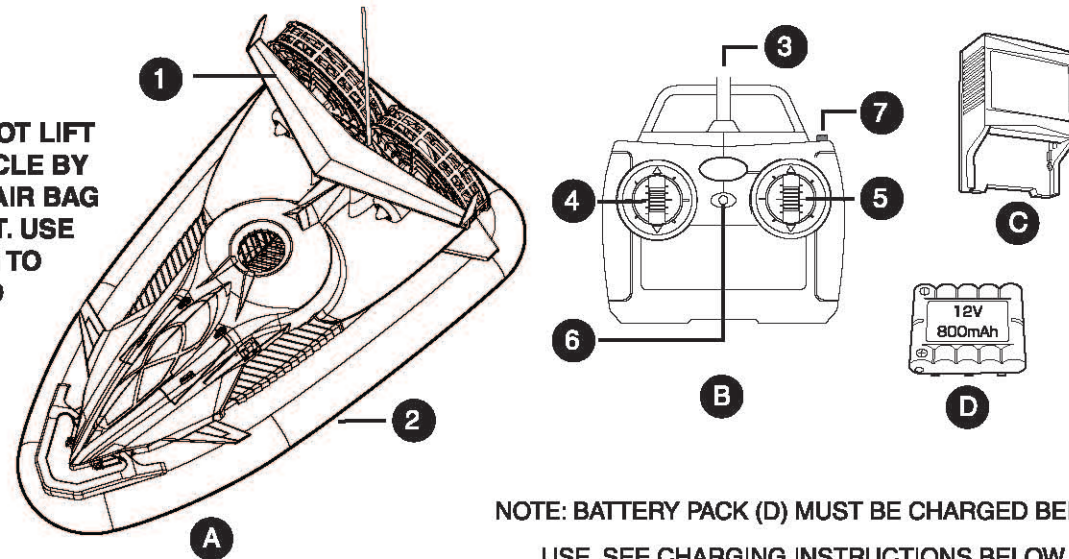

NOTE: BATTERY PACK (D) MUST BE CHARGED BEFORE USE. SEE CHARGING INSTRUCTIONS BELOW. TRANSMITTER (B) REQUIRES 9V BATTERY (NOT INCLUDED).

Note: Just turn your vehicle ON. Then move the sticks on the transmitter and you will be able to run and control your vehicle. Transmitter automatically turns off when not in use to save battery power.

X-CRAFT POWER SYSTEM

Your X-Craft uses a special 12-volt power system. Here are a few tips and hints:

- Because of its unique design, other battery chargers will be unable to charge your X-Craft battery pack. Use **ONLY** the X-Craft battery charger. The X-Craft battery pack is designed for use only in your X-Craft. It will not work in other vehicles.
- Your X-Craft's running time will vary depending on its power consumption (and your driving style).

CHARGING THE X-CRAFT BATTERY PACK

1. Slide the battery pack securely into the charger. Look for the (+) and (-) symbols on the battery pack and orient pack as shown in the illustration.
2. Plug the battery charger into standard wall outlet.
3. To disconnect, unplug charger from outlet and slide out the battery pack.
4. **New battery packs must be charged for 5-1/2 hours the first two times charged. After that, charges will require only 4 hours.**
5. After charging, the battery pack will feel warm. This is normal for fully charged batteries.
6. Unplug the charger when not in use.
7. Unlike alkaline batteries, which lose power gradually, your X-Craft battery pack will run for its normal running time, depending on your particular running style, and then lose most of its power at once. It is now time to recharge the battery pack.
8. Please make sure your NIMH rechargeable battery power is empty when recharging.
9. **After use, the battery pack will be hot! Wait at least 20 minutes until the battery pack cools down before recharging. Recharging a hot battery will greatly reduce the number of times your battery pack can be recharged.**

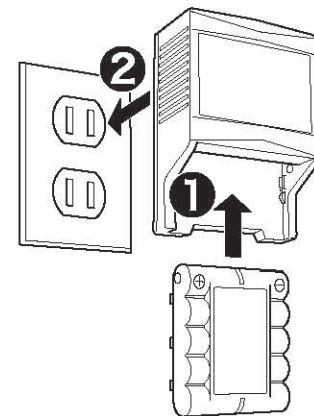

TRANSMITTER BATTERY INSTALLATION

1. Slide open and remove battery door as shown.
2. Install one 9V alkaline battery (NOT INCLUDED) in battery compartment as shown. Observe battery polarity (+ and -).
3. Replace battery door.

1 x 9V
(NOT INCLUDED)

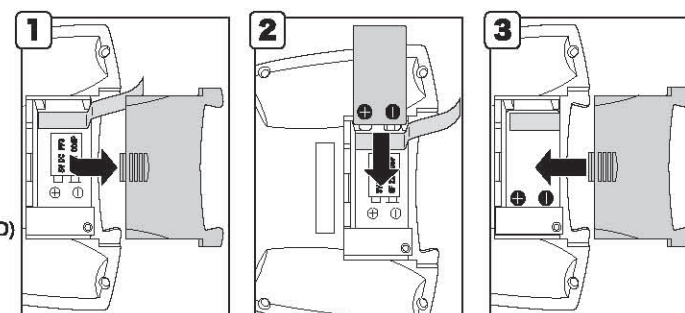

The adaptor be periodically examined for conditions that may result in the risk of fire, electric shock, or injury to persons and that, in an event such conditions, the adaptor should not be used until properly repaired.

VEHICLE BATTERY INSTALLATION

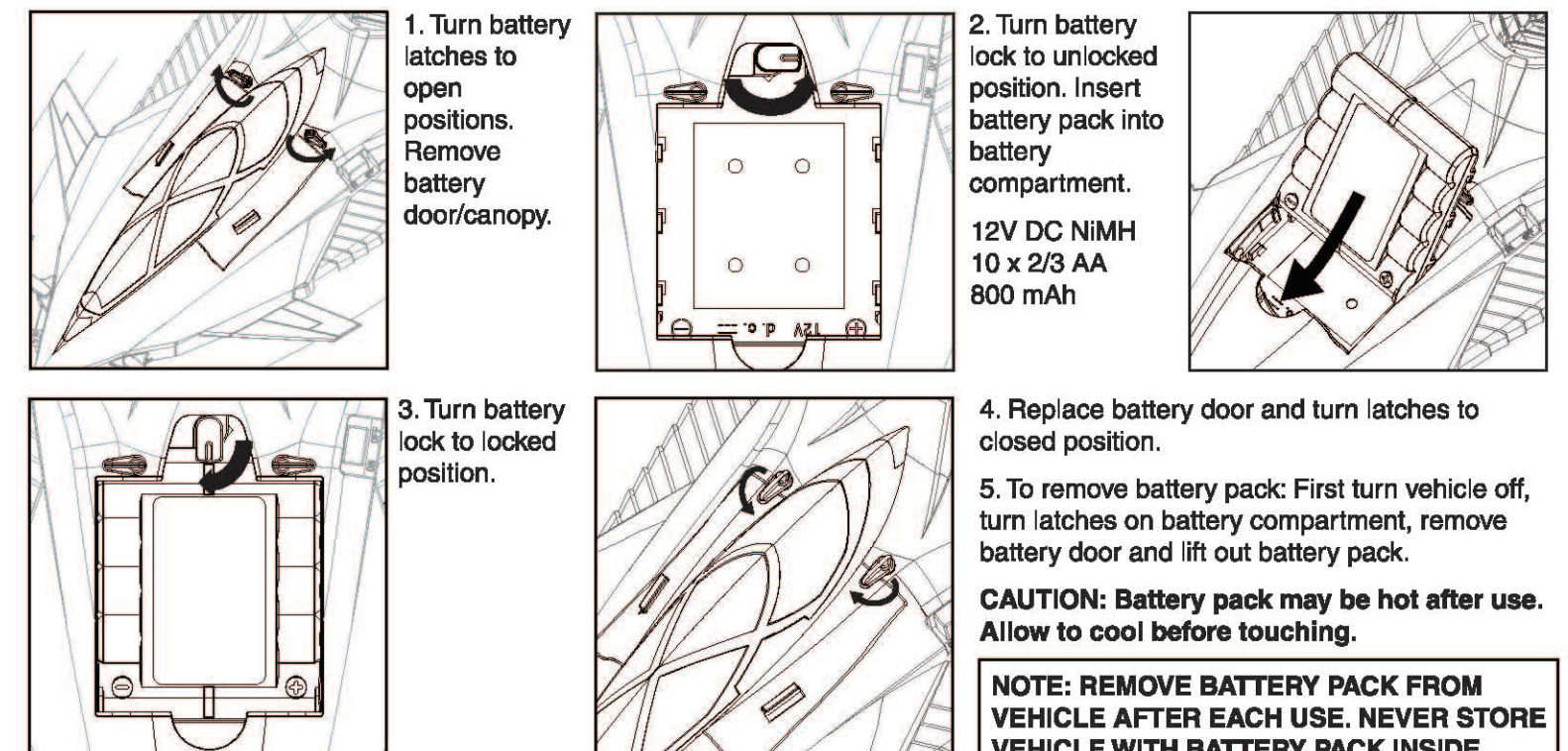

2. Turn battery lock to unlocked position. Insert battery pack into battery compartment.
**12V DC NiMH
10 x 2/3 AA
800 mAh**

1. Turn battery latch to open positions. Remove battery door/canopy.

3. Turn battery lock to locked position.

4. Replace battery door and turn latches to closed position.
5. To remove battery pack: First turn vehicle off, turn latches on battery compartment, remove battery door and lift out battery pack.

CAUTION: Battery pack may be hot after use. Allow to cool before touching.

NOTE: REMOVE BATTERY PACK FROM VEHICLE AFTER EACH USE. NEVER STORE VEHICLE WITH BATTERY PACK INSIDE.

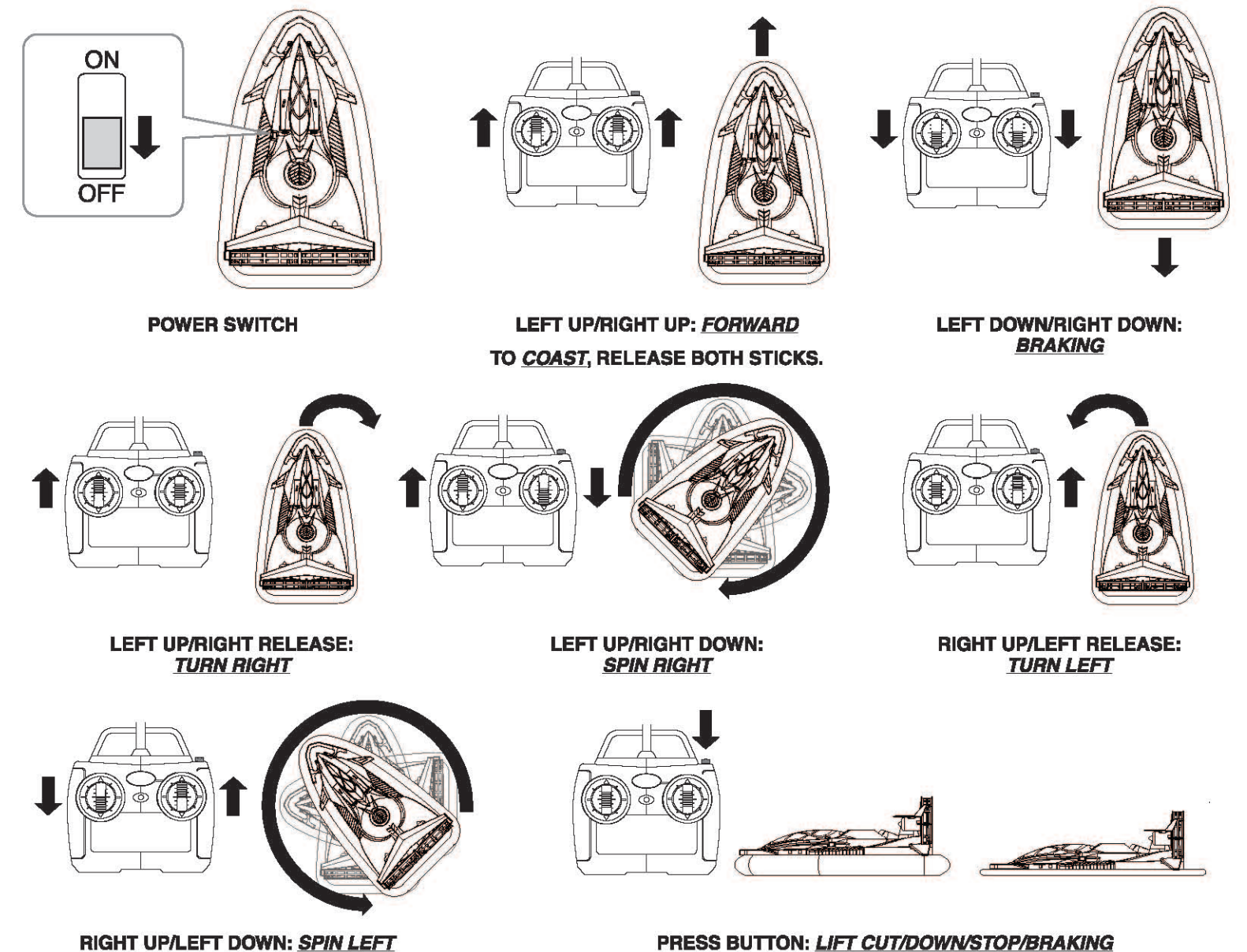

Warning: Changes or modifications to this unit not expressly approved by the party responsible for compliance could void the user's authority to operate the equipment.

NOTE: This equipment has been tested and found to comply with the limits for a class B digital device, pursuant to Part 15 of the FCC rules. These limits are designed to provide reasonable protection against harmful interference in a residential installation. This equipment generates, uses and can radiate radio frequency energy and, if not installed and used in accordance with the instruction, may cause harmful interference to radio communications. However, there is no guarantee that interference will not occur in particular installation. If this equipment does cause harmful interference to radio or television reception, which can be determined by turning the equipment off and on, the user is encouraged to try to correct the interference by one or more of the following measures:

- Reorient or relocate the receiving antenna.
- Increase the separation between the equipment and receiver.
- Connect the equipment into an outlet on a circuit different from that to which the receiver is connected.
- Consult the dealer or an experienced radio/TV technician for help.

FCC statement:

This device complies with Part 15 of the FCC Rules. Operation is subject to the following two conditions:

(1) this device may not cause harmful interference, and (2) this device must accept any interference received, including interference that may cause undesired operation.