

## Using instructions

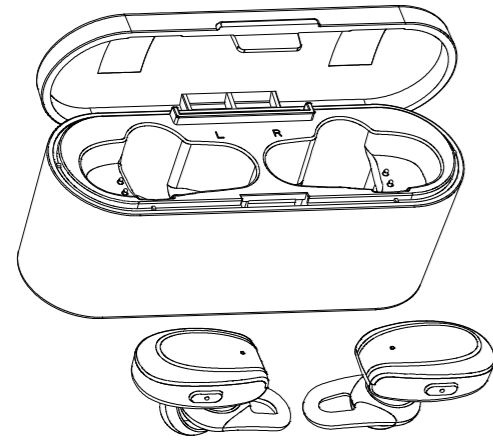

TWS-T02

### 1. Product Description

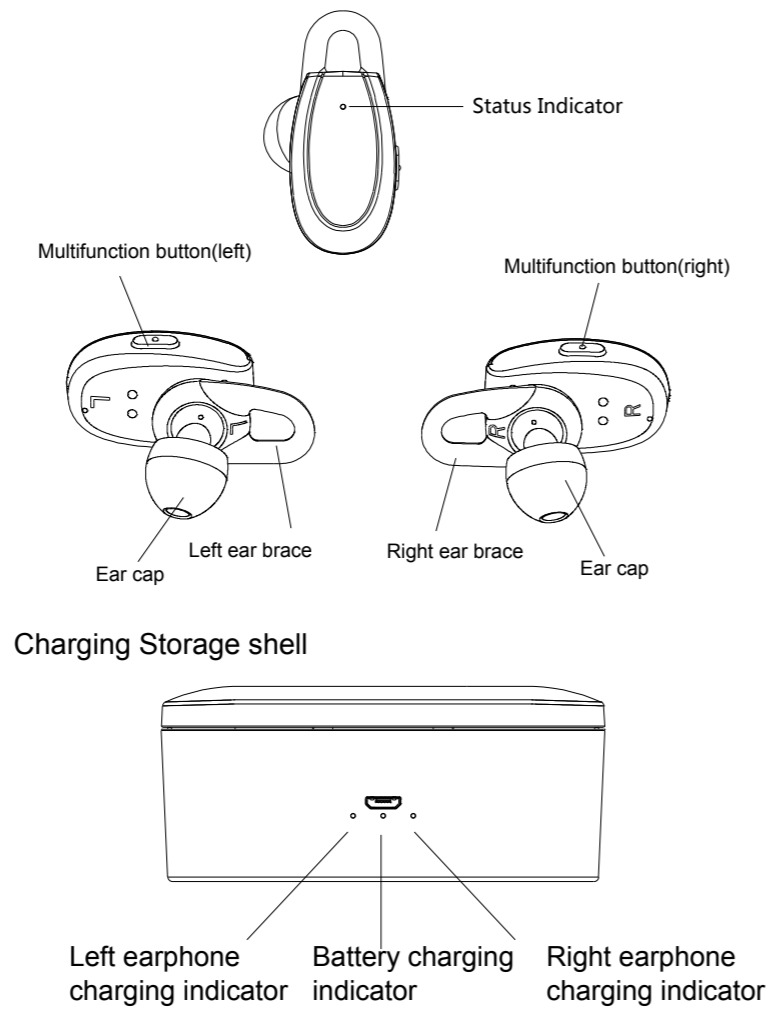

### 2. Parts list

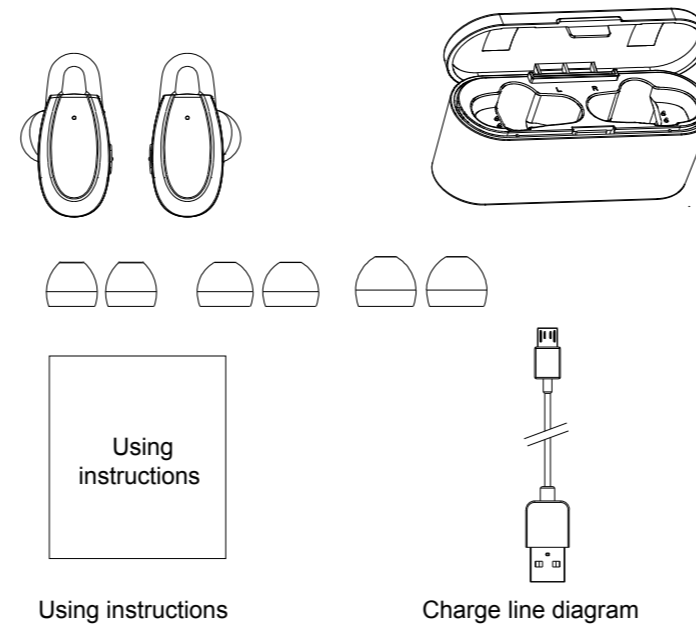

### 3. Attention

- Please charge the headphone first, then wear the headphone according to the instructions.
- Do not hit the host seriously.
- Do not touch thinner chemicals such as benzene.
- Do not disassemble, repair or modify it by yourself.
- Do not listen at a large volume for a long time to avoid adverse effects on your hearing.
- Do not expose to the sun for a long time.
- Do not leave it in water or in a damp place for a long time.

### 4. Wireless Earbuds Parameters

Wireless earbuds version: TWS-T02 wireless earbuds 4.2, support automatic boot, automatic connection, With English voice prompts, the device name is TWS-T02.  
Communication distance: 10m  
Waterproof Grade: IPX4  
Channel model: Two-channel stereo models  
Battery type: Lithium Ion batter  
Headset Battery: 3.7V, 60mahy  
Charging box battery: 3.7V, 800mah, can charge the headphones 5 times.  
Frequency response: 20hz-20khz  
Play time: about 3h  
Talk time: about 3h  
Main material: Plastic

### 5. Headphone wear and wireless earbuds connection

#### 1. Wear Earbuds

- (1) Remove the earphones from the charging box and wear the left and right ears according to the "L" and "R" on the headphones.
- (2) Ear caps are divided into large, medium and small types, according to the size of individual ears to choose to change the ear caps until feeling comfortable to wear.
- (3) Put the ears in the ear profile, so that the sound is more effective, more stable, more comfortable.

#### 2. Wireless earbuds connection

(1) Manual boot: press the multi-function button on the left and right headphones for 2 seconds, you can boot up.  
Automatic boot: Remove the left and right headphones from the charging box, it is already turned on.

right: a. power on      b. Connected, right channel  
c. please pair to your device (on masterearbud)  
left: a. power on      b. Connected, left channel

(2) Turn on wireless earbuds on your mobile device  
Click "Settings" → open "wireless earbuds" → turn on "wireless earbuds" → search for devices  
→ Click on "TWS-T02" to connect (while hearing the voice prompt: "Pairing Successful"). Just fine.

(3) If you want to pair with another wireless earbuds device.  
a. Turn on wireless earbuds, click on the name of the paired device, and click cancel pairing, while shutting down the existing equipment;  
b. Click on "Search for devices", find the name of the device you want to connect to, and click Connect.

#### 6. Music Play

1. After the wireless earbuds is connected successfully, turn on music play equipment;
2. Click any multi-function button on the headphones to start playing music;
3. Click any multi-function button on the headset again to stop playing.

### FCC warning

The FCC ID number of this product is: A4X-TWST02  
This device complies with Part 15 of the FCC Rules  
(1) This device may not cause harmful interference  
(2) This device must accept any interference received, including interference that may cause undesired operation.

### 7. Voice Command

1. Double-click the multifunction button on either side of the headphones.
2. The Siri helper and Android Google helper of the iPhone will be activated.
3. You can voice to ask any questions or requests.

### 8. Answer the call

1. When you receive an incoming call, the voice will report the mobile number of the call, click on the multi-function button on either side to connect to the phone, but only the main earphone can hear the sound.
2. Click the multi-function button again to hang up the phone.
3. When you receive a call alert, press and hold any multi-function button for 1s and you can reject the call.

### 9. If you change the right earphone to the main earphone, the steps are as follows:

1. After removing the left and right earphones from the charging box, at the same time, press the multi-function button to force the shutdown;
2. Press and hold the left and right headphone multi-function buttons at the same time until the status indicator lights flashing red and blue lights.
3. Double-click the left multi-function button to set the left earphone as the main body

(The status indicator will continue to display red and blue flashing, and the right headset status indicator will be displayed. Slow flashing blue light. );  
4. Wireless earbuds connection method can be connected according to 5 (2).

### 10. Charging

charging box  
The fully charged charging box can charge headphones for 5 times.

1. Insert the attached Micro USB cable included in the box into the Micro USB port of charging box.

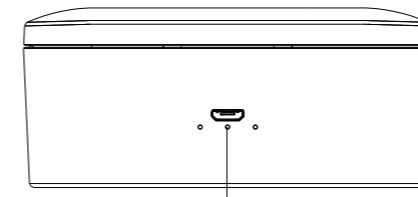

When charging, the status indicator light is red, the lights went out when the electricity was filled.

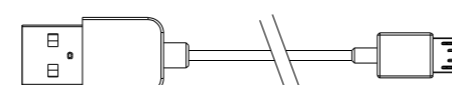

Data cable diagram

2. Plug the other end of the Micro USB cable. Power can be charged.

### Headphones

Headphones full of electricity can be played about 3h.

1. When the power is low, the voice will remind "Battery low";
2. Put the left and right headphones into the charging box, close Lid, you can charge the headset;
3. When left and right headphones are full of electricity, the headset is automatically connected when it is removed.

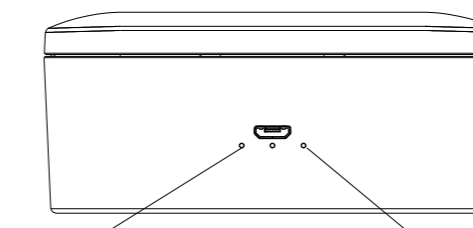

When charging, the status indicator light of the right earphone is red, lights went out when the electricity was filled.

When charging, the status indicator light of the left earphone is red, lights went out when the electricity was filled.

### 11. Troubleshooting problems

#### 1. The phone cannot search for wireless earbuds.

- (1) Check if the left earphone is flashing slowly (already paired with the host automatically), and the right earphone (host) red and blue lights flash alternately, wireless earbuds search mode
- (2) If wireless earbuds is still not connected to the headphone, please put the left and right headphones into the charging box. After that, try again and the wireless earbuds connected device will restart at the same time;

#### 2. wireless earbuds headphones always disconnected after connecting with wireless earbuds device.

- (1) Power is insufficient, please charge the wireless earbuds headphones as soon as possible;
- (2) The distance between the wireless earbuds device and the wireless earbuds headphones exceeds the wireless earbuds reception distance.

#### 3. Do you need to re-search to connect to wireless earbuds every time you use it?

No, as long as you have connected the TWS-T02 wireless earbuds headphones once, when you take it from the charging box, wireless earbuds will connect to your wireless earbuds device automatically.

#### 4. When I use the wireless earbuds headphones to make a call, only the right earphone can hear the sound, if I want to change to the left ear, can I hear the call?

Because only the main earphone can connect to the phone when answering the call, you can only hear the voice from one side of the headphones. If you want to set the left earphone as the main earphone, please follow the instructions in section 9 to change the setting operation of main earphone.

#### 5. Do I have to turn it on manually before and after use, how about shut down?

No, open the lid of the charging box, and take out the earphone, it will automatically turn on. When you put the earphones back inside the charging box, the earphones are automatically turned off and charged again. When you remove the box, Bluetooth automatically connects to your Bluetooth device.

#### 6. If the headphones are removed and not used for a long time, whether the headphones will wait for the power to run out and then shut down?

No, the headphones will automatically shut down after 15 minutes without using it.

## **FCC Statement**

This equipment has been tested and found to comply with the limits for a Class B digital device, pursuant to Part 15 of the FCC Rules. These limits are designed to provide reasonable protection against harmful interference in a residential installation. This equipment generates uses and can radiate radio frequency energy and, if not installed and used in accordance with the instructions, may cause harmful interference to radio communications. However, there is no guarantee that interference will not occur in a particular installation. If this equipment does cause harmful interference to radio or television reception, which can be determined by turning the equipment off and on, the user is encouraged to try to correct the interference by one or more of the following measures:

- Reorient or relocate the receiving antenna.
- Increase the separation between the equipment and receiver.
- Connect the equipment into an outlet on a circuit different from that to which the receiver is connected.
- Consult the dealer or an experienced radio/TV technician for help.

This device complies with part 15 of the FCC Rules. Operation is subject to the following two conditions:  
(1) This device may not cause harmful interference, and (2) this device must accept any interference received, including interference that may cause undesired operation.

Changes or modifications not expressly approved by the party responsible for compliance could void the user's authority to operate the equipment.