



FCC Information

FCC ID: 2AAQF-IHV315

FCC Statement

This equipment has been tested and found to comply with the limits for a Class B digital device, pursuant to part 15 of the FCC Rules. These limits are designed to provide reasonable protection against harmful interference in a residential installation. This equipment generates, uses and can radiate radio frequency energy and, if not installed and used in accordance with the instructions, may cause harmful interference to radio communications. However, there is no guarantee that interference will not occur in a particular installation. If this equipment does cause harmful interference to radio or television reception, which can be determined by turning the equipment off and on, the user is encouraged to try to correct the interference by one or more of the following measures:

- Reorient or relocate the receiving antenna.
- Increase the separation between the equipment and receiver.
- Connect the equipment into an outlet on a circuit different from that to which the receiver is connected.
- Consult the dealer or an experienced radio/TV technician for help.

Caution: Any changes or modifications to this device not explicitly approved by manufacturer could void your authority to operate this equipment.

This device complies with part 15 of the FCC Rules. Operation is subject to the following two conditions: (1) This device may not cause harmful interference, and (2) this device must accept any interference received, including interference that may cause undesired operation.

RF Exposure Information

The device has been evaluated to meet general RF exposure requirement. The device can be used in portable exposure condition without restriction.

IMPORTANT SAFETY INSTRUCTIONS

When used in the directed manner, this unit has been designed and manufactured to ensure your personal safety. However, improper use can result in potential electrical shock or fire hazards. Please read and follow all safety and operating instructions carefully before installation and use, and keep these instructions handy for future reference. Take special note of all warnings listed in these instructions and on the unit.

Heat - The unit should be situated away from heat sources such as radiators, heat registers, stoves or other appliances (including amplifiers) that produce heat."

Damage Requiring Service - The unit should be serviced by qualified service personnel when:

- A. the unit has been dropped or the enclosure damaged.
- B. the unit exhibits a marked change in performance or does not operate normally

Only use attachments/accessories specified by the manufacturer.



For warranty information:
 visit <https://www.ihome.com/support>

IHV315-052318-A

Printed in China



Quick Start Guide

Bluetooth Rechargeable Speaker

Model: IHV315

What's Included:

- Bluetooth Rechargeable Speaker
- USB Charging Cable



CHARGE BEFORE USE

Questions? Visit www.ihome.com
 or call 1-800-288-2792 Toll Free



IHV315 - QSG (English only)

GETTING STARTED

Charging your speaker

Speaker must be charged before use (about 2 hours).

- Connect small plug of the included USB charging cable to USB port located under the water resistant cover and connect the other end to a powered USB port.
- Indicator will glow red while charging and turn off once charged.
- Speaker should provide about 4 hours of audio when fully charged.

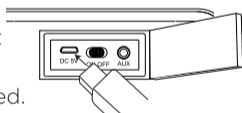

Basic Controls & Functions

Back

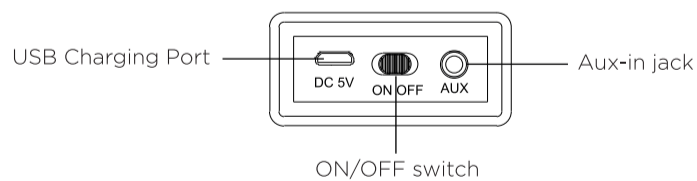

Top

- | | | |
|---|--|---|
| <ul style="list-style-type: none"> • Short press previous track • Long press lower volume | <ul style="list-style-type: none"> • Short press play/pause/resume audio • Press and hold 2 seconds activate Siri/Google Assistant • Press and hold 5 seconds for new Bluetooth pairing • Short press answer/end calls | <ul style="list-style-type: none"> • Short press next track • Long press raise volume |
|---|--|---|

WATER RESISTANT OPERATION

For proper water resistant operation, make sure the water resistant cover on the back of the unit is completely flush with the unit by pressing along the entire edge of the cover until it is completely and securely in place.

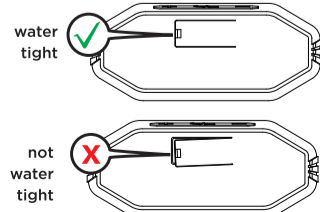

BLUETOOTH

Pairing establishes a unique communication connection between your Bluetooth device and the speaker. Once paired, you will be able to stream audio wirelessly to your Bluetooth Rechargeable Speaker.



- 1 When the speaker is powered ON it enters auto-link mode, searching for a previously connected Bluetooth device. If none is found, the unit switches to auto-pairing mode. The LED indicator on the front of the speaker will flash blue and tones will sound.



- 2 Turn on Bluetooth mode on your device (under Settings, Connections or similar).
- 3 Select "IHV315" on your device's menu of Bluetooth devices. When pairing is successful, the LED will turn solid blue. If prompted for a password, enter "0000" on your device. You can now begin to stream audio and calls from your device. The LED slowly flashes blue when audio is playing.



- 4 Press **Play/Pause/Speakerphone Button** to play/pause/resume Bluetooth audio. **Press and hold - or + Buttons** to adjust speaker volume.



- 5 To pair other devices, **press and hold the Play/Pause/Speakerphone Button for 5 seconds** to clear the current connection. Pair the new device per steps above. **Press and hold both - and + Buttons for 5 seconds** to reset the Bluetooth connection.



SPEAKERPHONE

Press the **Play/Pause/Speakerphone Button** to answer or end a call. **Press and hold for 2 seconds** to decline/ignore an incoming call.

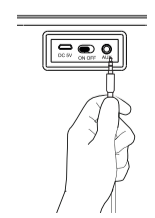

AUX-IN

Connect a standard 3.5 mm audio cable (not included) to the aux-in jack located on the back of the speaker under the water resistant cover and connect the other end to the headphone jack on your audio device. Power on the speaker. The LED indicator will slowly flash blue. **NOTE:** While using Aux-in, Bluetooth connection is disabled and media playback and volume adjustment must be controlled using your audio device.