

R/C HELICOPTER USING INSTRUCTION

- 1.Intelligentized R/C system.
- 2.Full scale remote contro.
- 3.360exact directional.
- 4.Smooth hang performance.
- 5.Newly designed electricity saving function.
- 6.Safeguard battery model to prolong the uses life.

Please read the instructions carefully before use .[Please read the Notice in details.]Please retain the instructions for future reference.

INCLUDED PARTS NAME:

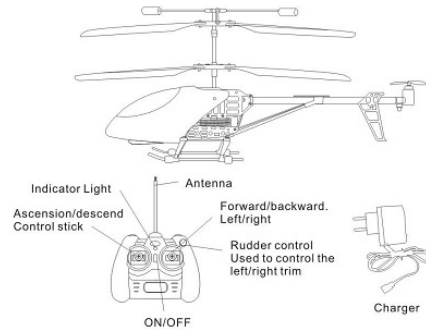

ASSEMBLY TRANSMITTER

- 1.Install antenna cord:remove antenna into adapter clockwise.
- 2.Install batteries:open the cover of battery case,insert 4batteries (size 1.5V AA) properly followed by polar indicator. (Batteries to be purchased).

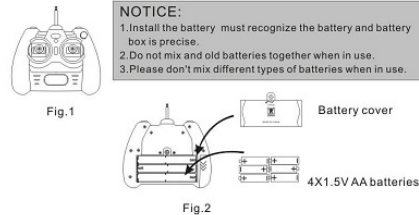

NOTICE:
 1. Install the battery must recognize the battery and battery box is precise.
 2. Do not mix and old batteries together when in use.
 3. Please don't mix different types of batteries when in use.

Using instructions of charging power batteries

Always turn off the helicopter power, unplug the battery connector, and connect it to the connector on charger, then insert the charger into the power jack. When charging the LED is red, and charge is finished the LED is green. Do not charge over the 100-110 minutes.

- Helicopter is equipped with a Li-Poly battery, please also pay attention to the following cautions for safety use.
 - Do not use or leave the battery near a heat source such as fire or heater. Otherwise it can cause damage or explode.
 - Do not immerse the battery in water, and keep the battery in a cool dry environment.
 - When recharging, only use the battery charger specifically for that purpose.
 - Do not disassemble the battery.
 - Never leave the battery unattended during charging.



NOTICE
 ●When you are tired of playing, please disconnect battery to extend battery's usage time.
 ●Be sure the adapter fit your local electrical power supply.

ENVIRONMENT FOR FLIGHT:

1. Fly on a sunny day, without wind.
 1. Do not fly in temperature above 113 degrees Fahrenheit /45 degrees centigrade, or below 50 degrees Fahrenheit /10 degrees centigrade. Flying in extreme heat and/or cold will affect performance and may damage the model.
 2. Do not fly in strong wind.
- Windy conditions will limit, or disturb the flying control.
 In very windy conditions, your helicopter may become lost and/or damaged.
 Animals or people nearby.



READY TO FLY

1. Lay your helicopter onto the ground, turn on the power switch, and the indicator lights.
2. Leave the helicopter at least two meters away, while the tail aimed at you.
3. Check that the helicopter be far away from the crowd, animals and other obstructions.
4. Pull the antenna of the remote controller to the longest and make sure the accelerator is at the minimum position. Turn on the remote controller, turn to full throttle and reset, the indicator light will be always on. This time you can use the remote controller and prepare for taking off.

NOTICE
 While the indicator of the controller is sparkle, which shows the controller is lack of power. And you can change some batteries for it.

CONTROL METHOD

Ascend	When you push up the left stick (throttle stick), the spinning speed of the main rotor blade is increase and the helicopter begin to ascend.		
Descend	When you pull down the left stick (throttle stick), the spinning speed of the main rotor blade is decrease and the helicopter begin to descend.		
Steering	1. when the right stick (rudder stick) is moving to left, the head of the helicopter turns to left. 2. when the right stick (rudder stick) is moving to right, the head of the helicopter turns to right.		
Forward	When you push up the right control lever (steering rudder), the nose incline to down, the helicopter is moving to forward.		
Backward	When you push down the right control lever (steering rudder), the nose incline to up, the helicopter is moving to backward.		

SPECIAL PROMPT

If helicopter flies, rotating in the air without pulling control stick, then you can stop the fly, use screw driver to adjust the potentiometer on chopper circuit board lightly till it is steady. Then adjust the hard adjustment till it stop revolving. If helicopter is revolving in the air yet you do not make action to the rudder, you can use the fine-tune-button on it to make helicopter stop revolving and back to the balance. If head of helicopter rotates clockwise, slowly touch fine-tune-button left of the rudder to keep it balance, and vice versa. But when this adjust action is useless, make helicopter landing, turn off the power on it. Then you turn on the power of helicopter and launch it, adjust the fine-tune-button again.)

NOTICE
 When the airplane away from the ground in 30cm position the helicopter will suffer by itself blade vortex to become unstable, we call it "effect response", when the helicopter weight lowers and the "effect response" affect will be bigger.

If head of helicopter rotates anticlockwise, tune the Rudder control clockwise to keep the helicopter.			Clockwise
If head of helicopter rotates clockwise, tune the Rudder control Counterclockwise to keep the helicopter.			Counterclockwise

FLYING PRACTICE

After the enough practice, you can attempts following flying practice

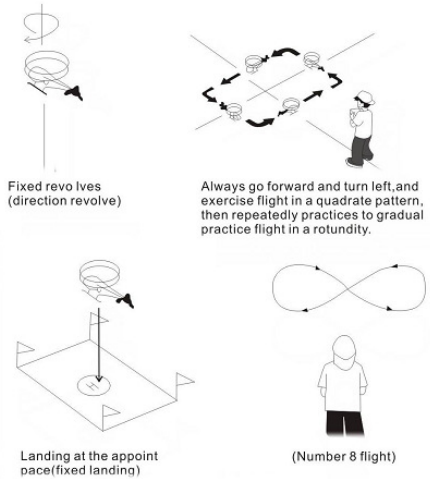

CAUTION: The user is cautioned that changes or modifications not expressly approved by the party responsible for compliance could void the user's authority to operate the equipment.

Note: This equipment has been tested and found to comply with the limits for a Class B digital device, pursuant to part 15 of the FCC Rules. These limits are designed to provide reasonable protection against harmful interference in a residential installation. This equipment generates, uses and can radiate radio frequency energy and, if not installed and used in accordance with the instructions, may cause harmful interference to radio communications. However, there is no guarantee that interference will not occur in a particular installation. If this equipment does cause harmful interference to radio or television reception, which can be determined by turning the equipment off and on, the user is encouraged to try to correct the interference by one or more of the following measures:
 -Reorient or relocate the receiving antenna.
 -Increase the separation between the equipment and receiver.
 -Connect the equipment into an outlet on a circuit different from that to which the receiver is connected.
 -Consult the dealer or an experienced radio/TV technician for help.

TROUBLE SHOOT AND DEALING WITH

PROBLEM	CAUSE	CHECK THIS
Controller doesn	1. Controllers power switch is "OFF".	1. Turn power switch "ON".
	2. Insert batteries into controller improperly	2. Confirm batteries be inserted according to their pole.
	3. Batteries lack of power.	3. Change new batteries instead.
Can not control the helicopter	1. You havent operated the controller.	1. Turn controller power switch "ON"
	2. Doesnt turn on controllers power switch.	2. Turn helicopters power switch "ON".
	3. Doesnt wrest antenna into controller completely or antenna isnt fully pulled out.	3. Wrest antenna completely and pull it out.
	4. You play the helicopter in strong winds weather.	4. Do not play the chopper in winds, which can confuse your control.
Helicopter can not rise	1. Main rotor blades rotate too slowly.	1. Pull up the throttle stick.
	2. Doesnt fully charge helicopters battery.	2. Full charge helicopter battery. (See instruction above)
Helicopter land too fast.	You loose the throttle stick or pull is down too fast.	Slowly pull down the throttle till the chopper landing smoothly.

CAUTION

1. The control distance will shorter when the quantity of electricity is not full.
2. When the quantity of the electricity of the helicopter is not full, the helicopter will difficulty or the height of fly is not enough.
3. If the helicopter become damaged, deformation, please repaired in time. If the rotor become damaged or broken, do not fly, otherwise, it will lead to injury.
4. If you don't use the transmitter for a long time. Remove all batteries out, in order to avoid the battery leakage to damage this product.
5. Dont drop the helicopter from high position or crash it seriously, because that will damage it seriously or shorten the using time.

SAFETY

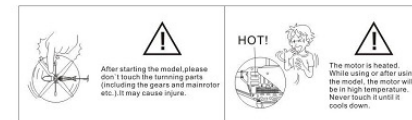

WARNING

- This product is not a toy. Be sure that you can control and operate it safely and it is not suitable for children under 14.
- If you don't have rich experience of controlling and operating the product, you are suggested any responsibility of the using of the product.
- Debugging and flight should be carried out strictly in accordance with the Manual and make sure to keep your hands, face and body away from the revolving parts.
- Be sure to fly the helicopter indoors or in a windless outdoor place. Keep the moving parts away from the other people and objects.
- While stopping flying, do pull off the joint of the battery power from the airframe, before turning off the switch of the transmitter power.
- Lithium polymer battery is included with this helicopter. Users are required to obey the operating regulation of the lithium battery otherwise it may cause accidents like burning, exploding and so on.
- Charge the product by using the charging system included with the controller or the product's special charge and power adapter.
- Take out the charge and the power adapter from the power outlet.
- To avoid accidents happening, never charge the product for a long time without anybody's watching.
- Never place the lithium battery in the direct sunlight or near fire. Never throw the battery into fire. Be sure to keep the battery in the dry environment.
- Never transport the battery and metal objects together.
- Never disassemble the battery.
- Never touch the charger or the power adapter with wet hands as to avoid accidents.
- While flying, do keep it away from the other electrical equipments, magnetic objects or radio devices so as to avoid accidents caused by interference and affection with each other.
- When battery power indicator light is twinkle, it shows that power of controller battery is insufficient, please stop flying and replace the controller battery.
- Guidelines for using lithium battery safely.
- In the case of not operating, charging the lithium battery may cause fire, personal injury and property loss. Users should be aware of the existence of risk while using such products. It is impossible for the manufacturer, dealers and retailers to take the responsibility for the existence of accidents. Please carefully read the instruction of guidance, aeromodeling and using battery before usage of the product.
- If you are not sure how to charge the battery, please consult the local charging and using battery before usage of the product.
- Keep the battery away from the children and pets. Users under the age of 18 should be used in adult's guardianship and users under the age of 14 are not suitable to operate the product.

PARTS ARE ALTERNATIVE

