

Service

CRAFTSMAN INFORMATION

No. 01
August 1998

MODEL(s) Craftsman 989.795040 and 989.796060

SUBJECT Additions / Corrections to Illustrated Parts List within Operator's Manuals

1. Craftsman Operator's Manual, Trimmer/Brushcutter Model 989.795040, PN 211862-01, Page 18 and Craftsman Operator's Manual, Trimmer Model 989.795060, PN 211864-01, Page 13

Changes to Part No. List on pages 13 and 18, respectively:

WALBRO				
ITEM	CHANGE PN	TO READ	CHANGE DESCRIPTION	TO READ
37	323601	325465	Cap, Lim, High, Black	Cap, Adj. High 2 Stg, Wht
38	323602	325466	Cap, Lim, Low, White	Cap, Adj. Low 2 Stg, Blk
ZAMA				
35	323603	111216	Cap, Lim, High, Black	Cap, Adj. High 2 Stg, Red
36	323604	111217	Cap, Lim, Low, White	Cap, Adj. Low 2 Stg, Nat

2. Craftsman Operator's Manual, Trimmer/Brushcutter Model 989.795040, PN 211862-01, Page 17 and Craftsman Operator's Manual, Trimmer Model 989.795060, PN 211864-01, Page 15

Changes to Part No. List on pages 15 and 17, respectively:

ITEM	CHANGE PN	TO READ	CHANGE DESCRIPTION	TO READ
10	224236-61	224236	Cover, Air Clnr, Lrg, Grey	Cover, Air Clnr, Lrg Blk
17	325121	See Pg 18	Carburetor w/Choke	Carburetor Asy
53	325157	300663	no change	Kit, Piston, 32cc Alum
54	no change	300482	Pin, C'Shaft Piston	Pin, C'Shaft Piston
55	no change	215876	Ring, Retaininig	Ring, Retaining
56	no change	224217	Ring, Piston	Ring, Piston
61	224235-61	224235	Cover, Cyl/Muff, Grey	Cover, Cyl/Muff, Blk

3. Craftsman Operator's Manual, Trimmer/Brushcutter Model 989.795040, PN 211862-01, Page 18

Changes to Part No. List on page 18:

ITEM	CHANGE PN	TO READ	CHANGE DESCRIPTION	TO READ
14	218075-01	218075	no change	Flange, Spindle
22	302554-01	300737	no change	Kit, Knob Asy, Left

**4. Craftsman Operator's Manual, Trimmer Model 989.796060,
PN 211864-01, Page 16**

Changes to illustration on page 16:

ITEM	CHANGE ITEM	TO READ	REASON
9	9	--	Item 9, at the powerhead end of the shaft should be removed
15	15	9	Item 15, at the "Guard, Wire Formed" should be item 9
19	--	19	Item 19 "325456 - Collar, Weed Wrap" is an added item

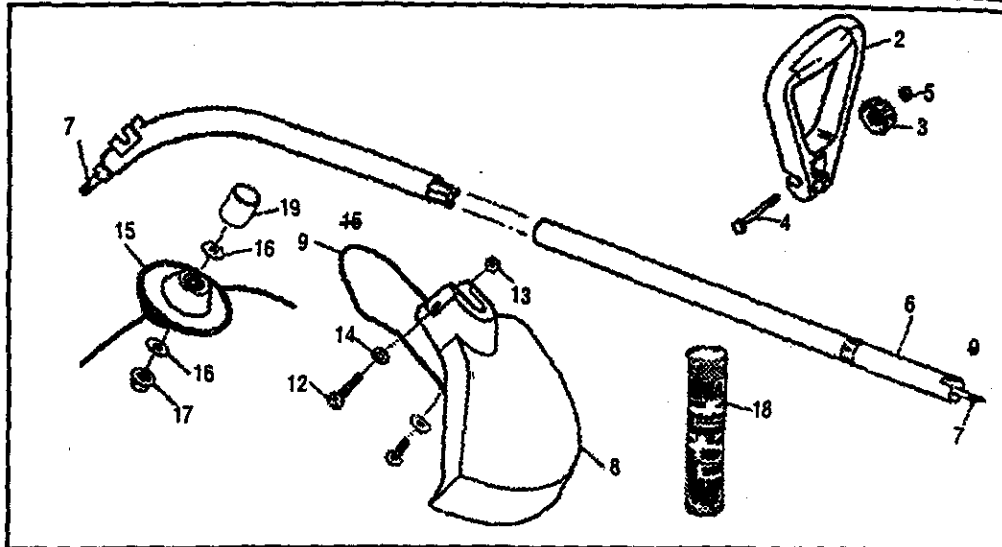

Changes to Shaft/Handle/Stringhead Part No. List on page 16:

ITEM	CHANGE PN	TO READ	CHANGE DESCRIPTION	TO READ
7	no change	301024	Shaft, Flex 48"	Drive Asy, w/clip, 48"
12	08031	08031-99	no change	Bolt, 10-32x2
13	13039	13039-99	no change	Nut, 10-32 Hex
19	added part	325456	added part	Collar, Weed Wrap (Qty 1)

*Item 19, Weed Wrap Collar, PN 325456, is a new service part with a suggested list price of \$.92. This Weed Wrap Collar was added to protect the shaft from binding due to debris build-up.

**5. Craftsman Operator's Manual, Trimmer Model 989.796060,
PN 211864-01, Pages 14 and 15**

Change to illustration on page 14: Change item 71 pointing at Starter/Clutch Housing to read item 72.

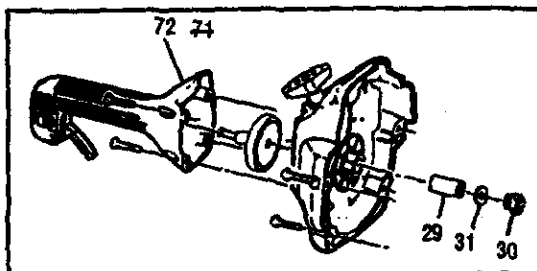

Add to Powerhead Part No. List on page 15:

ADD ITEM	PART No.	ADD DESCRIPTION	REASON
72	See Below	Starter/Clutch Hsg (Qty 1)	New Item No. 72, was inadvertently omitted from original parts list