

# CRAFTSMAN®

OPERATOR'S MANUAL

## **GTV** **SPRING ASSISTED** **SLEEVE HITCH**

MODEL:

**25241**

- Assembly
- Installation
- Operation
- Repair Parts

For use with SEARS  
Lawn/Garden Tractors

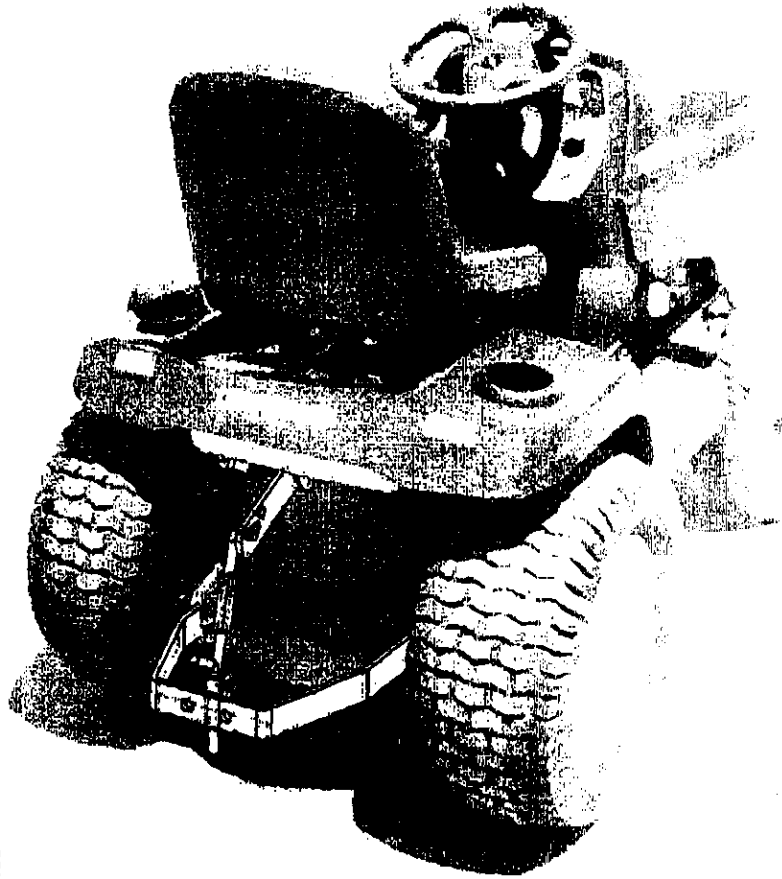

**Caution:** This manual contains information for the safety of persons and property. Read it carefully before assembly and operation of the equipment!

Sears, Roebuck and Co., Hoffman Estates, IL 60179 U.S.A.  
[www.sears.com/craftsman](http://www.sears.com/craftsman)

## CUSTOMER RESPONSIBILITY

Clean and store in waterproof building.

Apply a light coat of grease or oil to threaded parts, pivot points and the inside of Hitch Tube.

Touch up any scratches with enamel paint to avoid rusting.

## TABLE OF CONTENTS

SAFETY RULES .....	2
MAINTENANCE .....	2
WARRANTY.....	2
HARDWARE.....	3-4
PARTS REFERENCE .....	5
PARTS LIST .....	5
ASSEMBLY .....	6-9
OPERATION .....	10
NOTES .....	11



This symbol will help to point out important safety precautions throughout this manual. It means - ATTENTION! BECOME ALERT! Your safety is involved.

### Limited Warranty

For two(2) years from the date of purchase, when this Sleeve Hitch is maintained and lubricated according to the operating and maintenance instructions in the Owner's Manual, Sears will repair, free of charge, any defect in material or workmanship.

This warranty does not cover:

Repairs necessary because of operator abuse or negligence including the failure to maintain the equipment according to instructions contained in the Owner's Manual; and Sleeve Hitch used for commercial or rental purposes.

WARRANTY SERVICE IS AVAILABLE BY CONTACTING THE NEAREST SEARS SERVICE CENTER/DEPARTMENT IN THE UNITED STATES. This warranty applies only while this product is in use in the United States.

This warranty gives you specific legal rights, and you may also have other rights which vary from state to state.

SEARS, ROEBUCK AND CO., D/817 WA, Hoffman Estates, IL 60179 EE.UU.

Congratulations on your purchase! Your equipment has been designed, engineered, and manufactured to give you the best possible dependability and performance.

Should you experience any problem you cannot easily remedy, please contact your nearest Sears Service Center/Department. We have competent, well-trained technicians and the proper tools to service or repair your equipment. Please read and retain this Owner's Manual. The instructions will enable you to assemble and maintain your equipment properly. Always observe the 'Safety Rules' prior to use.

## RULES FOR SAFE OPERATION

- Know controls and how to stop towing equipment quickly. READ THE OWNER'S MANUAL.
- Do not allow children to operate the vehicle. Do not allow adults to operate without proper instruction or without having read the Owner's Manual.
- Do not carry passengers. Keep children and pets a safe distance away.
- Always wear substantial footwear. Do not wear loose-fitting clothing that can get caught in moving parts.
- Keep your eyes and mind on your towing equipment/attachment and area being covered. Do not let other interests distract you.
- Stay alert for holes in the terrain and other hidden hazards.
- Do not drive close to creeks, ditches, and public highways.
- Watch out for traffic when crossing or near roadways.
- When using any attachment, don't allow anyone near the vehicle while in operation.
- Keep the vehicle and attachment in good operating condition and keep safety devices in place.
- Keep all nuts, bolts, and screws tight to be sure the equipment is in safe working condition.
- The vehicle and attachment should be stopped and inspected for damage after striking any foreign object. The damage should be repaired before restarting and operating the equipment.
- See towing equipment Owner's Manual for safe operation of the equipment.



## MAINTENANCE

The key to years of trouble-free service is to keep your Equipment clean and dry.

Occasionally check all moving parts for free movement and, if necessary, lubricate with oil.

Should rust develop, sand lightly and then paint area with enamel.

Periodically check all fasteners for tightness.

**HARDWARE REFERENCE**

**Tools Required for Assembly:**

- 2 - 1/2" Wrenches
- 2 - 9/16" Wrenches
- 1 - 15/16" Wrench

This page is for reference use only.  
All items shown full size unless otherwise specified.

**Tip:** Several steps in this manual may require the assistance of another individual.

**Hardware Bag (Part No. Z-1258-5)**

**11**  
(1) 3/8"x1" Carriage Bolt



**12**  
(4) 5/16"x1" Hex Head Bolt

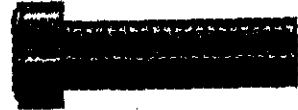

**13**  
(8) 3/8"x1" Hex Head Bolt



**14**  
(2) 3/8"x1-1/4" Hex Head Bolt



**15**  
(4) 5/16" Hex Nut



**16**  
(3) 3/8" Hex Nut



**17**  
(1) 3/8" Hex Jam Nut



**18**  
(3) 5/8" Hex Jam Nut



**19**  
(4) 5/16" Medium Lock Washer

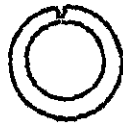

**22**  
(2) 5/8"x3" Hex Head Bolt



**25**  
(1) Adjustment Bolt

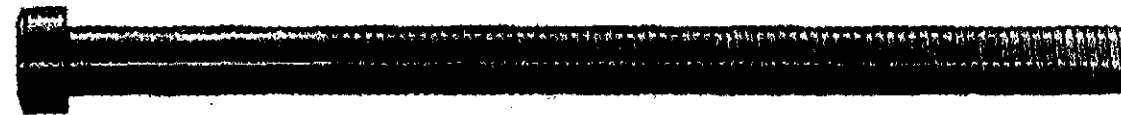

**23**  
(1) Spring Assist Bracket

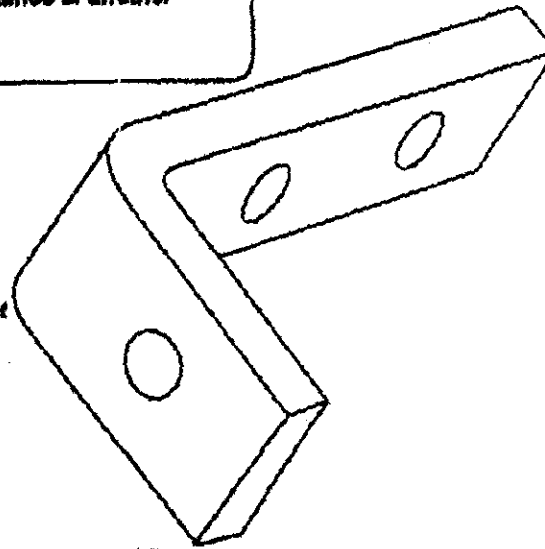

**20**  
(8) 3/8" Lock Washer



**21**  
(1) 1/2" Plain Washer



**26**  
(3) 3/8" Heavy Washer

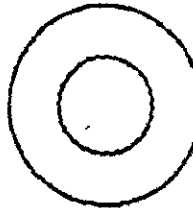

**24**  
(1) 3/8"x1-1/8" Clevis Pin

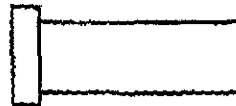

# HARDWARE REFERENCE

## Hardware Bag (Part No. Z-1258-4)

1  
(1) Hitch Pin  
NTS

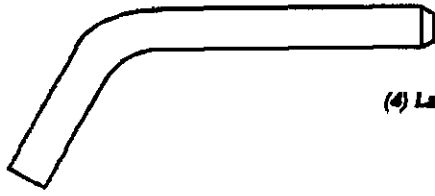

8  
(4) Large Retaining Spring

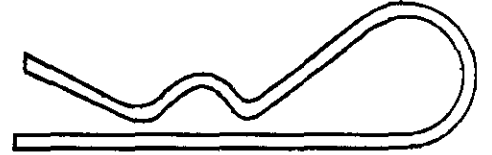

2  
(2) 5/8"x1-1/2" Clevis Pin

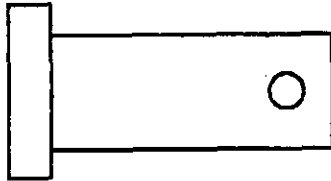

9  
(2) Small Retaining Spring

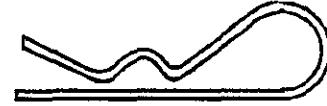

3  
(1) 1/2"x1-1/4" Clevis Pin



10  
(2) Drawbar Bracket  
NTS

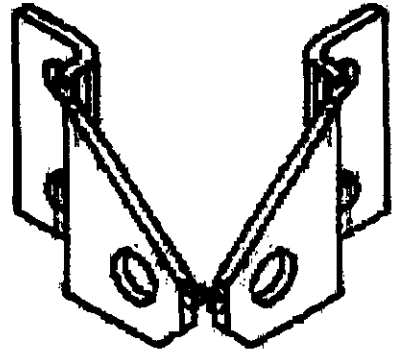

4  
(2) Pivot Bracket  
NTS

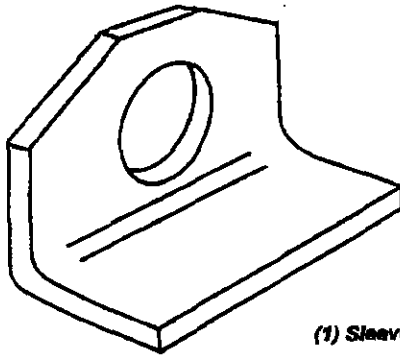

7  
(1) Sleeve Adjustment Link

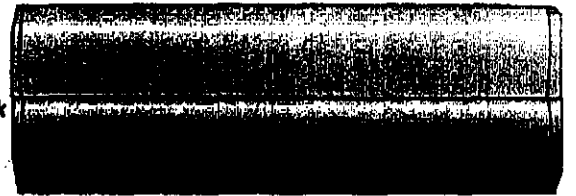

5  
(1) Upper Lift Link

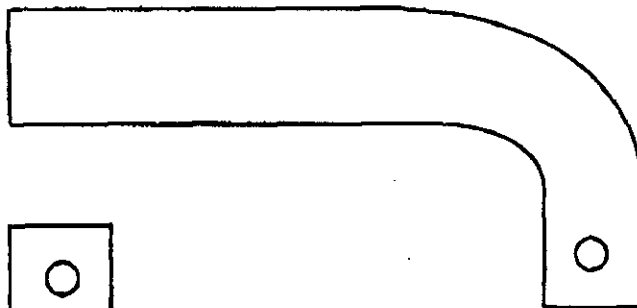

6  
(1) Lower Lift Link

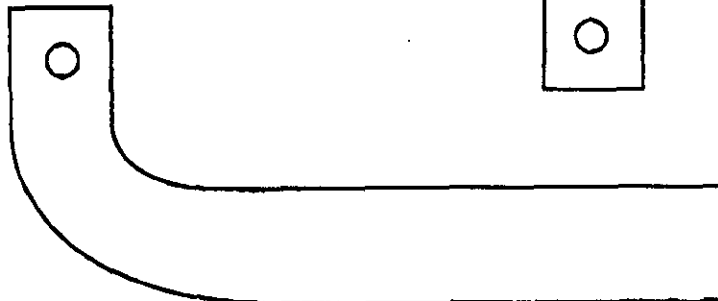

**Parts Reference**

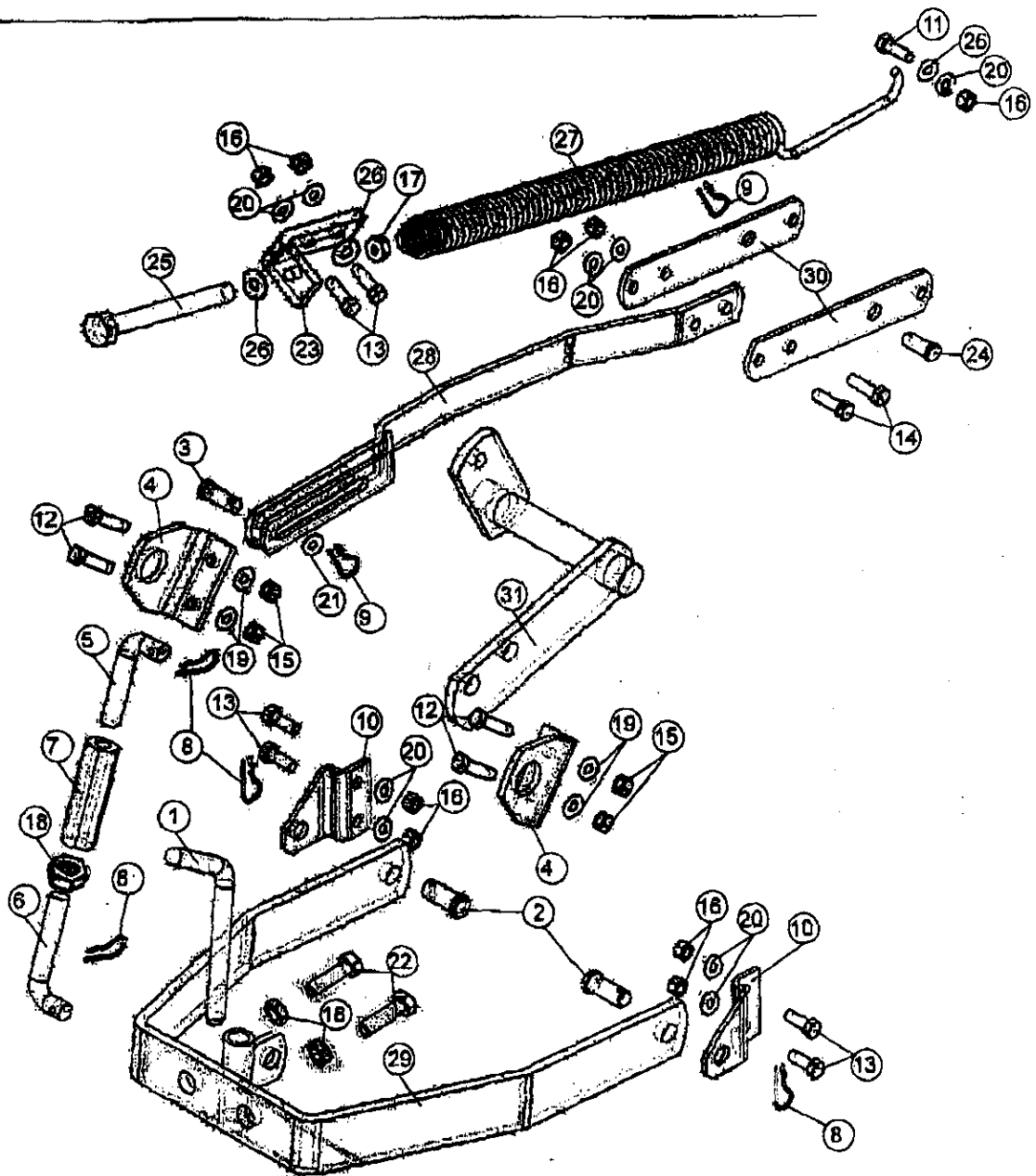

**Parts List**

REF. NO.	PART NO.	DESCRIPTION	QTY.	REF. NO.	PART NO.	DESCRIPTION	QTY.
* 1	H-130P-01	Hitch Pin	1	** 17	31M1200P	3/8" Hex Jamb Nut	1
* 2	H-522	5/8" x 1-1/2" Clevis Pin	2	** 18	31M2000P	5/8" Hex Jamb Nut	3
* 3	V-219P	1/2" x 1-1/4" Clevis Pin	1	** 19	40M1000P	5/16" Medium Lock Washer	4
* 4	H-525-10	Pivot Bracket	2	** 20	40M1200P	3/8" Lock Washer	9
* 5	H-526-01	Upper Lift Link	1	** 21	45M1717P	1/2" Plain Washer	1
* 6	H-527-01	Lower Lift Link	1	** 22	H-560	5/8" x 3" Hex Head Bolt	2
* 7	H-528-01	Sleeve Adjustment Link	1	** 23	H-582-10	Spring Assist Bracket	1
* 8	H-529	Large Retaining Spring	4	** 24	H-709	3/8" x 1-1/8" Clevis Pin	1
* 9	H-530	Small Retaining Spring	2	** 25	H-783	Adjustment Bolt	1
* 10	H-532RL-10	Drawbar Brackets (RH/LH)	1***	** 26	H-784	3/8" Heavy Washer	3
** 11	11M1216P	3/8" x 1" Carriage Bolt	1	** 27	H-584-10	Lift Assist Spring Assembly	1
** 12	1M1016P	5/16" x 1" Hex Head Bolt	4	** 28	H-721-10	Lift Bar Assembly	1
** 13	2M1216P	3/8" x 1" Hex Head Bolt	6	** 29	H-788-SR	Hitch Ball w/label	1
** 14	2M1220P	3/8" x 1-1/4" Hex Head Bolt	2	** 30	H-720-10	Extension Strap	2
** 15	30M1000P	5/16" Hex Nut	4	** 31	H-786-10	Lift Arm Assembly	1
** 16	30M1200P	3/8" Hex Nut	8				

\* - Hardware Bag (Z-1258-4)

\*\* - Hardware Bag (Z-1258-5)

\*\*\* - This bracket is divided into two parts forming a LH & RH part.

## FRONT FRAME & LIFT ASSEMBLY

Figure 1.

### BEFORE PROCEEDING!!!

1. Mower Deck must be removed from Tractor.
2. Tractor Height Adjustment Knob must be lowered completely. Adjust counterclockwise as far as possible (see Fig. 1).
3. Lower the Lift Mechanism completely (Mechanical or Electric).
4. Remove Plastic Access Cover (part # 121749X) from the Left Side of Tractor Frame.(see Fig. 3)

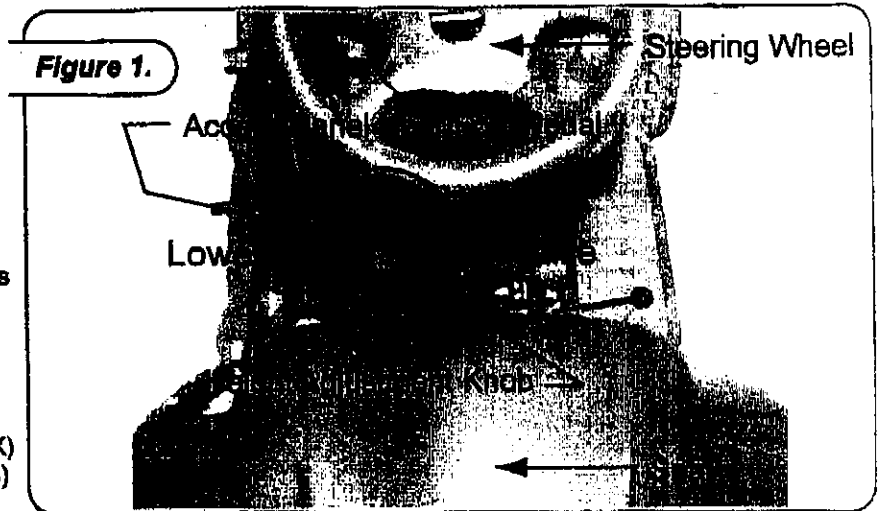

Figure 2.

5. Remove the Hex Bolt securing the top of the Tractor Fuel Tank Bracket to the frame on the left-hand side.
6. Install the Lift Assist Bracket(23) over the fuel tank bracket as shown. *The Lift Assist Bracket assembles to the outside of the frame, with the short leg through the opening in frame. Secure using two 3/8"x1" Hex Bolts(13-MUST BE INSTALLED FROM INSIDE TO OUTSIDE), Lock Washers(20), Hex Nuts(16), and a 3/8" Washer(26) between the the Lift Assist Bracket and the fuel tank bracket in the FORWARD HOLE ONLY! Tighten Securely.*
7. Make sure the fuel tank Hex Bolt previously removed is tightened securely.

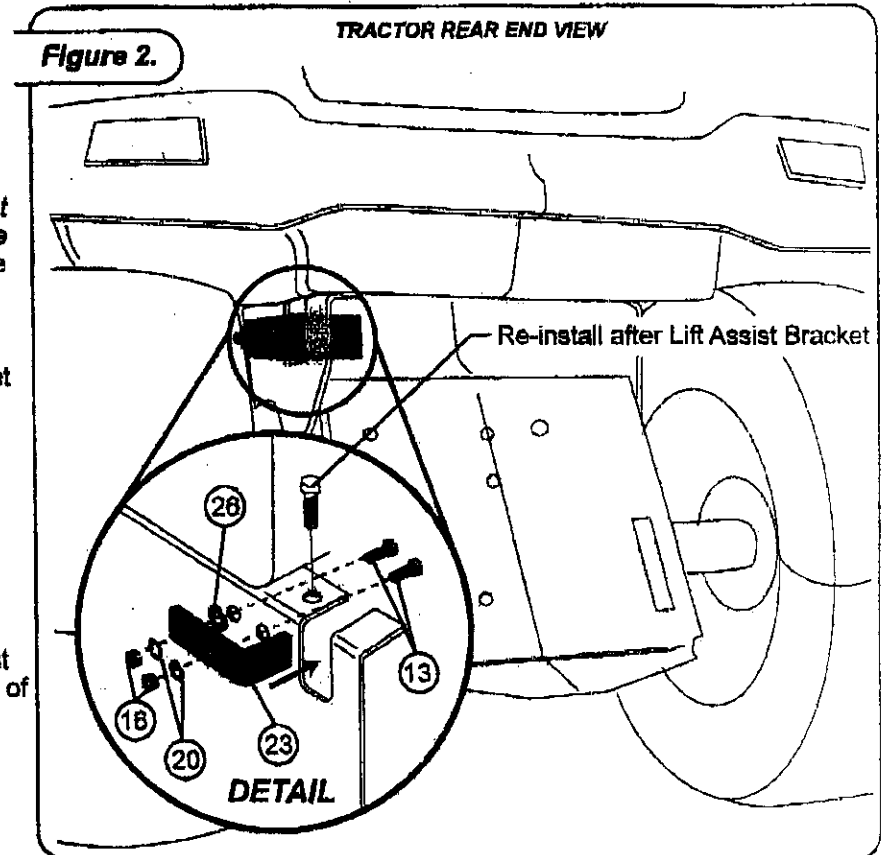
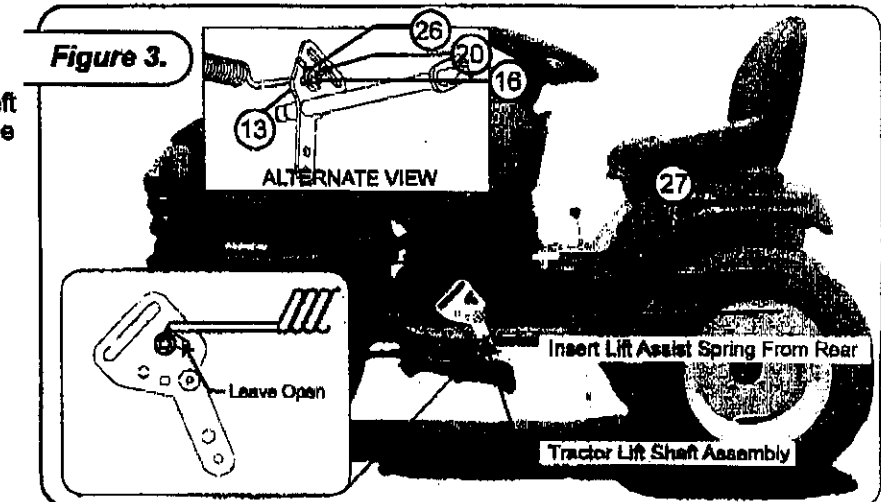

Figure 3.

8. From the rear of the tractor, feed the Lift Assist Spring(27- hook end first) along the inside left of the Tractor frame, just below the fuel tank.
9. Locate the Tractor Lift Shaft Assembly.
10. Insert the the "hook-end" of the Lift Assist Spring(27) into the "T"-shaped hole in the Lift Shaft Assembly as shown.

NOTE: Lift Assist Spring(27) and Bolt can be easily accessed through Access opening at left side of Tractor. Simply remove cover on frame to access if not already removed from Step 4.

11. As shown, secure the Lift Assist Spring(27) in the top-right of the "T"-shaped hole using a 3/8"x1" Carriage Bolt(11), 3/8" Washer(26), Lock Washer(20), and Hex Nut(16).



## HITCH BAIL ASSEMBLY

Figure 4.

12. Install a 3/8" Washer(26) on the long 3/8" Hex Bolt(25) and insert through hole in the Lift Assist Bracket(23) that was previously installed.
13. Thread a 3/8" Hex Jam Nut(17) on the end of the Bolt approximately 1/2".
14. Thread the Bolt at least 1/2" into threaded portion of Lift Assist Spring. Tighten Jam Nut(17) against Lift Assist Spring.

NOTE: Have someone operate the Tractor Lift Handle while someone checks to make sure the Lift Assist Spring clears all moving parts and fuel tank during operation. Failure to clear moving parts will result in damage to Tractor during operation.

15. Re-install the plastic access cover previously removed in step 4.

Figure 5.

16. Break the "R" and "L" Drawbar Brackets(10) apart.
17. From Rear of Tractor, assemble the "R" Bracket to the RIGHT SIDE, and the "L" Bracket to the LEFT SIDE respectively, secure using four 3/8" x 1" Hex Bolts(13), Lock Washers(20), and Hex Nuts(16). Finger tighten.
18. Position Hitch Bail Assembly(29) between Tractor frame and Drawbar Brackets(10) previously installed. Secure with two 5/8"x1-1/2" Clevis Pins(2) and Large Retaining Spring(8).

NOTE: Long extension of welded tube of Hitch Bail must be positioned UP as shown.

19. Tighten four 3/8" x 1" Hex Bolts(13) attaching Drawbar Brackets.
20. Screw a 5/8" Hex Jam Nut(18) on the two 5/8"x3" Hex Bolts(22). Assemble these through welded nuts on Hitch Bail Assembly, from inside out. Screw in until flush with outside of Hitch Bail Assembly(29) as shown. Tighten Jam Nuts(18) securely against Hitch Bail(29).
21. Insert Hitch Pin(1) through Hitch Tube in Hitch Bail Assembly.

Figure 4.

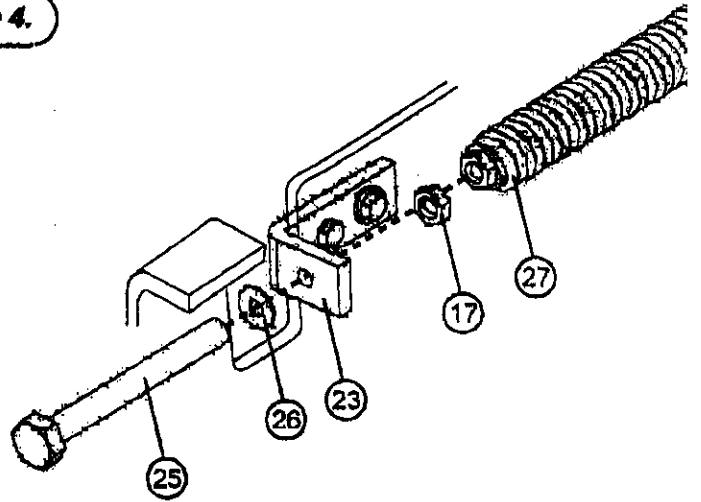
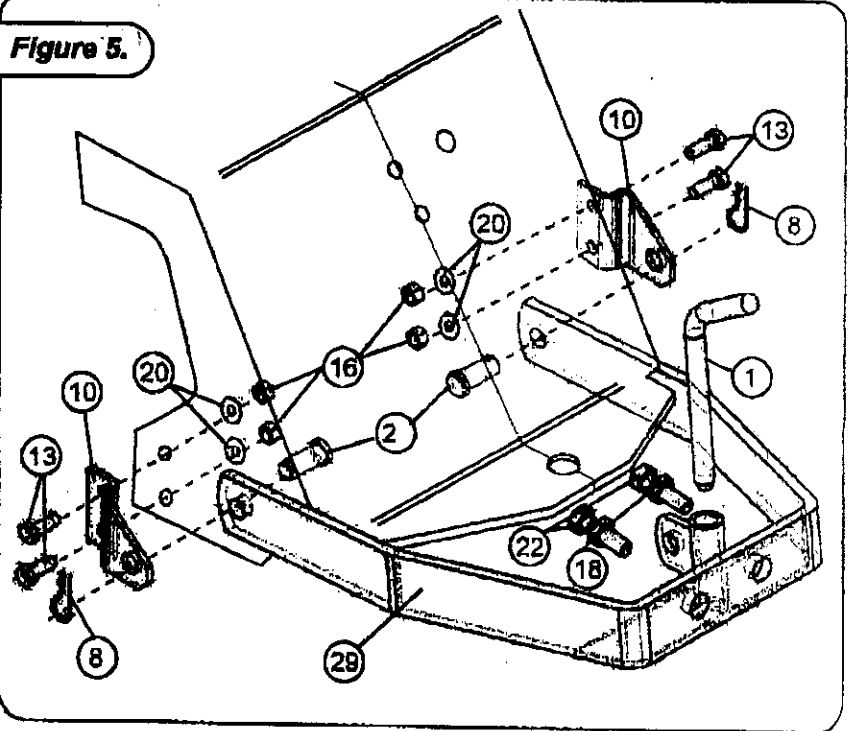

Figure 5.



## LIFT BAR AND EXTENSION STRAPS

Figure 6.

NOTE: Extension Straps(30) are used with Mechanical Lift Tractors(having lift handles) only and will not be used when mounting to Tractors using Electric Lift Accessories.

### MECHANICAL LIFT TRACTORS

22. Assemble the two Extension Straps(30) to the Lift Bar Assembly(28) using two 3/8"x 1-1/4" Hex Bolts(14), Lock Washers(20), and Hex Nuts(16).

NOTE: . Make sure the holes in the opposite end of Straps are in line, then tighten securely.

Figure 6.

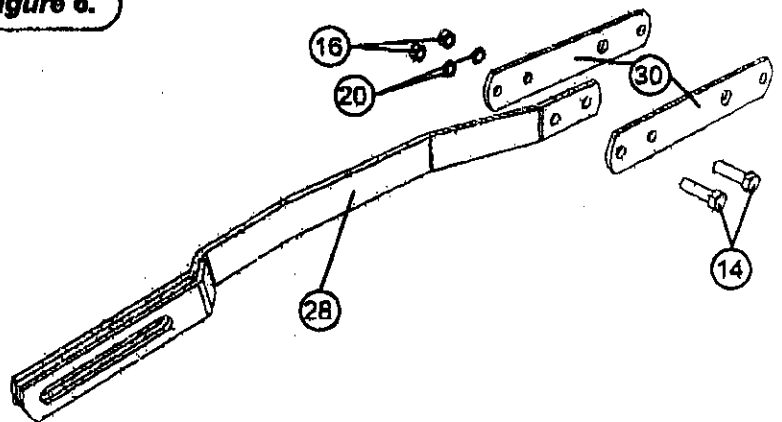

Figure 7.

23. From RIGHT side of Tractor, locate the Tractor Lift Shaft Assembly under the Tractor Frame.
24. Position the Lift Bar Assembly(28), with Extension Straps(30), along inside of Tractor Frame with welded end towards rear of Tractor. Slide welded end through cutout in upper left side of Drawbar as shown.
25. Position Extension Straps(30) over Tractor Lift Shaft Assembly Arm(at LEFT side of Tractor), aligning end holes to Straps(30) with bottom hole in Lift Arm. Secure using 3/8"x 1-1/8" Clevis Pin(24), and Small Retaining Spring(9).

### ELECTRIC LIFT TRACTORS

NOTE: This mounting will not require the use of Extension Straps(30).

26. Position the Lift Bar Assembly along inside of Tractor Frame with welded end towards the rear of Tractor. Slide welded end through cutout in the upper left side of Drawbar as shown.
27. NOT SHOWN!: Please refer to the Electric Lift Manual if needed. Position end of Lift Bar Assembly(28) between opening of Electric Lift double straps. Align holes and secure using 3/8"x 1-1/8" Clevis Pin(24) and Small Retaining Spring(9).

Figure 7.

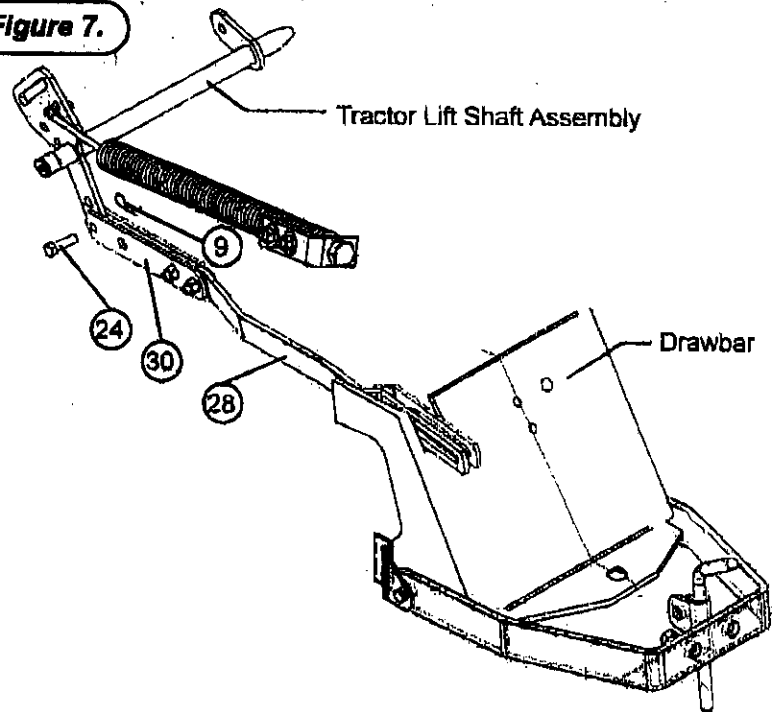



## LIFT ARM/TURNBUCKLE ASSEMBLY

Figure 8.

28. Assemble the first Pivot Bracket(4) with the short leg towards the center of the Tractor Drawbar and to the far left side using two 5/16" x 1" Hex Bolts(12), Lock Washers(19) and Hex Nuts(15). Tighten securely.

Figure 9.

29. Place Lift Arm Assembly(31) inside hole of Pivot Bracket(4) as shown in Fig 9. Note that that longer arm on the Pivot Bracket will be to the right or more towards the center of the tractor.
30. Assemble the other Pivot Bracket(4) with short leg facing towards the left side of the Drawbar using two 5/16" x 1" Hex Bolts(12), Lock Washers(19) and Hex Nuts(15). Tighten securely.
31. Connect previously assembled Lift Bar Assembly(28) to short arm on Lift Arm Assembly(31) using 1/2" diameter x 1-1/4" Clevis Pin(3), Plain Washer(21), and small Retaining Spring(9).
32. Thread a 5/8" Hex Jam Nut(18) onto the longer right hand threaded Lower Lift Link(6), as far as possible.
33. Assemble Lower Lift Link Assembly(6-step 32) into the right hand threaded end of Sleeve Adjustment Link(7) as far as possible.
34. Thread the shorter, (left hand threaded) Upper Lift Link(5) into other end of Sleeve Adjustment Link(7)(screws in counter-clockwise) as far as possible.
35. Attach the completed Turnbuckle Assembly to the upper adjusting hole in the Lift Arm Assembly(31) and the welded tab in Hitch Ball Assembly(29). Secure each end with a small Retaining Spring(9). Tighten the Jam Nut(18) against Sleeve Adjustment Link(7).
36. Make sure all Bolts and Nuts previously assembled are tight.

Figure 8.

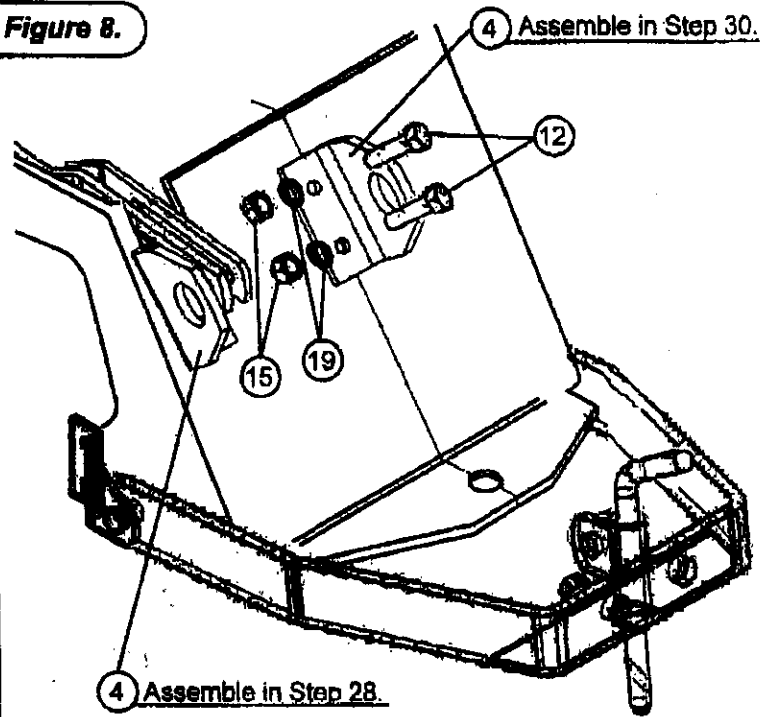
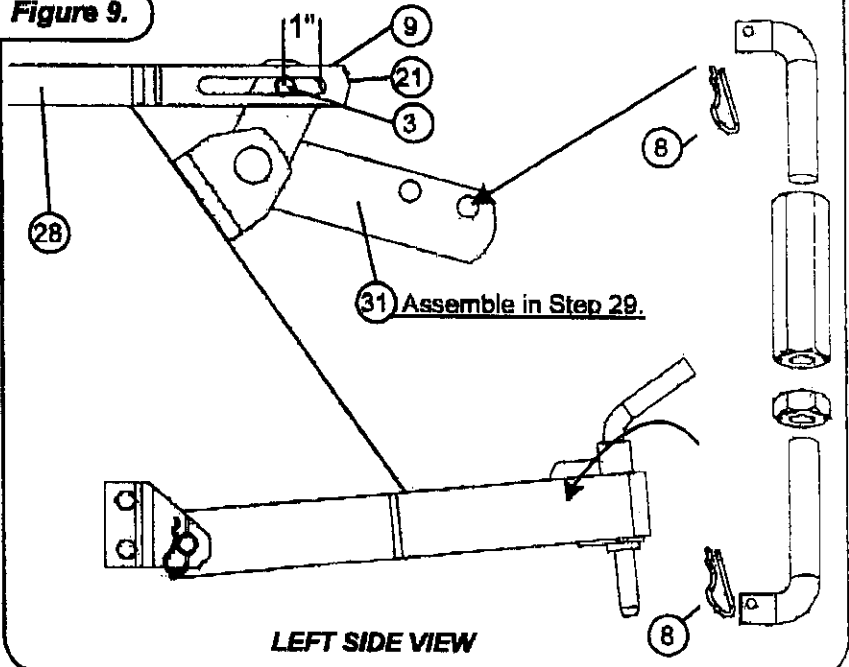

Figure 9.



## **ADJUSTMENTS**

Always make adjustments with Attachment installed, prior to using it. Additional Attachment Adjustments may also be required. See the Attachment Instruction Manual.

### **STABILIZER ADJUSTMENT**

Stabilizing an Attachment is removing all side-to-side movement. Do Not Stabilize the Plow or Disk Harrow. Stabilize all other Attachments.

- Turn both 5/8" x 3" Stabilizer Bolts(22) clockwise and equally against Yoke of Attachment. Lock the Stabilizer Bolts in place with Hex Jam Nuts.
- Loosen Stabilizer Bolts to remove Attachment from Hitch.

### **LIFT EFFORT ADJUSTMENT**

The Lift Spring aids in lifting the Attachment into Transport position. Due to different attachment weights, the Lift Spring may require adjustments. The Adjusting Bolt (25, Fig 4) is located at the upper left side of Tractor Drawbar Bracket.

- Lift effort is adjusted by increasing or reducing spring tension on the lift assist spring(27).
- Do not adjust to maximum spring tension when using lighter weight attachments.
- Do not overpower spring when removing attachments.
- Always lock Tractor Lift Handle DOWN when removing attachments.

### **LIFT ASSIST SET-UP FOLLOWING FOR AN ATTACHEMENT (see Fig 2):**

- Raise the Tractor Lift Handle to the Transport (up) position in order to adjust the Assist Spring tension.
- Loosen the Hex Jam Nut (17) against the Assist Spring (27).
- Turn the Adjusting Bolt (25) CLOCKWISE until the Washer (26) is against the Lift Assist Bracket (23). This will reduce lift effort. Re-tighten Hex Jam Nut (17).
- Use the Hitch with Turnbuckle Link in the UPPER HOLE in Lift Arm Assembly for most conditions. If Assist Spring adjustment does not result in acceptable lift effort, move the Turnbuckle link to the LOWER HOLE in the Lift Arm Assembly.

### **TURNBUCKLE ADJUSTMENT (see Fig 11):**

The Adjustable Turnbuckle can be lengthened or shortened to control Transport Height of Attachment.

- Always adjust Turnbuckle Assembly with Tractor Lift Handle locked in LOWERED position.
- At no time should the Turnbuckle Assembly be adjusted beyond 9-1/4" from end to end.
- Lower the Tractor Lift Handle and lock into lowered position. You may need to lower the " Attachment Depth Control" on your Tractor to do this.
- Mount the Attachment to the Sleeve Hitch using the Hitch Pin (1).
- With Attachment on ground, adjust Turnbuckle to give approximately 1" of distance between end of slot in Lift Bar Assembly (28) and Clevis Pin (3) (see Fig. 9) This will allow proper penetration depth of Attachment.

### **MOWER USE (see Fig 2):**

- The tension on Assist Spring(27) must be removed when operating Mower Deck.
- To remove tension, Lower Tractor Lift Handle to locked position, loosen Hex Bolt(25) until Washer(26) is loose against Lift Assist Bracket (23). With this adjustment, there will be no tension on the spring.

## **OPERATION**

- The Attachment Clutch Switch on Dash of Tractor (device that engages Tractor Mower) needs to be **ENGAGED** at all times while operating Tractor. This actuates the Operators Sensing Device in the Tractor seat. The Tractor Engine will stop in case you dismount or fall off Tractor. Failure to actuate this device can cause personal injury or damage to your Tractor and Property if you were to fall off. **SWITCH MUST BE DISENGAGED IN ORDER TO RESTART ENGINE!**
- The Mower Deck must be removed when using Sleeve Hitch Attachments. The Hitch may remain on Tractor when using Mower.
- Remove Hitch Ball and Turnbuckle Assembly when using Towed Attachments on Tractor Drawbar.
- Attachments are raised and lowered using Mower Lift Handle at right side of Tractor (or Electric Lift Switch if equipped). Pull back on Handle and Lock into Transport Lock Notch. To operate Attachment, lower the Handle and push forward and lock into lowered position Lock Notch. Make sure Handle is locked in this position so Attachment is not pulled up by Assist Spring.
- Turn the Height Adjustment Knob on Tractor counter-clockwise all the way. Failure to do so could affect operation of Hitch.
- Lift the Attachment out of ground when making turns or reversing.

For repair of major brand appliances in your own home...  
no matter who made it, no matter who sold it!

**1-800-4-MY-HOME<sup>SM</sup>** Anytime, day or night  
(1-800-469-4663)

[www.sears.com](http://www.sears.com)

To bring in products such as vacuums,  
lawn equipment and electronics for repair, call for  
the location of your nearest **Sears Parts & Repair Center.**

**1-800-488-1222** Anytime, day or night

[www.sears.com](http://www.sears.com)

For the replacement parts, accessories and owner's manuals  
that you need to do-it-yourself, call **Sears PartsDirect<sup>SM</sup>!**

**1-800-366-PART** 6 a.m. - 11 p.m. CST  
(1-800-366-7278) 7 days a week

[www.sears.com/partsdirect](http://www.sears.com/partsdirect)

To purchase or inquire about a Sears Service Agreement:

**1-800-827-6655**

7 a.m. - 5 p.m. CST, Mon. - Sat.

Para pedir servicio de reparacion a domicilio,  
y para ordenar piezas con entrega a domicilio:

**1-888-SU-HOGAR<sup>SM</sup>**  
(1-888-784-8427)

Au Canada pour service en francais:

**1-877-LE-FOYER<sup>SM</sup>**  
(1-877-533-6937)

**SEARS**  
HomeCentral