

Very Dazzle

radio control series

ITEM NO.2006B

Preparation:

1. Turn the lock that under the base for 90°, and take out the controller and antenna.

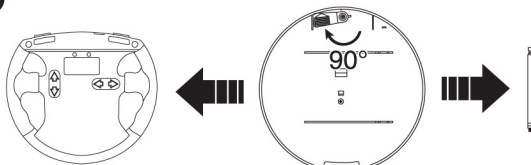

2. Rip off the paster, pull up the clear cover by the direction of arrow.

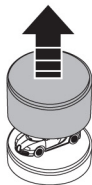

3. Use a pheels screwdriver to remove a screw on the base back by the counter-clockwise, under this circumstances, you will be gets a delicate racing car.

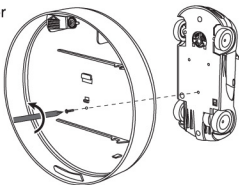

4. Insert the antenna into the hole at the top of the controller, and tighten it.



5. Remove the battery cover, insert 4X"AA" batteries with the correct polarity and replace the battery cover.

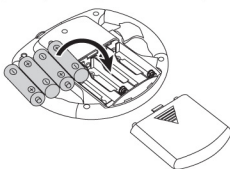

Charge:

Open the charging cover of controller, plug out the charging jack, and aim at the charging outlet of the R/C car, the charging indicator light will light up. And then, the charging indicator light will go off automatically after about 5 minutes passed, it means that R/C car is fully recharged.

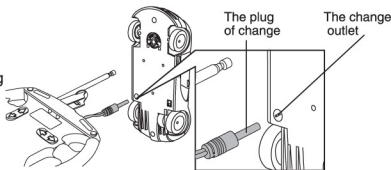

Operation:

1. Extend the transmitter antenna when in use; Slide the power switch of the car to "ON" position. Place the racing car on the flat place.

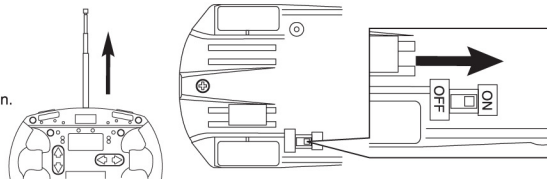

2. Controller button function:

- (1) Press the controller button, the indicator light on the controller will light up follows you press the controller button. (Press any button on the controller, the controller function indicator light will light up).
- (2) When pressing the forward/backward button, the racing car will go forward/backward, meanwhile, the front/rear light will light up.
- (3) When pressing the forward/backward button, and also press down the turn left/right button, the racing car will turn left/right.
- (4) Press the speedup button while forward, the racing car will speed up; The racing car will speed down automatically while press the left/right button, this safety feature will result in the reduction of accidents.
- (5) For easy operation, there are two speedup buttons on the controller, one on the left and one on the right. Press any speedup buttons, the racing car will speedup forward.

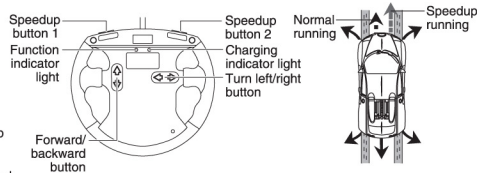

3. The directional guide on the bottom of the car can be used to adjust the car's straight-line-running performance.

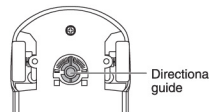

Caution:

o) This device complies with Industry Canada licence-exempt RSS standard(s). Operation is subject to the following two conditions: (1) this device may not cause interference, and (2) this device must accept any interference, including interference that may cause undesired operation of the device.

- a). Do not touch the antenna during operating, or the controlled distance may be affected; The antenna breaks to need adult is processing.
- b). This racing car has strong driving force, when it is high speed running that cannot suddenly stop as a result of the inertia, please use carefully.
- c). If the car becomes apparently slower during operation, it might due to insufficient power, please charge the car follow the illustration.
- d). The car should decelerate when turning rapidly or reversing, or the car may turn over.
- e). Replace the new batteries of the controller if they lack of power, the car can't be charge the indicator lamp turns dim.
- f). Pay attention to the plug of charge & the charge position when charging.
- g). Please remove the battery of the controller and turn the power of racing car switch to "OFF" position when it is not used for a long time.
- h). Non rechargeable batteries are not to be recharged.
- i). Old and new batteries or different types of batteries are not to be mixed.
- j). Batteries are to be inserted with the correct polarity, avoid install of mistake.
- k). Do not short circuit the batteries terminals.
- l). Remove the packing under adult supervision.
- m). Please retain the above information for future reference.

n) This device complies with RSS-310 of Industry Canada. Operation is subject to the condition that this device does not cause harmful interference.