

User Guide of 2.4 GHz Ball Sensor

Model: TPM201

NCC 警語

取得審驗證明之低功率射頻器材，非經核准，公司、商號或使用者均不得擅自變更頻率、加大功率或變更原設計之特性及功能。

低功率射頻器材之使用不得影響飛航安全及干擾合法通信；經發現有干擾現象時，應立即停用，並改善至無干擾時方得繼續使用。

前述合法通信，指依電信管理法規定作業之無線電通信。

低功率射頻器材須忍受合法通信或工業、科學及醫療用電波輻射性電機設備之干擾。

Federal Communications Commission (FCC) Statement

You are cautioned that changes or modifications not expressly approved by the part responsible for compliance could void the user's authority to operate the equipment.

This equipment has been tested and found to comply with the limits for a Class B digital device, pursuant to part 15 of the FCC rules. These limits are designed to provide reasonable protection against harmful interference in a residential installation. This equipment generates, uses and can radiate radio frequency energy and, if not installed and used in accordance with the instructions, may cause harmful interference to radio communications. However, there is no guarantee that interference will not occur in a particular installation. If this equipment does cause harmful interference to radio or television reception, which can be determined by turning the equipment off and on, the user is encouraged to try to correct the interference by one or more of the following measures:

- Reorient or relocate the receiving antenna.
- Increase the separation between the equipment and receiver.
- Connect the equipment into an outlet on a circuit different from that to which the receiver is connected.
- Consult the dealer or an experienced radio/TV technician for help.

For product available in the USA/Canada market, only channel 1~11 can be operated. Selection of other channels is not possible.

Operations in the 5.15-5.25GHz band are restricted to indoor usage only.

This device meets all the other requirements specified in Part 15E, Section

15.407 of the FCC Rules.

This device complies with Part 15 of the FCC Rules. Operation is subject to the following two conditions:

- 1) this device may not cause harmful interference, and
- 2) this device must accept any interference received, including interference that may cause undesired operation of the device.

FCC RF Radiation Exposure Statement:

This equipment complies with FCC radiation exposure limits set forth for an uncontrolled environment. This equipment should be installed and operated with minimum distance 20cm between the radiator & your body. This transmitter must not be co-located or operating in conjunction with any other antenna or transmitter.

Caution

1. This sensor can be used in truck and bus tubeless tires only (rim diameter $\geq 22.5''$).
2. The vehicle speed must not exceed 120 km/h (75 mph).

Installation

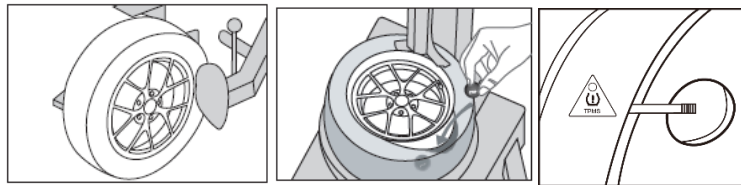

For 2.4 GHz type

1. Dismount the tire from the rim. If applicable, take out any existing TPMS sensors.
2. Use the Cub Retrofit truck tool to program the correct wheel position ID to the sensor, then throw it into the corresponding tire.
3. Write the wheel position ID on the label (contained in the 20-pcs package box) and paste it on the outside of the rim, near the valve, as an indicator of the presence of a sensor in the wheel and of the wheel position ID.

Warranty

The driver must obey the speed limit and allowable load according to local regulations; if not, the TPMS sensor may malfunction and the product warranty will not be valid.

CUB warrants that the TPMS sensor shall be free from defects in workmanship and material during warranty period. CUB does not assume any liability in case of faulty, incorrect installation of the product, or by using other products causing TPMS sensor malfunction on the part of customer or user.



www.cubelec.com.tw