

封面

258mm

86mm

344mm

canjice

A864

Bluetooth Headset

Manual

Wear Method

Step1: Choose the suitable ear cushions.



Step2: Wear it in the ear and adjust to a comfortable position (please note the left and right earbuds).



Incoming call

Earbuds answer: Press the multifunction button once.



Earbuds hangs up: Press the multifunction button once when calls.

Earbuds refused to answer the call: Long press the multifunction button for 2 seconds.

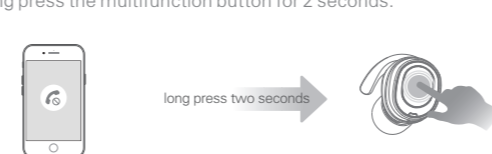

Start

Packing list

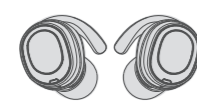

Earbuds x1

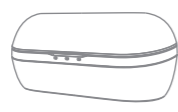

Charging Box x1



Ear cushions x3



USB cable x1



Manual/Warranty card

Power On

Method 1

Pick up automatic start from the charging box, Stays on white 2 seconds.

Pick up automatic start from the charging box, Stays on white 2 seconds.

Method 2

Long press the multifunction button for about 3 seconds in off state, Stays on white 2 seconds.



Volume " ± "

Volume" + "

In play or call, double-tap the L earbuds multifunction button.

Note: This function is not supported when L/R headphones are used alone.

Volume" - "

During play or call, click R Headset Multifunction button twice.

Note: This function is not supported when L/R headphones are used alone.

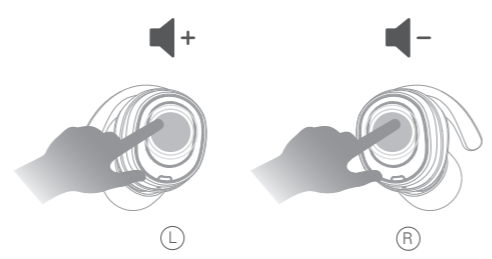

Product overview

- 1. Charging box LED light
2. USB
3. Multifunction button
4. Earbuds light
5. Talking mic
6. Magnetic charge point
7. Breathable hole
8. L/R logo

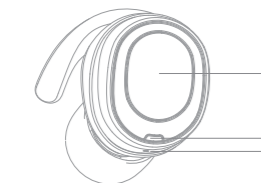
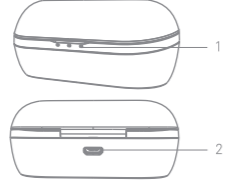

Pairing

Mobile phones and earbuds

Turn on the left and right earbuds respectively. After the two are automatically connected back, the right earbuds will automatically enter the pairing state.

Attention: 1. right earbuds as main earbuds. 2.If the two fail to connect back, the right earbuds will not enter the pairing state and need to be operated again.

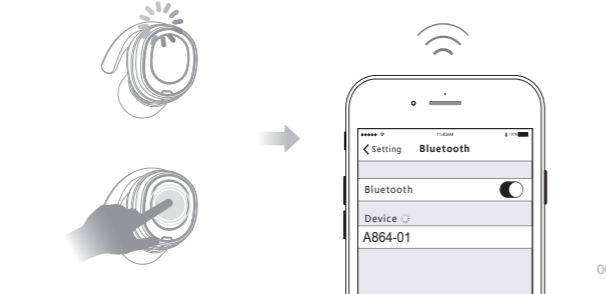

Music

Pause

In playback mode, click the R/L earbuds multi-function button once.

Play

In the pause state, click the R/L earbuds multi-function button once.

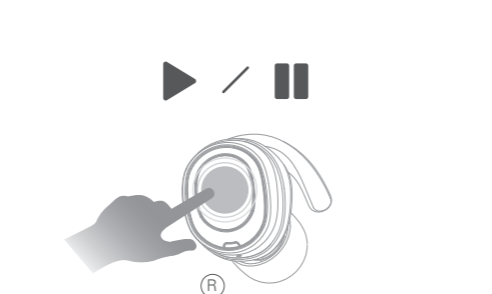

Specification

- 1. Bluetooth version: Bluetooth V5.0
2. Rated input: 5.0V ---500mA
3. Frequency Range: 20Hz-20KHz
4. Effective wireless range: 10m
5. Charging time: 1.5h
6. Nominal impedance: 32 Ω ± 15%
7. Support protocols: HSP、HFP、A2DP、AVRCP
8. Play time: 3.5h (earbuds) +12h (charging box)
9. Drive unit: 8mm dynamic speaker
10. Sensitivity (SPL) : 98 ± 3dB/mW (IEC-711 at 1KHz)
11. Product performance standards : GB 4943.1-2011

Connection lost

Situation 1: Bluetooth off

Turn off the player device phone Bluetooth Reconnection timeout for 5 minutes, the earbuds automatically Power Off.

Situation2: Out of connection distance

The mobile phone and the earbuds connection is beyond the scope effectively reconnection timeout for 5 minutes, the earbuds automatically Power Off.

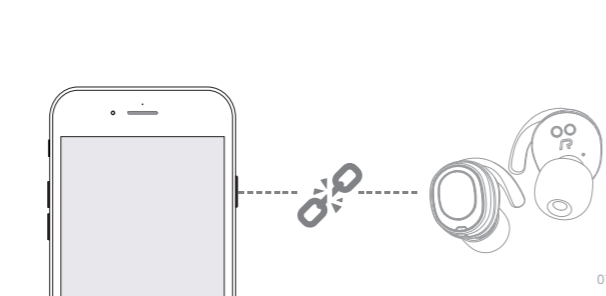

Track forward

In playback mode, long press the L earbuds multifunction button.

Note: This function is not supported when L/R earbuds are used alone.

Track backward

In the playing state, long press the R earbuds multifunction key

Note: This function is not supported when L/R earbuds are used alone.

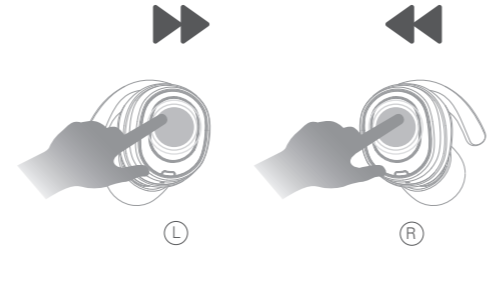

Monaural Use And Recovery

Monaural use

- 1. Take out one of the earbuds from the charging box and long press the multifunction button for 5 seconds until the earbuds lights up blue (power off).
2. Long press the multifunction button for 5 seconds until the blue and white lights flash alternately.
3. Open the phone Bluetooth search 'A864-01', click on the link to complete the monaural use.

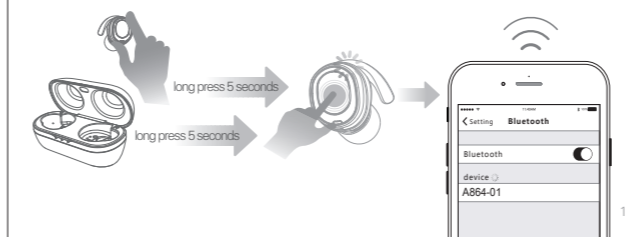

Charging box charging

LED status when charge the charging box: When the power is below 30%, the first light flashes; When the power is 30%-70%, the first light is always on, and the second light flashes; When the power is greater than 70%, the front 2 lights are always on, and the 3rd light flashing; When the power is 100%, 3 lights are always on.

Charging box electricity LED status when not charging: When the power is below 10%, the first light flashes; When the power is 10%-30%, the first light flashes; When the power is 30%-70%, the front 2 lights are on; When power is 70%-100%, 3 lights are always on.

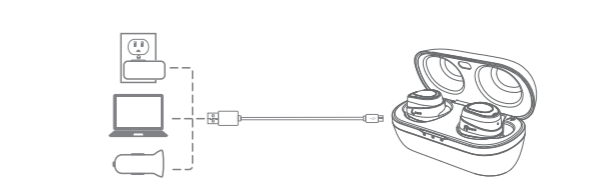

canjice

WARRANTY SERVICE CARD

www.canjice.com

Restoring left and right ear links

- 1. Put the separately paired earbuds into the charging box.
2. At the same time, take the left and right earbuds out of the charging box and they will be automatically paired into the pairing mode.
3. Open the phone to search for 'A864-01', click on the link to complete the use of left and right ear stereo.

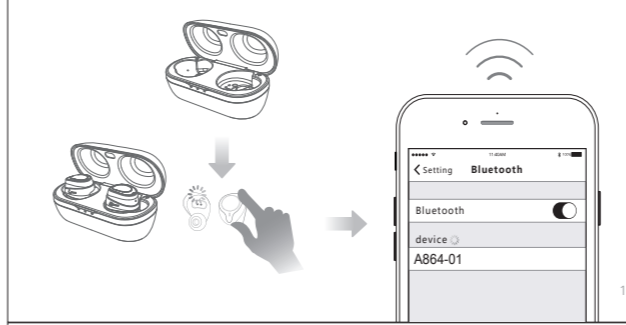

Safety and care

- 1. Using earbuds at high to moderate volumes for extended periods of time will result in permanent hearing damage. It is advised you keep volume levels moderate to low at all times for your safety.
2. Do not use while driving a car, cycling, operating machinery, or performing other activities that require hearing surrounding sounds.
3. Do not use earbuds in thunderstorm weather, the earbuds may not work properly in the condition, and increase the risk of being hit by lightning.
4. Earbuds may not work properly under high temperature or high humidity conditions.
5. Do not use any corrosive cleaner/oil to clean the earbuds.
6. Do not remove or modify the earbuds for any reason, as it may cause the head set to malfunction or burn out.
7. Keep the earbuds and packaging out of reach of children.
8. Do not dispose of this electronic design as normal waste when disposing of it. To reduce pollution and maximize the protection of the Earth's environment, recycle it.

Power Off

Method1

Put the earbuds into the charging box for automatic shutdown and the blue indicator lights up.



Method2

In the power on state, Long press the multifunction button for 5 seconds. The red indicator light will be on for 2 seconds

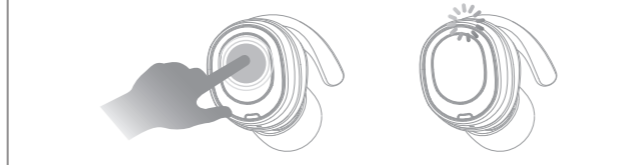

Battery warning!

- * Improper battery replacement can result in explosion hazard and can only be replaced with batteries of the same type or equivalent type.
* For batteries with removable batteries, batteries must be recycled or handled properly. Disassembly is not allowed for products that cannot be removed.
* Do not disassemble, strike, crush or put the battery into fire. Do not expose the battery to conductive materials, liquids, fire, or high temperatures.
* Do not allow metal objects to touch the two poles of the battery. Do not continue to use the battery if it has bulges, leaks, discoloration, odors, or any other abnormality.
* Do not use the battery after it has been immersed in water.
* If the battery is used improperly, it may explode or leak, causing burns and other personal injuries. If the battery leaks, it should be carefully disposed of according to the local laws and regulations concerning battery disposal.

Charging

Earbuds charging

put the earbuds into charging box

Charging: Stays on blue

Fully charged: Stays on white



LED status when the charging box charges the earbuds

The first light flashes when the L earbuds is charged; The third light flashes when the R earbuds is charged; When L and R are charged at the same time, the 1st and 3rd light flash at the same time; When the earbuds is full, the battery compartment will show the battery pack power for 5 seconds.

The name and content of harmful substances in the product

Table with columns: Components Name, Harmful Substance (Pb, Hg, Cd, Cr(VI), PBB, PBDE). Rows include Metal Component, Plastic Accessories, Plastic Components, Electric Cable, and Board Assembly.

This form is prepared in accordance with the provisions of SJ/T 11364.
O: Indicates that the content of the hazardous substance in all homogeneous materials of the part is below the limit requirement specified in GB/T 26572.
x: Indicates that the hazardous substance is at least in a homogeneous material of the part exceeding the limit requirement of GB/T 26572.
All parts marked "x" in the table comply with EU RoHS regulations (Directive 2011/65/EU).
Note: The environmental protection period depends on the temperature and humidity conditions of the normal working of the product.

The number in this logo indicates that the product has an environmental protection period of 10 years under normal use.
Depending on the model, the product may not include all of the above components.
Based on the actual sales configuration of the product.

According to the Chinese electronic industry standard SJ/T 11364 and related Chinese government regulations, this product and some of its internal or external components may carry an environmentally friendly service life mark, depending on the component and component manufacturer, the use of the product and its components. The term identifier may vary. The expiration date on the component takes precedence over any conflicting or different environmental use period identifiers on the product.

WARRANTY CARD

Dear users, this warranty card is an important certificate for applying for warranty service. Please fill in and keep it with the seller, thank you!

Warranty card form with fields for User Information (User Name, E-mail, Contact Address, Phone Number, Postal Code), Product Information (Product Name, Model Name, Product barcode), Dealer Information (Name, Address, Phone Number, Sales Date, Invoice Number, Postal Code), and Remarks.

1: This form is confirmed by the dealer stamp; 2: For products subject to the relevant warranty;

AFTER-SALES SERVICE

Dear users: Thank you for choosing Canjice products and services. For the products under this document, we will provide you with the following warranty and warranty services:

This document applies to individual product bodies (collectively referred to as 'products'). Other factory-configured parts, accessories and external equipment and other materials (collectively referred to as 'parts') and products or components not covered by this range (such as promotional items, gifts, and other factory-added parts) are warranted and warranted. Their separate warranty terms are enforced.

If the product is in normal use and maintenance conditions, performance failure due to material, process or manufacturing problems; during the warranty period, we will explain according to the provisions of this document. 'Normal use and maintenance conditions' means that the installation, use, maintenance, storage, transportation, etc. of the product meet the requirements of the instructions for use and for a reasonable purpose or use. 'Influencing normal use' means that the product does not perform the functions it should provide. We will not charge you for the warranty service unless you have previously stated or legally agreed to pay the fee. The above are all warranties for our product quality and service, and no other express or implied warranties. If the seller or any other third party has an additional commitment to you, you should fulfill the request to these third parties, and Koneixin is not responsible for it.

The corresponding warranty period of the product shall be counted from the date of first purchase of the product, and the date of purchase shall be based on the invoice date of the purchased product, and the service shall be guaranteed for one year. In the absence of a valid invoice, the warranty period will be calculated from the date of manufacture (label on the back or bottom of the product). In accordance with the notice, Koneixin's notice is executed in accordance with the notice. Products or parts that have been repaired or replaced within the scope of warranty will continue to be covered by the warranty for the remainder of the warranty period. The remaining warranty period is less than 3 months for 3 months, but for products with an initial warranty of less than 1 year, in the case, the remaining warranty period is less than 30 days and is calculated as 30 days. If the contract signed by Koneixin and you has otherwise provided for it, it shall be implemented as required.

NOTE

NOTE: This equipment has been tested and found to comply with the limits for a Class B digital device, pursuant to part 15 of the FCC Rules. These limits are designed to provide reasonable protection against harmful interference in a residential installation. This equipment generates uses and can radiate radio frequency energy and, if not installed and used in accordance with the instructions, may cause harmful interference to radio communications. However, there is no guarantee that interference will not occur in a particular installation. If this equipment does cause harmful interference to radio or television reception, which can be determined by turning the equipment off and on, the user is encouraged to try to correct the interference by one or more of the following measures:

- Reorient or relocate the receiving antenna.
- Increase the separation between the equipment and receiver.
- Connect the equipment into an outlet on a circuit different from that to which the receiver is connected.
- Consult the dealer or an experienced radio/TV technician for help.

Changes or modifications not expressly approved by the party responsible for compliance could void the user's warranty.

This device complies with Part 15 of the FCC Rules. Operation is subject to the following two conditions: (1) this device may not cause harmful interference, and (2) this device must accept any interference received, including interference that may cause undesired operation.

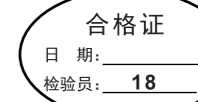

80g书纸, 344*258mm, 折叠

正面

背面