

Enable voice prompts: enter pairing mode: Press the volume "+" button for 3 seconds, the white LED lights flashes 3 times;

Disable voice prompts: enter pairing mode: Press the volume "-" button for 3 seconds, the red LED lights flashes 3 times.

Clear paired list

1. When the earphone is connected to the phone, then disconnected the phone, at the same time the earphone will enter into pairing mode.
2. Press volume "+" and volume "-" button at the same time until LED flashes blue, then LED flashes red and blue alternately, the paired list was cleared, the earphone will enter pairing mode after power on next time.

Hard reset

If the earphone can't power on even when fully charged, reset earphone as follows:

1. Press down multifunction button and connect earphone to the USB port of a PC or an USB power adaptor.
2. Continue to press and hold the multifunction button until earphone power on. The earphone is now reset.

Safety and care

Using earphone at high to moderate volumes for extended periods of time will result in permanent hearing damage. It is advised you keep volume levels moderate to low at all times for your safety.

Do not use while driving a car, cycling, operating machinery, or performing other activities that require hearing surrounding sounds.

Do not use earphone in thunderstorm weather, the earphone may not work properly in the condition, and increase the risk of being hit by lightning.

Earphone may not work properly under high temperature or high humidity conditions.

Do not use any corrosive cleaner/oil to clean the earphone.

If the earphone comes in contact with liquids, quickly wipe away. If submersed in water, do not turn the earphone on until completely dried. Tips: liquid submersion voids the warranty.

Keep the earphone and packaging out of reach of children.

canjice

W6 INSTRUCTION

Call

Answer a call

Press the Multifunction button or Volume "+" or Volume "-" once.

Reject a call

Press and hold the Multifunction button for about 2 seconds.

End a call

Press the Multifunction button once.

End current call and answer new call

When a new call rings during a call, press the Multifunction button once to answer new call and end current call simultaneously.

On hold current call and answer new call

When a new call rings during a call, Double the Multifunction button to hold current call and answer new call.

Reject the new call hold the current call

During the call there is a new call, press and hold the multifunction button for about 2 seconds to reject a new call, keeping the active call.

Mute on/off

Press the Volume "-" for about 2 seconds to mute on/off.

Switch between the earphone and phone

Press the multifunction button for about 2 seconds during a call, the call will be switched to the mobile phone, redo this operation again, the call will be switched to the earphone.

Voice dial (Need phone support)

In standby mode double press the multifunction button wait for phone prompt and then tell the phone to dial the name of a stored contact.

Music

(Need media player support).

Music play / pause

Press Multifunction button once to play / pause music. (Some phones may require you to start a media player first).

Track backward/forward

Press and hold Volume "-" button for about 2 seconds to skip track backward.
Press and hold Volume "+" button for about 2 seconds to skip track forward.

Switch Music and Call

When a call rings during a music playing, the music automatically pauses to allow you to answer or ignore the call. Once the call is ignored or ends, the music is resumed.

Basic operation

Status indicator

| Instruction | LED status | Voice prompts |
|---------------|-------------------------------------|---------------|
| Power on | White light flashes four times | Power on |
| Power off | Red light flashes four times | Power off |
| Standby | Blink white once every 5 seconds | / |
| Pairing | Flashes red and white alternately | / |
| Incoming call | Flashes white quickly | / |
| Battery low | Blink red | Battery low |
| Charging | Stays on red while charging | / |
| | Stays on white after fully charged. | |

Volume up/down Press the volume "+" to turn volume up
Press the volume "-" to turn volume down

Power on

Press and hold Multifunction button for about 1.5 seconds. The earphone says "power on" and the LED flashes white four times

Power off

Press and hold Multifunction button for about 5 seconds. The earphone says "power off" and the LED flashes red four times.

Tips: When the distance between the earphone and phone is beyond effective range, earphone disconnects with phone. Earphone will power off automatically once no active for 15 minutes.

Windows Phone 8

- On your phone, open the Settings menu.
- Select Bluetooth. If Bluetooth is off, turn it on. The Phone will search for new devices automatically.

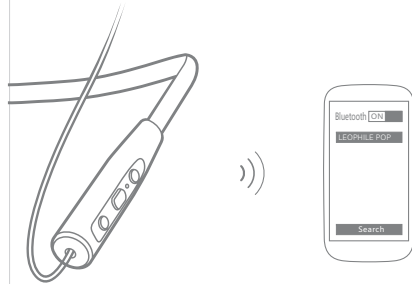

- Select "LEOPHILE POP". If your phone asks, enter 0000 (four zeros) for the pass code or accept the connection. The LED indicator stops flashing red and white once successfully paired, you hear "Connection successful". Some phone list an option to "Play through earphone", select to use the earphones.

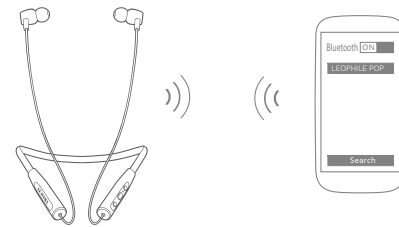

Pair another phone

Multipoint technology enables you to pair another phone and take a call from either.

To paired first smart phone power off the earphone, then power on and paired the second phone and then power off and restart the earphone, it will reconnect to second paired phone automatically for the first paired phone link, your shall manual operation from the 1st smart phone's bluetooth has paired list menu and select and click the "LEOPHILE POP"

Calling switch

When the first phone call rings, press the Multifunction button once to answer the call, if the seconds call rings at this moment, you can answer the second phone by double click Multifunction button, and on hold the first phone call.

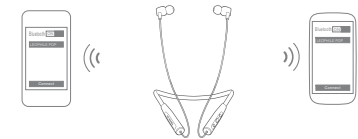

Start here

Following items are included

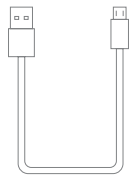

USB cable



use guide



Ear cushions

Product overview

- Volume - / Track backward
- Multifunction button
- Volume + / Track forward
- Talking mic
- Charge jack
- Battery
- Status indicator

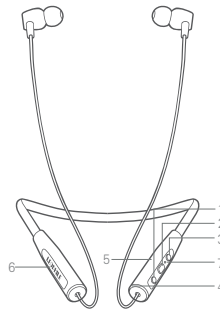

Charging

Your new earphone has enough power to pair and make a few calls. It takes 2 hours to fully charge the earphone; while charging, the battery indicator light is red, the indicator light flashes white once charging is complete.

Note: The lifetime of the battery will be significantly reduced if your earphone is left uncharged for a long period. We recommend that you recharge your earphone at least once a month.

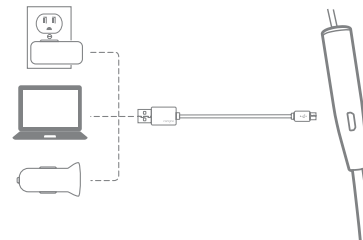

Pairing

Pair one phone

Note: When the earphone and phone have been paired once, they will automatically connect when the earphone is on and Bluetooth is activated on the phone.

Pair one phone

- Make sure the earphone is turned off and within 1 meter of your phone, press and hold the Multifunction button until the earphone power on, then release Multifunction button, the earphone reconnect the device in the paired device list, if fail, the earphone auto enter pairing mode.
- Activate Bluetooth on your phone (See below for more details).

iPhone

- On your phone, open the Settings menu.
- Select Bluetooth. If Bluetooth is off, turn it on. The iPhone will search for new devices automatically.

Android phone

- On your phone, open the Settings menu.
- Select Bluetooth (For old Android phone, Bluetooth is found in the Wireless & Networks). If Bluetooth is off, turn it on. Select Search for Devices if your phone does not automatically search for new devices.

NOTE: This equipment has been tested and found to comply with the limits for a Class B digital device, pursuant to part 15 of the FCC Rules. These limits are designed to provide reasonable protection against harmful interference in a residential installation. This equipment generates uses and can radiate radio frequency energy and, if not installed and used in accordance with the instructions, may cause harmful interference to radio communications. However, there is no guarantee that interference will not occur in a particular installation. If this equipment does cause harmful interference to radio or television reception, which can be determined by turning the equipment off and on, the user is encouraged to try to correct the interference by one or more of the following measures:

- Reorient or relocate the receiving antenna.
- Increase the separation between the equipment and receiver.
- Connect the equipment into an outlet on a circuit different from that to which the receiver is connected.
- Consult the dealer or an experienced radio/TV technician for help

Changes or modifications not expressly approved by the party responsible for compliance could void the user's authority to operate the equipment.

This device complies with Part 15 of the FCC Rules. Operation is subject to the following two conditions:

- (1) this device may not cause harmful interference, and
- (2) this device must accept any interference received, including interference that may cause undesired operation.