

Wireless File Transmitter

WFT-E3

WFT-E3A

This product is offered in two versions, WFT-E3 and WFT-E3A. Each version operates on a different number of wireless LAN channels. The WFT-E3 can transmit on 13 channels, and the WFT-E3A, on 11 channels. This difference in the number of channels available is due to varying radio regulations in areas of use.

In other respects, the WFT-E3 and WFT-E3A are identical. They are operated in the same way. This instruction manual describes operation using the WFT-E3 as an example.

Thank you for purchasing a Canon product.

The Wireless File Transmitter WFT-E3 is an accessory for EOS 40D cameras. It gives the camera wireless and wired LAN functionality and adds a USB port, enabling the following operations. The WFT-E3 is compatible with IEEE 802.11b and IEEE 802.11g wireless LANs as well as 100 Base-TX Ethernet wired LANs.

It also includes a vertical-grip shutter button for convenience in vertical shooting.

Wireless and Wired LAN Functions

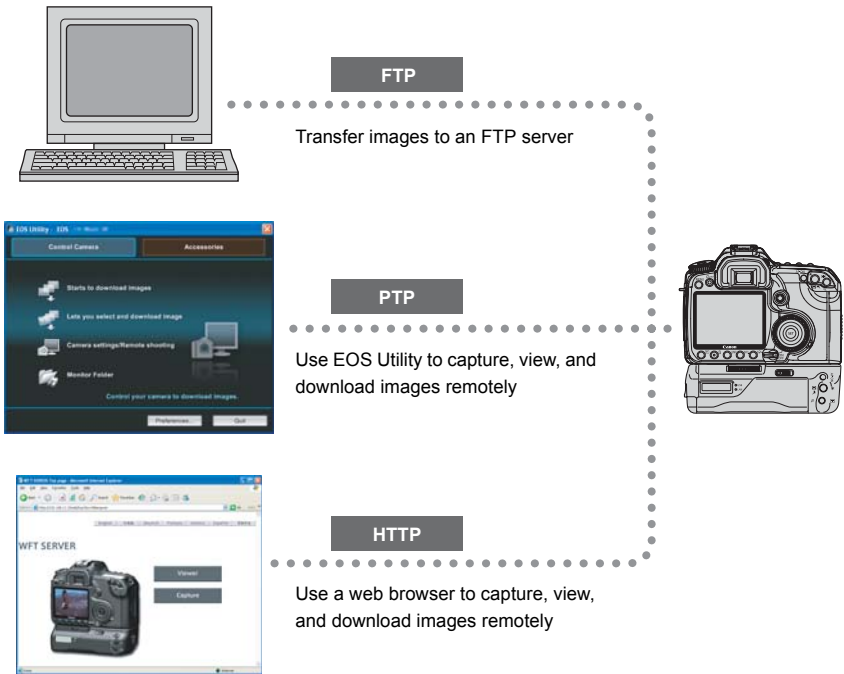

Functions When Connected via USB

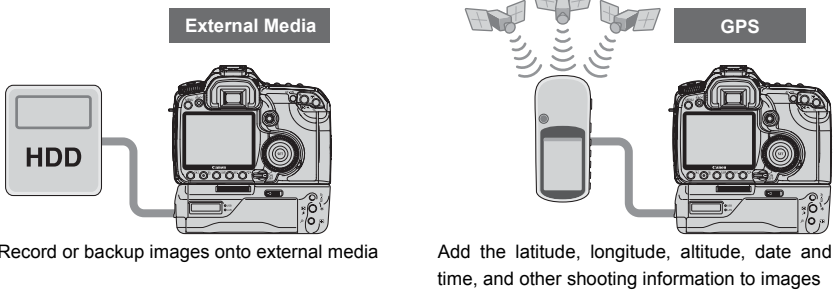

Conventions Used in this Manual

- These instructions should be followed only after your wireless or wired LAN and FTP server settings are complete. For details on configuring these settings, refer to the documentation provided with the respective equipment.
- Terms in brackets [] indicate button or icon names or other software elements. Brackets also denote camera menu items.
- Page numbers in parentheses indicate where you can find additional information.
- Instructions on camera operations should be followed only after you have read the Camera Instruction Manual and are familiar with operating the camera.
- Sections of this manual labeled with the following symbols contain information of the corresponding nature.



: Warnings to avoid potential problems are labeled with a caution symbol.



: Supplemental information is labeled with a note symbol.

- Windows is a trademark or registered trademark of Microsoft Corporation in the United States and other countries.
- Macintosh is a registered trademark of Apple Corporation in the United States and other countries.
- Wi-Fi is a registered trademark of the Wi-Fi Alliance.
- Wi-Fi Certified, WPA, WPA2, and the Wi-Fi Certified logo are trademarks of the Wi-Fi Alliance.
- UPnP is a trademark of the UPnP Implementers Corporation.
- All other corporate and brand names in this manual are trademarks or registered trademarks of their respective owners.

Using the transmitter for remote image transfer, capture, or viewing requires adequate knowledge of configuring your wireless or wired LAN and FTP server.

Canon cannot provide support for configuring wireless or wired LANs or FTP servers.

Note that Canon cannot be held liable for any loss or damage to the transmitter from erroneous network or FTP server settings. In addition, Canon cannot be held liable for any other loss or damage caused by use of the transmitter.

Contents

Introduction	
Conventions Used in this Manual	3
Areas of Use and Restrictions	6
Safety Warnings.....	7
Nomenclature.....	8
Attaching to the Camera	10
Vertical Shooting Controls	11
Loading and Unloading the Battery.....	12
Using a Household Power Outlet.....	14
Subsequent Organization of This Manual.....	15
1 Basic Network Settings	17
Displaying the Connection Wizard	18
Following the Connection Wizard	19
2 FTP Settings and Image Transfer	25
Configuring FTP Transfer Settings	26
Automatic Image Transfer After Each Shot	28
Transferring Images Individually	30
Batch Transfer	32
Checking Image Transfer History	35
Viewing Transferred Images	36
3 PTP Settings and Remote Capture	37
Configuring PTP Transfer Settings	38
Using EOS Utility	41
4 HTTP Settings and Remote Capture	43
Configuring HTTP Transfer Settings.....	44
Displaying WFT Server	46
Shooting Remotely.....	47
Viewing Images.....	49
5 Managing Settings Information	51
Checking Settings	52
Changing Settings.....	53
Saving and Loading Settings	55
6 Using External Media	57
Connecting External Media	58
Choosing Recording Media When Shooting	61
Using Together With a CF Card.....	63
Backing Up on External Media.....	64



7	Using GPS Devices	69
	Connecting GPS Devices	70
8	Troubleshooting	73
	Responding to Error Messages	74
	Wireless LAN Notes	87
	Checking Network Settings	88
9	Reference	89
	WFT Utility (Software)	90
	Creating and Registering Captions	92
	EOS Utility System Requirements	93
	Specifications	94
	Index	100



Areas of Use and Restrictions

- The WFT-E3 can be used only in the following areas.
Japan, France, Italy, Germany, United Kingdom, Belgium, the Netherlands, Luxembourg, Ireland, Denmark, Greece, Spain, Portugal, Austria, Finland, Sweden, Poland, Hungary, Czech Republic, Slovakia, Slovenia, Estonia, Latvia, Lithuania, Cyprus, Malta, Iceland, Norway, Switzerland, Australia, New Zealand, Singapore, Russia and China
- The WFT-E3A can be used in the United States and Canada, in addition to the previous areas.
For information on other areas where the transmitter can be used, contact the Canon Service Center.
- The WFT-E3, which operates on wireless LAN frequencies for 13 channels, cannot be used in the United States or Canada. Instead, use the WFT-E3A, which operates on wireless LAN frequencies for 11 channels.
- In France, using the transmitter outdoors is prohibited.
- In Italy, use outside of one's own premises requires general authorization.
- In Latvia, use outside of one's own premises requires an individual radio license.
- The following actions may be punishable under law. Disassembling or modifying the transmitter, or removing the certification label on it.
- Do not use the transmitter near other devices that emit radio waves, such as medical equipment or electronic devices. The transmitter may interfere with operation of these devices.
- Use the transmitter only with a compatible EOS DIGITAL camera. Using it with incompatible cameras may cause malfunction, accidents, and other problems not covered under warranty.
- Use the transmitter as a wireless or wired LAN device as described in this instruction manual. If you use the transmitter for any other purpose, Canon cannot be held liable for any loss or damage that may occur.

Safety Warnings

The following precautions are intended to prevent harm to you and others as well as damage to equipment. Become familiar with the precautions before using the transmitter to ensure correct and safe operation.

Be sure that you fully understand the safety precautions contained in the instruction manuals for the battery, charger, and AC Adapter Kit before using them.

Warning Preventing Serious Injury or Death

- To prevent fire, excessive heat, chemical leakage, or explosion, follow these safety guidelines.
 - Do not insert metallic objects between electrical contacts of the transmitter, accessories, or connecting cables.
- Do not use the transmitter where there is flammable gas. There is a risk of explosion or fire.
- If the transmitter is dropped and internal parts are exposed, do not touch the exposed parts. There is a risk of electrical shock.
- Do not disassemble or modify the transmitter. High-voltage internal parts may cause electrical shock.
- Do not store the transmitter in dusty or humid places. There is a risk of fire or electrical shock.
- Before using the transmitter on board airplanes or in hospitals, make sure use is permitted. Electromagnetic waves emitted by the transmitter may interfere with instrumentation or medical equipment.

Caution Preventing Injury or Equipment Damage

- Do not leave the transmitter inside a vehicle in hot weather or near a heat source. The transmitter may become hot and cause burns if touched.
- Do not cover or wrap the transmitter with a cloth. This may trap heat inside, posing a risk of case deformation or fire.
- Do not use paint thinner, benzene, or other organic solvents to clean the transmitter. This poses a risk of fire and may be hazardous to your health.

If the product malfunctions, becomes damaged, or requires repair, contact your dealer or the nearest Canon Service Center.

Handling Precautions

- The transmitter is a precision instrument. Do not drop it or subject it to shock.
- The transmitter is not waterproof. Do not use it underwater.
- Wipe off any moisture with a clean, dry cloth. If the transmitter has been exposed to salty air, wipe it with a clean damp cloth after wringing it out to remove excess water.
- Never leave the transmitter near any equipment that generates a strong magnetic field, such as magnets or electric motors.
- Do not leave the transmitter in excessive heat, such as in a vehicle in direct sunlight. High temperature may damage the transmitter.
- Do not wipe the transmitter using cleaners containing organic solvents. If the transmitter becomes difficult to clean, take it to the nearest Canon Service Center.
- To avoid corrosion, do not store the transmitter where there are strong chemicals, such as in darkrooms or chemical labs.

Nomenclature

Protective cover

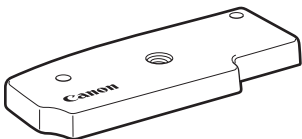

* Turn the attachment knob to remove.

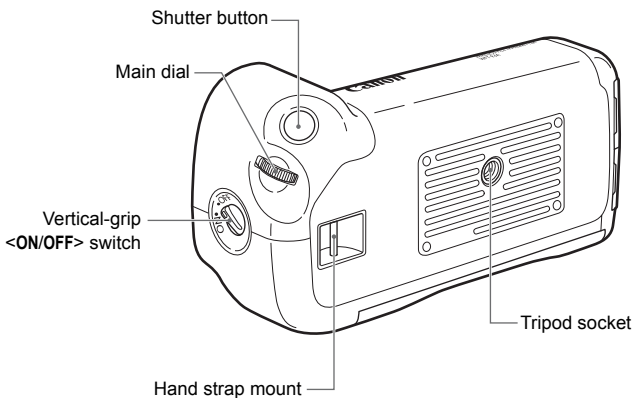
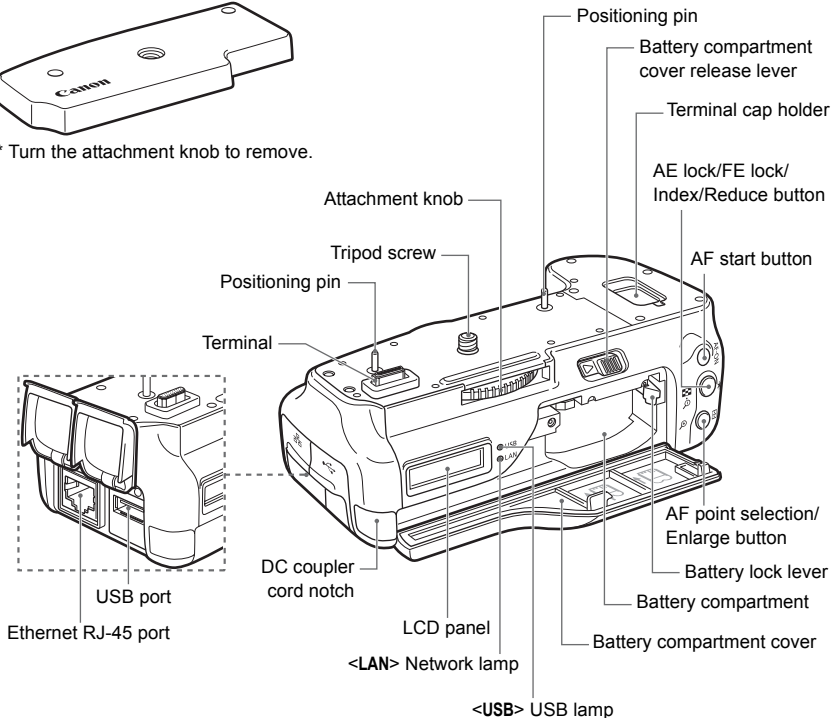

LCD panel

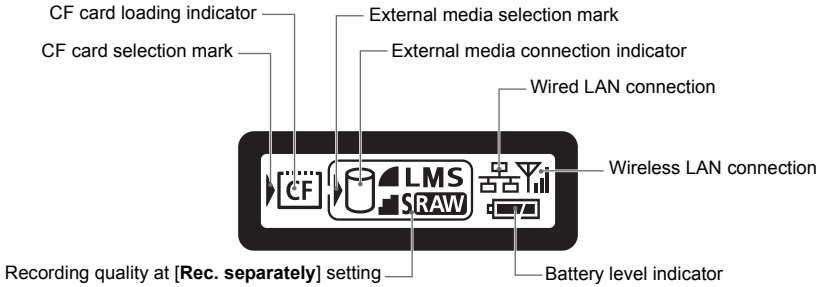

Accessories

Transmitter Case

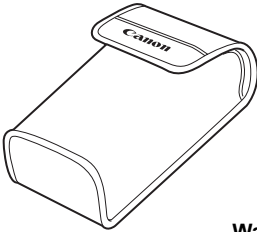

External Media Case*1

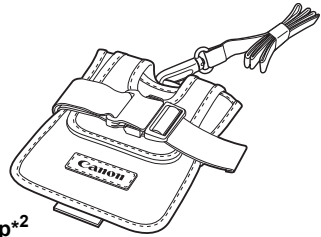

Waterproof/Dustproof USB Cap*2

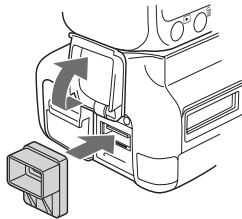

*1: This can hold portable hard disks and other devices up to 120 x 75 x 15 mm / 4.72 x 2.95 x 0.59 in. in size.

*2: Attach this cap before connecting the USB cable in rainy weather or under other adverse conditions.

Attaching to the Camera

Load a charged battery into the camera. Before attaching the transmitter to the camera, set the camera's power switch to <OFF>. The transmitter does not have a power switch. It is turned on and off in conjunction with the camera's power switch.

Before removing the transmitter, set the camera's power switch to <OFF>.

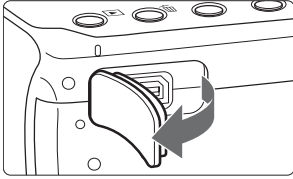

1 Remove the terminal cap from the camera.

- Peel off the terminal cap on the camera bottom to remove.
- Attach the removed terminal cap to the transmitter's terminal cap holder.

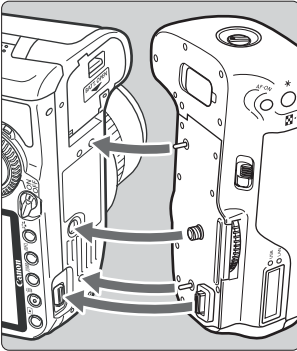
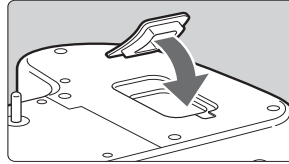

2 Attach the transmitter.

- As shown in the figure, align the transmitter and the camera, and turn the attachment knob to attach to the camera.

Vertical Shooting Controls

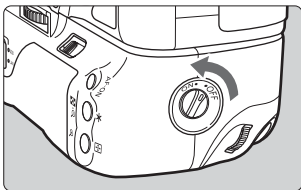

Setting the vertical-grip <ON/OFF> switch to <ON> enables the vertical-grip shutter button and other controls. These controls for shooting can still be used even when batteries are not loaded in the transmitter.

Attaching the Hand Strap E1

The Hand Strap E1 (sold separately) is attached as shown in the figure.

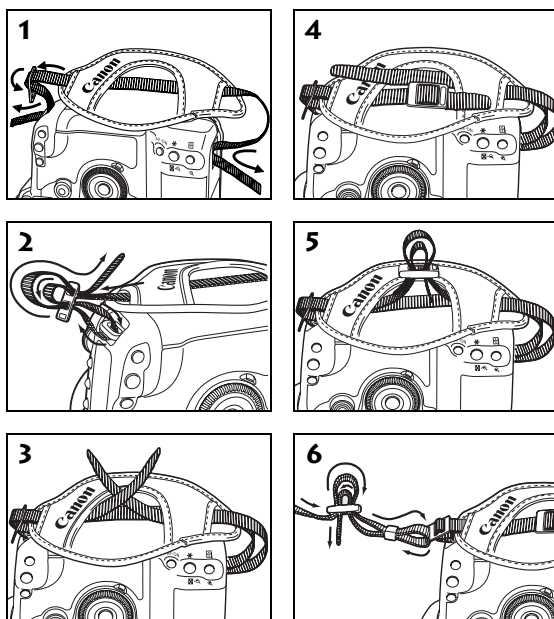

 After the hand strap is attached, check that all the slack at the buckle is removed and that there is no looseness at the buckle even when pulled tight.

Loading and Unloading the Battery

Use the Battery Pack BP-511A, 514, 511, or 512 for powering the transmitter. When replacing the transmitter's battery, be sure to first set the camera's power switch to <OFF> before opening the transmitter's battery compartment cover. In particular, if the transmitter's battery compartment cover is opened without setting the camera's power switch to <OFF> when an external media or a GPS device is connected, the connection operation for the external media or GPS device will have to be performed again.

The transmitter's battery is not included. Customers who do not have one should purchase it separately.

Loading

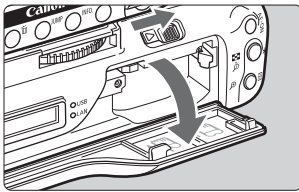

1 Open the cover.

- Slide the lever to open the cover.

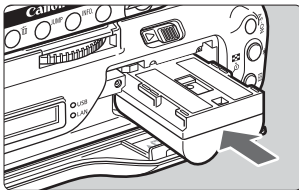

2 Load the battery.

- Insert from the side with battery contacts.
- Insert the battery all the way until it locks into place.

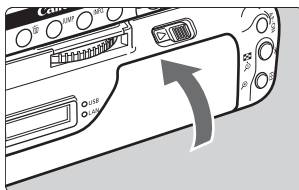



3 Close the cover.

- Press the cover up until it clicks into place.

Battery check

The remaining battery power is displayed when the camera's power switch is set to <ON>.

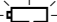

-  : The battery has enough power.
-  : The battery power is low.
-  : The battery must be recharged.

Number of images that can be transferred Approx. number of images

At Normal Temperature (23°C / 73°F)	At Low Temperature (0°C / 32°F)
2600	2600

- Using a fully charged BP-511A. The number of images that can be transferred is nearly the same at normal temperature (23°C / 73°F) and low temperature (0°C / 32°F).
- When automatic transfer is performed during shooting of an image of approx. 4MB under conditions based on the CIPA (Camera & Imaging Products Association) test standards.
- Fewer images can be transferred when transferring images over a wireless LAN.
- Fewer images can be transferred when using bus-power external media or GPS devices.

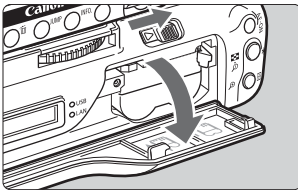
Unloading**1 Open the cover.**

- Slide the lever to open the cover.

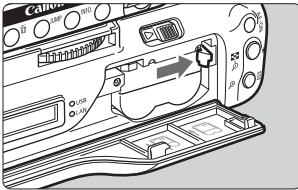
**2 Unload the battery.**

- Press the battery lock lever in the direction of the arrow to unlock, and then unload the battery.
- To prevent a short-circuit, be sure to always attach the protective cover to the battery.

Using a Household Power Outlet

When the AC Adapter Kit ACK-E2 (sold separately) is used, a household power outlet can be used to power the camera without worrying about the battery level.

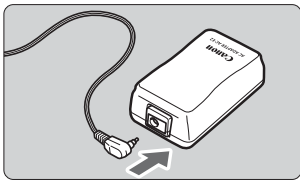

1

Connect the DC coupler plug.

- Connect the DC coupler plug to the socket of the AC adapter.

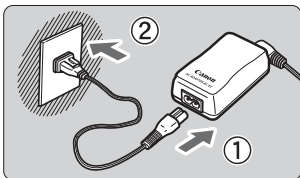

2

Connect the power cord.

- Connect the power cord to the AC adapter.
- Insert the plug into the outlet.
- After usage, unplug from the outlet.

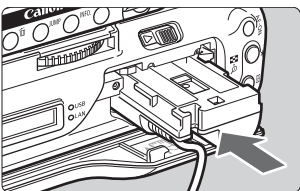

3

Load the DC coupler.

- Open the cover, and insert the DC coupler firmly until the lock position.

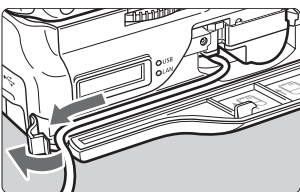

4

Close the cover.

- Pass the cord through the groove while opening the cap of the DC coupler cord notch, and then close the cover.



Do not connect or disconnect the power cord while the camera's power switch is set to <ON> or <↵>.

Subsequent Organization of This Manual

In addition to wireless and wired LAN functions, the WFT-E3 can communicate with external media and GPS devices.

For instructions on operations after you have attached the transmitter to the camera, click one of the following chapter titles to view the corresponding page.

Using a Wireless or Wired LAN

(Basic Network Settings)

Chapters 1 to 5

Using External Media

Chapter 6

Using GPS Devices

Chapter 7



1

Basic Network Settings

Complete the basic network settings by following the instructions of the transmitter connection wizard on the camera menu screen, which provides guidance.

Getting Ready

The connection wizard helps you follow the steps to connect the transmitter to an existing wireless or wired LAN.

To connect to a wireless LAN, prepare the wireless LAN device (wireless LAN access point or wireless LAN adapter) and computer in advance so that they are ready for you to connect the transmitter to the wireless network. When configuring the basic network settings, bring the transmitter within 3 m / 9.8 ft. of the wireless LAN device. To connect to a wired LAN, use a LAN cable to connect the transmitter and computer. Prepare the transmitter for connection to the wired network.

Displaying the Connection Wizard

This section describes the process of following the connection wizard instructions. If an error is displayed, refer to “Troubleshooting” in Chapter 8 (p.73) and check the settings.

- Pressing the shutter button or other camera controls during configuration by the connection wizard will close the connection wizard. Do not press the shutter button or other controls until configuration is finished.
- On the [**IF**] tab, set [**Auto power off**] to [**Off**]. If auto power off is activated, the connection wizard will be closed during the configuration process.

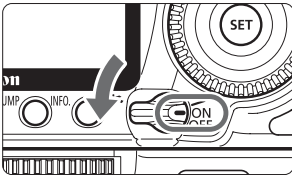

1 Turn the camera on.



2 Display the transmitter menu.

- On the camera, press the <MENU> button.
- On the [**IF**] tab, select [**WFT settings**] and press <SET>. [**WFT settings**] is added to the tab after you attach the transmitter.



3 Select [Connection wizard].

- ▶ The [**Select communication method**] screen is displayed.

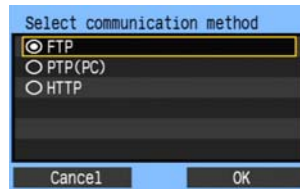

- ▶ The <LAN> lamp starts blinking.

Following the Connection Wizard

Selecting the Communication Method

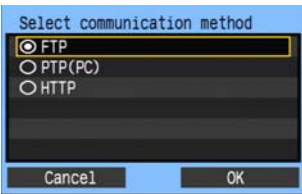

- Turn the <◂> dial to select the communication method, and then press <SET>.
- Select [OK] and press <SET> to go to the next screen.

• FTP

Choose this option to transfer captured images to an FTP server.

Images can be automatically transferred as you shoot them, or you can select images for transfer later.

Computer Operating Systems

Operation via [FTP] requires that Windows Vista (Business, Enterprise, or Ultimate Edition for 32- or 64-bit systems), Windows XP Professional, Windows 2000, or Mac OS X 10.4 be installed on your computer. In addition, the computer must be prepared as an FTP server in advance.

For instructions on preparing your computer as an FTP server, refer to the computer documentation.

Windows Vista Home Premium and Home Basic Edition as well as Windows XP Home Edition cannot be used because FTP server functionality is not supported.

• PTP

Choose this option when using EOS Utility for remote capture over a wireless or wired LAN.

In addition to remote capture, all camera operations in EOS Utility are supported because a wireless or wired network is used with this option instead of the USB cable.

Computer Operating Systems

Operation via [PTP] requires that any edition of Windows Vista for 32- or 64-bit systems (except Starter Edition), Windows XP (Home Edition or Professional, with Service Pack 2), or Mac OS X 10.4 be installed on your computer.

• HTTP

Choose this option for remote capture over a wireless or wired LAN.

In addition, images on a CF card in the camera can be viewed and downloaded to a computer. The camera can be accessed like browsing a webpage, by users at up to three computers.

Computer Operating Systems

Any computer with a web browser can be used, regardless of the operating system.

Selecting the LAN Type

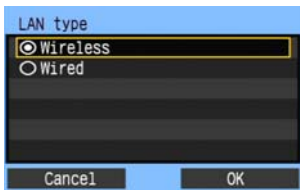

- Turn the <⊙> dial to select the type of LAN, and then press <SET>.
- Select [OK] and press <SET> to go to the next screen.

Wireless LAN

Active wireless LAN devices in your area are found and listed.

Wired LAN

The [Network] settings screen is displayed. If you have selected a wired network, refer to page 22, “Configuring Network Settings.”

Use a Category 5 or higher STP LAN cable. (STP: Shielded Twisted Pair)

Selecting the Wireless Network

Wireless LAN devices are listed with identifying information. Select the SSID (or ESS-ID) of your desired wireless LAN device.

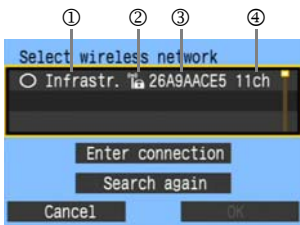

- To select the wireless LAN device, press <SET>.
- Turn the <⊙> dial to select the wireless LAN device, and then press <SET>.
- Select [OK] and press <SET> to go to the next screen.

- ① Indicates whether the device is in infrastructure or ad hoc mode
- ② An icon is displayed if the wireless LAN device is encrypting communication
- ③ Indicates the first 9 characters of the SSID
- ④ Indicates the channel used

Encryption by Wireless LAN Devices

If the wireless LAN device is encrypting communication, select the corresponding method in [Authentication] and [Encryption].

- [Authentication]: Open system, Shared key, WPA-PSK, or WPA2-PSK
- [Encryption]: WEP, TKIP, or AES

[Enter connection] and [Search again]

- To configure settings for the wireless LAN device manually, select **[Enter connection]** and press **<SET>**. Complete the settings for the items displayed, one after another.
- To search for wireless LAN devices again, select **[Search again]** and press **<SET>**.

Entering the Wireless LAN Encryption Key

Next, enter the encryption key of the wireless LAN device. For details on the encryption key, refer to the device's instruction manual.

Note that the screens displayed in steps 1 to 3 below vary depending on the authentication and encryption of the wireless LAN device.



1

- The **[Key index]** screen is displayed only if WEP encryption is used by the wireless LAN device.
- Turn the **<DIAL>** dial to select the key index number specified as the access point, and then press **<SET>**.
- Select **[OK]** and press **<SET>** to go to the next screen.

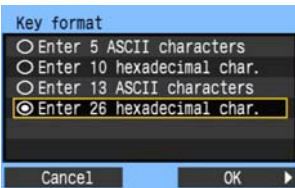

2

- Turn the **<DIAL>** dial to select the key format, and then press **<SET>**.
- Select **[OK]** and press **<SET>** to go to the next screen.

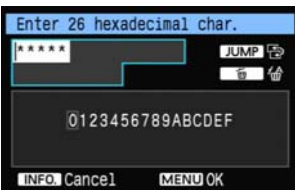

3

- Enter the encryption key.
- To switch between input areas, press the **<JUMP>** button.
- To move the cursor, turn the **<DIAL>** dial.
- In the bottom input area, turn the **<DIAL>** dial and press **<SET>** to enter the encryption key.
- If you make a mistake, press the **<W>** button to erase it.
- Press the **<MENU>** button to go to the next screen.
- To return to the previous screen, press the **<INFO.>** button. The entry is erased.

Configuring Network Settings

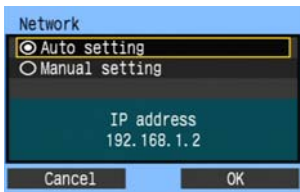

- Turn the <⌚> dial to select how to configure the network settings, and then press <SET>.
- Select [OK] and press <SET> to go to the next screen.

[Auto setting]

- Settings otherwise configured with [Manual setting] can be configured automatically. However, the IP address and similar settings must be automatically assigned and configured in environments using DHCP servers or wireless LAN devices or routers supporting DHCP server functions. If an error is displayed, select [Manual setting] regardless of whether the IP address and similar settings are automatically assigned and configured.

[Manual setting]

The [IP address set.] screen is displayed after you select [Manual setting]. If [Auto setting] results in an error, enter the IP address manually. As the IP address, enter the IP address assigned to the camera.

Enter the [IP address], [Subnet mask], [Gateway], and [DNS address] on each screen as they are displayed. If you are not sure what to enter, refer to page 88, “Checking Network Settings,” or ask the network administrator or another person knowledgeable about the network.

- When entering numbers for the IP address, subnet mask, and so on, press <SET> to move the input position and turn the <⌚> dial to enter the number.

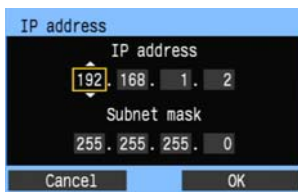
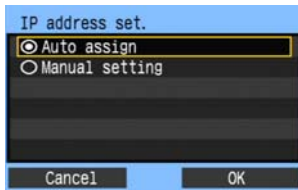

Completing Settings for the Communication Method

The following instructions are for settings screens that vary depending on the communication method (FTP, PTP, or HTTP), as shown below. Read the page that introduces the selected communication method.

FTP



Chapter 2 (p.25)

PTP



Chapter 3 (p.37)

Windows Vista Users

Before performing the operations from page 37, perform the operations below. If these operations are not performed, the WFT Pairing Software described on page 38 may not start.

Open the [C Drive] → [Program Files] → [Canon] → [EOS Utility] → [WFTPairing] folder (in this order), and then double-click the [WFT FirewallSettings] icon.

After performing this operation, perform the operation on page 37.

HTTP



Chapter 4 (p.43)

Virtual Keyboard Operation

The virtual keyboard is displayed during entry of the encryption key, server name, and other information.



Switching to other input areas

To switch between input areas, press the <JUMP> button.

Moving the cursor

To move the cursor, turn the <◂> dial.
You can also move the cursor using <⤴>.

Entering text

In the bottom input area, turn the <◂> dial to move the cursor and press <SET> to enter text.
You can also move the cursor using <⤴>.

Deleting text

If you make a mistake, press the <⏪> button to erase it.

Confirming entries

Press the <MENU> button to confirm what you have entered and go to the next screen.

Canceling entries

Press the <INFO.> button to erase the entry and return to the previous screen.

2

FTP Settings and Image Transfer

You can configure the FTP settings for automatic transfer of each image as you shoot or batch transfer after capture.

Configuring FTP Transfer Settings

These instructions are continued from Chapter 1.

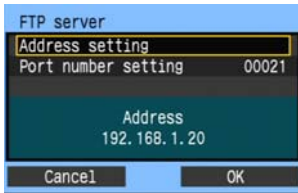

1

- Turn the <⊙> dial to select **[Address setting]**, and then press <SET>.



2

- If you have set the DNS server setting to **[Disable]**, the screen at left is displayed.
- Press <SET> to select the input position, and then turn the <⊙> dial to enter the IP address of the FTP server.



- If you have set the DNS server IP address setting to **[Auto assign]** or **[Manual setting]**, the screen at left is displayed.
- For instructions on screen operations, refer to “Virtual Keyboard Operation” (p.24).
- Enter the FTP server’s server name or IP address.

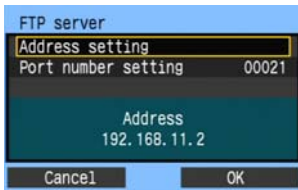

3

- In **[Port No.]**, enter 00021, in most cases.
- Turn the <⊙> dial to select **[OK]**, and then press <SET> to go to the next screen.

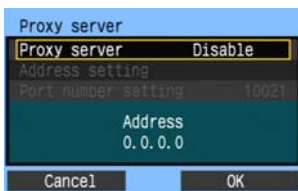

4

- Complete the **[Proxy server]** settings.
- Turn the <⊙> dial to select **[OK]**, and then press <SET> to go to the next screen.



5

- Complete the [**Login method**] settings.
- Turn the <⌂> dial to select [**OK**], and then press <SET> to go to the next screen.

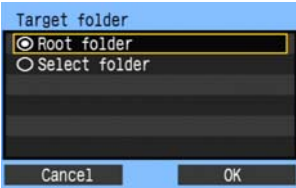

6

- Complete the [**Target folder**] settings.
- Select [**Root folder**] to have images saved in the root folder as specified in FTP server settings. (p.36)
- Select [**Select folder**] to specify a subfolder in the root folder. If no folder exists, a folder will be created automatically.
- Turn the <⌂> dial to select [**OK**], and then press <SET> to connect to the FTP server.



7

- On the confirmation screen displayed next, select [**OK**] and press <SET>.
- ▶ The <LAN> lamp is lit in green.



8

- Press <SET>. Turn the <⌂> dial to select the set number, and then press <SET>.
- Turn the <⌂> dial to select [**OK**], and then press <SET>. After the connection wizard is closed, the display reverts to the menu screen.



- Settings information is stored on the camera. It is not stored on the transmitter.

The FTP network settings are now complete.

Automatic Image Transfer After Each Shot

An image can be automatically transferred to the FTP server immediately after shooting. You can also continue shooting even while images are being transferred.

Before shooting, be sure to insert a CF card in the camera or connect external media (p.57). If you shoot without recording images, they cannot be transferred.



1 In [WFT settings], select [Set up].

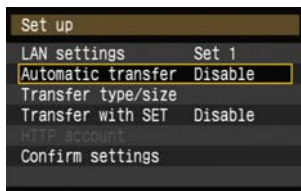

2 Select [Automatic transfer].

- Select [Enable].

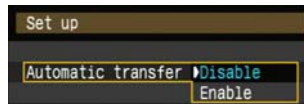

3 Take the picture.

- ▶ The captured image is transferred to the FTP server.
- During image transfer, the <LAN> lamp blinks.



- During continuous shooting, images are transferred to the FTP server in the order they are captured.
- The captured images are also stored on the CF card.
- Any images for which transfer fails or is interrupted can be transferred later together.

Selecting Particular Sizes or Types of Images to Transfer

In automatic transfer during shooting, you can choose which images to transfer if different size images are recorded to the CF card and external media (p.63), or if different types of images are recorded in RAW+JPEG shooting.



1 In [WFT settings], select [Set up].

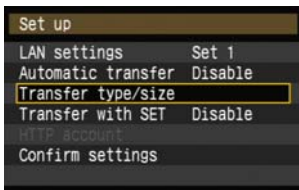

2 Select [Transfer type/size].

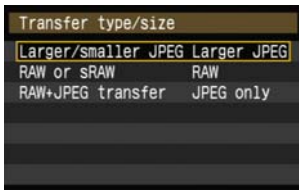

3 Select the size and type of images to transfer.

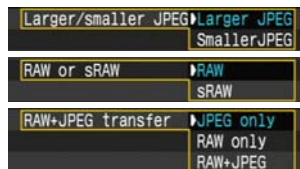

- For instance, if the camera is set up to record L images on a CF card and L images on external media and you want to transfer L images, set [Larger/smaller JPEG] to [Smaller JPEG].
- If the camera is set up to record RAW images on a CF card and JPEGs on external media, specify which images to transfer in the [RAW+JPEG transfer] setting. Similarly, complete the same setting if RAW+JPEG images are recorded simultaneously on a single CF card.

2

FTP Settings and Image Transfer

Transferring Images Individually

Simply press $\langle \text{SET} \rangle$ to transfer the currently displayed image. You can also add a caption before transferring images. You can also continue shooting even while images are being transferred.

Transferring the Current Image



1 In [WFT settings], select [Set up].

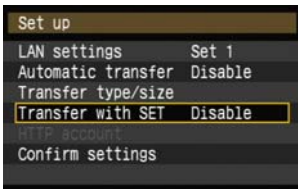

2 Select [Transfer with SET].

- Select [Enable].

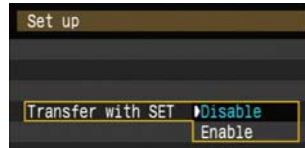

3 View the image.

- On the camera body, press the $\langle \text{▶} \rangle$ button.
- Select the image to transfer, and then press $\langle \text{SET} \rangle$ to transfer the image.

Adding a Caption Before Transfer

You can add a registered caption to each image before transfer. This is effective if you want to inform the recipient the printing quantity, for example. The caption is also added to images stored on the camera.

For instructions on creating and registering captions, refer to page 92.

You can check for captions added to images by examining the Exif information, in the user comments.

2

FTP Settings and Image Transfer

1 Take the picture.

2 In [WFT settings], select [Transfer with caption].

- ▶ The last captured image is displayed.

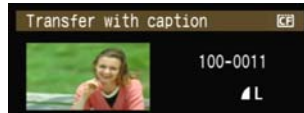

- It is not possible to select other images on the [Transfer with caption] screen. To select another image for transfer with a caption, view that image before following these steps.

3 Select a caption.

- Turn the <◂> dial to select the [Caption] frame, and then press <SET>.
- Turn the <◂> dial to select the content of the caption, and then press <SET>.

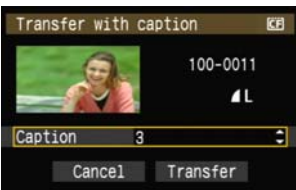

4 Transfer the image.

- Turn the <◂> dial to select [Transfer], and then press <SET>.

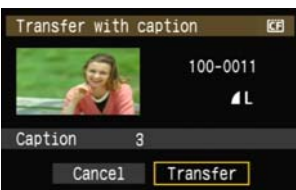

! If you add captions to images that include original decision data, these images are no longer judged to be original images.

Batch Transfer

After shooting, you can select multiple images as desired and transfer them all at once. You can also transfer unsent images or images that could not be sent previously.

If both a camera CF card and external media are used at the same time, images are transferred from the source specified on the menu [F] tab, in [Recording func.+media select] → [Record/play].

You can also continue shooting even while images are being transferred.

Selecting Images to Transfer



1 In [WFT settings], select [Image sel./transfer].



2 Select [Sel. Image].
▶ An image is displayed.



3 Select images to transfer.

- Press <SET>. Turn the <DISP> dial to display <✓> in the upper left corner of the image to transfer.
- Press <SET> to confirm your selection.
You can select up to 9,999 images.
- Press the <Q> button to display three images per screen. Press the <Q> button to display one image per screen again.

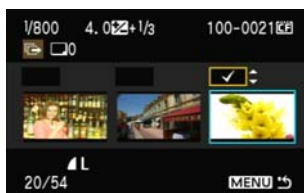

- After selecting images to transfer, press the <MENU> button.



4 Transfer the images.

- Select [**T**ransfer].
- Select [**O**K] on the confirmation screen displayed next.
- ▶ A transfer progress screen is displayed.



- During image transfer, the <LAN> lamp blinks.

Menu Operation During Image Transfer

You can use the menu even during image transfer. However, to prevent transfer problems, some menu items are unavailable during transfer, including [**W**FT settings], [**P**rotect images], [**E**rase images], and [**F**ormat].

Batch Transfer of Images on CF Cards



1 In [WFT settings], select [Image sel./transfer].



2 Select [All image].

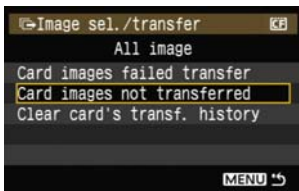

3 Select [Card images not transferred].

- To transfer images that could not previously be transferred, select [Card images failed transfer].



4 Transfer the images.

- Select [Transfer].
- Select [OK] on the confirmation screen displayed next.
- ▶ A transfer progress screen is displayed.
- During image transfer, the <LAN> lamp blinks.

Selecting [Clear card's transf. history] will set the transfer history of images on the CF card to "unset." This enables you to resend all the images on the card later by selecting [Card images not transferred].

Checking Image Transfer History

Checking the Transfer History of Individual Images

To check the transfer history, in [Image sel./transfer], select [Sel.Image].



Image not selected for transfer (no icon)

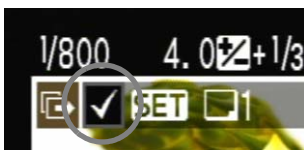

Image selected for transfer

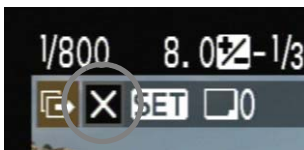

Image could not be transferred



Image transferred

Checking the Transfer History of CF Cards



On the [Image sel./transfer] screen, you can check the number of images for transfer as well as the transfer history of images in the CF card. Specifically, you can check the number of images classified as [Images failed trans.] and [Images transferred].

Viewing Transferred Images

Images transferred to the FTP server are stored in the following folder as specified in the FTP server settings.

Windows

- Under the default settings of the FTP server, images are stored in **[C drive]** → **[Inetpub]** folder → **[ftproot]** folder, or in a subfolder of this folder.
- If the root folder of the transfer destination has been changed in the FTP server settings, ask the FTP server administrator where images are transferred.

Macintosh

- Open the **[Macintosh HD]** → **[Users]** folder. The folder where images are stored is located in the folder of the user currently logged on, or in a subfolder there.

Folders for Image Storage

Under the default transmitter settings, transferred images will be stored in the root folder specified in the FTP server settings, in a folder structure such as A/DCIM/100CANON which is automatically created.

Additionally, if you have selected a CF card as the media for recording and playback, a folder structure such as “A/DCIM/100CANON” is automatically created for image storage. For external media, “C/DCIM/100CANON” is created. (CF card images are assigned to the A folder, and external media images to the C folder.)

3

PTP Settings and Remote Capture

You can use EOS Utility to shoot remotely over a wireless or wired LAN. In addition to remote capture, all camera operations in EOS Utility are supported because a wireless or wired network is used with this option instead of the USB cable.

Configuring PTP Transfer Settings

These instructions are continued from Chapter 1.

You can use the included WFT Pairing Software to enable the transmitter to communicate with a computer via PTP.

WFT Pairing Software is installed automatically during easy installation of the software provided with the camera. If it is not installed, install it on the computer for communication with the transmitter before this procedure.

The configuration procedure is as follows, using Windows XP as an example.



1

- First, the pairing screen is displayed.
- Turn the <SET> dial to select [OK]. When you press <SET>, the following message is displayed. Here, ***** represents the last six digits of the MAC address of the WFT-E3 for the connection.



2

- Start the pairing software.
- Normally, it is installed in the same location as EOS Utility.

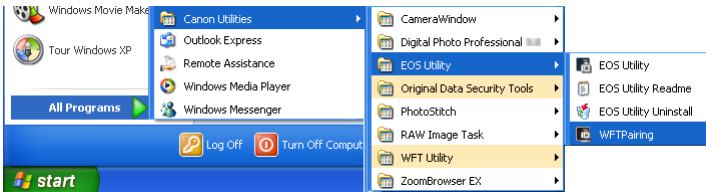

- ▶ After the pairing software starts up, an icon is displayed in the task bar.
- ▶ When the camera is detected, a message is displayed.

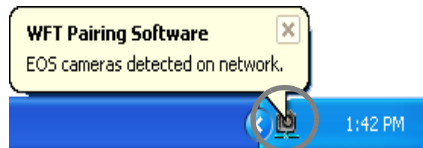

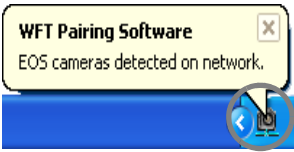

3

- Double-click the pairing software icon.
- ▶ Detected cameras are listed. Cameras that have already been connected are not included in the list.

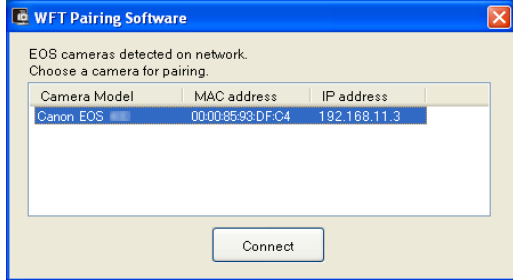

- Click [**Connect**].
- If multiple cameras are displayed, identify the camera to connect to by its [**MAC address**] or [**IP address**].
- You can check the [**MAC address**] and [**IP address**] by accessing [**Confirm settings**] in the menu (p.52).

3 PTP Settings and Remote Capture

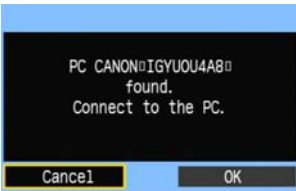

4

- When the camera detects the computer on which you clicked [**Connect**] in step 3, the message at left is displayed.
- Turn the <ⓘ> dial to select [**OK**], and then press <SET>.



5

- Press <SET>. Turn the <ⓘ> dial to select the set number, and then press <SET>.
- After you turn the <ⓘ> dial to select [**OK**] and press <SET>, the connection wizard is closed and EOS Utility starts up.
- ▶ The <LAN> lamp on the transmitter is lit in green.
- Settings information is stored on the camera. It is not stored on the transmitter.

The PTP network settings are now complete.

- There is no need to complete pairing again if you will continue using a particular camera, transmitter, and computer together after pairing without changing the settings. Before your next PTP session, simply turn on the camera to which the transmitter is attached and start the pairing software. The connection between the camera and computer will be established automatically.
- You can add the pairing software to the software launched at startup of your computer. In EOS Utility on the **[Preferences]** → **[Basic Settings]** tab, select [**Add WFT Pairing Software to the Startup folder**].

Using EOS Utility

For EOS Utility instructions, refer to the Software Instruction Manual (PDF). You can take full advantage of EOS Utility via the transmitter just as via a USB connection, without restrictions.



 In Remote Live View shooting, the rate of image transmission is slower than via USB. The motion of moving subjects cannot be displayed smoothly.



4

HTTP Settings and Remote Capture

You can use a web browser to shoot remotely over a wireless or wired LAN. In addition, images on a CF card in the camera can be viewed and downloaded to a computer.

Configuring HTTP Transfer Settings

These instructions are continued from Chapter 1.

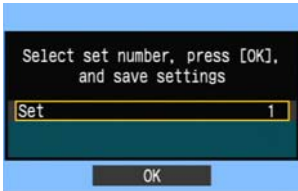

- Press <SET>. Turn the <DIAL> dial to select the set number, and then press <SET>.
- Turn the <DIAL> dial to select [OK], and then press <SET>. After the connection wizard is closed, the display reverts to the menu screen.
- ▶ The <LAN> lamp on the transmitter is lit in green.

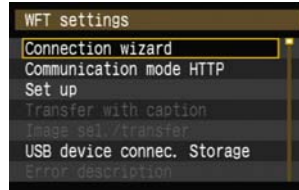

- Settings information is stored on the camera. It is not stored on the transmitter.

Setting up an Account

Enter a logon name and password for accessing the camera from a computer. The logon name and password you specify here are used on the computer when connecting to the camera.

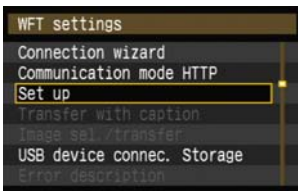

1

- Turn the <DIAL> dial to select [Set up], and then press <SET>.

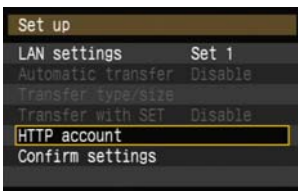

2

- Turn the <DIAL> dial to select [HTTP account], and then press <SET>.

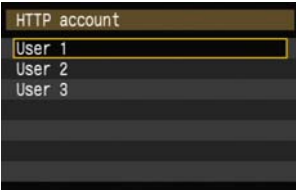

3

- Select a user number.
- The camera can be accessed via HTTP from up to three computers. Here, select a user number to prevent conflicts when users at other computers are connected to the transmitter simultaneously.
- Turn the <⊙> dial to select [User *], and then press <SET>.

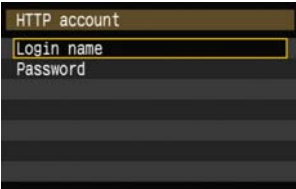

4

- After you select [Login name] and [Password], the following input screen is displayed.
- For instructions on input screen operations, refer to “Virtual Keyboard Operation” (p.24).



The HTTP network settings are now complete.

Displaying WFT Server

In the web browser, display WFT Server, a screen for transmitter operations. Make sure you have already established a connection between the camera and computer.

1 Start the web browser.

- First, start Internet Explorer or another web browser.



2 Enter the URL.

- In the address field, enter the IP address assigned to the camera.
- Press the <Enter> key.
- ▶ The account screen is displayed.



- Enter the login name and password as specified in the procedure on page 45. Click [OK] to display the WFT Server screen.
- Select the language.

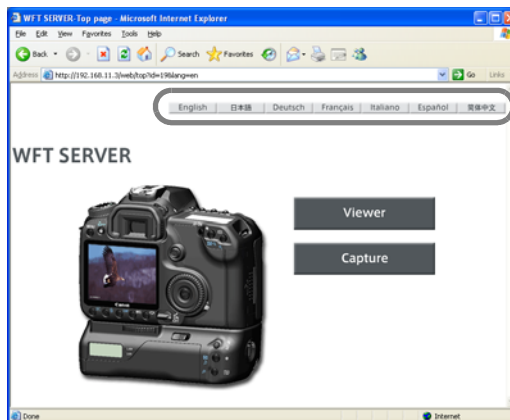

If you don't know the URL (IP address)

You can check the URL (IP address) by accessing [Confirm settings] in the menu (p.52).

Shooting Remotely



1

Click [Capture].

- ▶ The capture screen is displayed.

2

Take the picture.

- Set the lens focus mode switch to <MF> and adjust the focus.
- In the browser, click the release button of the simulated remote controller. The camera will shoot when the button is released.
- ▶ The captured image is displayed in the simulated camera monitor in the browser.
- Captured images are stored on the CF card.

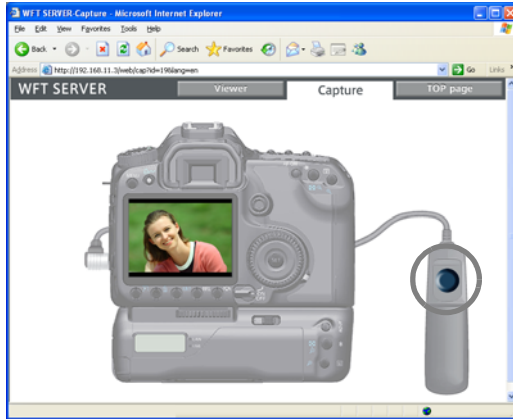

4



3 Download images to the computer.

- Click the image.
- ▶ The image is displayed at a larger size.
- Follow the web browser instructions to download the image to the computer.
- To return to the remote capture screen, click **[Return]**.

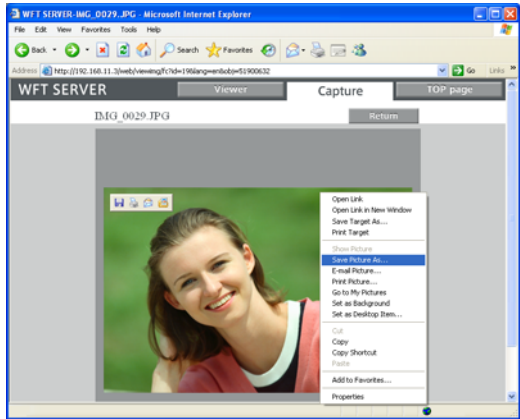

RAW images are not displayed at larger sizes, but they can be downloaded to the computer the same way as JPEGs.

Viewing Images

Browse images on the camera's CF card as follows.



1

Click [Viewer].

- ▶ The Viewer screen is displayed.

2

Select the memory card.

- If the camera is connected to external media, the corresponding icon is also displayed.
- Click the [DCIM] folder and select the folder where images are stored.

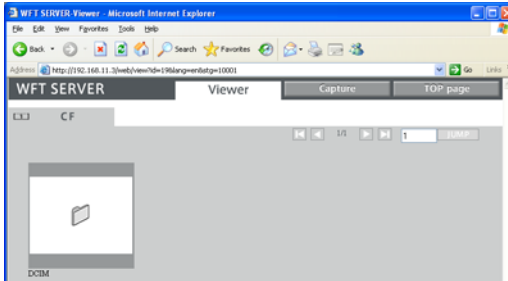

3

Select an image.

- To view another image, click the < [◀] [▶] [⏪] [⏩] > buttons or jump to other pages.

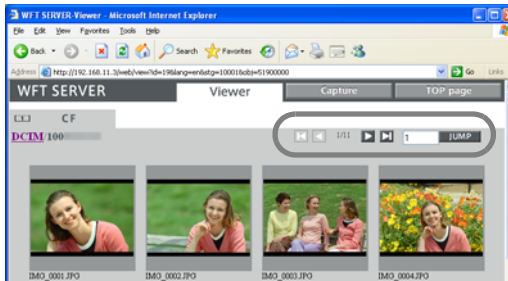

4 Download images to the computer.

- Click a thumbnail.
- ▶ The image is displayed at a larger size.
- Follow the web browser instructions to download the image to the computer.
- Click **[Return]** to return to the image viewing screen.

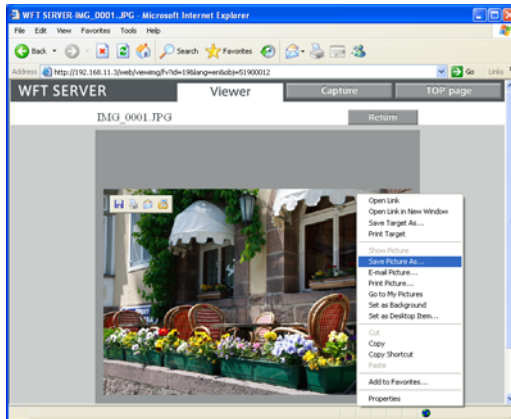

RAW images are not displayed at larger sizes, but they can be downloaded to the computer the same way as JPEGs.