

Refer to the InPower™ Pharmacy Software Learning Guide for information on how to use the Pod Pal with the InPower™ Pharmacy Software.

The InPower™ Pod Pal device is intended to be used with the InPower™ pharmacy software. The Pod Pal weighs and programs the InPower™ medication pods.

Intended Use:

Pod Pal Instructions for Use



- Do not place the device in a wet or humid area. Do not allow the device to become wet. Do not immerse the device in water.
- Do not place unused pods near the front of the Pod Pal while the Pod Pal is in use. This will cause delays in the software functionality.
- Ensure there are no vibrating devices or equipment on the same surface as the Pod Pal.
- Only use the InPower™ medication pods provided to you by Cardinal Health.
- Do not subject device to strong shocks, such as dropping on the floor.
- Do not overload power outlets. Plug the device into the appropriate voltage outlet.
- Do not plug or unplug the power cord from the electrical outlet with wet hands.
- Keep lid closed when not in use to prevent damage to the internal scale.
- Allow two hours for the device to acclimate to the temperature and humidity of its new environment after being unpacked and placed in the pharmacy.

General Warnings and Precautions

The device is not waterproof, therefore:

Cat. FUSE-005

WARNING: Any changes or modifications made to this product not expressly authorized by the manufacturer could void the user's right to operate this device.

The device complies with part 15 of the FCC Rules. Operation is subject to the following two conditions: (1) This device may not cause harmful interference, and (2) this device must accept any interference received, including interference that may cause undesired operation.

A separation distance of at least 20 centimeters should be maintained between the transmitter's radiating structure(s) and the body of the user or nearby persons.

Distributed by:

Cardinal Health

1500 Waukegan Road

Waukegan, IL 60085

Rev. A 2017-08

Phone: 1-855-946-7697 (1-855-9IN-POWR)

Document #: 36-6522

Version #: 2

© 2017 Cardinal Health. All Rights Reserved.
CARDINAL HEALTH, the Cardinal Health LOGO and INPOWER are trademarks of Cardinal Health and may be registered in the US and/or in other countries.



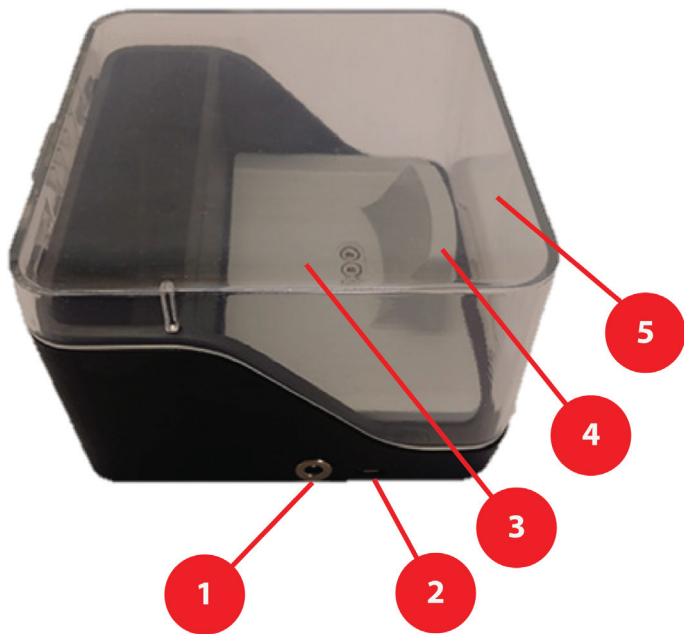

InPower™ Pod Pal side view

Feature Descriptions

1. **Power adapter input:** Receives power from the wall socket via the included AC/DC power adapter. Connect one end of the power adapter to the wall and the other end to the Pod Pal. Power specifications: ANS: Input: 120V AC 60Hz, Output: 5V DC 450mA.
2. **USB input:** Enables two-way communication between the Pod Pal and the computer via the included USB cord. Connect one end of the USB cord to the Pod Pal and the other end to the computer.
3. **Pod bay:** Place a medication pod inside the pod bay when adding, checking or fixing fills.
4. **Pod holder:** Holds the pod properly in place. Ensure the bottom of the pod is completely nested against the pod bay.
5. **Cover:** Hinged cover (lid) must be closed when weighing pods during fills to ensure more accurate weight readings. The cover does not need to be closed during Check and Fix Fill process, unless you are re-weighing the pods. Keep the cover closed when the Pod Pal is not in use.

Operating Instructions

1. Place the Pod Pal device on a flat, level, stable surface near a power outlet and the computer accessing the InPower™ Pharmacy Software.
2. Plug the power adapter into the Pod Pal while holding the device.
3. Plug the power adapter into a power outlet.
4. Plug the USB cable into the Pod Pal while holding the device.
5. Plug the USB cable into the computer accessing the InPower™ Pharmacy Software.
6. Refer to the InPower™ Pharmacy Software Learning Manual for software use instructions.

Cleaning

- Clean the exterior surfaces of the Pod Pal using a soft cloth, an alcohol pad or a disinfectant wipe.
- Do not use harsh chemicals to clean the device.
- Do not immerse the device in any fluid or allow fluid to enter through the USB or power adapter ports.

Maintenance & Disposal

- Do not attempt to service or repair the Pod Pal device.
- Do not use if maintenance is required.
- Do not dispose of the device. Return it to Cardinal Health instead.

Help Information

- If experiencing issues with the Pod Pal, try the following:
 - o Ensure the bottom of the pod is completely nested against the pod bay.
 - o Refresh the Pharmacy Software screen.
 - o Disconnect the USB cable from the computer and reconnect.
 - o Ensure the USB cable and power adapter are completely plugged in
- If issues persist, contact Cardinal Health Technical Support at 1-855-9IN-POWR (1-855-946-7697).