

1.6 User Manual



10115 2,4 GHZ WIRELESS+ SET EVOLUTION

D	Montage- und Betriebsanleitung
GB USA	Assembly and operating instructions
F	Instructions de montage et d'utilisation
E	Instrucciones de uso y montaje
P	Instruções de montagem e modo de utilização
I	Istruzioni per il montaggio e l'uso
NL	Montage- en gebruiksaanwijzing
S	Monterings- och bruksanvisning
FIN	Asennus- ja käyttöohjeet
N	Montajse- og bruksanvisning
H	Ősszeszerelési és használati útmutató
PL	Instrukcja obsługi i montażu
SK	Návod na montáž a pre prevádzku
CZ	Návod na montáž a pro provoz
BG	Ръководство за монтаж и експлоатация
GR	Οδηγίες συναρμολόγησης και λειτουργίας
RO	Instrucțiuni de montaj și de utilizare
DK	Monterings- og driftsvejledning
RC	安装和使用说明
J	取扱説明書取扱説明書の内容は予
ROK	조립과 작동 방법
Arabic	إرشادات التركيب و الأستخدام
TR	Montaj ve işletme kılavuzu
RUS	Инструкция по монтажу и эксплуатации

Verpackungsinhalt · Contents of package · Contenu du carton · Contenido de la caja · Conteúdo da embalagem · Contenuto della confezione · Verpakking inhoud · Innehållet i förpackningen · Pakkauksen sisältö · Innholdet i pakningen · A csomag tartalma · Zawartość opakowania · Obsah balenia · Obsah balení · Съдържание на опаковката · Περιεχόμενα συσκευασίας · Conținutul ambalajului · Emballageinhold · 包装内容 · 梱包内容 · 포장내용물 · محتويات الغلاف · Ambalaj içeriği · Содержимое картона

10115 2,4 GHz WIRELESS+ SET EVOLUTION

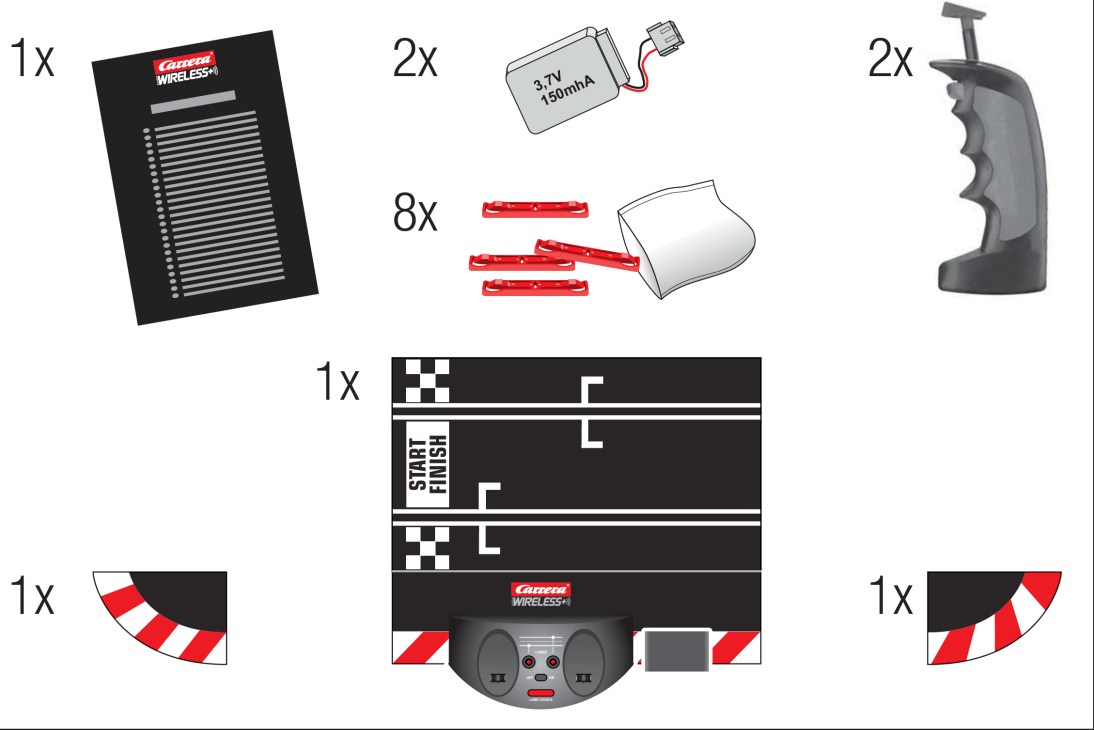

Montage- und Betriebsanleitung • Technische und designbedingte Änderungen vorbehalten	4
Assembly and operating instructions • Subject to technical and design-related changes	6
Instructions de montage et d'utilisation • Sous réserve de modifications techniques ou de design	8
Instrucciones de uso y montaje • Se reserva el derecho de efectuar modificaciones técnicas y relacionadas con el diseño	10
Instruções de montagem e modo de utilização • Reservados os direitos de alterações técnicas e no design	12
Istruzioni per il montaggio e l'uso • Con riserva di modifiche tecniche e di design	14
Montage- en gebruiksaanwijzing • Technische en designgeboden afwijkingen voorbehouden	16
Monterings- och bruksanvisning • Med reservation för tekniska och designrelaterade ändringar	18
Asennus- ja käyttöohjeet • Oikeus tekniikan ja muotoilun aiheuttamiin muutoksiin pidätetään	20
Montajse- og bruksanvisning • Det tas forbehold om endringer i teknikk og design	22
Ósszeszerelési és használati útmutató • Műszaki és konstrukciós változások előfordulhatnak	24
Instrukcja obsługi i montażu • Zastrzegamy sobie możliwość zmian	26
Návod na montáž a pre prevádzku • Technické zmeny a zmeny podmienené dizajnom sú vyhradené	28
Návod na montáž a pro provoz • Technické změny a změny podmíněné designem jsou vyhrazeny	30
Ръководство за монтаж и експлоатация • Запазваме си правото на технически промени и промени, наложени от дизайна	32
Οδηγίες συναρμολόγησης και λειτουργίας • Επιφύλαξη τεχνικών - σχεδιαστικών τροποίης	34
Instrucțiuni de montaj și de utilizare • Sub rezerva modificărilor tehnice și de design	36
Monterings- og driftsvejledning • Tekniske og designmæssige ændringer forbeholdes	38
安装和使用说明 • 保留因技术和外观设计需要进行更改的权利	40
取扱説明書取扱説明書の内容は予 • 技術・設計上、変更される場合があります。あらかじめご了承ください	42
조립과 작동 방법 • 기술과 디자인상 변동 소지 있음	44
إرشادات التركيب و الاستخدام • يبقى حق التعديرات التقنية والتصميمية محفوظا	46
Montaj ve işletme kılavuzu • Teknik ve dizayna bağlı değişiklikler mahfuz tutulur	48
Инструкция по монтажу и эксплуатации • Возможны технические и обусловленные дизайном изменения	50

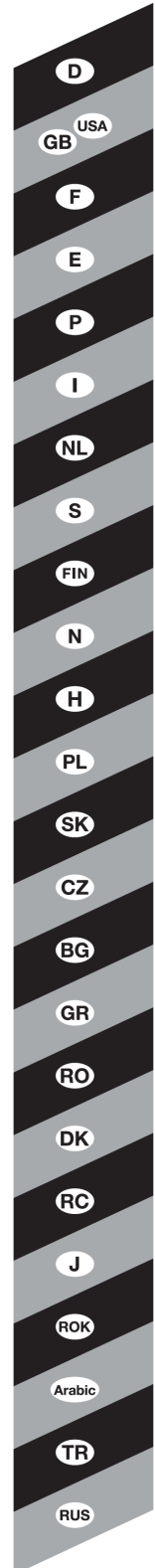



Table of contents

Safety instructions	6
Declaration of Conformity	6
Contents of package	6
Description	6
Before first use	6
Care of the battery	6
Electrical connection	6
Binding process	7
Preparation of start	7
Troubleshooting	7
Maintenance and care	7
Technical specifications	7
Warnings	7

Welcome

Welcome to the Team Carrera!
This instruction manual contains important information on setting up and operating your Carrera EVOLUTION 2.4 GHz WIRELESS+ system. Please read them carefully and keep them in a safe place afterwards. If you have any queries, please do not hesitate to contact our distributor or visit our websites: carrera-toys.com

Please check the contents for completeness and possible transport damage. The packaging contains important information and should also be retained.

Should you need any information on operating the Carrera EVOLUTION racetrack, please refer to the corresponding instruction manual.

We hope you will derive a lot of pleasure from your new 2.4 GHz WIRELESS+ set for Carrera EVOLUTION.

Safety instructions

WARNING! Not suitable for children under 36 months. Danger of suffocation due to small parts which may be swallowed. Caution: risk of pinching caused by function.

WARNING!
Only allow children at least 8 years old to use the battery charger. Sufficient instruction must be given to enable the child to use the battery charger in a safe way and explain that it is not a toy and must not be played with.

Important note to parents:
Transformers and power supply units are not suitable to be used as toys. The use of such products needs to be constantly supervised by the parents.

- Regularly check the track, cars and charger for damage to cables, plugs and housings! Replace defective parts.
- The car racetrack is not suitable for outdoor operation or operation in wet locations! Keep away from liquids.
- Do not place any metal parts onto the track to avoid short-circuits. Do not place the track in the immediate vicinity of delicate objects, as these could be damaged by cars hurled from the track.
- Pull the plug before cleaning the racetrack! Only use a damp cloth for cleaning, no solvents or chemicals. When it is not in use, store the track in a dry and dust-protected location, preferably in the original cardboard box.
- Do not operate race track at face- or eye-level – risk of injury due to cars being catapulted off the track.
- Misuse of transformer can cause electrical shock.
- The toy is only to be connected to Class II equipment bearing the following symbol.
- The toy and the charger must only be used with a transformer designed for toys.
- If the supply cord is damaged, it must be replaced by the manufacturer, its service agent or similarly qualified persons in order to avoid danger.

This appliance is not intended for use by persons (including children) with reduced physical, sensory or mental capabilities, or lack of experience and knowledge, unless they have been given supervision or instruction concerning use of the appliance by a person responsible for their safety. Children should be supervised to ensure that they do not play with the appliance.
Instruct the child not to try and recharge non-rechargeable batteries because of the danger of explosion.

Please also observe the safety instructions included with the basic sets of Carrera EVOLUTION.

Declaration of Conformity

The company Stadtbauer Marketing + Vertrieb GmbH, hereby confirms that the product „2.4 GHz WIRELESS+“ complies with the fundamental requirements of Guideline 1999/5/EC (R&TTE).
The Declaration of Conformity can be called up from the following address: www.carrera-toys.com

Contents of package

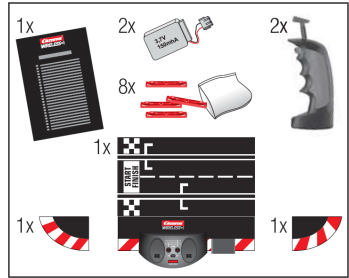

- 2 2.4 GHz WIRELESS+ speed controllers
- 1 2.4 GHz WIRELESS+ connecting section
- 2 LiPo rechargeable batteries for speed controllers
- 2 Shoulder end sections (left and right)
- 8 Track section bolts
- 1 Instructions

Description

We hope you will derive a lot of pleasure from your new 2.4 GHz WIRELESS+ set for Carrera EVOLUTION. The 2.4 GHz radio technology with frequency-hopping is free of interference and offers a range of up to 15 metres. Thanks to powerful lithium polymer rechargeable battery, continuous play for up to eight hours is possible and stand-by operation for over 80 days.

Before first use

Before first using the speed controller, the rechargeable battery supplied (2) must be inserted in the controller. Unscrew the battery compartment (1) on the underside of the speed controller. Connect the battery plug into the socket in the speed controller and put the battery in place in the compartment. Finally screw down the cover of the battery compartment again.

The batteries are recharged at the factory; they should however be topped up completely before they are first used.



Care of the battery

To make sure the battery performs well for as long as possible, the following points should be observed regarding its care and storage.

- Before first using them, new batteries should always be charged fully.
 - With a fully-charged battery, continuous play is possible for up to eight hours. When the battery power is falling off, range of the speed controller will diminish. As soon as you notice this, the battery should be fully recharged.
 - If it is not to be used for an extended period, remove the battery and store the controller at room temperature (16-18 °C) in a dry place. To prevent a deep discharge of the battery, the stored battery should be charged every 2 to 3 months.
- After disconnecting the battery, you must bond the hand controller to the connector track once again.

Electrical connection

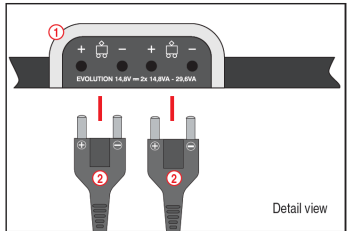
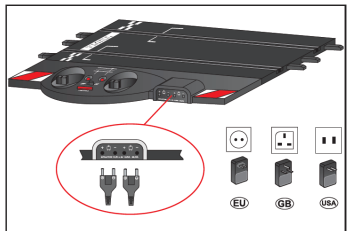

Connect the two plugs (2) on the transformer with the connection sockets (1) on the connector track, taking care not to reverse the polarity of the plugs and sockets!

Advice: The toy must not be connected to extraneous electrical equipment, plugs, cables or other objects: short-circuits and power surges can thus be avoided. The Carrera Evolution racing track only functions faultlessly with the original Carrera Evolution transformer.

In the event of a short-circuit or an overload, the connector track switches off for about 5 seconds and both LEDs start to flash.

Binding process



To permit the hand controllers to control the cars, they must once be 'bonded' to the connector track. To do this, switch on the racetrack. Both control LEDs on the connector track now light continuously.

- To bond the first controller, press once on the button "Lane choice" (1). The left LED now lights continuously. Now press the "Bonding button" (2) of the first hand controller. If bonding is successful, both LEDs will then light continuously. The controller is now bonded to the connector track and controls the car on the front lane.



2
To bond the second controller, press twice on the button "Lane choice" (1). The right LED now lights continuously. Now press the "Bonding button" (2) of the second hand controller. If bonding is successful, both LEDs will then light continuously. The controller is now bonded to the connector track and controls the car on the rear lane.

To display the address set for the speed controller, press once on the binding button (1) on the top of the speed controller. The LED (2) will then flash, according to the address set.



Preparation of start

Before using them for the first time, the 2.4 GHz Wireless+ hand controllers should be fully charged. To do this, put the controllers in the charger and switch on the track. While charging is in progress, the LEDs (1) on the hand controllers will flash. When charging is complete, the LEDs (2) light continuously. By employing a lithium-polymer battery, the hand controllers can be topped up at any time.



If the speed controller is not actuated, it switches automatically after about 30 seconds into energy-saving mode. The speed controller can be reactivated by pressing the tappet or the lane-change button.

Troubleshooting

In case of any malfunctions, please check the following:

- Is the connector track properly connected in the running direction?
- Are the power pack plugs inserted the right way round?
- Is the battery fully charged?
- Does the LED on the controller flash while charging?
- Is the speed controller bound to the receiver?
- Is the hand controller bonded to the connector track?
- Has the speed controller got a duplicate address assignment?
- Is the connector track in stand-by mode?

Note:
During operation small car parts as spoilers or mirrors may get off or brake due to being original detailed parts of the car model. To avoid this it is possible to remove them before operation.

All Carrera spare parts are available in the webshop: carrera-toys.com
Delivery exclusively to Germany, Austria, Netherlands, Belgium and Luxembourg.

Maintenance and care



To ensure a proper operation of the motor-racing circuit, all race-track components should be regularly cleaned. Pull the plug prior to cleaning.

- 1 Racetrack:** Keep the track surface and track slots clean with a dry cloth. Do not use any solvents or chemicals for cleaning. When it is not in use, store the racetrack in a clean and dust-protected location, preferably in the original cardboard box.

Technical specifications



Output voltage: Toy transformer

14,8 V \approx 2 x 14,8 VA (Carrera EVOLUTION)

lithium polymer rechargeable battery:
3,7 \approx 150mAh - 0.55 Wh

Maximum charging time: 2 hours

Electricity modes:

- 1.) Operating mode = cars are operated via speed controllers
- 2.) Idle mode/Stand-by mode = speed controllers not activated, no game
CURRENT CONSUMPTION < 0.5 watt/0.5W
- 3.) Stand-by mode = after approx. 20 minutes idle mode the connecting section switches to stand-by mode.
The LED is not lit any more.
CURRENT CONSUMPTION < 0.5 watt/0.5W
By switching the connection track off and then on again the stand-by modus is terminated and the track is once again in 'sleep' mode.
- 4.) To switch off = power supply unit disconnected from mains supply

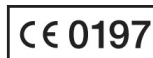

This device is marked by "selective sort through" symbol related to sort through domestic, electric and electronic, waste. This means the product must be treated by a specialized "sorting/collecting" system in accordance with European directive 2002/96/CE, to reduce the impact upon environment. For more precise information, please contact your local administration. Electronic product which are not going through special collecting, are potentially dangerous for environment and human health, because of dangerous substance.



Output voltage: Toy transformer

14,8 V \approx 2 x 14,8 VA (Carrera EVOLUTION)

lithium polymer rechargeable battery:
3,7 \approx 150mAh - 0.55 Wh

Maximum charging time: 2 hours

Electricity modes:

- 1.) Operating mode = cars are operated via speed controllers
- 2.) Idle mode/Stand-by mode = speed controllers not activated, no game
CURRENT CONSUMPTION < 0.5 watt/0.5W
- 3.) Stand-by mode = after approx. 20 minutes idle mode the connecting section switches to stand-by mode.
The LED is not lit any more.
CURRENT CONSUMPTION < 0.5 watt/0.5W
By switching the connection track off and then on again the stand-by modus is terminated and the track is once again in 'sleep' mode.
- 4.) To switch off = power supply unit disconnected from mains supply



Conforms to the safety requirements of ASTM F963.

Requirement for FCC Part 15

Warning: Changes or modifications not expressly approved by the party responsible for compliance could void the user's authority to operate the equipment.

Note: This equipment has been tested and found to comply with the limits for a Class B digital device, pursuant to Part 15 of the FCC Rules. These limits are designed to provide reasonable protection against harmful interference in a residential installation. This equipment generates, uses and can radiate radio frequency energy and, if not installed and used in accordance with the instructions, may cause harmful interference to radio communications. However, there is no guarantee that interference will not occur in a particular installation.

If this equipment does cause harmful interference to radio or television reception, which can be determined by turning the equipment off and on, the user is encouraged to try to correct the interference by one or more of the following measures:

- Reorient or relocate the receiving antenna.
- Increase the separation between the equipment and receiver.
- Connect the equipment into an outlet on a circuit different from that to which the receiver is connected.
- Consult the dealer or an experienced radio/TV technician for help.

Warnings

Guidelines and warnings about using the LiPo battery/batteries:
LiPo rechargeable batteries are much more sensitive than the traditional alkaline or NiMH rechargeables. For this reason all instructions and warnings must be scrupulously observed. Incorrect treatment of LiPo rechargeable batteries may cause a fire. In handling, charging and using the LiPo battery/batteries supplied, you take over all responsibility for the risks attached to lithium batteries.

- Non-rechargeable batteries must not be recharged!
- For recharging batteries, only the charging cradle supplied may be used. If this instruction is disregarded, there is a risk of fire which may endanger your health and/or cause damage to property. NEVER use any other charging unit!
- Rechargeable batteries may only be recharged under adult supervision. When charging, never leave the battery unattended. When you recharge the battery, you should always be in the vicinity to keep watch on the process so that you can react to any possible problem.
- If the battery swells or deforms during either discharge or charging process, stop the process immediately. Remove the battery as fast and as carefully as possible and place it on a safe and open area away from any flammable materials, and keep it under observation for at least 15 minutes. If you continue to charge or discharge a battery which has already started to swell or deform, there is danger of fire! Even at the slightest sign of swelling or deforming, the battery must be taken out of service.
- The battery supplied must be charged in a safe place away from flammable materials.
- Store the battery at room temperature (16 - 18 °C) in a dry place. Do not expose the battery to direct sunlight or any other sources of heat. Temperatures over 50 °C are generally to be avoided.
- Always recharge the battery after use to avoid the possibility of its becoming deep discharged. When it is not in use, recharge the battery from time to time, say every 2-3 months. Failure to observe the methods of handling described above may lead to defects.
- When changing batteries do not use any sharp or pointed objects or tools. Avoid damaging the protective foil around the battery at all costs.
- When replacing defective batteries, only the recommended battery types may be used. Damaged or unusable batteries are hazardous waste, and must be disposed of accordingly.
- Never throw batteries, rechargeable or otherwise, on the fire or expose them to high temperatures. This may cause a fire or an explosion.
- The electrolyte and electrolyte vapour in the LiPo batteries are hazardous to health. Always avoid direct contact with electrolyte. If electrolyte makes contact with skin, eyes or other parts of the body, it must immediately be washed out or off with plenty of fresh water and a doctor must be consulted.
- Rechargeable batteries are not toys and must not fall into the hands of children. Keep batteries inaccessible to children.
- The connector clips / battery connections must never be short-circuited!
- The toy is only to be operated with a transformer or power pack designed for use with toys!
- The transformer / the power pack is not a toy!