

## 1.6 User Manual



**Dark Lizzard**  
**Speed Fighter**  
**Turbo Fire 2**  
**Sun Charger 2**

#370160113  
#370160114  
#370160116  
#370160117

- D** *Montage- und Betriebsanleitung*
- GB USA** *Assembly and operating instructions*
- F** *Instructions de montage et d'utilisation*
- E** *Instrucciones de montaje y de servicio*
- I** *Istruzioni per il montaggio e l'uso*
- NL** *Montage- en gebruiksaanwijzing*
- P** *Instruções de montagem e modo de utilização*
- S** *Monterings- och bruksanvisning*
- FIN** *Asennus- ja käyttöohje*
- PL** *Instrukcja montażu i obsługi*
- H** *Szerelési és használati utasítás*
- SLO** *Navodila za montažo in uporabo*
- CZ** *Návod k montáži a obsluze*
- SK** *Návod na montáž a obsluhu*
- HR** *Uputa za montažu i uporabu*
- N** *Montajse- og bruksanvisning*
- DK** *Monterings- og driftsvejledning*
- TR** *Montaj ve işletme kılavuzu*
- Arabic** *إرشادات التركيب و الاستخدام*

**RC Power**  
[carrera-rc.com](http://carrera-rc.com)  
*Made in China, Huizhou*

Sicherheitsbestimmungen · Safety instructions · Consignes de sécurité  
Disposiciones de seguridad · Norme di sicurezza · Veiligheidsbepalingen  
Prescrições de segurança · Säkerhetsbestämmelser · Turvallisuuohjeet  
Zasady bezpieczeñstwa · Biztonsági rendelkezések · Varnostna določila  
Bezpečnostní předpisy · Bezpečnostné predpisy · Sigurnosne odredbe  
Sikkerhetsbestemmelser · Sikkerhedsbestemmelser · Emniyet kaideleri

أنظمة السلامة

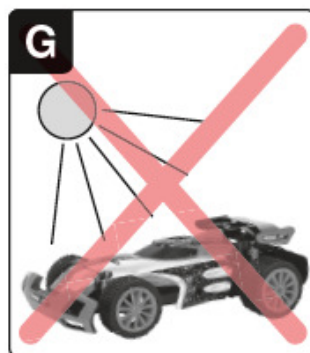
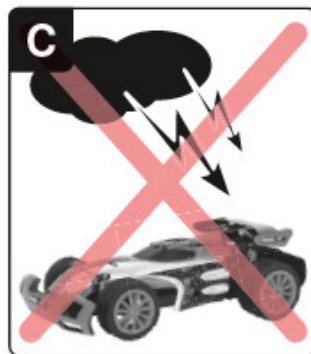

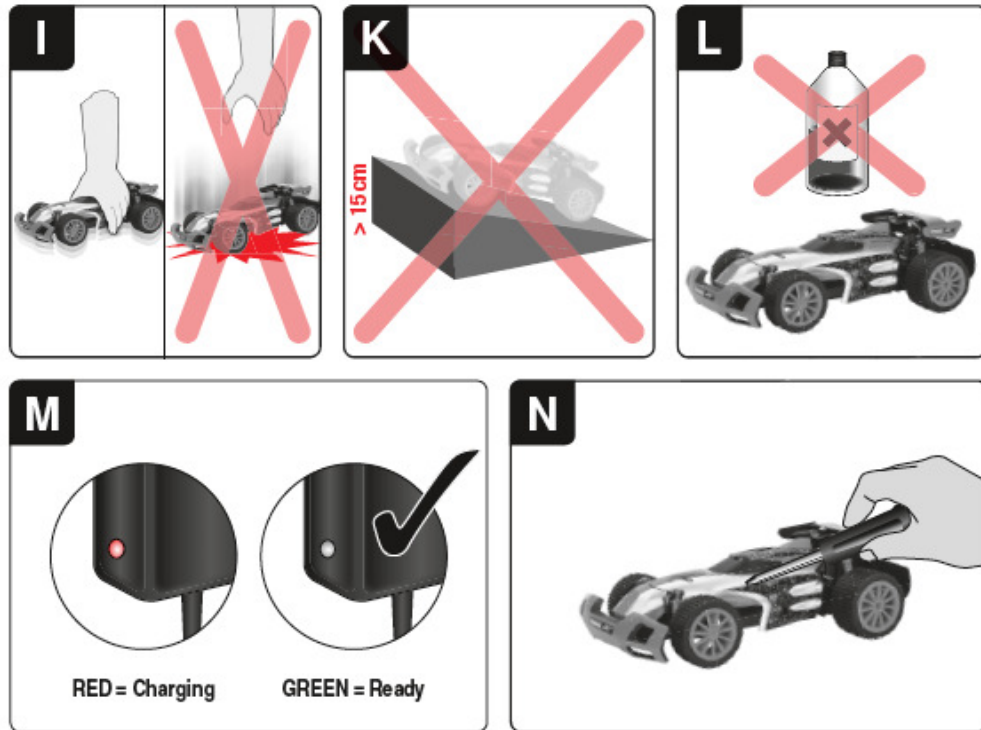

**1**

1x 3,7 V  
600 mAH  
2,22Wh!

2x AAA Battery

\* Nur ein Modell erhalten - Certains seul un modèle - contém un model - Contiene sólo un modelo - Contiene un solo modelo - Bekaf slechts één model - Contém só uma miniatura - Endast en modell - Sisällää vain yhden pieno-ajattelun - Získáte tylko jedno model - Csak egy modell tartalmaz - Vrijudan samo et model - Obzahuje pouze jedno model - Imaholder kun samme modell - Indeholder kun en model - Содержи только один модель - Sadece tek model dahildir

**2**

Green = Connection OK

Red = Charging

Green = Ready

**3**

3,7 V  
600 mAH  
2,22Wh!

**4**

2x AAA Battery

**5**

OFF ON

**6**

ON OFF

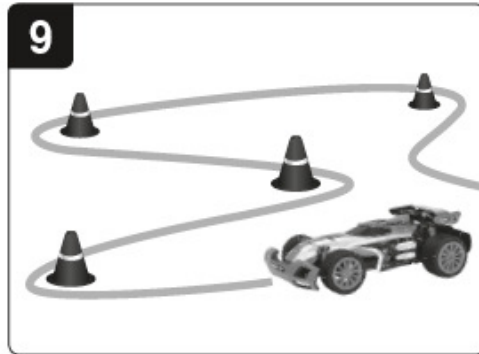
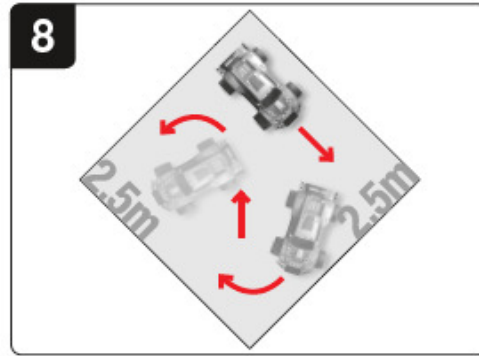
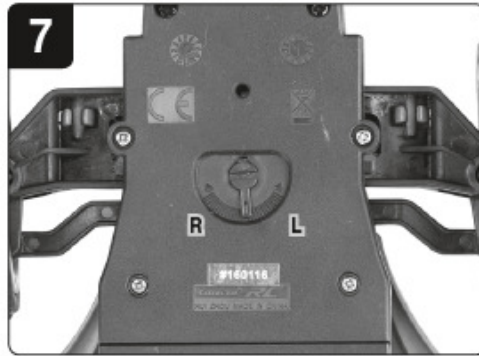

**Dear customer**

Congratulations on purchasing a Carrera RC model car, manufactured in accordance with the latest technology. As it is our constant endeavour to develop and improve our products, we reserve the right to make modifications, either of a technical nature or with respect to features, materials, and design, at any time, and without prior notice. For this reason, no claims will be accepted for any slight deviations in your product from the data and illustrations contained in these instructions. These operating and assembly instructions are an integral part of the product. Non-observance of these operating instructions and the safety instructions they contain will render the guarantee null and void. These instructions are to be kept for future reference and in the event that the product is passed on to a third party.

For the latest version of these operating instructions and information on replacement and spare parts available, please visit [carrera-rc.com](http://carrera-rc.com) in the service area.

**Guarantee conditions**

A Carrera product is built to high technical standards and is to be treated with care. Please ensure that you observe all the instructions contained in this guide. All components have been subjected to careful inspection (technical modifications and alterations to the model for the purpose of product improvement are reserved).

Should any faults nevertheless occur, guarantee is assumed within the scope of the following conditions: The guarantee covers demonstrable material or manufacturing defects that existed at the time that the Carrera product was purchased. The guarantee period is 24 months beginning with the date of purchase. The guarantee does not extend to wearing parts (such as Carrera RC rechargeable batteries, antennas, tyres, gearbox components etc.), damage caused by improper treatment or use (such as performing jumps in excess of the recommended height, dropping the product etc.), or unauthorised intervention. Repair may only be performed by Stadtbauer Marketing + Vertrieb GmbH itself or by a company it has authorised to do so. Within the scope of this guarantee, either the product as a whole or only the defective components will be replaced or equivalent substitution performed, as deemed appropriate by Stadtbauer Marketing + Vertrieb GmbH. The guarantee does not cover transport, packaging or travel costs or any damage for which the buyer is responsible. These costs are to be covered by the buyer. Guarantee claims will only be accepted from the original purchaser of the Carrera product.

Guarantee claims can only be accepted when:

- The card has been filed in properly and sent in together with the defective Carrera product and the purchase receipt/invoice/cash-register receipt.
  - No unauthorised alterations have been made by the buyer to the guarantee card.
  - The toy has been treated in accordance with the operating instructions and subjected to its intended use.
  - The damage/defect/operation is not due to acts of God or normal wear and tear.
- Guarantee cards cannot be replaced.

Note for EU countries: Reference is hereby made to the seller's statutory guarantee obligation, to the extent that this guarantee obligation is not restricted by the product guarantee.

**Declaration of conformity**

Stadtbauer Marketing + Vertrieb GmbH hereby declares that this model including the controller conforms with the fundamental requirements of the following EC directives: EC Directives 2009/48 and 2004/108/EC regarding electromagnetic compatibility and the other relevant regulations of Directive 1999/5/EC (R&TTE). The original declaration of conformity can be requested from [carrera-rc.com](http://carrera-rc.com).



Maximum radio-frequency power transmitted <10 dBm

**Warning!**

 **WARNING!** This toy contains small parts which can be swallowed and is therefore not suitable for children under 3 years of age. **WARNING!** danger of pinching during operation! Remove all packaging materials and wire fastenings before handing the toy over to the child. Please retain the packaging and address for information and in the event of any questions.



This symbol, showing refuse bins with a cross through them, denotes that empty batteries, rechargeable batteries, button cells, rechargeable battery packs, equipment batteries, disused electrical equipment, etc. should not be disposed of in domestic refuse, as they are harmful to the environment and health. Please help to preserve environment and health and talk to your children about the correct disposal of used batteries and disused electrical equipment. Batteries and disused electrical equipment should be handed in to the usual collection points where they can be properly recycled.

Do not mix dissimilar battery types or employ new and used batteries together. Empty batteries should be removed from the product. Do not recharge non-rechargeable batteries due to risk of explosion.

**WARNING!** Rechargeable batteries are only to be charged by adults.

**Never leave the battery unattended while it is charging.** Exhausted batteries are to be removed from the toy. Rechargeable batteries should be removed from the product before charging. Supply terminal are not to be short-circuited. Only use the batteries recommended or equivalent types. If in regular use the charger must be examined for damage to the cord, plug, covers and all other parts. If any signs of damage are found the charger may only be used again after repair work has been completed. The external flexible cable or cord of this charger cannot be replaced: If the cord is damaged the charger shall be scrapped.

**FCC statement**

This device complies with Part 15 of the FCC Rules. Operation is subject to the following two conditions:

- (1) this device may not cause harmful interference, and
  - (2) this device must accept any interference received, including interference that may cause undesired operation.
- Changes or modifications not expressly approved by the party responsible for compliance could void the user's authority to operate the equipment.

**Safety instructions**

**A** A Carrera RC vehicle is a remote-controlled model car that uses special rechargeable batteries for this purpose. Only original Carrera RC Li-Ion rechargeable batteries may be used. Rechargeable batteries are to be removed from the toy before being charged.

**B** The Carrera RC vehicle is designed for hobby use only and may only be operated on tracks and in spaces especially intended for this purpose. **WARNING!** Do not use the Carrera RC vehicle in road traffic.

**C** Do not operate the car beneath overhead high-voltage cables or broadcasting masts or during a storm! Atmospheric disturbances can affect the operation of the vehicle. When there a large temperature differences between your car's garage and the running track, please wait until the vehicle has had time to acclimatise. This will help prevent condensation forming and the possibility of malfunctions resulting.

**D** Never operate the product on grass surfaces. There is the risk of grass hindering the movement of the axles, which can lead to the motor overheating. Do not use the Carrera RC vehicle for transporting goods, persons or animals.

**E** Never use the Carrera RC vehicle outdoors during rain or snowfall. The car must not be run through water, puddles and snow, and must always be kept stored in a dry place.

**F** Never operate the vehicle near rivers, ponds or lakes, to avoid the risk of the Carrera RC car falling into the water. Avoid running on courses which are laid exclusively with sand.

**G** Do not expose the Carrera RC vehicle to direct sunlight. To avoid the electronics in the car overheating, when temperatures are above 35 °C, regular short pauses in operation are essential.

**H** Never subject the Carrera car to repeated changes of load – that means continuously reversing it.

**I** Always place the car on the floor by hand. Never throw the car on the floor from a standing position.

**K** Avoid jumping from jumps or ramps higher than 15 cm (0.49 ft.).

**L** Never use strong solvents for cleaning the car.

**M** To avoid malfunctions to the control system resulting in uncontrolled operation of the Carrera RC vehicle, check that the controller batteries and the rechargeable batteries in the vehicle have sufficient charge. Supply terminals are not to be short-circuited.

**N** The Carrera RC vehicle must be inspected before and after operation, each time it is used, to ensure that it has not become disassembled. Any screws or nuts that may have become loosened during operation must be tightened.

## Instruction Manual

### Contents of package

- 1** 1x Carrera RC Vehicle  
1x Controller  
1x USB charger cable and charging cradle  
1x Rechargeable Battery  
2x 1.5 V Micro AAA batteries (non-rechargeable)

### Charging the rechargeable battery via computer

**2** Take care only to charge the lithium ion battery supplied with the lithium ion charging unit (USB charger cable) also supplied.

If you attempt to recharge the battery with any other lithium ion battery charger or any other type of charger, this may result in serious damage.

You can recharge the rechargeable battery with the respective USB charger cable from a USB port of a computer:

- Connect the USB charger cable with the USB port of a computer **1**. The LED on the USB charger cable lights green and indicates that the charger is correctly connected to the computer. Place the rechargeable battery in the charging cradle on the USB cable **2**. The LED on

the USB charger cable lights red to indicate that the battery is being charged. The USB charger cable is so designed that reversed polarity is not possible.

- It lasts about 90 minutes to recharge a discharged (NOT a deep-discharged) battery. When the battery is fully charged, the LED display on the USB charger cable lights green again.

**Note: when delivered, the lithium ion rechargeable battery contained is already part-charged, so the first charging operation will not last so long.**

**Always recharge the battery after use to prevent its becoming deep discharged. After use, the battery must be allowed to cool down for at least 20 minutes before it can be fully recharged. Failure to observe this pause may damage the battery. Recharge the battery occasionally (suggested every 2-3 months).**

**Failure to treat the battery as described above can lead to its becoming defective.**

### Installing the rechargeable battery

- 3** Using a screwdriver, remove the cover of the battery compartment in the Carrera RC car. Place the Carrera RC battery in the vehicle. Ensure the polarity is correct. Replace the compartment cover using a screwdriver.

### Inserting the batteries

- 4** Open the battery compartment with a screwdriver and insert the batteries in the remote control. Ensure the polarity is correct. Replace the compartment cover using a screwdriver.

### Now you can drive the car

The Carrera RC car and the remote control are bound as a factory setting.

- 5** 1. Switch the car ON at the ON/OFF switch. The LED on top of the car will flash rhythmically.

- 6** 2. Switch on the controller. The LED on top of the controller will flash rhythmically.

After a few seconds, the LEDs on the car and on the controller will light continuously, meaning the bind has been made.

- 7** Adjusting the steering  
If the Carrera RC vehicle is found to pull towards the left or right while moving, use the adjuster control shown in the illustration to adjust the car's track precision.

### Let's practise!

- 8** **Warning!** This vehicle reaches high speeds! Practice on an empty surface at least 2.5 metres (8.2) square. When first starting, be very careful when operating the gas pedal.

- 9** Now it's time to practise! Set up a Carrera RC vehicle racing track in a large empty area, using cones/posts, empty cans, or similar objects. The basic technique to adopt when operating a Carrera RC is to drive fast on the straight sections and to slow down in the curves.

- When changing from the first battery to the second battery, you must stop running for at least ten minutes. At the next change, a pause of at least 20 minutes is absolutely essential.
- Avoid constant motor operation.
- If the car switches itself off several times one after another, the battery is dead. Please recharge the battery.
- To switch off after use, follow the steps in the reverse order.
- After use, remove or disconnect the battery. Always recharge the battery after use to prevent its becoming deep discharged. After use, the battery must be allowed to cool down for at least 20 minutes before it can be fully recharged.
- Always keep the rechargeable battery stored outside the vehicle.
- Clean the Carrera RC car after use.

### Controller functions

- 10** Full Function  
You can steer the car in any direction using the joysticks:  
Joystick on left: forwards/backwards  
Joystick on right: left/right
- 11** The LED on the controller lights as soon as you move one of the two joysticks up or down, left or right.
- 12** If you do not touch one of the joysticks, the LED is not lit, irrespective of whether the ON/OFF switch is set at ON or OFF.

### Trouble shooting

Problem: Car does not move.

Cause: Either the switch on the controller or the car is set to OFF.  
Solution: Switch on.

Cause: There is no rechargeable battery in the car or the battery is too weak.  
Solution: Insert charged battery.

Cause: The car has come to a stop at an obstacle.  
Solution: The voltage surge protector has switched the car off. Turn the ON/OFF switch on the car to OFF, then back to ON, and place the car on a clear surface.

Cause: The battery or rechargeable battery in the transmitter or model is too weak.  
Solution: Insert new battery or recharged battery.

Cause: When it was last used, the model was not switched off, and the battery is discharged.  
Solution: Please recharge the battery.

Cause: The vehicle is very warm.  
Solution: Switch both car and controller off and allow the car to cool down for about 30 minutes.

Problem: Car cannot be controlled.

Cause: Vehicle starts moving unintentionally.  
Solution: First turn on the transmitter, only then the vehicle.

### 5 6 7

Errors and charges accepted  
Colours / final design - change accepted  
Technical changes and design-related changes accepted  
Photograms - symbolic photos

  
**DISTRIBUTORS**

**AUSTRIA**  
 Stadlbauer Marketing +  
 Vertrieb GmbH  
 Rennbahn Allee 1  
 A-5412 Puch / Salzburg  
 Phone ++43 682 88821-0  
 Fax ++43 682 88821-512  
 Internet www.carrera-rc.com

**GERMANY**  
 Stadlbauer Marketing +  
 Vertrieb GmbH  
 Rennbahn Allee 1  
 A-5412 Puch / Salzburg  
 Phone ++49 911 7099-0  
 Fax ++49 911 7099-119  
 Internet www.carrera-rc.com

**HONG KONG**  
 Stadlbauer (HK) Ltd.  
 Room 1917,  
 North Tower,  
 Concordia Plaza  
 1 Solencia Museum Road,  
 Tsimshatsui East,  
 Kowloon Hong Kong  
 Phone ++852 2722 0820  
 Fax ++852 238 7 0782  
 Internet www.carrera-rc.com

**USA/CANADA/MEXICO**  
 Carrera of America Inc.  
 2 Corporate Drive  
 Cranbury  
 NJ 08512,  
 USA  
 Phone ++1 609 409 8510  
 Fax ++1 609 409 8810  
 Email reception@  
 carreratoy.com  
 Internet www.carrera-rc.com

**BENELUX**  
 Stadlbauer Marketing +  
 Vertrieb GmbH  
 Landheerlaan 33  
 NL-6114 MP Susteren  
 Email service@benelux@  
 carreratoy.com  
 Internet www.carrera-rc.com

**FRANCE**  
 Stadlbauer Marketing +  
 Vertrieb GmbH  
 21 B, Route Nationale  
 Domaine de L'Hancardrie  
 FR-59320 Ernates-en-Wéppes  
 Email carreratoyseorange.fr  
 Internet www.carrera-rc.com

**HUNGARY**  
 Magyarorszag Importer  
 Stadlbauer Marketing +  
 Vertrieb GmbH  
 Rennbahn Allee 1  
 A-5412 Puch / Salzburg  
 Phone ++36 305558502  
 Email office@stadlbauer-toys.hu  
 Internet www.carrera-rc.com  
**Service:**  
**GAME PARK - VINCZE ZOLTAN**  
 Borky Lili utca 36,  
 1171 Budapest - Hungary  
 Phone ++36 1 2587809  
 Email vincze@online.hu

**POLAND**  
 Stadlbauer Marketing +  
 Vertrieb GmbH  
 Rennbahn Allee 1  
 A-5412 Puch / Salzburg  
 Phone ++48 22 645 14 20  
 Fax ++48 22 645 14 21  
 Email office@stadlbauer-toys.pl  
 Internet www.carrera-rc.com  
**Service:**  
**REKMAN**  
 ul. Fabryczna 14  
 53-609 Wroclaw  
 Poland  
 Phone ++48 71 359 48 19  
 Fax ++48 71 359 48 21  
 Email j@qj@rekman.com.pl

**SPAIN/PORTUGAL**  
 Stadlbauer Iberia SLU  
 Calle Fluvia, 97, 1ª 2ª  
 08019 Barcelona - Spain  
 Phone ++34 93 303 63 35  
 Email contacto@carrera-toys.com  
 Internet www.carrera-rc.com

**CARRERA RC DISTRIBUTORS**

**AUSTRALIA**  
 Zimble Pty Ltd.  
 898 Heidelberg Road  
 Ivanhoe, Victoria 3079  
 Australia  
 Phone ++ 61 3 8481 1000  
 Fax ++ 61 3 8487 2311  
 Email sales@zimble.com.au  
 Internet www.zimble.com.au

**BULGARIA**  
 Ivantchov Ltd.  
 76a, Maria Luiza Blvd.  
 BG-1202 Sofia  
 Phone ++359 283 22020  
 Fax ++359 283 22020  
 Email kivanchov@vel.bg

**CHINA**  
 Shanghai Wowgama Commercial  
 Company Ltd.  
 Room 110, Tower 1,  
 German Centre, 88 Koyuan Road,  
 (Zhongjiang Hi-Tech Park),  
 Pudong, Shanghai, (Zip: 201203)  
 China  
 Phone ++86 21-53821682  
 Mobile ++86 15577449439  
 Email sddy@shanghaiwowgama.com.cn  
 Internet www.wowgama.net.cn

**CZECH REPUBLIC**  
 ConQuest entertainment a.s.  
 Houbatinska 11  
 CZ-198 00 Praha 9 - Hloubetin  
 Phone ++420 284 000 175  
 Fax ++420 284 000 101  
 Email redim.kaloc@conquest.cz  
 Internet www.autodrahycz

**ESTONIA**  
 Aniol Ltd.  
 Madisa 7  
 EE-74114 Maardu  
 Phone ++372 69 89 100  
 Fax ++372 69 89 101  
 Email aniole@aniol.ee  
 Internet www.wanvolee

**GREECE**  
 Enerxis Dynamic Media Ltd.  
 68, Iliu Street  
 11744, Neos Kosmos  
 Athens  
 Greece  
 Phone ++30 210 9011900  
 Fax ++30 210 9026700  
 Email info@enerxis.eu  
 Internet www.enerxis.eu

**HONG KONG**  
 Chun Lee (China) Industrial Limited  
 RM. 1801-5, 18/F,  
 King Palace Plaza,  
 25A Sha Tsui Road,  
 Tsim Wan,  
 NT Hong Kong  
 Email cdy@chunley.com  
 Mobile ++ 852 9109 6678

**INDIA**  
 Karma Solutions  
 121A, Dahsara Industrial Centre,  
 Link Rd - Goregaon (W),  
 Mumbai - 400104  
 India  
 Phone ++91 22 66716714  
 Mobile ++91 9820075400  
 Email karmasolutions7@gmail.com  
 Internet www.karma-toys.com

**ISRAEL**  
 TOP PLAY ISRAEL (TPH) LTD  
 Smitat Abazar Str. 8A - Industrial  
 Zone Sogula-Petach-Tikva, 4968108  
 Israel  
 Phone ++972 3 8323767  
 Fax ++972 3 8086074  
 Mobile ++972 52 8339866  
 Email top-play@012.net.il  
 Internet www.TopPlay-toys.com

**LEBANON**  
 F. ADLAD  
 Robar1565, Jounieh Lebanon  
 Twin Towers Building Blk A  
 Sarba High Way  
 Jounieh - Lebanon  
 Phone ++961 9 840505  
 Fax ++961 9 635473  
 Email fawaded@fawad.com  
 riad.ouad@fawad.com

**NEW ZEALAND**  
 F.W. Cave Ltd.  
 15 Old North Road  
 P.O. Box 278  
 Kumau 0841  
 Auckland - New Zealand  
 Phone ++64 9 415 7766  
 Fax ++64 9 415 7099  
 Email sales@fwcave.co.nz  
 Internet www.fwcave.co.nz

**ROMANIA**  
 Seven Springrom srl.  
 Piata 29 Decembrie nr. 18  
 RO 610007 Piatra Neamt, jud. Neamt  
 Phone ++40-233-221117  
 Email office@seven-toys.ro  
 Internet www.seven-toys.ro

**RUSSIA**  
 Unitoys MSK Ltd.  
 Minsviki Street 7, Building 2  
 RU-123308, Moscow  
 Phone ++7 495 276 0266  
 Fax ++7 499 946 4616  
 Email office@unitoys.ru  
 Internet www.unitoys.ru

**SERBIA/MONTENEGRO**  
 Cool Play d.o.o.  
 Zivka Davidovica 13  
 11000 Beograd - Serbia  
 Phone ++381 11 3809143  
 Fax ++381 11 3809144  
 Email office@coolplays.rs

**SWITZERLAND**  
 Waldmeier AG  
 Neustrasse 50  
 CH-4823 Neuendorf  
 Phone ++41 82 987 88 18  
 Fax ++41 82 987 88 20  
 Email info@waldmeier.ch  
 Internet www.waldmeier.ch

**UNITED KINGDOM**  
 The Hobby Company Ltd.  
 Garththorpe Place, Knowthill  
 Milton Keynes MK5 8PG - UK  
 Phone ++44 1908 209 480  
 Fax ++44 1908 235 900  
 Email enquiries@hobbyco.net  
 Internet www.hobbyco.net

**UNITED ARAB EMIRATES**  
 Toyworld Distributor  
 P.O. Box 288, Gibco Building  
 Al Mafha Street, Sharjah  
 United Arab Emirates  
 Phone ++971 6 539 7418  
 Fax ++971 6 539 6682  
 Email toyworld@toyworldholding.net

 **WARNING:**  
 CHOKING HAZARD-SMALL PARTS  
 NOT FOR CHILDREN UNDER 3 YEARS.

 **ATTENTION:**  
 DANGER D'ETOUFFEMENT - PRESENCE DE PETITES PIÈCES  
 NE CONVIENT PAS AUX ENFANTS DE MOINS DE 3 ANS.

**carrera-rc.com**

Stadlbauer Marketing + Vertrieb GmbH · Rennbahn Allee 1 · 5412 Puch / Salzburg · Austria