

Prüfbericht - Nr.:
Test Report No.:

14023315 001

Seite 7 von 12
Page 7 of 12

User manual



#161001
#161002
#161003
#161006
Made in China, Huizhou.

Shadow Wolf
Speed Fighter
Agent Black - Tornado

Carrera® **RC**

- D** *Montage- und Betriebsanleitung*
- GB USA** *Assembly and operating instructions*
- F** *Instructions de montage et d'utilisation*
- E** *Instrucciones de montaje y de servicio*
- I** *Istruzioni per il montaggio e l'uso*
- NL** *Montage- en gebruiksaanwijzing*
- P** *Instruções de montagem e modo de utilização*
- S** *Monterings- och bruksanvisning*
- FIN** *Asennus- ja käyttöohje*
- PL** *Instrukcja montażu i obsługi*
- H** *Szerelési és használati utasítás*
- SLO** *Navodila za montažo in uporabo*
- CZ** *Návod k montáži a obsluze*
- BUL** *Инструкция за монтаж и експлоатация*

RC *Power*
carrera-rc.com

Prüfbericht - Nr.:
Test Report No.:
14023315 001

Seite 8 von 12
Page 8 of 12

Montage- und Betriebsanleitung <i>Technische und designbedingte Änderungen vorbehalten</i>	4	D
Assembly and operating instructions <i>Subject to technical or design-related modification</i>	8	GB USA
Instructions de montage et d'utilisation <i>Sous réserve de modifications techniques et des véhicules</i>	12	F
Instrucciones de montaje y de servicio <i>Reservado el derecho a modificaciones técnicas o debidas al diseño</i>	16	E
Istruzioni per il montaggio e l'uso <i>Con riserva di modifiche tecniche e dovute al design</i>	20	I
Montage- en gebruiksaanwijzing <i>Technische en door het design bepaalde wijzigingen voorbehouden</i>	24	NL
Instruções de montagem e modo de utilização <i>Sujeito a alterações de design e técnicas</i>	28	P
Monterings- och bruksanvisning <i>Tekniska och designrelaterade ändringar förbehållna</i>	32	S
Asennus- ja käyttöohje <i>Oikeudet teknisiin ja muotoilumuutosten aiheuttamiin muutoksiin pidätetään</i>	36	FIN
Instrukcja montażu i obsługi <i>Zastrzega się prawo do zmian technicznych oraz uwarunkowanych wzornictwem</i>	40	PL
Szerelési és használati utasítás <i>A műszaki és formatervezésből eredő módosítások joga fenntartva</i>	44	H
Navodila za montažo in uporabo <i>Tehnično in oblikovno pogojene spremembe pridržane</i>	48	SLO
Návod k montáži a obsluze <i>Technické a designem podmíněné změny vyhrazeny</i>	52	CZ
Инструкция за монтаж и експлоатация <i>Запазва се правото за технически и дизайнерски промени</i>	56	BUL

Dear customer

Congratulations on purchasing a Carrera RC model car, manufactured in accordance with the latest technology. As it is our constant endeavour to develop and improve our products, we reserve the right to make modifications, either of a technical nature or with respect to features, materials, and design, at any time, and without prior notice. For this reason, no claims will be accepted for any slight deviations in your product from the data and illustrations contained in these instructions. These operating and assembly instructions are an integral part of the product. Non-observance of these operating instructions and the safety instructions they contain will render the guarantee null and void. These instructions are to be kept for future reference and in the event that the product is passed on to a third party.

Guarantee conditions

A Carrera product is built to high technical standards and is to be treated with care. Please ensure that you observe all the instructions contained in this guide. All components have been subjected to careful inspection (technical modifications and alterations to the model for the purpose of product improvement are reserved).

Should any faults nevertheless occur, guarantee is assumed within the scope of the following conditions:

The guarantee covers demonstrable material or manufacturing defects that existed at the time that the Carrera product was purchased. The guarantee period is 24 months beginning with the date of purchase. The guarantee does not extend to wearing parts, damage caused by improper treatment or use, or unauthorised intervention. Repair may only be performed by Stadlbauer Marketing + Vertrieb Ges. m. b. H. itself or by a company it has authorised to do so. Within the scope of this guarantee, either the product as a whole or only the defective components will be replaced or equivalent substitution performed, as deemed appropriate by Stadlbauer Marketing + Vertrieb Ges. m. b. H. The guarantee does not cover transport, packaging or travel costs or any damage for which the buyer is responsible. These costs are to be covered by the buyer. Guarantee claims will only be accepted from the original purchaser of the Carrera product.

Guarantee claims can only be accepted when:

- The card has been filled in properly and sent in together with the defective Carrera product and the purchase receipt/invoice/cash-register receipt.
- No unauthorised alterations have been made by the buyer to the guarantee card.
- The toy has been treated in accordance with the operating instructions and subjected to its intended use.
- The damage/faulty operation is not due to acts of God or normal wear and tear.

Guarantee cards cannot be replaced.

Note for EU countries: Reference is hereby made to the seller's statutory guarantee obligation, to the extent that this guarantee obligation is not restricted by the product guarantee.

Declaration of conformity

Stadlbauer Marketing + Vertrieb Ges. m. b. H. hereby declares that this model including the controller conforms with the fundamental requirements of the following EC directives: 88/378/EEC and 2004/108/EC regarding electromagnetic

compatibility and the other relevant provisions of Directive 1999/5/EC (R&TTE). The original declaration of conformity can be requested from www.carrera-rc.com.

CE 0197

Warning!



This toy contains small parts which can be swallowed and is therefore not suitable for children under the age of 36 months. Caution: danger of pinching during operation! Remove all packaging materials and wire fastenings before handing the toy over to the child. Please retain the packaging and address for information and in the event of any questions.

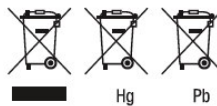

This symbol, showing refuse bins with a cross through them, denotes that empty batteries, rechargeable batteries, button cells, rechargeable battery packs, equipment batteries, disused electrical equipment, etc. should not be disposed of in domestic refuse, as they are harmful to the environment and health. Please help to preserve environment and health and talk to your children about the correct disposal of used batteries and disused electrical equipment. Batteries and disused electrical equipment should be handed in to the usual collection points where they can be properly recycled.

Do not mix dissimilar battery types or employ new and used batteries together. Empty batteries should be removed from the product. Do not attempt to recharge non-rechargeable batteries. Rechargeable batteries should only be charged under adult supervision. Exhausted batteries are to be removed from the toy. Rechargeable batteries should be removed from the product before charging. Supply terminal are not to be short-circuited. Only use the batteries recommended or equivalent types.

If in regular use the charger must be examined for damage to the cord, plug, covers and all other parts. If any signs of damage are found the charger may only be used again after repair work has been completed.

Requirement for FCC Part 15

Warning: Changes or modifications not expressly approved by the party responsible for compliance could void the user's authority to operate the equipment.

Note: This equipment has been tested and found to comply with the limits for a Class B digital device, pursuant to Part 15 of the FCC Rules. These limits are designed to provide reasonable protection against harmful interference in a residential installation. This equipment generates, uses and can radiate radio frequency energy and, if not installed and used in accordance with the instructions, may cause harmful interference to radio communications.

However, there is no guarantee that interference will not occur in a particular installation. If this equipment does cause harmful interference to radio or television reception, which can be determined by turning the equipment off and on, the user is encouraged to try to correct the interference by one or more of the following measures:

- Reorient or relocate the receiving antenna.
- Increase the separation between the equipment and receiver,
- Connect the equipment into an outlet on a circuit different from that to which the receiver is connected.
- Consult the dealer or an experienced radio/TV technician for help.

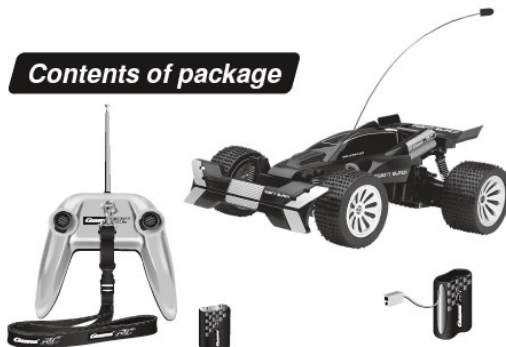
Contents of package

1x Shadow Wolf / Speed Fighter
Agent Black / Tomado
1x Controller
1x Lanyard

1x Battery Charger
1x Rechargeable Battery
1x Antenna
1x 9V Block Battery
(non-rechargeable)

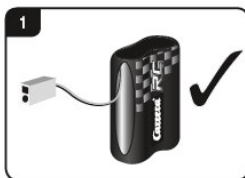
Safety instructions

A Carrera RC vehicle is a remote-controlled model car that uses special rechargeable batteries for this purpose. Only original Carrera RC Li-Ion rechargeable batteries may be used.



The Carrera RC vehicle is designed for hobby use only and may only be operated on tracks and in spaces especially intended for this purpose.
CAUTION! Do not use the Carrera RC vehicle in road traffic.

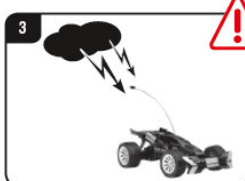

Do not operate the car beneath overhead high-voltage cables or broadcasting masts or during a storm! Atmospheric disturbances can affect the operation of the vehicle.

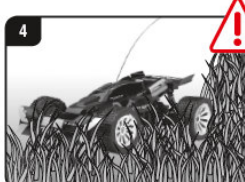

Never operate the product on grass surfaces. There is the risk of grass hindering the movement of the axles, which can lead to the motor overheating. Do not use the Carrera RC vehicle for transporting goods, persons or animals.

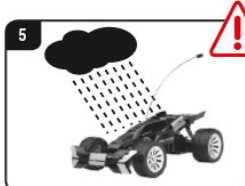

Never use the Carrera RC vehicle outdoors during rain or snowfall.



Never operate the vehicle near rivers, ponds or lakes, to avoid the risk of the Carrera RC car falling into the water.

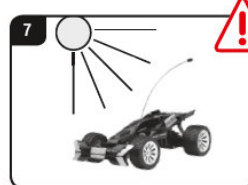

Do not expose the Carrera RC vehicle to direct sunlight.



Handle the tip of the antenna with care. Danger of injury!

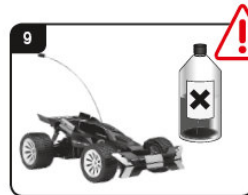

Never use strong solvents for cleaning the car.

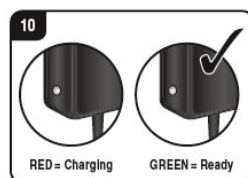

To avoid malfunctions to the control system resulting in uncontrolled operation of the Carrera RC vehicle, check that the controller batteries and the rechargeable batteries in the vehicle have sufficient charge.

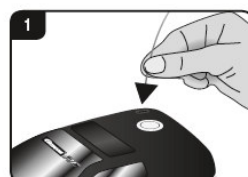

The Carrera RC vehicle must be inspected before and after operation, each time it is used, to ensure that it has not become disassembled. Any screws or nuts that may have become loosened during operation must be tightened.

Mounting the antenna

Push the antenna cable through the antenna tube and then mount this to the Carrera RC vehicle. Secure the end of the antenna cable with a Carrera RC sticker from the logo sheet.

Charging the rechargeable battery

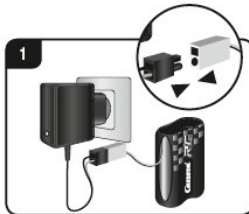

First connect the Carrera RC rechargeable battery to the battery charger supplied. The connection terminals between the battery and the charger are designed to prevent connection with the wrong polarity. Connect the charger to a power source.

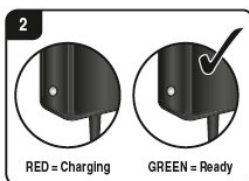

When the battery is properly connected and charging normally, the red LED is constantly lit. Once the battery is fully charged, the red LED switches to green. The battery can now be disconnected and installed in the Carrera RC car. The car is now ready for use.

Installing the rechargeable battery

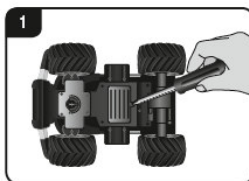

Using a screwdriver, remove the cover of the battery compartment in the Carrera RC car.

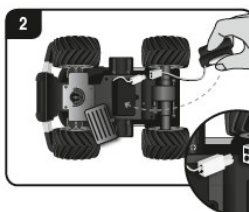

Connect the end of the cable from the Carrera RC vehicle with the charged battery. Put the battery in place. Replace the compartment cover using a screwdriver.

Inserting the 9V block battery



Unscrew the cover of the battery compartment in the controller and insert the 9V block battery.



When inserting the 9V block battery, ensure that the polarity is correct. Replace the cover using a screwdriver.

Now you can drive the car

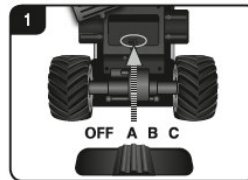

Make sure that nobody in your vicinity is using the same frequency. The frequency switch is in the battery holder.

To avoid this and to ensure that your vehicle will receive the signal from your controller, make sure that both your car and the controller are set to the same frequency (A/B/C).



The use of different channels allows three vehicles to be operated at the same time.

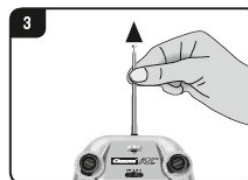

Pull out the antenna of the controller to its full extent.

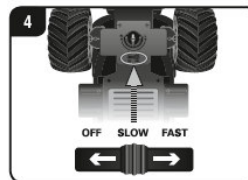

Switch on the Carrera RC car using the ON/OFF switch. Your Carrera RC car has two speeds.

The ON/OFF switch is also used to select the training or indoor mode.



Adjusting the steering

If the Carrera RC vehicle is found to pull towards the left or right while moving, use the adjuster control shown in the illustration to adjust the car's track precision.

Let's practise!

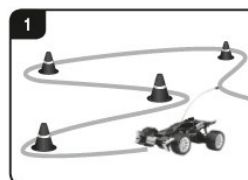

Now it's time to practise! Set up a Carrera RC vehicle racing track in a large empty area, using cornerposts, empty cans, or similar objects. The basic technique to adopt when operating a Carrera RC is to drive fast on the straight sections and to slow down in the curves.

- Avoid constant motor operation.
- To switch off after use, follow the steps in the reverse order.
- After use, remove or disconnect the battery.
- Clean the Carrera RC car after use.

Controller functions

1

Full Function
 You can steer the car in any direction using the joysticks:
Joystick on left:
 forwards/backwards
Joystick on right:
 left/right



2

The joysticks are removable. Alternatively, the vehicle can be controlled with a rocker.



3

The joysticks can be stored in the special compartment at the back of the controller.



4

Attach the lanyard to the eyelet on the controller and let the controller hang from your neck.

High Speed Turbo Button

1

Press the button on the right-hand side of the controller to actuate the High Speed Turbo function.

Troubleshooting

Problem	Cause	Solution
Car does not move	Either the switch on the controller or the car is set to OFF.	Switch on.
	There is no rechargeable battery in the car or the battery is too weak.	Insert charged battery.
	The overheat protection has caused the car's motor to cut out due to excess temperature.	Switch off the receiver. Leave the RC car to cool down for approx. 30 minutes.
	The battery or rechargeable battery in the transmitter or model is too weak.	Insert new battery or recharged battery.
	Different channel set up for car and controls.	Switch to same channel.
Car cannot be controlled	Transmitter antenna is defective.	Extend the antenna fully.
	Another RC model is using the same frequency.	Change the frequency.

Errors and changes excepted
 Colours / final de sign - changes excepted
 Technical changes and design-related changes excepted
 Pictograms = symbolic photos