

CASIO®



Using the Watch

Charging

Remove the watch from your wrist and place it in a brightly lit area.

- The watch may become hot when exposed to light for charging. Take care to avoid burn injury.
- Avoid charging in locations where it is very hot.

Power Saving

- Leaving the watch in a dark location for about one week will cause all hands to stop at 12 o'clock

Battery Alerts

- Low Battery
Second hand jumps every two seconds (Low Battery Alert).
- Dead Battery
All hands stopped at 12 o'clock

Watch Operations

You can view the current time in your Home City and in one more time zone.

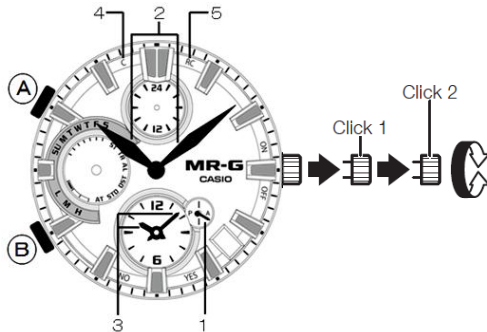

1. Dual time 24-hour hand
2. Home Time hour and minute hands
3. Dual Time hour and minute hands
4. Bluetooth Connection
5. Bluetooth standby

Swapping Home Time and Dual Time *1

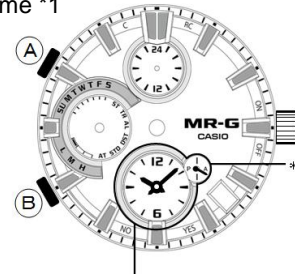

Dual Time dial
(Current time in another time zone)

*1 Hold down A for at least three seconds to swap your Home Time and Dual Time.

*2 Dual time 24-hour hand

Bluetooth Connection

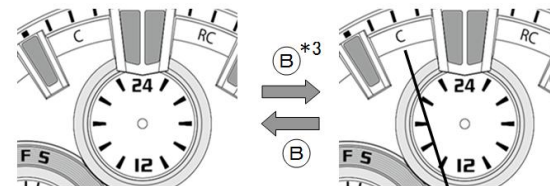

Connected with a mobile phone

* Hold down (B) for about 1.5 seconds to connect via Bluetooth.