

REMOTE LAYOUT & INSTRUCTIONS

Installing/Replacing the Battery

1. Remove the plastic tab located on the bottom of the remote to activate the battery.
2. To replace the battery - remove the cover from the back of the remote by pushing the tab (A) in and pulling the cover out to release the battery pack (B).
3. Install the new (CR2025) battery.
4. Close the cover – the remote is now be ready for use.

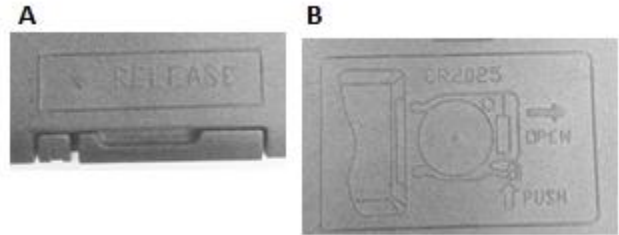

Dynamic Mode

Mode 1 Cloudy Day	Light intensity is continually increased and decreased to give the effect of a cloudy day
Mode 2 Daytime Lightning	Lights will flash and remain on in between flashes to simulate lightning during the day
Mode 3 Nighttime Lightning	Lights will flash and turn off in between flashes to simulate lightning at night

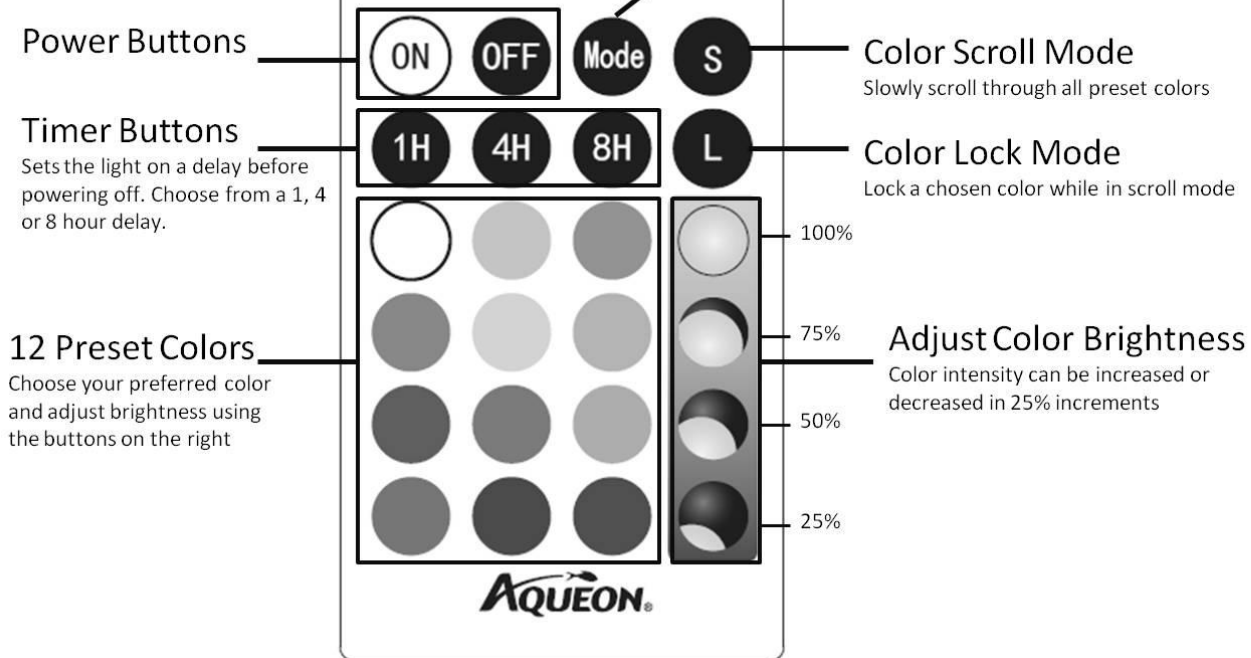

FCC Certification

This device complies with Part 15 of the FCC Rules. Operation is subject to the following two conditions: (1) this device may not cause harmful interference, and (2) this device must accept any interference received, including interference that may cause undesired operation.

WARNING: Changes or modifications to this unit not expressly approved by the party responsible for compliance could void the user's authority to operate the equipment.

NOTE: This equipment has been tested and found to comply with the limits for a Class B digital device, pursuant to Part 15 of the FCC Rules. These limits are designed to provide reasonable protection against harmful interference in a residential installation. This equipment generates uses and can radiate radio frequency energy and, if not installed and used in accordance with the instructions, may cause harmful interference to radio communications.

However, there is no guarantee that interference will not occur in a particular installation. If this equipment does cause harmful interference to radio or television reception, which can be determined by turning the equipment off and on, the user is encouraged to try to correct the interference by one or more of the following measures:

- Reorient or relocate the receiving antenna.
- Increase the separation between the equipment and receiver.
- Connect the equipment into an outlet on a circuit different from that to which the receiver is connected.
- Consult the dealer or an experienced radio/TV technician for help.

Color Changing LED Accent Light Owner's Manual

INSTALLATION INSTRUCTIONS

The Aqueon® Color Changing LED Accent Light is fully submersible. It can be installed in the aquarium using the included suction clips and can also be clipped into Aqueon® LED Strip Lights and Modular LED Light fixtures.

Installation Using the Suction Cups

1. Attach the suction cups to each end of the Accent Light. (Fig. 1)
2. Place the Accent Light in the aquarium, using the suction cups to attach it securely. Adjust the light to the desired angle by rotating the light tube in the suction cups.
 - a. The Accent Light can be placed anywhere in the aquarium – just be sure that the control box is not submersed in the water. (Fig. 1).
3. Connect the transformer to the connector on the Accent Light.
4. Plug the transformer into an acceptable outlet. Be sure to incorporate a “drip loop” to prevent water droplets from running down the cord and into the outlet should any water get onto the cord.
5. Turn the Accent Light on using the remote control.

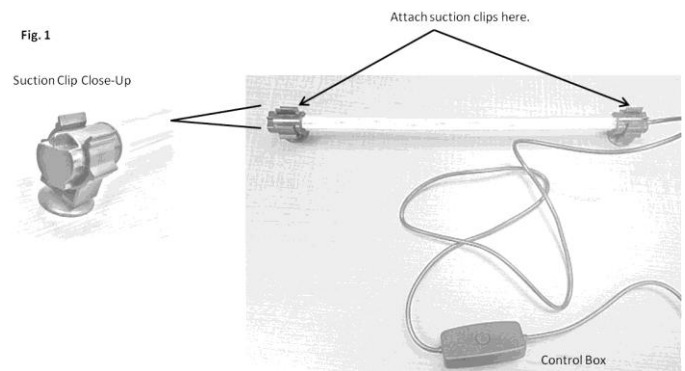

Installation into an Aqueon® LED Fixture

1. Turn the light fixture off and unplug the transformer from the outlet prior to installing or uninstalling the LED Accent Light. Flip the fixture over onto a clean/non abrasive surface so the underside is accessible.
2. Install the Accent light (without the suction cups) on the fixture by snapping both plastic ends of the LED lamp into the lamp clips inside the fixture housing making sure it is completely installed and held securely by the clips. (Fig. 2)
 - a. To uninstall, unclip the plastic ends of the lamp from the lamp clips inside the fixture and remove.
3. For the Aqueon® Modular LED Light: Be sure to route the light cord under the cover plates so they can slide back into their original position, covering the ends of the LED lamps.
4. Connect the transformer to the connector on the Accent Light.
5. Plug the transformer into an acceptable outlet. Be sure to incorporate a “drip loop” to prevent water droplets from running down the cord and into the outlet should any water get onto the cord.
6. Turn the Accent Light on using the remote control.

Fig. 2

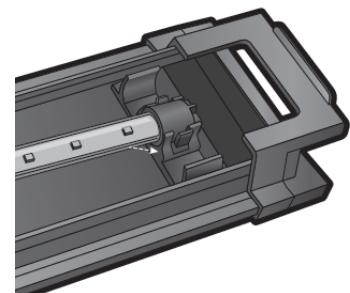

Color Changing LED Accent Light Fits >>	Aqueon® Modular LED Fixture	Aqueon® LED Strip Light
Size 30 LED Accent Light	15612	21102
Size 36 LED Accent Light	15613	21103
Size 48 LED Accent Light	15614	-

IMPORTANT CLEANING & SERVICING PRECAUTIONS

CLEANING: It is important to keep this appliance clean. **Unplug** and remove the unit from the aquarium. Wipe exposed surfaces carefully with a damp cloth to remove any dust or mineral deposits which may collect over time. Make sure all surfaces are dry before reinstalling.

SERVICING: In order to assure proper electrical connections and polarity, replacement parts and servicing should be performed only by a qualified electrician.

IMPORTANT SAFETY INSTRUCTIONS

WARNING - To guard against injury, basic safety precautions should be observed including the following:

1. READ AND FOLLOW ALL SAFETY INSTRUCTIONS.

2. **DANGER** - To avoid possible electric shock, special care should be taken since water is employed in the use of aquarium equipment. For each of the following situations, do not attempt to repair yourself; return the appliance to an authorized service facility for service or discard the appliance.
 - A. If the appliance falls into the water, DO NOT reach for it! First unplug it and then retrieve it. If electrical components of the appliance get wet, unplug the appliance immediately.
 - B. Carefully examine the appliance after installation. It should not be plugged in if there is water on the parts not intended to be wet.
 - C. Do not operate any appliance if it has a damaged cord or plug, if it is malfunctioning or if it is dropped or damaged in any manner.
 - D. To avoid the possibility of the appliance plug getting wet, position aquarium stand and tank to one side of a wall mounted receptacle to prevent water from dripping onto the receptacle or plug. A "drip loop", shown in the figure below, should be arranged by the user for each cord connecting an aquarium appliance to the receptacle. The "drip loop" is the part of the cord below the level of the receptacle, or the connector if an extension cord is used, to prevent water traveling along the cord and coming in contact with the receptacle. If the plug or receptacle does get wet, DO NOT unplug the cord. Disconnect the fuse to the circuit breaker that supplies power to the appliance. Then unplug and examine for the presence of water in the receptacle.
3. Close supervision is necessary when any appliance is used by or near children.
4. To avoid injury, do not contact moving parts or hot parts such as heaters, reflectors, lamp bulbs, and the like.
5. Always unplug the appliance from the outlet when not in use, before putting on or taking off parts, and before cleaning. Never yank the cord to pull plug from outlet. Grasp the plug and pull to disconnect.
6. Do not use an appliance for other than intended use. The use of attachments not recommended or sold by the appliance manufacturer may cause an unsafe condition.
7. Do not install or store the appliance where it will be exposed to the weather or to temperatures below freezing.
8. Make sure an appliance mounted on a tank is securely installed before operating it.
9. Read and observe all the important notices on the appliance.
10. If an extension cord is necessary, a cord with a proper rating should be used. A cord rated for less amperes or watts than the appliance rating may overheat. Care should be taken to arrange the cord so that it will not be tripped over or pulled.
11. This appliance is recommended for use over a glass aquarium cover or panel.
The appliance is intended **FOR HOUSEHOLD USE ONLY**.

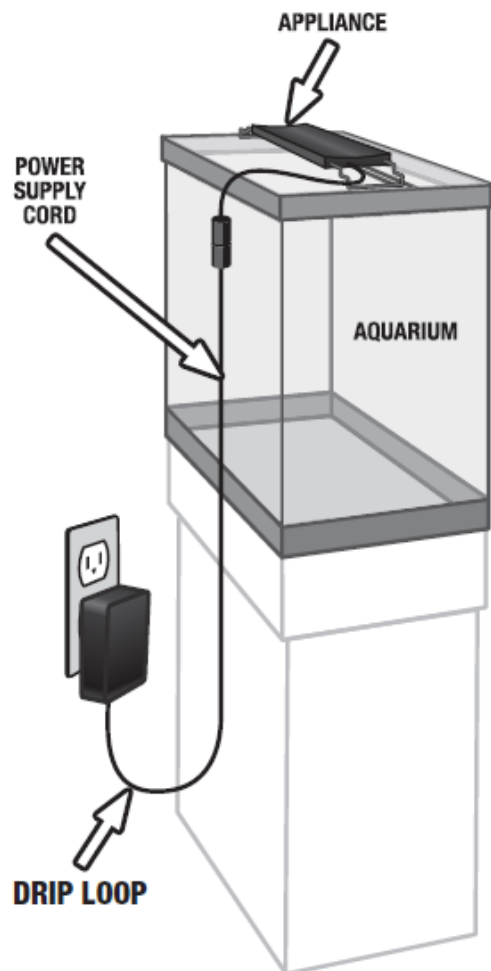

12. SAVE THESE INSTRUCTIONS.

LIMITED WARRANTY

Aqueon® warrants that this product shall be free from defective electrical components due to defects in materials or workmanship for a period of twelve months from the date of purchase. If a defect is shown, Aqueon® will, at the sole discretion of Aqueon®, either repair or replace the product without charge. No cash refunds will be made. This warranty is provided solely to the original consumer purchaser of the product and may not be transferred or assigned. You must retain original proof of purchase to validate this warranty.

This warranty does not apply to damage resulting from accident, misuse, abuse, lack of reasonable care, failure to follow safety and installation instructions, use of the product with non-standard electrical service, or any other defect not resulting from defects in the electrical components of the product or defects in materials or workmanship. This warranty will not be effective unless and until the Aqueon® product is shown to have been used in accordance with the safety and installation instructions accompanying the product, including the requirement that the product be used over a covered aquarium.

THIS CONSTITUTES THE ENTIRE AQUEON® WARRANTY AND AQUEON® MAKES NO OTHER WARRANTIES, WHETHER EXPRESS OR IMPLIED, WITH RESPECT TO THE PRODUCT. AQUEON® SPECIFICALLY DISCLAIMS ANY AND ALL IMPLIED WARRANTIES, INCLUDING, WITHOUT LIMITATION, WARRANTIES OF MERCHANTABILITY AND FITNESS FOR A PARTICULAR PURPOSE. IF AQUEON® CANNOT LAWFULLY DISCLAIM IMPLIED WARRANTIES UNDER THIS LIMITED WARRANTY, ALL SUCH WARRANTIES, INCLUDING WARRANTIES OF MERCHANTABILITY AND FITNESS FOR A PARTICULAR PURPOSE ARE LIMITED IN DURATION TO THE DURATION OF THIS WARRANTY.

AQUEON® IS NOT RESPONSIBLE FOR DIRECT, SPECIAL, INCIDENTAL OR CONSEQUENTIAL DAMAGES RESULTING FROM ANY BREACH OF WARRANTY OR CONDITION, OR UNDER ANY OTHER LEGAL THEORY. AQUEON® EXPRESSLY DISCLAIMS ALL ALLEGED DAMAGES FOR LOSS OF AQUATIC LIFE, PERSONAL INJURY, AND/OR PROPERTY DAMAGE. Some states and provinces do not allow the exclusion or limitation of incidental or consequential damages or exclusions or limitations on the duration of implied warranties or conditions, so the above limitations or exclusions may not apply to you. This warranty gives you specific legal rights, and you may also have other rights that vary by state or province.

Aqueon® shall not have any obligations under this warranty unless the owner notifies Aqueon® in writing of any alleged defect(s) within 30 days of discovery of the defect(s). Any notice to Aqueon® must be delivered by United States or electronic mail to one of the following addresses:

U.S. Mail: Central Aquatics - Aqueon, 5401 West Oakwood Park Drive, Franklin, Wisconsin 53132

Electronic Mail: info@Central-Aquatics.com

Aqueon® shall be allowed a reasonable period of time to investigate any warranty claim and to perform any testing Aqueon® deems necessary to determine the cause of the defect. This warranty shall be interpreted under the laws of the state of Wisconsin.

For additional information regarding this limited warranty, please contact us at the addresses above, or call us at 888-255-4527.