

# CLICKER

Model No. CLT 1

## Universal Garage Door Opener Remote Control

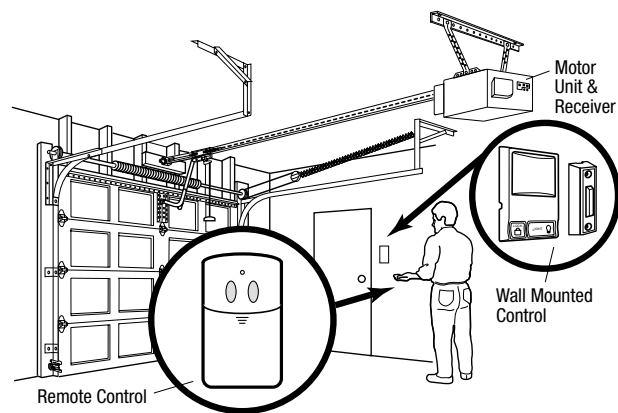

The clicker remote can be programmed to operate up to 2 garage door openers or gates, including different brands. All programming is done using the:

- Brand switch
- Transmitter DIP switch
- Transmit push buttons A and B, and LED indicator

### Preparation

Determine the **BRAND** of the existing garage door opener or handheld remote controls. If all remote controls are lost, the **BRAND** is located on the ceiling mounted motor unit or on the receiver near the flexible wire antenna. Proceed to the SECTION indicated on the BRAND chart below.

**Note:** If programming to more than one opener, after programming button "A" refer to brand chart, and follow the instructions pertaining to the brand you wish to program into button "B".

When the remotes range is diminished, operation is intermittent, or the LED dims, replace the battery. Memory is not lost when the battery is removed. Note: Dispose of old batteries properly.

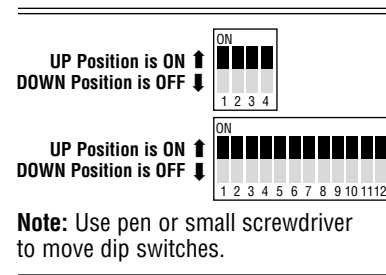

**Note:** Use pen or small screwdriver to move dip switches.

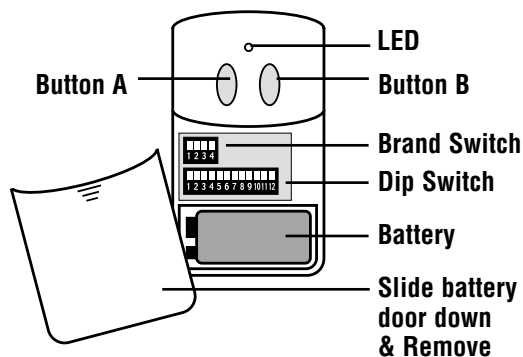

## BRAND CHART

Proceed to appropriate section.

**SECTION I -**

Chamberlain, Sears, LiftMaster, Master Mechanic, Dolt

**SECTION II -**

Stanley, Multi-code, Linear, Moore-O-Matic

**SECTION III -**

Genie

## SECTION I - Chamberlain, Sears, LiftMaster, Master Mechanic, Dolt

Determine if your motor unit/receiver system has DIP switches or a smart-learn button. (Locate the small gray wire antenna. Some models require removing the light lens.)

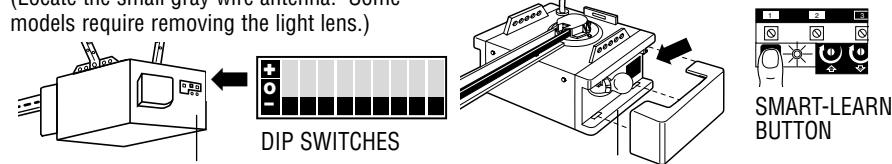

- If the Receiver has 9 DIP switches Proceed to **TYPE A**
- If the Receiver has a yellow, white, or gray smart-learn button, proceed to **TYPE B**
- If the Receiver has a green, red, or orange smart-learn button, proceed to **TYPE C**

**TYPE A** The Receiver DIP switch has three positions labeled "+", "0" and "-". **The "0" setting cannot be used with the clicker remote.**

1) Reset switches: 1 to "-" and positions 2 through 9 to a random setting using "+" and the "-". **DO NOT USE THE "0" SETTING.**

2) Gather any existing remotes and open to expose the DIP switches. Reset the DIP switch to match the newly coded receiver. **Note:** some three button remotes do not have a #1 switch. Match the 2 through 9 to the receiver. On three button remotes the large button is now programmed to activate the door. 3) Test all the newly coded remote controls to be sure that they operate the door before proceeding to the **BRAND MODE SETTING.**

Use this button

**TYPE B** After determining that the Receiver has a yellow, white or gray learn button, 1) Gather any existing remotes and open to expose the DIP switches labeled "+", "0" and "-". 2) Reset switches: 1 to "-" and positions 2 through 9 to a random setting using "+" and the "-". **DO NOT USE THE "0" SETTING, SET ALL REMOTES TO THE SAME SETTING.** On three button remotes the large button is now programmed to activate the door. 3) The recoded remotes must be programmed to the receiver. Press and release the smart-learn button. Then press and hold the existing remote push button for three seconds. 4) Test all the newly coded remote controls to be sure that they operate the door before proceeding to the **BRAND MODE SETTING.**

Use this button

**TYPE C** With this type receiver, the existing remotes do not contain DIP switches. Proceed to **BRAND MODE SETTINGS.**

### BRAND MODE SETTINGS - Set switches on clicker remote

**FOR TYPE A AND B**

**Step 1**

ON ON OFF OFF

Existing Remote

Match existing codes. Set extra switches off.

Clicker Remote

**FOR TYPE C - Step 1**

GREEN SMART-LEARN BUTTON

ON ON ON OFF

- OR -

ORANGE/RED SMART-LEARN BUTTON

OFF ON ON OFF

Code switch settings are not used.

Continue to Step 2.

- Step 2** - Press and hold both buttons for 5 seconds or until LED begins to flash.
- Step 3** - When LED flashes, release both buttons.
- Step 4** - Press the button you wish to operate the opener (your choice).  
For type A & B, proceed to step 6. For type C, continue on to Step 5.

**Step 5**

A. Press and release Smart-Learn button.

B. Press and hold button selected in Step 4 for 3 seconds.

**Step 6** - Programming is complete, to test, press the button selected to activate garage door.

## SECTION II - Stanley, Multi-Code, Linear, Moore-O-Matic

- Determine specific brand and circle above.
- Set brand mode switches on clicker remote.
- Open existing remote to expose code switches.
- Program clicker remote push button.

### Step 1

STANLEY	OFF	OFF	OFF	OFF
MULTI-CODE	ON	OFF	OFF	OFF
LINEAR/MOORE-O-MATIC	OFF	ON	OFF	OFF

### Step 2

Existing Remote

Match existing codes. Set extra switches off.

Clicker Remote

**Step 3** - Press and hold both buttons for 5 seconds or until LED begins to flash.

**Step 4** - When LED flashes, release both buttons.

**Step 5** - Press the button you wish to operate the opener (your choice).

**Step 6** - Programming is complete, to test, press the button selected to activate garage door.

## SECTION III - Genie - 9 Code Switch, Genie - 12 Code Switch

- Open existing remote; determine if there are 9 or 12 code switch settings.
- Set brand mode switches on clicker remote.
- Program clicker remote push button.

### Step 1

GENIE 9 SWITCH	OFF	OFF	ON	OFF
GENIE 12 SWITCH	ON	OFF	ON	OFF

### Step 2

Existing Remote

Match existing codes. Set extra switches off.

Clicker Remote

**Step 3** - Press and hold both buttons for 5 seconds or until LED begins to flash.

**Step 4** - When LED flashes, release both buttons.

**Step 5** - Press the button you wish to operate the opener (your choice).

**Step 6** - Programming is complete, to test, press the button selected to activate garage door.

## WARNING

To prevent possible **SERIOUS INJURY** or **DEATH** from a moving gate or garage door:

- ALWAYS keep remote controls out of reach of children. NEVER permit children to operate, or play with remote control transmitters.
- Activate gate or door ONLY when it can be seen clearly, is properly adjusted, and there are no obstructions to door travel.
- ALWAYS keep gate or garage door in sight until completely closed. Never permit anyone to cross path of moving gate or door.

**NOTICE:** To comply with FCC and or Industry Canada rules, adjustment or modifications of this receiver and/or transmitter are prohibited, except for changing the code setting or replacing the battery. THERE ARE NO OTHER USER SERVICEABLE PARTS. Tested to Comply with FCC Standards FOR HOME OR OFFICE USE. Operation is subject to the following two conditions: (1) this device may not cause harmful interference, and (2) this device must accept any interference received, including interference that may cause undesired operation.

**TECHNICAL SUPPORT: 800-442-1255 (MONDAY-FRIDAY 6AM-7PM CST; SATURDAY 8AM-6PM)**

Chamberlain, LiftMaster and Moore-O-Matic are Trademarks of Chamberlain Group. Genie is a Trademark of Overhead Door Corporation. Linear and Multi-Code are Trademarks of Linear Corporation. Master Mechanic is a Trademark of TruServ. Sears is a Trademark of Sears & Roebuck. Stanley is a Trademark of The Stanley Works. Dolt is a trademark of Dolt Best Corporation.