

MONITORED WIRELESS EDGE KIT MONITORED WIRELESS EDGE KIT MONITORED WIRELESS EDGE KIT

Model/Modèle/Modelo LMWEKITU



Review Copy

LiftMaster®



WARNING

To prevent possible **SERIOUS INJURY** or **DEATH** from a closing gate or door:

- Be sure to **DISCONNECT ALL POWER** to the operator **BEFORE** installing the wireless edge kit.
- The gate or door **MUST** be in the fully opened or closed position **BEFORE** installing the LiftMaster® Monitored Entrapment Protection device.
- Correctly install and connect the wireless edge kit.
- LiftMaster® Monitored Entrapment Protection devices are for use with LiftMaster® UL 325 compliant Gate and Commercial Door Operators **ONLY**. Use with **ANY** other product voids the warranty.
- Monitored external entrapment protection devices **MUST** be installed per the operator installation manual for each Entrapment Zone.

AVERTISSEMENT

To prevent possible **SERIOUS INJURY** or **DEATH** from a closing gate or door:

- Be sure to **DISCONNECT ALL POWER** to the operator **BEFORE** installing the wireless edge kit.
- The gate or door **MUST** be in the fully opened or closed position **BEFORE** installing the LiftMaster® Monitored Entrapment Protection device.
- Correctly install and connect the wireless edge kit.
- LiftMaster® Monitored Entrapment Protection devices are for use with LiftMaster® UL 325 compliant Gate and Commercial Door Operators **ONLY**. Use with **ANY** other product voids the warranty.
- Monitored external entrapment protection devices **MUST** be installed per the operator installation manual for each Entrapment Zone.

ADVERTENCIA

To prevent possible **SERIOUS INJURY** or **DEATH** from a closing gate or door:

- Be sure to **DISCONNECT ALL POWER** to the operator **BEFORE** installing the wireless edge kit.
- The gate or door **MUST** be in the fully opened or closed position **BEFORE** installing the LiftMaster® Monitored Entrapment Protection device.
- Correctly install and connect the wireless edge kit.
- LiftMaster® Monitored Entrapment Protection devices are for use with LiftMaster® UL 325 compliant Gate and Commercial Door Operators **ONLY**. Use with **ANY** other product voids the warranty.
- Monitored external entrapment protection devices **MUST** be installed per the operator installation manual for each Entrapment Zone.

Review Copy

CARTON INVENTORY

INVENTAIRE DE L'EMBALLAGE

CONTENIDO DE LA CAJA



AA Lithium Batteries (2)
Energizer® Ultimate Lithium AA L91 recommended as replacements
 AA Lithium Batteries (2)
Energizer® Ultimate Lithium AA L91 recommended as replacements
 AA Lithium Batteries (2)
Energizer® Ultimate Lithium AA L91 recommended as replacements

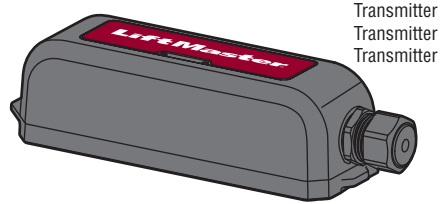

Transmitter
 Transmitter
 Transmitter

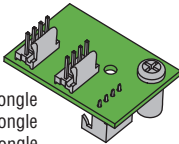

I²C Dongle
 I²C Dongle
 I²C Dongle

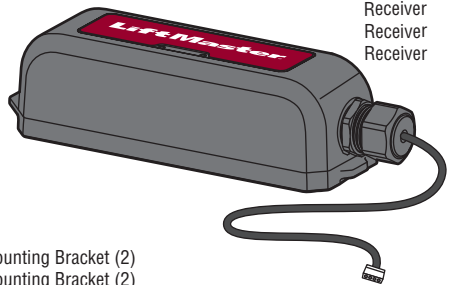

Receiver
 Receiver
 Receiver



1" Screw (8)
 1" Screw (8)
 1" Screw (8)



.375" Screw (8)
 .375" Screw (8)
 .375" Screw (8)

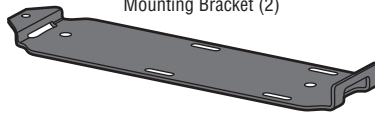

Mounting Bracket (2)
 Mounting Bracket (2)
 Mounting Bracket (2)

INTRODUCTION

The LiftMaster® Wireless Edge Kit provides a Bluetooth® connection between a LiftMaster® monitored resistive edge (not included) and the gate operator. Maximum range is 130 ft. (objects in the path of the signal and location of devices may reduce range). You can program up to 4 transmitters to the receiver. The kit works with LiftMaster® monitored resistive edge sensors ONLY. Contact closure edge sensors are NOT supported.

For use with LiftMaster® gate operators that meet UL 325 requirements. Transmitter and receiver are UL Recognized Components and meet UL 325 requirements. A monitored safety device MUST be installed in each entrapment zone.

INTRODUCTION

The LiftMaster® Wireless Edge Kit provides a Bluetooth® connection between a LiftMaster® monitored resistive edge (not included) and the gate operator. Maximum range is 130 ft. (objects in the path of the signal and location of devices may reduce range). You can program up to 4 transmitters to the receiver. The kit works with LiftMaster® monitored resistive edge sensors ONLY. Contact closure edge sensors are NOT supported.

For use with LiftMaster® gate operators that meet UL 325 requirements. Transmitter and receiver are UL Recognized Components and meet UL 325 requirements. A monitored safety device MUST be installed in each entrapment zone.

INTRODUCCIÓN

The LiftMaster® Wireless Edge Kit provides a Bluetooth® connection between a LiftMaster® monitored resistive edge (not included) and the gate operator. Maximum range is 130 ft. (objects in the path of the signal and location of devices may reduce range). You can program up to 4 transmitters to the receiver. The kit works with LiftMaster® monitored resistive edge sensors ONLY. Contact closure edge sensors are NOT supported.

For use with LiftMaster® gate operators that meet UL 325 requirements. Transmitter and receiver are UL Recognized Components and meet UL 325 requirements. A monitored safety device MUST be installed in each entrapment zone.

1

WIRE RECEIVER

1. Find the operator diagram on pages 12-18 to see the mounting location for the receiver and wire routing.
2. Open the receiver housing.
3. Route the wire harness from the receiver to the operator control board. Connect the wire harness to the "EXP. BOARD" terminal on the control board **or** to the expansion board (if installed) using the provided I²C dongle. Connect the dongle to the "TO MAIN BOARD" terminal on the expansion board.

The blue power LED will come on.

WIRE RECEIVER

1. Find the operator diagram on pages 12-18 to see the mounting location for the receiver and wire routing.
2. Open the receiver housing.
3. Route the wire harness from the receiver to the operator control board. Connect the wire harness to the "EXP. BOARD" terminal on the control board **or** to the expansion board (if installed) using the provided I²C dongle. Connect the dongle to the "TO MAIN BOARD" terminal on the expansion board.

The blue power LED will come on.

WIRE RECEIVER

1. Find the operator diagram on pages 12-18 to see the mounting location for the receiver and wire routing.
2. Open the receiver housing.
3. Route the wire harness from the receiver to the operator control board. Connect the wire harness to the "EXP. BOARD" terminal on the control board **or** to the expansion board (if installed) using the provided I²C dongle. Connect the dongle to the "TO MAIN BOARD" terminal on the expansion board.

The blue power LED will come on.

2

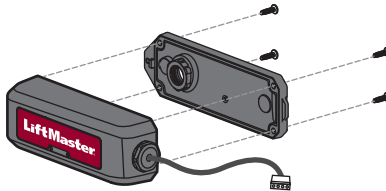

3

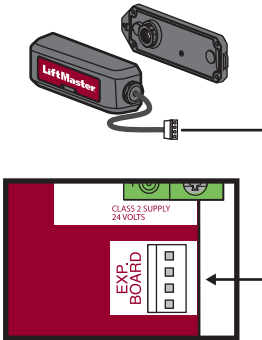

Control Board
Tableau de commande
Tarjeta de control

OR
OU
O

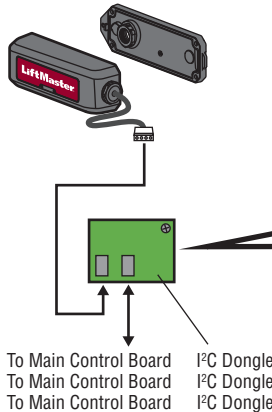

To Main Control Board
To Main Control Board
To Main Control Board
I²C Dongle
I²C Dongle
I²C Dongle

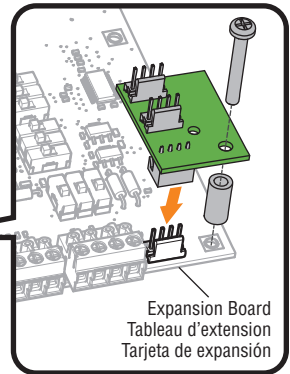

Review Copy

Illustrations in manual are for reference only, your application may look different
Les illustrations dans le manuel sont fournies à titre de référence uniquement; votre application peut avoir une autre apparence.
Las ilustraciones del manual se ofrecen únicamente como referencia, su instalación podría ser diferente.

2

INSTALL TRANSMITTER BATTERIES AND SET EDGE DIRECTION

1. Open the transmitter housing.
2. Install the batteries.
3. Decide the direction (open or closed) the edge will be installed. Set "OPEN/CLOSE" DIP switch to match the direction of the edge protection.

INSTALL TRANSMITTER BATTERIES AND SET EDGE DIRECTION

1. Open the transmitter housing.
2. Install the batteries.
3. Decide the direction (open or closed) the edge will be installed. Set "OPEN/CLOSE" DIP switch to match the direction of the edge protection.

INSTALL TRANSMITTER BATTERIES AND SET EDGE DIRECTION

1. Open the transmitter housing.
2. Install the batteries.
3. Decide the direction (open or closed) the edge will be installed. Set "OPEN/CLOSE" DIP switch to match the direction of the edge protection.

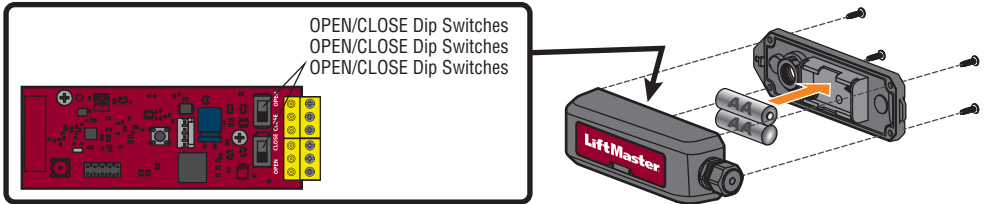

3

PROGRAMMING

The receiver can learn up to 4 transmitters.

1. Press the learn button on the RECEIVER board. The red LED will come on and the operator control board will beep once to indicate programming mode. **NOTE:** Press the learn button again to exit programming mode.
2. Press the learn button on the TRANSMITTER to be learned. The red LED on the RECEIVER will blink 4 times. Press the learn button on the next TRANSMITTER to be learned. **NOTE:** Learn mode times out after 60 seconds if no transmitters are added or the capacity is reached. After each transmitter is learned there will be an additional 60 seconds to complete programming.

PROGRAMMATION

The receiver can learn up to 4 transmitters.

1. Press the learn button on the RECEIVER board. The red LED will come on and the operator control board will beep once to indicate programming mode. **NOTE:** Press the learn button again to exit programming mode.
2. Press the learn button on the TRANSMITTER to be learned. The red LED on the RECEIVER will blink 4 times. Press the learn button on the next TRANSMITTER to be learned. **NOTE:** Learn mode times out after 60 seconds if no transmitters are added or the capacity is reached. After each transmitter is learned there will be an additional 60 seconds to complete programming.

PROGRAMACIÓN

The receiver can learn up to 4 transmitters.

1. Press the learn button on the RECEIVER board. The red LED will come on and the operator control board will beep once to indicate programming mode. **NOTE:** Press the learn button again to exit programming mode.
2. Press the learn button on the TRANSMITTER to be learned. The red LED on the RECEIVER will blink 4 times. Press the learn button on the next TRANSMITTER to be learned. **NOTE:** Learn mode times out after 60 seconds if no transmitters are added or the capacity is reached. After each transmitter is learned there will be an additional 60 seconds to complete programming.

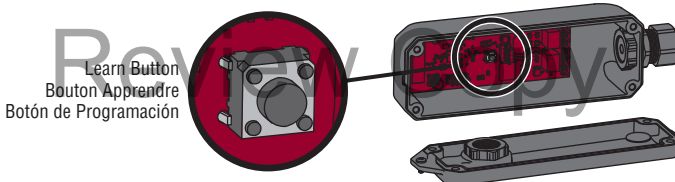

4

MOUNT THE RECEIVER

1. Find the operator diagram on pages 12-18 to see the mounting location for the receiver.
2. Attach the mounting bracket to the gate operator.
3. Reattach the receiver housing.
4. Snap the receiver onto the mounting bracket and secure with screw provided.

MOUNT THE RECEIVER

1. Find the operator diagram on pages 12-18 to see the mounting location for the receiver.
2. Attach the mounting bracket to the gate operator.
3. Reattach the receiver housing.
4. Snap the receiver onto the mounting bracket and secure with screw provided.

MOUNT THE RECEIVER

1. Find the operator diagram on pages 12-18 to see the mounting location for the receiver.
2. Attach the mounting bracket to the gate operator.
3. Reattach the receiver housing.
4. Snap the receiver onto the mounting bracket and secure with screw provided.

2

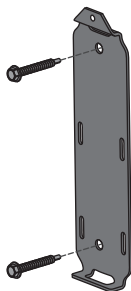

3

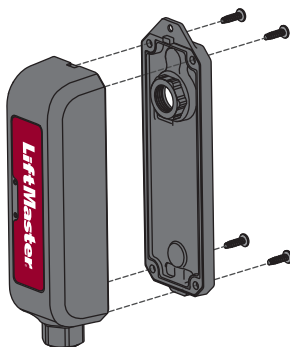

4

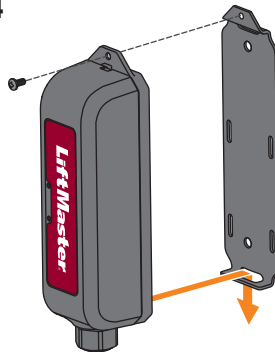

Review Copy

5

WIRE AND MOUNT THE TRANSMITTER(S)

NOTE: The transmitter can be wired to 1 or 2 edge sensors.

1. Route the wires from the edge sensor into the transmitter. Connect the wires to the terminal blocks (polarity is NOT important).
2. Attach the mounting bracket to the gate using the screws provided. If installing on a round surface, use zip ties (not provided).
3. Reattach the transmitter housing.
4. Snap the transmitters onto the mounting bracket and secure with the screw provided.

WIRE AND MOUNT THE TRANSMITTER(S)

NOTE: The transmitter can be wired to 1 or 2 edge sensors.

1. Route the wires from the edge sensor into the transmitter. Connect the wires to the terminal blocks (polarity is NOT important).
2. Attach the mounting bracket to the gate using the screws provided. If installing on a round surface, use zip ties (not provided).
3. Reattach the transmitter housing.
4. Snap the transmitters onto the mounting bracket and secure with the screw provided.

WIRE AND MOUNT THE TRANSMITTER(S)

NOTE: The transmitter can be wired to 1 or 2 edge sensors.

1. Route the wires from the edge sensor into the transmitter. Connect the wires to the terminal blocks (polarity is NOT important).
2. Attach the mounting bracket to the gate using the screws provided. If installing on a round surface, use zip ties (not provided).
3. Reattach the transmitter housing.
4. Snap the transmitters onto the mounting bracket and secure with the screw provided.

1

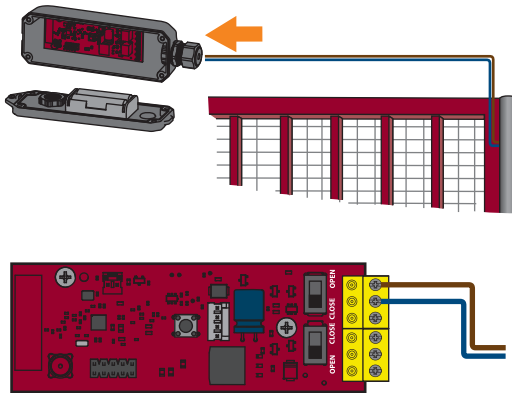

2

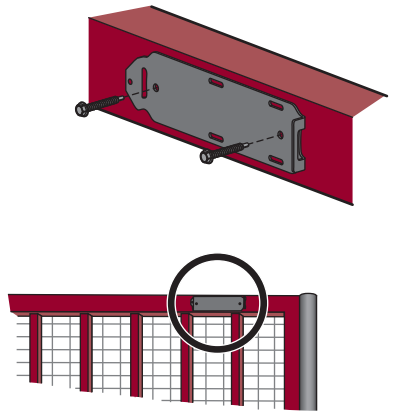

3

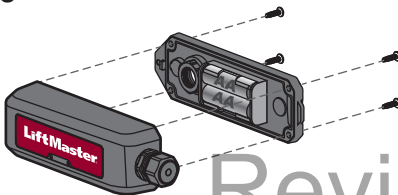

4

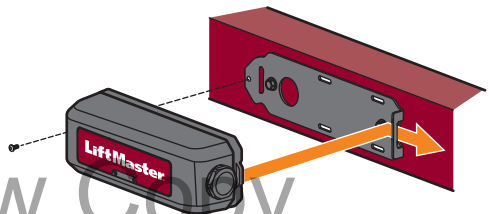

Review Copy

6

TEST

Apply pressure to edge. The red LED on the TRANSMITTER and the corresponding open or close edge LED on the gate operator control board will flash. If the TRANSMITTER LED does not flash, check the transmitter and edge sensor for proper installation and wiring.

TEST

Apply pressure to edge. The red LED on the TRANSMITTER and the corresponding open or close edge LED on the gate operator control board will flash. If the TRANSMITTER LED does not flash, check the transmitter and edge sensor for proper installation and wiring.

TEST

Apply pressure to edge. The red LED on the TRANSMITTER and the corresponding open or close edge LED on the gate operator control board will flash. If the TRANSMITTER LED does not flash, check the transmitter and edge sensor for proper installation and wiring.

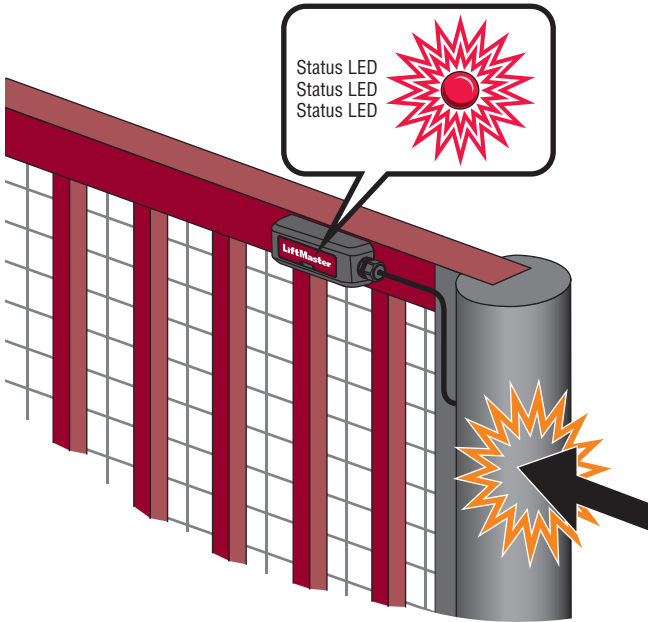

Review Copy

BATTERY STATUS

During normal operation, the red status LEDs on the transmitter(s) and receiver flash to indicate the battery status.

NOTE: The receiver LED corresponds to the lowest battery level of all transmitters.

1 Flash	Battery is fine.
2 Flashes	Battery is low; the operator will beep twice.
3 Flashes	Battery is critically low; the operator will not function until the battery is replaced. The operator will either open automatically (fail-safe) or latch at close (fail-secure) based on the operator setting (see the gate operator manual for more information).

BATTERY STATUS

During normal operation, the red status LEDs on the transmitter(s) and receiver flash to indicate the battery status.

NOTE: The receiver LED corresponds to the lowest battery level of all transmitters.

1 Flash	Battery is fine.
2 Flashes	Battery is low; the operator will beep twice.
3 Flashes	Battery is critically low; the operator will not function until the battery is replaced. The operator will either open automatically (fail-safe) or latch at close (fail-secure) based on the operator setting (see the gate operator manual for more information).

BATTERY STATUS

During normal operation, the red status LEDs on the transmitter(s) and receiver flash to indicate the battery status.

NOTE: The receiver LED corresponds to the lowest battery level of all transmitters.

1 Flash	Battery is fine.
2 Flashes	Battery is low; the operator will beep twice.
3 Flashes	Battery is critically low; the operator will not function until the battery is replaced. The operator will either open automatically (fail-safe) or latch at close (fail-secure) based on the operator setting (see the gate operator manual for more information).

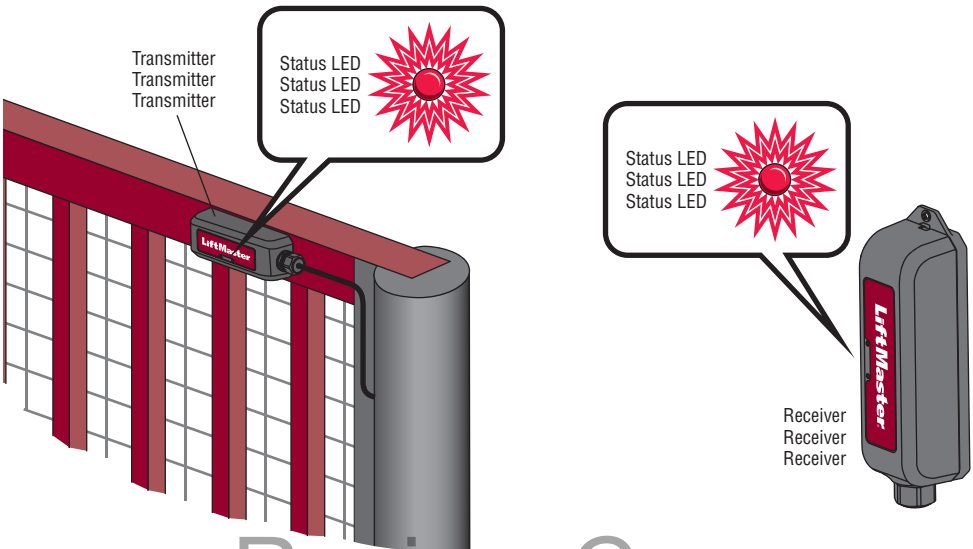

Review Copy

REMOVE A TRANSMITTER

1. Disconnect the edge sensor wires from the TRANSMITTER.
2. Remove the batteries from the TRANSMITTER.
3. Press and hold the RECEIVER learn button until the red status LED begins to flash (about 3 seconds) then release. The receiver will remove disconnected transmitters from memory and return to normal operation after 60 seconds or when the user presses the learn button again.

REMOVE A TRANSMITTER

1. Disconnect the edge sensor wires from the TRANSMITTER.
2. Remove the batteries from the TRANSMITTER.
3. Press and hold the RECEIVER learn button until the red status LED begins to flash (about 3 seconds) then release. The receiver will remove disconnected transmitters from memory and return to normal operation after 60 seconds or when the user presses the learn button again.

REMOVE A TRANSMITTER

1. Disconnect the edge sensor wires from the TRANSMITTER.
2. Remove the batteries from the TRANSMITTER.
3. Press and hold the RECEIVER learn button until the red status LED begins to flash (about 3 seconds) then release. The receiver will remove disconnected transmitters from memory and return to normal operation after 60 seconds or when the user presses the learn button again.

1-2

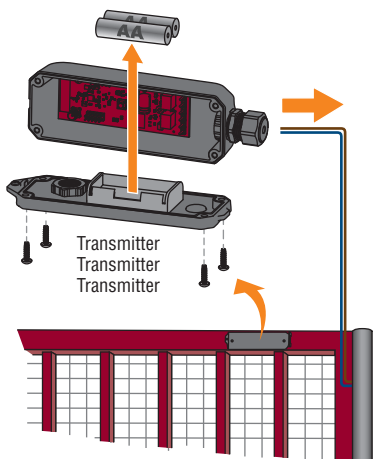

3

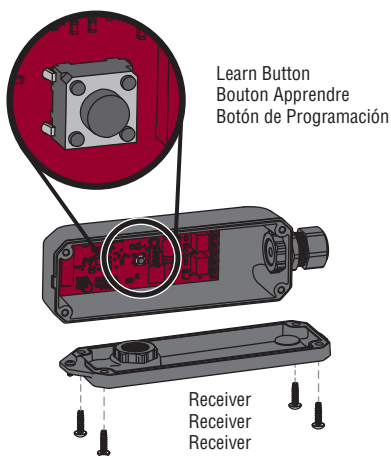

ERASE ALL TRANSMITTERS FROM MEMORY

Press and hold the RECEIVER learn button until the red status LED begins to flash. Hold the learn button until the LED turns off (about 10 seconds) then release. The gate operator will beep for 5 seconds to confirm all transmitters are erased.

ERASE ALL TRANSMITTERS FROM MEMORY

Press and hold the RECEIVER learn button until the red status LED begins to flash then turns off (about 10 seconds) then release. The operator will beep for 5 seconds to confirm all transmitters are erased.

ERASE ALL TRANSMITTERS FROM MEMORY

Press and hold the RECEIVER learn button until the red status LED begins to flash then turns off (about 10 seconds) then release. The operator will beep for 5 seconds to confirm all transmitters are erased.

Review Copy

TROUBLESHOOTING

The diagnostic display on the operator control board will display an error code to indicate a problem. See the gate operator manual for instructions to display error codes.

46	Wireless edge battery low	Replace batteries in wireless edge.
67	Wireless edge triggered more than 3 minutes	Check wired input for wiring issue or obstruction.
68	Wireless edge loss of monitoring	Check wireless edge inputs. Check for connection between receiver and main board/expansion board.
69	Wireless edge triggered	If an obstruction occurred, no action required. If an obstruction did NOT occur, check inputs and wiring.

DÉPANNAGE

The diagnostic display on the operator control board will display an error code to indicate a problem. See the gate operator manual for instructions to display error codes.

46	Pile faible du chant sans fil	Remplacer les piles du chant sans fil.
67	Chant sans fil déclenché pendant plus de 3 minutes	Vérifier l'entrée câblée pour tout problème de câblage ou obstruction.
68	Perte de surveillance du chant sans fil	Vérifier les entrées du chant sans fil. Check for connection between receiver and main board/expansion board.
69	Chant sans fil déclenché	Si une obstruction s'est produite, aucune action n'est requise. Si une obstruction ne s'est pas produite, vérifier les entrées et le câblage.

RESOLUCIÓN DE PROBLEMAS

The diagnostic display on the operator control board will display an error code to indicate a problem. See the gate operator manual for instructions to display error codes.

46	Wireless edge battery low	Replace batteries in wireless edge.
67	Wireless edge triggered more than 3 minutes	Check wired input for wiring issue or obstruction.
68	Wireless edge loss of monitoring	Check wireless edge inputs. Check for connection between receiver and main board/expansion board.
69	Wireless edge triggered	If an obstruction occurred, no action required. If an obstruction did NOT occur, check inputs and wiring.

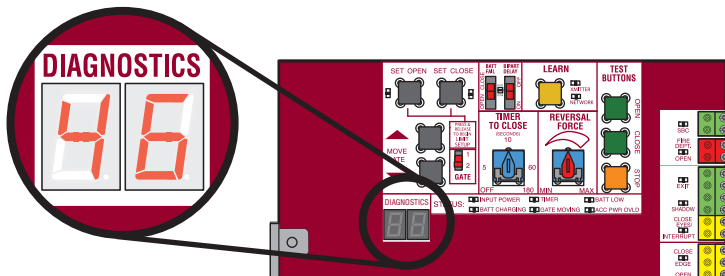

Control Board
Tableau de commande
Tarjeta de control

Review Copy

MODEL RSW12U - RECEIVER MOUNTING LOCATION

Mount the bracket on the side facing the gate.

MODEL RSW12U - RECEIVER MOUNTING LOCATION

Mount the bracket on the side facing the gate.

MODEL RSW12U - RECEIVER MOUNTING LOCATION

Mount the bracket on the side facing the gate.

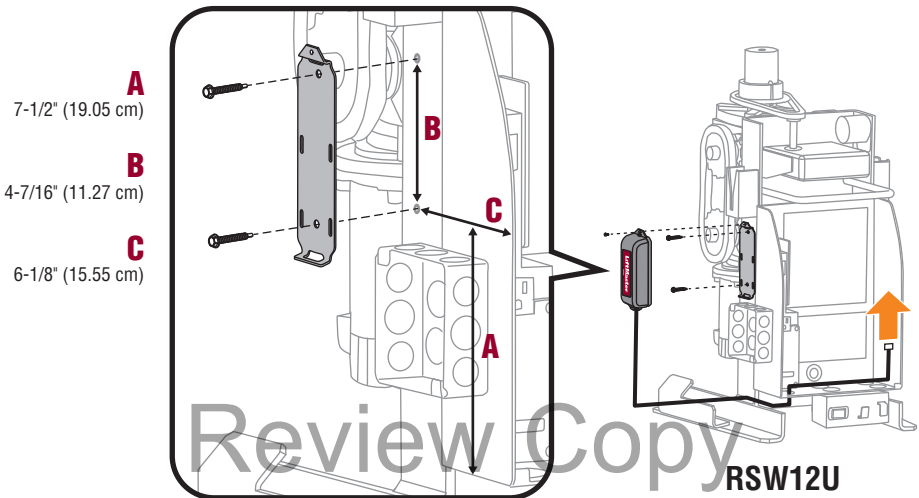
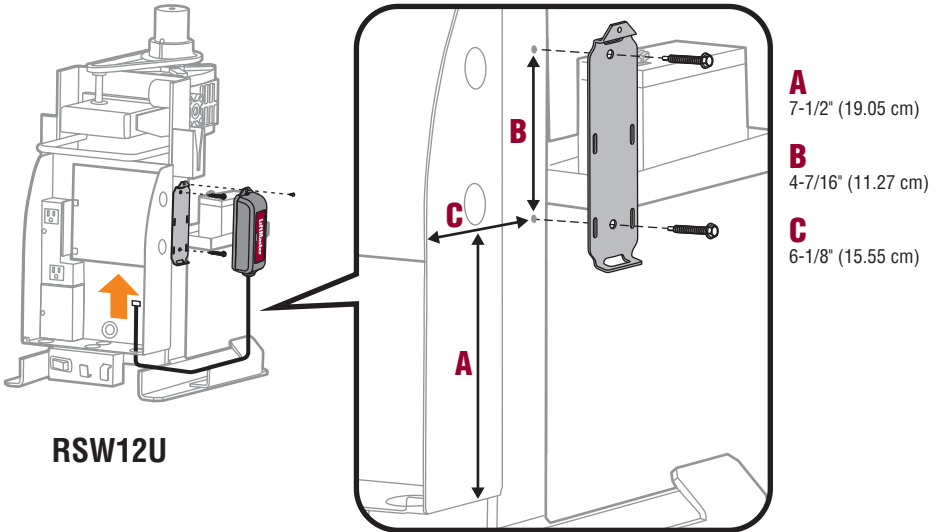

MODEL CSW24U - RECEIVER MOUNTING LOCATION

Mount the bracket on the side facing the gate.

MODÈLE CSW24U - RECEIVER MOUNTING LOCATION

Mount the bracket on the side facing the gate.

MODELO CSW24U - RECEIVER MOUNTING LOCATION

Mount the bracket on the side facing the gate.

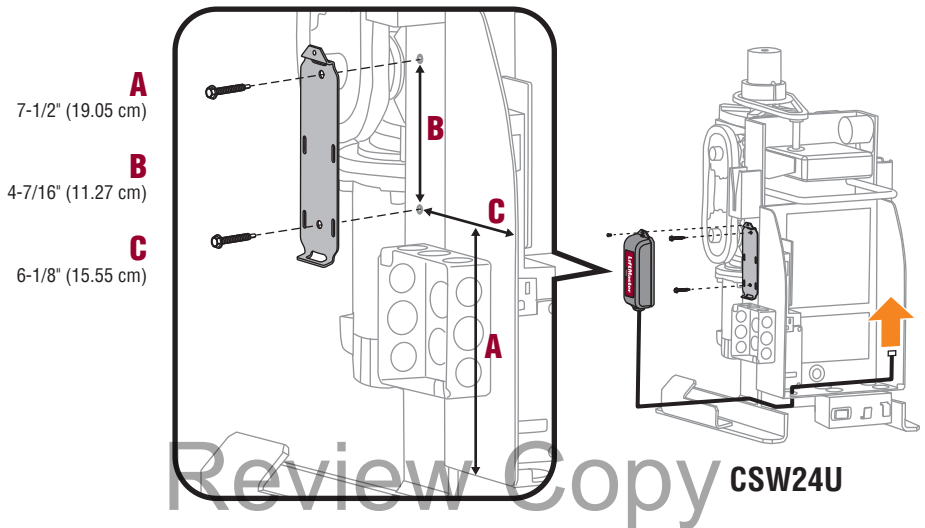
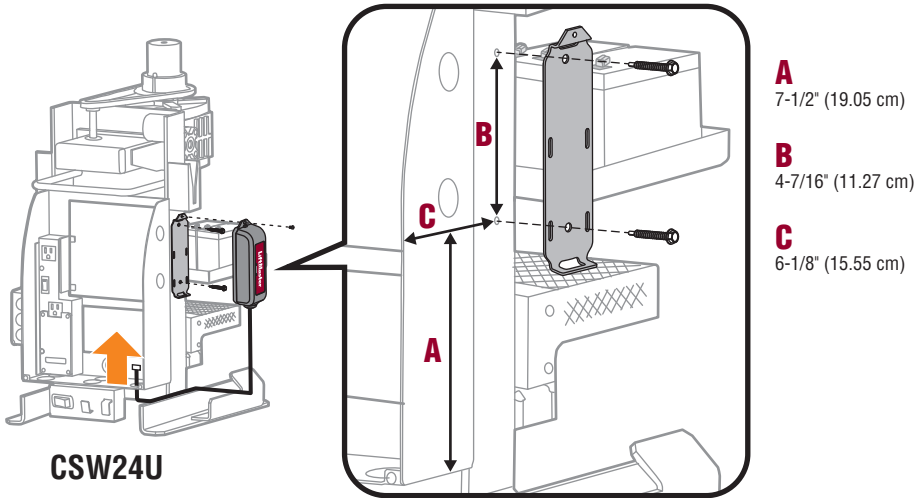

MODELS RSL12U AND CSL24U - RECEIVER MOUNTING LOCATION
 MODÈLES RSL12U ET CSL24U - RECEIVER MOUNTING LOCATION
 MODELOS RSL12U Y CSL24U - RECEIVER MOUNTING LOCATION

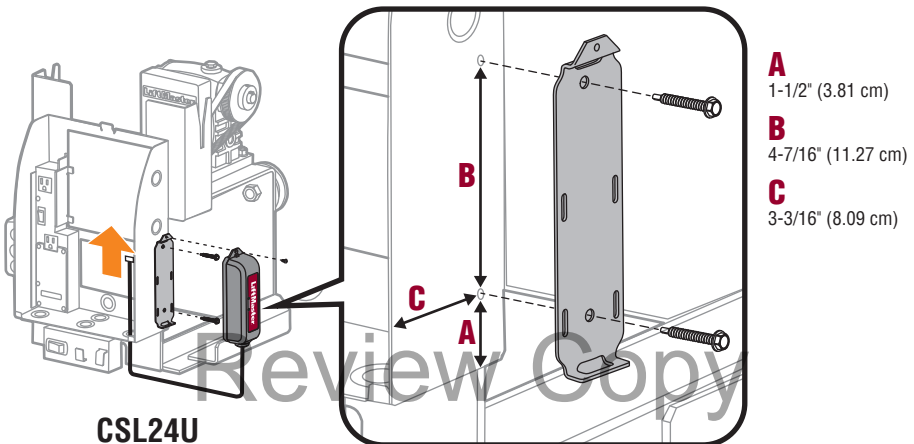
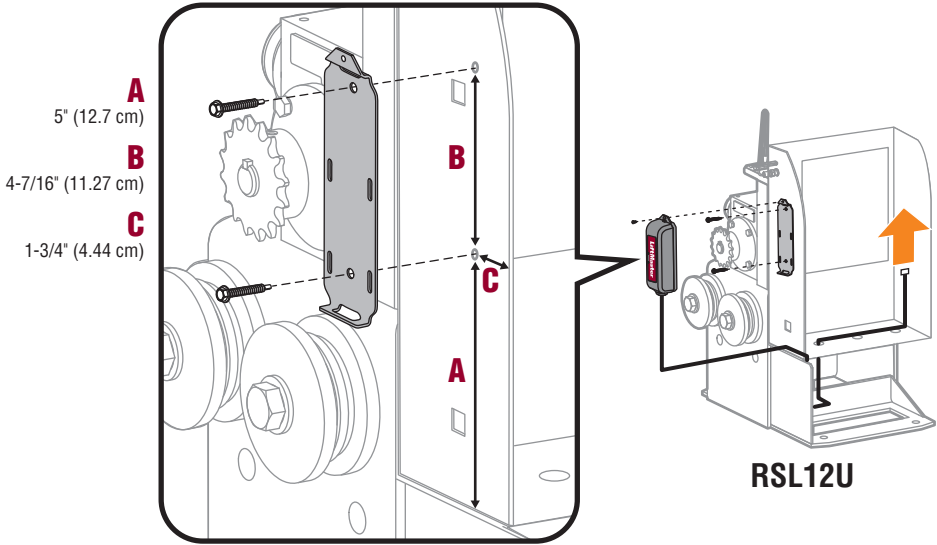

MODELS LA400, LA412, AND LA500 - RECEIVER MOUNTING LOCATION
 MODÈLES LA400U, LA412, ET LA500 - RECEIVER MOUNTING LOCATION
 MODELOS LA400U, LA412, Y LA500 - RECEIVER MOUNTING LOCATION

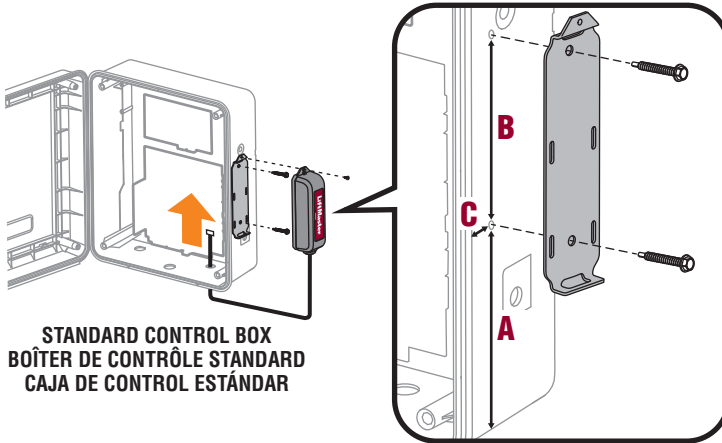

STANDARD CONTROL BOX
GRAND BOÎTER DE CONTRÔLE EN MÉTAL
CAJA DE CONTROL METÁLICA GRANDE

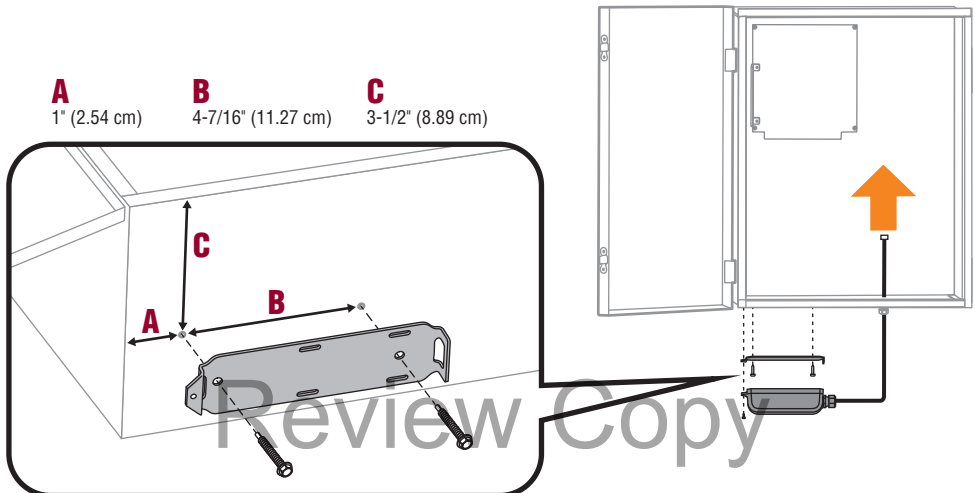

MODEL CSW200U - RECEIVER MOUNTING LOCATION

Mount the bracket on the side facing the gate.

MODÈLE CSW200U - RECEIVER MOUNTING LOCATION

Mount the bracket on the side facing the gate.

MODELO CSW200U - RECEIVER MOUNTING LOCATION

Mount the bracket on the side facing the gate.

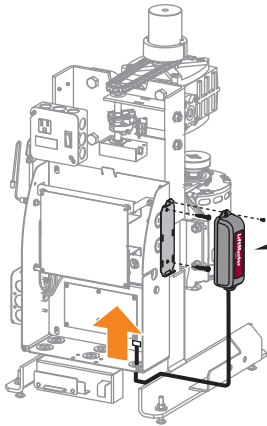

CSW200U

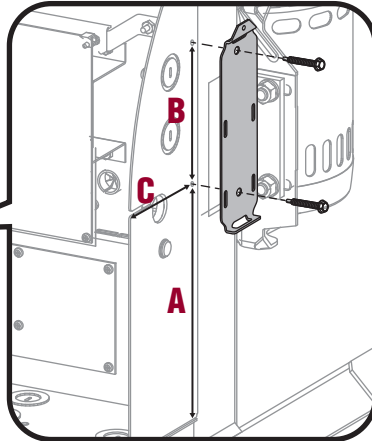

- A**
8" (20.32 cm)
- B**
4-7/16" (11.27 cm)
- C**
3-3/4" (9.52 cm)

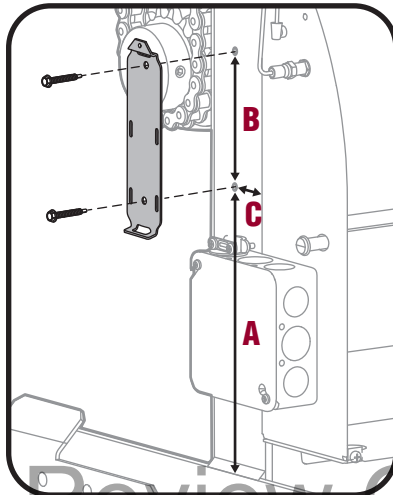

- A**
9" (22.86 cm)
- B**
4-7/16" (11.27 cm)
- C**
1-1/2" (3.81 cm)

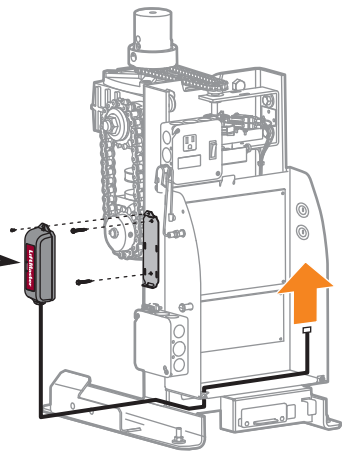

CSW200U

Review Copy

MODEL SL3000U - RECEIVER MOUNTING LOCATION

Mount the bracket on the side facing the gate.

MODÈLE SL3000U - RECEIVER MOUNTING LOCATION

Mount the bracket on the side facing the gate.

MODELO SL3000U - RECEIVER MOUNTING LOCATION

Mount the bracket on the side facing the gate.

A
3-1/4" (8.25 cm)

B
4-7/16" (11.27 cm)

C
1" (2.54 cm)

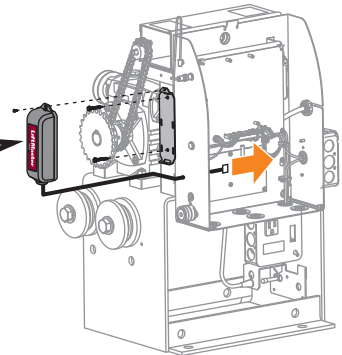
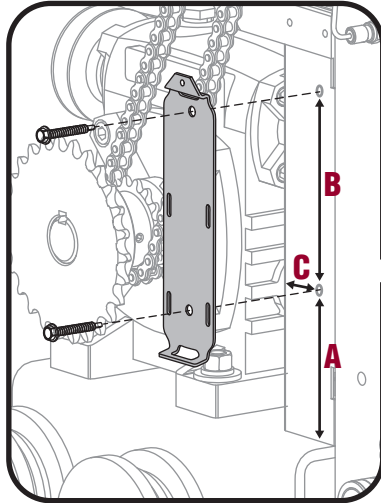

SL3000

Review Copy

MODELS SL585 AND SL595 - RECEIVER MOUNTING LOCATION
 MODÈLES SL585 AND SL595 - RECEIVER MOUNTING LOCATION
 MODELOS SL585 AND SL595 - RECEIVER MOUNTING LOCATION

- A**
4-1/16" (10.3 cm)
- B**
4-7/16" (11.27 cm)
- C**
1" (2.54 cm)

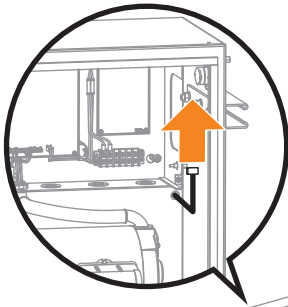
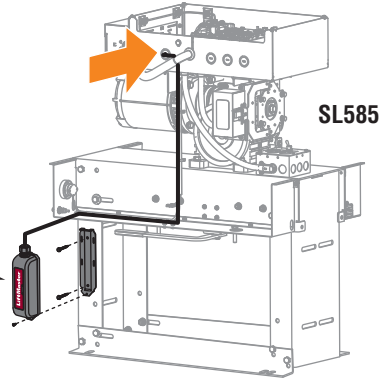
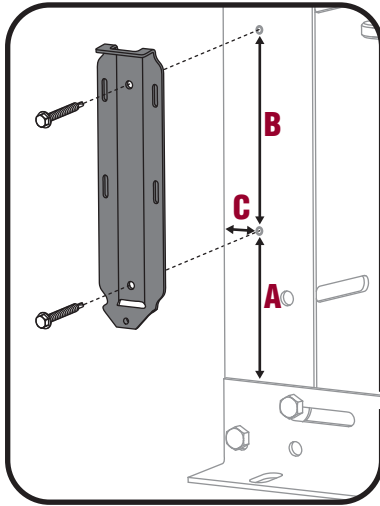

- A**
6" (15.24 cm)
- B**
4-7/16" (11.27 cm)
- C**
11-3/4" (29.84 cm)
- D**
1" (2.54 cm)

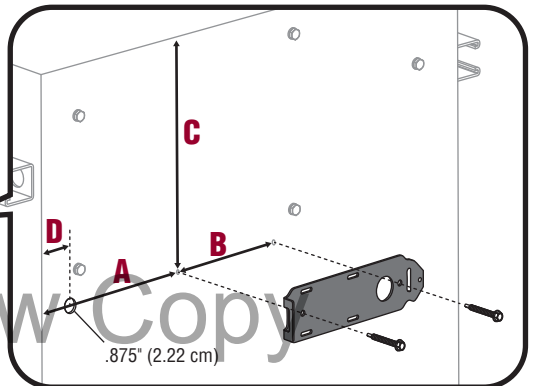
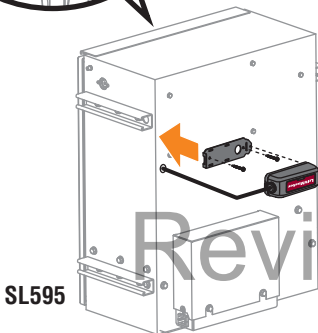

Review Copy

WARRANTY

LiftMaster® warrants to the first consumer purchaser of this product that it is free from defect in materials and/or workmanship for a period of 2 years from the date of purchase.

GARANTIE

LiftMaster® garantit à l'acheteur initial de ce produit que celui-ci est exempt de tout défaut matériel ou de fabrication pendant une période de deux ans suivant la date d'achat.

GARANTÍA

LiftMaster® garantiza al primer comprador minorista de este producto, que el mismo está libre de defectos de materiales y de mano de obra por un período de dos años a partir de la fecha de compra.

NOTICE: This device complies with part 15 of the FCC rules and Industry Canada (IC) licence-exempt RSS standard(s). Operation is subject to the following two conditions: (1) this device may not cause harmful interference, and (2) this device must accept any interference received, including interference that may cause undesired operation.

Any changes or modifications not expressly approved by the party responsible for compliance could void the user's authority to operate the equipment.

This Class B digital apparatus complies with Canadian ICES-003.

This device must be installed in a way where a minimum 8" (20cm) distance is maintained between users/bystanders and device.

This device has been tested and found to comply with the limits for a Class B digital device, pursuant to part 15 of the FCC rules. These limits are designed to provide reasonable protection against harmful interference in a residential installation. This equipment generates, uses and can radiate radio frequency energy and, if not installed and used in accordance with the instructions, may cause harmful interference to radio communications. However, there is no guarantee that interference will not occur in a particular installation. If this equipment does cause harmful interference to radio or television reception, which can be determined by turning the equipment off and on, the user is encouraged to try to correct the interference by one or more of the following measures:

- Reorient or relocate the receiving antenna.
- Increase the separation between the equipment and receiver.
- Connect the equipment into an outlet on a circuit different from that to which the receiver is connected.
- Consult the dealer or an experienced radio/TV technician for help.

AVIS : Ce dispositif est conforme à la partie 15 des règles de la FCC et des normes RSS exemptées de licence d'Industrie Canada (IC). L'utilisation est assujettie aux deux conditions ci-après : (1) ce dispositif ne doit pas causer d'interférences nuisibles, et (2) ce dispositif doit accepter toute interférence reçue, y compris une interférence pouvant causer un fonctionnement indésirable.

Tout changement ou toute modification non expressément approuvés par la partie responsable de la conformité pourrait annuler l'autorité de l'utilisateur d'utiliser l'équipement.

Cet appareil numérique de classe B est conforme à la norme ICES-003 du Canada.

This device must be installed in a way where a minimum 8" (20cm) distance is maintained between users/bystanders and device.

Ce dispositif a été mis à l'essai et déclaré conforme aux limites établies pour les dispositifs numériques de classe B, conformément à l'article 15 des règles de la FCC. Cette conformité a pour but de fournir une protection raisonnable contre les interférences nuisibles dans une installation résidentielle. Cet équipement génère, utilise et peut émettre des fréquences radio et, s'il n'est pas installé et utilisé conformément aux instructions, causer des interférences nuisibles aux communications radio. Cependant, il n'existe aucune garantie que des interférences ne se produiront pas dans une installation particulière. Si cet équipement provoque des interférences nuisibles à la réception d'une diffusion sonore ou visuelle, ce qui peut être déterminé en l'allumant et en l'éteignant, l'utilisateur est invité à essayer de résoudre ce problème en prenant une ou plusieurs des mesures suivantes :

- Réorienter ou déplacer antenne de réception.
- Augmenter la distance entre l'équipement et le récepteur.
- Brancher l'appareil à une prise sur un circuit différent de celui du récepteur.
- Pour obtenir de l'aide, consulter le détaillant ou un radiotechnicien expérimenté.

AVISO: Este dispositivo cumple con la Parte 15 de las normas FCC y las normas RSS con excepción de licencia de Industry Canada (IC) de Canadá. El uso está sujeto a las siguientes condiciones: (1) Este dispositivo no debe causar interferencia perjudicial, y (2) este dispositivo debe poder recibir interferencia, incluso interferencia que pueda afectar su funcionamiento.

Todo cambio o toda modificación no expresamente aprobada por la parte responsable del cumplimiento podría anular el derecho de usar el equipo.

Este aparato digital de Clase B cumple con las normas canadienses ICES-003

This device must be installed in a way where a minimum 8" (20cm) distance is maintained between users/bystanders and device.

Este dispositivo ha sido probado y cumple con los límites establecidos para un dispositivo digital de Clase B según la Parte 15 de las Normas de FCC de EE.UU. Estos límites tienen por objeto brindar un grado razonable de protección contra interferencias molestas en una instalación residencial. Este equipo genera, usa y puede emitir energía de radiofrecuencia. Si no se instala y utiliza de acuerdo con las instrucciones podrá causar interferencia con comunicaciones radiales. Aun así, no hay garantía de que no se produzcan interferencias en una instalación particular. Si este equipo produce interferencia en la recepción de radio o televisión, lo cual puede determinarse apagando y encendiendo la unidad, el usuario debe tratar de corregir el problema por medio de lo siguiente:

- Reorientar o reubicar la antena de recepción.
- Aumentar la distancia de separación entre el equipo y el receptor.
- Conectar el equipo a un tomacorriente de un circuito eléctrico diferente al que esté conectado el receptor.
- Consultar al distribuidor del producto o a un técnico idóneo de radio y televisión.

For parts and accessories visit LiftMaster.com
Pour les pièces et accessoires, allez à LiftMaster.com
En LiftMaster.com pueden adquirirse repuestos y accesorios

LiftMaster®
845 Larch Avenue
Elmhurst, IL 60126-1196
LiftMaster.com

The Bluetooth® word mark and logos are registered trademarks owned by Bluetooth SIG, Inc.
The Bluetooth® word mark and logos are registered trademarks owned by Bluetooth SIG, Inc.
The Bluetooth® word mark and logos are registered trademarks owned by Bluetooth SIG, Inc.

Review Copy

© 2015, LiftMaster
All Rights Reserved
Tous droits réservés
Todos los derechos reservados