

### OVERVIEW

For use with any 315 MHz SECURITY+® garage door openers having a purple "learn" button.

The EntryEase system uses biometric technology that enables an authorized user to gain access by scanning their fingerprint. The sensor strip on the unit makes a numeric template of the fingerprint that is unique only to that user.

**Resend Button:** When pressed the traveling door will reverse. The fingerprint sensor is inactive for 15 seconds after valid swipe so reswiping will not reverse the door.

**Enroll Button:** When pressed the Enroll LED will light up signaling that the device is in enroll mode.

**READY LED:** Lit (green) when unit is ready to accept a fingerprint scan.

**PASS LED:** Lit (green) when a scanned fingerprint matches a stored print.

**FAIL LED:** Lit (red) when a scanned fingerprint does not match a stored print.

**RETRY LED:** Lit (yellow) when another swipe is required.

**ENROLL LED:** Lit (yellow) when the unit is in enroll mode.

**SEND LED:** Lit (yellow) after a passed fingerprint scan and enables the Resend button for retransmission.

**NOTE:** The term "enroll" refers to scanning the fingerprint so the device will recognize the user. The term "swipe" refers to the movement of the finger across the sensor strip. The term "LED" stands for Light Emitting Diode.

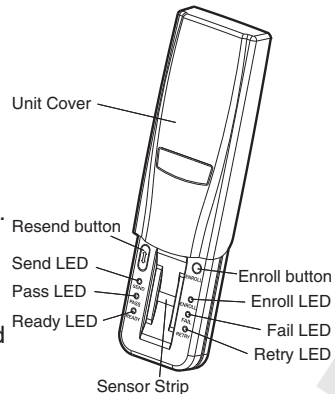

### INSTALLATION

1. Choose a convenient location for installation. Install out of the reach of children at a minimum height of 5 feet (1.5 m), away from all moving parts of door.

For a one-piece door, choose the optional location shown in the illustration to avoid injury as the door swings up and out.

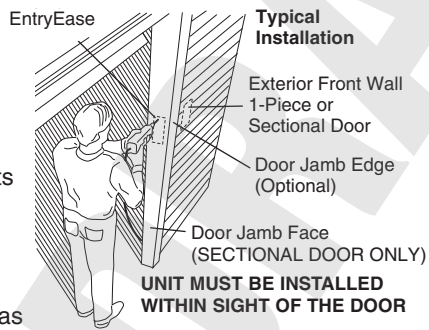

2. Remove the cover to access the top mounting hole by sliding past the "up stop" position.
3. Center the unit at eye level against the selected location. Mark the bottom edge at the center of the unit and remove from wall. Measure up 1-1/4" (3.2 cm) from this mark to locate the bottom mounting hole. Be sure that you have at least 11" (28 cm) above this mark to allow for the removal of cover. Drill a 1/8" (3.2 mm) pilot hole. Install bottom mounting screw, allowing 1/8" (3.2 mm) to protrude above surface. Position unit on screw head and adjust for snug fit.

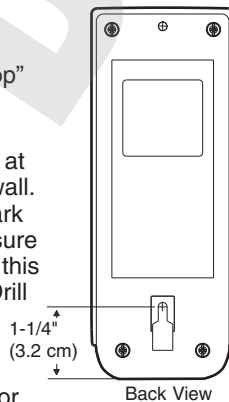

With cover off so top mounting hole is visible, mark the position of the hole. Remove unit and drill 1/8" (3.2 mm) pilot hole. Replace unit and complete installation of top screw, using care to avoid cracking plastic housing. Do not over tighten. To replace cover, insert into tracks and slide down.

### ! WARNING

To prevent possible SERIOUS INJURY or DEATH from a moving gate or garage door:

- Install Keyless Entry Control within sight of the garage door, out of reach of children at a minimum height of 5 feet (1.5 m), and away from all moving parts of door.
- ALWAYS keep remote controls out of reach of children. NEVER permit children to operate, or play with remote control transmitters.
- Activate gate or door ONLY when it can be seen clearly, is properly adjusted, and there are no obstructions to door travel.
- ALWAYS keep gate or garage door in sight until completely closed. NEVER permit anyone to cross path of moving gate or door.

**NOTICE:** To comply with FCC and or Industry Canada (IC) rules, adjustment or modifications of this receiver and/or transmitter are prohibited, except for changing the code setting or replacing the battery. THERE ARE NO OTHER USER SERVICEABLE PARTS.

Tested to Comply with FCC Standards FOR HOME OR OFFICE USE. Operation is subject to the following two conditions: (1) this device may not cause harmful interference, and (2) this device must accept any interference received, including interference that may cause undesired operation.

### TIPS FOR SUCCESSFUL ENROLLMENT

#### Correct

1. Make sure finger is free of grease or dirt. Place finger flat above the sensor strip with the top knuckle above the sensor.
2. Swipe finger straight down keeping firm contact with the sensor. The swipe should be a slow, constant speed.

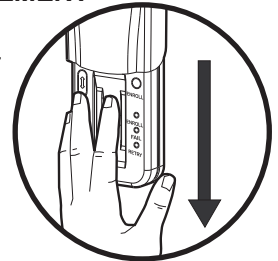

**NOTE:** Use the same finger for every swipe.

#### Incorrect

- Do not bend finger during the swipe as this will only scan the tip of your finger.
- Swipe straight down, not at an angle.
- Swipe flat, not tilted or rolled to one side.

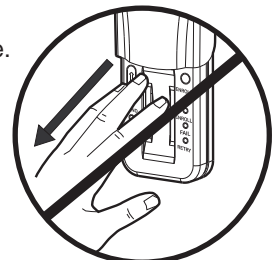
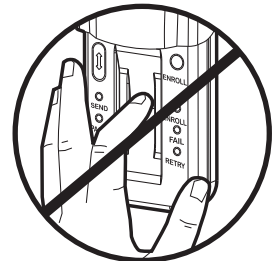

## ENROLLING INITIAL USER

**NOTE:** The unit requires at least 3 good swipes to enroll a user.

1. Ensure that Enroll LED and Ready LED are lit and not flashing.
2. Swipe fingerprint down the sensor strip. The Pass LED will light briefly if a good swipe was achieved. If Retry LED lights followed by Ready LED, continue swiping until Pass LED is lit.
3. When enroll process is complete, the Enroll LED and Pass LED will flash.

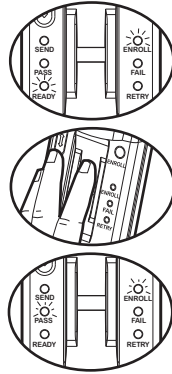

## PROGRAMMING TO OPENER

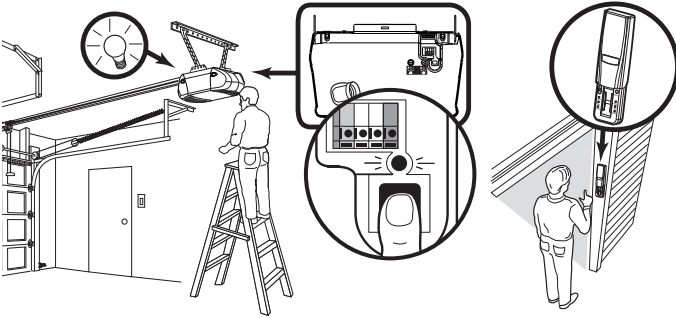

**NOTE:** The unit must have an enrolled user before it can be programmed to the opener.

1. Press the purple “learn” button on the motor unit of the opener.
2. Within 30 seconds, swipe enrolled fingerprint then press the Resend button.

**NOTE:** Due to the 30 second time interval, a second person may be needed to press the “learn” button.

## OPERATION

1. Open cover and unit will turn on. If cover is already open, press either the Resend or the Enroll button to turn unit on.
2. When Ready LED is lit, swipe an enrolled finger.
3. The Pass LED will flash and garage door will either open or close depending on the door’s current state. The Fail LED will light if another swipe is required.

## TO ENROLL ADDITIONAL USERS

The device can store up to four fingerprints at a time.

1. Turn unit on and wait for Ready LED to light.
2. Press and hold Enroll button for 1 second.
3. The Enroll LED will flash and an enrolled user must swipe fingerprint to allow new enrollment.
4. The Enroll LED and Ready LED will light up when ready for scan. The new user can now swipe their fingerprint. The fingerprint will be swiped at least 3 times to ensure that a good scan is made.
5. The Enroll LED and Pass LED will flash indicating successful enrollment and unit will return to Ready mode.

## TO ERASE USERS

**NOTE:** Erasing a user will erase **ALL** stored fingerprints and will no longer be programmed to the opener.

1. Enrolled user must swipe fingerprint.
2. Press and hold the Enroll button for at least 6 seconds. The Pass LEDs will flash for 15 seconds. During this time the Resend button is active. After 15 seconds the Enroll and Ready LEDs will light indicating fingerprints are erased. The unit will return to Enroll mode.

## FACTORY RESET

1. When unit is on, press and hold the Enroll button until all LEDs turn off (approximately 6 seconds).
2. Release the Enroll button.
3. Press and hold the Enroll button until the Ready and Enroll LEDs are lit and not flashing. The unit will clear all enrolled users and return to factory reset state.

## TROUBLESHOOTING

- If no known enrolled users are available:
  - The unit must be reset using the Factory Reset process.
- If the unit does not recognize a swiped fingerprint:
  - Ensure that the Ready LED is lit before you swipe.
  - Ensure that fingerprint is swiped correctly (See Tips for Successful Enrollment).
  - Ensure that fingerprint is enrolled.
  - Ensure that sufficient pressure is being applied to sensor strip (do not press too hard).
  - The finger may need to be moistened if skin is too dry.
- If the unit is Enroll mode at power up:
  - Complete enrollment process for initial user.
  - The initial enroll process failed (signalled by a lit Enroll LED and Fail LED) and must be repeated.
- If enrolling new user and all LEDs flash and unit returns to Ready mode:
  - The memory is full.
- If the unit does not wake:
  - A button may be stuck. Press Enroll and Resend buttons to ensure free movement.
  - The batteries may need to be replaced.

**NOTE:** If sensor is dirty, user should wipe sensor with a clean finger to remove any residue. It is recommended that the sensor be periodically cleaned with a lint-free cloth dampened with alcohol.

## THE BATTERY

### ⚠ WARNING

To prevent possible **SERIOUS INJURY** or **DEATH**:

- NEVER allow small children near batteries.
- If battery is swallowed, immediately notify doctor.

The batteries should produce power for at least one year. Replace when the Fail LED flashes during use.

The unit requires 4 AAA batteries.

Dispose of old batteries properly.

1. Slide cover past the normal “up stop” position.
2. Unscrew the two screws and remove the battery cover.
3. Replace the batteries. Screw the battery cover back on.
4. Slide entry cover back into place.

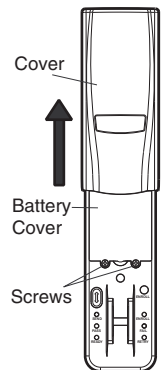

### Replacement parts:

Unit cover ..... 41A579

### FOR SERVICE DIAL OUR TOLL FREE NUMBER:

**1-800-4-MY-HOME® (1-800-469-4663)**