

Oracle limited LIFETIME WARRANTY

International Electronics Inc. (IEI) warrants this product to be free of defects in materials and workmanship, for its usable lifetime. For a period of ONE YEAR following purchase, IEI will repair or replace the product free of charge, including parts, labor, return shipping to you, and handling.

All repairs or replacements are at the discretion of the Manufacturer. This warranty excludes items that have been abused, altered, incorrectly installed, or repaired by an unauthorized person. Changes or modifications not expressly approved by the Manufacturer could void the user's authority to operate the equipment. The manufacturer is not responsible for any radio or TV interference caused by unauthorized modifications to this equipment. Such modifications could void the user's authority to operate the equipment. This warranty is limited to the product only. No consequential damages are covered.

After the initial one year of operation, the limited lifetime warranty will cover parts, labor, and return shipping to you, with a minimal handling charge specific to the product, as listed below:

Telephone Interface unit: \$40.00

If you have installation or operation questions or are in need of warranty service, please contact our Product Support department by email at techsupp@nwlink.com or call 360-254-1564 Tuesday-Friday 7-5 Pacific Time. If the issue is not resolvable, a manufacturer's warranty repair order may be issued. To have the product(s) sent for warranty service, a Return Authorization number will be issued for warranty service, which must be put on the outside of the package, to be received and handled properly. Packages for warranty service may be sent to the following address. Packages with no RA# may not be accepted.

IEI
5913C NE 127th AVE, Suite 800
Vancouver, WA 98682

Please include a note describing the problem that you are having and a copy of your original sales receipt (within the first year). If the warranty service is outside the first year, please include a check made out to IEI, based on the list of handling fees, shown above. Please note that you may need to send multiple units for warranty service, testing, and upgrading, though only the applicable fee for handling the failed unit(s) will be charged.

Please allow 2-4 weeks for service and return shipping. If an EXPEDITED repair/replacement is requested, a 100% surcharge applies. In this case, please write EXPEDITED after the RA number. IEI will attempt to return expedited repair orders within one week, except during holidays.

This device complies with part 15 of the FCC Rules. Operation is subject to the following two conditions: (1) This device may not cause harmful interference, and (2) this device must accept any interference received, including interference that may cause undesired operation.

International Electronics, Inc.
FCC ID: JLF7TU1
IC:
Model: OTIU
Country Of Origin: USA

Oracle^(tm)

Wireless Telephone Interface Unit

Thank you for purchasing the Oracle Telephone Interface Unit. This product has been designed and manufactured in the USA, utilizing the highest quality standards available.

**No Wiring or Trenching
Required**

- Easy to install
- Highly miniaturized unit requires minimal space
- 1000-foot standard range
- Range extendable by using Oracle Repeaters
- Digitally encrypted protocol for totally secure conversation
- Digital sound quality ensures crystal clear audio
- Highly adaptive penetration and channel handling protocols
- Compatible with multiple Oracle PRO, MiniGAP, and FrontDoor units
- Identify which gate or door a visitor is at with Caller ID and Distinctive Ring Tone
- Call forwarding function lets you control Gate Access when you are away
- Can command the Gate at any time using telephone keypad
 - Distinctive Call Waiting
 - Call Waiting ID
 - Places Conversation On-Hold
 - Auto Reconnect to 1st Connection
 - Busy Detect & Retry on Forwarded Calls
 - DTMF Decoding



International Electronics, Inc.



Made With Pride In the USA.

A manufacturer's full One Year Warranty covers this product.

TABLE OF CONTENTS

Preface	
General Information.....	3
Parts Supplied.....	3
Section 1 – Installation	
Installing the OTIU.....	3-4
Section 2 – Activation	
2.1 Activating the OTIU with a GAP unit.....	4
2.2 Activating the OTIU with a MiniGAP unit.....	5
2.3 Activating the OTIU with a FrontDoor unit.....	5
2.4 Activating the OTIU within an existing Network.....	6
2.5 Activating the OTIU with a Repeater.....	7
Section 3 – Use	
Using the OTIU.....	8
Section 4 – OTIU Functions	
4.1 Caller ID Function.....	8
4.2 Call Waiting Function.....	8
4.3 Call Forwarding Function.....	9
A. To program a call forwarding number.....	9
B. To verify a call forwarding number.....	9
C. To enable/disable call forwarding.....	10
4.4 Change the number of rings.....	10
4.5 Place the OTIU in Intercom Mode.....	10
A. To enable/disable intercom mode	
Section 5 – Quick List of Functions	
Quick list of functions and their respective key codes.....	11
Section 6 – Frequently Asked Questions	
Troubleshooting and FAQ's.....	11

NOTE: This product is compatible with Oracle PRO Gate Access Panel (GAP) model 600-8 or later and/or Oracle Repeater (RPT-1) model 604-2 or later.

QUICK LIST OF FUNCTIONS

Activating the OTIU	**07
Clear memory:	**#8
Activate gate:	*9
Verify call-forwarding number:	**06
Enable call forwarding:	**01
Disable call forwarding:	**02
Change number of rings:	**10_(2-5)
Enable intercom mode:	**031
Disable intercom mode:	**032

TROUBLESHOOTING AND FREQUENTLY ASKED QUESTIONS

The OTIU does not seem to function

If you hear nothing on the telephone that is connected to the OTIU, check the phone connections and if it is a two-line phone, be sure that it is on LINE 1. If you receive a dual-tone error sound when attempting to open a gate, make sure that the OTIU is indeed programmed to the correct GAP, MiniGAP, or FrontDoor Unit and that the Gate Controller in question has been taught to the master unit as well. If an OTIU has already been taught, trying to re-teach it will sound a dual-tone error as well. See "How do I clear the memory".

How do I clear the memory of the OTIU

Clearing the memory will not clear any OTIU settings or programmed phone numbers. To clear the memory, use the telephone that is directly connected to the OTIU and dial:

*** * # 8 "BEEP"**

While entering numbers, it goes to a dial tone

All numbers and symbols must be dialed within 3 seconds of each other, otherwise the unit times out and goes back to a dial tone.

It is not getting the expected transmission range

Trees, metal or anything electrical between units can limit the range, as can having any units mounted on a tree, masonry, or metal surface.

I dial ** and hear the beep, but it won't accept the rest of the command

Check the line and phone connections.

TO ENABLE/DISABLE CALL FORWARDING

To enable the Call Forwarding function, use the telephone that is directly connected to the OTIU and dial: *** * 0 1** "BEEP"

To enable the Call Forwarding function, use the telephone that is directly connected to the OTIU and dial: *** * 0 2** "BEEP"

TO CHANGE THE NUMBER OF TIMES THE OTIU RINGS THE PHONE

By default, the OTIU will ring the telephone 4 times. You might want to change the number of times the telephone rings for any given reason.

For example, if you have an answering machine and it is programmed to pick up after 4 rings, you might want to change the OTIU to ring the telephone only 3 times. This will prevent your answering machine from picking up if your phone is not answered when someone presses the "CALL" button on your GAP, MiniGAP, or FrontDoor Unit.

NOTE: If your answering machine does pick up, the visitor will hear your answering machine message through the speaker.

Using the telephone that is directly connected to the OTIU, dial:

*** * 1 0 2** for 2 rings, up through *** * 1 0 5** for 5 rings.

TO PLACE THE OTIU IN INTERCOM MODE

If you would like the OTIU to act independently from your home phone line, you can simply have it as part of your network in intercom mode. To enable/disable this feature, you will need to have the phone cord plugged into the wall jack.

TO ENABLE/DISABLE INTERCOM MODE

To enable the Intercom Mode function, with the phone cord plugged into the wall jack and using the telephone that is directly connected to the OTIU, dial: *** * 0 3 1** Unplug the phone cord from the wall jack.

To disable the Intercom Mode function, with the phone cord plugged into the wall jack and using the telephone that is directly connected to the OTIU, dial: *** * 0 3 2**

NOTE: If you have the Intercom Mode enabled on the OTIU you cannot use the Call Forwarding feature, as there is no line to dial out on.

GENERAL INFORMATION

The Oracle Telephone Interface Unit (OTIU) allows you to talk to visitors at your gate or door, when used with the Oracle PRO Gate System, MiniGAP, and/or Oracle FrontDoor Unit. When used with the Oracle PRO Gate System or MiniGAP, the OTIU allows you to activate your gate from your phone, no matter where you are, using your telephone keypad.

The OTIU easily connects to any phone or phone system and provides Long-Range Wireless Connection from the Oracle GAP, MiniGAP, or FrontDoor to any or all of the phones.

The OTIU works at it's maximum potential when utilized with an Expandable Phone System* and is the recommended setup for this product. With this type of setup, the OTIU will ring all of the phones in your house when there is a visitor at your gate or front door. When you have different types of phones (non-expandable systems) throughout your house, the OTIU will only ring the phone that it is connected to.

*One base station, requiring only one phone jack allowing you to add additional handsets into the system that use wall power only.

PARTS SUPPLIED

- 1 - Oracle Telephone Interface Unit (OTIU)
- 1 - Antenna
- 1 - 18V Power Adapter
- 1 - Phone Cord
- 1 - Set of 4 Bumper Feet

INSTALLING THE OTIU

Place the 4 Bumper Feet onto the bottom of the OTIU. This will keep the unit from sliding around.

Plug the antenna into the back of the Telephone Interface Unit (OTIU) where it is labeled "antenna". Make sure to position the antenna wire pointing straight up from the unit to achieve maximum range.

INSTALLING THE OTIU - CON'T

Place the OTIU in an out-of-the-way location near the primary telephone connection and an electrical outlet. Make sure to keep obstructions away from the antenna and do not allow any cables or cords to become entangled in it.

Plug in the 18V power adapter into the back of the OTIU where it is labeled "18VDC". The POWER light on the OTIU will light-up.

Plug the included phone cord into the wall phone jack and connect to the OTIU using the LINE port on the back of the unit.

Connect the telephone line to the OTIU using the PHONE port on the back of the unit.

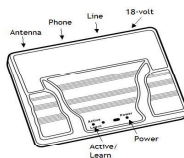

2.1 ACTIVATING THE OTIU WITH GAP

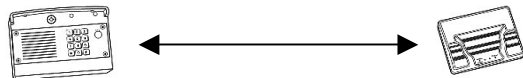

(NOTE: Both step A & B must occur within 15 seconds of each other)

- A. Using the phone that is connected to the OTIU, once you hear a dial tone press: *** * 0 7 "BEEP"**

Hang up and the LEARN light will flash for up to 15 seconds. If it does not and you hear an error tone, see "How do I clear the memory", in the FAQ section. Otherwise, repeat the process.

- B. On the Gate Access Panel (GAP), enter the Master PIN number:

For example: **1 2 3 4 "BEEP"**

Followed by: **0 5**

Then press: **"CALL"**

The OTIU will ring the telephone and Caller ID will display "Unit Learned".

4.3 CALL FORWARDING FUNCTION

(Does NOT require Call Forwarding Service with your telephone company)

If you are going to be away from home, you can have the OTIU call you when there is a visitor. When a visitor presses the CALL button, the OTIU will ring the home telephone 1 time. If the telephone is not answered, the OTIU will dial the call-forwarding number that you have programmed into it (see below). After ringing the forwarding number 3 times, the OTIU will hang up. If a visitor presses the CALL button again, the process will repeat.

When you answer a call from the OTIU, you will hear a repeating beep for up to 10 seconds. If you want to accept the call from the OTIU simply dial: **0** Hang up to disconnect.

To control the gate, dial: *** 9**

TO PROGRAM A FORWARDING PHONE NUMBER

To program in forwarding telephone number, use the telephone that is directly connected to the OTIU, and dial:

*** # "BEEP"**

Enter the telephone number (up to 14 digits) that you wish to forward calls to. To accept the new number simply press:

"BEEP"

NOTE: For long distance calls, be sure to include the proper prefix.

VERIFYING THE CALL FORWARDING PHONE NUMBER

Using the telephone connected to the OTIU, dial:

*** * 0 6 "BEEP"** Hang up the telephone.

The telephone will ring and the forwarded number that you have programmed into the OTIU will be displayed on the Caller ID screen.

USING THE OTIU

When a visitor presses the CALL button, the telephone that is connected to the OTIU will give a distinctive ring up to 4 times. Or in the case of having an expandable phone system, all phones within the system will ring. Simply answer the phone and you will automatically connect to the Intercom at the gate or door.

After you have connected to the Intercom, if the visitor is at a Gate, you can then activate that Gate by dialing:

*	9
---	---

NOTE: At any time, you can pick up the telephone that is plugged into the OTIU and dial *9 to activate the primary gate controller.

4.1 CALLER ID FUNCTION

(Does NOT require Caller ID Service with your telephone company)

When there is a gate visitor, the OTIU will display 'Gate Visitor' on a Caller ID telephone (or Caller ID box) that it is directly connected to.

When there is a door visitor, the OTIU will display 'Front Door' or 'Back Door' depending on how you have your FrontDoor set up (see the FrontDoor unit instruction manual).

4.2 CALL WAITING FUNCTION

(Does NOT require Caller ID Service with your telephone company)

If you are talking on the telephone that is plugged into the OTIU, you will hear a distinctive call waiting beep on the line and the Caller ID will display, as above, alerting you to a visitor. To place the call on hold and connect to the Oracle Intercom, press the FLASH button (or switchhook) as you would to answer any call waiting call.

If you are talking on a different telephone, which is not in an expandable phone system, the telephone that is connected to the OTIU will ring as normal.

2.2 ACTIVATING THE OTIU WITH MINIGAP

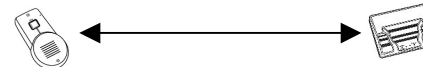

(IF THERE IS NOT AN EXISTING NETWORK)

(NOTE: Both step A & B must occur within 15 seconds of each other)

A. Using the phone that is connected to the OTIU, once you hear a dial tone press:

*	*	0	7
---	---	---	---

 "BEEP"

Hang up and the LEARN light will flash for up to 15 seconds. If it does not and you hear an error tone, see "How do I clear the memory", in the FAQ section. Otherwise, repeat the process.

B. On the MiniGAP, press and hold down the learn button for 1 second, to put it into learn mode.

NOTE: The learn button is a little black button located on the inside of the unit at the very top of the circuit board.

The OTIU will ring the telephone and Caller ID will display "Unit Learned".

2.3 ACTIVATING THE OTIU WITH FRONTDOOR

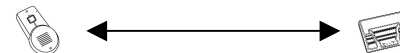

(IF THERE IS NO EXISTING NETWORK)

(NOTE: Both step A & B must occur within 15 seconds of each other)

A. Using the phone that is connected to the OTIU, once you hear a dial tone press:

*	*	0	7
---	---	---	---

 "BEEP"

Hang up and the LEARN light will flash for up to 15 seconds. If it does not and you hear an error tone, see "How do I clear the memory", in the FAQ section. Otherwise, repeat the process.

B. On the FrontDoor, press and hold down the learn button for 1 second, to put it into learn mode.

NOTE: The learn button is a little black button located on the inside of the unit at the very top of the circuit board.

The OTIU will ring the telephone and Caller ID will display "Unit Learned".

2.4 ACTIVATING THE OTIU WITHIN AN EXISTING NETWORK

When activating the OTIU within an existing network, simply follow the instructions for “Activating the OTIU with GAP” if the GAP is the Active (Main) Unit, the instructions for “Activating the OTIU with MiniGAP” if the MiniGAP is the Active Unit, or “Activating the OTIU with a FrontDoor” if the FrontDoor is the Active Unit. A few examples of an existing network are pictured as follows:

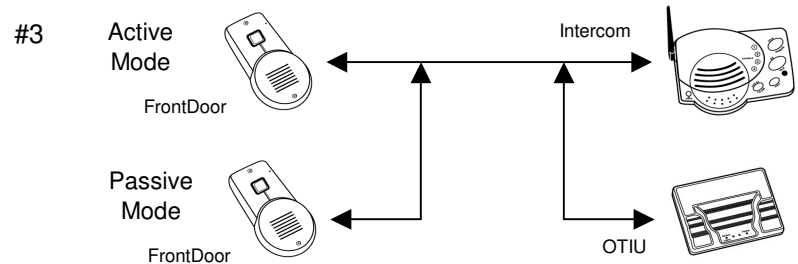
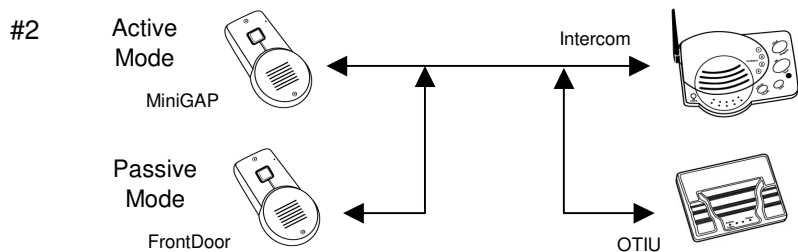
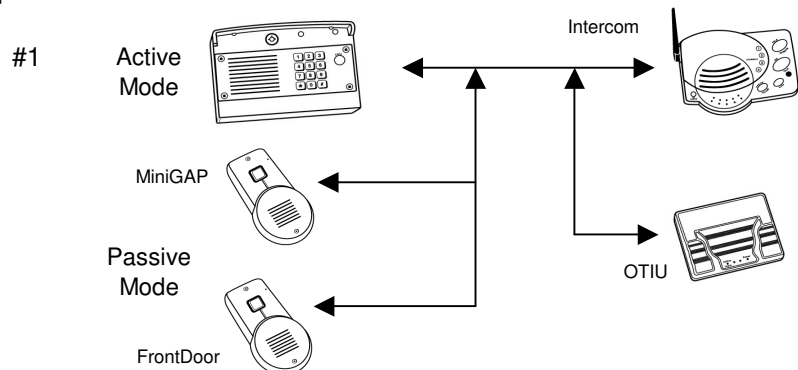

NOTE: By activating the OTIU to the Active Unit, you are activating the OTIU into the existing network with no further steps to take.

2.5 ACTIVATING THE OTIU WITH A REPEATER

(WITHIN AN EXISTING NETWORK)

Using the phone that is connected to the OTIU. Once you hear a dial tone press: *** * 0 7 "BEEP"**

Hang up and the LEARN light will flash for up to 15 seconds. If it does not and you hear an error tone, see “How do I clear the memory”, in the FAQ section. Otherwise, repeat the process.

Within 15 seconds, press the LEARN button on ONE of the Repeater Units. The LED by the LEARN button will light up for several seconds, then will go out and the OTIU will ring the telephone and display “Unit Learned”, indicating a successful activation.

NOTE: If the Repeater Units have not been previously activated to anything within an existing network, please follow the directions found in the Oracle Wire-free Repeater product manual.

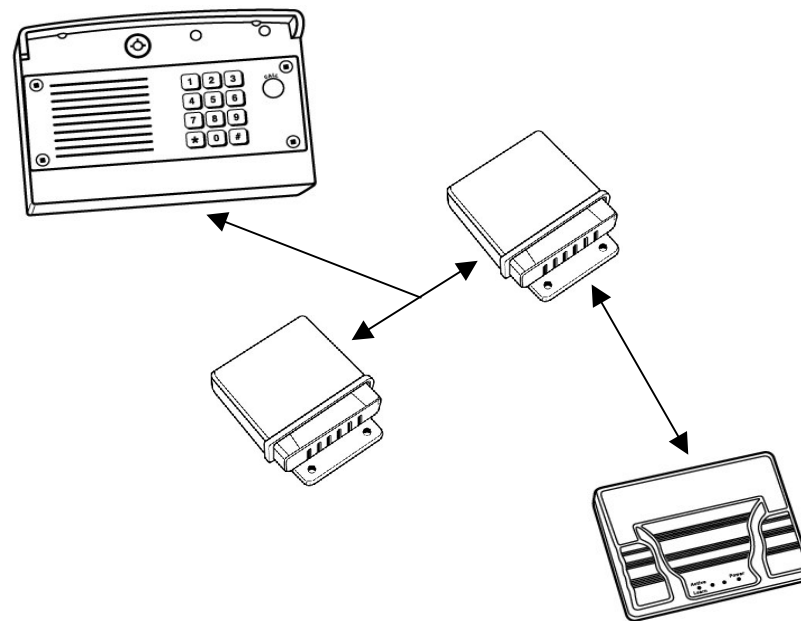

Model OTIU 608-1
4/5/2006
Patents Pending

Model OTIU 608-1
4/5/2006
Patents Pending

Model OTIU 608-1
4/5/2006
Patents Pending



Model OTIU 608-1
4/5/2006
Patents Pending