

Caution: The user is cautioned that changes and modifications made to the equipment without the approval of manufacturer could void the user's authority to operate this equipment.

Notes: This equipment has been tested and found to comply with the limits for a Class B digital device, pursuant to part 15 of the FCC Rules. These limits are designed to provide reasonable protection against harmful interference in a residential installation. This equipment generates, uses and can radiate radio frequency energy and, if not installed and used in accordance with the instructions, may cause harmful interference to radio communications. However, there is no guarantee that interference will not occur in a particular installation. If this equipment does cause harmful interference to radio or television reception, which can be determined by turning the equipment off and on, the user is encouraged to try to correct the interference by one or more of the following measures:

- Reorient or relocate the receiving antenna.
- Increase the separation between the equipment and receiver.
- Connect the equipment into an outlet on a circuit different from that to which the receiver is connected.
- Consult the dealer or an experienced radio/TV technician for help.

FCC Warning:

This device complies with part 15 of the FCC Rules. Operation is subject to the following two conditions: (1) This device may not cause harmful interference, and (2) this device must accept any interference received, including interference that may cause undesired operation.

1. Product Introduction:

1.1 Mounting the Rain Gauge

First remove the self-stick tape and rubber inset on the counting lever as shown as the following figure.

Secondly place the counting lever into the base and make sure the counting lever is placed in an upright position and is free to swing smoothly. Then place the rain collection into the unit.

Finally place the rain gauge on a flat surface above ground level to avoid being immersed in water while it is raining.

Note: do not store or locate the outdoor rain gauge close to any source of magnetic interference or electrical equipment.

2. Specifications :

- a. Rain 1 Hour Range: 0 to 5.10 inch
Rain 24 Hour Range: 0 to 81.8 inch
Rain Days Range: 0 to 199.98 inch
Rain Total Range: 0 to 199.98 inch
Resolution: 0.02 inch

- b. Transmission time interval:

Rain gauge: 57 OR 59 OR 61 OR 67 seconds.

3.Important Information:

- 1) For the initial set-up put the batteries in the indoor rain monitor base unit first and then into the outdoor rain gauge transmitter.
- 2) For the outdoor rain gauge transmitter, please make sure the counting lever inside the unit is placed in an upright position and is free to swing smoothly.
- 3) For the best reception and to avoid the outdoor rain gauge being immersed in water while it is raining, please place the outdoor rain gauge on a flat surface above ground level.
- 4) Do not store or locate the outdoor rain gauge and a counting lever close to any source of magnetic interference or electrical equipment.

3. Before Getting Started:

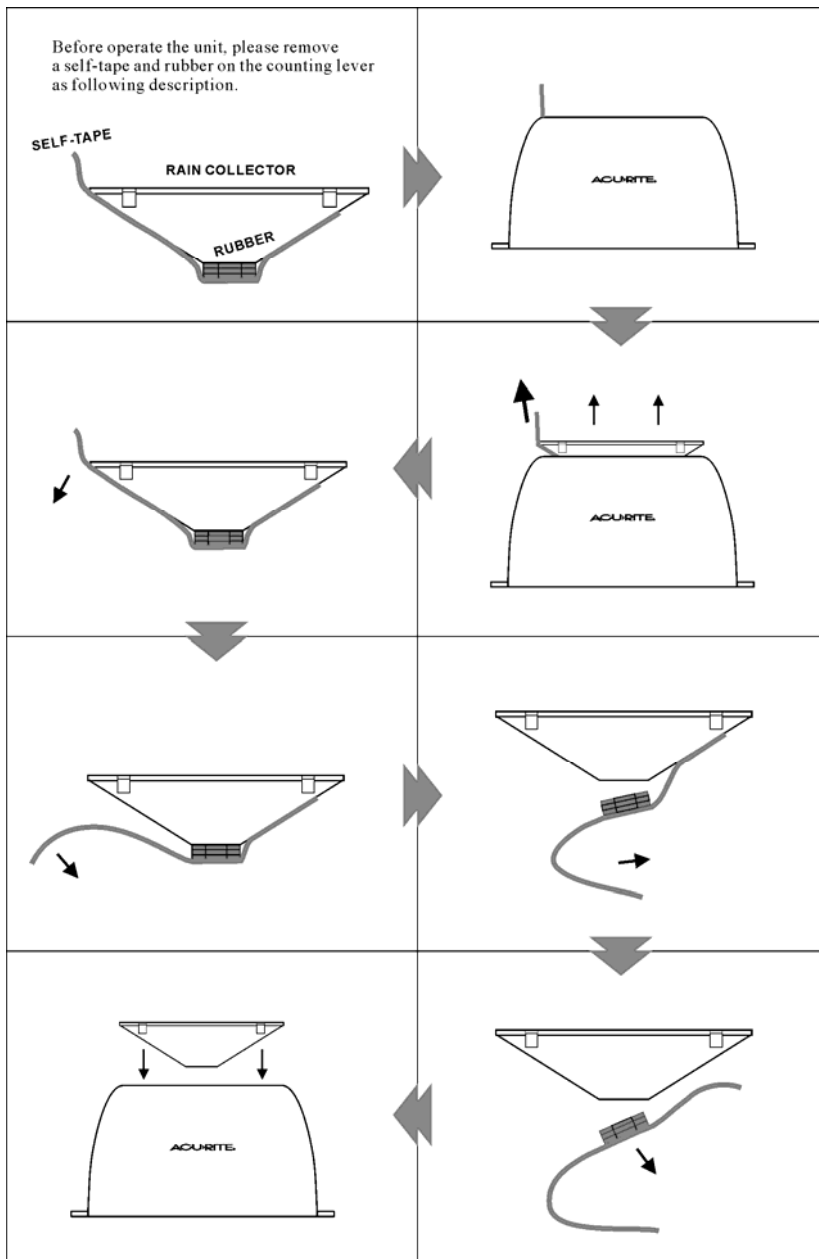
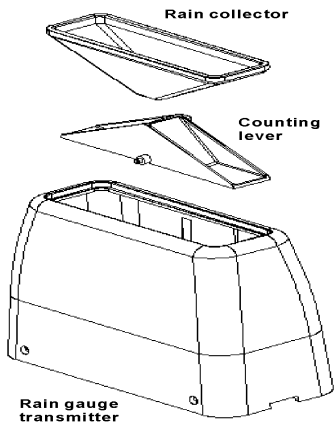

4. Getting Started (Power reset procedure)

1. Please make sure batteries are inserted into the indoor rain monitor first and the display appears. The unit will go into “sync mode” for 30 minutes.
2. Insert batteries in the outdoor rain gauge transmitter.
3. In the “sync mode” the indoor rain monitor will receive the outdoor transmission signal within 1 minutes.
4. At the synchronization period, the antenna  wave icon will keep blinking on the rain monitor display.
5. When the antenna wave icon stops blinking and remains on the display, this means synchronization has occurred and the main unit has gotten the signal from the transmitter unit.
6. Once the synchronization has occurred, the indoor rain monitor will detect updated rainfall information from the transmitter every minute automatically.

5. Outdoor Rain Gauge Transmitter:

- Measures the rainfall using the internal counting lever and transmits rainfall & rain mode information to the indoor rain monitor base unit.
- Lever resolution: each lever swing = 0.02 inch (0.508 millimeter).
- Low battery condition will be detected and displayed on the indoor rain monitor.
- Operation temperature range: -30° C to 50° C
- The antenna used for this transmitter must be installed to provide a separation distance of at least 20 cm from all persons and must not be co-located or operating in conjunction with any other antenna or transmitter.

6. Indoor Rain Monitor:

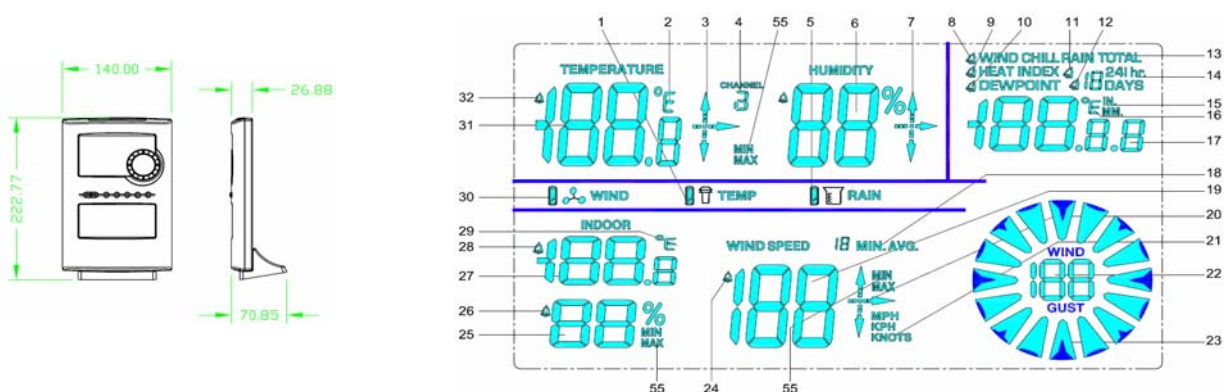

5. Low battery indicator for rain sender

13. Rainfall total display (optional)

14. 24h or user defined period display (optional)

15. Rainfall units (inch or MM)

6.1 Display

6.1.1 Press “Display” button is to view the following display area in upper right hand screen.

- Wind chill
- Heat index
- Dew point
- Rain in last hour
- Rain in last 24 hours
- Rain in user defined days
- Rain total

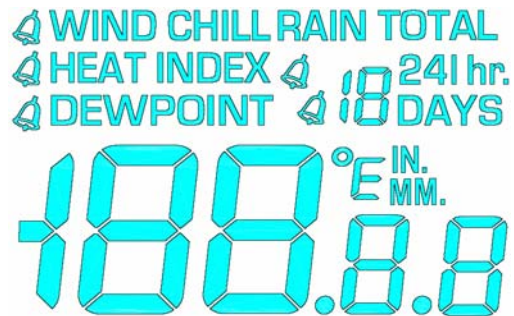

6.1.2 In the rain total mode, press and hold “Clear” button for 3 seconds is to clear the total rain record. (If it has the capability of rain gage)

6.1.3 The following record can be viewed in the MAX/MIN mode

1. Wind chill / Heat index / Dew point/Rain 1 hr. / Rain 24 hr.

View the max/min of anyone of them, press “Display” button is to set the one in normal mode.

6.2 In MAX / MIN mode, press “Daily Record” button to view rain 1 hr., the last 24 hour record can be viewed. When first press “MAX or MIN” button and later press “Daily Record” button to view rain 24 hr., the last 19 day record can be viewed.

6.3 In MAX / MIN mode, press “Record” button to view long time record, the rainfall can not be viewed.

7. Low battery indicator and battery changing



Battery full Low Battery

If you see that the low battery indicator(s) has changed to half-full status, please install fresh batteries.

Remove 4 screws from the bottom of the unit and remove the cover, install 2 AA alkaline batteries according to the polarity indicated. Then close the cover and screw 4 screws.

8. Indoor rain monitor:

Remove the old batteries from the battery compartment and insert 2 fresh “AA” alkaline batteries. Unit will sync with the outdoor transmitter unit automatically.

NOTE: After battery replacement, if you find any data showing on the indoor rain monitor display, it must be accumulated data. Please press the “RESET” button for 1 second to clear the display and start counting from 00.00IN or 000.0MM.

9. Outdoor rain gauge

To change the outdoor rain gauge batteries, you must press and hold the “RESET” button for 1 seconds on the indoor rain monitor and let it re-sync again.

NOTE: After battery replacement, if you find any data show on the indoor rain monitor display, it may an incorrect counting the occurred during the battery change. Please press the “RESET” button for 1 second to clear the display and start counting from 00.00IN or 000.0MM.

FCCID: RNE00597TX Notes: RAIN GAUGE Transmitter

This device complies with part 15 of the FCC rules. Operation is subject to the following two conditions: (1) This device may not cause harmful interference, and (2) this device must accept any interference received, including interference that may cause undesired operation.

