

#### LIMITED ONE YEAR WARRANTY

Chaney Instrument Company warrants that all products it manufactures to be of good material and workmanship and to be free of defects if properly installed and operated for a period of one year from date of purchase. REMEDY FOR BREACH OF THIS WARRANTY IS EXPRESSLY LIMITED TO REPAIR OR REPLACEMENT OF DEFECTIVE ITEMS. Any product which, under normal use and service, is proven to breach the warranty contained herein within ONE YEAR from date of sale will, upon examination by Chaney, and at its sole option, be repaired or replaced by Chaney. In all cases, transportation costs and charges for returned goods shall be paid for by the purchaser. Chaney hereby disclaims all responsibility for such transportation costs and charges. This warranty will not be breached, and Chaney will give no credit for products it manufactures which shall have received normal wear and tear, been damaged, tampered, abused, improperly installed, damaged in shipping, or repaired or altered by others than authorized representatives of Chaney.

THE ABOVE-DESCRIBED WARRANTY IS EXPRESSLY IN LIEU OF ALL OTHER WARRANTIES, EXPRESS OR IMPLIED, AND ALL OTHER WARRANTIES ARE HEREBY EXPRESSLY DISCLAIMED, INCLUDING WITHOUT LIMITATION THE IMPLIED WARRANTY OF MERCHANTABILITY AND THE IMPLIED WARRANTY OF FITNESS FOR A PARTICULAR PURPOSE. CHANEY EXPRESSLY DISCLAIMS ALL LIABILITY FOR SPECIAL, CONSEQUENTIAL OR INCIDENTAL DAMAGES, WHETHER ARISING IN TORT OR BY CONTRACT FROM ANY BREACH OF THIS WARRANTY. SOME STATES DO NOT ALLOW THE EXCLUSION OR LIMITATION OF INCIDENTAL OR CONSEQUENTIAL DAMAGES, SO THE ABOVE LIMITATION OR EXCLUSION MAY NOT APPLY TO YOU. CHANEY FURTHER DISCLAIMS ALL LIABILITY FROM PERSONAL INJURY RELATING TO ITS PRODUCTS TO THE EXTENT PERMITTED BY LAW. BY ACCEPTANCE OF ANY OF CHANEY'S EQUIPMENT OR PRODUCTS, THE PURCHASER ASSUMES ALL LIABILITY FOR THE CONSEQUENCES ARISING FROM THEIR USE OR MISUSE. NO PERSON, FIRM OR CORPORATION IS AUTHORIZED TO ASSUME FOR CHANEY ANY OTHER LIABILITY IN CONNECTION WITH THE SALE OF ITS PRODUCTS. FURTHERMORE, NO PERSON, FIRM OR CORPORATION IS AUTHORIZED TO MODIFY OR WAIVE THE TERMS OF THIS PARAGRAPH, AND THE PRECEDING PARAGRAPH, UNLESS DONE IN WRITING AND SIGNED BY A DULY AUTHORIZED AGENT OF CHANEY. THIS WARRANTY GIVES YOU SPECIFIC LEGAL RIGHTS, AND YOU MAY ALSO HAVE OTHER RIGHTS WHICH VARY FROM STATE TO STATE.

#### For in-warranty repair, please contact:

Customer Care Department  
Chaney Instrument Company  
965 Wells Street  
Lake Geneva, WI 53147

This device complies with part 15 of the FCC rules and RSS-210 of IC rules subject to the following two conditions:

- 1- This device may NOT cause harmful interference, and
- 2- This device must accept any interference received, including interference that may cause undesired operation.

Le présent appareil est conforme aux CNR d'Industrie Canada applicables aux appareils radio exempts de licence. L'exploitation est autorisée aux deux conditions suivantes :

- [1] l'appareil ne doit pas produire de brouillage, et
- [2] l'utilisateur de l'appareil doit accepter tout brouillage radioélectrique subi, même si le brouillage est susceptible d'en compromettre le fonctionnement.

**WARNING:** Changes or modifications to this unit not expressly approved by the party responsible for compliance could void the user's authority to operate the equipment.

**NOTE:** This equipment has been tested and found to comply with the limits for a Class B digital device, pursuant to Part 15 of the FCC rules. These limits are designed to provide reasonable protection against harmful interference in a residential installation. This equipment generates, uses and can radiate radio frequency energy and, if not installed and used in accordance with the instructions, may cause harmful interference to radio communications. However, There is no guarantee that interference will not occur in a particular installation. If this equipment does cause harmful interference to radio or television reception, which can be determined by turning the equipment off and on, the user is encouraged to try to correct the interference by one or more of the following measures:

- Reorient or relocate the receiving antenna.
- Increase the separation between the equipment and the receiver.
- Connect the equipment into an outlet on a circuit different from that to which the receiver is connected.
- Consult the dealer or an experienced radio/TV technician for help.

**NOTE:** The manufacturer is not responsible for any radio or TV interference caused by unauthorized modifications to this equipment. Such modifications could void the user authority to operate the equipment.

Patent numbers: 5,978,738; 6,076,044; 6,597,990  
ACURITE® is a registered trademark of the Chaney Instrument Co.  
Lake Geneva, WI 53147

06095BDIA1 102011

**ACURITE®**  
DESIGNED TO WORK FOR YOU™



**Weather Thermometer**  
model : 00609A1TX

**Instruction Manual**

## Introduction

Thank You for purchasing this Acurite® product. Please read through this manual in it's entirety to fully enjoy the benefits and features of this product. Please keep this manual for future reference.

NOTE: A protective film is applied to the LCD at the factory that must be removed prior to using this product. Locate the tab and simply peel to remove.

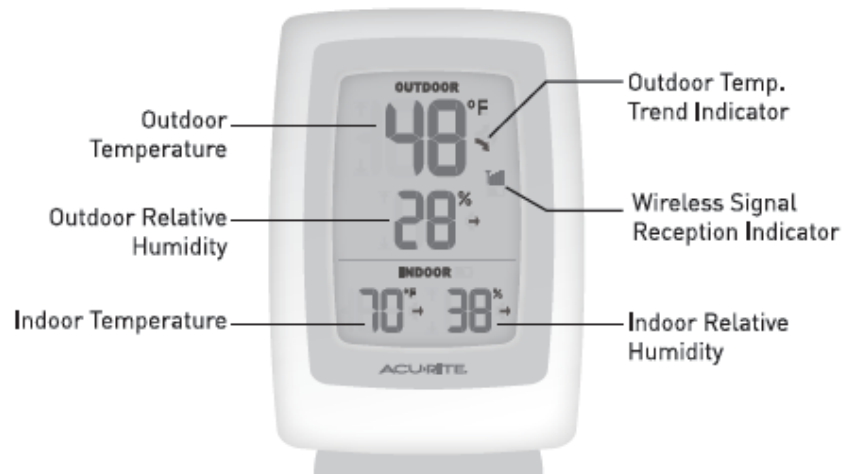

## Main Unit Detachable Stand

Included with the main unit is a detachable stand for table top placement.

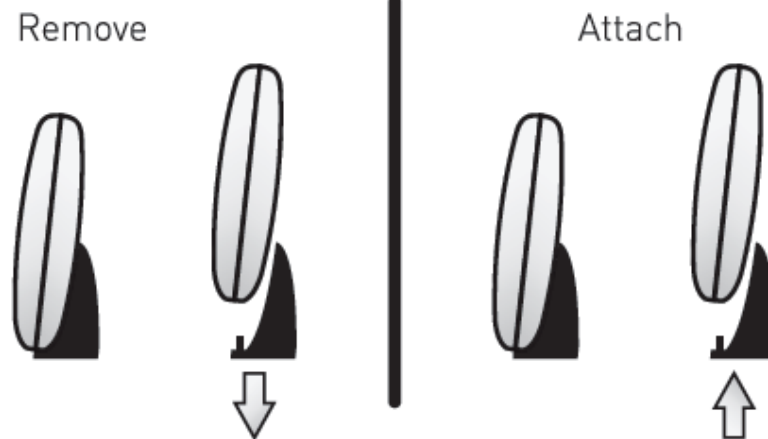

## Installing Batteries - Wireless Sensor

Remove the battery compartment cover. Install 2 fresh "AA" batteries as shown here. **BATTERIES MUST BE INSTALLED FOR THE SENSOR TO OPERATE**



## Battery Choice & Temperature Range

Extended periods of cold temperatures ( below -4°F / -20°C ) can cause alkaline batteries to function improperly. This will cause the outdoor wireless sensor to stop transmitting temperature readings. Use lithium batteries in these low temperature conditions to ensure continued operation for wireless sensors placed outdoors. NOTE: Rechargeable batteries are not recommended due to higher operating voltages.

**LITHIUM BATTERIES** -40°F (-40°C) (70°C) 158°F

**ALKALINE BATTERIES** -4°F (-20°C) (70°C) 158°F

## Installing Batteries - Display Unit

Remove the stand and battery compartment cover.

Install 2 fresh "AA" batteries into the battery compartment.

Replace the battery compartment cover.



Now that setup is complete, you must choose a location to place the wireless sensor and the display unit. The wireless sensor **MUST** be placed less than 165 feet (50 meters) away from the display unit.

This wireless thermometer uses radio frequency for communication, which is susceptible to interference from other electronic devices and large metallic items or thick walls. Always place both units at least 3 feet (.91 m) away from appliances ( TV, microwave, radios, etc. ) or objects that may interfere with the wireless communication ( large metal surfaces, thick stone walls, etc. ).

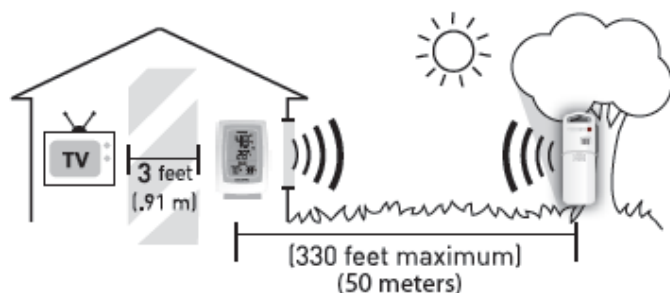

## Placement of Display Unit

Place the display unit in a dry area free of dirt and dust. To help ensure an accurate indoor temperature and humidity measurement, be sure to place the display unit out of direct sunlight, and away from any heat sources or vents in your home. There are 2 placement options for the display unit. You may hang the main unit on a wall using the integrated hang hole. Alternatively, you may place the main unit on a table top or other flat surface using the included detachable table top display stand.

## Placement of Sensor

The wireless sensor **MUST BE PLACED OUTDOORS** to observe outdoor temperatures and humidity. The wireless sensor must be placed less than 165 feet (50 m) from the display unit. The wireless sensor is water **resistant** and is designed for general outdoor use. However, to extend the life of the product, place the wireless sensor in an area protected from direct weather elements. To ensure an accurate outdoor temperature measurement, be sure the wireless sensor is placed out of direct sunlight and away from any heat sources.

There are 2 placement options for the wireless sensor. You may hang it using one of the two integrated hang holes, or use string (not included) to hang it from a suitable location like a well covered tree branch.

## Display Unit : MIN/MAX Memory

This wireless thermometer features a MIN/MAX memory feature which records the MINIMUM and MAXIMUM temperature and humidity readings.

To view the MINIMUM recorded temperature/humidity readings, press and release the "MIN" button. Note the "↓" icon on the display. To clear the MIN recorded values, press and hold the "MIN" button while in the MIN view mode. Dashes will display in the display to confirm you have cleared the MIN values for outdoor temperature and indoor temperature/humidity.

To view the MAXIMUM recorded temperature/humidity readings, press and release the "MAX" button. Note the "↑" icon on the display. To clear the MAX recorded values, press and hold the "MAX" button while in the MAX view mode. Dashes will display to confirm you have cleared the MAX values for outdoor temperature and indoor temperature/humidity.

### PRODUCT REGISTRATION

To receive product updates and information, Log on to [www.Acurite.com](http://www.Acurite.com)

Search keyword or item#

TECHNOLOGY ▾ SUPPORT ABOUT US ▾ CONTACT US ▾

- Product Documentation
- Frequently Asked Questions (FAQ)
- Troubleshooting
- Product Registration**

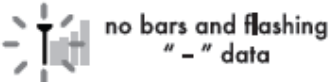
Problem	Possible Solution
<p><b>Bad Wireless Sensor Reception</b></p> 	<p>Relocate the main unit and/or the wireless sensor. Both units must be within 165 feet (50m) from each other. Make sure both units are placed at least 3 feet (.91 m) from other electronic appliances and devices that may interfere with the wireless communication (such as TV's, microwaves, computers etc). NOTE: It may take up to 20 minutes for the main unit to re-synchronize with the sensor when batteries are replaced. Use lithium batteries in sensor when temperature is below -4°F (-20°C).</p>
<p><b>No Wireless Sensor Data (no communication)</b></p> 	<p>If wireless reception is bad (no bars), see "Bad Reception" section above. The wireless ID setting on each unit must match for all units to communicate properly. See "Set Wireless ID" on the next page.</p>
<p><b>Display Console Screen Not Working</b></p>	<p>Make certain that the batteries are installed correctly.</p> <p>Batteries may need replacing</p>



Please DO NOT return product to the retail store. For technical assistance and product return information, please call Customer Care: **877-221-1252** Mon. - Fri. 7:00 A.M. to 7:00 P.M. (CST)

[www.acurite.com](http://www.acurite.com)

Batteries: 4 x "AA" (not included)

Lithium Batteries Recommended in **Outdoor Sensor** if temperatures are below -4°F

#### Measurement Ranges

Outdoor Temperature: -40°F to 158°F  
-40°C to 70°C

Outdoor Humidity: 1% to 99%

Indoor Temperature: 32°F to 122°F  
0°C to 50°C

Indoor Humidity: 1% to 99%

**Wireless Range:** 165 ft / 50 m MAX

Depending on home construction materials

## IMPORTANT NOTICE

Have questions about product setup or operation? We're here to help!

24/7 Support: [www.acurite.com](http://www.acurite.com)

- › Product Setup & Demo Videos
- › Product Manuals
- › Frequently Asked Questions
- › Register your Product
- › Support Forum
- › Submit Feedback & Ideas

EMAIL:  
[info@chaney-inst.com](mailto:info@chaney-inst.com)

TOLL FREE:  
**(877) 221-1252**  
7:00 a.m. - 7:00 p.m. CST

**1-Year Warranty**  
Don't forget! Register your product at: [www.acurite.com](http://www.acurite.com)



**PLEASE DISPOSE OF OLD OR DEFECTIVE BATTERIES IN AN ENVIRONMENTALLY SAFE WAY AND IN ACCORDANCE WITH YOUR LOCAL LAWS AND REGULATIONS.**

**BATTERY SAFETY:** Clean the battery contacts and also those of the device prior to battery installation. Remove batteries from equipment which is not to be used for an extended period of time. Follow the polarity (+/-) diagram in the battery compartment. Promptly remove dead batteries from the device. Dispose of used batteries properly. Only batteries of the same or equivalent type as recommended are to be used. DO NOT incinerate used batteries. DO NOT dispose of batteries in fire, as batteries may explode or leak. DO NOT mix old and new batteries or types of batteries (alkaline/standard). DO NOT use rechargeable batteries. DO NOT recharge non-rechargeable batteries. DO NOT short-circuit the supply terminals.